

Royal Borough of Kingston Upon Thames

Application to vary a premises licence under the Licensing Act 2003

PLEASE READ THE FOLLOWING INSTRUCTIONS FIRST

Before completing this form please read the guidance notes at the end of the form. If you are completing this form by hand please write legibly in block capitals. In all cases ensure that your answers are inside the boxes and written in black ink. Use additional sheets if necessary.

You may wish to keep a copy of the completed form for your records.

We Funbox Entertainment (UK) Limited

being the premises licence holder, apply to vary a premises licence under section 34 of the Licensing Act 2003 for the premises described in Part 1 below

|   |
|---|
| <b>Premises licence number</b><br>24/01617/LAPREM |
|---|

Part 1 – Premises Details

|   |                      |                  |         |
|---|----------------------|------------------|---------|
| <b>Postal address of premises or, if none, ordnance survey map reference or description</b> |                      |                  |         |
| Urban Fun<br>146 - 152 Clarence Street  |                      |                  |         |
| <b>Post town</b>  | Kingston Upon Thames | <b>Post code</b> | KT1 1QP |

|   |          |
|---|----------|
| Telephone number at premises (if any)   |          |
| Non-domestic rateable value of premises | £412,500 |

Part 2 – Applicant details

|   |  |                 |          |
|---|--|-----------------|----------|
| <b>Daytime contact telephone number</b>                               |  |                 |          |
| <b>E-mail address (optional)</b>                                      |  |                 |          |
| <b>Current residential address if different from premises address</b> | Funbox Entertainment (UK) Limited<br>Medina House,<br>2 Station Avenue |                 |          |
| <b>Post Town</b>  | Bridlington  | <b>Postcode</b> | YO16 4LZ |

**Part 3 - Variation**

Please tick yes

Do you want the proposed variation to have effect as soon as possible? - **FROM THE DATE ON WHICH THE COUNCIL ARE NOTIFIED THAT THE WORKS HAVE BEEN COMPLETED**

If not, from what date do you want the variation to take effect?

| Day | Month | Year |
|-----|-------|------|
|     |       |      |

Do you want the proposed variation to have effect in relation to the introduction of the late night levy? (Please see guidance note 1) Yes No

**Please describe briefly the nature of the proposed variation** (Please read guidance)

To vary the layout of the premises in accordance with plans supplied by the applicant such variation to have effect upon the completion of the works as notified to the Licensing Authority in writing. Permitted hours and licensable activities remain as existing

Alterations to the plans include the following:

Ground floor:

1. Small extension to licensed area to the rear of the premises with raised area formed.
2. New fixed seating booths next to kitchen area
3. Reconfiguration of kitchen layout
4. Host /check in area to front of the premises
5. Reconfigured food area to front of the premises
6. Revised location for AR darts
7. Revised location for golf simulators
8. Reconfigure toilet layout

Basement

1. Amended layout to mini golf structures
2. Revised bar/check in layout
3. New fixed seating to middle of premises
4. New screens at various locations

If your proposed variation would mean that 5,000 or more people are expected to attend the premises at any one time, please state the number expected to attend

|     |
|-----|
| N/A |
|-----|

**Part 4 Operating Schedule**

Please complete those parts of the Operating Schedule below which would be subject to change if this application to vary is successful.

**Provision of regulated entertainment** (Please read guidance note 3)

**Please tick all that apply**

- a) plays (if ticking yes, fill in box A)
- b) films (if ticking yes, fill in box B)

|                          |
|--------------------------|
| <input type="checkbox"/> |
| <input type="checkbox"/> |

- c) indoor sporting events (if ticking yes, fill in box C)
- d) boxing or wrestling entertainment (if ticking yes, fill in box D)
- e) live music (if ticking yes, fill in box E)
- f) recorded music (if ticking yes, fill in box F)
- g) performances of dance (if ticking yes, fill in box G)
- h) anything of a similar description to that falling within (e), (f) or (g)  
(if ticking yes, fill in box H)
- Provision of late night refreshment** (if ticking yes, fill in box I)
- Sale by retail of alcohol** (if ticking yes, fill in box J)

**In all cases complete boxes K, L and M**

**A**

|   |       |        |  |          |                          |
|---|-------|--------|--|----------|--------------------------|
| <b>Plays</b><br>Standard days and timings (please read guidance note 8) |       |        | <b>Will the performance of a play take place indoors or outdoors or both – please tick</b><br>(please read guidance note 4)  | Indoors  | <input type="checkbox"/> |
|   |       |        |  | Outdoors | <input type="checkbox"/> |
|   |       |        |  | Both     | <input type="checkbox"/> |
| Day   | Start | Finish |  |          |                          |
| Mon   |       |        | <b>Please give further details here</b> (please read guidance note 5)  |          |                          |
| Tue   |       |        |  |          |                          |
| Wed   |       |        | <b>State any seasonal variations for performing plays</b> (please read guidance note 6)  |          |                          |
| Thur  |       |        |  |          |                          |
| Fri   |       |        | <b>Non standard timings. Where you intend to use the premises for the performance of plays at different times to those listed in the column on the left, please list</b> (please read guidance note 7) |          |                          |
| Sat   |       |        |  |          |                          |
| Sun   |       |        |  |          |                          |

**B – NO CHANGE**

|   |           |        |  |          |                          |
|---|-----------|--------|--|----------|--------------------------|
| <b>Films</b><br>Standard days and timings (please read guidance note 8) |           |        | <b>Will the exhibition of films take place indoors or outdoors or both – please tick</b><br>(please read guidance note 4)  | Indoors  | <input type="checkbox"/> |
|   |           |        |  | Outdoors | <input type="checkbox"/> |
|   |           |        |  | Both     | <input type="checkbox"/> |
| Day   | Start     | Finish | NO CHANGE  |          |                          |
| Mon   | NO CHANGE |        | <b>Please give further details here</b> (please read guidance note 5)  |          |                          |
| Tue   | NO CHANGE |        |  |          |                          |
| Wed   | NO CHANGE |        | <b>State any seasonal variations for the exhibition of films</b><br>(please read guidance note 6)<br>NO CHANGE   |          |                          |
| Thur  | NO CHANGE |        |  |          |                          |
| Fri   | NO CHANGE |        | <b>Non standard timings. Where you intend to use the premises for the exhibition of films at different times to those listed in the column on the left, please list</b> (please read guidance note 7)<br>NO CHANGE |          |                          |
| Sat   | NO CHANGE |        |  |          |                          |
| Sun   | NO CHANGE |        |  |          |                          |

### C – NO CHANGE

|  |           |        |  |  |
|--|-----------|--------|--|--|
| <b>Indoor sporting events</b><br>Standard days and timings (please read guidance note 8) |           |        | <b>Please give further details</b> (please read guidance note 5)   |  |
|  |           |        | NO CHANGE  |  |
| Day  | Start     | Finish |  |  |
| Mon  | NO CHANGE |        |  |  |
|  |           |        |  |  |
| Tue  | NO CHANGE |        | <b>State any seasonal variations for indoor sporting events</b> (please read guidance note 6)  |  |
|  |           |        |  |  |
| Wed  | NO CHANGE |        | NO CHANGE  |  |
|  |           |        |  |  |
| Thur   | NO CHANGE |        | <b>Non standard timings. Where you intend to use the premises for indoor sporting events at different times to those listed in the column on the left, please list</b> (please read guidance note 7) |  |
|  |           |        |  |  |
| Fri  | NO CHANGE |        |  |  |
|  |           |        |  |  |
| Sat  | NO CHANGE |        | NO CHANGE  |  |
|  |           |        |  |  |
| Sun  | NO CHANGE |        |  |  |
|  |           |        |  |  |

### D

|  |       |        |   |  |          |                                     |
|--|-------|--------|---|--|----------|-------------------------------------|
| <b>Boxing or wrestling entertainments</b><br>Standard days and timings (please read guidance note 8) |       |        | <b>Will the boxing or wrestling entertainment take place indoors or outdoors or both – please tick</b> (please read guidance note 4)  |  | Indoors  | <input checked="" type="checkbox"/> |
|  |       |        |   |  | Outdoors | <input type="checkbox"/>            |
|  |       |        |   |  | Both     | <input type="checkbox"/>            |
| Day  | Start | Finish |   |  |          |                                     |
| Mon  |       |        | <b>Please give further details here</b> (please read guidance note 5)   |  |          |                                     |
|  |       |        |   |  |          |                                     |
| Tue  |       |        |   |  |          |                                     |
|  |       |        |   |  |          |                                     |
| Wed  |       |        | <b>State any seasonal variations for boxing or wrestling entertainment</b> (please read guidance note 6)  |  |          |                                     |
|  |       |        |   |  |          |                                     |
| Thur   |       |        |   |  |          |                                     |
|  |       |        |   |  |          |                                     |
| Fri  |       |        | <b>Non standard timings. Where you intend to use the premises for boxing or wrestling entertainment at different times to those listed in the column on the left, please list</b> (please read guidance note 7) |  |          |                                     |
|  |       |        |   |  |          |                                     |
| Sat  |       |        |   |  |          |                                     |
|  |       |        |   |  |          |                                     |
| Sun  |       |        |   |  |          |                                     |
|  |       |        |   |  |          |                                     |

**E**

|  |       |        |   |          |                                     |
|--|-------|--------|---|----------|-------------------------------------|
| <b>Live music</b><br>Standard days and timings (please read guidance note 8) |       |        | <b>Will the performance of live music take place indoors or outdoors or both – please tick</b> (please read guidance note 4)  | Indoors  | <input checked="" type="checkbox"/> |
|  |       |        |   | Outdoors | <input type="checkbox"/>            |
|  |       |        |   | Both     | <input type="checkbox"/>            |
| Day  | Start | Finish |   |          |                                     |
| Mon  |       |        | <b>Please give further details here</b> (please read guidance note 5)   |          |                                     |
| Tue  |       |        |   |          |                                     |
| Wed  |       |        | <b>State any seasonal variations for the performance of live music</b> (please read guidance note 6)  |          |                                     |
| Thur   |       |        |   |          |                                     |
| Fri  |       |        | <b>Non standard timings. Where you intend to use the premises for the performance of live music at different times to those listed in the column on the left, please list</b> (please read guidance note 7) |          |                                     |
| Sat  |       |        |   |          |                                     |
| Sun  |       |        |   |          |                                     |

**F NO CHANGE**

|  |           |        |   |          |                          |
|--|-----------|--------|---|----------|--------------------------|
| <b>Recorded music</b><br>Standard days and timings (please read guidance note 8) |           |        | <b>Will the playing of recorded music take place indoors or outdoors or both – please tick</b> (please read guidance note 4)  | Indoors  | <input type="checkbox"/> |
|  |           |        |   | Outdoors | <input type="checkbox"/> |
|  |           |        |   | Both     | <input type="checkbox"/> |
| Day  | Start     | Finish | NO CHANGE   |          |                          |
| Mon  | NO CHANGE |        | <b>Please give further details here</b> (please read guidance note 5)   |          |                          |
| Tue  | NO CHANGE |        |   |          |                          |
| Wed  | NO CHANGE |        | <b>State any seasonal variations for the playing of recorded music</b> (please read guidance note 6)  |          |                          |
| Thur   | NO CHANGE |        |   |          |                          |
| Fri  | NO CHANGE |        | <b>Non standard timings. Where you intend to use the premises for the playing of recorded music at different times to those listed in the column on the left, please list</b> (please read guidance note 7) |          |                          |
| Sat  | NO CHANGE |        |   |          |                          |
| Sun  | NO CHANGE |        |   |          |                          |

## G – NO CHANGE

|   |           |        |   |  |          |                          |
|---|-----------|--------|---|--|----------|--------------------------|
| <b>Performances of dance</b><br>Standard days and timings (please read guidance note 8) |           |        | <b><u>Will the performance of dance take place indoors or outdoors or both – please tick</u></b><br>(please read guidance note 4)   |  | Indoors  | <input type="checkbox"/> |
|   |           |        | NO CHANGE   |  | Outdoors | <input type="checkbox"/> |
| Day   | Start     | Finish |   |  | Both     | <input type="checkbox"/> |
| Mon   | NO CHANGE |        | <b><u>Please give further details here</u></b> (please read guidance note 5)  |  |          |                          |
|   |           |        | NO CHANGE   |  |          |                          |
| Tue   | NO CHANGE |        |   |  |          |                          |
|   |           |        |   |  |          |                          |
| Wed   | NO CHANGE |        | <b><u>State any seasonal variations for the performance of dance</u></b><br>(please read guidance note 6)   |  |          |                          |
|   |           |        | NO CHANGE   |  |          |                          |
| Thur  | NO CHANGE |        |   |  |          |                          |
|   |           |        |   |  |          |                          |
| Fri   | NO CHANGE |        | <b><u>Non standard timings. Where you intend to use the premises for the performance of dance at different times to those listed in the column on the left, please list</u></b> (please read guidance note 7) |  |          |                          |
| Sat   | NO CHANGE |        |   |  |          |                          |
|   |           |        |   |  |          |                          |
| Sun   | NO CHANGE |        | NO CHANGE   |  |          |                          |
|   |           |        |   |  |          |                          |

## H – NO CHANGE

|  |           |        |  |  |          |                          |
|--|-----------|--------|--|--|----------|--------------------------|
| <b>Anything of a similar description to that falling within (e), (f) or (g)</b><br>Standard days and timings (please read guidance note 8) |           |        | <b><u>Please give a description of the type of entertainment you will be providing</u></b>   |  |          |                          |
|  |           |        | NO CHANGE  |  |          |                          |
| Day  | Start     | Finish | <b><u>Will this entertainment take place indoors or outdoors or both – please tick</u></b> (please read guidance note 4)   |  | Indoors  | <input type="checkbox"/> |
| Mon  | NO CHANGE |        |  |  | Outdoors | <input type="checkbox"/> |
|  |           |        | NO CHANGE  |  | Both     | <input type="checkbox"/> |
| Tue  | NO CHANGE |        | <b><u>Please give further details here</u></b> (please read guidance note 5)   |  |          |                          |
|  |           |        | NO CHANGE  |  |          |                          |
| Wed  | NO CHANGE |        |  |  |          |                          |
|  |           |        |  |  |          |                          |
| Thur   | NO CHANGE |        | <b><u>State any seasonal variations for entertainment of a similar description to that falling within (e), (f) or (g)</u></b> (please read guidance note 6)  |  |          |                          |
|  |           |        | NO CHANGE  |  |          |                          |
| Fri  | NO CHANGE |        |  |  |          |                          |
|  |           |        |  |  |          |                          |
| Sat  | NO CHANGE |        | <b><u>Non standard timings. Where you intend to use the premises for the entertainment of a similar description to that falling within (e), (f) or (g) at different times to those listed in the column on the left, please list</u></b> (please read guidance note 7) |  |          |                          |
| Sun  | NO CHANGE |        |  |  |          |                          |
|  |           |        | NO CHANGE  |  |          |                          |

## I – NO CHANGE

|  |           |        |  |  |                          |
|--|-----------|--------|--|--|--------------------------|
| <b>Late night refreshment</b><br>Standard days and timings (please read guidance note 8) |           |        | <b>Will the provision of late night refreshment take place indoors or outdoors or both – please tick</b> (please read guidance note 4) | Indoors  | <input type="checkbox"/> |
|  |           |        |  | Outdoors   | <input type="checkbox"/> |
| Day  | Start     | Finish | NO CHANGE  | Both   | <input type="checkbox"/> |
| Mon  | NO CHANGE |        | NO CHANGE  | <b>Please give further details here</b> (please read guidance note 5)  |                          |
| Tue  | NO CHANGE |        |  |  |                          |
| Wed  | NO CHANGE |        | NO CHANGE  | <b>State any seasonal variations for the provision of late night refreshment</b> (please read guidance note 6)   |                          |
| Thur   | NO CHANGE |        |  |  |                          |
| Fri  | NO CHANGE |        | NO CHANGE  | <b>Non standard timings. Where you intend to use the premises for the provision of late night refreshment at different times, to those listed in the column on the left, please list</b> (please read guidance note 7) |                          |
| Sat  | NO CHANGE |        |  |  |                          |
| Sun  | NO CHANGE |        |  |  |                          |

## J – NO CHANGE

|   |           |        |  |   |                          |
|---|-----------|--------|--|---|--------------------------|
| <b>Supply of alcohol</b><br>Standard days and timings (please read guidance note 8) |           |        | <b>Will the supply of alcohol be for consumption (Please tick box)</b> (please read guidance note 9) | On the premises   | <input type="checkbox"/> |
|   |           |        |  | Off the premises  | <input type="checkbox"/> |
| Day   | Start     | Finish | NO CHANGE  | Both  | <input type="checkbox"/> |
| Mon   | NO CHANGE |        | NO CHANGE  | <b>State any seasonal variations for the supply of alcohol</b> (please read guidance note 6)  |                          |
| Tue   | NO CHANGE |        |  |   |                          |
| Wed   | NO CHANGE |        |  |   |                          |
| Thur  | NO CHANGE |        | NO CHANGE  | <b>Non-standard timings. Where you intend to use the premises for the supply of alcohol at different times to those listed in the column on the left, please list</b> (please read guidance note 7) |                          |
| Fri   | NO CHANGE |        |  |   |                          |
| Sat   | NO CHANGE |        |  |   |                          |
| Sun   | NO CHANGE |        |  |   |                          |

## K

|   |
|---|
| <b>Please highlight any adult entertainment or services, activities, other entertainment or matters ancillary to the use of the premises that may give rise to concern in respect of children</b> (please read guidance note 8) |
| N/A   |



## L – NO CHANGE

|   |           |        |   |
|---|-----------|--------|---|
| <b>Hours premises are open to the public</b><br>Standard days and timings (please read guidance note 8) |           |        | <b>State any seasonal variations</b> (please read guidance note 6)<br><br>NO CHANGE   |
| Day   | Start     | Finish |   |
| Mon   | NO CHANGE |        |   |
| Tue   | NO CHANGE |        |   |
| Wed   | NO CHANGE |        |   |
| Thur  | NO CHANGE |        |   |
| Fri   | NO CHANGE |        |   |
| Sat   | NO CHANGE |        |   |
| Sun   | NO CHANGE |        | <b>Non standard timings. Where you intend the premises to be open to the public at different times from those listed in the column on the left, please list</b> (please read guidance note 7) |
|   |           |        |   |

Please identify those conditions currently imposed on the licence which you believe could be removed as a consequence of the proposed variation you are seeking

None

Please tick yes

- I have enclosed the premises licence
- I have enclosed the relevant part of the premises licence

If you have not ticked one of these boxes please fill in reasons for not including the licence, or part of it, below

Reasons why I have failed to enclose the premises licence or relevant part of premises licence

**M** Describe any additional steps you intend to take to promote the four licensing objectives as a result of the proposed variation:

**a) General – all four licensing objectives (b,c,d,e)** (please read guidance note 11)

We have considered the impact of the proposed alterations and do not feel that there will be any increased risk. No further steps will be necessary to promote the licensing objectives and the existing measures will continue

**b) The prevention of crime and disorder**

See a) above

**c) Public safety**

See a) above

**d) The prevention of public nuisance**

See a) above

**e) The protection of children from harm**

See a) above

**Please tick yes**

- I have made or enclosed payment of the fee or
- I have not made or enclosed payment of the fee because this application has been made in relation to the introduction of the late night levy
- I have sent copies of this application and the plan to responsible authorities and others where applicable
- I understand that I must now advertise my application
- I have enclosed the premises licence or relevant part of it or explanation
- I understand that if I do not comply with the above requirements my application will be rejected

**IT IS AN OFFENCE, UNDER SECTION 158 OF THE LICENSING ACT 2003, TO MAKE A FALSE STATEMENT IN OR IN CONNECTION WITH THIS APPLICATION. THOSE WHO MAKE A FALSE STATEMENT MAY BE LIABLE ON SUMMARY CONVICTION TO A FINE OF ANY AMOUNT.**

**Part 5 – Signatures** (please read guidance note 12)

**Signature of applicant (the current premises licence holder) or applicant’s solicitor or other duly authorised agent** (please read guidance note 13). **If signing on behalf of the applicant please state in what capacity.**

|           |   |
|-----------|---|
| Signature |  |
| Date      | 07/04/2025  |

|          |  |
|----------|--|
| Capacity | Poppleston Allen – Solicitors for & on behalf of the applicant |
|----------|--|

**Where the premises licence is jointly held signature of 2nd applicant (the current premises licence holder) or 2nd applicant's solicitor or other authorised agent (please read guidance note 14). If signing on behalf of the applicant please state in what capacity.**

|           |  |
|-----------|--|
| Signature |  |
| Date      |  |
| Capacity  |  |

|   |            |                  |         |
|---|------------|------------------|---------|
| <b>Contact name (where not previously given) and address for correspondence associated with this application (please read guidance note 15)</b><br>██████████<br>Poppleston Allen Solicitors<br>37 Stoney Street<br>The Lace Market |            |                  |         |
| <b>Post town</b>  | Nottingham | <b>Post code</b> | NG1 1LS |
| <b>Telephone number (if any)</b>  | ██████████ |                  |         |
| <b>If you would prefer us to correspond with you by e-mail your e-mail address (optional)</b><br>██████████   |            |                  |         |

### Notes for Guidance

**This application cannot be used to vary the licence so as to extend the period for which the licence has effect or to vary substantially the premises to which it relates. If you wish to make that type of change to the premises licence you should make a new premises licence application under section 17 of the Licensing Act 2003.**

1. You do not have to pay a fee if the only purpose of the variation for which you are applying is to avoid becoming liable for the late night levy
2. Describe the premises. For example the type of premises, its general situation and layout and any other information which could be relevant to the licensing objectives. Where your application includes off-supplies of alcohol and you intend to provide a place for consumption of these off-supplies you must include a description of where the place will be and its proximity to the premises.
3. In terms of specific regulated entertainments please note that:
  - Plays: no licence is required for performances between 08.00 and 23.00 on any day, provided that the audience does not exceed 500.
  - Films: no licence is required for 'not-for-profit' film exhibition held in community premises between 08.00 and 23.00 on any day provided that the audience does not exceed 500 and the organiser (a) gets consent to the screening from a person who is responsible for the premises; and (b) ensures that each such screening abides by age classification ratings.
  - Indoor sporting events: no licence is required for performances between 08.00 and 23.00 on any day, provided that the audience does not exceed 1000.
  - Boxing or Wrestling Entertainment: no licence is required for a contest, exhibition or display of Greco-Roman wrestling, or freestyle wrestling between 08.00 and 23.00 on any day, provided that the audience does not exceed 1000. Combined fighting sports – defined as a contest, exhibition or display which combines boxing or wrestling with

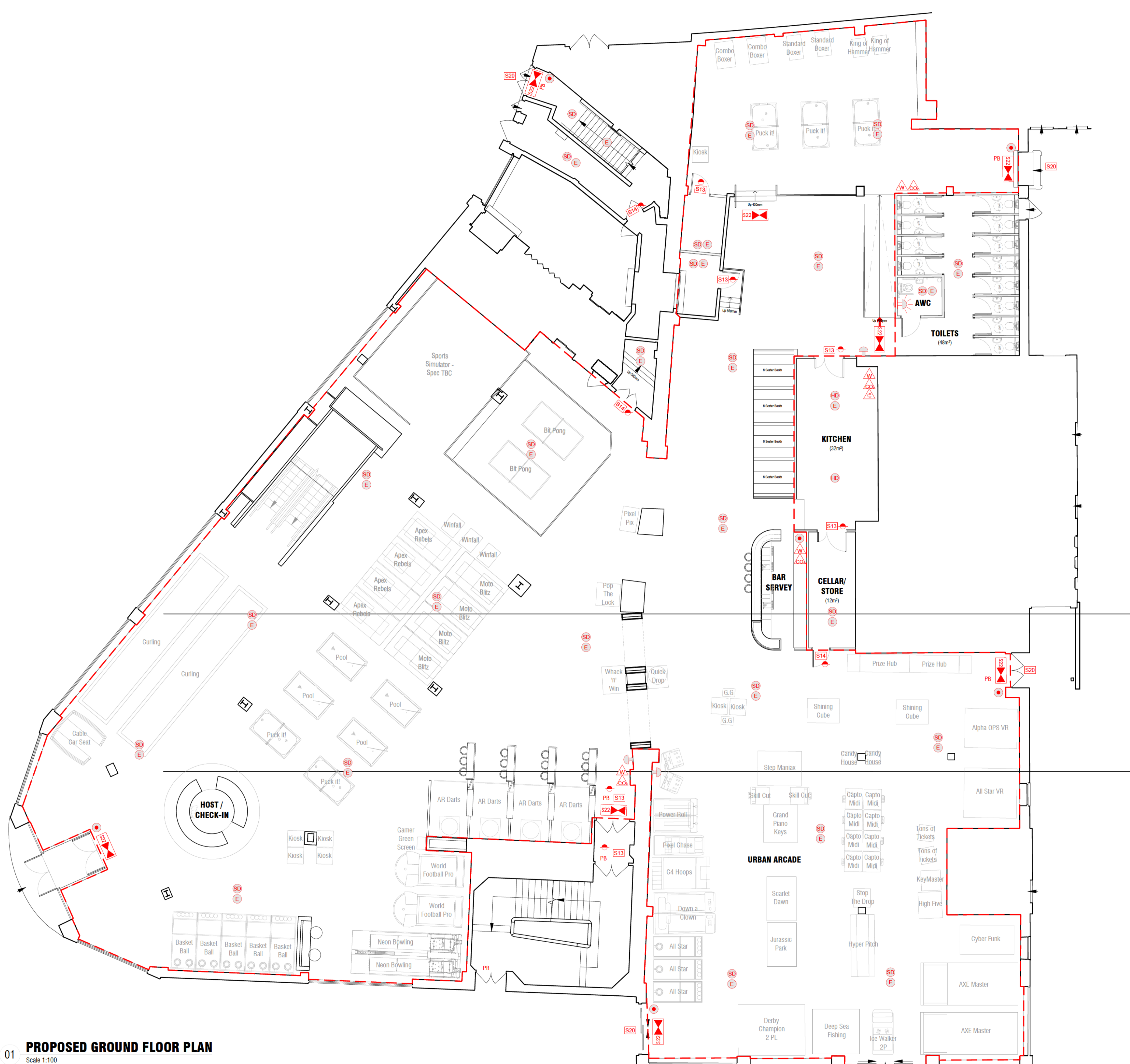

| Fire safety installation legend  |   |
|--|---|
|  | 13A rated water extinguisher  |
|  | 6 litre foam extinguisher   |
|  | 2kg carbon dioxide extinguisher   |
|  | Fire blanket  |
|  | 6 litre Wet Chemical extinguisher   |
|  | All fire extinguishers to have plywood patress built into wall  |
|  | Fire alarm call point (BS 5839)   |
|  | Area covered by smoke detector (BS 5839)  |
|  | Area covered by heat detector (BS 5839)   |
|  | Area covered by void detector (BS 5839)   |
|  | Only required where void exceeds 800mm in height  |
|  | Area covered by emergency luminaire. Certificates of compliance to B.S. 5839 (Fire Alarms) and/or B.S. 5266 (Emergency Lighting) to be provided to the fire Authority. Note: All fittings to be 60mins maintained |
|  | Area covered by alarm sounder (at high level to be agreed on site)  |
|  | Area covered by visual and audible alarm sounder (at high level to be agreed on site)   |
|  | Sign - 'FIRE DOOR KEEP SHUT' - 75mm letters to both sides of door leaf  |
|  | Sign - 'FIRE DOOR KEEP LOCKED' - 75mm letters to both outward face of door leaf   |
|  | Sign - 'FIRE EXIT KEEP CLEAR' - 75mm letters to external face of door leaf  |
|  | Sign - internally illuminated 'FIRE EXIT' or graphic equivalent - 75mm high letters   |
|  | Directional arrow on escape signage   |
|  | Fire alarm panel (location TBC)   |
|  | Non fire rated doors  |
|  | FD30S (fitted with automatic closer)  |
|  | FD60S (fitted with automatic closer)  |
| FR doors to be self-closing doors fitted with combined intumescent strips and smoke seals. Their associated walls and partitioning should be thirty minutes fire resisting and extend from true floor to true ceiling: |   |
|  | VP/SH Vision panel / Spy hole to match FR rating of door  |
|  | Doors which are provided with panic bolts. A notice reading 'Push Bar to Open' to be displayed.   |

Licensed Area  
The area where licensable activities will take place.

Notes: Items shown on this plan which are not part of the statutory requirements are shown for indicative purposes only. This would include loose or fixed furniture in certain circumstances, the position of toilet cubicles, CCTV cameras and fire safety equipment not specified in the regulations. These are shown upon the plans for illustrative purposes only and may be moved at the discretion of the licence holder.

The location and type of any fire safety and any other safety equipment is shown as at present. This may be varied from time to time with the agreement of the Fire Officer or after a fire risk assessment.

GENERAL INFORMATION

| REV | DATE     | NOTE             | BY |
|-----|----------|------------------|----|
| A   | 13.03.25 | Minor amendment. | JT |

|                       |   |
|-----------------------|---|
| <b>STATUS</b>         | <b>PRELIMINARY</b>  |
| <b>CLIENT</b>         | Urban Fun   |
| <b>SITE ADDRESS</b>   | 146 - 152 Clarence St,<br>Kingston upon Thames<br>KT1 1QP |
| <b>TITLE</b>          | Proposed Licensing Plan<br>Ground Floor                   |
| <b>DRAWING NUMBER</b> | 0236 104.2  |
| <b>REVISION</b>       | A   |
| <b>DATE</b>           | MAR 25  |
| <b>DRAWN BY</b>       | JT  |
| <b>SCALE</b>          | 1:100   |
| <b>SIZE</b>           | A1  |

**Barki!**  
design studios

Tel: 01889 554111  
info@barkidesignstudios.co.uk  
www.barkidesignstudios.co.uk

The Old Coal Yard,  
Colton Road, Rugeley,  
WS15 3HF

Drawing issued on condition it is not copied in whole or part without consent. Figured dimensions take precedent over scaled. All dimensions to be checked on site prior to commencement of any work or shop drawings. To be read in conjunction with specification where relevant. All drawings to be read in conjunction with Structural Engineer's details & any relevant sub-contractor's details. All works to comply with current Building Regulations, British Standards & Codes of Practice. Contractor to ensure that all work meets the requirements of the EHO, Building Control, Fire Authority and all other statutory bodies. Any issues regarding the above contact BARK! Design studios Limited at the above contact information and address.

01 **PROPOSED GROUND FLOOR PLAN**  
Scale 1:100

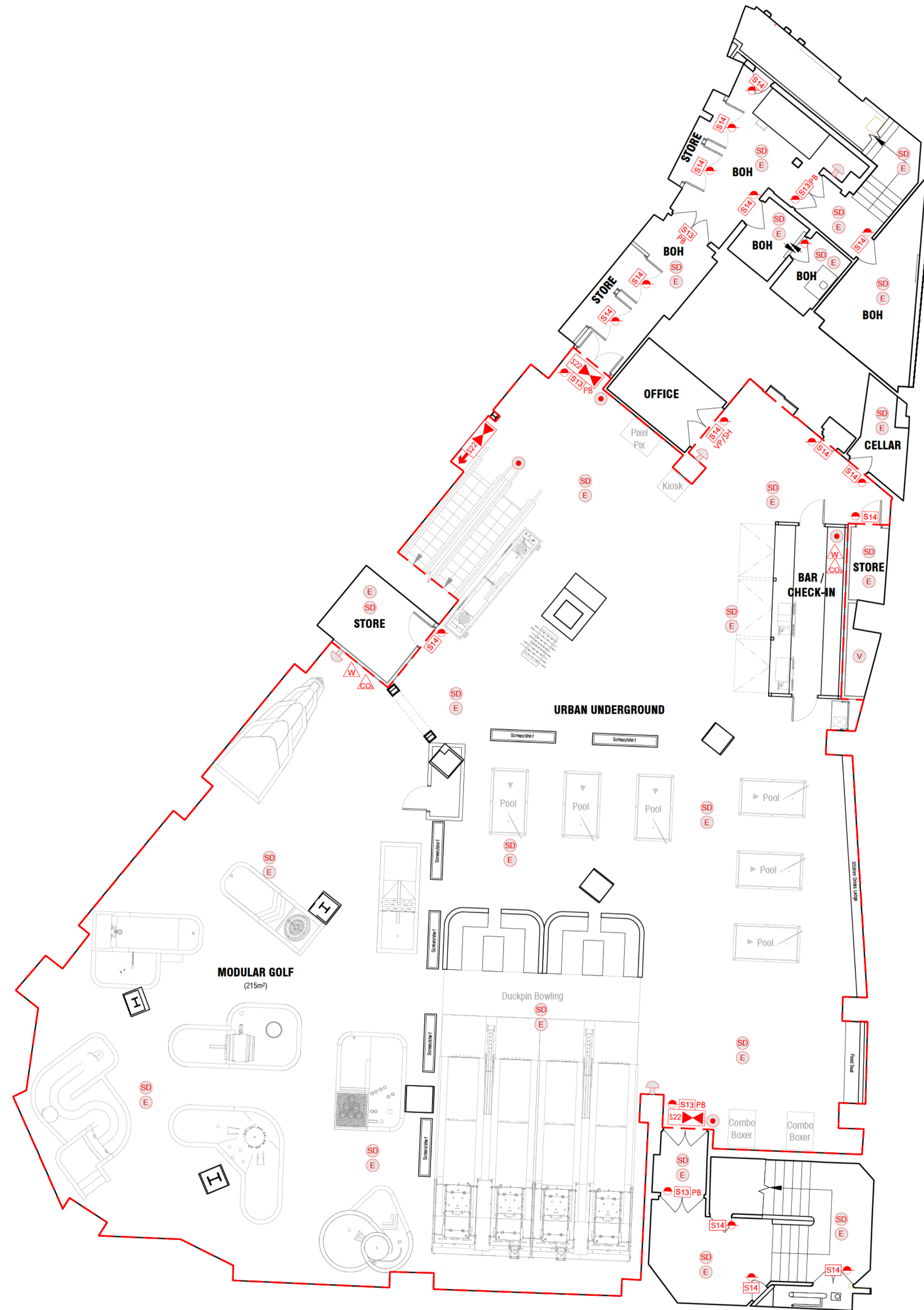

| Fire safety installation legend |  |
|---------------------------------|--|
|                                 | 13A rated water extinguisher   |
|                                 | 6 litre foam extinguisher  |
|                                 | 2kg carbon dioxide extinguisher  |
|                                 | Fire blanket   |
|                                 | 6 litre Wet Chemical extinguisher  |
|                                 | All fire extinguishers to have plywood patress built into wall   |
|                                 | Fire alarm call point (BS 5839)  |
|                                 | Area covered by smoke detector (BS 5839)   |
|                                 | Area covered by heat detector (BS 5839)  |
|                                 | Area covered by void detector (BS 5839)  |
|                                 | Only required where void exceeds 800mm in height   |
|                                 | Area covered by emergency luminaire. Certificates of compliance to B.S. 5839 (Fire Alarms) and/or B.S. 5266 (Emergency Lighting) to be provided to the fire Authority. Note: All fittings to be 60mins maintained      |
|                                 | Area covered by alarm sounder (at high level to be agreed on site)   |
|                                 | Area covered by visual and audible alarm sounder (at high level to be agreed on site)  |
|                                 | Sign - 'FIRE DOOR KEEP SHUT' - 75mm letters to both sides of door leaf   |
|                                 | Sign - 'FIRE DOOR KEEP LOCKED' - 75mm letters to both outward face of door leaf  |
|                                 | Sign - 'FIRE EXIT KEEP CLEAR' - 75mm letters to external face of door leaf   |
|                                 | Sign - internally illuminated 'FIRE EXIT' or graphic equivalent - 75mm high letters  |
|                                 | Directional arrow on escape signage  |
|                                 | Fire alarm panel (location TBC)  |
|                                 | Non fire rated doors   |
|                                 | FD30S (fitted with automatic closer)   |
|                                 | FD60S (fitted with automatic closer)   |
|                                 | FR doors to be self-closing doors fitted with combined intumescent strips and smoke seals. Their associated walls and partitioning should be thirty minutes fire resisting and extend from true floor to true ceiling: |
|                                 | Vision panel / Spy hole to match FR rating of door   |
|                                 | Doors which are provided with panic bolts. A notice reading 'Push Bar to Open' to be displayed.  |

Licensed Area  
 The area where licensable activities will take place.

Notes: Items shown on this plan which are not part of the statutory requirements are shown for indicative purposes only. This would include loose or fixed furniture in certain circumstances, the position of toilet cubicles, CCTV cameras and fire safety equipment not specified in the regulations. These are shown upon the plans for illustrative purposes only and may be moved at the discretion of the licence holder.

The location and type of any fire safety and any other safety equipment is shown as at present. This may be varied from time to time with the agreement of the Fire Officer or after a fire risk assessment.

GENERAL INFORMATION

| REV | DATE | NOTE | BY |
|-----|------|------|----|
|     |      |      |    |



Tel: 01889 504111  
 info@barkdesignstudios.co.uk  
 www.barkdesignstudios.co.uk

The Old Oast Yard,  
 Colton Road, Rugeley,  
 WS15 3HF

**STATUS** PRELIMINARY

**CLIENT** Urban Fun

**SITE ADDRESS**  
 146 - 152 Clarence St,  
 Kingston upon Thames  
 KT1 1QP

**TITLE**  
 Proposed Licensing Plan  
 Basement

**DRAWING NUMBER** 0236  
**REVISION** 104.1

| DATE   | DRAWN BY | SCALE | SIZE |
|--------|----------|-------|------|
| MAR 25 | JT       | 1:100 | A1   |

Drawing issued on condition it is not copied in whole or part without consent. Figured dimensions take precedent over scaled. All dimensions to be checked on site prior to commencement of any work or shop drawings. To be read in conjunction with specification where relevant. All drawings to be read in conjunction with Structural Engineer's details & any relevant sub-contractor's details. All works to comply with current Building Regulations, British Standards & Codes of Practice. Contractor to ensure that all work meets the requirements of the EHO, Building Control, Fire Authority and all other statutory bodies. Any issues regarding the above contact BARK Design studios Limited at the above contact information and address.