



**Kingston upon Thames**  
**Application for a premises licence**  
**Licensing Act 2003**

For help contact  
[licensing@kingston.gov.uk](mailto:licensing@kingston.gov.uk)  
Telephone: 020 8547 5002

\* required information

**Section 1 of 21**

You can save the form at any time and resume it later. You do not need to be logged in when you resume.

System reference  This is the unique reference for this application generated by the system.

Your reference  You can put what you want here to help you track applications if you make lots of them. It is passed to the authority.

Are you an agent acting on behalf of the applicant?

☐ Yes ☒ No

Put "no" if you are applying on your own behalf or on behalf of a business you own or work for.

**Applicant Details**

\* First name

\* Family name

\* E-mail

Main telephone number   
Include country code.

Other telephone number

☐ Indicate here if you would prefer not to be contacted by telephone

Are you:

☒ Applying as a business or organisation, including as a sole trader

☐ Applying as an individual

A sole trader is a business owned by one person without any special legal structure. Applying as an individual means you are applying so you can be employed, or for some other personal reason, such as following a hobby.

**Applicant Business**

Is your business registered in the UK with Companies House? ☒ Yes ☐ No

Note: completing the Applicant Business section is optional in this form.

Registration number

Business name

If your business is registered, use its registered name.

VAT number

Put "none" if you are not registered for VAT.

Legal status

**Continued from previous page...**

Your position in the business

Home country

The country where the headquarters of your business is located.

**Registered Address**

Address registered with Companies House.

Building number or name

Street

District

City or town

County or administrative area

Postcode

Country

**Section 2 of 21**

**PREMISES DETAILS**

I/we, as named in section 1, apply for a premises licence under section 17 of the Licensing Act 2003 for the premises described in section 2 below (the premises) and I/we are making this application to you as the relevant licensing authority in accordance with section 12 of the Licensing Act 2003.

**Premises Address**

Are you able to provide a postal address, OS map reference or description of the premises?

☒ Address    ☐ OS map reference    ☐ Description

**Postal Address Of Premises**

Building number or name

Street

District

City or town

County or administrative area

Postcode

Country

**Further Details**

Telephone number

Non-domestic rateable value of premises (£)

## Section 3 of 21

### APPLICATION DETAILS

In what capacity are you applying for the premises licence?

- ☐ An individual or individuals
- ☒ A limited company / limited liability partnership
- ☐ A partnership (other than limited liability)
- ☐ An unincorporated association
- ☐ Other (for example a statutory corporation)
- ☐ A recognised club
- ☐ A charity
- ☐ The proprietor of an educational establishment
- ☐ A health service body
- ☐ A person who is registered under part 2 of the Care Standards Act 2000 (c14) in respect of an independent hospital in Wales
- ☐ A person who is registered under Chapter 2 of Part 1 of the Health and Social Care Act 2008 in respect of the carrying on of a regulated activity (within the meaning of that Part) in an independent hospital in England
- ☐ The chief officer of police of a police force in England and Wales

### Confirm The Following

- ☒ I am carrying on or proposing to carry on a business which involves the use of the premises for licensable activities
- ☐ I am making the application pursuant to a statutory function
- ☐ I am making the application pursuant to a function discharged by virtue of His Majesty's prerogative

## Section 4 of 21

### NON INDIVIDUAL APPLICANTS

Provide name and registered address of applicant in full. Where appropriate give any registered number. In the case of a partnership or other joint venture (other than a body corporate), give the name and address of each party concerned.

#### Non Individual Applicant's Name

Name

#### Details

Registered number (where applicable)

Description of applicant (for example partnership, company, unincorporated association etc)

*Continued from previous page...*

Private Ltd Company

### Address

Building number or name	<input type="text" value="2"/>
Street	<input type="text" value="Poole Road"/>
District	<input type="text"/>
City or town	<input type="text" value="Bournemouth"/>
County or administrative area	<input type="text" value="Dorset"/>
Postcode	<input type="text" value="BH2 5QY"/>
Country	<input type="text" value="United Kingdom"/>

### Contact Details

E-mail	<input type="text" value="Will.Morris@seventa.co.uk"/>
Telephone number	<input type="text" value=""/>
Other telephone number	<input type="text"/>
* Date of birth	<input type="text" value=""/> dd / <input type="text" value=""/> mm / <input type="text" value=""/> yyyy
* Nationality	<input type="text" value=""/>

[Documents that demonstrate entitlement to work in the UK](#)

Add another applicant

## Section 5 of 21

### OPERATING SCHEDULE

When do you want the premises licence to start?	<input type="text" value="01"/> dd	/	<input type="text" value="11"/> mm	/	<input type="text" value="2025"/> yyyy
---	---------------------------------------	---	---------------------------------------	---	---

If you wish the licence to be valid only for a limited period, when do you want it to end	<input type="text"/> dd	/	<input type="text"/> mm	/	<input type="text"/> yyyy
---	----------------------------	---	----------------------------	---	------------------------------

Provide a general description of the premises

For example the type of premises, its general situation and layout and any other information which could be relevant to the licensing objectives. Where your application includes off-supplies of alcohol and you intend to provide a place for consumption of these off- supplies you must include a description of where the place will be and its proximity to the premises.

Lawns of All Saints Church - Kingston Upon Thames.

License to be used seasonally across Nov,Dec & Jan for the supply of alcohol during a Christmas event located on the lawns of All Saints Church

**Continued from previous page...**

If 5,000 or more people are expected to attend the premises at any one time, state the number expected to attend

## Section 6 of 21

### PROVISION OF PLAYS

[See guidance on regulated entertainment](#)

Will you be providing plays?

☐ Yes ☒ No

## Section 7 of 21

### PROVISION OF FILMS

[See guidance on regulated entertainment](#)

Will you be providing films?

☒ Yes ☐ No

### Standard Days And Timings

#### MONDAY

Start

End

Start

End

Give timings in 24 hour clock.  
(e.g., 16:00) and only give details for the days  
of the week when you intend the premises  
to be used for the activity.

#### TUESDAY

Start

End

Start

End

#### WEDNESDAY

Start

End

Start

End

#### THURSDAY

Start

End

Start

End

#### FRIDAY

Start

End

Start

End

#### SATURDAY

Start

End

Start

End

**Continued from previous page...**

SUNDAY

Start

End

Start

End

Will the exhibition of films take place indoors or outdoors or both?

☐ Indoors ☒ Outdoors ☐ Both

Where taking place in a building or other structure tick as appropriate. Indoors may include a tent.

State type of activity to be authorised, if not already stated, and give relevant further details, for example (but not exclusively) whether or not music will be amplified or unamplified.

State any seasonal variations for the exhibition of film

For example (but not exclusively) where the activity will occur on additional days during the summer months.

If shown, films would be seasonal (ie Christmas films) show on projected screen with music run through standard PA System. All individual licenses for specific films would be obtained ahead of showing.

Non standard timings. Where the premises will be used for the exhibition of film at different times from those listed in the column on the left, list below

For example (but not exclusively), where you wish the activity to go on longer on a particular day e.g. Christmas Eve.

N/A

## Section 8 of 21

### PROVISION OF INDOOR SPORTING EVENTS

[See guidance on regulated entertainment](#)

Will you be providing indoor sporting events?

☐ Yes ☒ No

## Section 9 of 21

### PROVISION OF BOXING OR WRESTLING ENTERTAINMENTS

[See guidance on regulated entertainment](#)

Will you be providing boxing or wrestling entertainments?

☐ Yes ☒ No

## Section 10 of 21

### PROVISION OF LIVE MUSIC

[See guidance on regulated entertainment](#)

Will you be providing live music?

Continued from previous page...

### Standard Days And Timings

#### MONDAY

Start

End

Start

End

Give timings in 24 hour clock.  
(e.g., 16:00) and only give details for the days  
of the week when you intend the premises  
to be used for the activity.

#### TUESDAY

Start

End

Start

End

#### WEDNESDAY

Start

End

Start

End

#### THURSDAY

Start

End

Start

End

#### FRIDAY

Start

End

Start

End

#### SATURDAY

Start

End

Start

End

#### SUNDAY

Start

End

Start

End

Will the performance of live music take place indoors or outdoors or both?

☐ Indoors ☐ Outdoors ☒ Both

Where taking place in a building or other  
structure tick as appropriate. Indoors may  
include a tent.

State type of activity to be authorised, if not already stated, and give relevant further details, for example (but not exclusively) whether or not music will be amplified or unamplified.

Amplified and Non Amplified music for atmospheric setting/background music, predominantly recorded music, acoustic/  
instrumental performance and DJ

State any seasonal variations for the performance of live music

For example (but not exclusively) where the activity will occur on additional days during the summer months.



*Continued from previous page...*

Non-standard timings. Where the premises will be used for the performance of live music at different times from those listed in the column on the left, list below

For example (but not exclusively), where you wish the activity to go on longer on a particular day e.g. Christmas Eve.

## Section 11 of 21

### PROVISION OF RECORDED MUSIC

[See guidance on regulated entertainment](#)

Will you be providing recorded music?

☒ Yes ☐ No

#### Standard Days And Timings

MONDAY

Start

End

Start

End

Give timings in 24 hour clock.  
(e.g., 16:00) and only give details for the days  
of the week when you intend the premises  
to be used for the activity.

TUESDAY

Start

End

Start

End

WEDNESDAY

Start

End

Start

End

THURSDAY

Start

End

Start

End

FRIDAY

Start

End

Start

End

SATURDAY

Start

End

Start

End



**Continued from previous page...**

SUNDAY

Start

End

Start

End

Will the playing of recorded music take place indoors or outdoors or both?

☐ Indoors ☐ Outdoors ☒ Both

Where taking place in a building or other structure tick as appropriate. Indoors may include a tent.

State type of activity to be authorised, if not already stated, and give relevant further details, for example (but not exclusively) whether or not music will be amplified or unamplified.

Playlists for atmospheric/background setting music to be played through PA system.

State any seasonal variations for playing recorded music

For example (but not exclusively) where the activity will occur on additional days during the summer months.

Non-standard timings. Where the premises will be used for the playing of recorded music at different times from those listed in the column on the left, list below

For example (but not exclusively), where you wish the activity to go on longer on a particular day e.g. Christmas Eve.

## Section 12 of 21

### PROVISION OF PERFORMANCES OF DANCE

[See guidance on regulated entertainment](#)

Will you be providing performances of dance?

☐ Yes ☒ No

## Section 13 of 21

### PROVISION OF ANYTHING OF A SIMILAR DESCRIPTION TO LIVE MUSIC, RECORDED MUSIC OR PERFORMANCES OF DANCE

[See guidance on regulated entertainment](#)

Will you be providing anything similar to live music, recorded music or performances of dance?

☐ Yes ☒ No

## Section 14 of 21

### LATE NIGHT REFRESHMENT

Will you be providing late night refreshment?

Continued from previous page...

## Section 15 of 21

### SUPPLY OF ALCOHOL

Will you be selling or supplying alcohol?

☒ Yes ☐ No

#### Standard Days And Timings

MONDAY

Start

End

Start

End

Give timings in 24 hour clock.  
(e.g., 16:00) and only give details for the days  
of the week when you intend the premises  
to be used for the activity.

TUESDAY

Start

End

Start

End

WEDNESDAY

Start

End

Start

End

THURSDAY

Start

End

Start

End

FRIDAY

Start

End

Start

End

SATURDAY

Start

End

Start

End

SUNDAY

Start

End

Start

End

Will the sale of alcohol be for consumption:

☐ On the premises ☐ Off the premises ☒ Both

If the sale of alcohol is for consumption on  
the premises select on, if the sale of alcohol  
is for consumption away from the premises  
select off. If the sale of alcohol is for  
consumption on the premises and away  
from the premises select both.

State any seasonal variations

For example (but not exclusively) where the activity will occur on additional days during the summer months.

**Continued from previous page...**

Non-standard timings. Where the premises will be used for the supply of alcohol at different times from those listed in the column on the left, list below

For example (but not exclusively), where you wish the activity to go on longer on a particular day e.g. Christmas Eve.

State the name and details of the individual whom you wish to specify on the licence as premises supervisor

**Name**

First name	<input type="text" value="William"/>
Family name	<input type="text" value="Morris"/>
Date of birth	<div><input type="text" value=""/> dd</div> / <div><input type="text" value=""/> mm</div> / <div><input type="text" value=""/> yyyy</div>

**Enter the contact's address**

Building number or name	<input type="text" value=""/>
Street	<input type="text" value=""/>
District	<input type="text" value=""/>
City or town	<input type="text" value=""/>
County or administrative area	<input type="text" value=""/>
Postcode	<input type="text" value=""/>
Country	<input type="text" value="United Kingdom"/>
Personal Licence number (if known)	<input type="text" value=""/>
Issuing licensing authority (if known)	<input type="text" value=""/>

**PROPOSED DESIGNATED PREMISES SUPERVISOR CONSENT**

How will the consent form of the proposed designated premises supervisor be supplied to the authority?

- ☐ Electronically, by the proposed designated premises supervisor
- ☒ As an attachment to this application

*Continued from previous page...*

Reference number for consent form (if known)

If the consent form is already submitted, ask the proposed designated premises supervisor for its 'system reference' or 'your reference'.

## Section 16 of 21

### ADULT ENTERTAINMENT

Highlight any adult entertainment or services, activities, or other entertainment or matters ancillary to the use of the premises that may give rise to concern in respect of children

Give information about anything intended to occur at the premises or ancillary to the use of the premises which may give rise to concern in respect of children, regardless of whether you intend children to have access to the premises, for example (but not exclusively) nudity or semi-nudity, films for restricted age groups etc gambling machines etc.

N/A

## Section 17 of 21

### HOURS PREMISES ARE OPEN TO THE PUBLIC

#### Standard Days And Timings

##### MONDAY

Start

End

Start

End

Give timings in 24 hour clock. (e.g., 16:00) and only give details for the days of the week when you intend the premises to be used for the activity.

##### TUESDAY

Start

End

Start

End

##### WEDNESDAY

Start

End

Start

End

##### THURSDAY

Start

End

Start

End

##### FRIDAY

Start

End

Start

End

##### SATURDAY

Start

End

Start

End

*Continued from previous page...*

SUNDAY

Start

End

Start

End

State any seasonal variations

For example (but not exclusively) where the activity will occur on additional days during the summer months.

Non standard timings. Where you intend to use the premises to be open to the members and guests at different times from those listed in the column on the left, list below

For example (but not exclusively), where you wish the activity to go on longer on a particular day e.g. Christmas Eve.

## Section 18 of 21

### LICENSING OBJECTIVES

Describe the steps you intend to take to promote the four licensing objectives:

a) General – all four licensing objectives (b,c,d,e)

List here steps you will take to promote all four licensing objectives together.

A full Alcohol Management Plan will be submitted with this application

b) The prevention of crime and disorder

Seventa Events consider the event and offer to be a low risk to public and guest disorder however a security contractor will provide SIA registered security to support in the management of Apres Kingston, security will be present at all times alcohol is served and their badge number recorded in the logbook when on duty.

Management will not accept prejudiced or aggressive behaviour amongst customers, any reports of such incidents will be fully investigated and the perpetrators, if apprehended, ejected from the area or passed to the police.

If anyone is intoxicated upon ordering they will primarily be refused service. If anyone is deemed intoxicated to the point of a welfare risk, they will be assessed as to their vulnerability and we will establish if they have the means to be able to be transported home via a friend, taxi, etc. If they have no means of being able to be transported home, have a medical need, or become aggressive and cause public disorder then the appropriate emergency service will be called.

All bar refusals and event security incidents will be recorded both by the management team of Apres Kingston on site and also by site Security within their logbook.

An internal and external CCTV system shall be in place to cover the main service points of the bar areas including the external customer ordering points area, allowing for clear facial recognition at point of ordering. The system will be installed



***Continued from previous page...***

and maintained by a selected contractor, and shall continually record during all times of trade. All recordings shall be stored for a minimum of 31 days with correct date and time stamping and be made available immediately upon the request of police or an authorised officer of the council throughout the preceding 31 days period.

**c) Public safety**

Ensuring the safety of our visitors and staff is a top priority. Apres Kingston will comply with all safety regulations. A full event management plan will be created, to include all necessary risk assessments, and all equipment such as fire extinguishers, alarms, and emergency lighting will be in place.

All staff will receive safety training, and evacuation routes will be clearly marked. A fully stocked first aid kit will be kept on-site, and at least one member of staff trained in first aid will be present during operating hours. Emergency contact numbers will be readily available.

Zero glass will be used for this event. Beer and cider will be served in clearly defined paper or rPET pint and half pint cups, spirits will be served in 12oz rPET cups whilst wine will be sold in polycarbonate wine cups. Soft Drinks will be sold in their pre-packaged case or served in rPET cups. All hot drinks will be served in clearly defined double walled paper cups to easily determine whether the contents are alcoholic (eg Mulled Wine) or non alcoholic (eg Coffee/Hot Chocolate).

**d) The prevention of public nuisance**

We are committed to ensuring that Apres Kingston does not create a public nuisance for local residents and businesses. Seventa Events will have a dedicated sound contractor set up the site music system and the volume controls will be managed solely by the operational team and site management. If requested, access to the controls will be made available to Kingston Upon Thames Environmental Health Department for the purposes of sound level measurement.

Clear signage will be placed near exits asking customers to leave quietly and respect the local neighbourhood. Security staff will monitor customers leaving the premises and encourage them to disperse quietly. Apres Kingston staff will follow a waste disposal plan to ensure that all waste is removed regularly and disposed of responsibly, ensuring that any later evening bin movement is minimal and done quietly to avoid disturbance.

**e) The protection of children from harm**

Seventa Events are committed to ensuring that alcohol is not sold to anyone under 18. All customers whom management believe to look under the age of 25 will be asked to prove that they are over 18 by way of acceptable photographic identification, as per the Challenge 25 policy

Challenge 25 posters will be clearly displayed at serving points. Bar staff will be required to check the ID of any customer who appears to be under 25 and will be reminded of this obligation at their daily briefing.

All bar staff will have participated in a training session delivered by a member of the Operations Team, covering Challenge 25, conflict management and intoxicated customers. They will have all signed to confirm they have received training and understood the policy. A log will be kept detailing any customers who are refused service, this will be available throughout the trading period on request of the relevant local authorities.

**Section 19 of 21**

**NOTES ON DEMONSTRATING ENTITLEMENT TO WORK IN THE UK**

*Continued from previous page...*

### **Entitlement to work/immigration status for individual applicants and applications from partnerships which are not limited liability partnerships:**

A licence may not be held by an individual or an individual in a partnership who is resident in the UK who:

- does not have the right to live and work in the UK; or
- is subject to a condition preventing him or her from doing work relating to the carrying on of a licensable activity.

Any premises licence issued in respect of an application made on or after 6 April 2017 will become invalid if the holder ceases to be entitled to work in the UK.

Applicants must demonstrate that they have an entitlement to work in the UK and are not subject to a condition preventing them from doing work relating to the carrying on of a licensable activity. They do this in one of two ways: 1) by providing with this application copies or scanned copies of the documents listed below (which do not need to be certified), or 2) by providing their 'share code' to enable the licensing authority to carry out a check using the Home Office online right to work checking service (see below).

### **Documents which demonstrate entitlement to work in the UK**

- An expired or current passport showing the holder, or a person named in the passport as the child of the holder, is a British citizen or a citizen of the UK and Colonies having the right of abode in the UK [please see note below about which sections of the passport to copy].
- An expired or current passport or national identity card showing the holder, or a person named in the passport as the child of the holder, is a national of a European Economic Area country or Switzerland.
- A Registration Certificate or document certifying permanent residence issued by the Home Office to a national of a European Economic Area country or Switzerland.
- A Permanent Residence Card issued by the Home Office to the family member of a national of a European Economic Area country or Switzerland.
- A **current** Biometric Immigration Document (Biometric Residence Permit) issued by the Home Office to the holder indicating that the person named is allowed to stay indefinitely in the UK, or has no time limit on their stay in the UK.
- A **current** passport endorsed to show that the holder is exempt from immigration control, is allowed to stay indefinitely in the UK, has the right of abode in the UK, or has no time limit on their stay in the UK.
- A **current** Immigration Status Document issued by the Home Office to the holder with an endorsement indicating that the named person is allowed to stay indefinitely in the UK or has no time limit on their stay in the UK, **when produced in combination with** an official document giving the person's permanent National Insurance number and their name issued by a Government agency or a previous employer.
- A birth or adoption certificate issued in the UK, **when produced in combination with** an official document giving the person's permanent National Insurance number and their name issued by a Government agency or a previous employer.
- A birth or adoption certificate issued in the Channel Islands, the Isle of Man or Ireland **when produced in combination with** an official document giving the person's permanent National Insurance number and their name issued by a Government agency or a previous employer.
- A certificate of registration or naturalisation as a British citizen, **when produced in combination with** an official document giving the person's permanent National Insurance number and their name issued by a Government agency or a previous employer.



*Continued from previous page...*

- A **current** passport endorsed to show that the holder is allowed to stay in the UK and is currently allowed to work and is not subject to a condition preventing the holder from doing work relating to the carrying on of a licensable activity.
- A **current** Biometric Immigration Document (Biometric Residence Permit) issued by the Home Office to the holder which indicates that the named person can currently stay in the UK and is allowed to work relation to the carrying on of a licensable activity.
- A **current** Residence Card issued by the Home Office to a person who is not a national of a European Economic Area state or Switzerland but who is a family member of such a national or who has derivative rights or residence.
- A **current** Immigration Status Document containing a photograph issued by the Home Office to the holder with an endorsement indicating that the named person may stay in the UK, and is allowed to work and is not subject to a condition preventing the holder from doing work relating to the carrying on of a licensable activity **when produced in combination with** an official document giving the person's permanent National Insurance number and their name issued by a Government agency or a previous employer.
- A Certificate of Application, **less than 6 months old**, issued by the Home Office under regulation 18(3) or 20(2) of the Immigration (European Economic Area) Regulations 2016, to a person who is not a national of a European Economic Area state or Switzerland but who is a family member of such a national or who has derivative rights of residence.
- Reasonable evidence that the person has an outstanding application to vary their permission to be in the UK with the Home Office such as the Home Office acknowledgement letter or proof of postage evidence, or reasonable evidence that the person has an appeal or administrative review pending on an immigration decision, such as an appeal or administrative review reference number.
- Reasonable evidence that a person who is not a national of a European Economic Area state or Switzerland but who is a family member of such a national or who has derivative rights of residence in exercising treaty rights in the UK including:-
  - evidence of the applicant's own identity – such as a passport,
  - evidence of their relationship with the European Economic Area family member – e.g. a marriage certificate, civil partnership certificate or birth certificate, and
  - evidence that the European Economic Area national has a right of permanent residence in the UK or is one of the following if they have been in the UK for more than 3 months:
    - (i) working e.g. employment contract, wage slips, letter from the employer,
    - (ii) self-employed e.g. contracts, invoices, or audited accounts with a bank,
    - (iii) studying e.g. letter from the school, college or university and evidence of sufficient funds; or
    - (iv) self-sufficient e.g. bank statements.

Family members of European Economic Area nationals who are studying or financially independent must also provide evidence that the European Economic Area national and any family members hold comprehensive sickness insurance in the UK. This can include a private medical insurance policy, an EHIC card or an S1, S2 or S3 form.

**Original documents must not be sent to licensing authorities.** If the document copied is a passport, a copy of the following pages should be provided:-

- (i) any page containing the holder's personal details including nationality;
- (ii) any page containing the holder's photograph;
- (iii) any page containing the holder's signature;
- (iv) any page containing the date of expiry; and
- (v) any page containing information indicating the holder has permission to enter or remain in the UK and is permitted to work.

*Continued from previous page...*

If the document is not a passport, a copy of the whole document should be provided.

Your right to work will be checked as part of your licensing application and this could involve us checking your immigration status with the Home Office. We may otherwise share information with the Home Office. Your licence application will not be determined until you have complied with this guidance.

### **Home Office online right to work checking service**

As an alternative to providing a copy of the documents listed above, applicants may demonstrate their right to work by allowing the licensing authority to carry out a check with the Home Office online right to work checking service.

To demonstrate their right to work via the Home Office online right to work checking service, applicants should include in this application their 9-digit share code (provided to them upon accessing the service at <https://www.gov.uk/prove-right-to-work>) which, along with the applicant's date of birth (provided within this application), will allow the licensing authority to carry out the check.

In order to establish the applicant's right to work, the check will need to indicate that the applicant is allowed to work in the United Kingdom and is not subject to a condition preventing them from doing work relating to the carrying on of a licensable activity.

An online check will not be possible in all circumstances because not all applicants will have an immigration status that can be checked online. The Home Office online right to work checking service sets out what information and/or documentation applicants will need in order to access the service. Applicants who are unable to obtain a share code from the service should submit copy documents as set out above.

## **Section 20 of 21**

### **NOTES ON REGULATED ENTERTAINMENT**

*Continued from previous page...*

In terms of specific **regulated entertainments** please note that:

- Plays: no licence is required for performances between 08:00 and 23.00 on any day, provided that the audience does not exceed 500.
- Films: no licence is required for 'not-for-profit' film exhibition held in community premises between 08.00 and 23.00 on any day provided that the audience does not exceed 500 and the organiser (a) gets consent to the screening from a person who is responsible for the premises; and (b) ensures that each such screening abides by age classification ratings.
- Indoor sporting events: no licence is required for performances between 08.00 and 23.00 on any day, provided that the audience does not exceed 1000.
- Boxing or Wrestling Entertainment: no licence is required for a contest, exhibition or display of Greco-Roman wrestling, or freestyle wrestling between 08.00 and 23.00 on any day, provided that the audience does not exceed 1000. Combined fighting sports – defined as a contest, exhibition or display which combines boxing or wrestling with one or more martial arts – are licensable as a boxing or wrestling entertainment rather than an indoor sporting event.
- Live music: no licence permission is required for:
  - o a performance of unamplified live music between 08.00 and 23.00 on any day, on any premises.
  - o a performance of amplified live music between 08.00 and 23.00 on any day on premises authorised to sell alcohol for consumption on those premises, provided that the audience does not exceed 500.
  - o a performance of amplified live music between 08.00 and 23.00 on any day, in a workplace that is not licensed to sell alcohol on those premises, provided that the audience does not exceed 500.
  - o a performance of amplified live music between 08.00 and 23.00 on any day, in a church hall, village hall, community hall, or other similar community premises, that is not licensed by a premises licence to sell alcohol, provided that (a) the audience does not exceed 500, and (b) the organiser gets consent for the performance from a person who is responsible for the premises.
  - o a performance of amplified live music between 08.00 and 23.00 on any day, at the non-residential premises of (i) a local authority, or (ii) a school, or (iii) a hospital, provided that (a) the audience does not exceed 500, and (b) the organiser gets consent for the performance on the relevant premises from: (i) the local authority concerned, or (ii) the school or (iii) the health care provider for the hospital.
- Recorded Music: no licence permission is required for:
  - o any playing of recorded music between 08.00 and 23.00 on any day on premises authorised to sell alcohol for consumption on those premises, provided that the audience does not exceed 500.
  - o any playing of recorded music between 08.00 and 23.00 on any day, in a church hall, village hall, community hall, or other similar community premises, that is not licensed by a premises licence to sell alcohol, provided that (a) the audience does not exceed 500, and (b) the organiser gets consent for the performance from a person who is responsible for the premises.
  - o any playing of recorded music between 08.00 and 23.00 on any day, at the non-residential premises of (i) a local authority, or (ii) a school, or (iii) a hospital, provided that (a) the audience does not exceed 500, and (b) the organiser gets consent for the performance on the relevant premises from: (i) the local authority concerned, or (ii) the school proprietor or (iii) the health care provider for the hospital.

**Continued from previous page...**

- Dance: no licence is required for performances between 08.00 and 23.00 on any day, provided that the audience does not exceed 500. However, a performance which amounts to adult entertainment remains licensable.
- Cross activity exemptions: no licence is required between 08.00 and 23.00 on any day, with no limit on audience size for:
  - o any entertainment taking place on the premises of the local authority where the entertainment is provided by or on behalf of the local authority;
  - o any entertainment taking place on the hospital premises of the health care provider where the entertainment is provided by or on behalf of the health care provider;
  - o any entertainment taking place on the premises of the school where the entertainment is provided by or on behalf of the school proprietor; and
  - o any entertainment (excluding films and a boxing or wrestling entertainment) taking place at a travelling circus, provided that (a) it takes place within a moveable structure that accommodates the audience, and (b) that the travelling circus has not been located on the same site for more than 28 consecutive days.

**Section 21 of 21**

**PAYMENT DETAILS**

This fee must be paid to the authority. If you complete the application online, you must pay it by debit or credit card.

Premises Licence Fees are determined by the non domestic rateable value of the premises being licensed. To find out the premises non domestic rateable value, use the Valuation Office Agency website at <http://www.voa.gov.uk/rli>. Band A - None to £4,300 – Application Fee £100.00 Band B - £4,301 to £33,000 – Application Fee £190.00 Band C - £33,001 to £87,000 – Application Fee £315.00 Band D - £87,001 to £125,000 – Application Fee £450.00\* Band E - £125,001 and over – Application Fee £635.00\* \*If the premises rateable value is in Bands D or E and the premises is primarily used for the consumption of alcohol on the premises then you are required to pay a higher fee Band D – Higher Application Fee £900.00 and Band E – Higher Application Fee of £1,905.00 There is an exemption from the payment of fees in relation to the provision of regulated entertainment at church halls, chapel halls or premises of a similar nature, village halls, parish or community halls, or other premises of a similar nature. If, however, the licence also authorises the use of the premises for the supply of alcohol or the provision of late night refreshment, a fee will be required. Schools and sixth form colleges are exempt from the fees associated with the authorisation of regulated entertainment where the entertainment is provided by and at the school or college and solely for the purposes of the school or college. If you operate a premises with a capacity greater than 5,000 people you are subject to ADDITIONAL fees based upon the maximum capacity. You will be notified if these charges apply to your application. Details can be found in the following document: [https://www.gov.uk/government/uploads/system/uploads/attachment\\_data/file/98160/other-fees.doc](https://www.gov.uk/government/uploads/system/uploads/attachment_data/file/98160/other-fees.doc)

\* Fee amount (£)

100.00

**DECLARATION**

[Applicable to individual applicants only, including those in a partnership which is not a limited liability partnership] I understand I am not entitled to be issued with a licence if I do not have the entitlement to live and work in the UK (or if I am subject to a condition preventing me from doing work relating to the carrying on of a licensable activity) and that my licence will become invalid if I cease to be entitled to live and work in the UK (please read guidance note 15)

The DPS named in this application form is entitled to work in the UK (and is not subject to conditions preventing him or her from doing work relating to a licensable activity) and I have seen a copy of his or her proof of entitlement to work, if appropriate (please see note 15)

☒ Ticking this box indicates you have read and understood the above declaration

This section should be completed by the applicant, unless you answered "Yes" to the question "Are you an agent acting on behalf of the applicant?"

\* Full name

William Morris

\* Capacity

Operations Director

Continued from previous page...

\* Date

/

/

dd

mm

yyyy

Add another signatory

Once you're finished you need to do the following:

1. Save this form to your computer by clicking file/save as...
2. Go back to <https://www.gov.uk/apply-for-a-licence/premises-licence/kingston-upon-thames/apply-1> to upload this file and continue with your application.

Don't forget to make sure you have all your supporting documentation to hand.

**IT IS AN OFFENCE LIABLE TO SUMMARY CONVICTION TO A FINE OF ANY AMOUNT UNDER SECTION 158 OF THE LICENSING ACT 2003, TO MAKE A FALSE STATEMENT IN OR IN CONNECTION WITH THIS APPLICATION**

**IT IS AN OFFENCE UNDER SECTION 24B OF THE IMMIGRATION ACT 1971 FOR A PERSON TO WORK WHEN THEY KNOW, OR HAVE REASONABLE CAUSE TO BELIEVE, THAT THEY ARE DISQUALIFIED FROM DOING SO BY REASON OF THEIR IMMIGRATION STATUS. THOSE WHO EMPLOY AN ADULT WITHOUT LEAVE OR WHO IS SUBJECT TO CONDITIONS AS TO EMPLOYMENT WILL BE LIABLE TO A CIVIL PENALTY UNDER SECTION 15 OF THE IMMIGRATION, ASYLUM AND NATIONALITY ACT 2006 AND PURSUANT TO SECTION 21 OF THE SAME ACT, WILL BE COMMITTING AN OFFENCE WHERE THEY DO SO IN THE KNOWLEDGE, OR WITH REASONABLE CAUSE TO BELIEVE, THAT THE EMPLOYEE IS DISQUALIFIED**

**OFFICE USE ONLY**

Applicant reference number	<input type="text" value="AK2025"/>
Fee paid	<input type="text"/>
Payment provider reference	<input type="text"/>
ELMS Payment Reference	<input type="text"/>
Payment status	<input type="text"/>
Payment authorisation code	<input type="text"/>
Payment authorisation date	<input type="text"/>
Date and time submitted	<input type="text"/>
Approval deadline	<input type="text"/>
Error message	<input type="text"/>
Is Digitally signed	<input type="checkbox"/>

# **Alcohol Management Plan**

## **'Apres Kingston'**

### **All Saints Church, Market Place, Kingston Upon Thames, KT1 1KP**

#### **Introduction & Scope**

As an experienced operator of venues and events held across various town centre locations throughout the UK, Seventa Events fully understands the social responsibilities attached to the service and provision of alcoholic beverages at our events. We support the four licensing objectives:

- Preventing crime and disorder
- Maintaining public safety
- Preventing public nuisance
- Protecting children from harm

The following alcohol management plan aims to ensure that our 'Apres Kingston' event, on the grounds of All Saints Church, Market Place, Kingston Upon Thames, KT1 1KP operates responsibly, safely and within the parameters of the law; while providing an inclusive environment for the controlled consumption of alcohol.

#### **Operational Schedule & Management**

Apres Kingston, including the bar outlets on site, will be managed by Seventa Events under the direction of the Operational Team.

The main individuals are as follows:

- [REDACTED]
- William Morris
- [REDACTED]

Operational hours : 10:00am to 23:00pm

Duration of event/licence : From 1st November - until 6th January in any year

Designated Premises Supervisor : William Morris (Personal Licence [REDACTED])

#### **Bar Management**

A simple drink offering will be created using multiple small bar outlets within the site layout, selling a range of draught Beer and Cider, Spirits, Wine, Soft Drinks and Hot Drinks. Customer seating will be available throughout the site.

Apres Kingston will have a dedicated Operations Manager (Will Morris) and dedicated Bar Manager, alongside a team who are conversant with the requirements and responsibilities for the sale of alcohol.

The Bar Manager will directly instruct, monitor and support the staff in ensuring the requirements of the Licensing Act 2003 are adhered to at all times.

This Alcohol Management Plan demonstrates our commitment to promoting responsible alcohol consumption and upholding the licensing objectives set out by the Licensing Act 2003. We will work closely with the local council, police, and residents to ensure the safe and responsible operation of Apres Kingston. Further information with regards to the individual licensing objectives are set out below.

#### **Protection of children from harm**

Seventa Events are committed to ensuring that alcohol is not sold to anyone under 18. All customers whom management believe to look under the age of 25 will be asked to prove that they are over 18 by way of acceptable photographic identification, as per the Challenge 25 policy

Challenge 25 posters will be clearly displayed at serving points. Bar staff will be required to check the ID of any customer who appears to be under 25 and will be reminded of this obligation at their daily briefing.

All bar staff will have participated in a training session delivered by a member of the Operations Team, covering Challenge 25, conflict management and intoxicated customers. They will have all signed to confirm they have received training and understood the policy. A log will be kept detailing any customers who are refused service, this will be available throughout the trading period on request of the relevant local authorities.

## **Prevention of crime and disorder**

Seventa Events consider the event and offer to be a low risk to public and guest disorder however a security contractor will provide SIA registered security to support in the management of Apres Kingston, security will be present at all times alcohol is served and their badge number recorded in the logbook when on duty.

Management will not accept prejudiced or aggressive behaviour amongst customers, any reports of such incidents will be fully investigated and the perpetrators, if apprehended, ejected from the area or passed to the police.

If anyone is intoxicated upon ordering they will primarily be refused service. If anyone is deemed intoxicated to the point of a welfare risk, they will be assessed as to their vulnerability and we will establish if they have the means to be able to be transported home via a friend, taxi, etc. If they have no means of being able to be transported home, have a medical need, or become aggressive and cause public disorder then the appropriate emergency service will be called.

All bar refusals and event security incidents will be recorded both by the management team of Apres Kingston on site and also by site Security within their logbook.

An internal and external CCTV system shall be in place to cover the main service points of the bar areas including the external customer ordering points area, allowing for clear facial recognition at point of ordering. The system will be installed and maintained by a selected contractor, and shall continually record during all times of trade. All recordings shall be stored for a minimum of 31 days with correct date and time stamping and be made available immediately upon the request of police or an authorised officer of the council throughout the preceding 31 days period.

## **Public Safety**

Ensuring the safety of our visitors and staff is a top priority. Apres Kingston will comply with all safety regulations. A full event management plan will be created, to include all necessary risk assessments, and all equipment such as fire extinguishers, alarms, and emergency lighting will be in place.

All staff will receive safety training, and evacuation routes will be clearly marked. A fully stocked first aid kit will be kept on-site, and at least one member of staff trained in first aid will be present during operating hours. Emergency contact numbers will be readily available.

Zero glass will be used for this event. Beer and cider will be served in clearly defined paper or rPET pint and half pint cups, spirits will be served in 12oz rPET cups whilst wine will be sold in polycarbonate wine cups. Soft Drinks will be sold in their pre-packaged case or served in rPET cups. All hot drinks will be served in clearly defined double walled paper cups to easily determine whether the contents are alcoholic (eg Mulled Wine) or non alcoholic (eg Coffee/Hot Chocolate).

## **Prevention of Public Nuisance**

We are committed to ensuring that Apres Kingston does not create a public nuisance for local residents and businesses. Seventea Events will have a dedicated sound contractor set up the site music system and the volume controls will be managed solely by the operational team and site management. If requested, access to the controls will be made available to Kingston Upon Thames Environmental Health Department for the purposes of sound level measurement.

Clear signage will be placed near exits asking customers to leave quietly and respect the local neighbourhood. Security staff will monitor customers leaving the premises and encourage them to disperse quietly. Apres Kingston staff will follow a waste disposal plan to ensure that all waste is removed regularly and disposed of responsibly, ensuring that any later evening bin movement is minimal and done quietly to avoid disturbance.



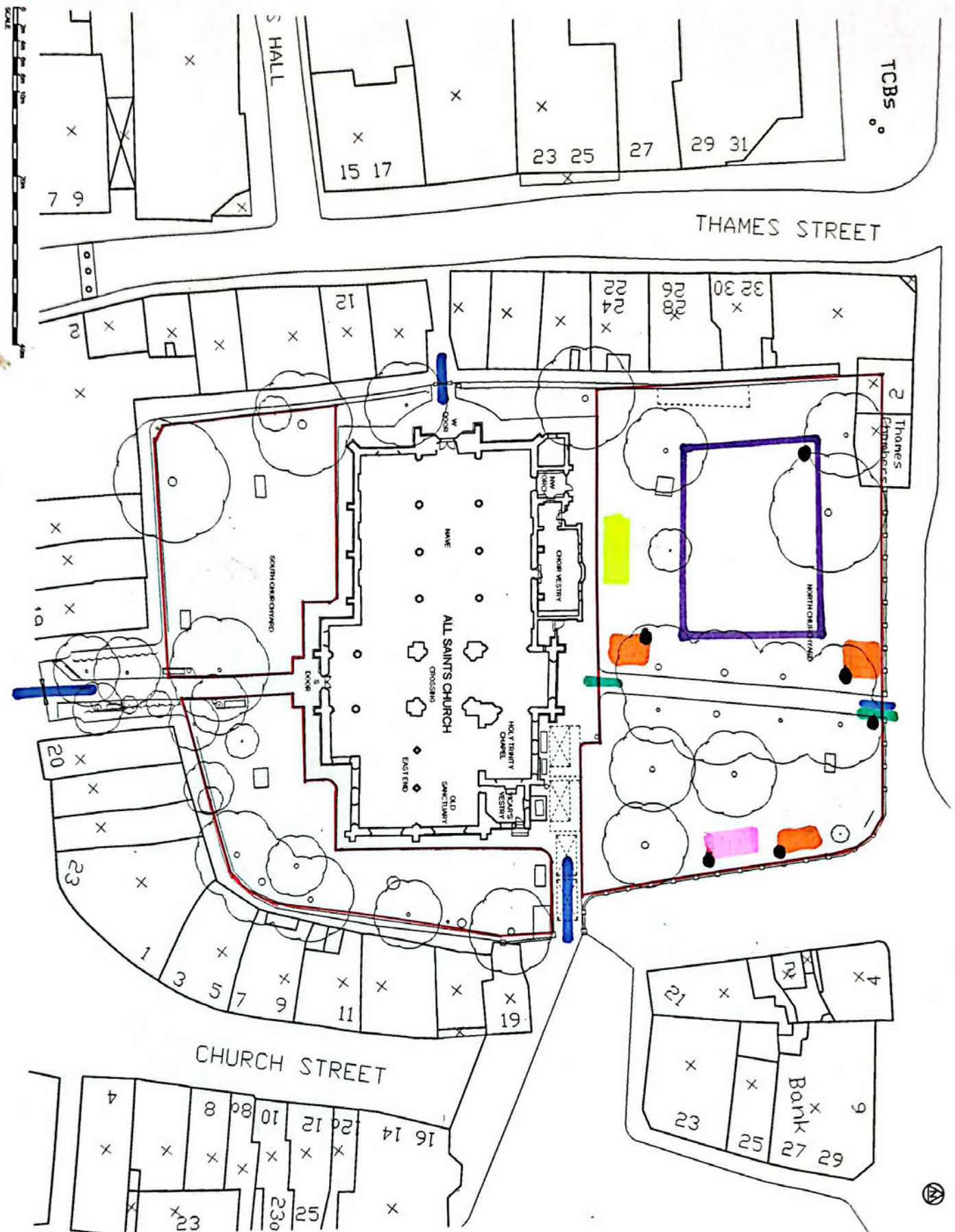

**FOR PLANNING**

ALL SAINTS CHURCH  
 100, 101, 102, 103, 104, 105, 106, 107, 108, 109, 110, 111, 112, 113, 114, 115, 116, 117, 118, 119, 120, 121, 122, 123, 124, 125, 126, 127, 128, 129, 130, 131, 132, 133, 134, 135, 136, 137, 138, 139, 140, 141, 142, 143, 144, 145, 146, 147, 148, 149, 150, 151, 152, 153, 154, 155, 156, 157, 158, 159, 160, 161, 162, 163, 164, 165, 166, 167, 168, 169, 170, 171, 172, 173, 174, 175, 176, 177, 178, 179, 180, 181, 182, 183, 184, 185, 186, 187, 188, 189, 190, 191, 192, 193, 194, 195, 196, 197, 198, 199, 200, 201, 202, 203, 204, 205, 206, 207, 208, 209, 210, 211, 212, 213, 214, 215, 216, 217, 218, 219, 220, 221, 222, 223, 224, 225, 226, 227, 228, 229, 230, 231, 232, 233, 234, 235, 236, 237, 238, 239, 240, 241, 242, 243, 244, 245, 246, 247, 248, 249, 250, 251, 252, 253, 254, 255, 256, 257, 258, 259, 260, 261, 262, 263, 264, 265, 266, 267, 268, 269, 270, 271, 272, 273, 274, 275, 276, 277, 278, 279, 280, 281, 282, 283, 284, 285, 286, 287, 288, 289, 290, 291, 292, 293, 294, 295, 296, 297, 298, 299, 300, 301, 302, 303, 304, 305, 306, 307, 308, 309, 310, 311, 312, 313, 314, 315, 316, 317, 318, 319, 320, 321, 322, 323, 324, 325, 326, 327, 328, 329, 330, 331, 332, 333, 334, 335, 336, 337, 338, 339, 340, 341, 342, 343, 344, 345, 346, 347, 348, 349, 350, 351, 352, 353, 354, 355, 356, 357, 358, 359, 360, 361, 362, 363, 364, 365, 366, 367, 368, 369, 370, 371, 372, 373, 374, 375, 376, 377, 378, 379, 380, 381, 382, 383, 384, 385, 386, 387, 388, 389, 390, 391, 392, 393, 394, 395, 396, 397, 398, 399, 400, 401, 402, 403, 404, 405, 406, 407, 408, 409, 410, 411, 412, 413, 414, 415, 416, 417, 418, 419, 420, 421, 422, 423, 424, 425, 426, 427, 428, 429, 430, 431, 432, 433, 434, 435, 436, 437, 438, 439, 440, 441, 442, 443, 444, 445, 446, 447, 448, 449, 450, 451, 452, 453, 454, 455, 456, 457, 458, 459, 460, 461, 462, 463, 464, 465, 466, 467, 468, 469, 470, 471, 472, 473, 474, 475, 476, 477, 478, 479, 480, 481, 482, 483, 484, 485, 486, 487, 488, 489, 490, 491, 492, 493, 494, 495, 496, 497, 498, 499, 500, 501, 502, 503, 504, 505, 506, 507, 508, 509, 510, 511, 512, 513, 514, 515, 516, 517, 518, 519, 520, 521, 522, 523, 524, 525, 526, 527, 528, 529, 530, 531, 532, 533, 534, 535, 536, 537, 538, 539, 540, 541, 542, 543, 544, 545, 546, 547, 548, 549, 550, 551, 552, 553, 554, 555, 556, 557, 558, 559, 560, 561, 562, 563, 564, 565, 566, 567, 568, 569, 570, 571, 572, 573, 574, 575, 576, 577, 578, 579, 580, 581, 582, 583, 584, 585, 586, 587, 588, 589, 590, 591, 592, 593, 594, 595, 596, 597, 598, 599, 600, 601, 602, 603, 604, 605, 606, 607, 608, 609, 610, 611, 612, 613, 614, 615, 616, 617, 618, 619, 620, 621, 622, 623, 624, 625, 626, 627, 628, 629, 630, 631, 632, 633, 634, 635, 636, 637, 638, 639, 640, 641, 642, 643, 644, 645, 646, 647, 648, 649, 650, 651, 652, 653, 654, 655, 656, 657, 658, 659, 660, 661, 662, 663, 664, 665, 666, 667, 668, 669, 670, 671, 672, 673, 674, 675, 676, 677, 678, 679, 680, 681, 682, 683, 684, 685, 686, 687, 688, 689, 690, 691, 692, 693, 694, 695, 696, 697, 698, 699, 700, 701, 702, 703, 704, 705, 706, 707, 708, 709, 710, 711, 712, 713, 714, 715, 716, 717, 718, 719, 720, 721, 722, 723, 724, 725, 726, 727, 728, 729, 730, 731, 732, 733, 734, 735, 736, 737, 738, 739, 740, 741, 742, 743, 744, 745, 746, 747, 748, 749, 750, 751, 752, 753, 754, 755, 756, 757, 758, 759, 760, 761, 762, 763, 764, 765, 766, 767, 768, 769, 770, 771, 772, 773, 774, 775, 776, 777, 778, 779, 780, 781, 782, 783, 784, 785, 786, 787, 788, 789, 790, 791, 792, 793, 794, 795, 796, 797, 798, 799, 800, 801, 802, 803, 804, 805, 806, 807, 808, 809, 810, 811, 812, 813, 814, 815, 816, 817, 818, 819, 820, 821, 822, 823, 824, 825, 826, 827, 828, 829, 830, 831, 832, 833, 834, 835, 836, 837, 838, 839, 840, 841, 842, 843, 844, 845, 846, 847, 848, 849, 850, 851, 852, 853, 854, 855, 856, 857, 858, 859, 860, 861, 862, 863, 864, 865, 866, 867, 868, 869, 870, 871, 872, 873, 874, 875, 876, 877, 878, 879, 880, 881, 882, 883, 884, 885, 886, 887, 888, 889, 890, 891, 892, 893, 894, 895, 896, 897, 898, 899, 900, 901, 902, 903, 904, 905, 906, 907, 908, 909, 910, 911, 912, 913, 914, 915, 916, 917, 918, 919, 920, 921, 922, 923, 924, 925, 926, 927, 928, 929, 930, 931, 932, 933, 934, 935, 936, 937, 938, 939, 940, 941, 942, 943, 944, 945, 946, 947, 948, 949, 950, 951, 952, 953, 954, 955, 956, 957, 958, 959, 960, 961, 962, 963, 964, 965, 966, 967, 968, 969, 970, 971, 972, 973, 974, 975, 976, 977, 978, 979, 980, 981, 982, 983, 984, 985, 986, 987, 988, 989, 990, 991, 992, 993, 994, 995, 996, 997, 998, 999, 1000

Towers

File Equipment

Bar

Food Units

Cinema Lane  
 Bal and Seats

Access Lane

Land

Boundary

DO NOT SCALE FROM THIS DRAWING  
 ALL DIMENSIONS ARE IN METRES  
 UNLESS OTHERWISE STATED  
 THE DRAWING IS THE PROPERTY OF THE ARCHITECT  
 AND IS NOT TO BE REPRODUCED OR COPIED  
 WITHOUT THE WRITTEN PERMISSION OF THE ARCHITECT  
 THE ARCHITECT ACCEPTS NO LIABILITY FOR  
 THE ACCURACY OF THE INFORMATION PROVIDED  
 OR FOR THE CONSEQUENCES OF ANY ACTION  
 TAKEN OR NOT TAKEN IN RELIANCE ON THIS  
 DRAWING