

ROYAL BOROUGH OF KINGSTON UPON THAMES

EXPERIMENTAL BANNED LEFT TURN – FULLERS WAY NORTH INTO TOLWORTH ROAD (REF. TMO-P324)

THE KINGSTON UPON THAMES (PRESCRIBED ROUTES)
(AMENDMENT NO. 43) EXPERIMENTAL TRAFFIC ORDER 2023

MODIFICATION DOCUMENTS FOR INSPECTION

1. A copy of the notice to appear in the Surrey Comet and the London Gazette on 9th February 2023
2. The Council's statement of reasons for making the Order
3. The made Order
4. A plan to indicate the location and effect of the Order

Available for inspection until further notice

ROYAL BOROUGH OF KINGSTON UPON THAMES

BANNED LEFT TURN – TOLWORTH ROAD EXPERIMENTAL TMO

1. NOTICE IS HEREBY GIVEN that the Council of the Royal Borough of Kingston upon Thames on **6 February 2023** made the following Order **The Kingston upon Thames (Prescribed Routes) (Amendment No. 43) Experimental Order 2023** under section 9 of the Road Traffic Regulation Act 1984, as amended by the Local Government Act 1985:
2. Further to the notice published on 12 January 2023 (which introduced the above titled scheme). The general effect of the Order, which will come into force on **20 February 2023**, will be to, on an experimental basis modify the operating times to include Monday to Friday as follows, prohibit motor vehicles between **8am and 10am** and between **4pm and 6pm Monday to Friday** from turning left onto **Tolworth Road**, Surbiton from its junction with **Fullers Way North**. The prohibition will not apply to pedal cycles.
3. The Order provide that, subject to the provisions of section 10 of the Road Traffic Regulation Act 1984, the Council's Assistant Director - Highways, Transport, and Regulatory Services, or some person authorised on behalf of him or her, may, if it appears to that person essential in the interest of the expeditious, convenient and safe movement of traffic or for providing suitable and adequate parking facilities on the highway or for preserving or improving the amenities of the area through which any road affected by the Order run, modify or suspend the Order or any provision contained therein.
4. Copies of the Experimental Order, of the Council's Statement of Reasons for making the Order and a plan showing the location and the effect of the Order may be inspected as follows:-
 - (a) online at <https://www.kingston.gov.uk/tmos-open-statutory-consultation> selecting reference **P324 Tolworth Road Banned Left Turn - Modification Documents**;
 - (b) The Information and Advice Centre, Guildhall 2, Kingston upon Thames, KT1 1EU between 9am and 5pm Mondays to Fridays inclusive
 - (c) Council libraries; and
 - (d) copies of the made Experimental Order and plan can also be obtained by calling 020 8547 5000 (between 9am and 5pm Mondays to Fridays); or
 - (e) by emailing tmo@kingston.gov.uk (please quote ref **P324 Tolworth Road Banned Left Turn**).
5. Any person desiring to question the validity of the experimental Order or of any provision contained therein on the grounds that it is not within the relevant powers of the Road Traffic Regulation Act 1984 or that any relevant requirements thereof or any relevant regulations made thereunder have not been complied with in relation to the experimental Order may, within six weeks from the date on which the experimental Order was made, make an application for the purpose to the High Court.
6. The Council will consider in due course whether the provision of the experimental Order should be continued in force indefinitely by means of an Order made under sections 6, of the Road Traffic Regulation Act 1984. Any person may object to the making of the experimental Order for the purpose of such indefinite continuation within a period of six months beginning from the date on which the experimental Order came into force, or if the experimental Order is varied or modified, beginning with the date on which such variation or modification came into force. Any objection must be in writing stating the grounds on which it is made and sent to, Traffic Order Section, Guildhall 2, Kingston upon Thames, KT1 1EU or to tmo@kingston.gov.uk (please quote ref. **P324 Tolworth Road Banned Left Turn**).

Dated 9 February 2023.

Jayne Dando
Head of Corporate Service – Highways and Transport

Please Note: Persons responding to the Orders should be aware that the Council may be legally obliged to disclose the information provided to third parties

ROYAL BOROUGH OF KINGSTON UPON THAMES

EXPERIMENTAL BANNED LEFT TURN – FULLERS WAY NORTH INTO TOLWORTH ROAD (REF. TMO-P324)

THE KINGSTON UPON THAMES (PRESCRIBED ROUTES)
(AMENDMENT NO. 43) EXPERIMENTAL TRAFFIC ORDER 2023

MODIFIED DOCUMENTS

STATEMENT OF REASONS

‘Reduce the volume of traffic using Tolworth Road at peak times’

These measures will be subject to an Experimental Traffic Management Order (ETMO). An ETMO is the legal mechanism the council as traffic authority uses to control aspects of the way that the highway is used. They provide the legal backing to signs and road markings used on the highway and allow them to be enforceable. The ETMOs will be enforceable for a period up to 18 months to allow the assessment of any impact the road closure might have on the area and surrounding roads, and to revise the scheme if necessary within that time. A review will be carried out to assess the initial success of the scheme and whether the road closure should be made permanent after 6 months.



TRAFFIC MANAGEMENT ORDER

2023 No. 6

The Kingston upon Thames (Prescribed Routes) (Amendment No. 43) Experimental Order 2023.

Made: 6 February 2023

Coming into force: 20 February 2023

The Council of the Royal Borough of Kingston upon Thames, after consulting the Commissioner of Police of the Metropolis, in exercise of the powers conferred by section 9 of the Road Traffic Regulation Act 1984(a), as amended, and all other enabling powers, hereby makes the following Order:-

1. This Order shall come into force on 20 February 2023 and may be cited as **The Kingston upon Thames (Prescribed Routes) (Amendment No. 43) Experimental Order 2023**.

2. (1) In this Order:

the Order of 2013” means the Kingston upon Thames (Prescribed Routes) (No. 6) Traffic Order 2013(b);

“enactment” means any enactment, whether public general or local, and includes any order, byelaw, rule, regulation, scheme or other instrument having effect by virtue of an enactment; and

(2) Any reference in this Order to any enactment shall be construed as a reference to that enactment as amended, applied, consolidated, re-enacted by or as having effect by virtue of any subsequent enactment.

Amendment of the Order of 2013

3. (1) Without prejudice to the validity of anything done or to any liability incurred in respect of any act or omission before the coming into force of this Order, the Order of 2013 shall have effect as though there were added to Schedule 2 to that Order the item numbered 280 and set out in the Schedule to this Order;

(2) The relevant provisions of the Order of 2013 shall apply to the item set out in the Schedule to this Order.

4. In pursuance of section 10(2) of the Road Traffic Regulation Act 1984, Assistant Director - Highways, Transport, and Regulatory Services of the Royal Borough of Kingston upon Thames, or some person authorised by him or her, may, if it appears essential in the interests of the expeditious, convenient and safe movement of traffic, or of the provision of suitable and adequate parking facilities on the highway, or for improving the amenities of the area through which any road affected by this Order runs, and after consulting the Commissioner of Police of the Metropolis, modify or suspend any provision of this Order.

Dated this sixth day of February 2023.

Jayne Dando
Head of Corporate Service – Highways and Transport
(The officer appointed for this purpose)

SCHEDULE (addition to Schedule 2 to the Order of 2013)

Item No.	Prescribed Street	Instruction	Direction	Location	Exception Reference (see Schedule 3)
(1)	(2)	(3)	(4)	(5)	(6)
281	Fullers Way North	Any person causing any vehicle to proceed in the road or length of road shown in column 2 shall, on reaching the junction with the road shown in column 5, on Monday to Friday between 8am and 10am and between 4pm and 6pm cause that vehicle to turn left.	-	Tolworth Road, Surbiton	Ex1, Ex2, Ex4, or Ex5

EXPLANATORY NOTE

(This Note is not part of the Order, but is intended to indicate its general purport.)

This Order amends The Kingston upon Thames (Prescribed Routes) (No. 6) Traffic Order 2013 and further modifies The Kingston upon Thames (Prescribed Routes) (Amendment No. 42) Experimental Order 2023 to introduce, on an experimental basis, a banned left turn into Tolworth Road, from its junction with Fullers Way North to include Monday to Friday 8am and 10am and 4pm and 6pm

The following exemptions apply to the banned left turn:

anything done with the permission or at the direction of a police constable in uniform (Ex1);
any person who causes any vehicle to proceed in accordance with any restriction or requirement indicated by traffic signs placed pursuant to Section 66 or Section 67 of the Road Traffic Regulation Act 1984 (Ex2);
a pedal cycle (Ex4);
any vehicle when used in an emergency for fire brigade, ambulance or police purposes (Ex5).

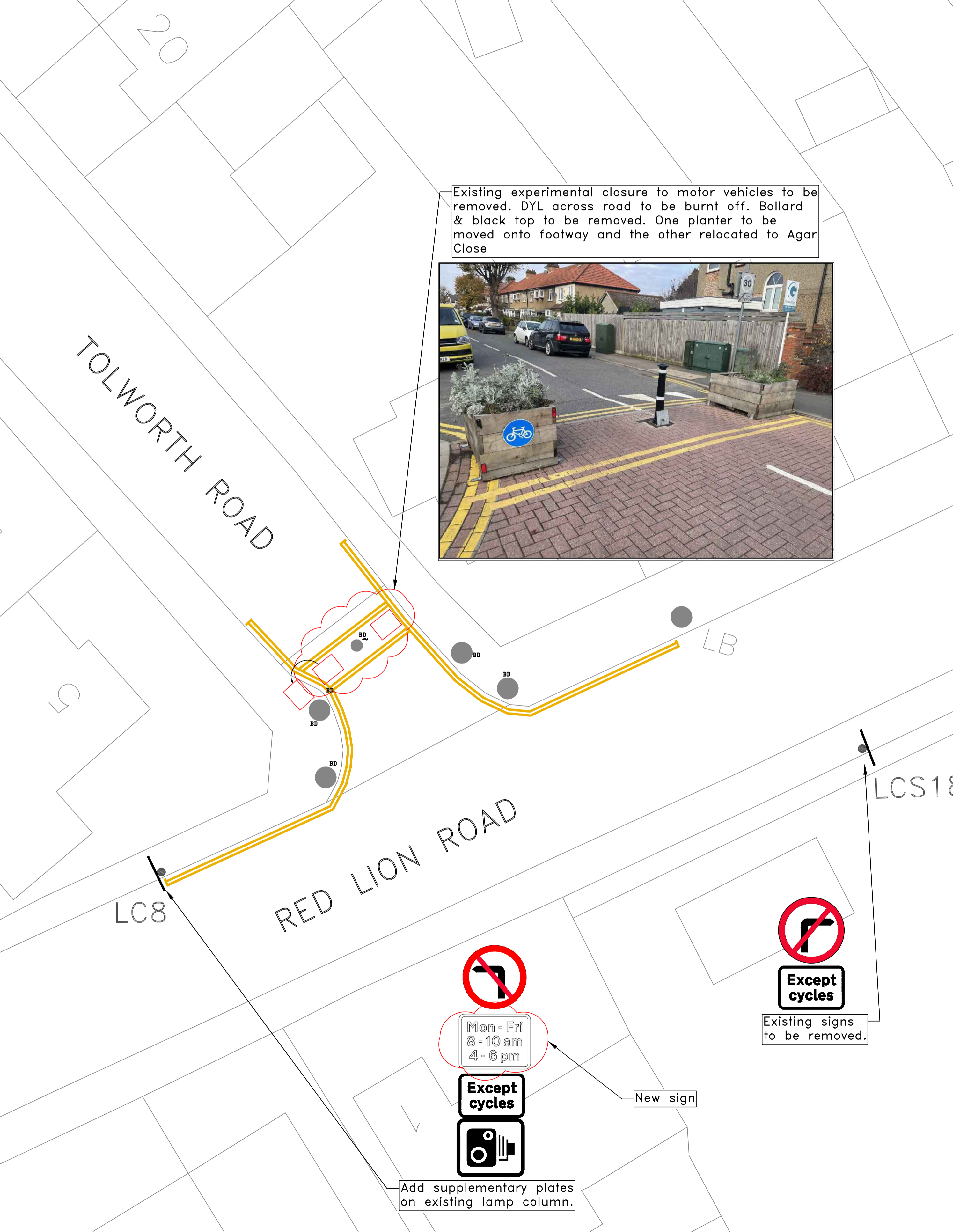

Existing experimental closure to motor vehicles to be removed. DYL across road to be burnt off. Bollard & black top to be removed. One planter to be moved onto footway and the other relocated to Agar Close



Mon - Fri
8 - 10 am
4 - 6 pm

Except
cycles

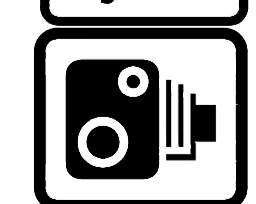

Add supplementary plates on existing lamp column.



Except
cycles

Existing signs to be removed.

New sign

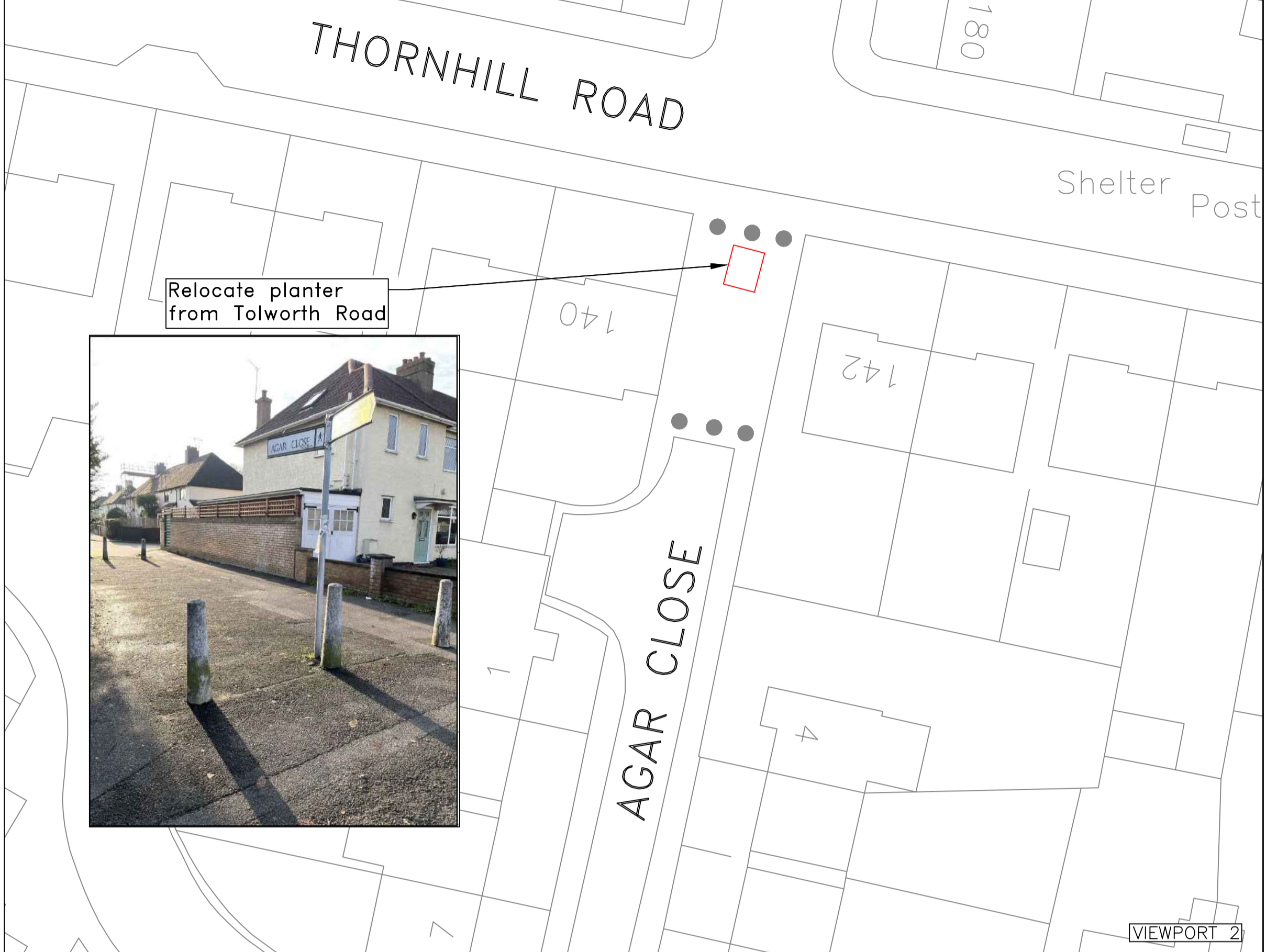
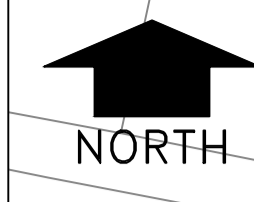

Relocate planter from Tolworth Road

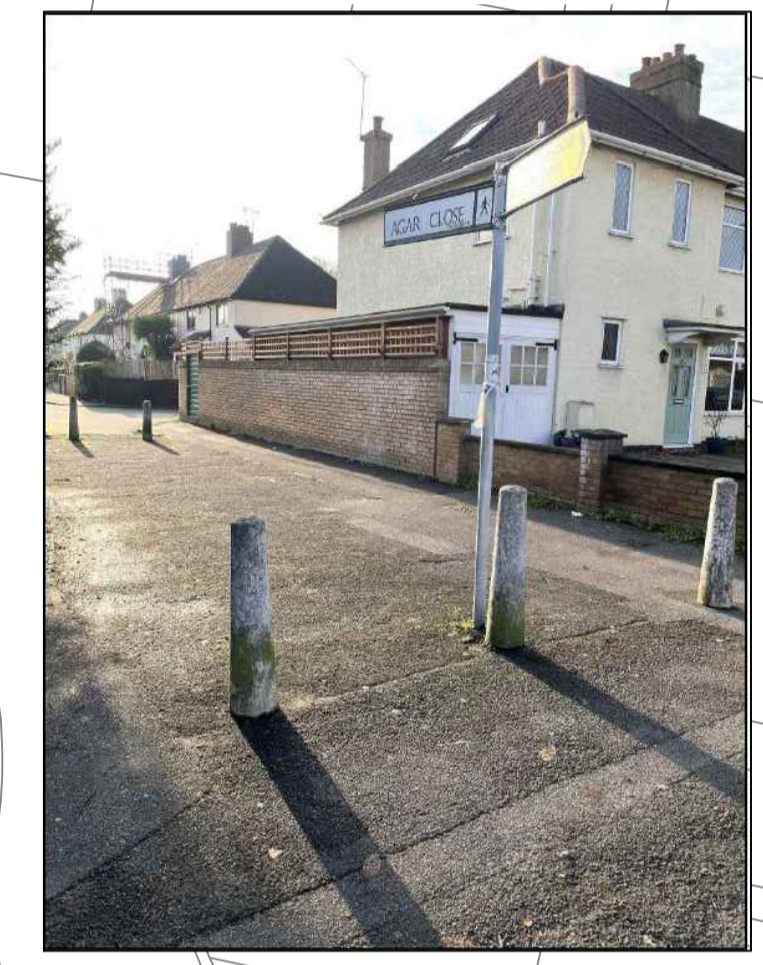

Remove to tip off site existing signs and post

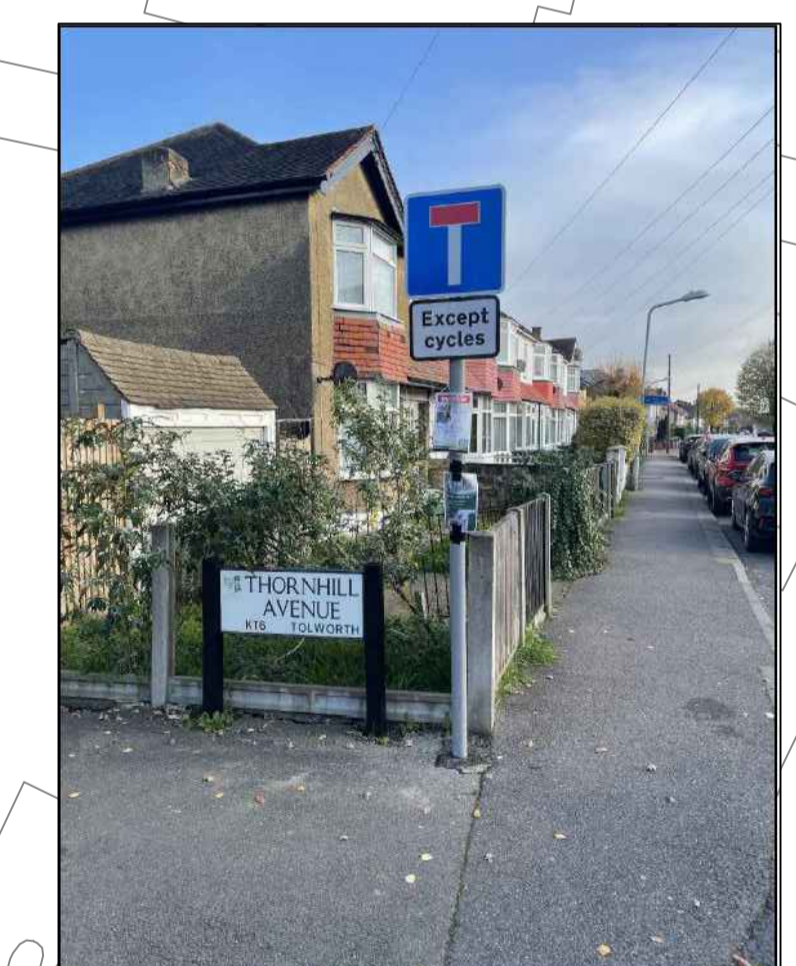

- NOTES:
- All dimensions and levels are in metres unless stated otherwise.
 - The contractor is liable to maintain the minimum and safe access width for pedestrians on all footpaths and walkways (1.2m).
 - The Contractor shall be responsible for ensuring that all traffic management during construction is agreed the Highway Authority prior to works commencing on site.
 - The Contractor is to make whatever inquiries of the respective Statutory Authorities he considers necessary to satisfy himself and to avoid disturbing any Statutory services.
 - All areas affected by the works shall be maintained and made good to replace or improve the existing surface as required by the Engineer on site.

- KEY :
- LC† Proposed sign on existing lighting column
 - BD Existing bollard
 - BD Existing bollard to be removed
 - Existing road markings

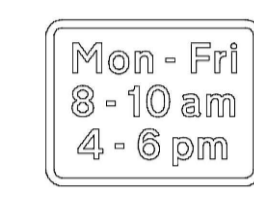

Scheme Ref.	Tolworth Road	x-height	50.0
Sign Ref.	Sign1	SIGN FACE	
Letter colour	BLACK	Width	465 mm
Background	WHITE	Height	330 mm
Border	BLACK	Area	0.16 m ²
Material	Class R38-UK		

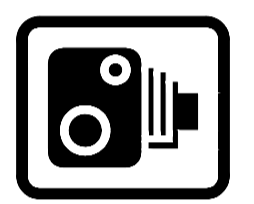

Scheme Ref.		x-height	100.0
Sign Ref.	879	SIGN FACE	
Letter colour	N/A	Width	700 mm
Background	WHITE	Height	600 mm
Border	BLACK	Area	0.42 m ²
Material	Class R38-UK		

C	Time sign plate changed	01/23	MM
B	Remaining planter moved	12/22	MM
A	Accept for access plate removed	12/22	MM
No.	Amendment	Date	Int'l



KINGSTON AND SUTTON
SHARED ENVIRONMENT SERVICE
Scheme

TOLWORTH ROAD

Drawing Title
**TOLWORTH ROAD
EXISTING EXPERIMENTAL CLOSURE**

MATTHEW HILL
ASSISTANT DIRECTOR TRANSPORTATION,
HIGHWAYS AND REGULATORY SERVICES
KINGSTON AND SUTTON
ROYAL BOROUGH OF KINGSTON UPON THAMES
GUILDHALL 2, HIGH STREET
KINGSTON UPON THAMES KT1 1EU

Date	DEC 2022	Designed	MM
Scale	N.T.S	Drawn	MM
CAD No.	137221C	Chk'd	MG
		App'd	YH

DRG.NO. DD/1372/21C