

NSL CONTOURS



PROJECT: 14047 - CAMBRIDGE ROAD
REPORT TITLE: EXISTING VS. PROPOSED
ADDRESS: 28 PIPER ROAD
DATE: 02/10/2020
SCHEME IR: IR23 (07.09.2020)
DRAWING No.: 14047-RELO6-IS02-DD56

KEY:

- GAIN
- LOSS
- MAINTAINED LIT AREA
- 1 METRE GRID

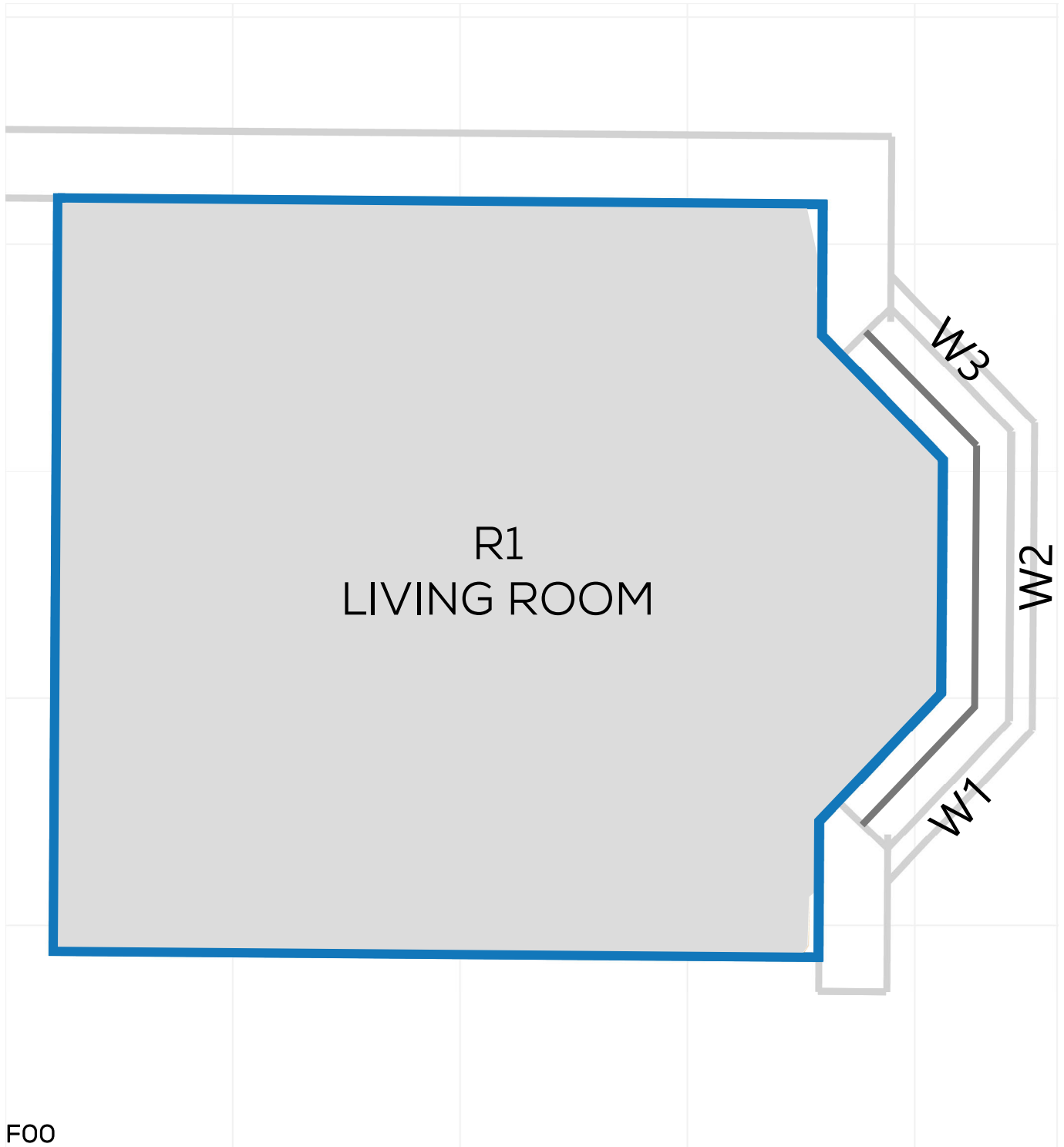

FOO

NSL CONTOURS



PROJECT: 14047 - CAMBRIDGE ROAD
REPORT TITLE: EXISTING VS. PROPOSED
ADDRESS: 28 PIPER ROAD
DATE: 02/10/2020
SCHEME IR: IR23 (07.09.2020)
DRAWING No.: 14047-RELO6-IS02-DD57

KEY:

- GAIN
- LOSS
- MAINTAINED LIT AREA
- 1 METRE GRID

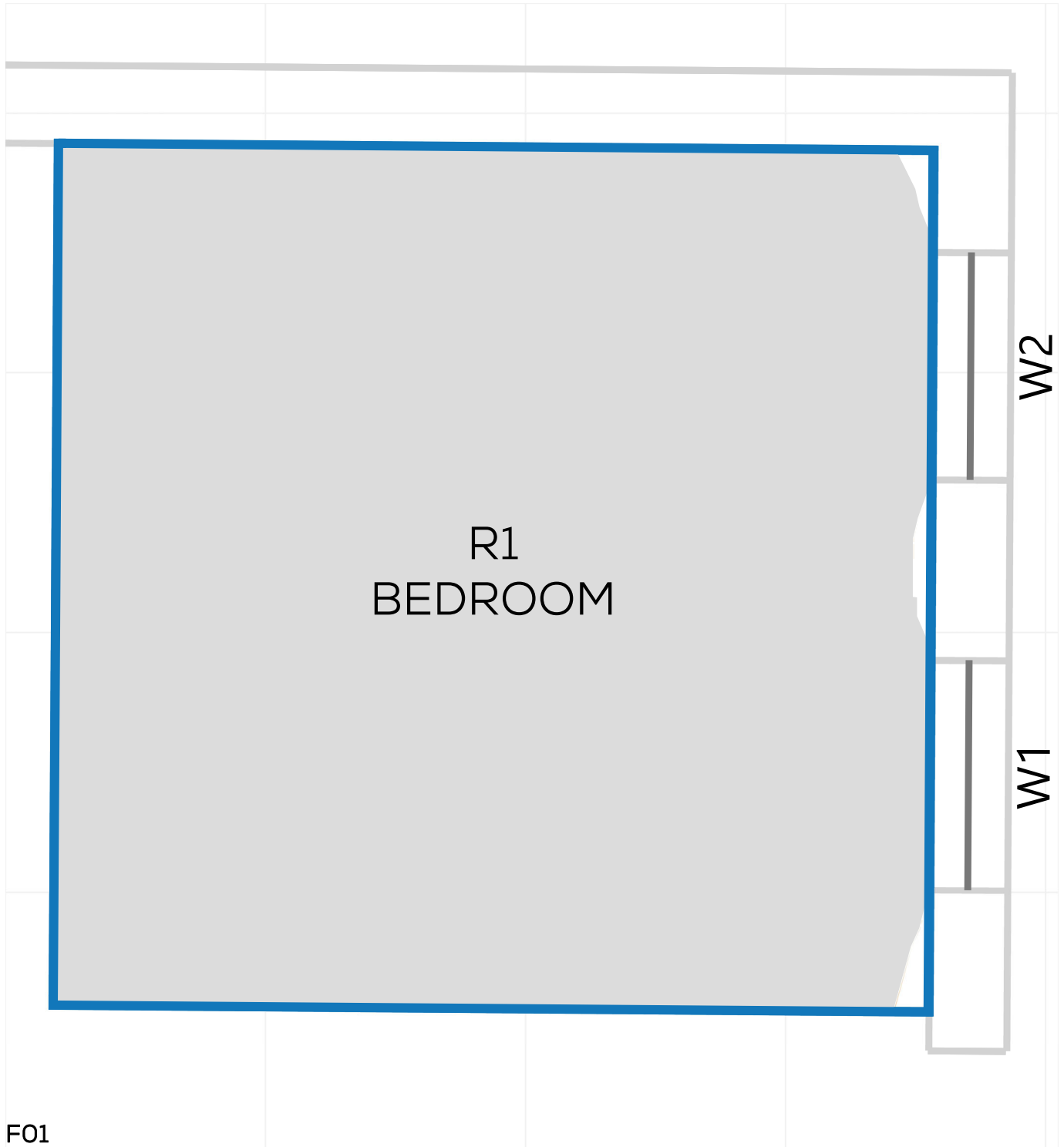

NSL CONTOURS



PROJECT: 14047 - CAMBRIDGE ROAD
REPORT TITLE: EXISTING VS. PROPOSED
ADDRESS: 22 PIPER ROAD
DATE: 02/10/2020
SCHEME IR: IR23 (07.09.2020)
DRAWING No.: 14047-RELO6-IS02-DD58

KEY:

- GAIN
- LOSS
- MAINTAINED LIT AREA
- 1 METRE GRID

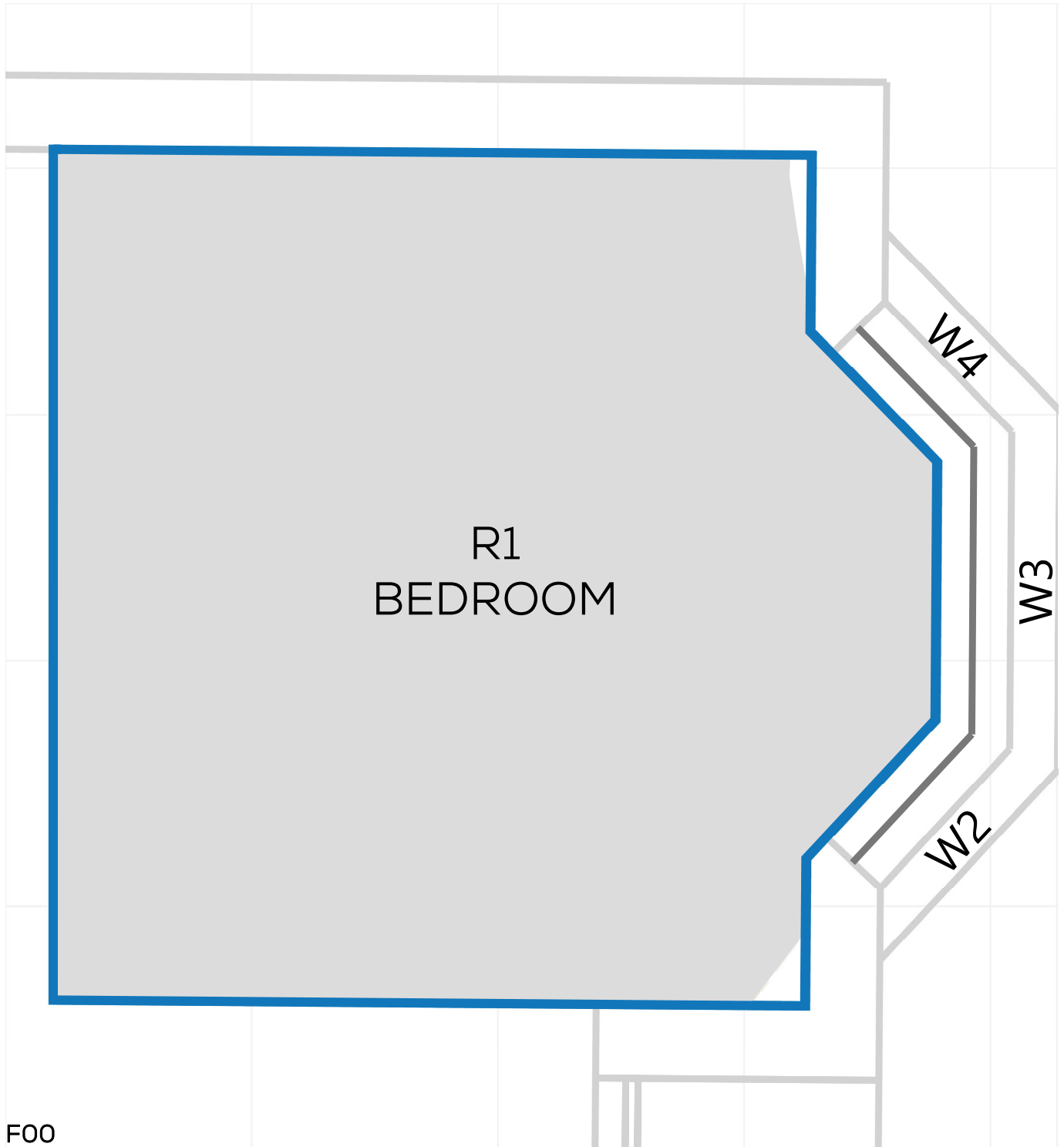

NSL CONTOURS



PROJECT: 14047 - CAMBRIDGE ROAD
REPORT TITLE: EXISTING VS. PROPOSED
ADDRESS: 22 PIPER ROAD
DATE: 02/10/2020
SCHEME IR: IR23 (07.09.2020)
DRAWING No.: 14047-RELO6-IS02-DD59

KEY:

- GAIN
- LOSS
- MAINTAINED LIT AREA
- 1 METRE GRID



NSL CONTOURS



PROJECT: 14047 - CAMBRIDGE ROAD
REPORT TITLE: EXISTING VS. PROPOSED
ADDRESS: 24 PIPER ROAD
DATE: 02/10/2020
SCHEME IR: IR23 (07.09.2020)
DRAWING No.: 14047-RELO6-IS02-DD60

KEY:

- GAIN
- LOSS
- MAINTAINED LIT AREA
- 1 METRE GRID

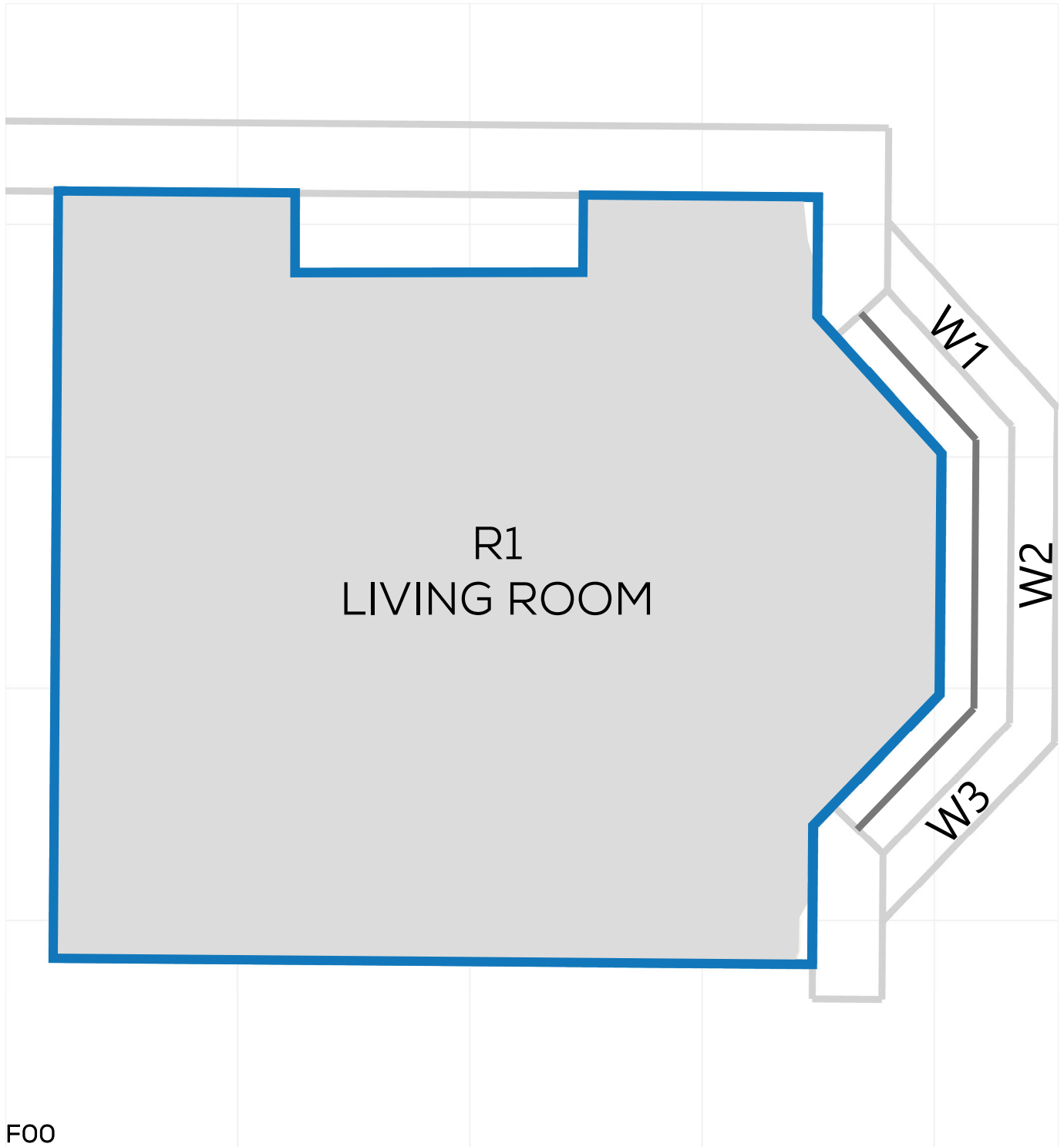

NSL CONTOURS



PROJECT: 14047 - CAMBRIDGE ROAD
REPORT TITLE: EXISTING VS. PROPOSED
ADDRESS: 24 PIPER ROAD
DATE: 02/10/2020
SCHEME IR: IR23 (07.09.2020)
DRAWING No.: 14047-RELO6-IS02-DD61

KEY:

- GAIN
- LOSS
- MAINTAINED LIT AREA
- 1 METRE GRID

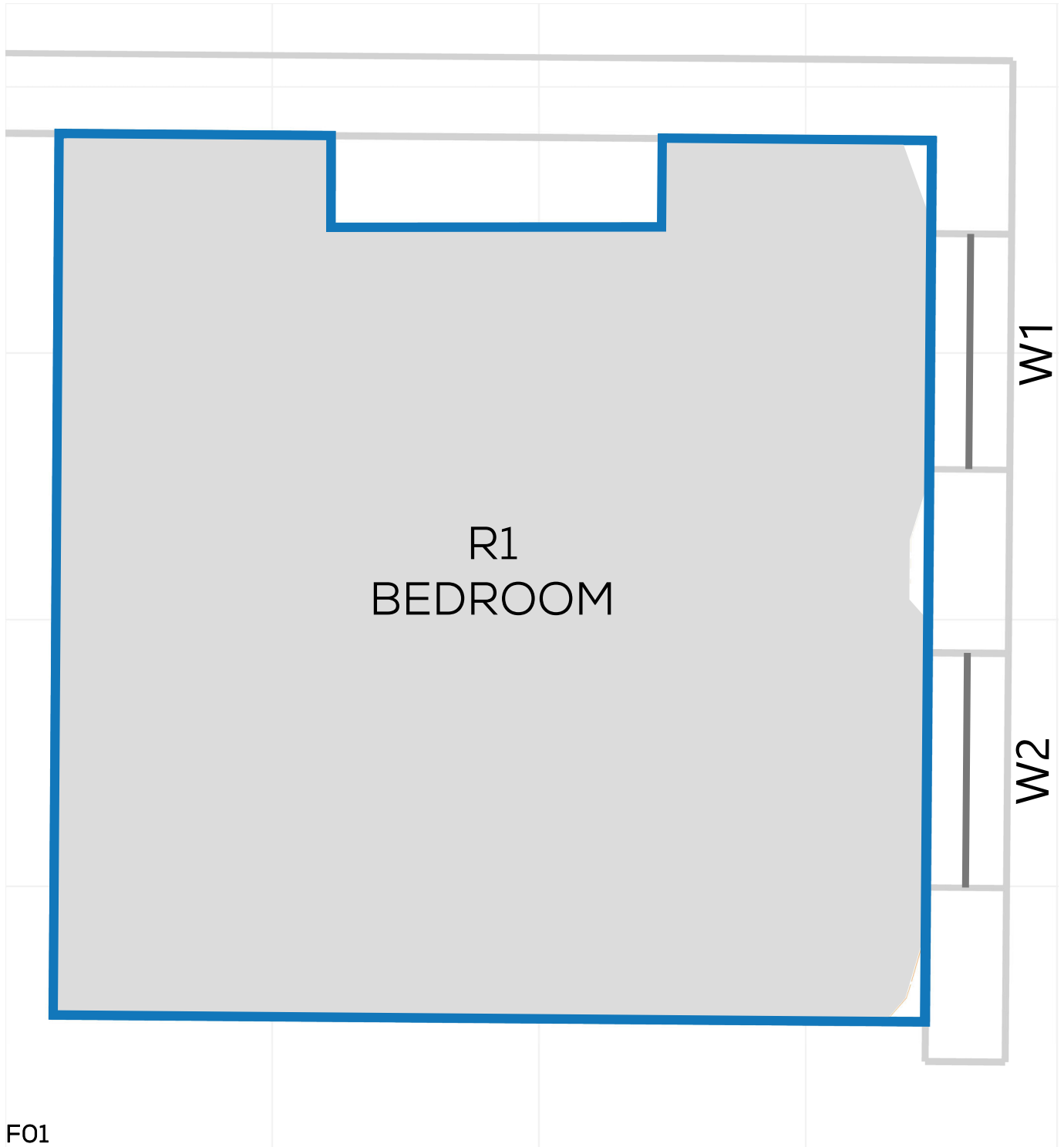

NSL CONTOURS



PROJECT: 14047 - CAMBRIDGE ROAD
REPORT TITLE: EXISTING VS. PROPOSED
ADDRESS: 26 PIPER ROAD
DATE: 02/10/2020
SCHEME IR: IR23 (07.09.2020)
DRAWING No.: 14047-RELO6-IS02-DD62

KEY:

- GAIN
- LOSS
- MAINTAINED LIT AREA
- 1 METRE GRID

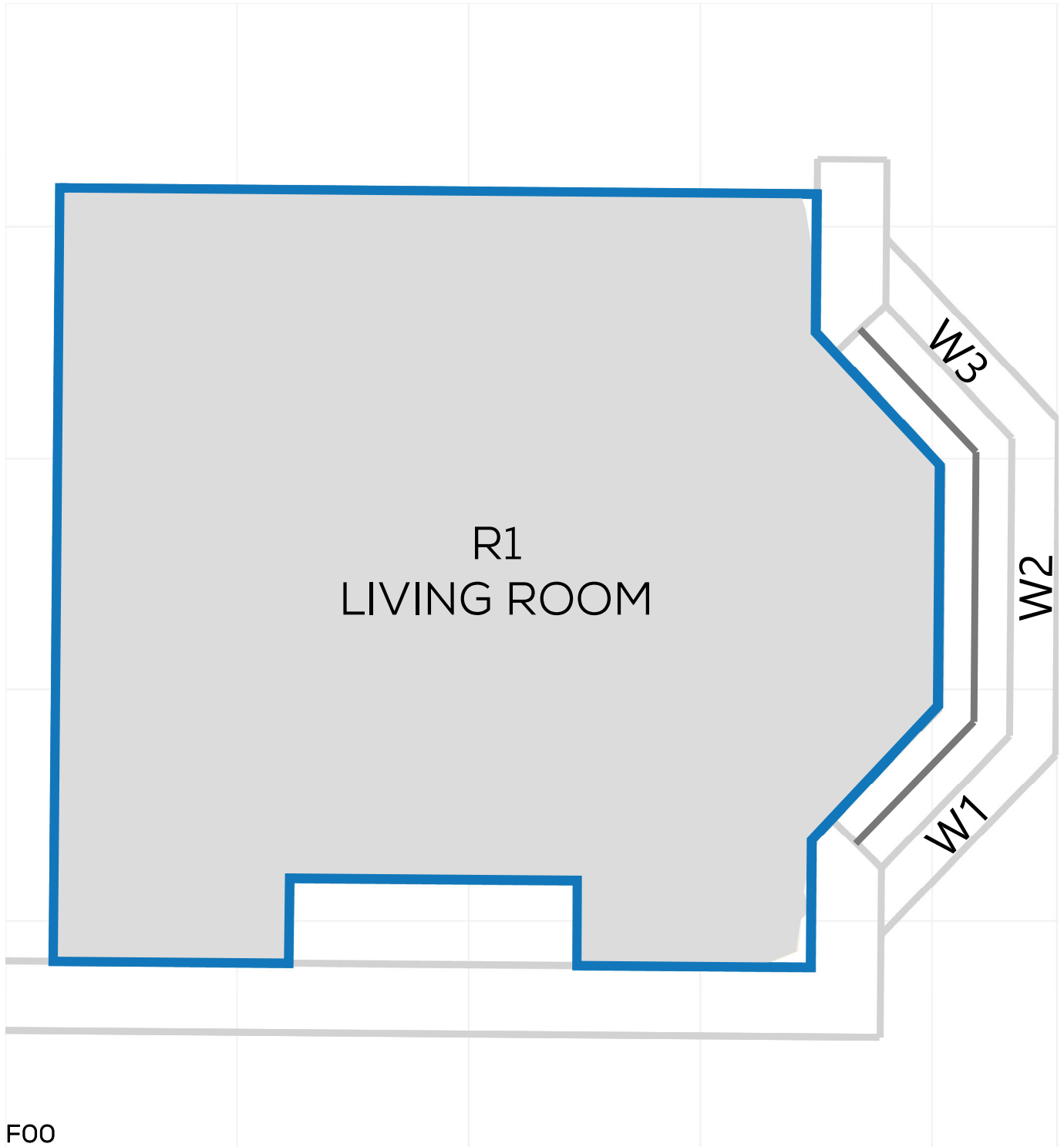

NSL CONTOURS



PROJECT: 14047 - CAMBRIDGE ROAD
REPORT TITLE: EXISTING VS. PROPOSED
ADDRESS: 26 PIPER ROAD
DATE: 02/10/2020
SCHEME IR: IR23 (07.09.2020)
DRAWING No.: 14047-RELO6-IS02-DD63

KEY:

- GAIN
- LOSS
- MAINTAINED LIT AREA
- 1 METRE GRID

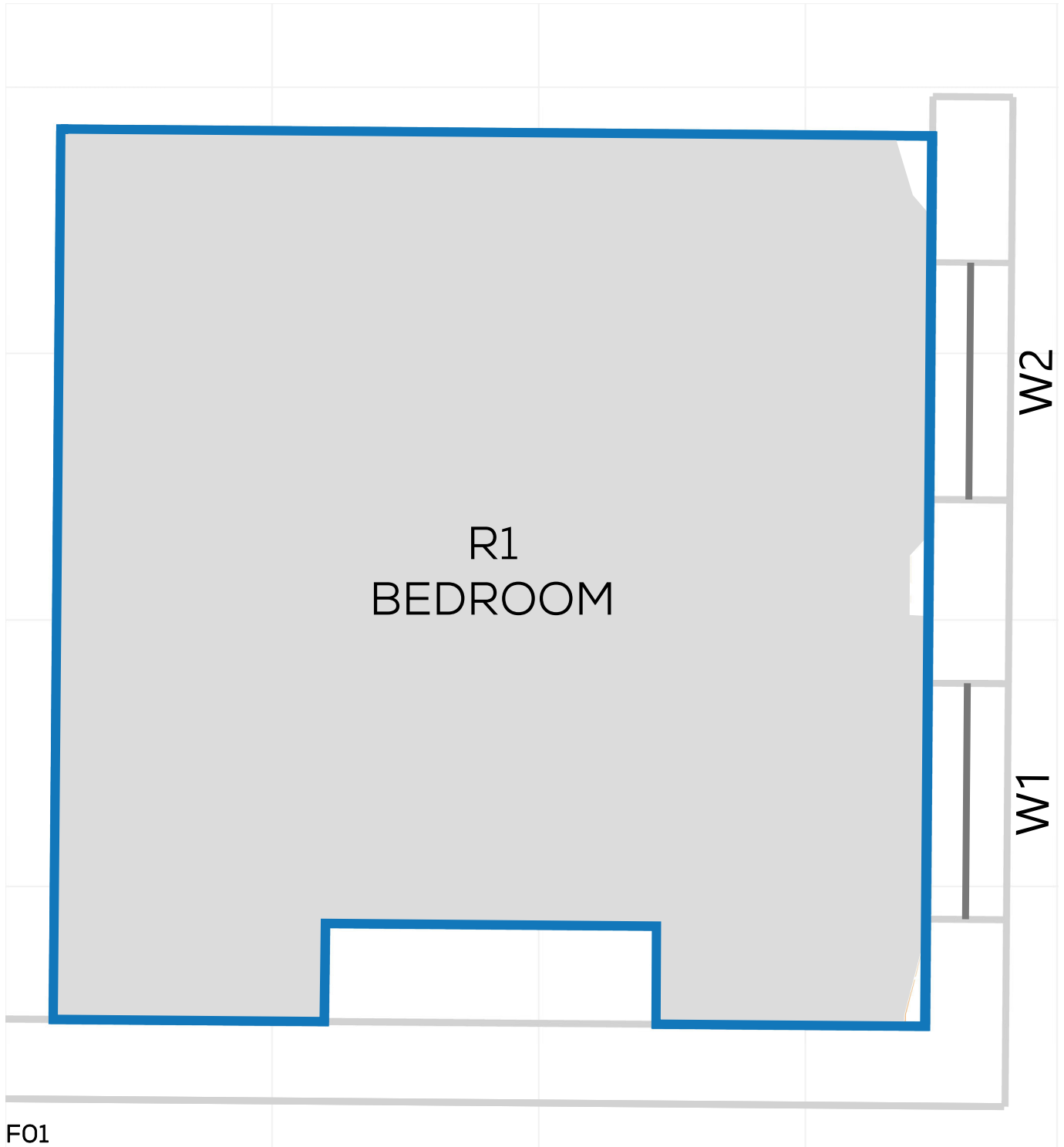

NSL CONTOURS



PROJECT: 14047 - CAMBRIDGE ROAD
REPORT TITLE: EXISTING VS. PROPOSED
ADDRESS: 5 PORTMAN ROAD
DATE: 02/10/2020
SCHEME IR: IR23 (07.09.2020)
DRAWING No.: 14047-RELO6-IS02-DD64

KEY:

- GAIN
- LOSS
- MAINTAINED LIT AREA
- 1 METRE GRID

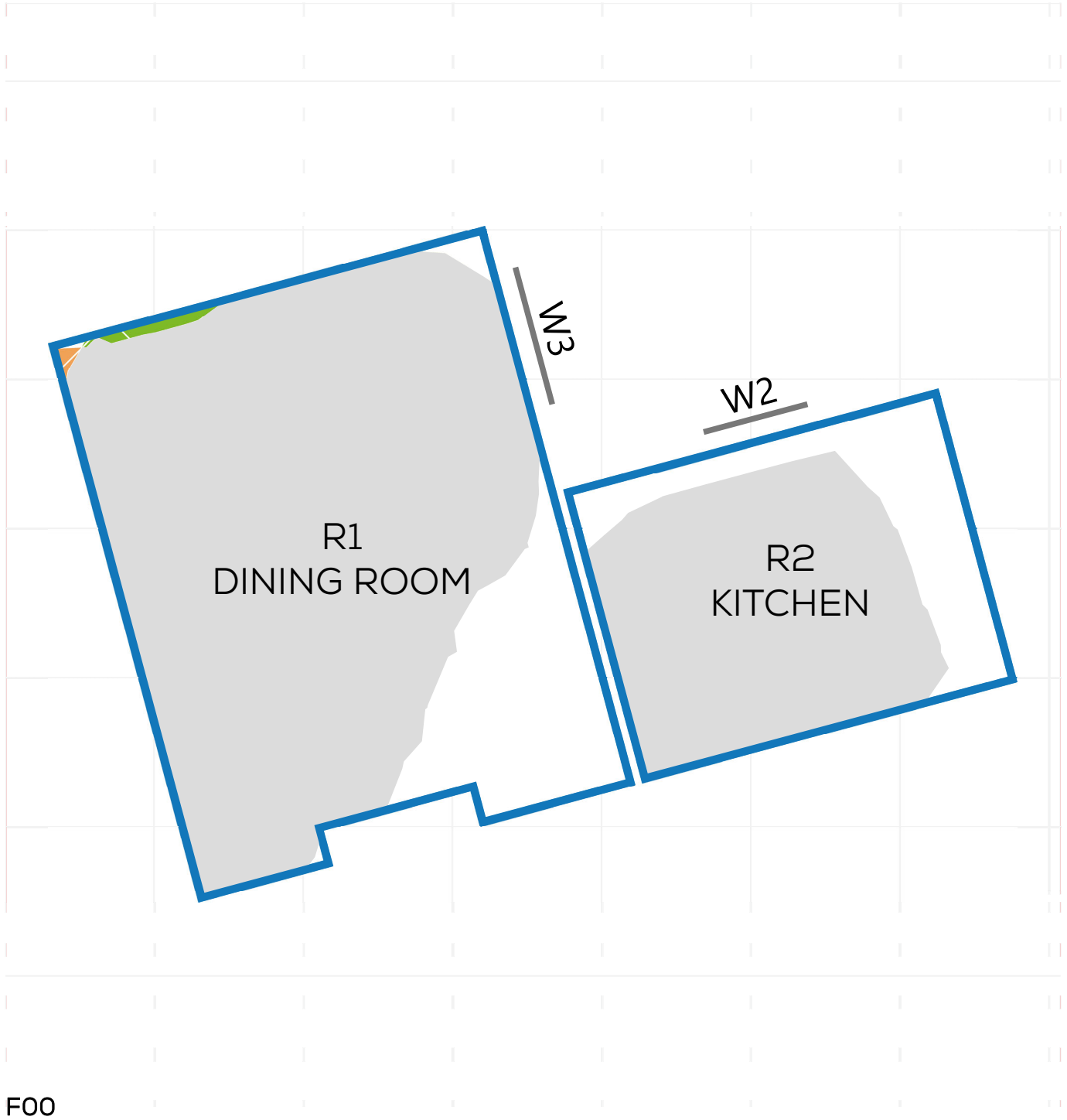
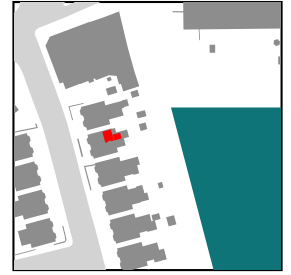

NSL CONTOURS



PROJECT: 14047 - CAMBRIDGE ROAD
REPORT TITLE: EXISTING VS. PROPOSED
ADDRESS: 5 PORTMAN ROAD
DATE: 02/10/2020
SCHEME IR: IR23 (07.09.2020)
DRAWING No.: 14047-RELO6-IS02-DD65

KEY:

- GAIN
- LOSS
- MAINTAINED LIT AREA
- 1 METRE GRID

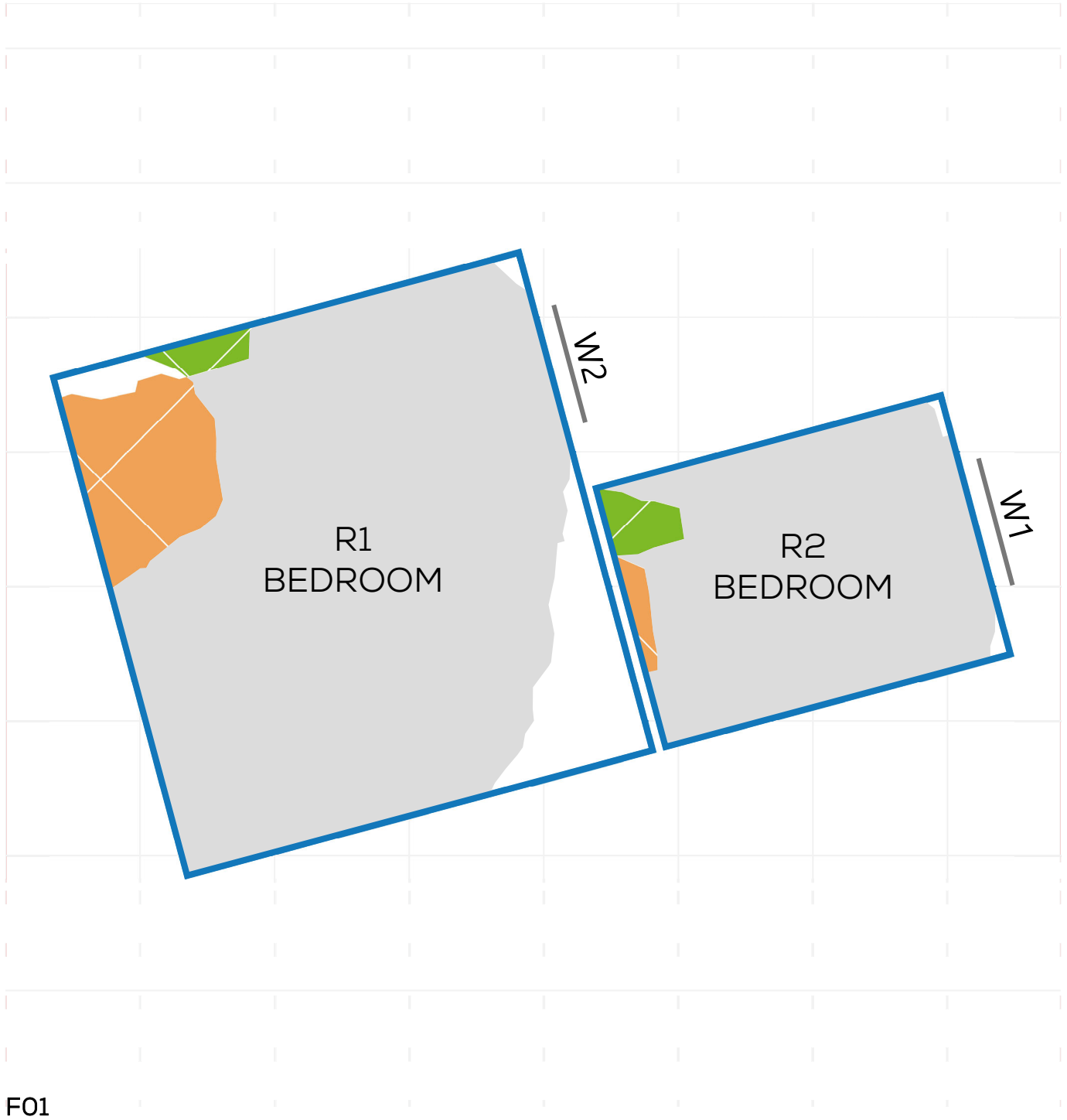
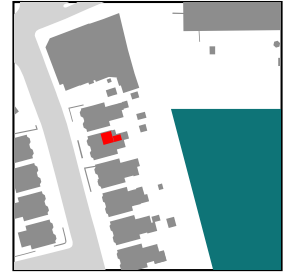

NSL CONTOURS



PROJECT: 14047 - CAMBRIDGE ROAD
REPORT TITLE: EXISTING VS. PROPOSED
ADDRESS: 7 PORTMAN ROAD
DATE: 02/10/2020
SCHEME IR: IR23 (07.09.2020)
DRAWING No.: 14047-RELO6-IS02-DD66

KEY:

- GAIN
- LOSS
- MAINTAINED LIT AREA
- 1 METRE GRID

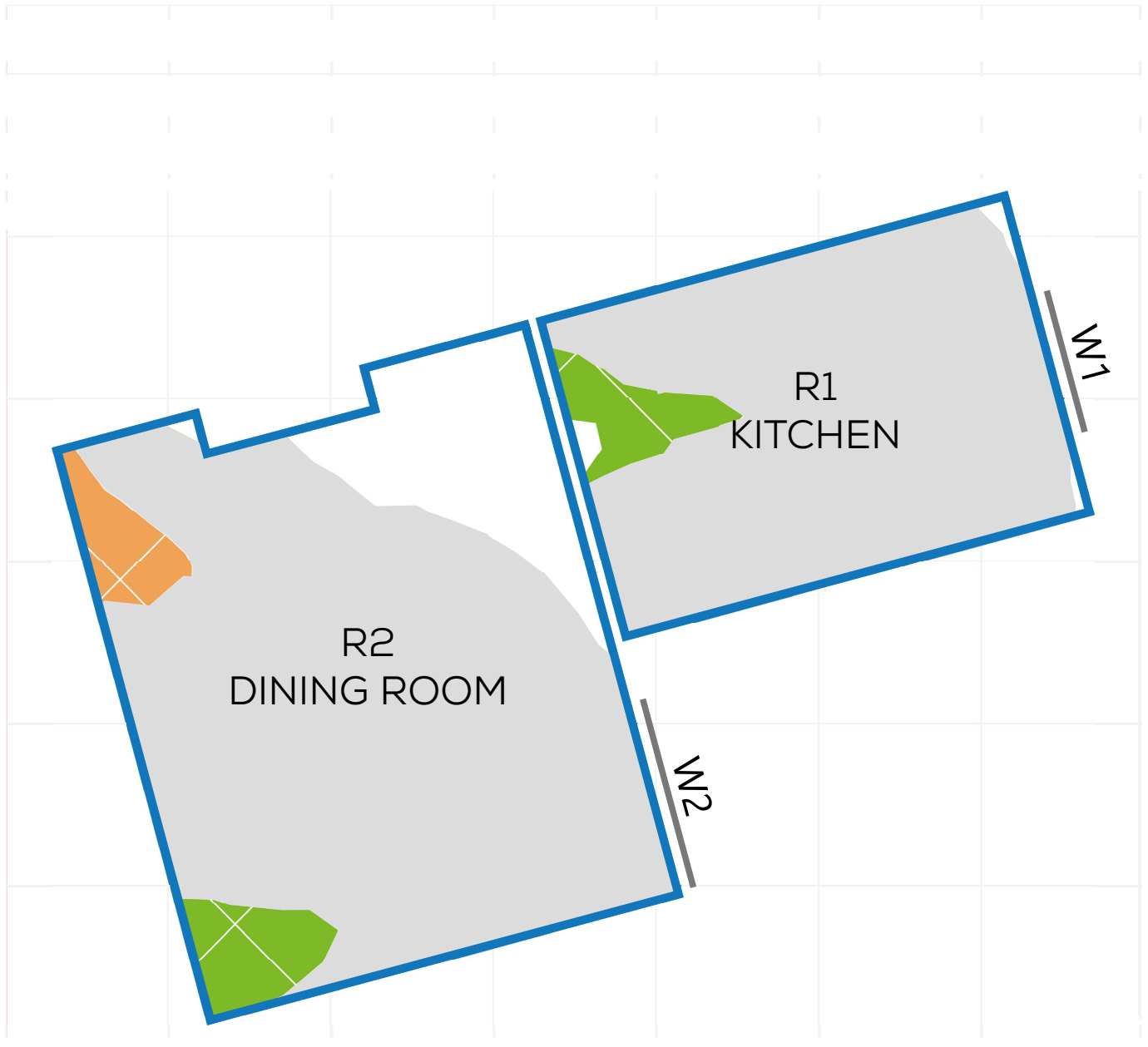
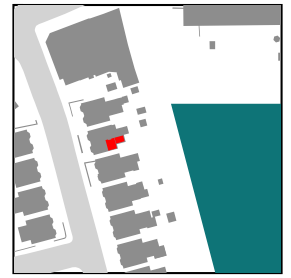

NSL CONTOURS



PROJECT: 14047 - CAMBRIDGE ROAD
REPORT TITLE: EXISTING VS. PROPOSED
ADDRESS: 7 PORTMAN ROAD
DATE: 02/10/2020
SCHEME IR: IR23 (07.09.2020)
DRAWING No.: 14047-RELO6-IS02-DD67

KEY:

- GAIN
- LOSS
- MAINTAINED LIT AREA
- 1 METRE GRID

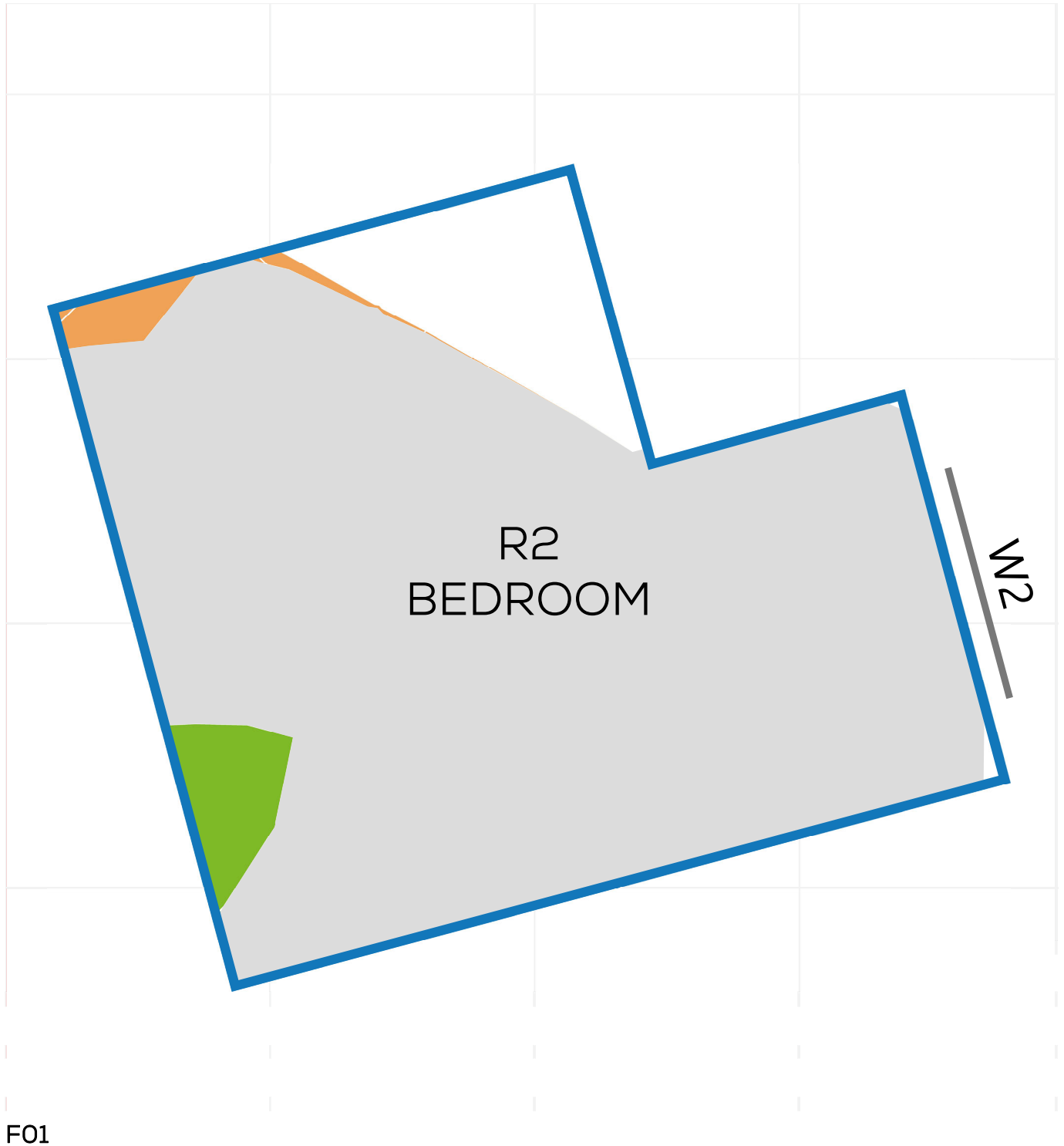
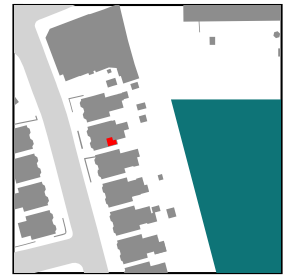

NSL CONTOURS



PROJECT: 14047 - CAMBRIDGE ROAD
REPORT TITLE: EXISTING VS. PROPOSED
ADDRESS: 37 ROWLLS ROAD
DATE: 02/10/2020
SCHEME IR: IR23 (07.09.2020)
DRAWING No.: 14047-RELO6-IS02-DD68

KEY:

- GAIN
- LOSS
- MAINTAINED LIT AREA
- 1 METRE GRID

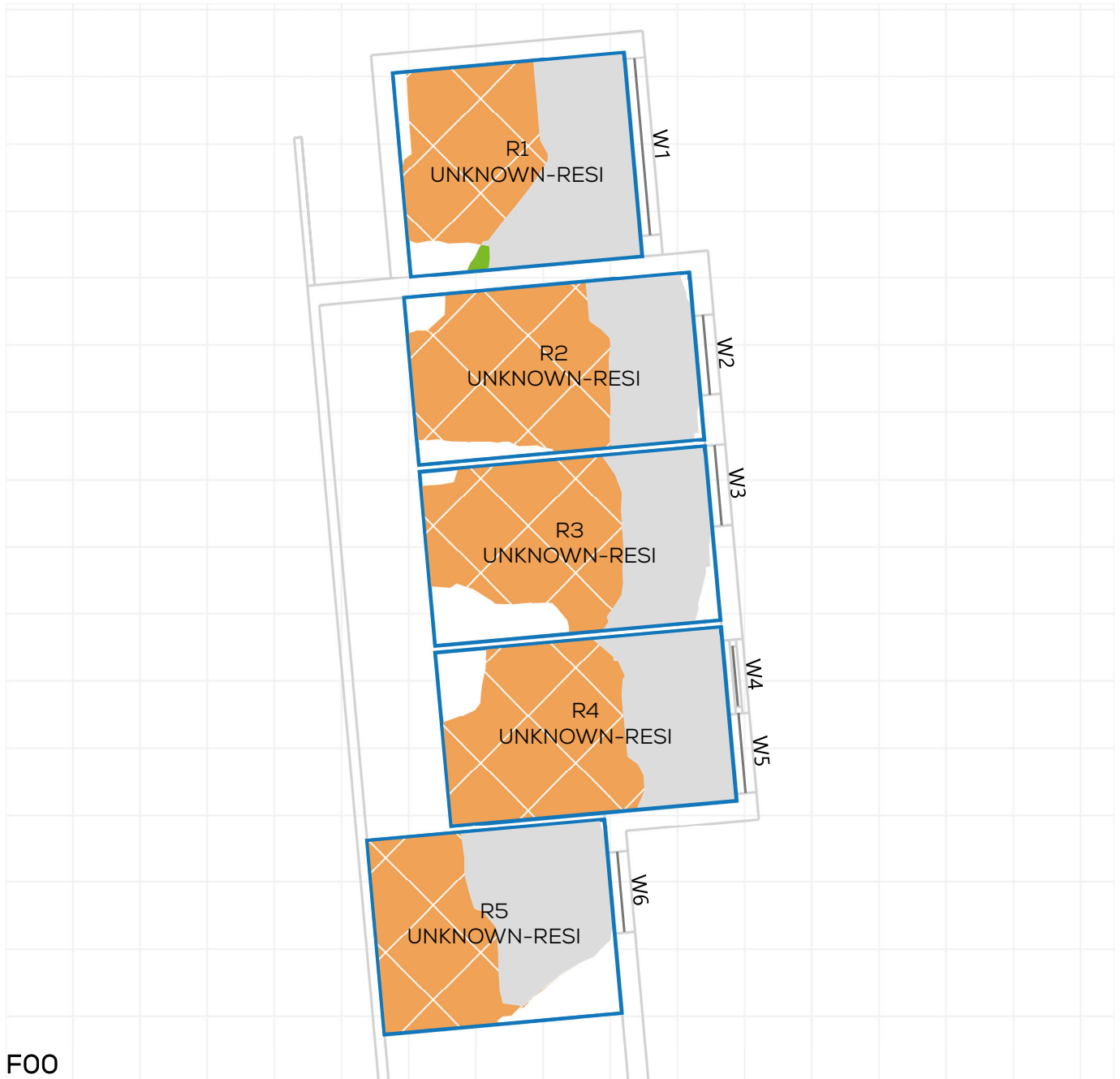
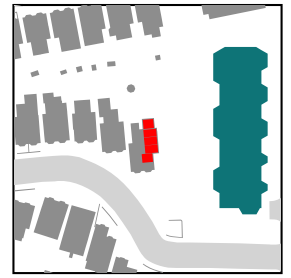

NSL CONTOURS



PROJECT: 14047 - CAMBRIDGE ROAD
REPORT TITLE: EXISTING VS. PROPOSED
ADDRESS: 37 ROWLLS ROAD
DATE: 02/10/2020
SCHEME IR: IR23 (07.09.2020)
DRAWING No.: 14047-RELO6-IS02-DD69

KEY:

- GAIN
- LOSS
- MAINTAINED LIT AREA
- 1 METRE GRID

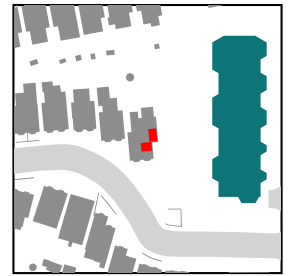

NSL CONTOURS



PROJECT: 14047 - CAMBRIDGE ROAD
REPORT TITLE: EXISTING VS. PROPOSED
ADDRESS: 37 ROWLLS ROAD
DATE: 02/10/2020
SCHEME IR: IR23 (07.09.2020)
DRAWING No.: 14047-RELO6-IS02-DD70

KEY:

- GAIN
- LOSS
- MAINTAINED LIT AREA
- 1 METRE GRID

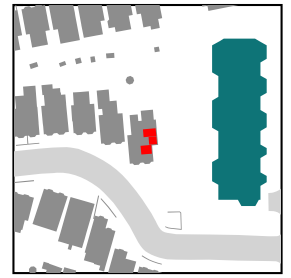

F02

NSL CONTOURS



PROJECT: 14047 - CAMBRIDGE ROAD
REPORT TITLE: EXISTING VS. PROPOSED
ADDRESS: 1 SOMERSET ROAD
DATE: 02/10/2020
SCHEME IR: IR23 (07.09.2020)
DRAWING No.: 14047-RELO6-IS02-DD71

KEY:

- GAIN
- LOSS
- MAINTAINED LIT AREA
- 1 METRE GRID



FOO

NSL CONTOURS



PROJECT: 14047 - CAMBRIDGE ROAD
REPORT TITLE: EXISTING VS. PROPOSED
ADDRESS: 1 SOMERSET ROAD
DATE: 02/10/2020
SCHEME IR: IR23 (07.09.2020)
DRAWING No.: 14047-RELO6-IS02-DD72

KEY:

- GAIN
- LOSS
- MAINTAINED LIT AREA
- 1 METRE GRID

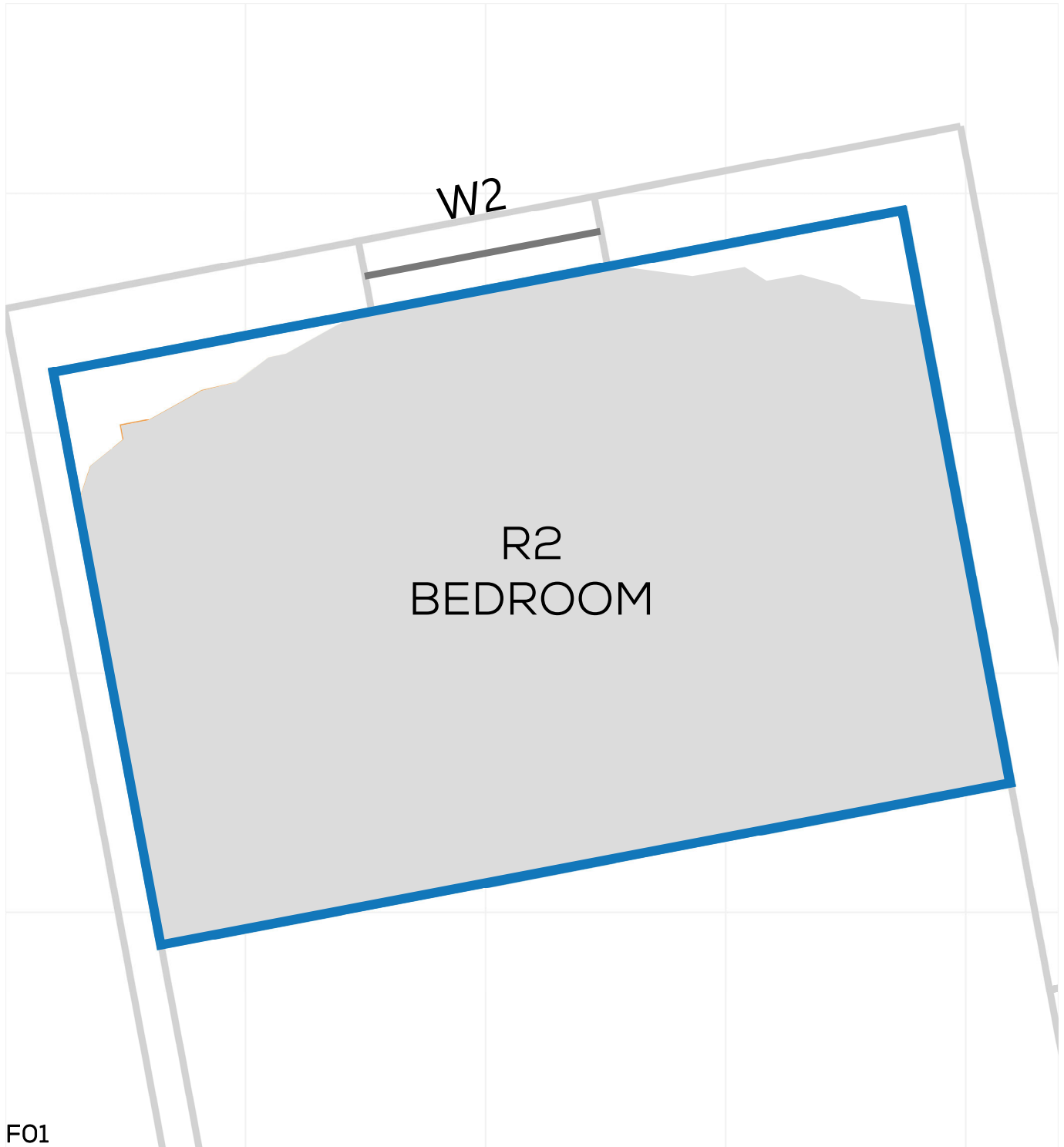

NSL CONTOURS



PROJECT: 14047 - CAMBRIDGE ROAD
REPORT TITLE: EXISTING VS. PROPOSED
ADDRESS: 35 PORTMAN ROAD
DATE: 02/10/2020
SCHEME IR: IR23 (07.09.2020)
DRAWING No.: 14047-RELO6-IS02-DD73

KEY:

- GAIN
- LOSS
- MAINTAINED LIT AREA
- 1 METRE GRID

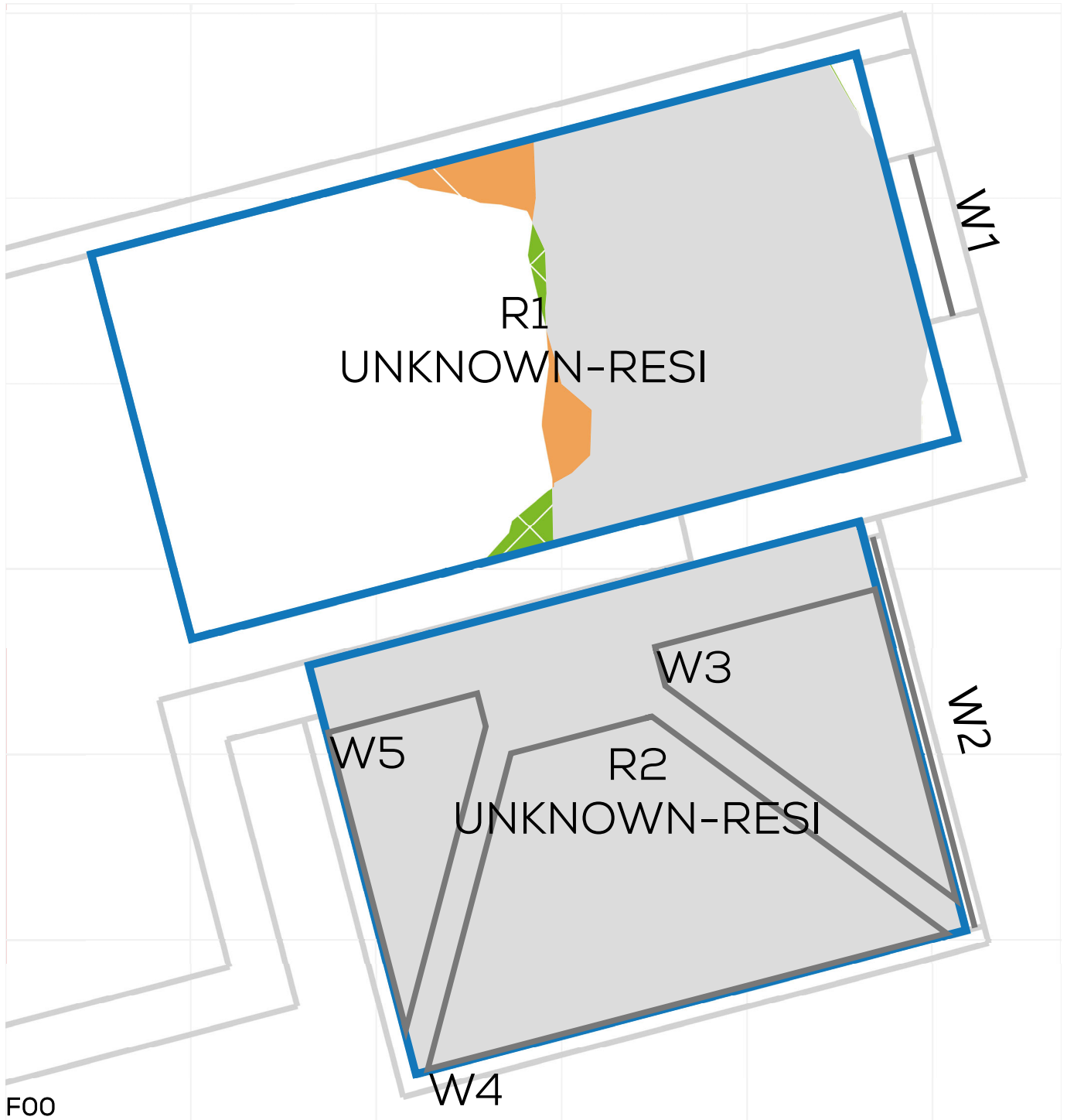

NSL CONTOURS



PROJECT: 14047 - CAMBRIDGE ROAD
REPORT TITLE: EXISTING VS. PROPOSED
ADDRESS: 35 PORTMAN ROAD
DATE: 02/10/2020
SCHEME IR: IR23 (07.09.2020)
DRAWING No.: 14047-RELO6-IS02-DD74

KEY:

- GAIN
- LOSS
- MAINTAINED LIT AREA
- 1 METRE GRID



NSL CONTOURS



PROJECT: 14047 - CAMBRIDGE ROAD
REPORT TITLE: EXISTING VS. PROPOSED
ADDRESS: 35 PORTMAN ROAD
DATE: 02/10/2020
SCHEME IR: IR23 (07.09.2020)
DRAWING No.: 14047-RELO6-IS02-DD75

KEY:

- GAIN
- LOSS
- MAINTAINED LIT AREA
- 1 METRE GRID



NSL CONTOURS



PROJECT: 14047 - CAMBRIDGE ROAD
REPORT TITLE: EXISTING VS. PROPOSED
ADDRESS: 37 PORTMAN ROAD
DATE: 02/10/2020
SCHEME IR: IR23 (07.09.2020)
DRAWING No.: 14047-RELO6-IS02-DD76

KEY:

- GAIN
- LOSS
- MAINTAINED LIT AREA
- 1 METRE GRID

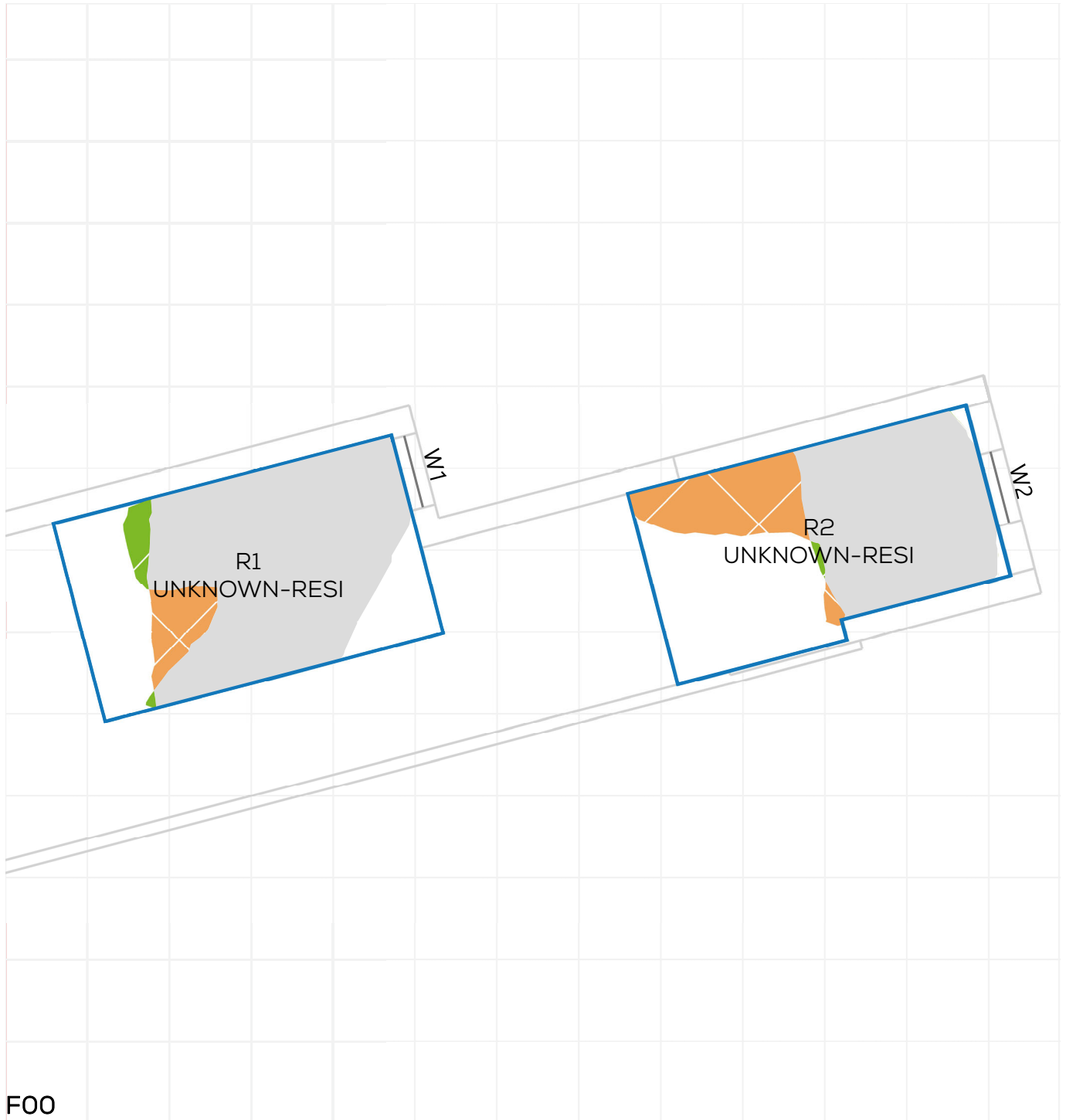

NSL CONTOURS



PROJECT: 14047 - CAMBRIDGE ROAD
REPORT TITLE: EXISTING VS. PROPOSED
ADDRESS: 37 PORTMAN ROAD
DATE: 02/10/2020
SCHEME IR: IR23 (07.09.2020)
DRAWING No.: 14047-RELO6-IS02-DD77

KEY:

- GAIN
- LOSS
- MAINTAINED LIT AREA
- 1 METRE GRID



NSL CONTOURS



PROJECT: 14047 - CAMBRIDGE ROAD
REPORT TITLE: EXISTING VS. PROPOSED
ADDRESS: 21 PORTMAN ROAD
DATE: 02/10/2020
SCHEME IR: IR23 (07.09.2020)
DRAWING No.: 14047-RELO6-IS02-DD78

KEY:

- GAIN
- LOSS
- MAINTAINED LIT AREA
- 1 METRE GRID

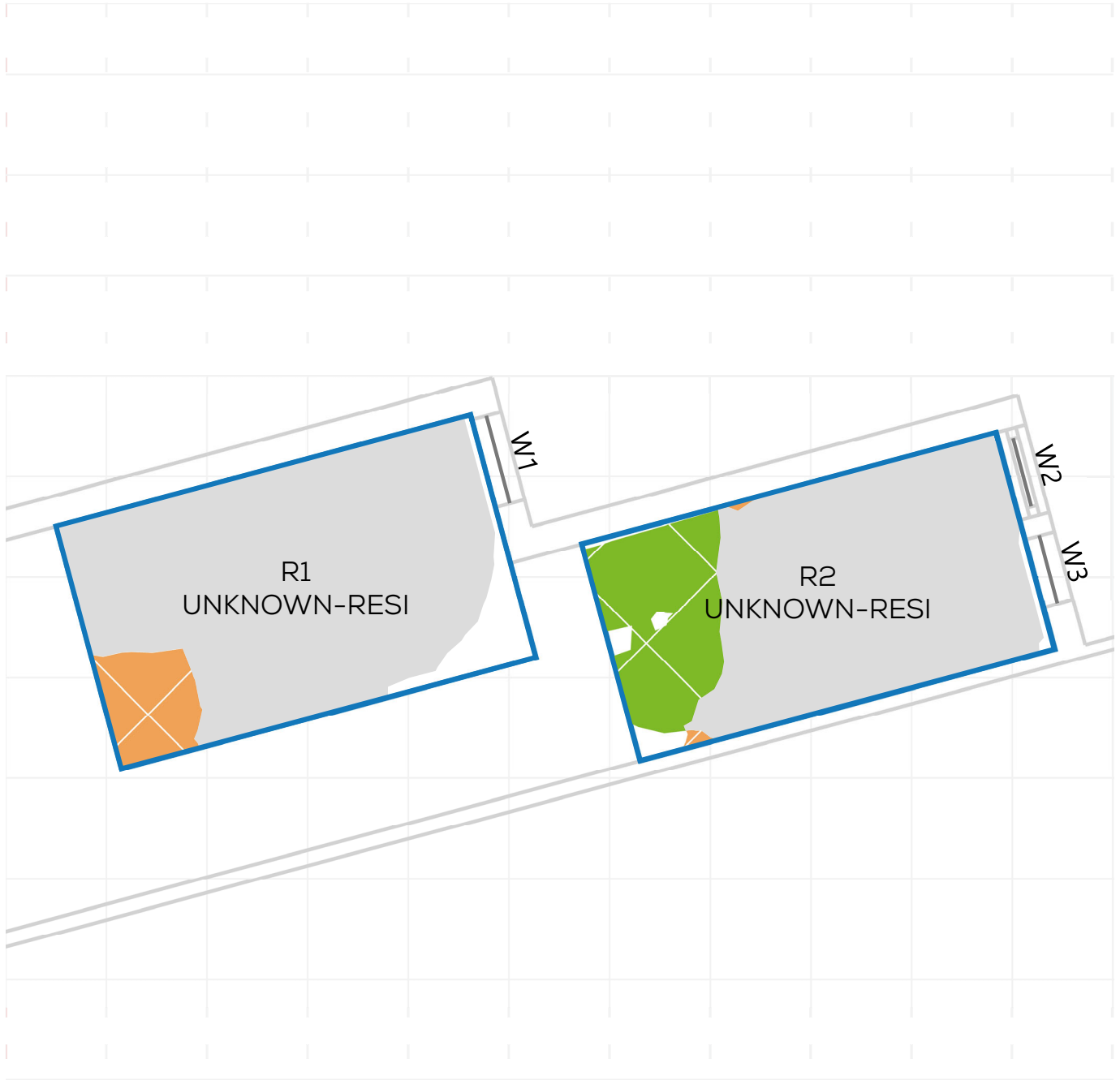
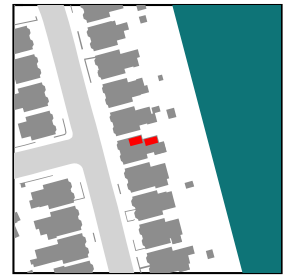

NSL CONTOURS



PROJECT: 14047 - CAMBRIDGE ROAD
REPORT TITLE: EXISTING VS. PROPOSED
ADDRESS: 21 PORTMAN ROAD
DATE: 02/10/2020
SCHEME IR: IR23 (07.09.2020)
DRAWING No.: 14047-RELO6-IS02-DD79

KEY:

- GAIN
- LOSS
- MAINTAINED LIT AREA
- 1 METRE GRID

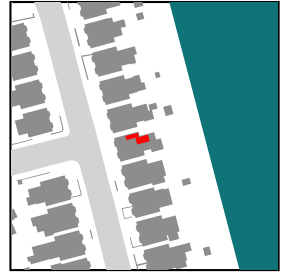

NSL CONTOURS



PROJECT: 14047 - CAMBRIDGE ROAD
REPORT TITLE: EXISTING VS. PROPOSED
ADDRESS: 23 PORTMAN ROAD
DATE: 02/10/2020
SCHEME IR: IR23 (07.09.2020)
DRAWING No.: 14047-RELO6-IS02-DD80

KEY:

- GAIN
- LOSS
- MAINTAINED LIT AREA
- 1 METRE GRID

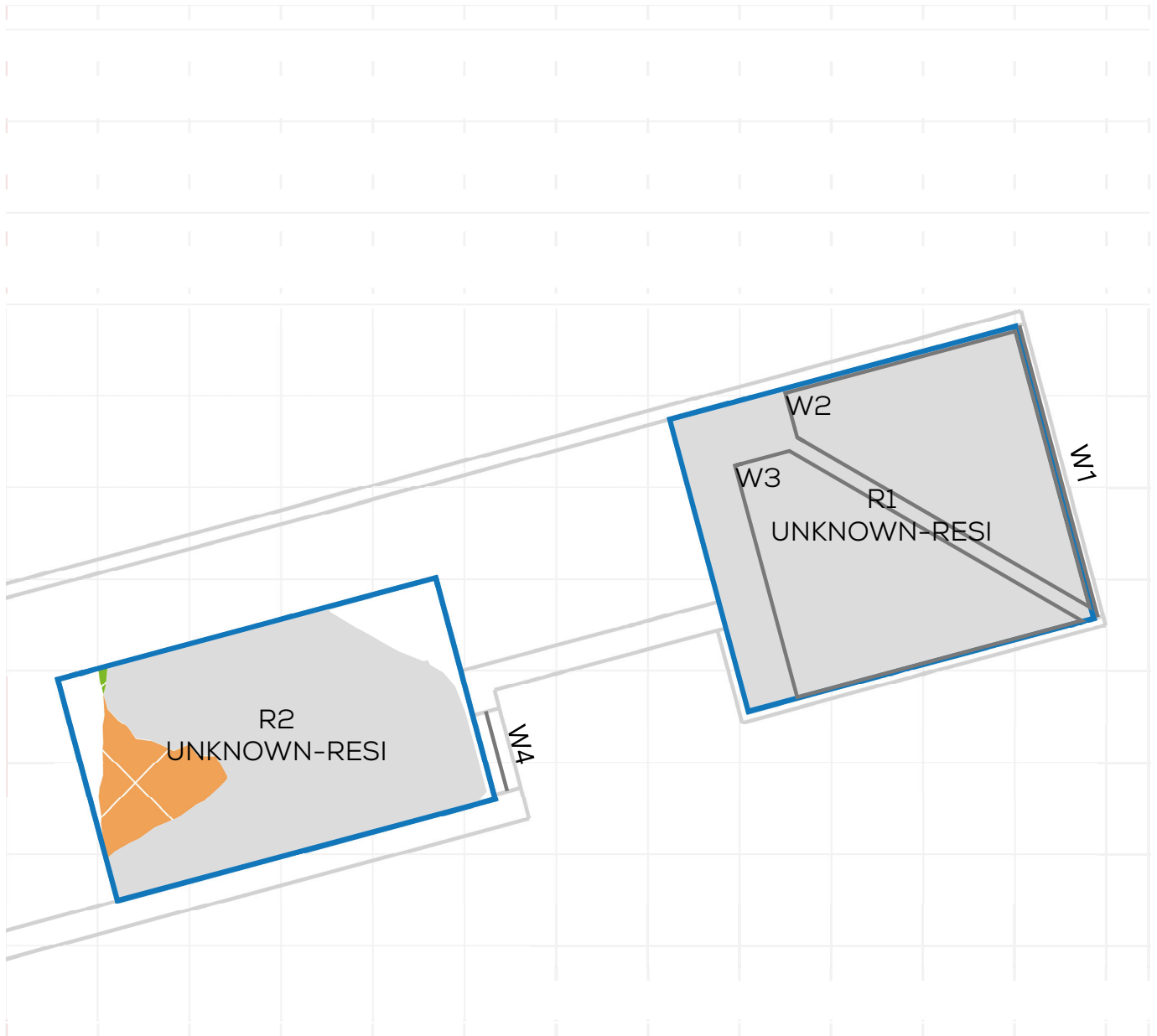

NSL CONTOURS



PROJECT: 14047 - CAMBRIDGE ROAD
REPORT TITLE: EXISTING VS. PROPOSED
ADDRESS: 23 PORTMAN ROAD
DATE: 02/10/2020
SCHEME IR: IR23 (07.09.2020)
DRAWING No.: 14047-RELO6-IS02-DD81

KEY:

- GAIN
- LOSS
- MAINTAINED LIT AREA
- 1 METRE GRID

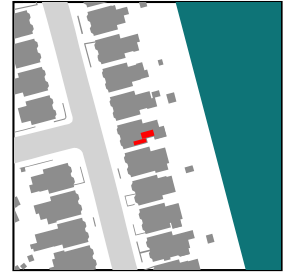

NSL CONTOURS



PROJECT: 14047 - CAMBRIDGE ROAD
REPORT TITLE: EXISTING VS. PROPOSED
ADDRESS: 9 PORTMAN ROAD
DATE: 02/10/2020
SCHEME IR: IR23 (07.09.2020)
DRAWING No.: 14047-RELO6-IS02-DD82

KEY:

- GAIN
- LOSS
- MAINTAINED LIT AREA
- 1 METRE GRID

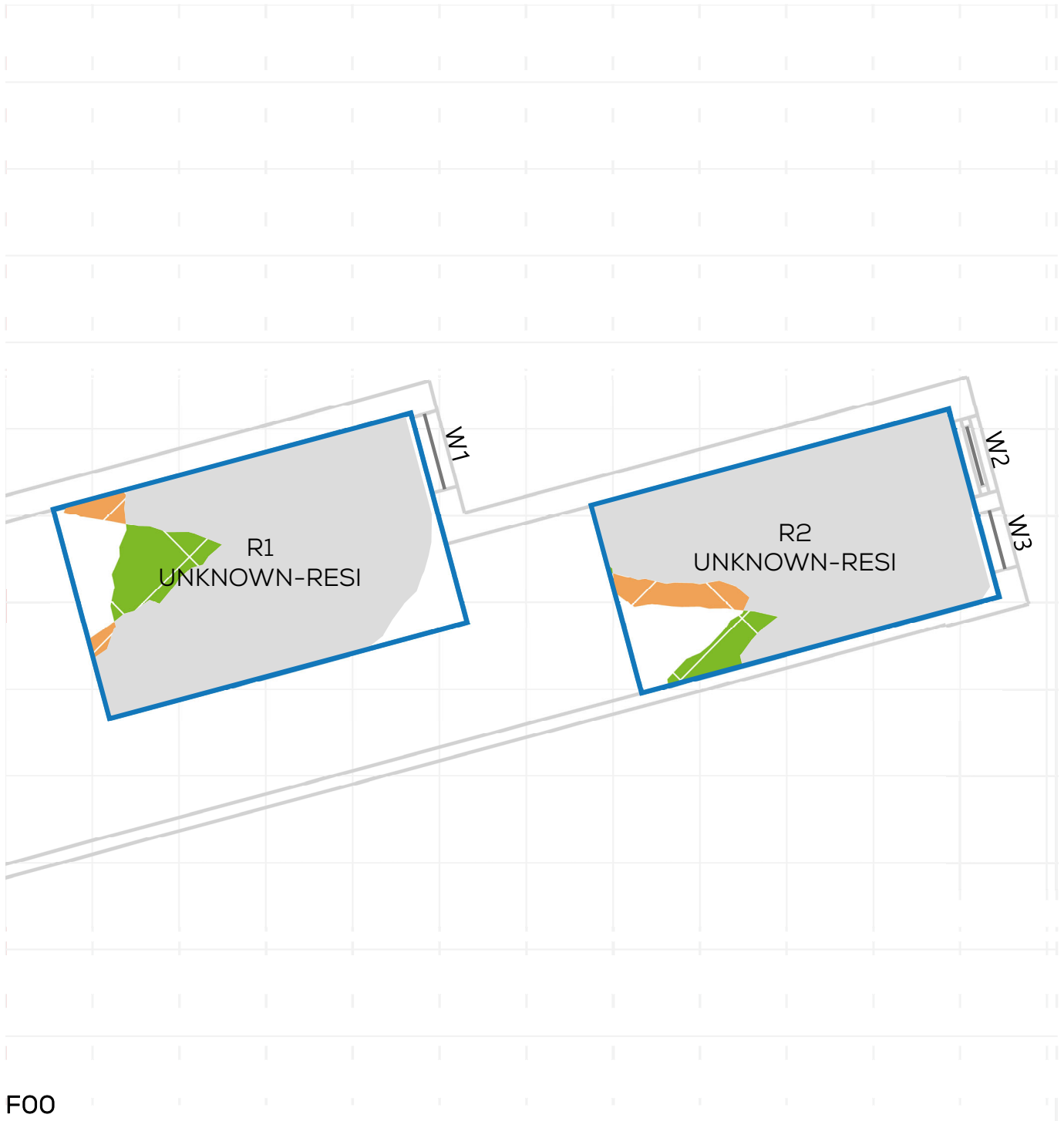
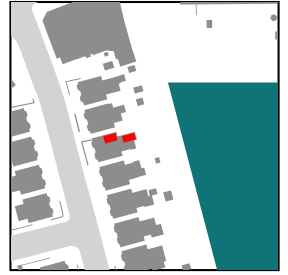

NSL CONTOURS



PROJECT: 14047 - CAMBRIDGE ROAD
REPORT TITLE: EXISTING VS. PROPOSED
ADDRESS: 9 PORTMAN ROAD
DATE: 02/10/2020
SCHEME IR: IR23 (07.09.2020)
DRAWING No.: 14047-RELO6-IS02-DD83

KEY:

- GAIN
- LOSS
- MAINTAINED LIT AREA
- 1 METRE GRID

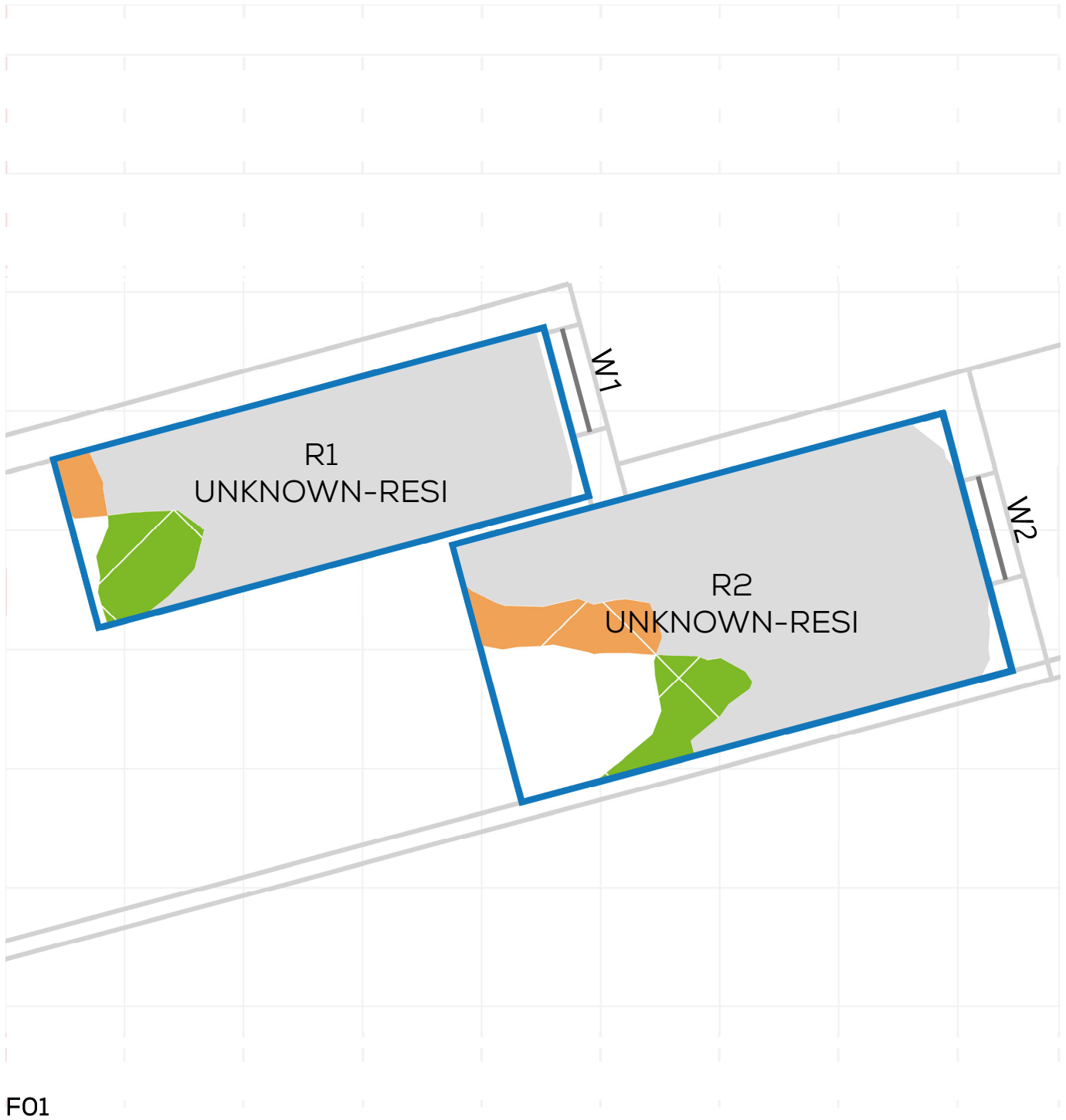

NSL CONTOURS



PROJECT: 14047 - CAMBRIDGE ROAD
REPORT TITLE: EXISTING VS. PROPOSED
ADDRESS: 11 PORTMAN ROAD
DATE: 02/10/2020
SCHEME IR: IR23 (07.09.2020)
DRAWING No.: 14047-RELO6-IS02-DD84

KEY:

- GAIN
- LOSS
- MAINTAINED LIT AREA
- 1 METRE GRID

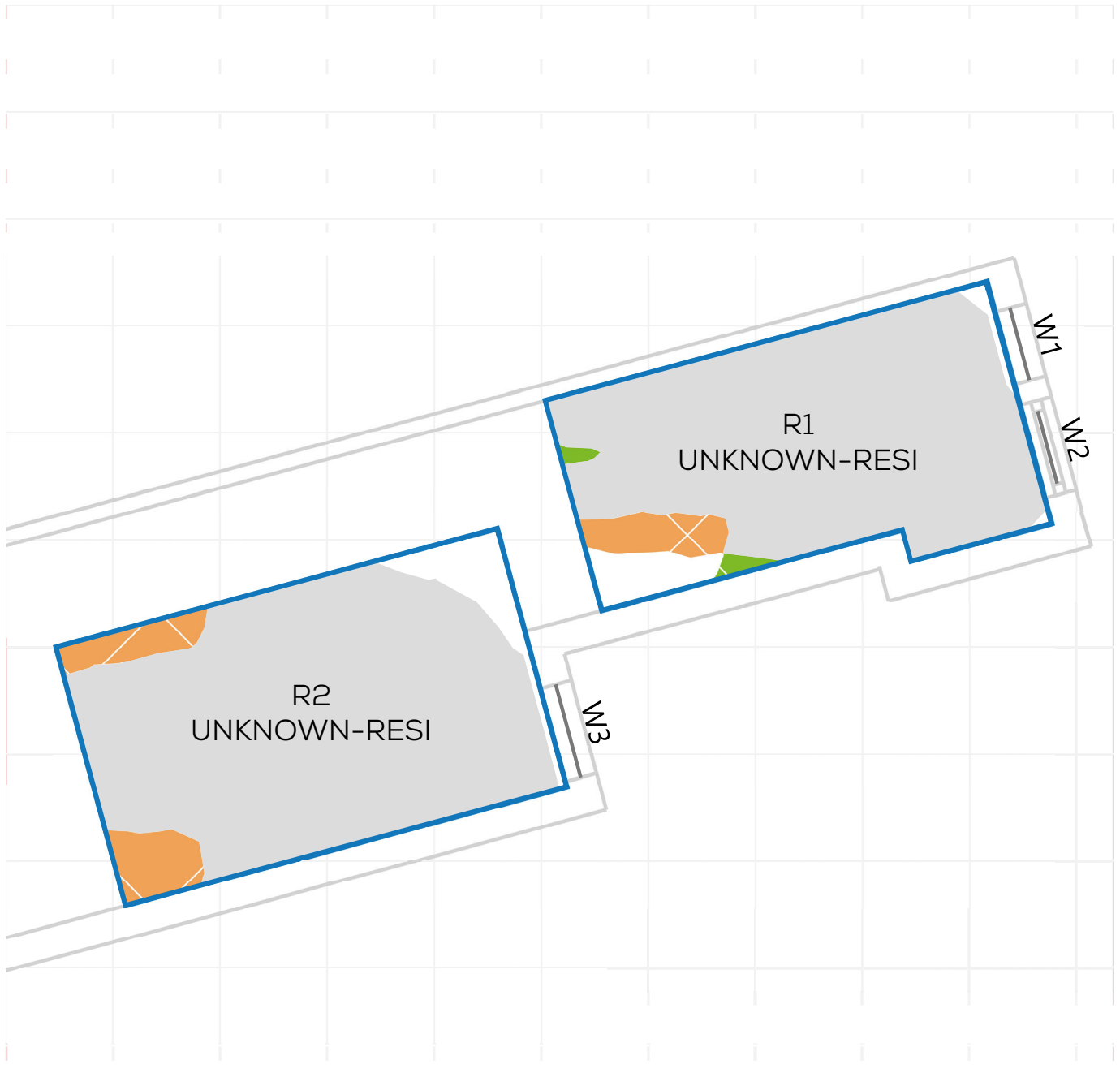
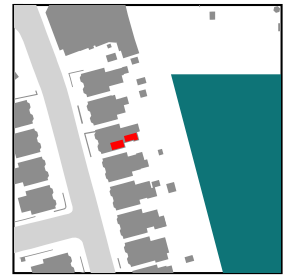

NSL CONTOURS



PROJECT: 14047 - CAMBRIDGE ROAD
REPORT TITLE: EXISTING VS. PROPOSED
ADDRESS: 11 PORTMAN ROAD
DATE: 02/10/2020
SCHEME IR: IR23 (07.09.2020)
DRAWING No.: 14047-RELO6-IS02-DD85

KEY:

- GAIN
- LOSS
- MAINTAINED LIT AREA
- 1 METRE GRID

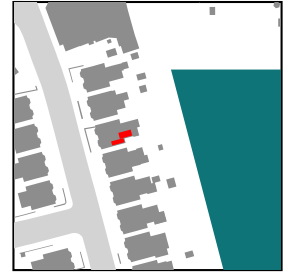





NSL CONTOURS



PROJECT: 14047 - CAMBRIDGE ROAD
REPORT TITLE: EXISTING VS. PROPOSED
ADDRESS: 21 PIPER ROAD
DATE: 02/10/2020
SCHEME IR: IR23 (07.09.2020)
DRAWING No.: 14047-RELO6-IS02-DD86

KEY:

-  GAIN
-  LOSS
-  MAINTAINED LIT AREA
-  1 METRE GRID

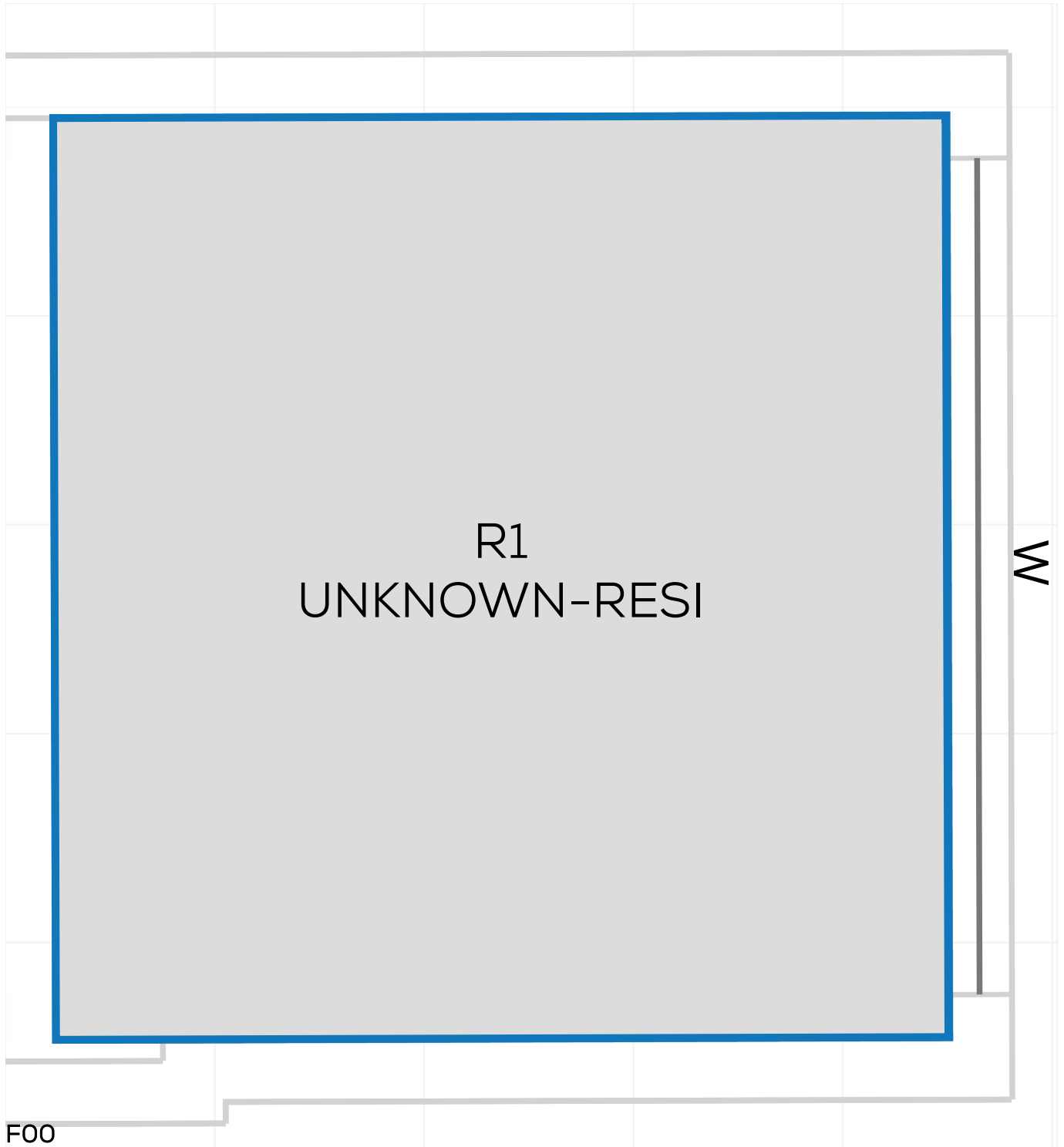
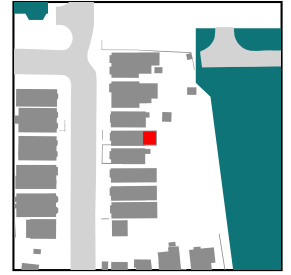





NSL CONTOURS



PROJECT: 14047 - CAMBRIDGE ROAD
REPORT TITLE: EXISTING VS. PROPOSED
ADDRESS: 21 PIPER ROAD
DATE: 02/10/2020
SCHEME IR: IR23 (07.09.2020)
DRAWING No.: 14047-RELO6-IS02-DD87

KEY:

-  GAIN
-  LOSS
-  MAINTAINED LIT AREA
-  1 METRE GRID

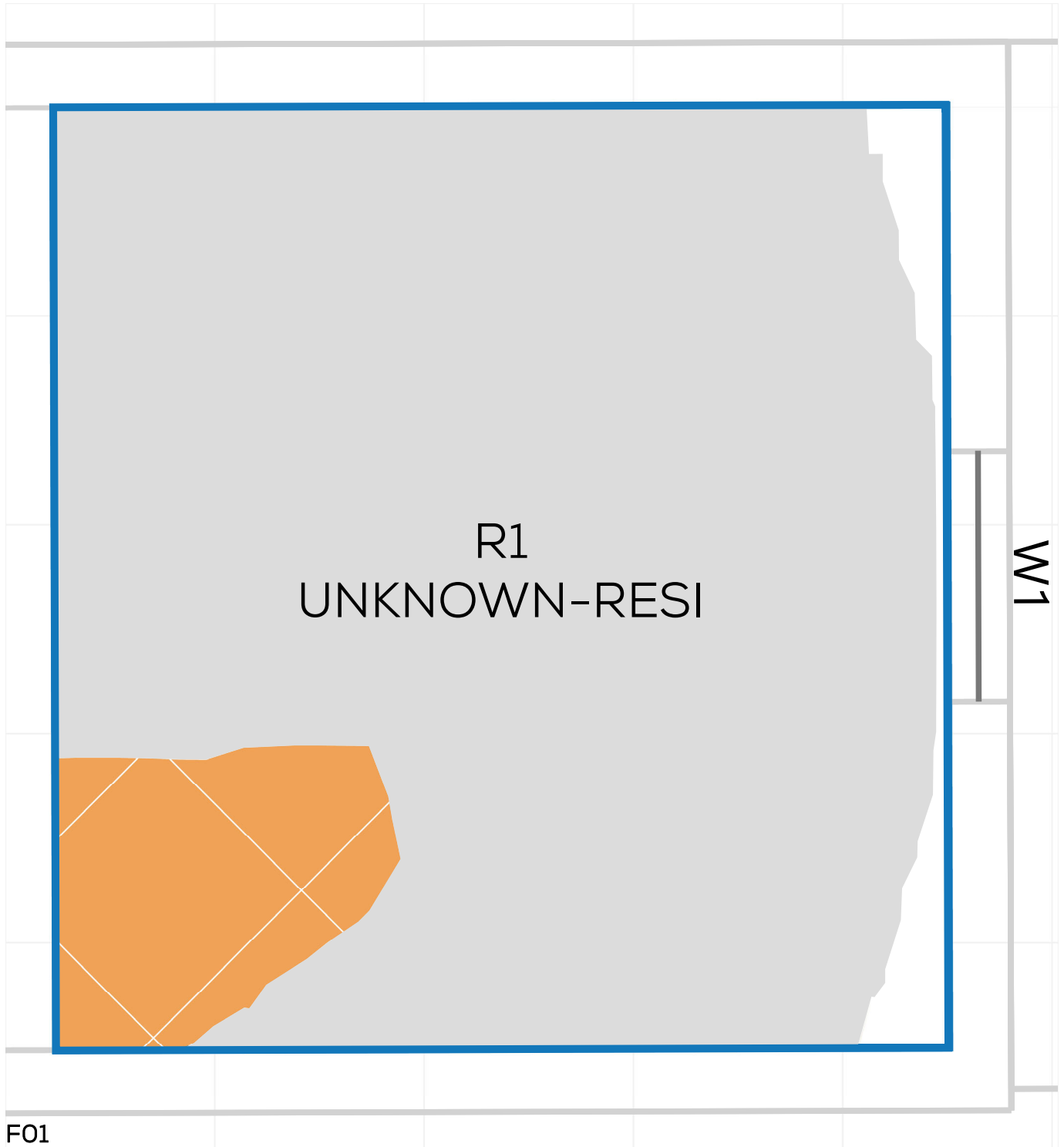

NSL CONTOURS



PROJECT: 14047 - CAMBRIDGE ROAD
REPORT TITLE: EXISTING VS. PROPOSED
ADDRESS: 19 PIPER ROAD
DATE: 02/10/2020
SCHEME IR: IR23 (07.09.2020)
DRAWING No.: 14047-RELO6-IS02-DD88

KEY:

- GAIN
- LOSS
- MAINTAINED LIT AREA
- 1 METRE GRID

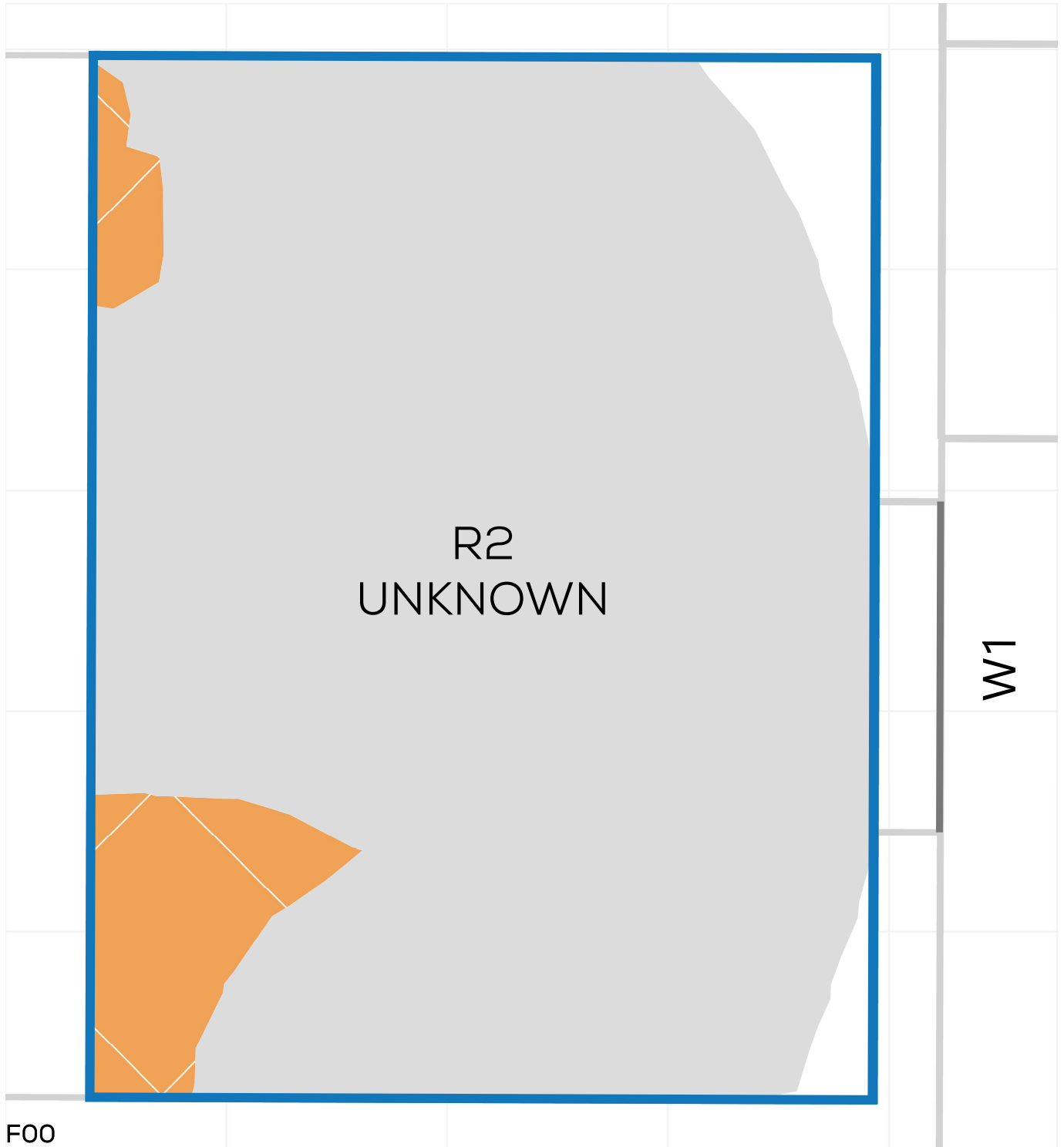
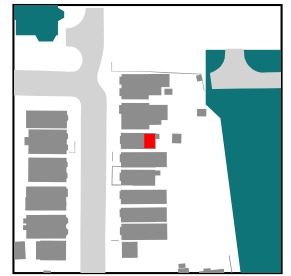

NSL CONTOURS



PROJECT: 14047 - CAMBRIDGE ROAD
REPORT TITLE: EXISTING VS. PROPOSED
ADDRESS: 19 PIPER ROAD
DATE: 02/10/2020
SCHEME IR: IR23 (07.09.2020)
DRAWING No.: 14047-RELO6-IS02-DD89

KEY:

- GAIN
- LOSS
- MAINTAINED LIT AREA
- 1 METRE GRID

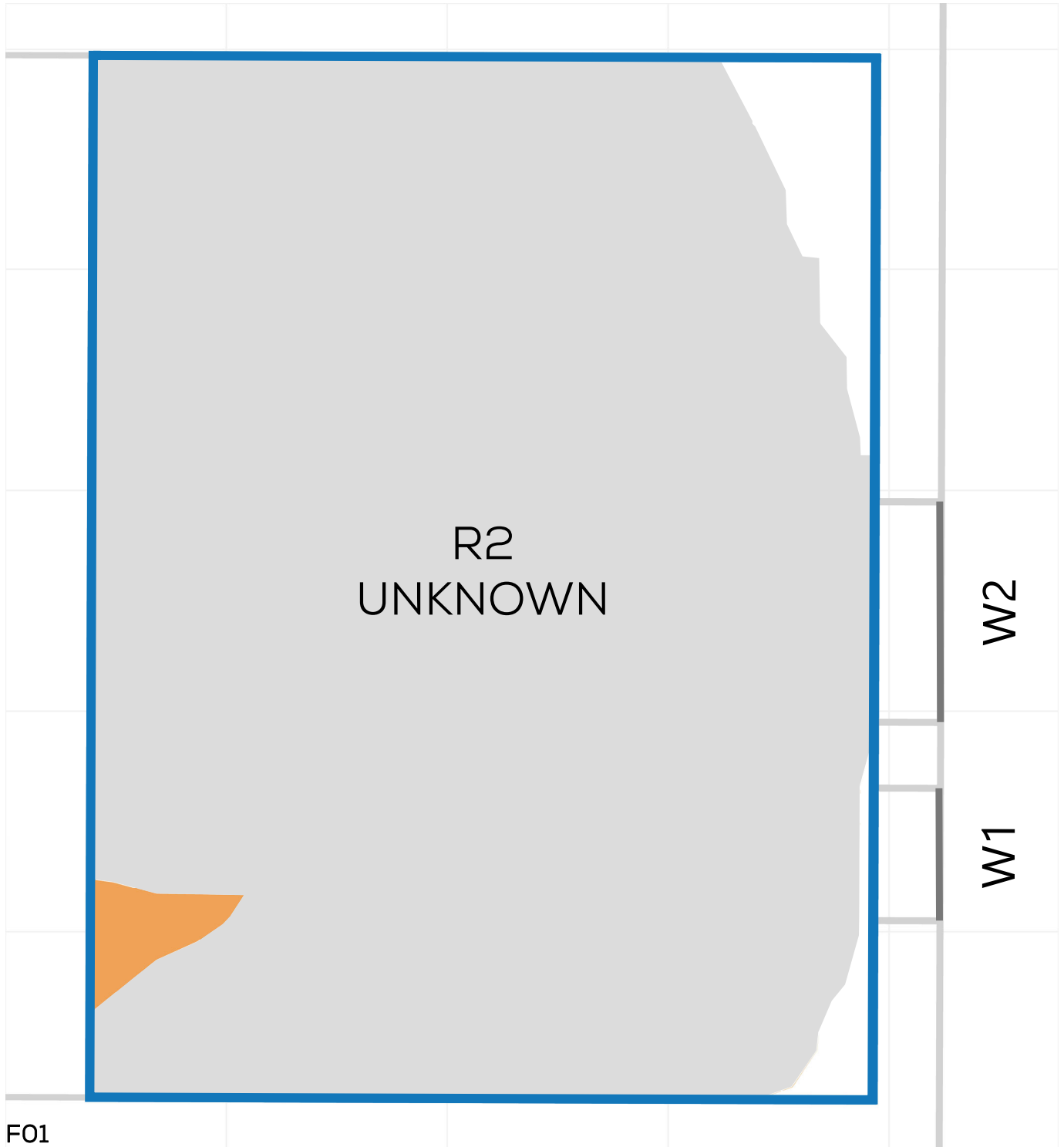
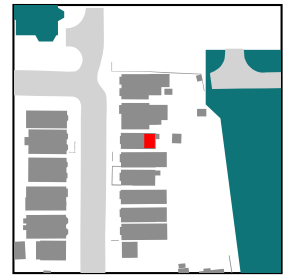





NSL CONTOURS



PROJECT: 14047 - CAMBRIDGE ROAD
REPORT TITLE: EXISTING VS. PROPOSED
ADDRESS: 37 CAMBRIDGE ROAD
DATE: 02/10/2020
SCHEME IR: IR23 (07.09.2020)
DRAWING No.: 14047-RELO6-IS02-DD90

KEY:

-  GAIN
-  LOSS
-  MAINTAINED LIT AREA
-  1 METRE GRID

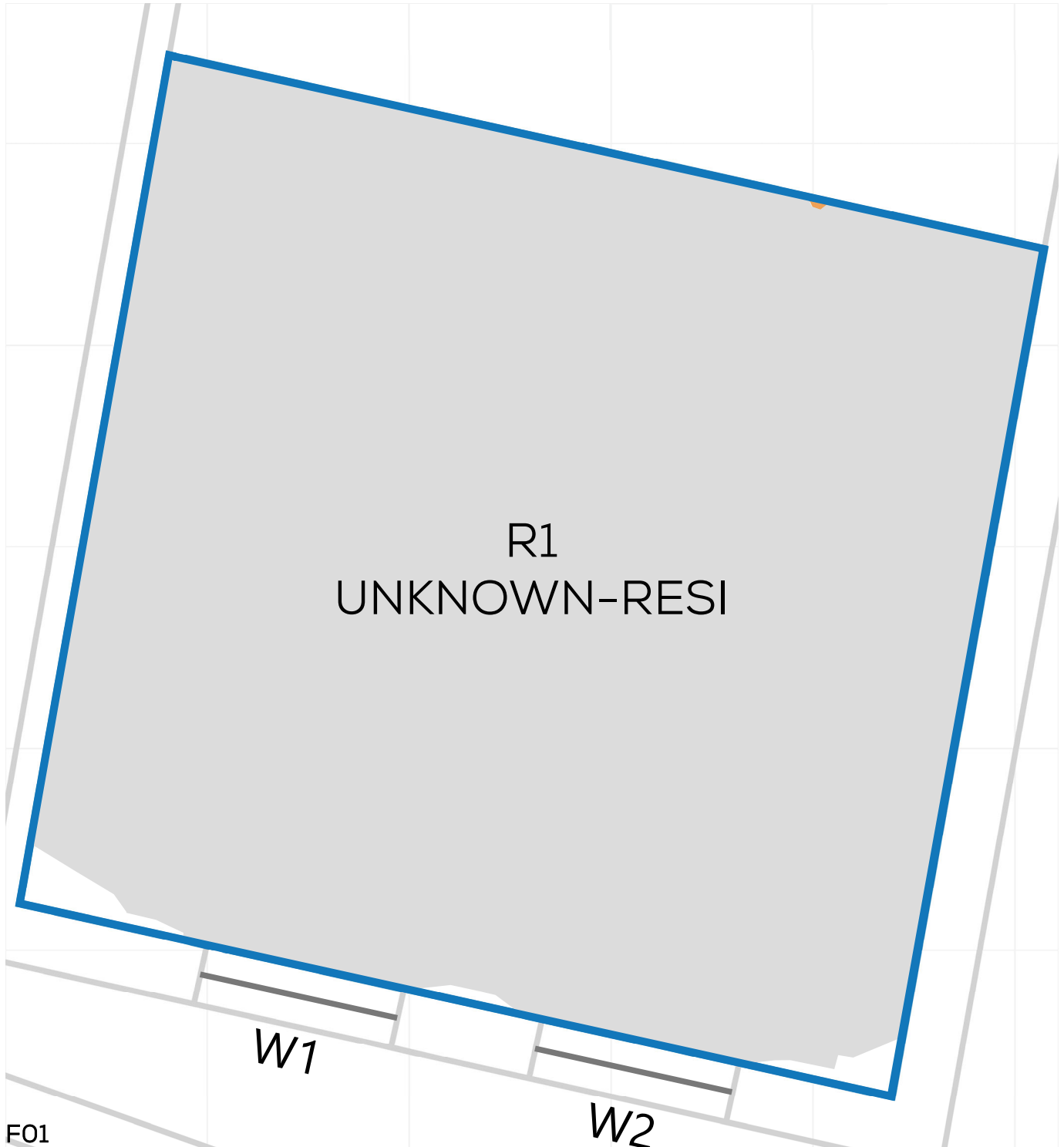

NSL CONTOURS



PROJECT: 14047 - CAMBRIDGE ROAD
REPORT TITLE: EXISTING VS. PROPOSED
ADDRESS: 35 CAMBRIDGE ROAD
DATE: 02/10/2020
SCHEME IR: IR23 (07.09.2020)
DRAWING No.: 14047-RELO6-IS02-DD91

KEY:

- GAIN
- LOSS
- MAINTAINED LIT AREA
- 1 METRE GRID

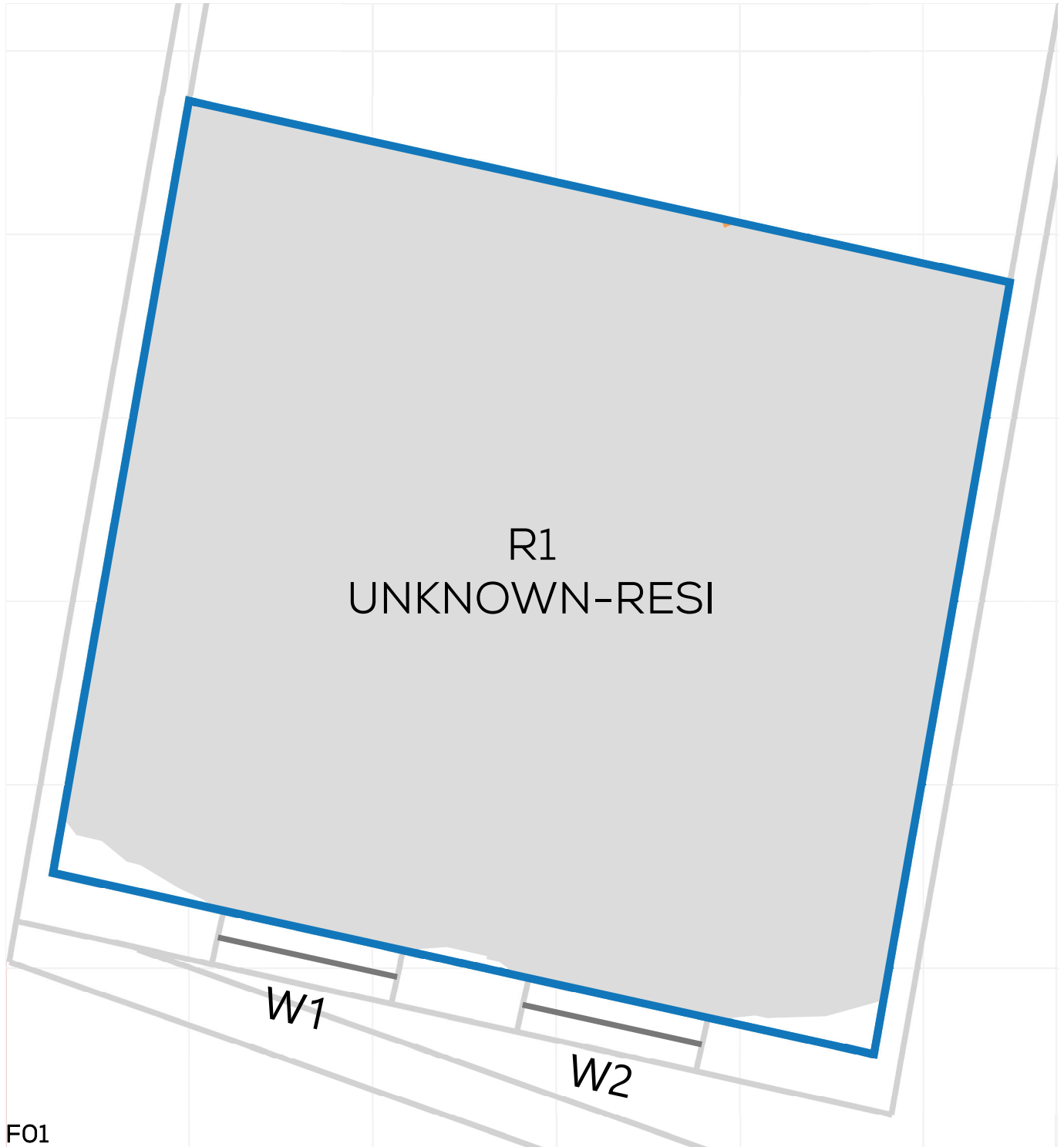

NSL CONTOURS



PROJECT: 14047 - CAMBRIDGE ROAD
REPORT TITLE: EXISTING VS. PROPOSED
ADDRESS: 61 CAMBRIDGE GROVE ROAD
DATE: 02/10/2020
SCHEME IR: IR23 (07.09.2020)
DRAWING No.: 14047-RELO6-IS02-DD92

KEY:

- GAIN
- LOSS
- MAINTAINED LIT AREA
- 1 METRE GRID

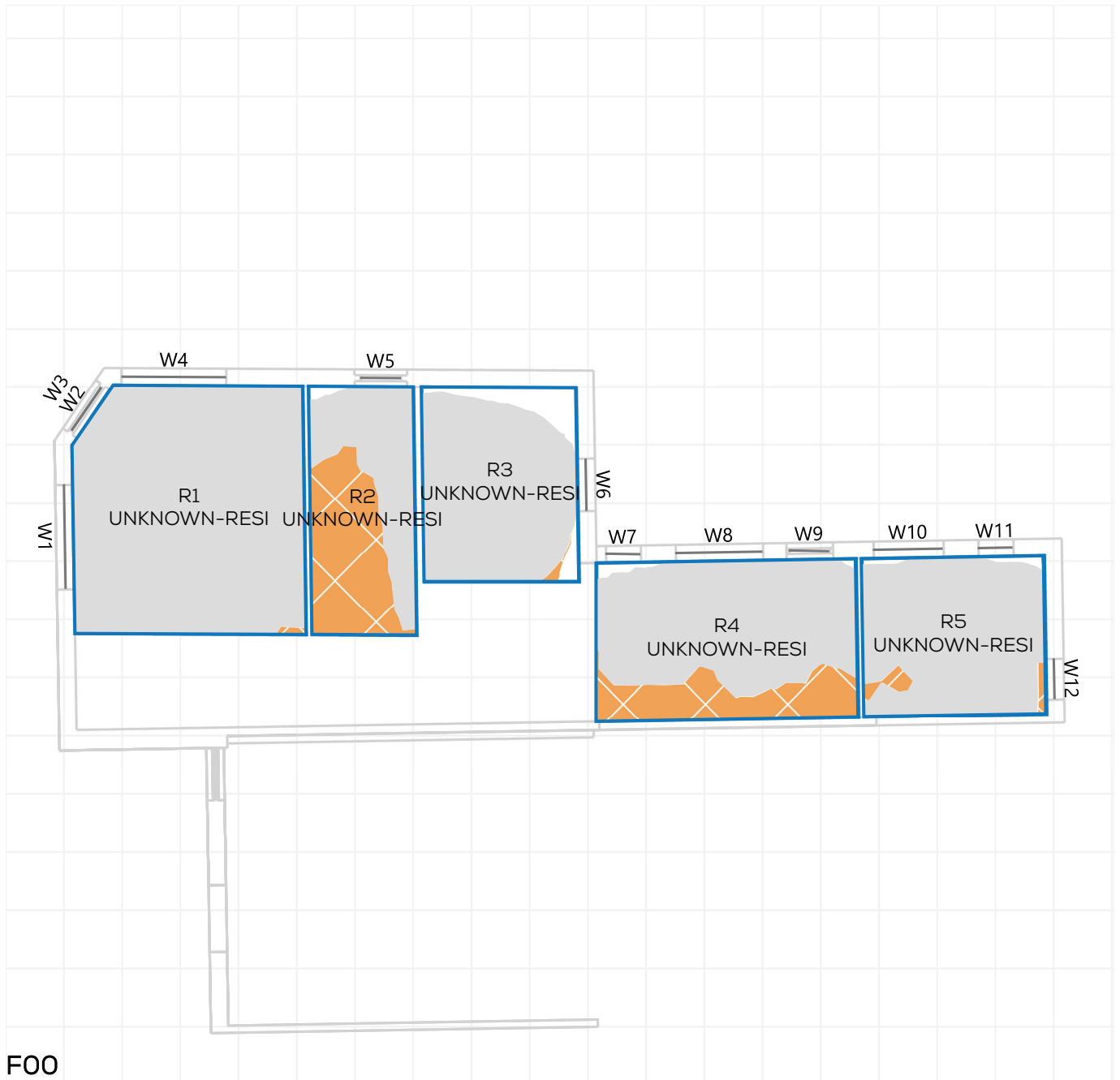

NSL CONTOURS



PROJECT: 14047 - CAMBRIDGE ROAD
REPORT TITLE: EXISTING VS. PROPOSED
ADDRESS: 61 CAMBRIDGE GROVE ROAD
DATE: 02/10/2020
SCHEME IR: IR23 (07.09.2020)
DRAWING No.: 14047-RELO6-IS02-DD93

KEY:

- GAIN
- LOSS
- MAINTAINED LIT AREA
- 1 METRE GRID

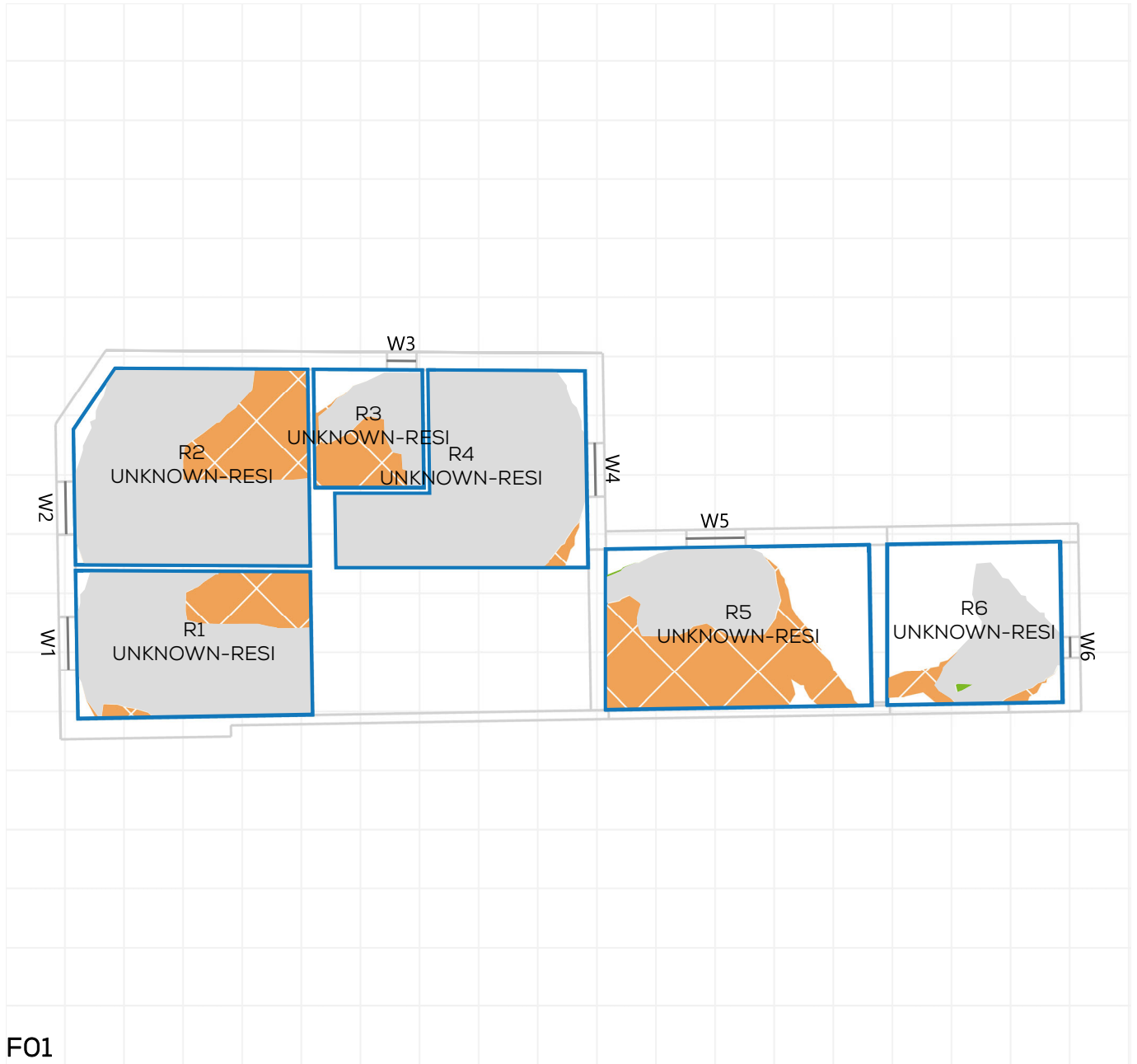

F01