

# NSL CONTOURS



PROJECT: 14047 - CAMBRIDGE ROAD  
REPORT TITLE: EXISTING VS. PROPOSED  
ADDRESS: 134 GLOUCESTER ROAD  
DATE: 02/10/2020  
SCHEME IR: IR23 (07.09.2020)  
DRAWING No.: 14047-RELO6-IS02-DD223



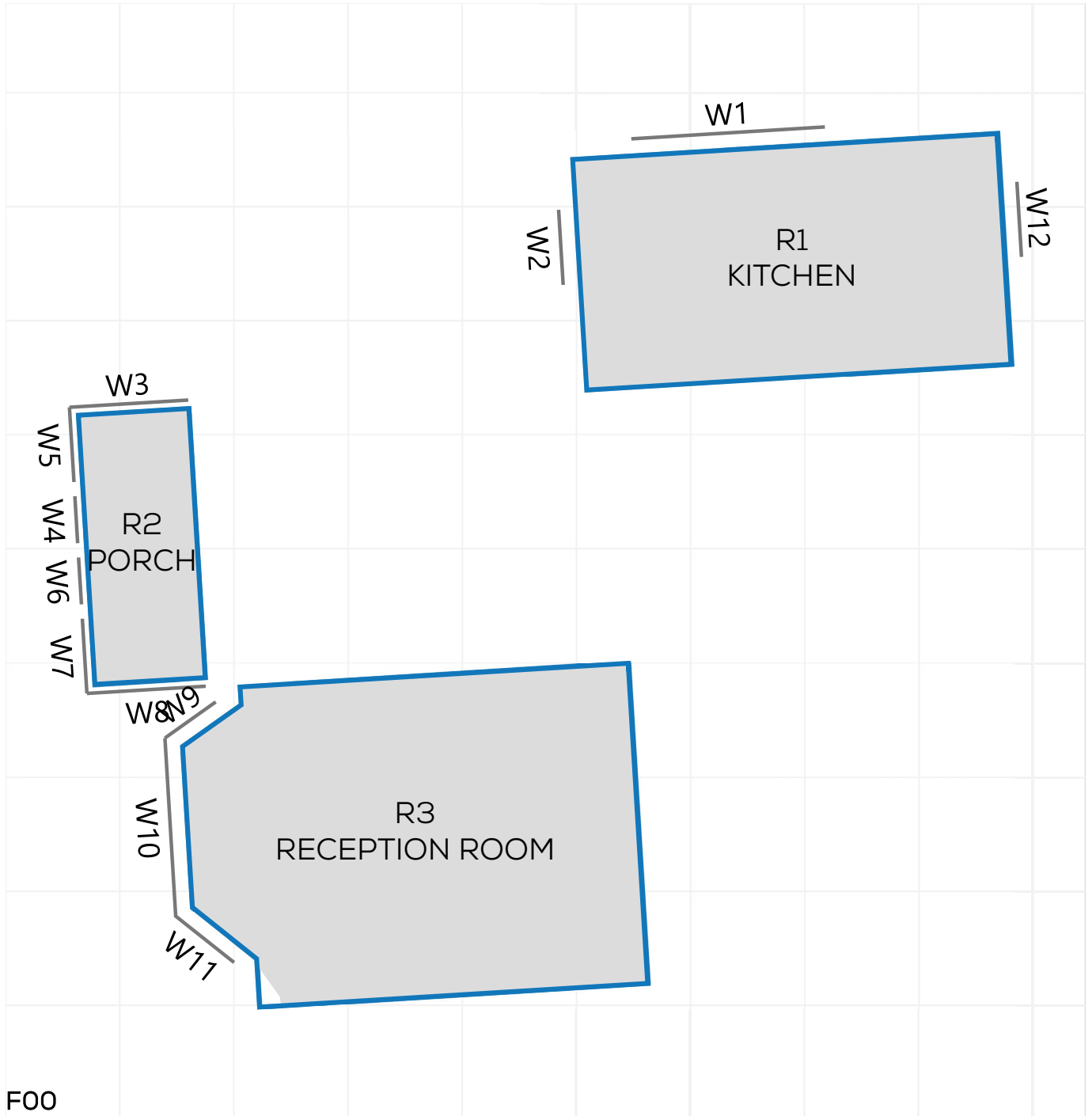

### KEY:

- GAIN
- LOSS
- MAINTAINED LIT AREA
- 1 METRE GRID



PROJECT: 14047 - CAMBRIDGE ROAD  
REPORT TITLE: EXISTING VS. PROPOSED  
ADDRESS: 134 GLOUCESTER ROAD  
DATE: 02/10/2020  
SCHEME IR: IR23 (07.09.2020)  
DRAWING No.: 14047-RELO6-IS02-DD224

KEY:

-  GAIN
-  LOSS
-  MAINTAINED LIT AREA
-  1 METRE GRID



# NSL CONTOURS



PROJECT: 14047 - CAMBRIDGE ROAD  
REPORT TITLE: EXISTING VS. PROPOSED  
ADDRESS: 59 CAMBRIDGE ROAD  
DATE: 02/10/2020  
SCHEME IR: IR23 (07.09.2020)  
DRAWING No.: 14047-RELO6-IS02-DD225

**KEY:**

- GAIN
- LOSS
- MAINTAINED LIT AREA
- 1 METRE GRID

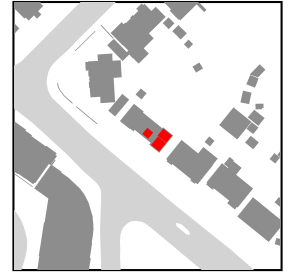

# NSL CONTOURS



PROJECT: 14047 - CAMBRIDGE ROAD  
REPORT TITLE: EXISTING VS. PROPOSED  
ADDRESS: 59 CAMBRIDGE ROAD  
DATE: 02/10/2020  
SCHEME IR: IR23 (07.09.2020)  
DRAWING No.: 14047-RELO6-IS02-DD226

**KEY:**

- GAIN
- LOSS
- MAINTAINED LIT AREA
- 1 METRE GRID

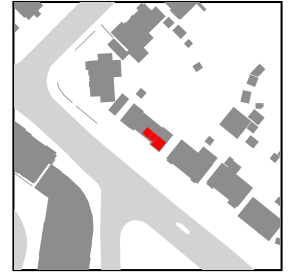

# NSL CONTOURS



PROJECT: 14047 - CAMBRIDGE ROAD  
REPORT TITLE: EXISTING VS. PROPOSED  
ADDRESS: 57 CAMBRIDGE ROAD  
DATE: 02/10/2020  
SCHEME IR: IR23 (07.09.2020)  
DRAWING No.: 14047-RELO6-IS02-DD227

**KEY:**

- GAIN
- LOSS
- MAINTAINED LIT AREA
- 1 METRE GRID

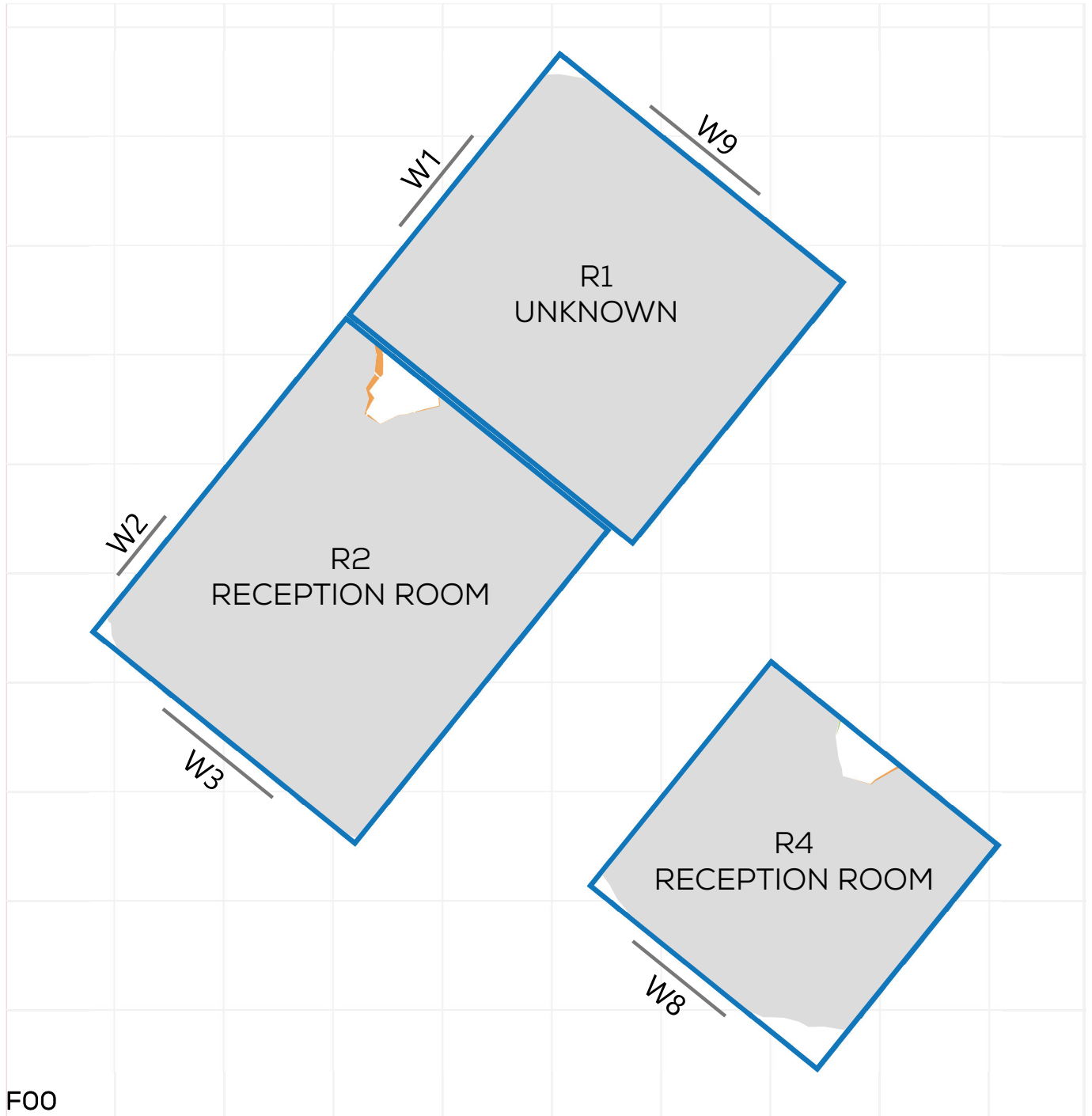
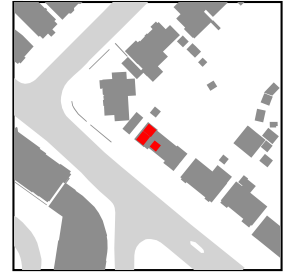

FOO

PROJECT: 14047 - CAMBRIDGE ROAD  
REPORT TITLE: EXISTING VS. PROPOSED  
ADDRESS: 57 CAMBRIDGE ROAD  
DATE: 02/10/2020  
SCHEME IR: IR23 (07.09.2020)  
DRAWING No.: 14047-RELO6-IS02-DD228

**KEY:**

- GAIN
- LOSS
- MAINTAINED LIT AREA
- 1 METRE GRID

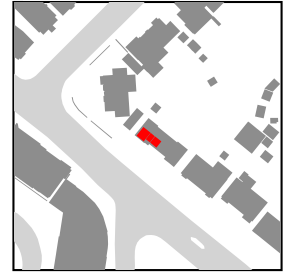

# NSL CONTOURS



PROJECT: 14047 - CAMBRIDGE ROAD  
REPORT TITLE: EXISTING VS. PROPOSED  
ADDRESS: 63 CAMBRIDGE ROAD  
DATE: 02/10/2020  
SCHEME IR: IR23 (07.09.2020)  
DRAWING No.: 14047-RELO6-IS02-DD229

## KEY:

- GAIN
- LOSS
- MAINTAINED LIT AREA
- 1 METRE GRID



# NSL CONTOURS



PROJECT: 14047 - CAMBRIDGE ROAD  
REPORT TITLE: EXISTING VS. PROPOSED  
ADDRESS: 63 CAMBRIDGE ROAD  
DATE: 02/10/2020  
SCHEME IR: IR23 (07.09.2020)  
DRAWING No.: 14047-RELO6-IS02-DD230

**KEY:**

- GAIN
- LOSS
- MAINTAINED LIT AREA
- 1 METRE GRID

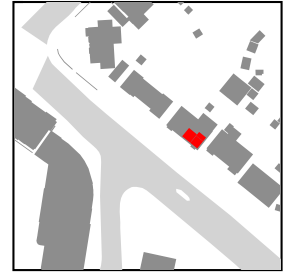

F01



# NSL CONTOURS



PROJECT: 14047 - CAMBRIDGE ROAD  
REPORT TITLE: EXISTING VS. PROPOSED  
ADDRESS: 61 CAMBRIDGE ROAD  
DATE: 02/10/2020  
SCHEME IR: IR23 (07.09.2020)  
DRAWING No.: 14047-RELO6-IS02-DD231

**KEY:**

- GAIN
- LOSS
- MAINTAINED LIT AREA
- 1 METRE GRID

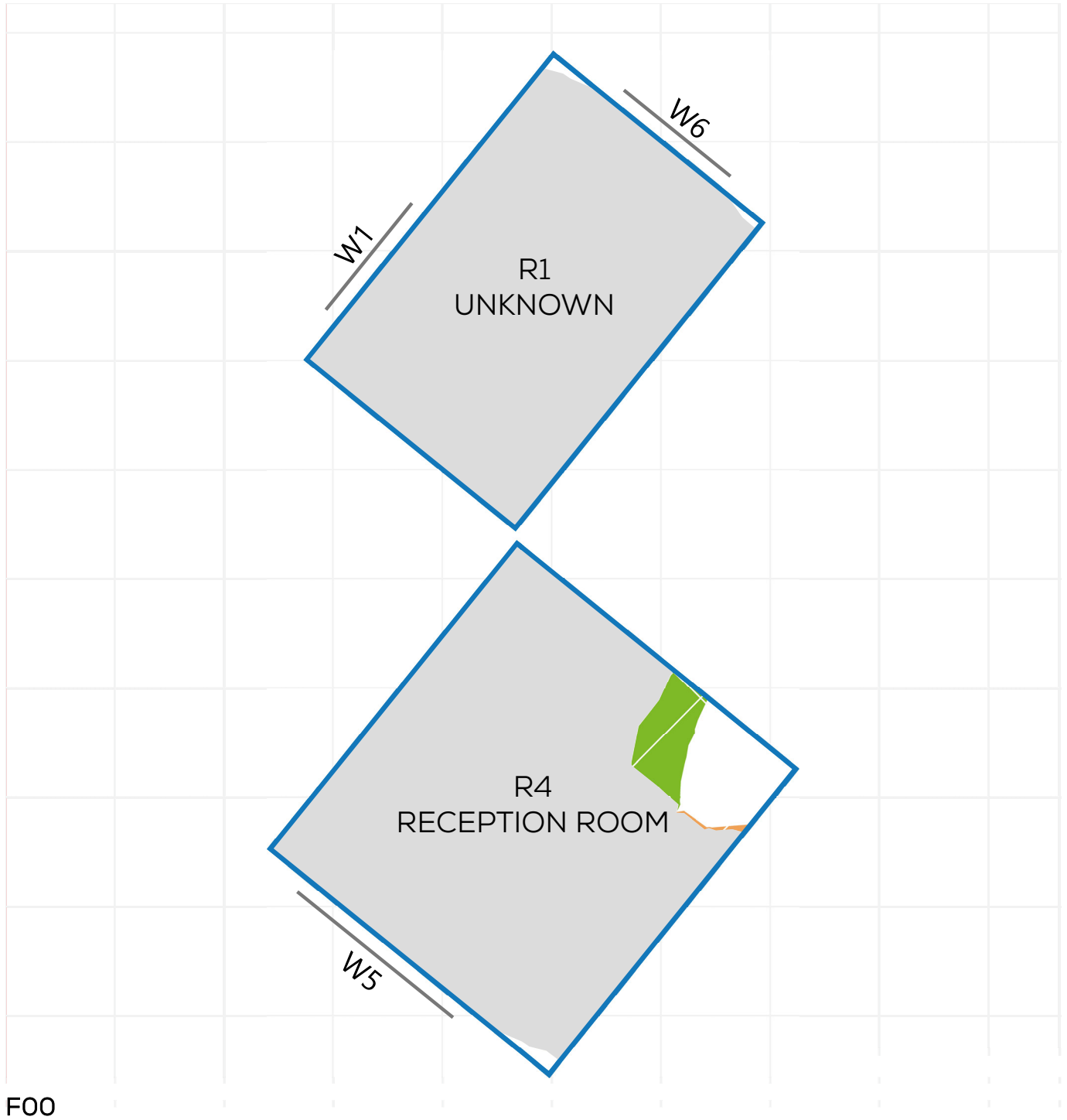
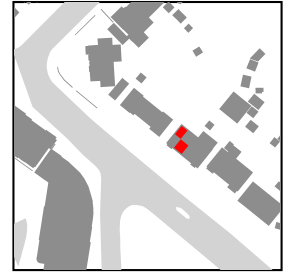

# NSL CONTOURS



PROJECT: 14047 - CAMBRIDGE ROAD  
REPORT TITLE: EXISTING VS. PROPOSED  
ADDRESS: 61 CAMBRIDGE ROAD  
DATE: 02/10/2020  
SCHEME IR: IR23 (07.09.2020)  
DRAWING No.: 14047-RELO6-IS02-DD232

## KEY:

- GAIN
- LOSS
- MAINTAINED LIT AREA
- 1 METRE GRID

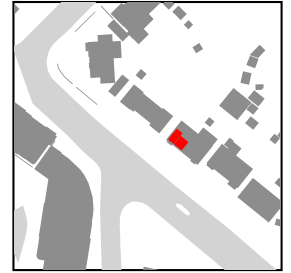

F01

PROJECT: 14047 - CAMBRIDGE ROAD  
REPORT TITLE: EXISTING VS. PROPOSED  
ADDRESS: 48 VINCENT ROAD  
DATE: 02/10/2020  
SCHEME IR: IR23 (07.09.2020)  
DRAWING No.: 14047-RELO6-IS02-DD233

**KEY:**

- GAIN
- LOSS
- MAINTAINED LIT AREA
- 1 METRE GRID

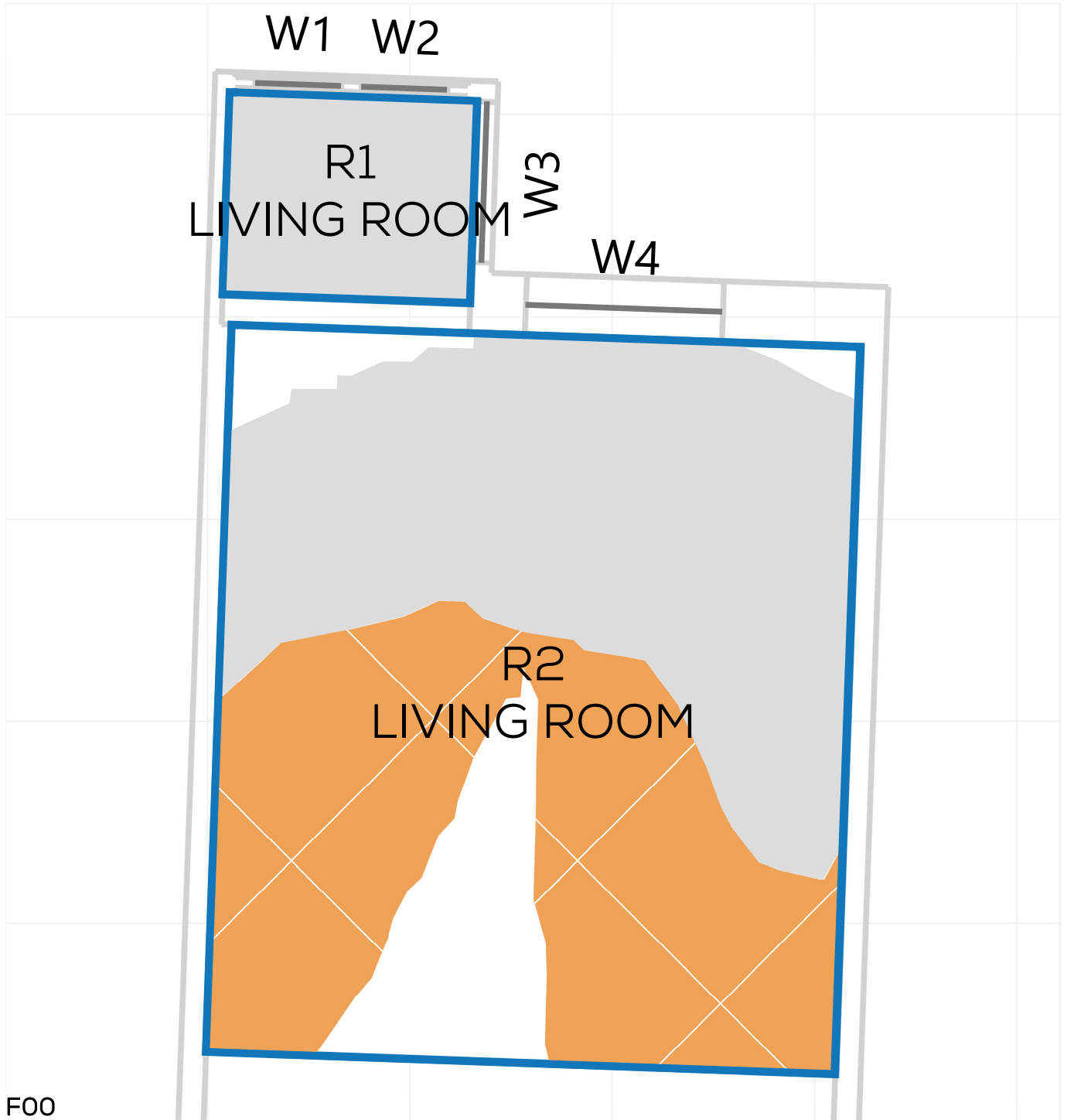

# NSL CONTOURS



PROJECT: 14047 - CAMBRIDGE ROAD  
REPORT TITLE: EXISTING VS. PROPOSED  
ADDRESS: 48 VINCENT ROAD  
DATE: 02/10/2020  
SCHEME IR: IR23 (07.09.2020)  
DRAWING No.: 14047-RELO6-IS02-DD234

**KEY:**

- GAIN
- LOSS
- MAINTAINED LIT AREA
- 1 METRE GRID

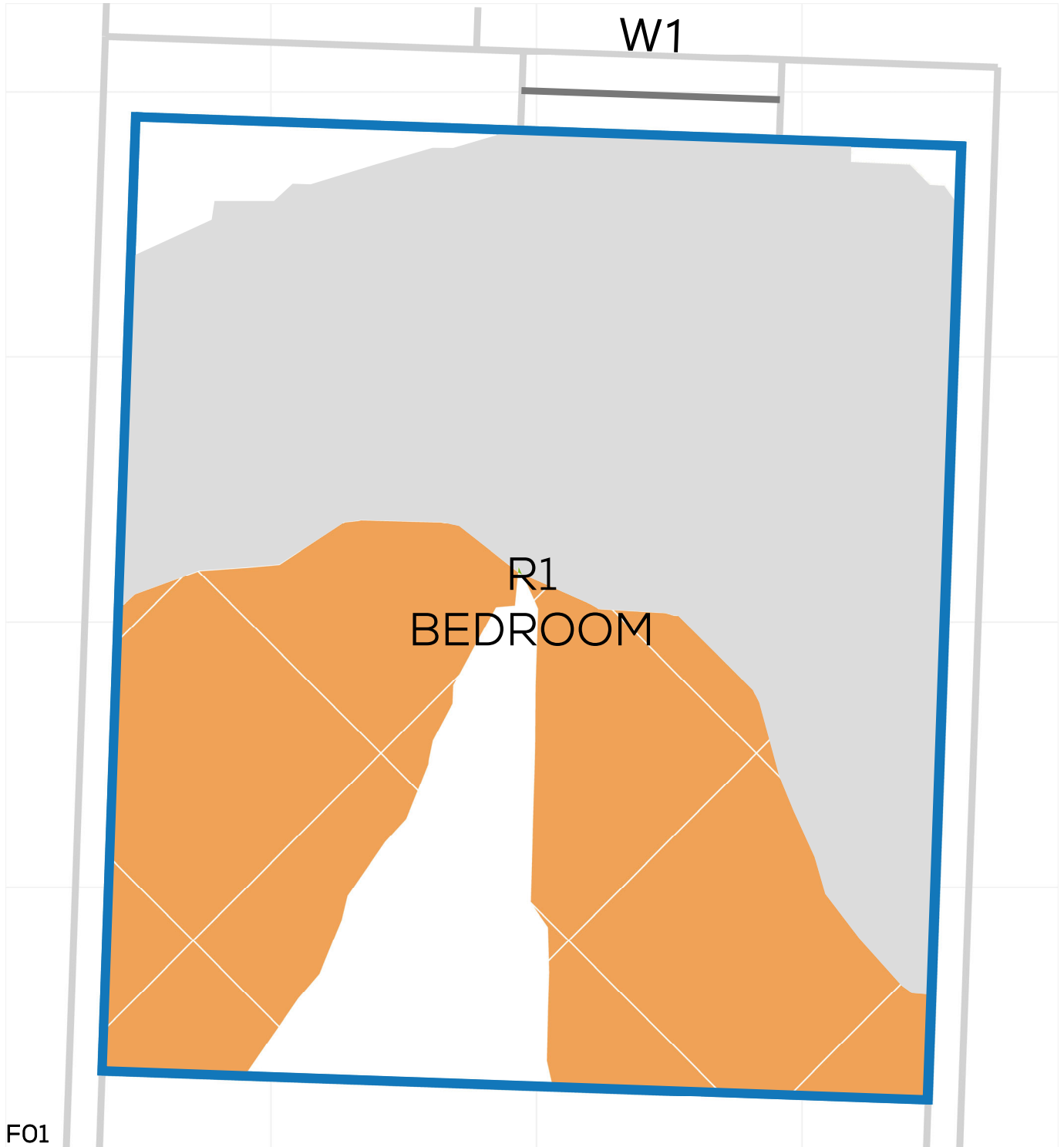
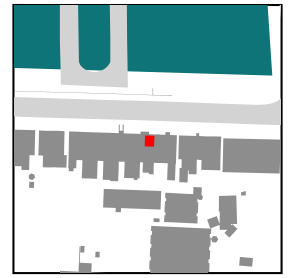

# NSL CONTOURS



PROJECT: 14047 - CAMBRIDGE ROAD  
REPORT TITLE: EXISTING VS. PROPOSED  
ADDRESS: 34 VINCENT ROAD  
DATE: 02/10/2020  
SCHEME IR: IR23 (07.09.2020)  
DRAWING No.: 14047-RELO6-IS02-DD235

## KEY:

- GAIN
- LOSS
- MAINTAINED LIT AREA
- 1 METRE GRID

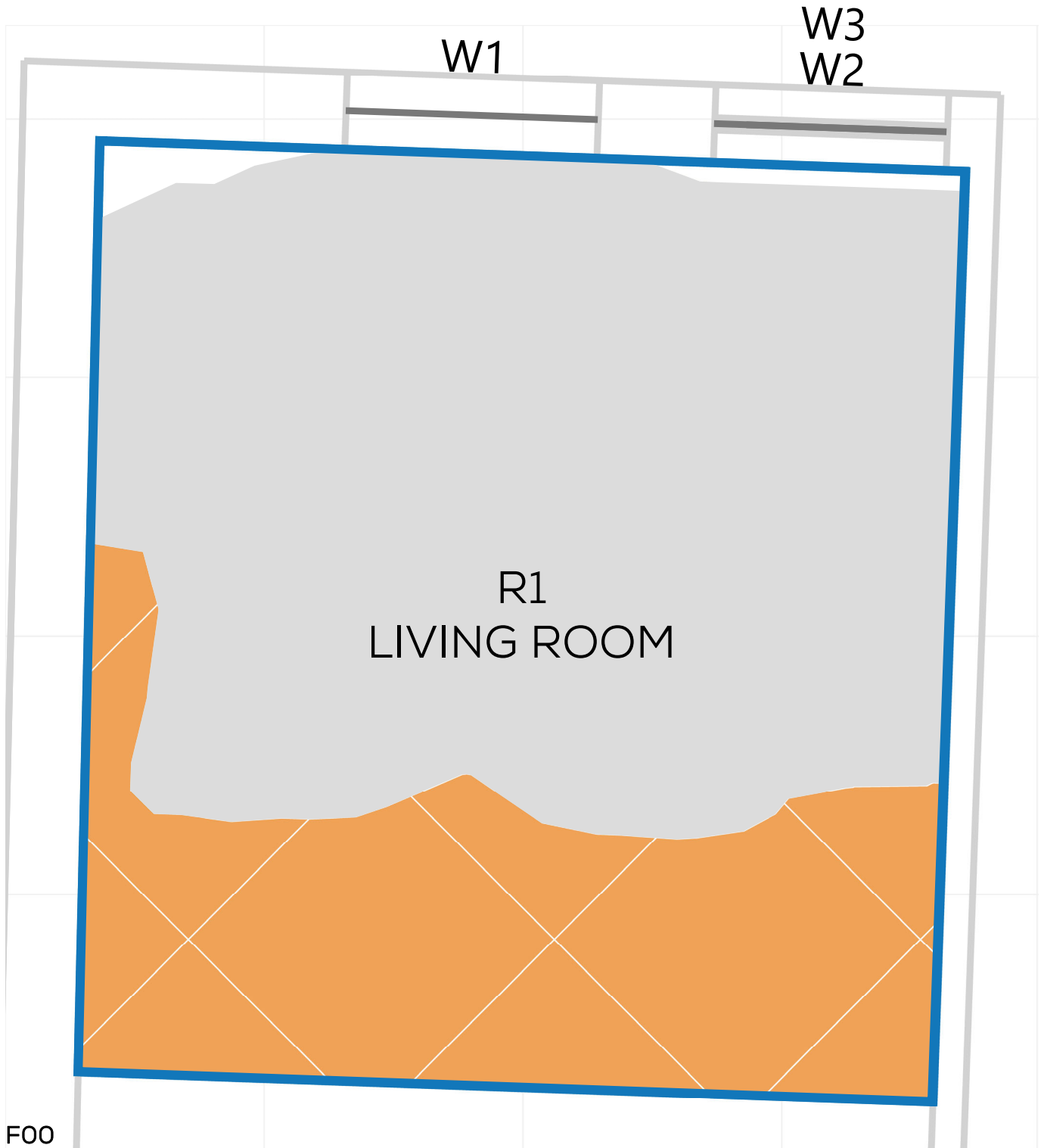

# NSL CONTOURS



PROJECT: 14047 - CAMBRIDGE ROAD  
REPORT TITLE: EXISTING VS. PROPOSED  
ADDRESS: 34 VINCENT ROAD  
DATE: 02/10/2020  
SCHEME IR: IR23 (07.09.2020)  
DRAWING No.: 14047-RELO6-IS02-DD236

## KEY:

- GAIN
- LOSS
- MAINTAINED LIT AREA
- 1 METRE GRID

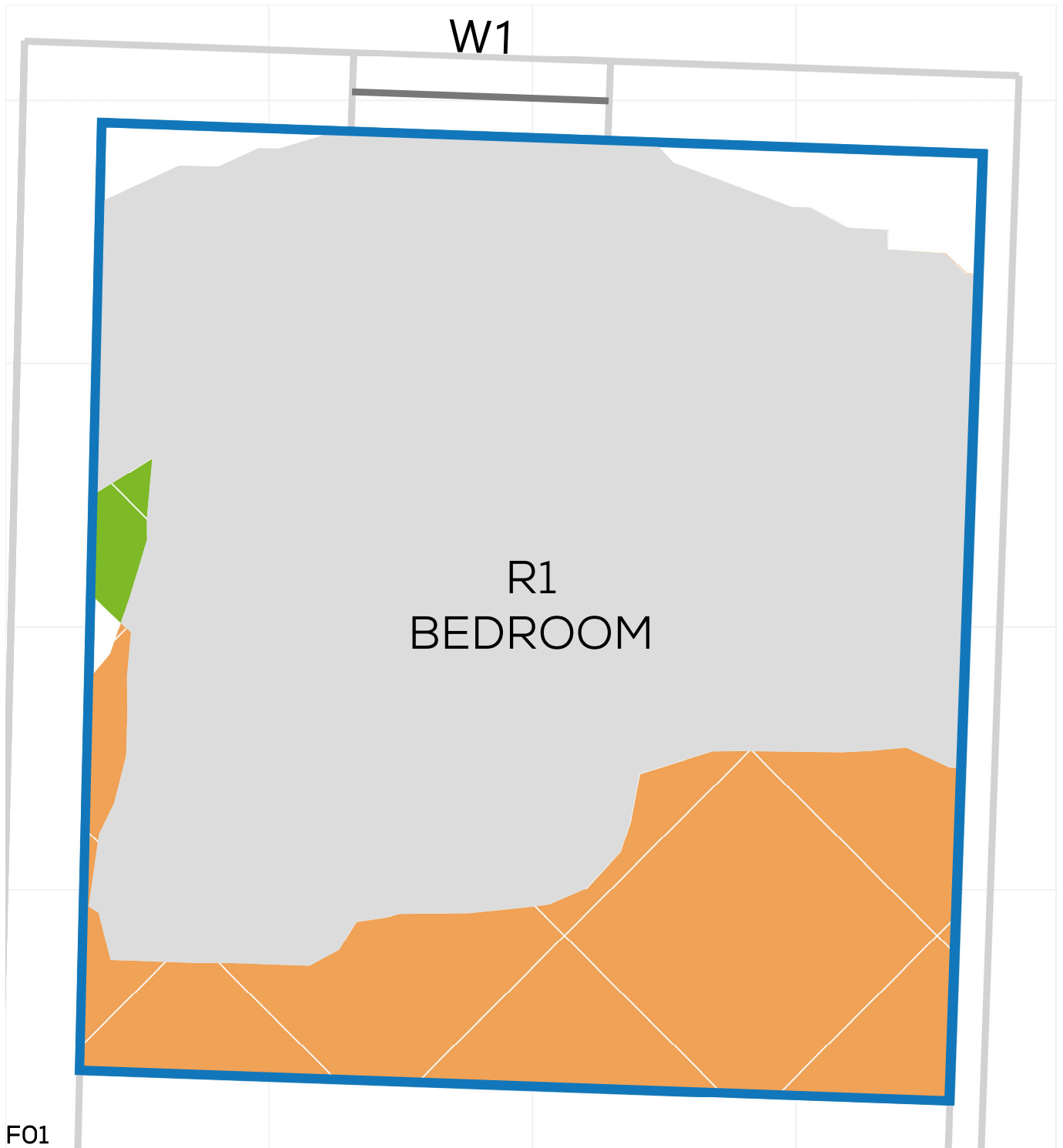

PROJECT: 14047 - CAMBRIDGE ROAD  
REPORT TITLE: EXISTING VS. PROPOSED  
ADDRESS: 52 VINCENT ROAD  
DATE: 02/10/2020  
SCHEME IR: IR23 (07.09.2020)  
DRAWING No.: 14047-RELO6-IS02-DD237

**KEY:**

- GAIN
- LOSS
- MAINTAINED LIT AREA
- 1 METRE GRID

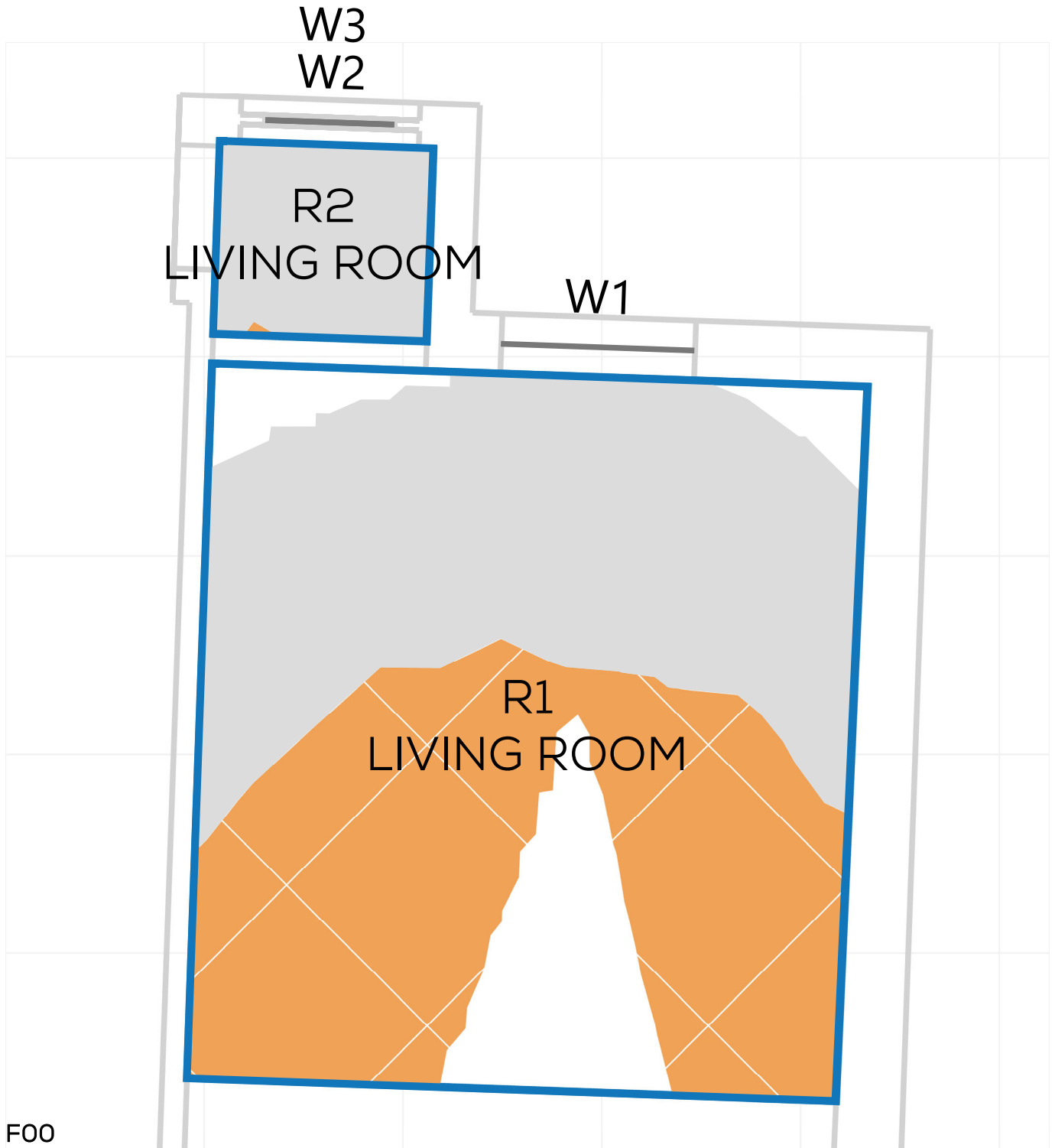
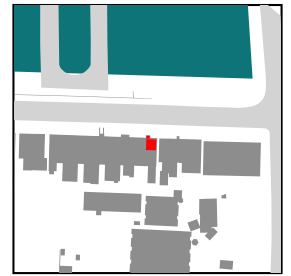

PROJECT: 14047 - CAMBRIDGE ROAD  
REPORT TITLE: EXISTING VS. PROPOSED  
ADDRESS: 52 VINCENT ROAD  
DATE: 02/10/2020  
SCHEME IR: IR23 (07.09.2020)  
DRAWING No.: 14047-RELO6-IS02-DD238

**KEY:**

- GAIN
- LOSS
- MAINTAINED LIT AREA
- 1 METRE GRID

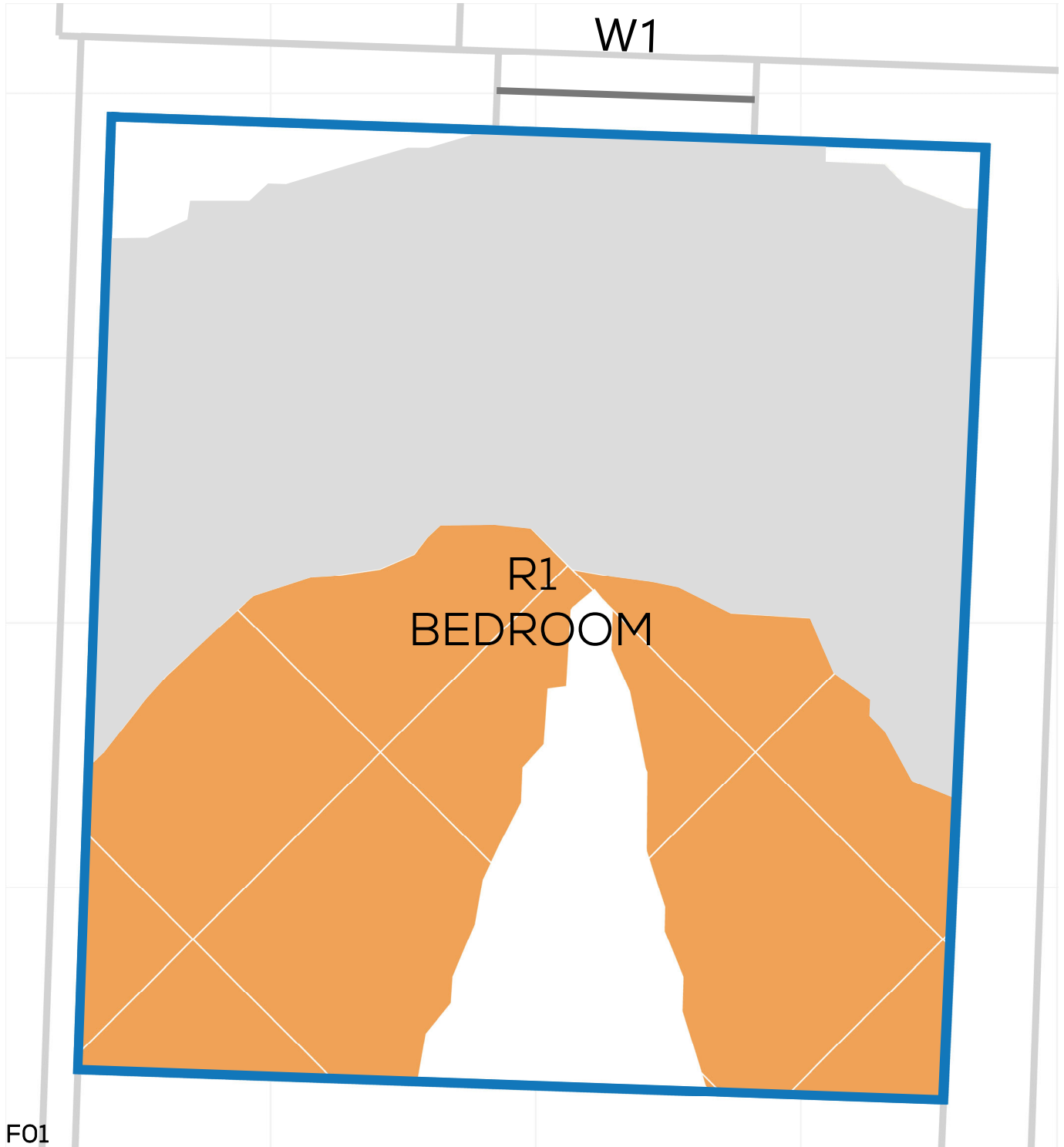



# NSL CONTOURS



PROJECT: 14047 - CAMBRIDGE ROAD  
REPORT TITLE: EXISTING VS. PROPOSED  
ADDRESS: 50 VINCENT ROAD  
DATE: 02/10/2020  
SCHEME IR: IR23 (07.09.2020)  
DRAWING No.: 14047-RELO6-IS02-DD239

### KEY:

- GAIN
- LOSS
- MAINTAINED LIT AREA
- 1 METRE GRID

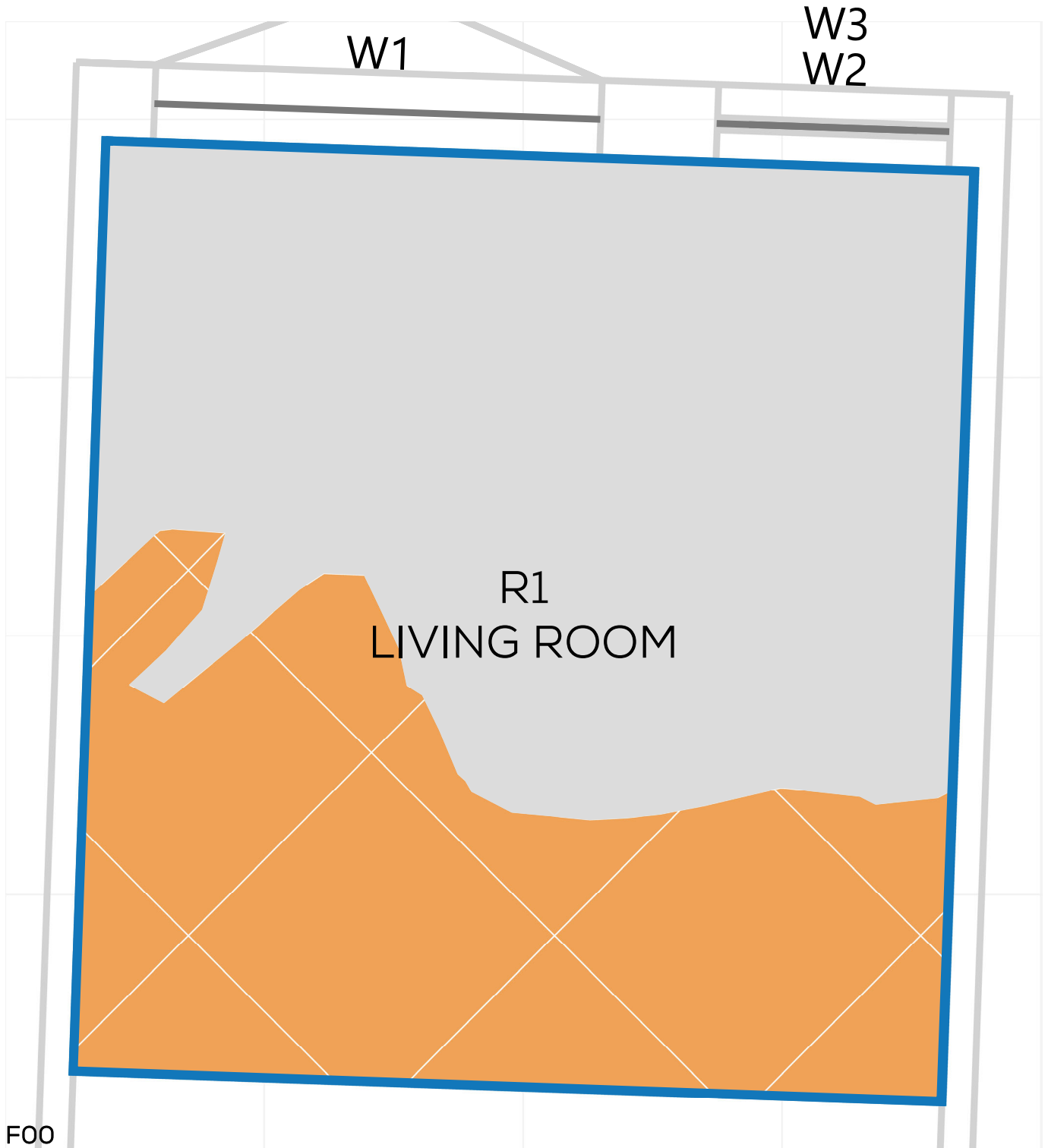
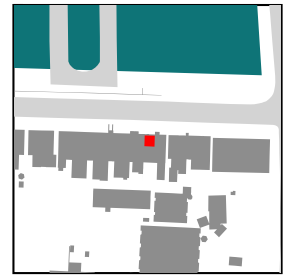

PROJECT: 14047 - CAMBRIDGE ROAD  
REPORT TITLE: EXISTING VS. PROPOSED  
ADDRESS: 50 VINCENT ROAD  
DATE: 02/10/2020  
SCHEME IR: IR23 (07.09.2020)  
DRAWING No.: 14047-RELO6-IS02-DD240

**KEY:**

- GAIN
- LOSS
- MAINTAINED LIT AREA
- 1 METRE GRID

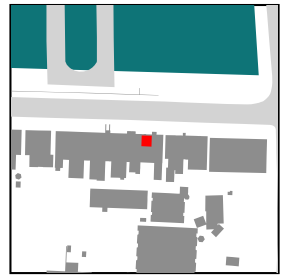

# NSL CONTOURS



PROJECT: 14047 - CAMBRIDGE ROAD  
REPORT TITLE: EXISTING VS. PROPOSED  
ADDRESS: 46 VINCENT ROAD  
DATE: 02/10/2020  
SCHEME IR: IR23 (07.09.2020)  
DRAWING No.: 14047-RELO6-IS02-DD241

### KEY:

- GAIN
- LOSS
- MAINTAINED LIT AREA
- 1 METRE GRID

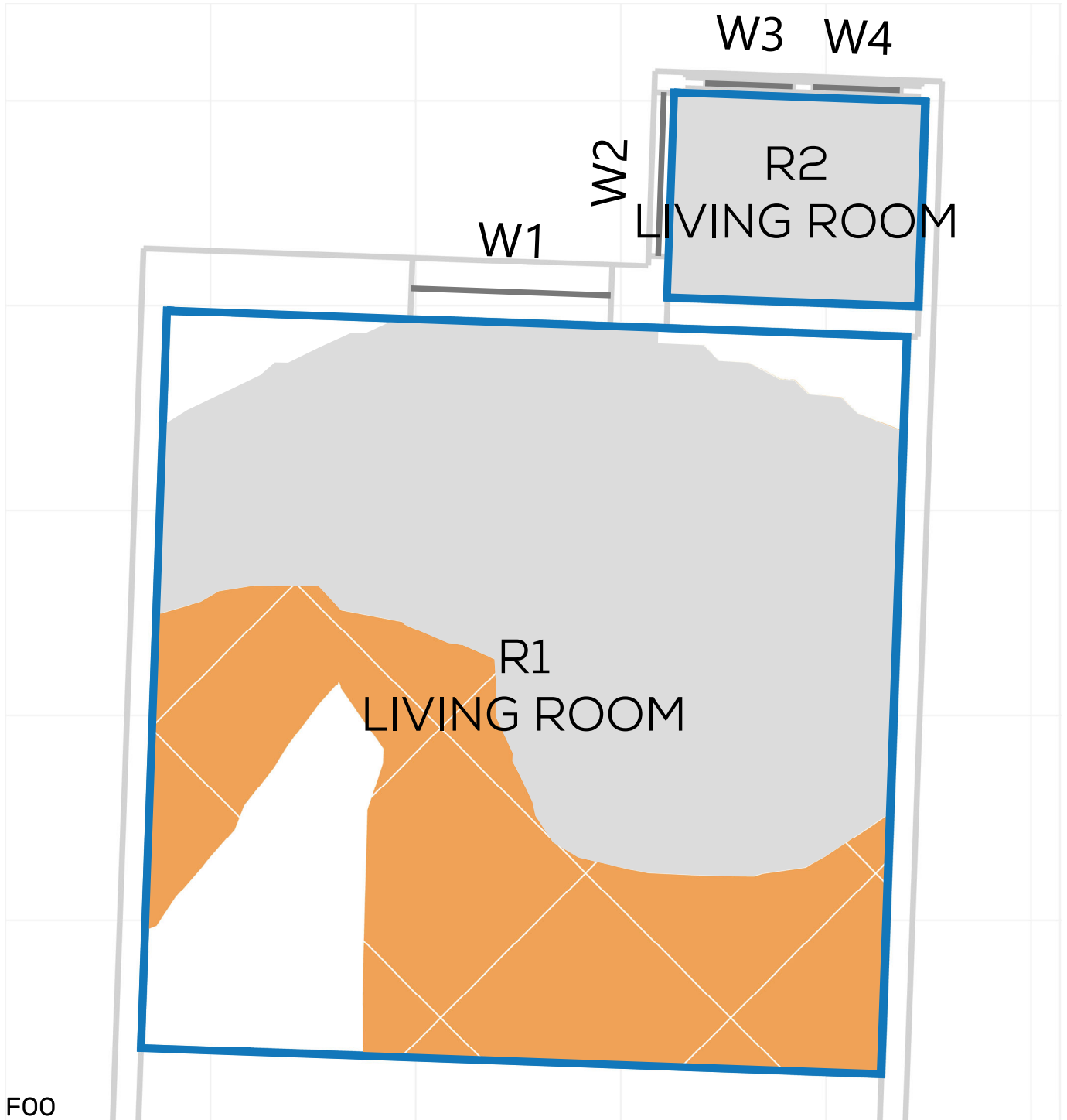
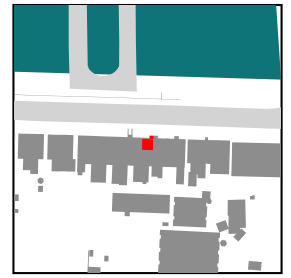

# NSL CONTOURS



PROJECT: 14047 - CAMBRIDGE ROAD  
REPORT TITLE: EXISTING VS. PROPOSED  
ADDRESS: 46 VINCENT ROAD  
DATE: 02/10/2020  
SCHEME IR: IR23 (07.09.2020)  
DRAWING No.: 14047-RELO6-IS02-DD242

## KEY:

- GAIN
- LOSS
- MAINTAINED LIT AREA
- 1 METRE GRID

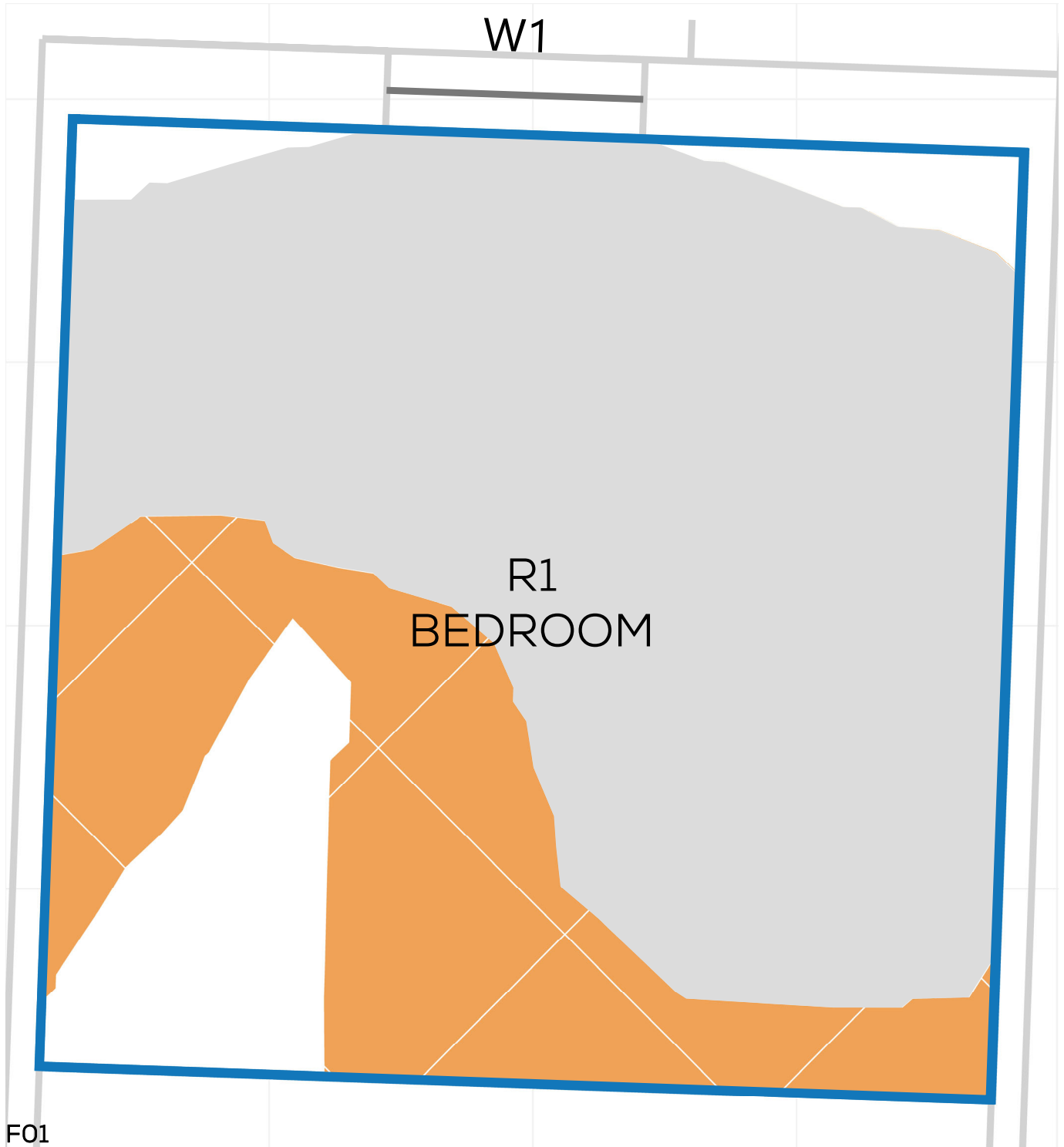
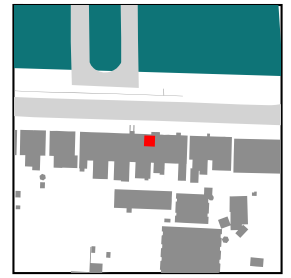

# NSL CONTOURS



PROJECT: 14047 - CAMBRIDGE ROAD  
REPORT TITLE: EXISTING VS. PROPOSED  
ADDRESS: 44 VINCENT ROAD  
DATE: 02/10/2020  
SCHEME IR: IR23 (07.09.2020)  
DRAWING No.: 14047-RELO6-IS02-DD243

## KEY:

- GAIN
- LOSS
- MAINTAINED LIT AREA
- 1 METRE GRID

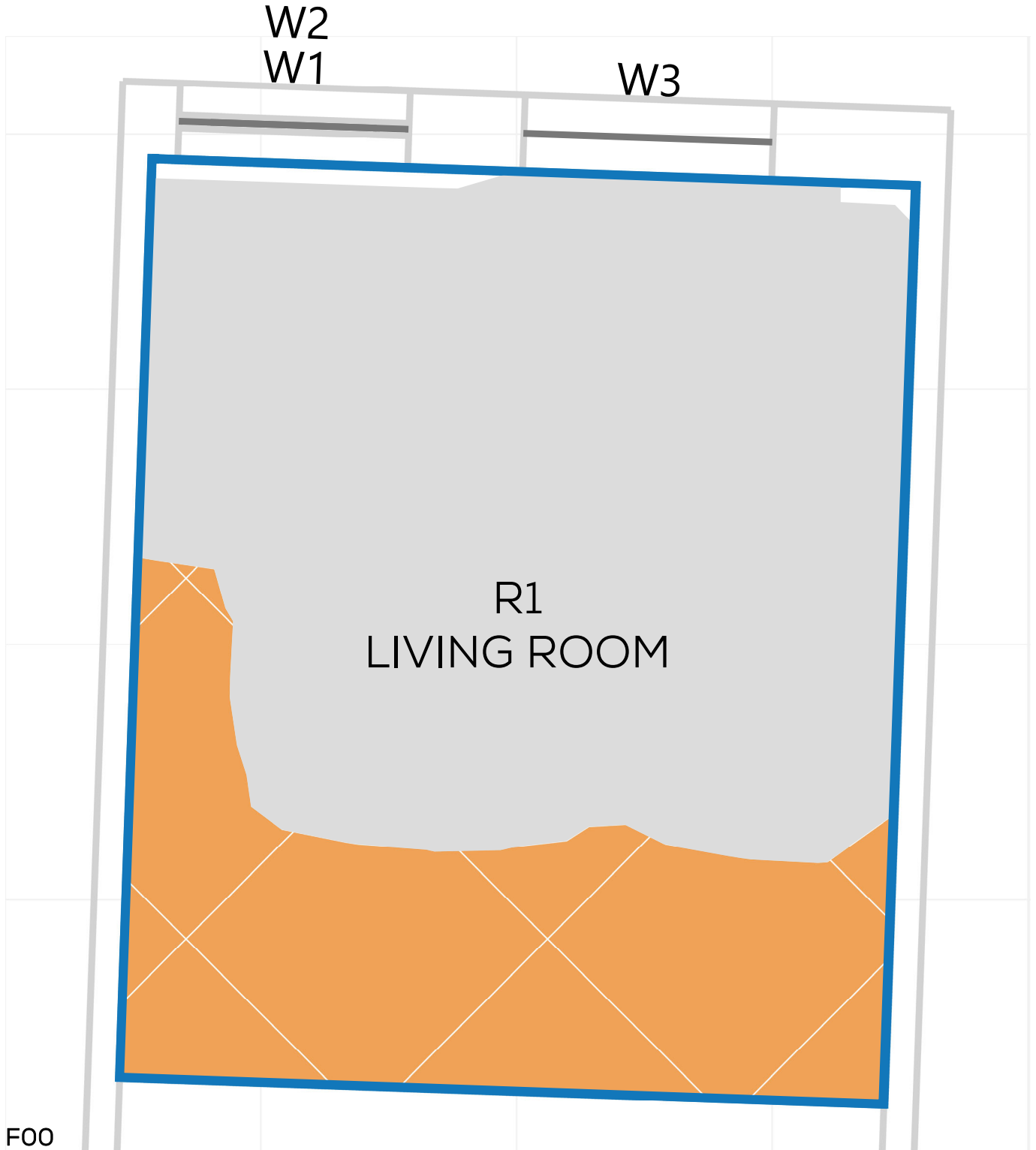
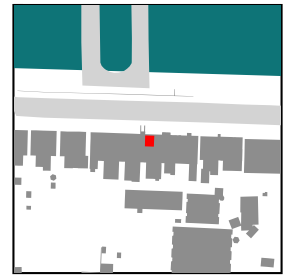

# NSL CONTOURS



PROJECT: 14047 - CAMBRIDGE ROAD  
REPORT TITLE: EXISTING VS. PROPOSED  
ADDRESS: 44 VINCENT ROAD  
DATE: 02/10/2020  
SCHEME IR: IR23 (07.09.2020)  
DRAWING No.: 14047-RELO6-IS02-DD244

### KEY:

- GAIN
- LOSS
- MAINTAINED LIT AREA
- 1 METRE GRID

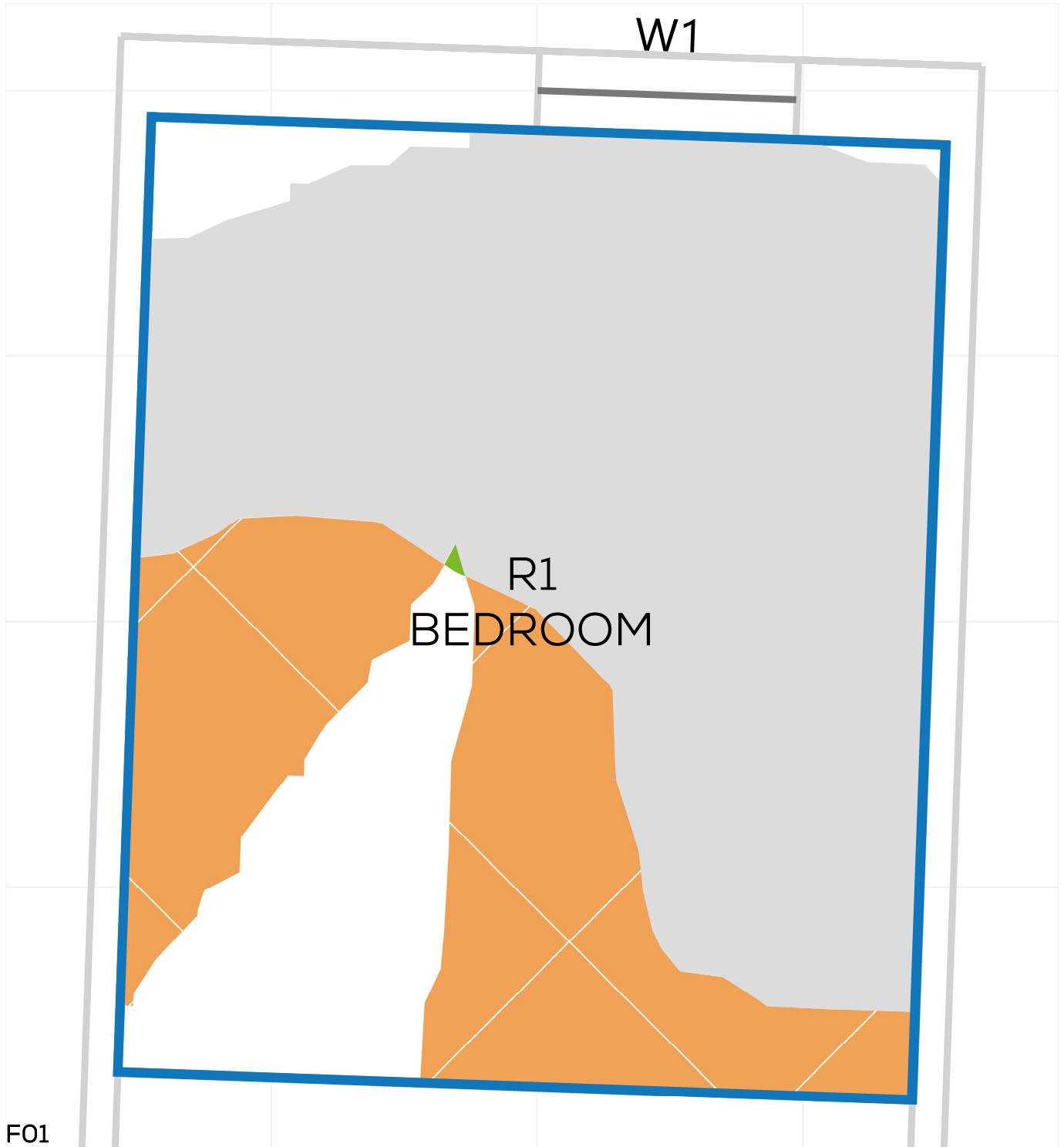
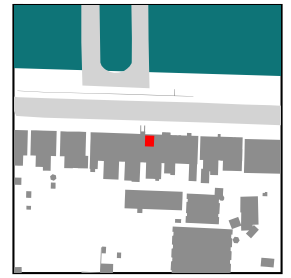

PROJECT: 14047 - CAMBRIDGE ROAD  
REPORT TITLE: EXISTING VS. PROPOSED  
ADDRESS: 42 VINCENT ROAD  
DATE: 02/10/2020  
SCHEME IR: IR23 (07.09.2020)  
DRAWING No.: 14047-RELO6-IS02-DD245

**KEY:**

- GAIN
- LOSS
- MAINTAINED LIT AREA
- 1 METRE GRID

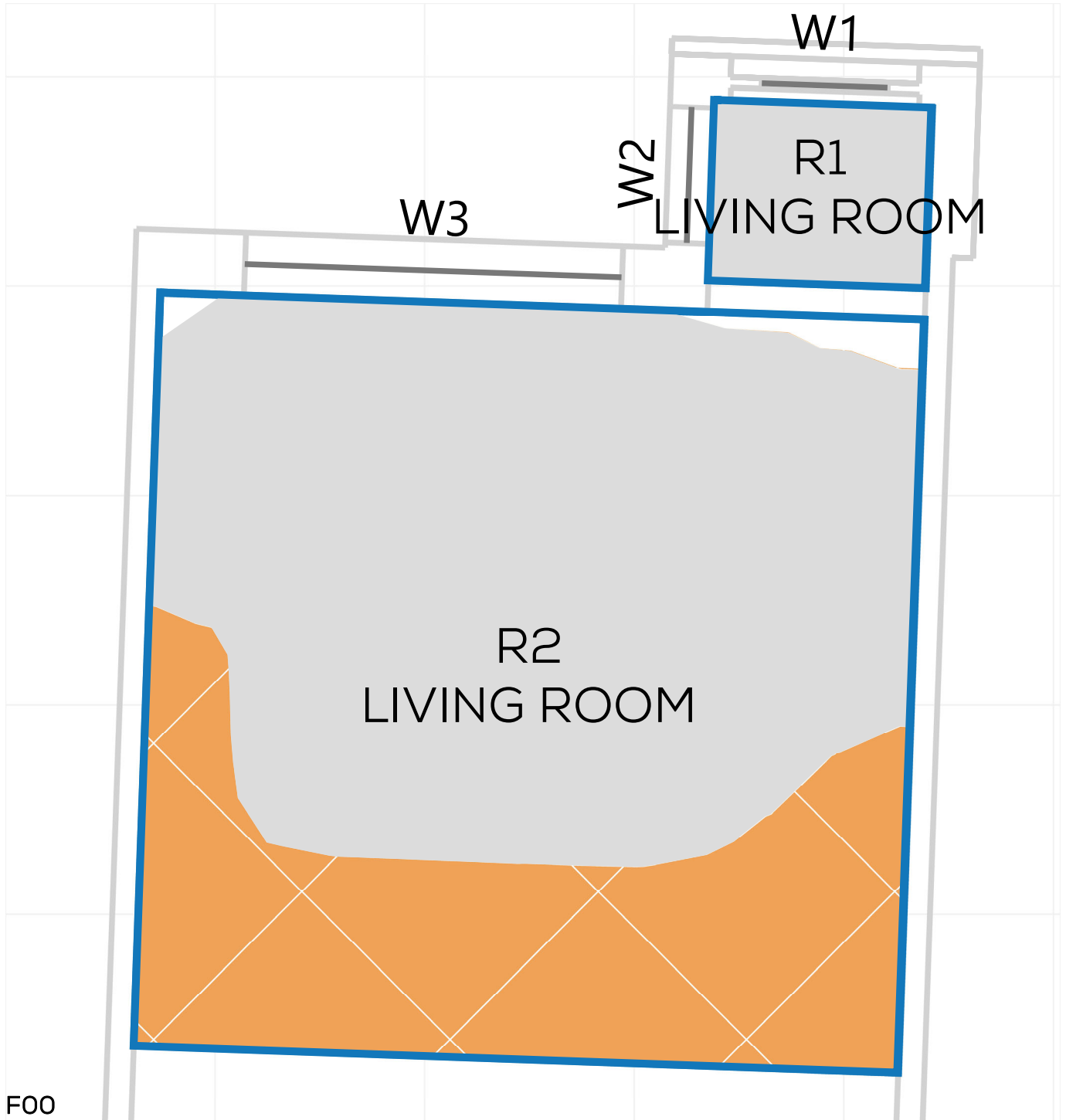
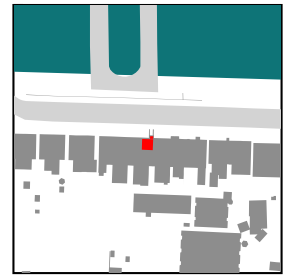

# NSL CONTOURS



PROJECT: 14047 - CAMBRIDGE ROAD  
REPORT TITLE: EXISTING VS. PROPOSED  
ADDRESS: 42 VINCENT ROAD  
DATE: 02/10/2020  
SCHEME IR: IR23 (07.09.2020)  
DRAWING No.: 14047-RELO6-IS02-DD246

**KEY:**

- GAIN
- LOSS
- MAINTAINED LIT AREA
- 1 METRE GRID

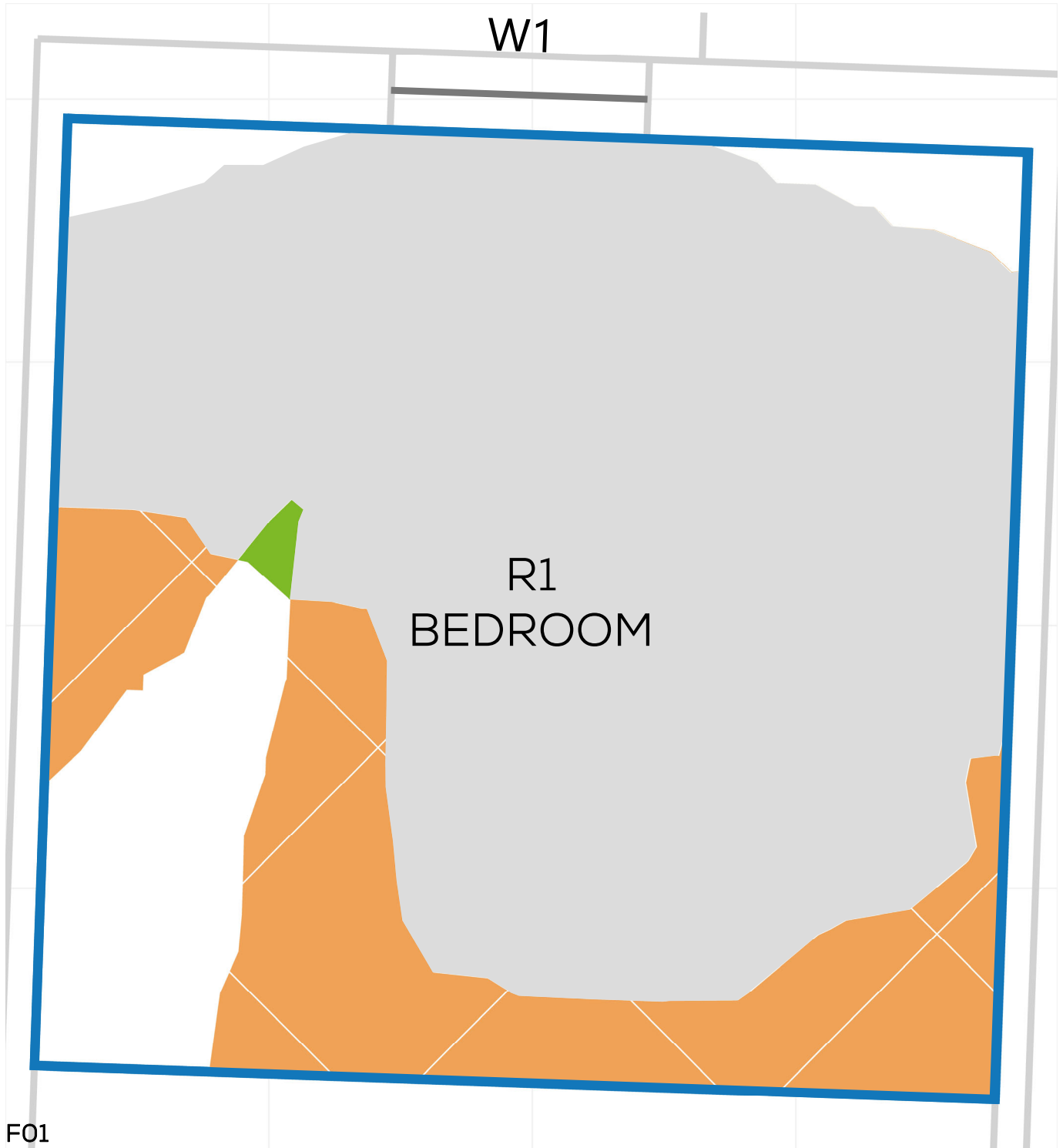
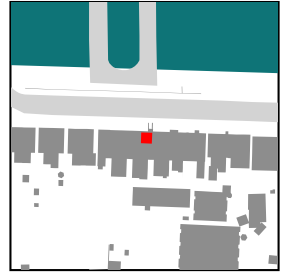



PROJECT: 14047 - CAMBRIDGE ROAD  
REPORT TITLE: EXISTING VS. PROPOSED  
ADDRESS: 40 VINCENT ROAD  
DATE: 02/10/2020  
SCHEME IR: IR23 (07.09.2020)  
DRAWING No.: 14047-RELO6-IS02-DD247

KEY:

- GAIN
- LOSS
- MAINTAINED LIT AREA
- 1 METRE GRID

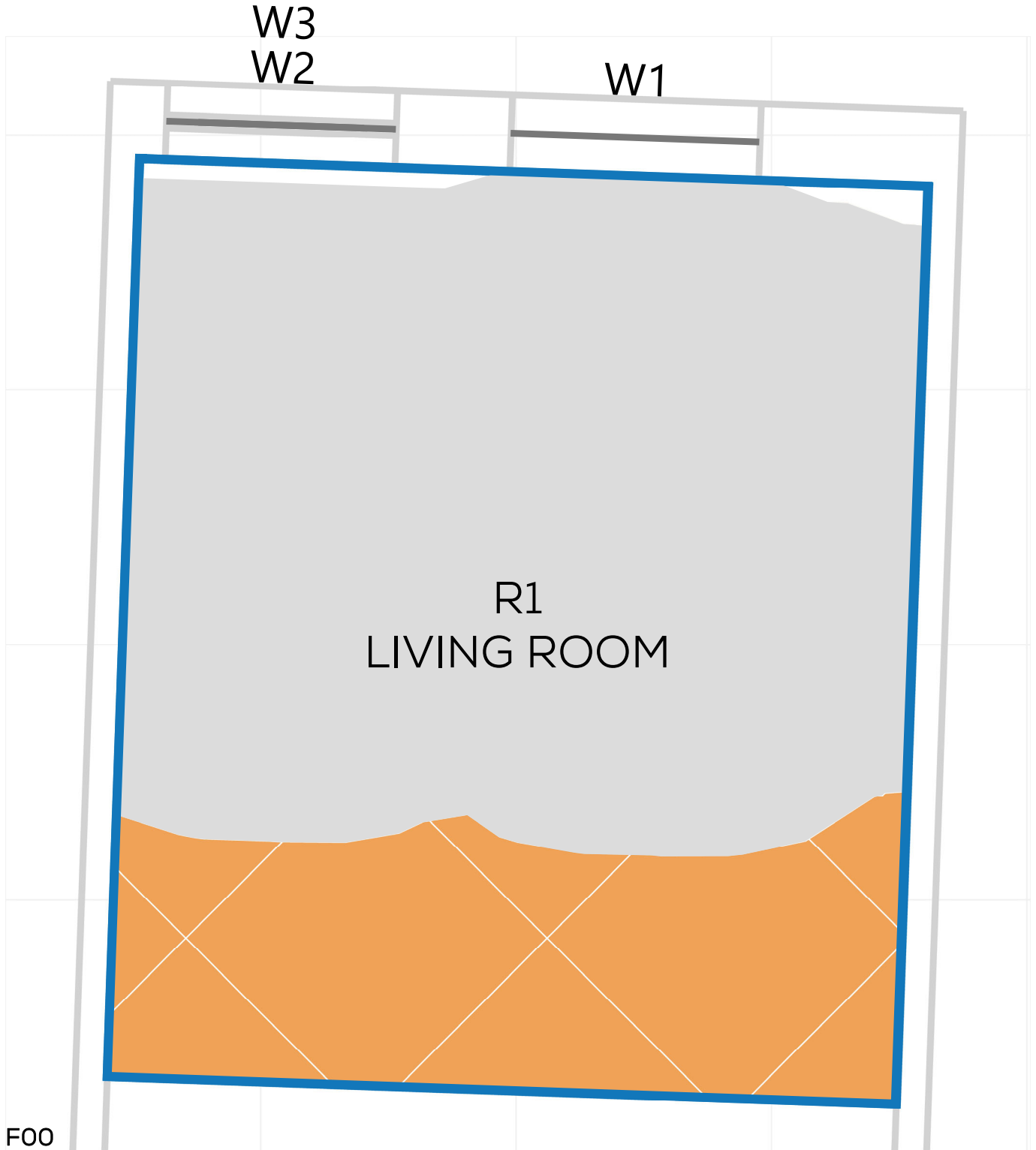
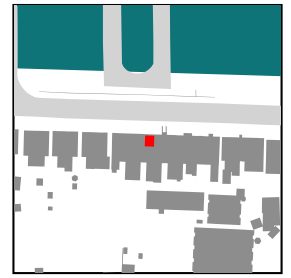

# NSL CONTOURS



PROJECT: 14047 - CAMBRIDGE ROAD  
REPORT TITLE: EXISTING VS. PROPOSED  
ADDRESS: 40 VINCENT ROAD  
DATE: 02/10/2020  
SCHEME IR: IR23 (07.09.2020)  
DRAWING No.: 14047-RELO6-IS02-DD248

### KEY:

- GAIN
- LOSS
- MAINTAINED LIT AREA
- 1 METRE GRID

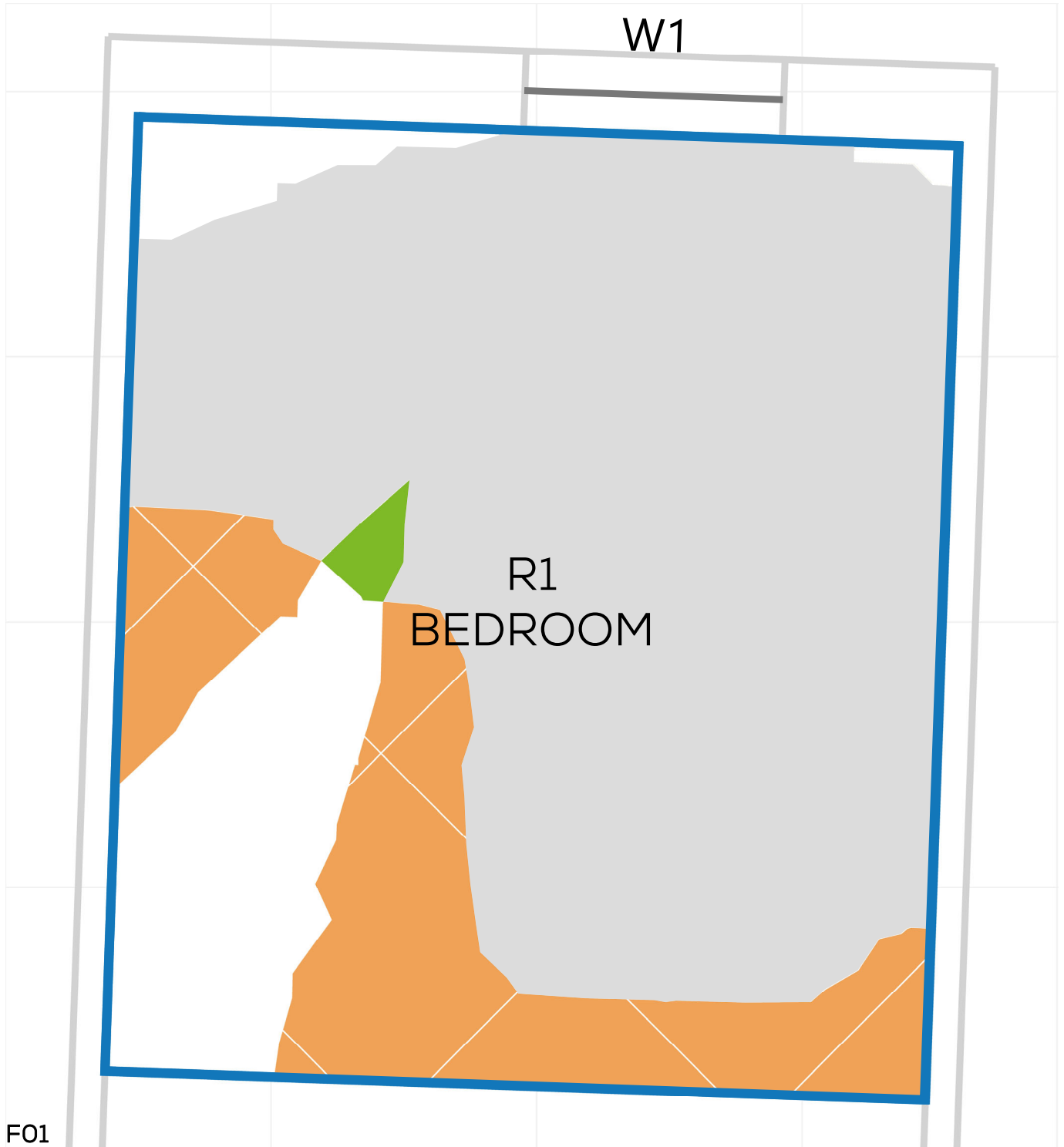
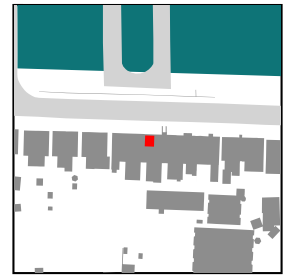

# NSL CONTOURS



PROJECT: 14047 - CAMBRIDGE ROAD  
REPORT TITLE: EXISTING VS. PROPOSED  
ADDRESS: 38 VINCENT ROAD  
DATE: 02/10/2020  
SCHEME IR: IR23 (07.09.2020)  
DRAWING No.: 14047-RELO6-IS02-DD249

**KEY:**

- GAIN
- LOSS
- MAINTAINED LIT AREA
- 1 METRE GRID

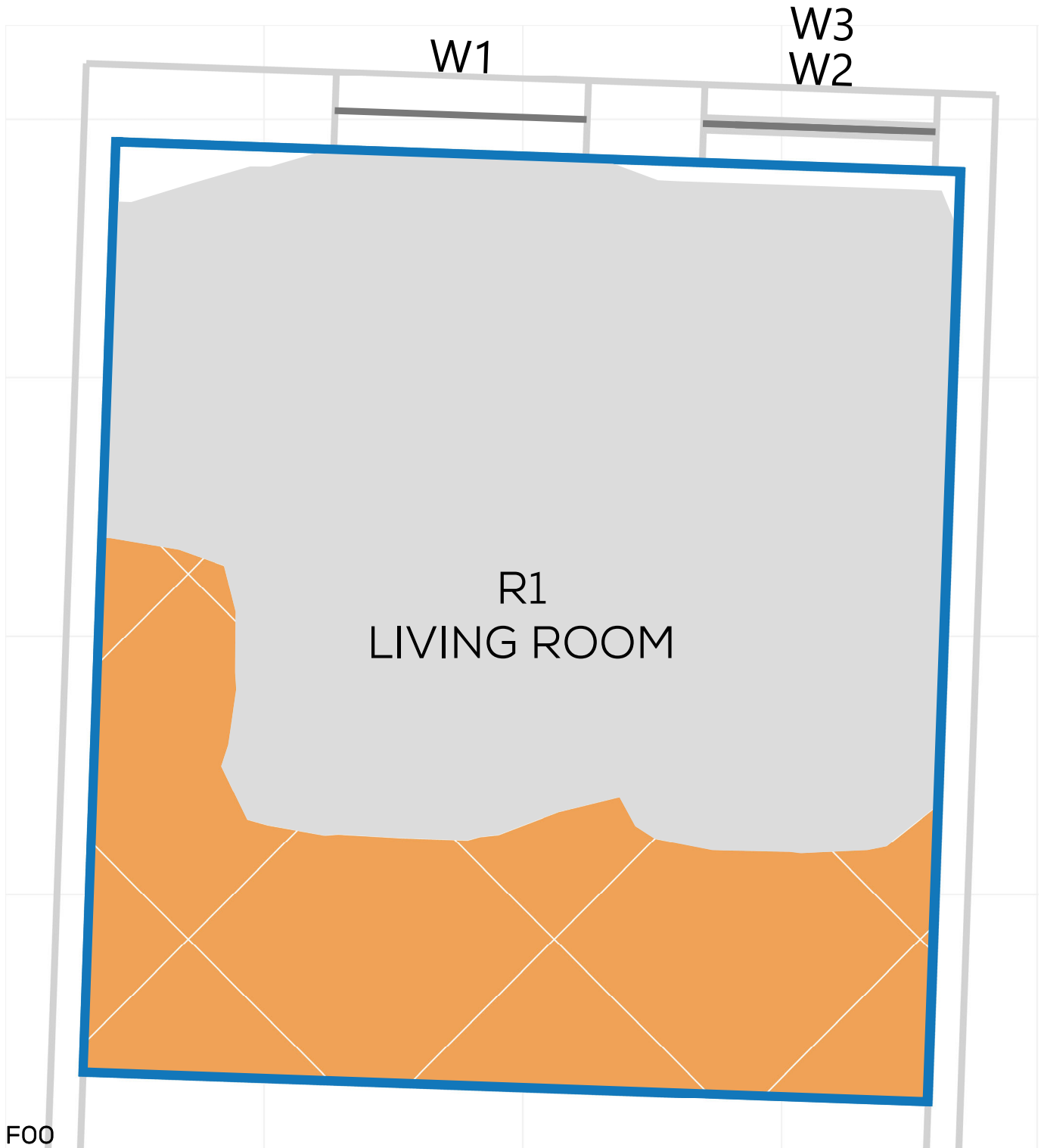
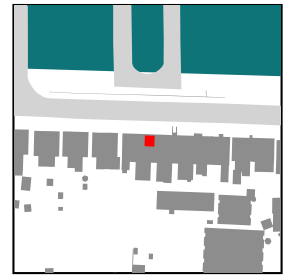

# NSL CONTOURS



PROJECT: 14047 - CAMBRIDGE ROAD  
REPORT TITLE: EXISTING VS. PROPOSED  
ADDRESS: 38 VINCENT ROAD  
DATE: 02/10/2020  
SCHEME IR: IR23 (07.09.2020)  
DRAWING No.: 14047-RELO6-IS02-DD250

**KEY:**

- GAIN
- LOSS
- MAINTAINED LIT AREA
- 1 METRE GRID

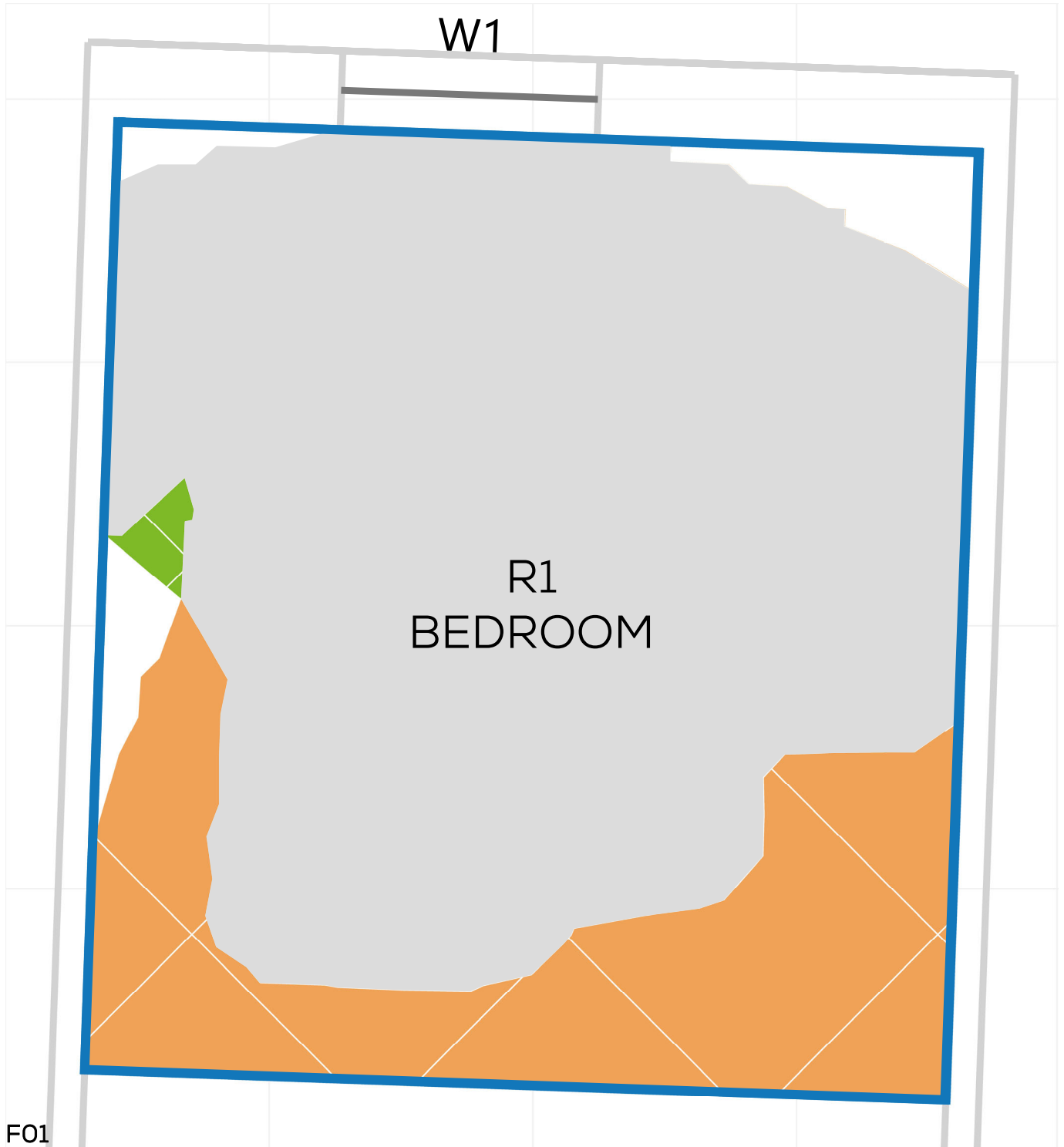
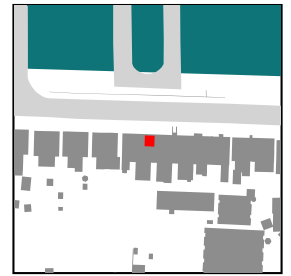

# NSL CONTOURS



PROJECT: 14047 - CAMBRIDGE ROAD  
REPORT TITLE: EXISTING VS. PROPOSED  
ADDRESS: 36 VINCENT ROAD  
DATE: 02/10/2020  
SCHEME IR: IR23 (07.09.2020)  
DRAWING No.: 14047-RELO6-IS02-DD251

## KEY:

- GAIN
- LOSS
- MAINTAINED LIT AREA
- 1 METRE GRID

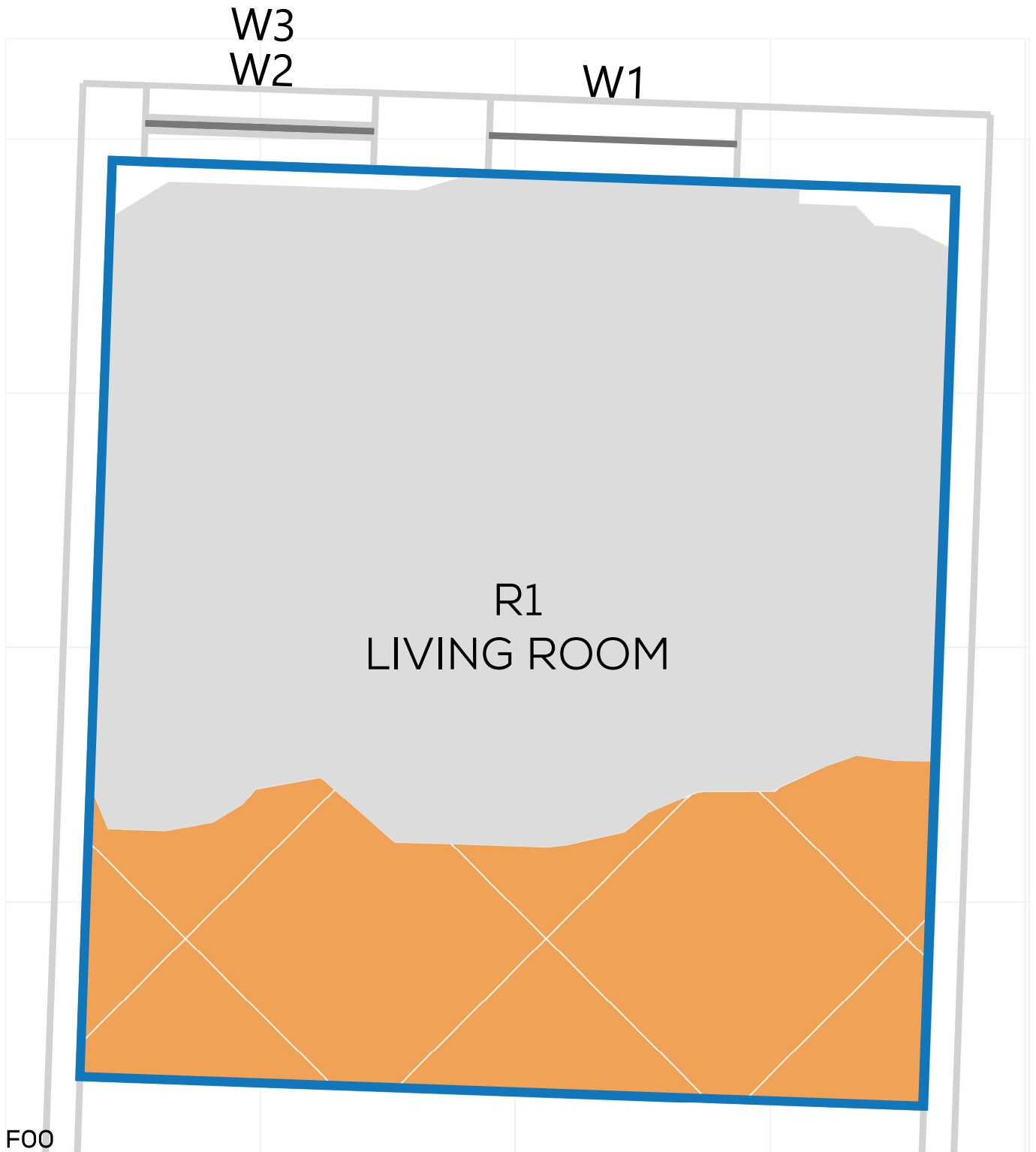

# NSL CONTOURS



PROJECT: 14047 - CAMBRIDGE ROAD  
REPORT TITLE: EXISTING VS. PROPOSED  
ADDRESS: 36 VINCENT ROAD  
DATE: 02/10/2020  
SCHEME IR: IR23 (07.09.2020)  
DRAWING No.: 14047-RELO6-IS02-DD252

**KEY:**

- GAIN
- LOSS
- MAINTAINED LIT AREA
- 1 METRE GRID

