

NSL CONTOURS



PROJECT: 14047 - CAMBRIDGE ROAD
REPORT TITLE: EXISTING VS. PROPOSED
ADDRESS: VIBE STUDENT LIVING 66-70 CAMBRIDGE
DATE: 02/10/2020
SCHEME IR: IR23 (07.09.2020)
DRAWING No.: 14047-RELO6-IS02-DD281

KEY:

- GAIN
- LOSS
- MAINTAINED LIT AREA
- 1 METRE GRID

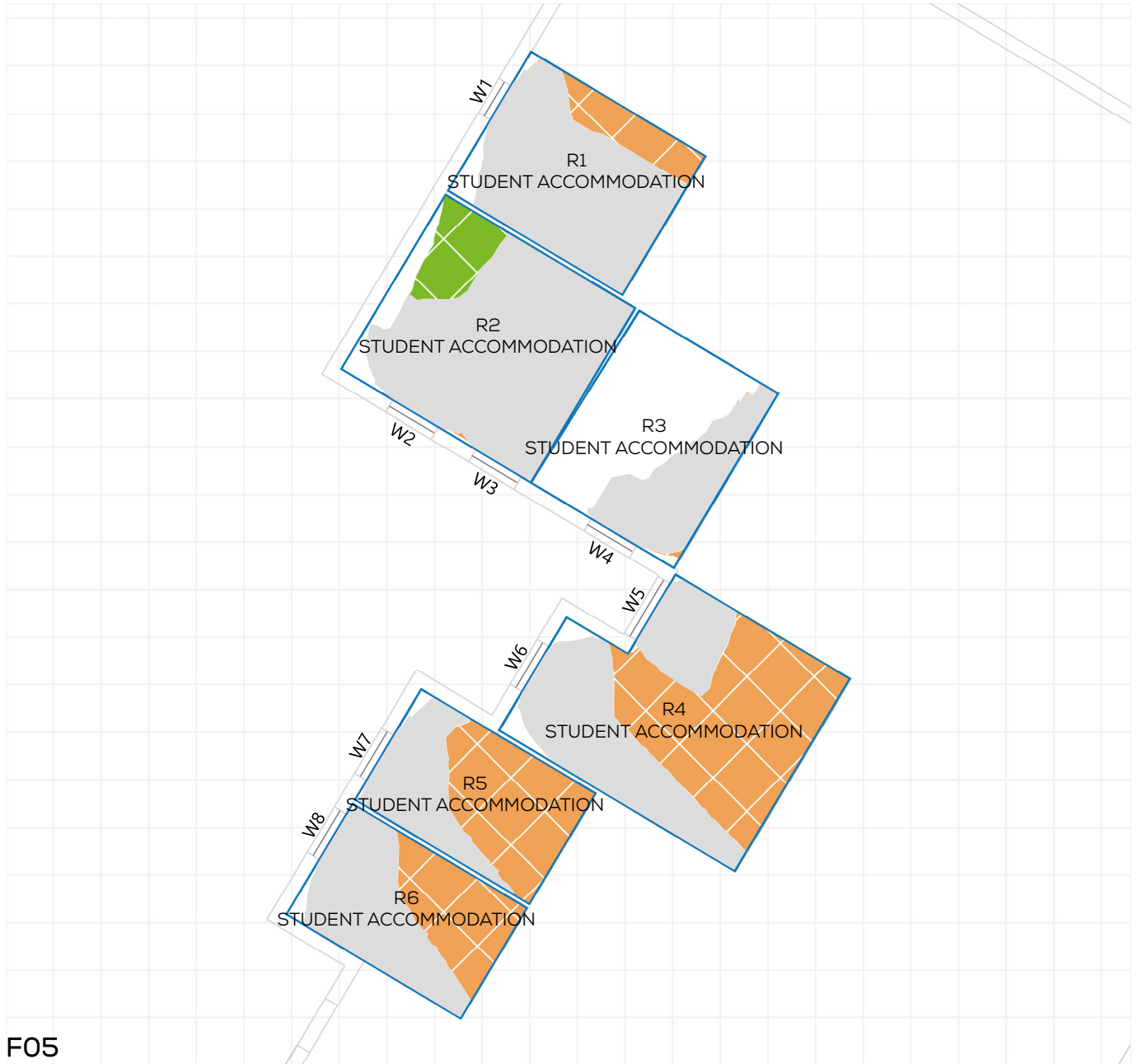
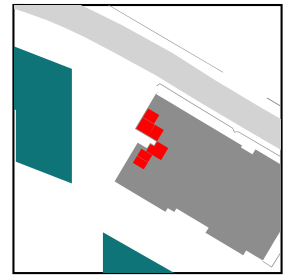

PROJECT: 14047 - CAMBRIDGE ROAD
REPORT TITLE: EXISTING VS. PROPOSED
ADDRESS: VIBE STUDENT LIVING 66-70 CAMBRIDGE
DATE: 02/10/2020
SCHEME IR: IR23 (07.09.2020)
DRAWING No.: 14047-RELO6-IS02-DD282

KEY:

- GAIN
- LOSS
- MAINTAINED LIT AREA
- 1 METRE GRID

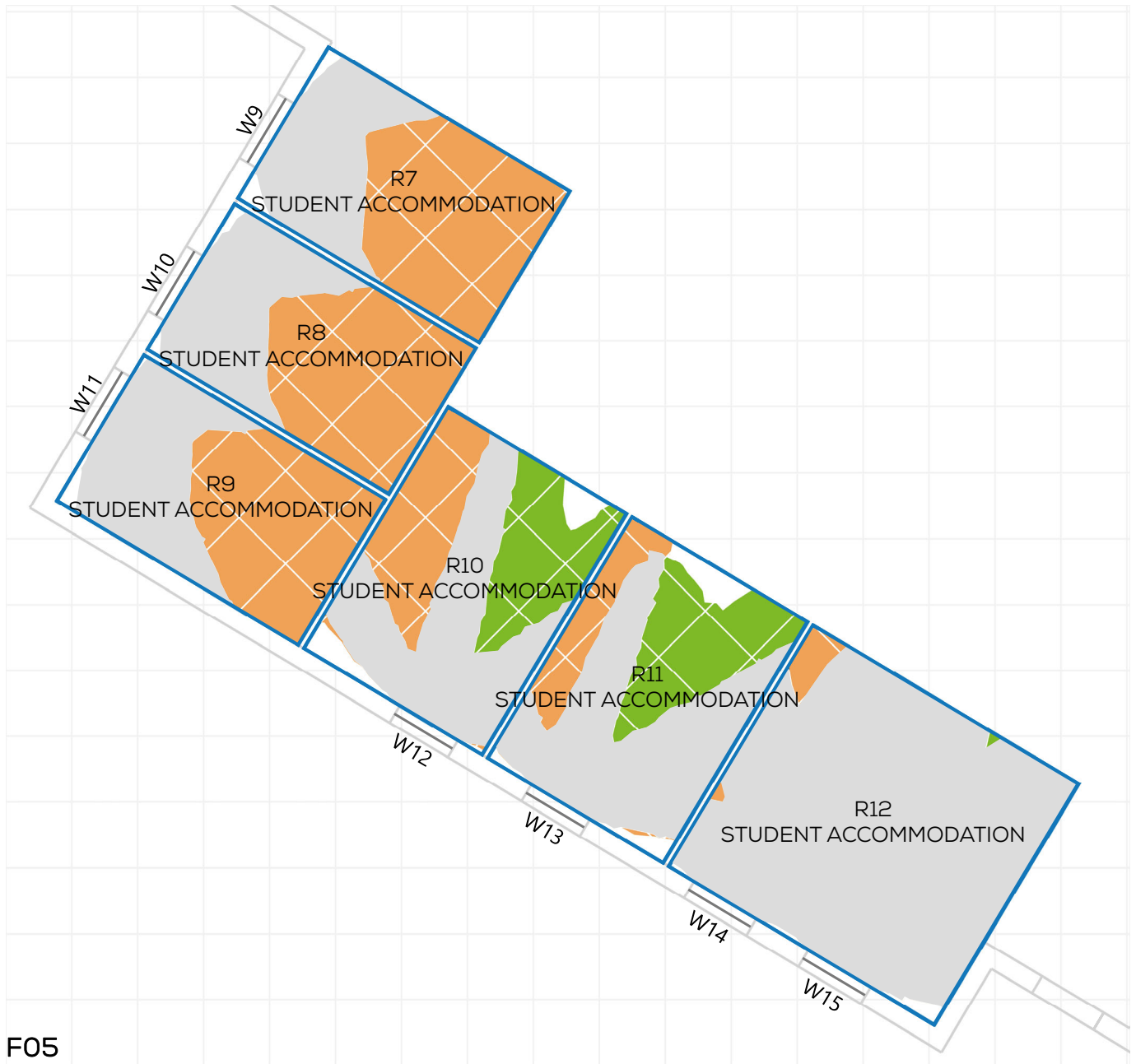
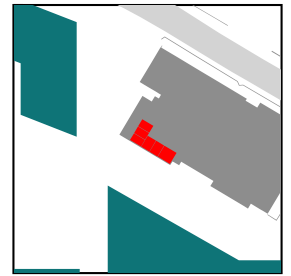

NSL CONTOURS



PROJECT: 14047 - CAMBRIDGE ROAD
REPORT TITLE: EXISTING VS. PROPOSED
ADDRESS: VIBE STUDENT LIVING 66-70 CAMBRIDGE
DATE: 02/10/2020
SCHEME IR: IR23 (07.09.2020)
DRAWING No.: 14047-RELO6-IS02-DD283

KEY:

- GAIN
- LOSS
- MAINTAINED LIT AREA
- 1 METRE GRID

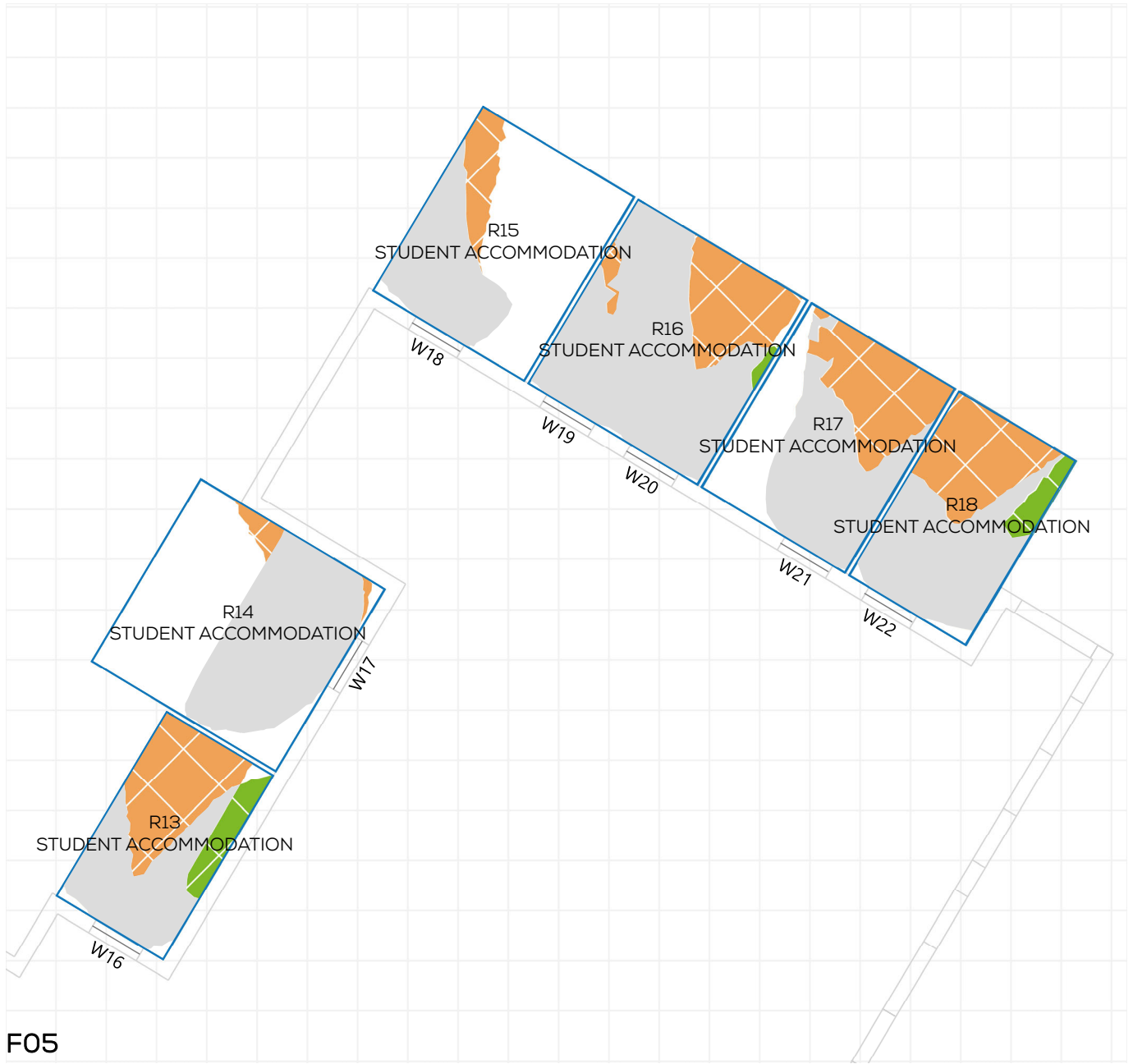
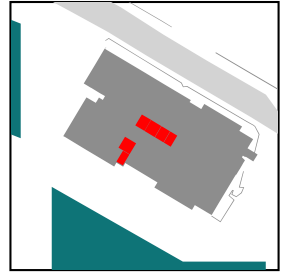

F05

NSL CONTOURS



PROJECT: 14047 - CAMBRIDGE ROAD
REPORT TITLE: EXISTING VS. PROPOSED
ADDRESS: VIBE STUDENT LIVING 66-70 CAMBRIDGE
DATE: 02/10/2020
SCHEME IR: IR23 (07.09.2020)
DRAWING No.: 14047-RELO6-IS02-DD284

KEY:

- GAIN
- LOSS
- MAINTAINED LIT AREA
- 1 METRE GRID

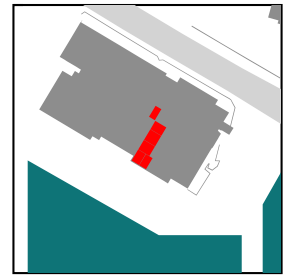

F05

NSL CONTOURS



PROJECT: 14047 - CAMBRIDGE ROAD
REPORT TITLE: EXISTING VS. PROPOSED
ADDRESS: VIBE STUDENT LIVING 66-70 CAMBRIDGE
DATE: 02/10/2020
SCHEME IR: IR23 (07.09.2020)
DRAWING No.: 14047-RELO6-IS02-DD285

KEY:

- GAIN
- LOSS
- MAINTAINED LIT AREA
- 1 METRE GRID

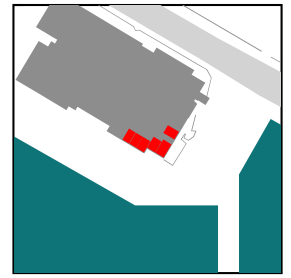

F05

NSL CONTOURS



PROJECT: 14047 - CAMBRIDGE ROAD
REPORT TITLE: EXISTING VS. PROPOSED
ADDRESS: VIBE STUDENT LIVING 66-70 CAMBRIDGE
DATE: 02/10/2020
SCHEME IR: IR23 (07.09.2020)
DRAWING No.: 14047-RELO6-IS02-DD286

KEY:

- GAIN
- LOSS
- MAINTAINED LIT AREA
- 1 METRE GRID

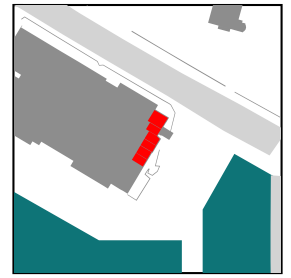

F05

NSL CONTOURS



PROJECT: 14047 - CAMBRIDGE ROAD
REPORT TITLE: EXISTING VS. PROPOSED
ADDRESS: VIBE STUDENT LIVING 66-70 CAMBRIDGE
DATE: 02/10/2020
SCHEME IR: IR23 (07.09.2020)
DRAWING No.: 14047-RELO6-IS02-DD287

KEY:

- GAIN
- LOSS
- MAINTAINED LIT AREA
- 1 METRE GRID

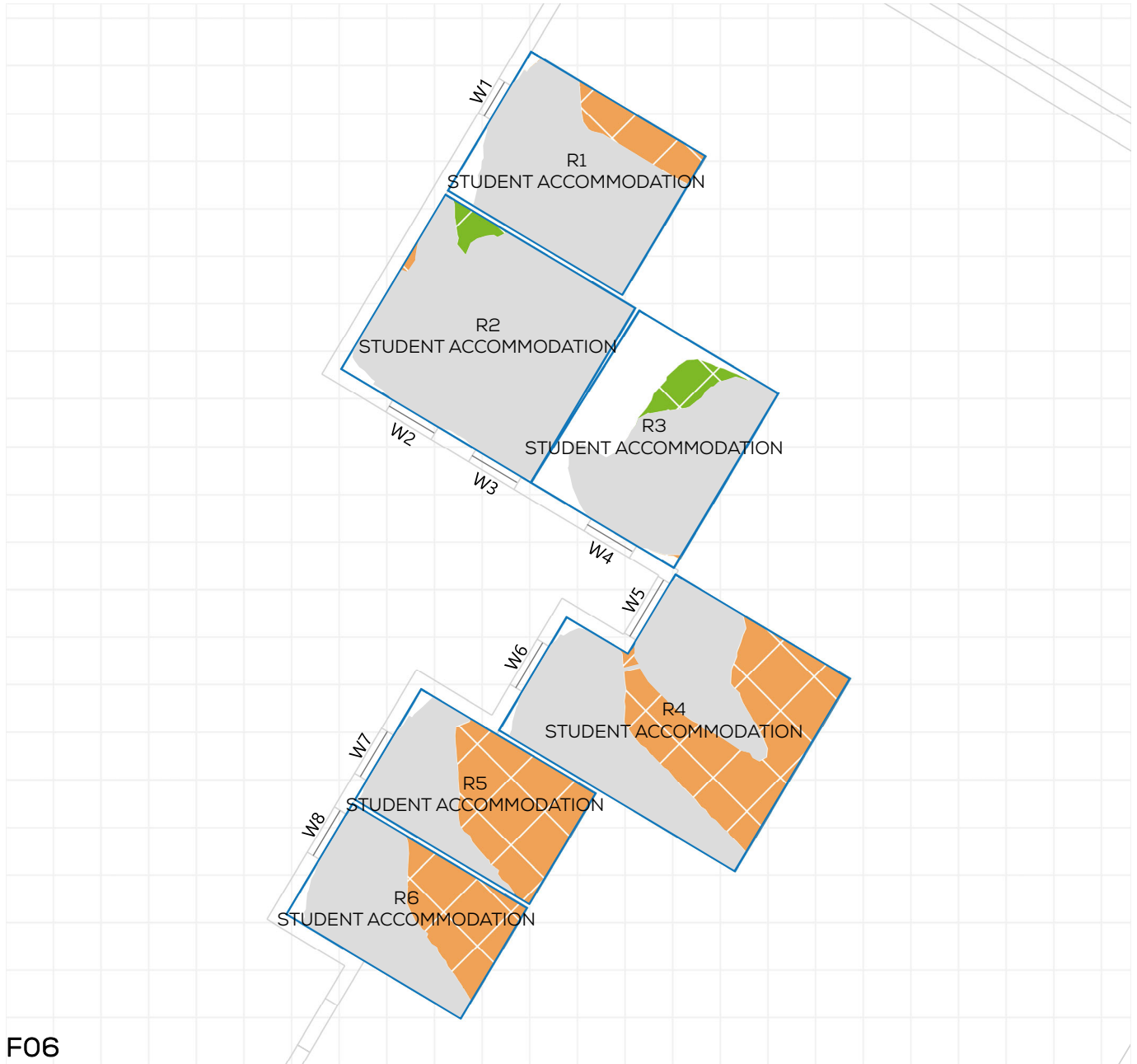
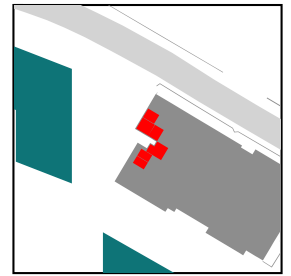

F06

NSL CONTOURS



PROJECT: 14047 - CAMBRIDGE ROAD
REPORT TITLE: EXISTING VS. PROPOSED
ADDRESS: VIBE STUDENT LIVING 66-70 CAMBRIDGE
DATE: 02/10/2020
SCHEME IR: IR23 (07.09.2020)
DRAWING No.: 14047-RELO6-IS02-DD288

KEY:

- GAIN
- LOSS
- MAINTAINED LIT AREA
- 1 METRE GRID

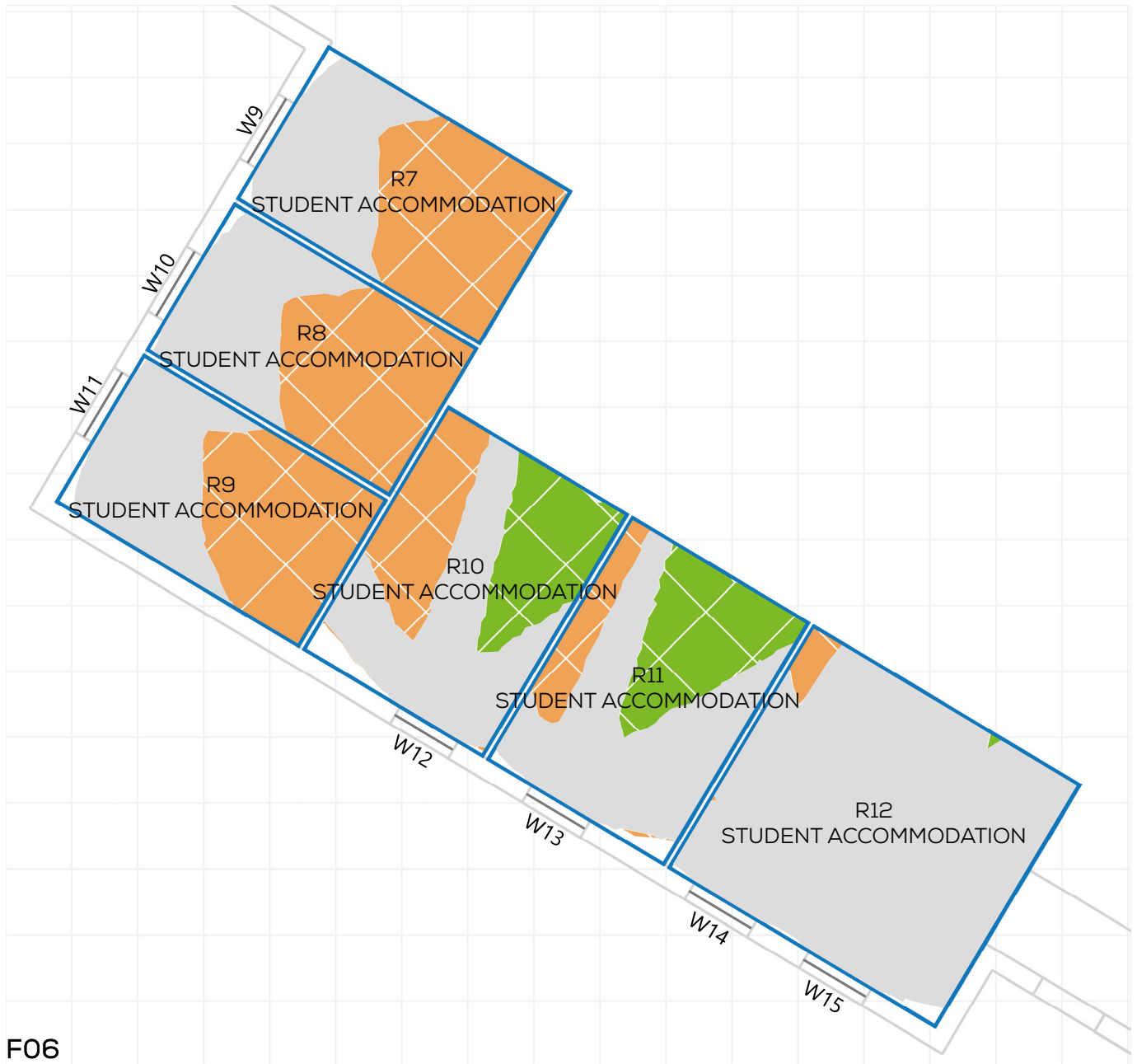
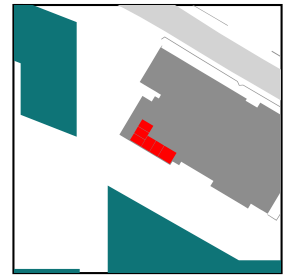

F06

NSL CONTOURS



PROJECT: 14047 - CAMBRIDGE ROAD
REPORT TITLE: EXISTING VS. PROPOSED
ADDRESS: VIBE STUDENT LIVING 66-70 CAMBRIDGE
DATE: 02/10/2020
SCHEME IR: IR23 (07.09.2020)
DRAWING No.: 14047-RELO6-IS02-DD289

KEY:

- GAIN
- LOSS
- MAINTAINED LIT AREA
- 1 METRE GRID

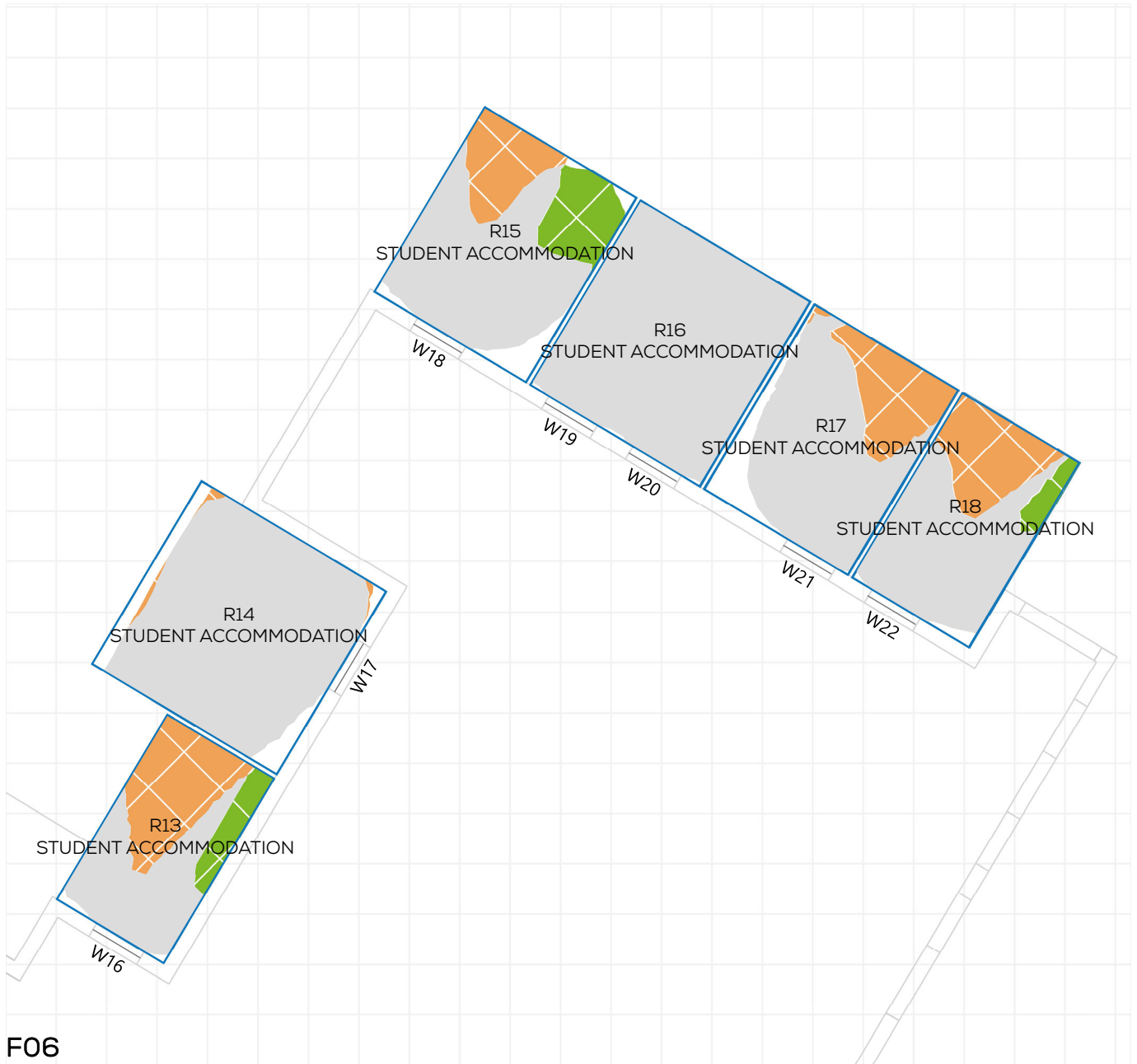
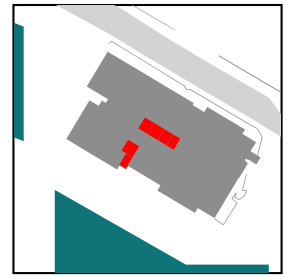

NSL CONTOURS



PROJECT: 14047 - CAMBRIDGE ROAD
REPORT TITLE: EXISTING VS. PROPOSED
ADDRESS: VIBE STUDENT LIVING 66-70 CAMBRIDGE
DATE: 02/10/2020
SCHEME IR: IR23 (07.09.2020)
DRAWING No.: 14047-RELO6-IS02-DD290

KEY:

- GAIN
- LOSS
- MAINTAINED LIT AREA
- 1 METRE GRID

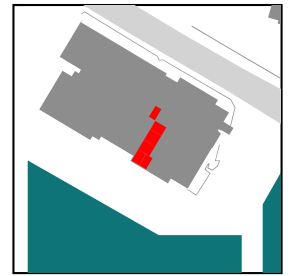

F06

NSL CONTOURS



PROJECT: 14047 - CAMBRIDGE ROAD
REPORT TITLE: EXISTING VS. PROPOSED
ADDRESS: VIBE STUDENT LIVING 66-70 CAMBRIDGE
DATE: 02/10/2020
SCHEME IR: IR23 (07.09.2020)
DRAWING No.: 14047-RELO6-IS02-DD291

KEY:

- GAIN
- LOSS
- MAINTAINED LIT AREA
- 1 METRE GRID

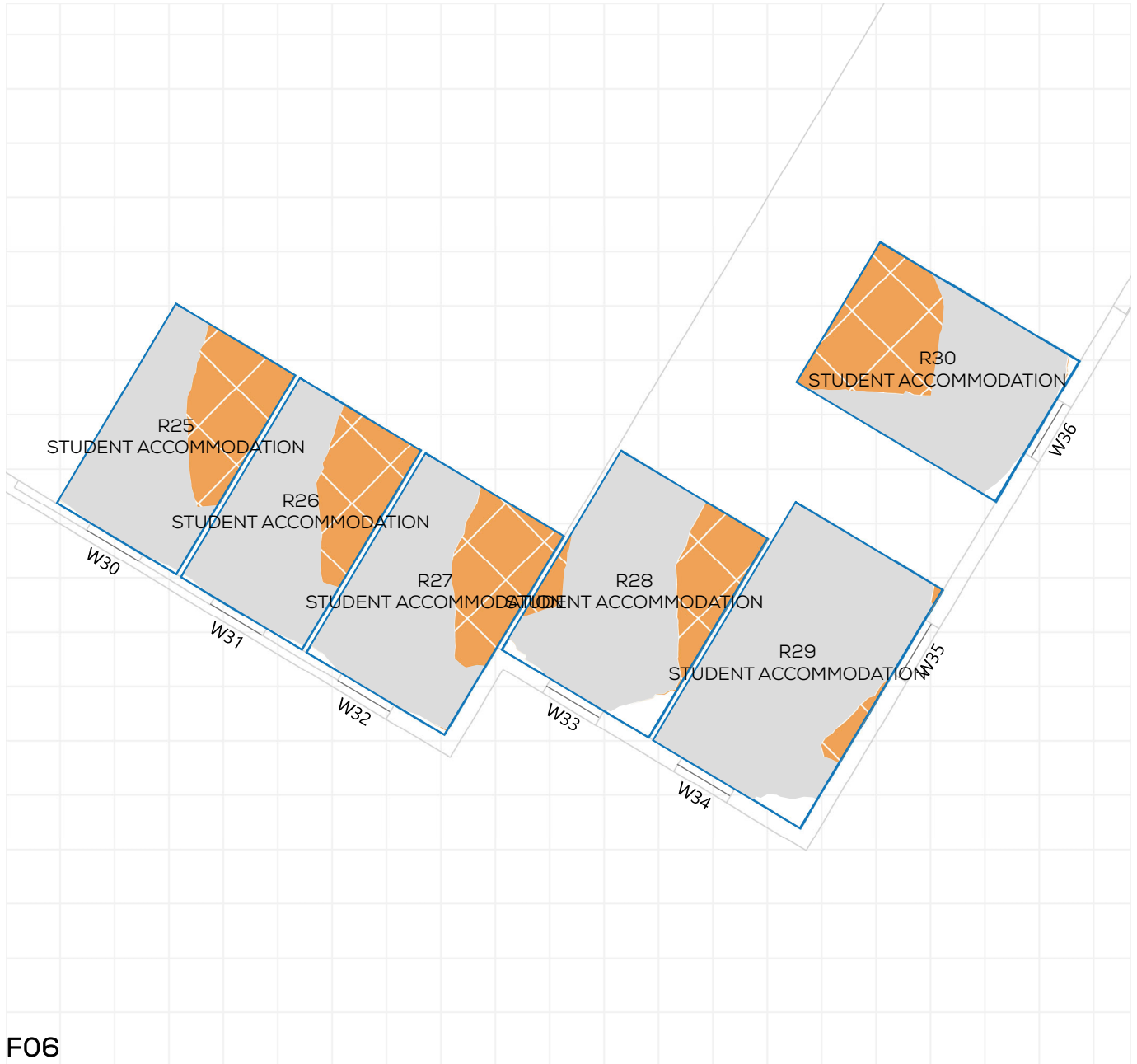
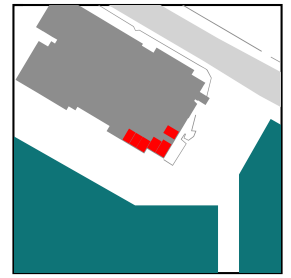

F06

NSL CONTOURS



PROJECT: 14047 - CAMBRIDGE ROAD
REPORT TITLE: EXISTING VS. PROPOSED
ADDRESS: VIBE STUDENT LIVING 66-70 CAMBRIDGE
DATE: 02/10/2020
SCHEME IR: IR23 (07.09.2020)
DRAWING No.: 14047-RELO6-IS02-DD292

KEY:

- GAIN
- LOSS
- MAINTAINED LIT AREA
- 1 METRE GRID

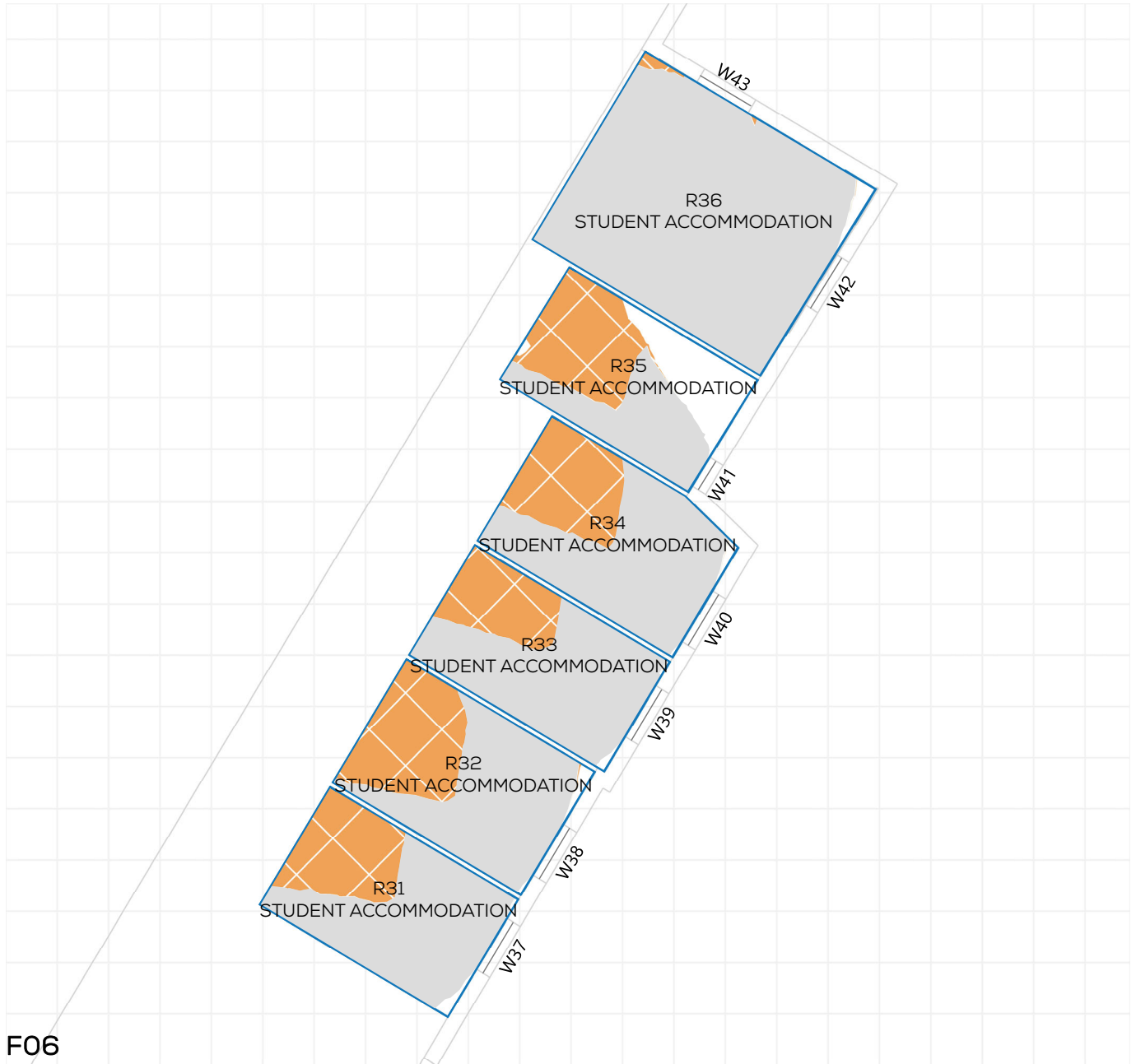
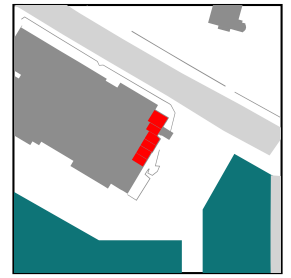

NSL CONTOURS



PROJECT: 14047 - CAMBRIDGE ROAD
REPORT TITLE: EXISTING VS. PROPOSED
ADDRESS: VIBE STUDENT LIVING 66-70 CAMBRIDGE
DATE: 02/10/2020
SCHEME IR: IR23 (07.09.2020)
DRAWING No.: 14047-RELO6-IS02-DD293

KEY:

- GAIN
- LOSS
- MAINTAINED LIT AREA
- 1 METRE GRID

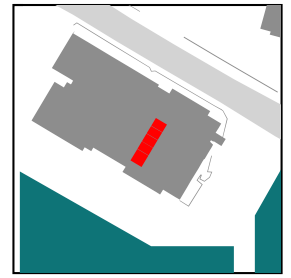

NSL CONTOURS



PROJECT: 14047 - CAMBRIDGE ROAD
REPORT TITLE: EXISTING VS. PROPOSED
ADDRESS: VIBE STUDENT LIVING 66-70 CAMBRIDGE
DATE: 02/10/2020
SCHEME IR: IR23 (07.09.2020)
DRAWING No.: 14047-RELO6-IS02-DD294

KEY:

- GAIN
- LOSS
- MAINTAINED LIT AREA
- 1 METRE GRID

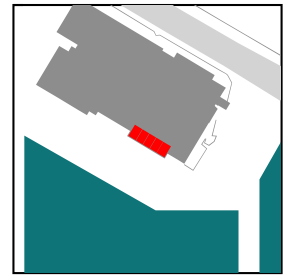

F07

NSL CONTOURS



PROJECT: 14047 - CAMBRIDGE ROAD
REPORT TITLE: EXISTING VS. PROPOSED
ADDRESS: CASCADIA HOUSE CAMBRIDGE ROAD
DATE: 02/10/2020
SCHEME IR: IR23 (07.09.2020)
DRAWING No.: 14047-RELO6-IS02-DD295

KEY:

- GAIN
- LOSS
- MAINTAINED LIT AREA
- 1 METRE GRID

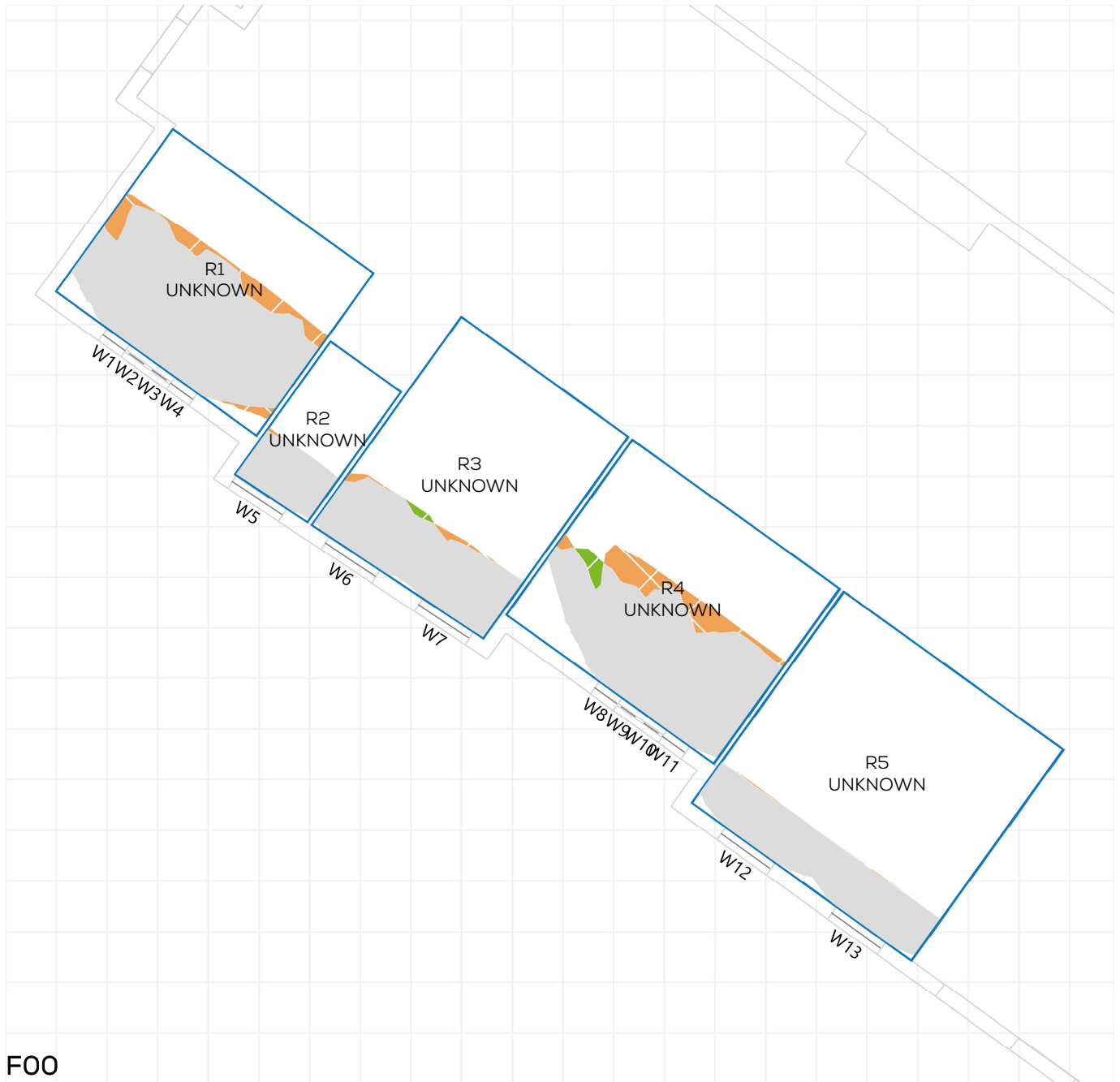
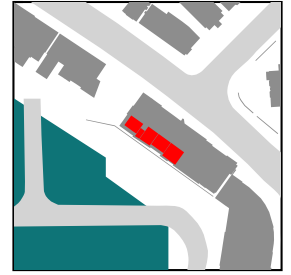

FOO

NSL CONTOURS



PROJECT: 14047 - CAMBRIDGE ROAD
REPORT TITLE: EXISTING VS. PROPOSED
ADDRESS: CASCADIA HOUSE CAMBRIDGE ROAD
DATE: 02/10/2020
SCHEME IR: IR23 (07.09.2020)
DRAWING No.: 14047-RELO6-IS02-DD296

KEY:

- GAIN
- LOSS
- MAINTAINED LIT AREA
- 1 METRE GRID

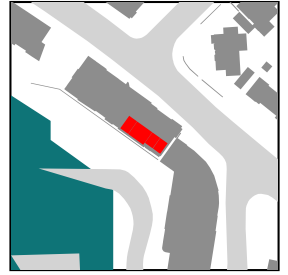

NSL CONTOURS



PROJECT: 14047 - CAMBRIDGE ROAD
REPORT TITLE: EXISTING VS. PROPOSED
ADDRESS: CASCADIA HOUSE CAMBRIDGE ROAD
DATE: 02/10/2020
SCHEME IR: IR23 (07.09.2020)
DRAWING No.: 14047-RELO6-IS02-DD297

KEY:

- GAIN
- LOSS
- MAINTAINED LIT AREA
- 1 METRE GRID



NSL CONTOURS



PROJECT: 14047 - CAMBRIDGE ROAD
REPORT TITLE: EXISTING VS. PROPOSED
ADDRESS: CASCADIA HOUSE CAMBRIDGE ROAD
DATE: 02/10/2020
SCHEME IR: IR23 (07.09.2020)
DRAWING No.: 14047-RELO6-IS02-DD298

KEY:

- GAIN
- LOSS
- MAINTAINED LIT AREA
- 1 METRE GRID

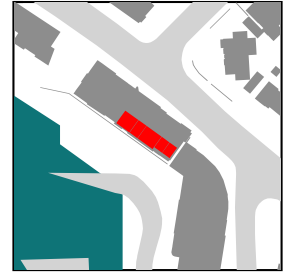

F01

NSL CONTOURS



PROJECT: 14047 - CAMBRIDGE ROAD
REPORT TITLE: EXISTING VS. PROPOSED
ADDRESS: CASCADIA HOUSE CAMBRIDGE ROAD
DATE: 02/10/2020
SCHEME IR: IR23 (07.09.2020)
DRAWING No.: 14047-RELO6-IS02-DD299

KEY:

- GAIN
- LOSS
- MAINTAINED LIT AREA
- 1 METRE GRID



F02

NSL CONTOURS



PROJECT: 14047 - CAMBRIDGE ROAD
REPORT TITLE: EXISTING VS. PROPOSED
ADDRESS: CASCADIA HOUSE CAMBRIDGE ROAD
DATE: 02/10/2020
SCHEME IR: IR23 (07.09.2020)
DRAWING No.: 14047-RELO6-IS02-DD300

KEY:

- GAIN
- LOSS
- MAINTAINED LIT AREA
- 1 METRE GRID

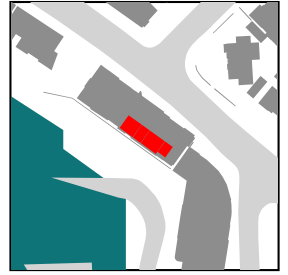

F02

NSL CONTOURS



PROJECT: 14047 - CAMBRIDGE ROAD
REPORT TITLE: EXISTING VS. PROPOSED
ADDRESS: CASCADIA HOUSE CAMBRIDGE ROAD
DATE: 02/10/2020
SCHEME IR: IR23 (07.09.2020)
DRAWING No.: 14047-RELO6-IS02-DD301

KEY:

- GAIN
- LOSS
- MAINTAINED LIT AREA
- 1 METRE GRID

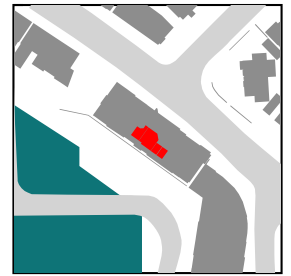

F03

NSL CONTOURS



PROJECT: 14047 - CAMBRIDGE ROAD
REPORT TITLE: EXISTING VS. PROPOSED
ADDRESS: CASCADIA HOUSE CAMBRIDGE ROAD
DATE: 02/10/2020
SCHEME IR: IR23 (07.09.2020)
DRAWING No.: 14047-RELO6-IS02-DD302

KEY:

- GAIN
- LOSS
- MAINTAINED LIT AREA
- 1 METRE GRID



NSL CONTOURS



PROJECT: 14047 - CAMBRIDGE ROAD
REPORT TITLE: EXISTING VS. PROPOSED
ADDRESS: 140 CAMBRIDGE ROAD
DATE: 02/10/2020
SCHEME IR: IR23 (07.09.2020)
DRAWING No.: 14047-RELO6-IS02-DD303

KEY:

- GAIN
- LOSS
- MAINTAINED LIT AREA
- 1 METRE GRID

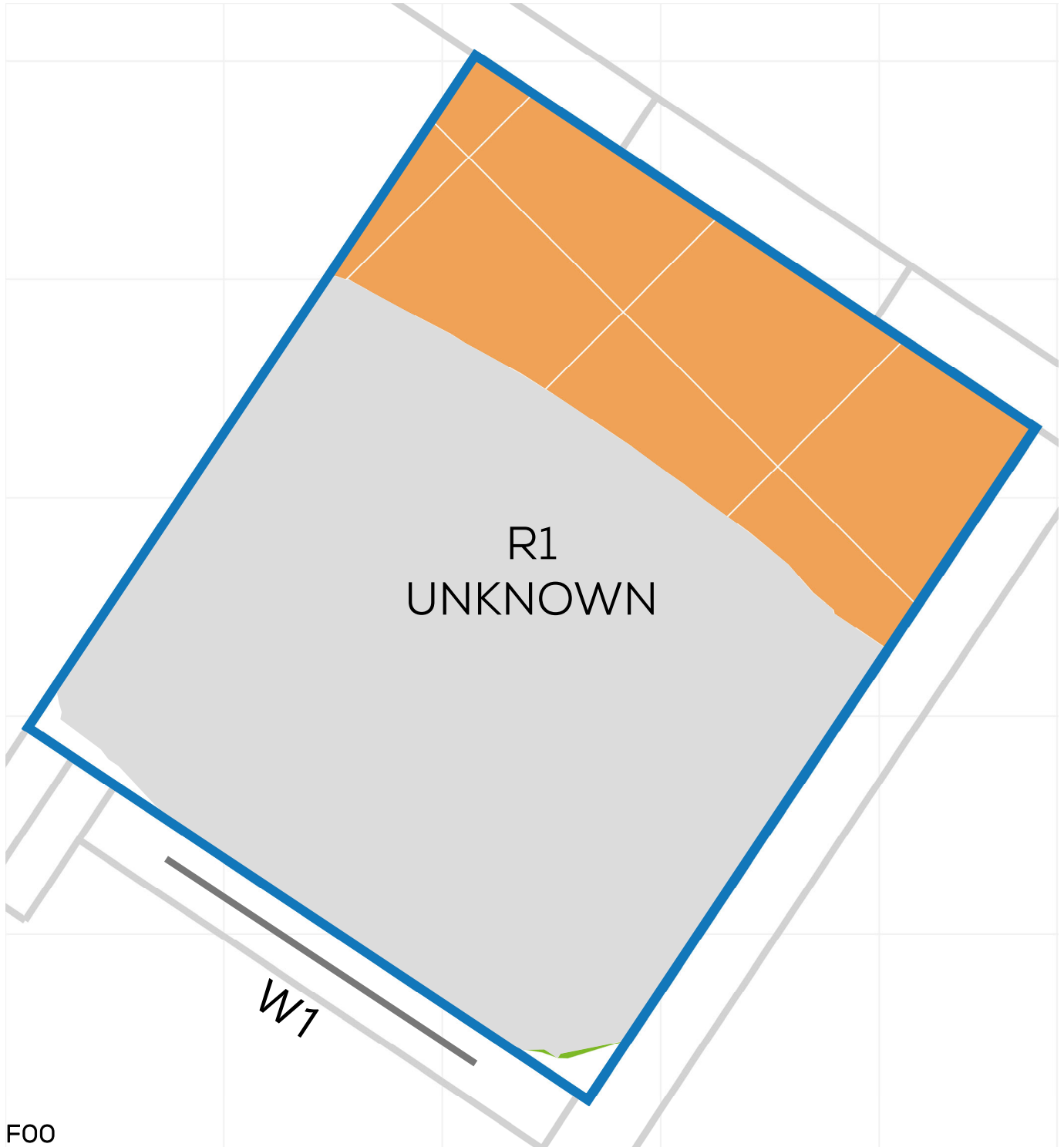
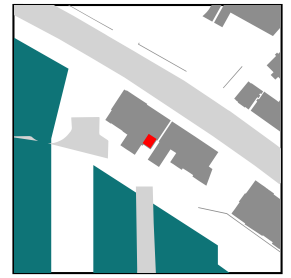

NSL CONTOURS



PROJECT: 14047 - CAMBRIDGE ROAD
REPORT TITLE: EXISTING VS. PROPOSED
ADDRESS: 140 CAMBRIDGE ROAD
DATE: 02/10/2020
SCHEME IR: IR23 (07.09.2020)
DRAWING No.: 14047-RELO6-IS02-DD304

KEY:

- GAIN
- LOSS
- MAINTAINED LIT AREA
- 1 METRE GRID

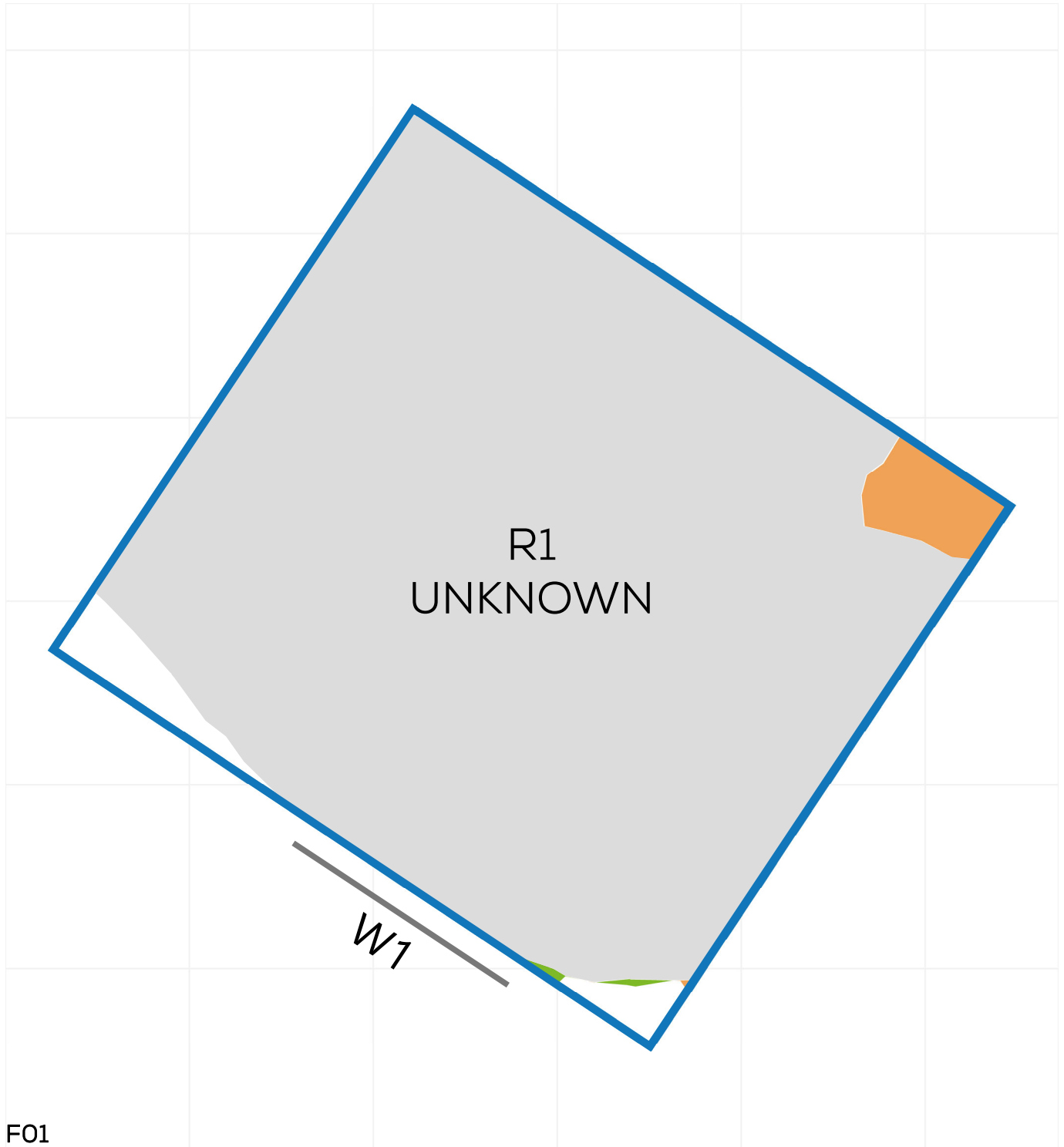

NSL CONTOURS



PROJECT: 14047 - CAMBRIDGE ROAD
REPORT TITLE: EXISTING VS. PROPOSED
ADDRESS: 138 CAMBRIDGE ROAD
DATE: 02/10/2020
SCHEME IR: IR23 (07.09.2020)
DRAWING No.: 14047-RELO6-IS02-DD305

KEY:

- GAIN
- LOSS
- MAINTAINED LIT AREA
- 1 METRE GRID

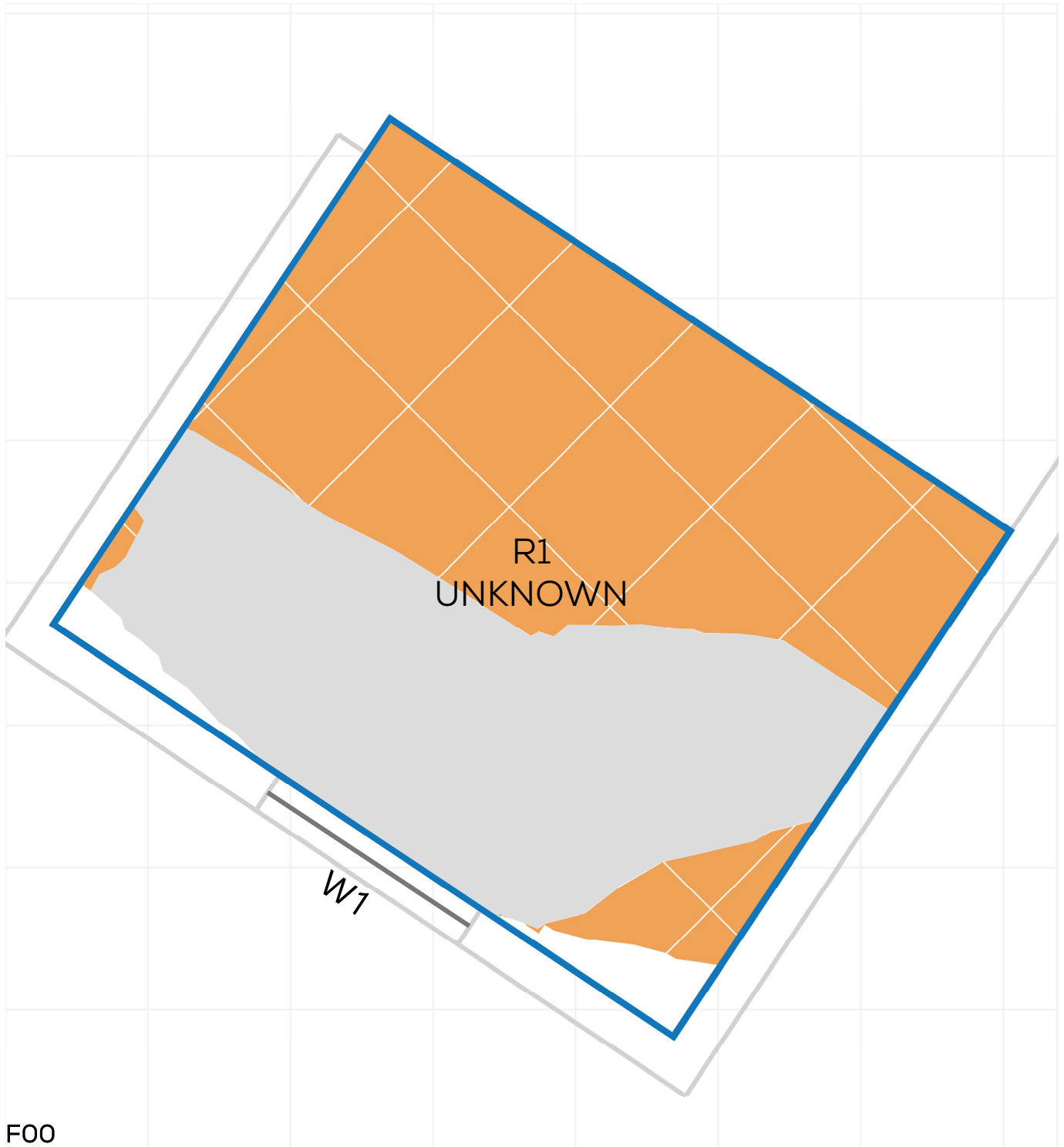
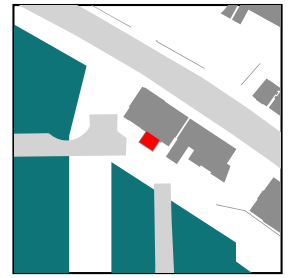

NSL CONTOURS



PROJECT: 14047 - CAMBRIDGE ROAD
REPORT TITLE: EXISTING VS. PROPOSED
ADDRESS: 138 CAMBRIDGE ROAD
DATE: 02/10/2020
SCHEME IR: IR23 (07.09.2020)
DRAWING No.: 14047-RELO6-IS02-DD306

KEY:

- GAIN
- LOSS
- MAINTAINED LIT AREA
- 1 METRE GRID

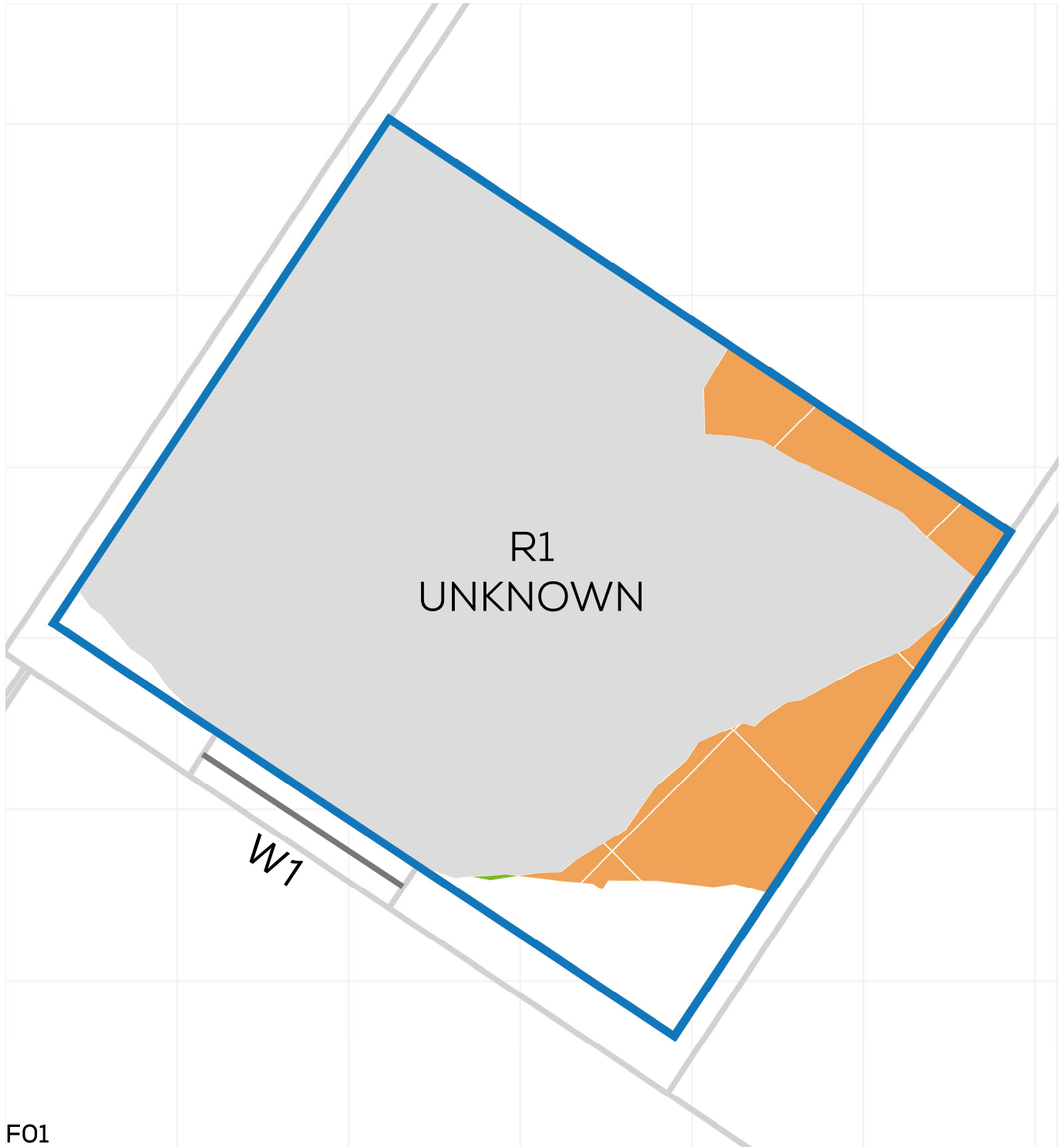
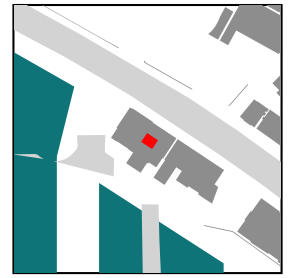

NSL CONTOURS



PROJECT: 14047 - CAMBRIDGE ROAD
REPORT TITLE: EXISTING VS. PROPOSED
ADDRESS: 136 CAMBRIDGE ROAD
DATE: 02/10/2020
SCHEME IR: IR23 (07.09.2020)
DRAWING No.: 14047-RELO6-IS02-DD307

KEY:

- GAIN
- LOSS
- MAINTAINED LIT AREA
- 1 METRE GRID

