

# NSL CONTOURS



PROJECT: 14047 - CAMBRIDGE ROAD  
REPORT TITLE: EXISTING VS. PROPOSED  
ADDRESS: 39 PORTMAN ROAD  
DATE: 02/10/2020  
SCHEME IR: IR23 (07.09.2020)  
DRAWING No.: 14047-RELO6-IS02-DD371

### KEY:

- GAIN
- LOSS
- MAINTAINED LIT AREA
- 1 METRE GRID

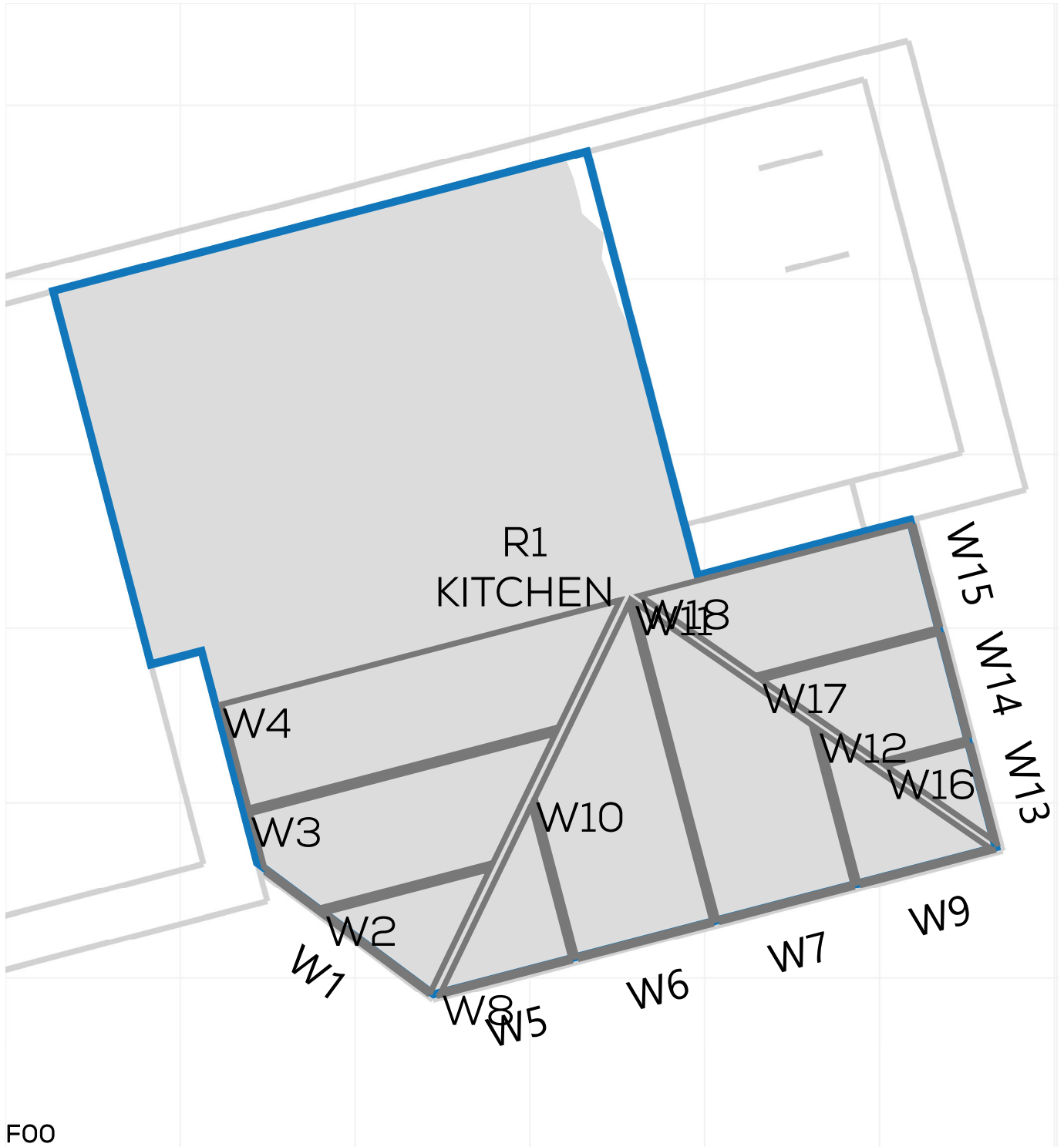

# NSL CONTOURS



PROJECT: 14047 - CAMBRIDGE ROAD  
REPORT TITLE: EXISTING VS. PROPOSED  
ADDRESS: 39 PORTMAN ROAD  
DATE: 02/10/2020  
SCHEME IR: IR23 (07.09.2020)  
DRAWING No.: 14047-RELO6-IS02-DD372

**KEY:**

- GAIN
- LOSS
- MAINTAINED LIT AREA
- 1 METRE GRID



# NSL CONTOURS



PROJECT: 14047 - CAMBRIDGE ROAD  
REPORT TITLE: EXISTING VS. PROPOSED  
ADDRESS: 2 SOMERSET ROAD  
DATE: 02/10/2020  
SCHEME IR: IR23 (07.09.2020)  
DRAWING No.: 14047-RELO6-IS02-DD373

**KEY:**

- GAIN
- LOSS
- MAINTAINED LIT AREA
- 1 METRE GRID

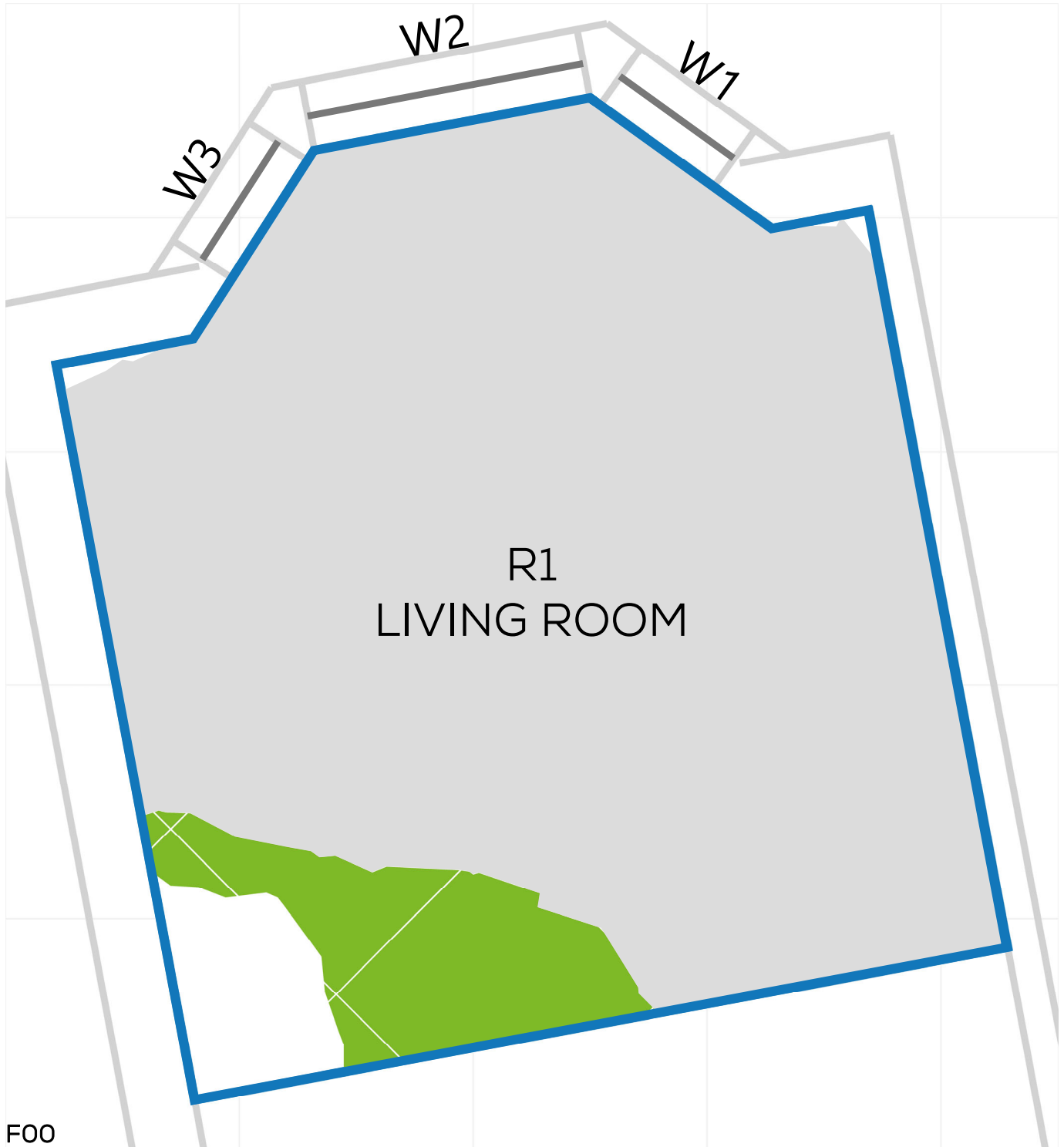

# NSL CONTOURS



PROJECT: 14047 - CAMBRIDGE ROAD  
REPORT TITLE: EXISTING VS. PROPOSED  
ADDRESS: 2 SOMERSET ROAD  
DATE: 02/10/2020  
SCHEME IR: IR23 (07.09.2020)  
DRAWING No.: 14047-RELO6-IS02-DD374

**KEY:**

- GAIN
- LOSS
- MAINTAINED LIT AREA
- 1 METRE GRID

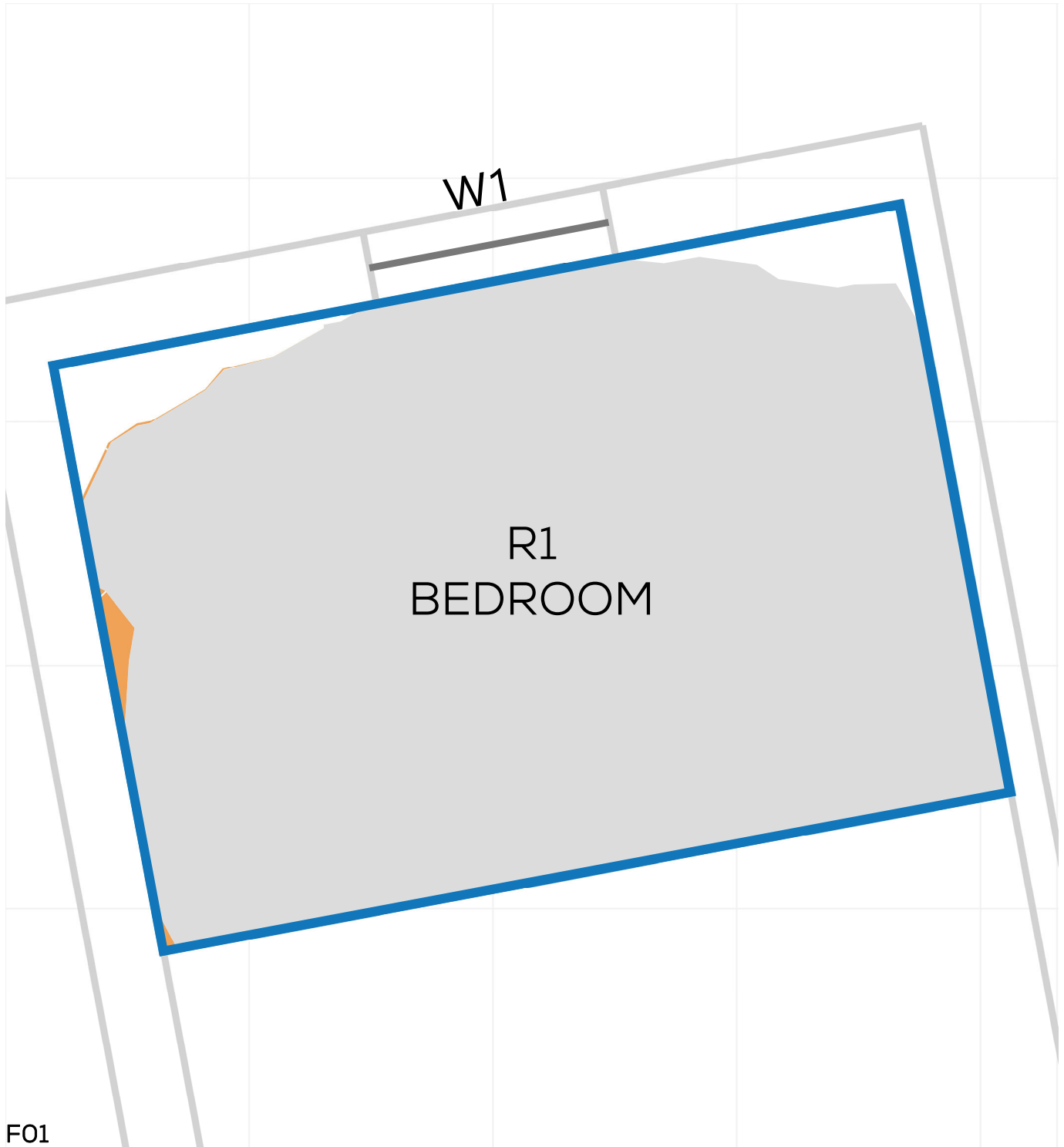

# NSL CONTOURS



PROJECT: 14047 - CAMBRIDGE ROAD  
REPORT TITLE: EXISTING VS. PROPOSED  
ADDRESS: 3 SOMERSET ROAD  
DATE: 02/10/2020  
SCHEME IR: IR23 (07.09.2020)  
DRAWING No.: 14047-RELO6-IS02-DD375

## KEY:

- GAIN
- LOSS
- MAINTAINED LIT AREA
- 1 METRE GRID

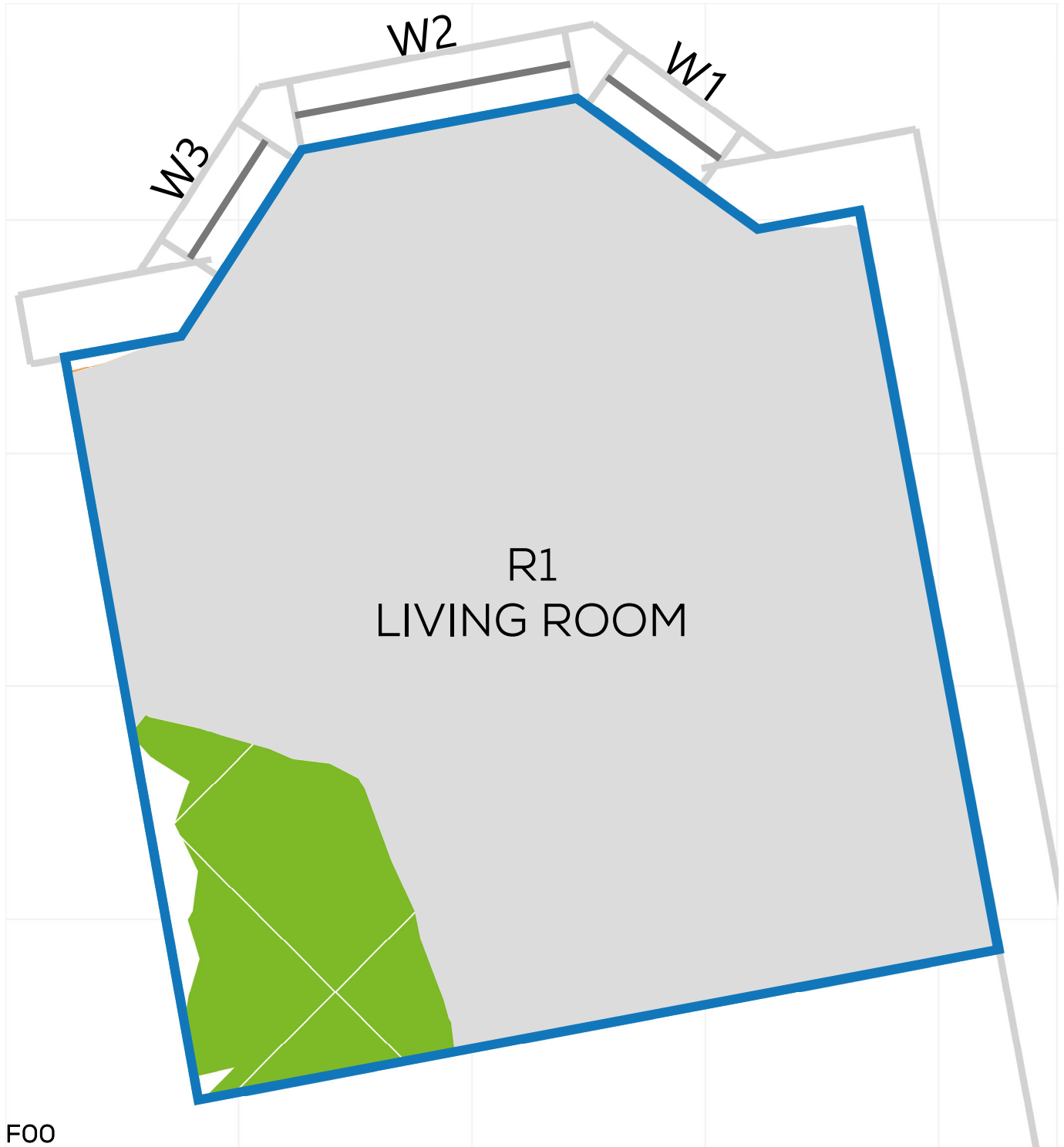
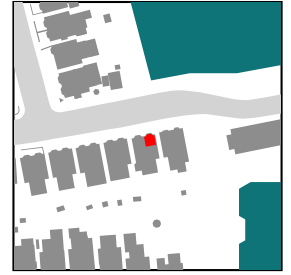

# NSL CONTOURS



PROJECT: 14047 - CAMBRIDGE ROAD  
REPORT TITLE: EXISTING VS. PROPOSED  
ADDRESS: 3 SOMERSET ROAD  
DATE: 02/10/2020  
SCHEME IR: IR23 (07.09.2020)  
DRAWING No.: 14047-RELO6-IS02-DD376

**KEY:**

- GAIN
- LOSS
- MAINTAINED LIT AREA
- 1 METRE GRID

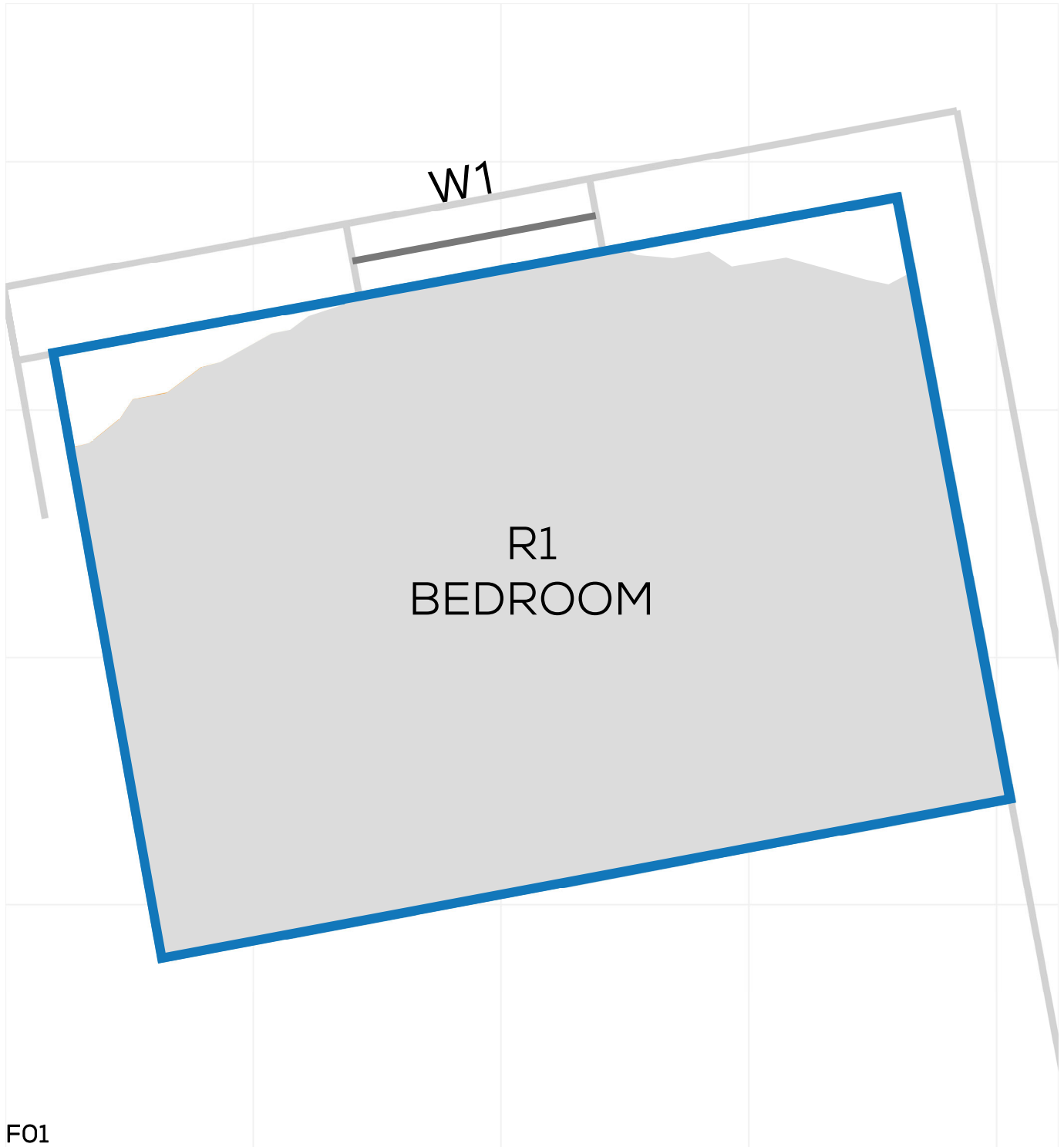





# NSL CONTOURS



PROJECT: 14047 - CAMBRIDGE ROAD  
REPORT TITLE: EXISTING VS. PROPOSED  
ADDRESS: 3 SOMERSET ROAD  
DATE: 02/10/2020  
SCHEME IR: IR23 (07.09.2020)  
DRAWING No.: 14047-RELO6-IS02-DD377

## KEY:

-  GAIN
-  LOSS
-  MAINTAINED LIT AREA
-  1 METRE GRID

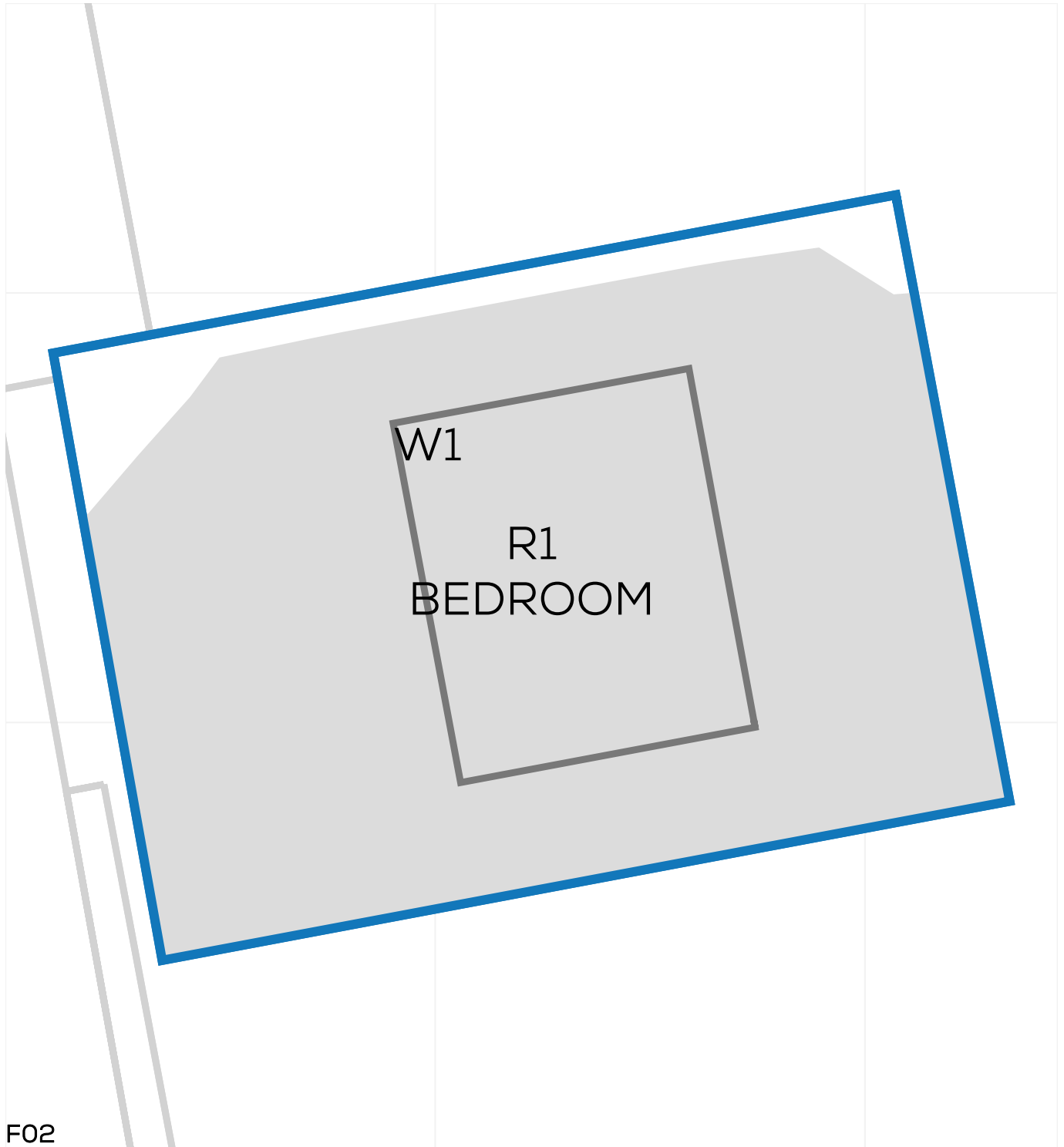

F02

# NSL CONTOURS



PROJECT: 14047 - CAMBRIDGE ROAD  
REPORT TITLE: EXISTING VS. PROPOSED  
ADDRESS: 4 SOMERSET ROAD  
DATE: 02/10/2020  
SCHEME IR: IR23 (07.09.2020)  
DRAWING No.: 14047-RELO6-IS02-DD378

**KEY:**

- GAIN
- LOSS
- MAINTAINED LIT AREA
- 1 METRE GRID

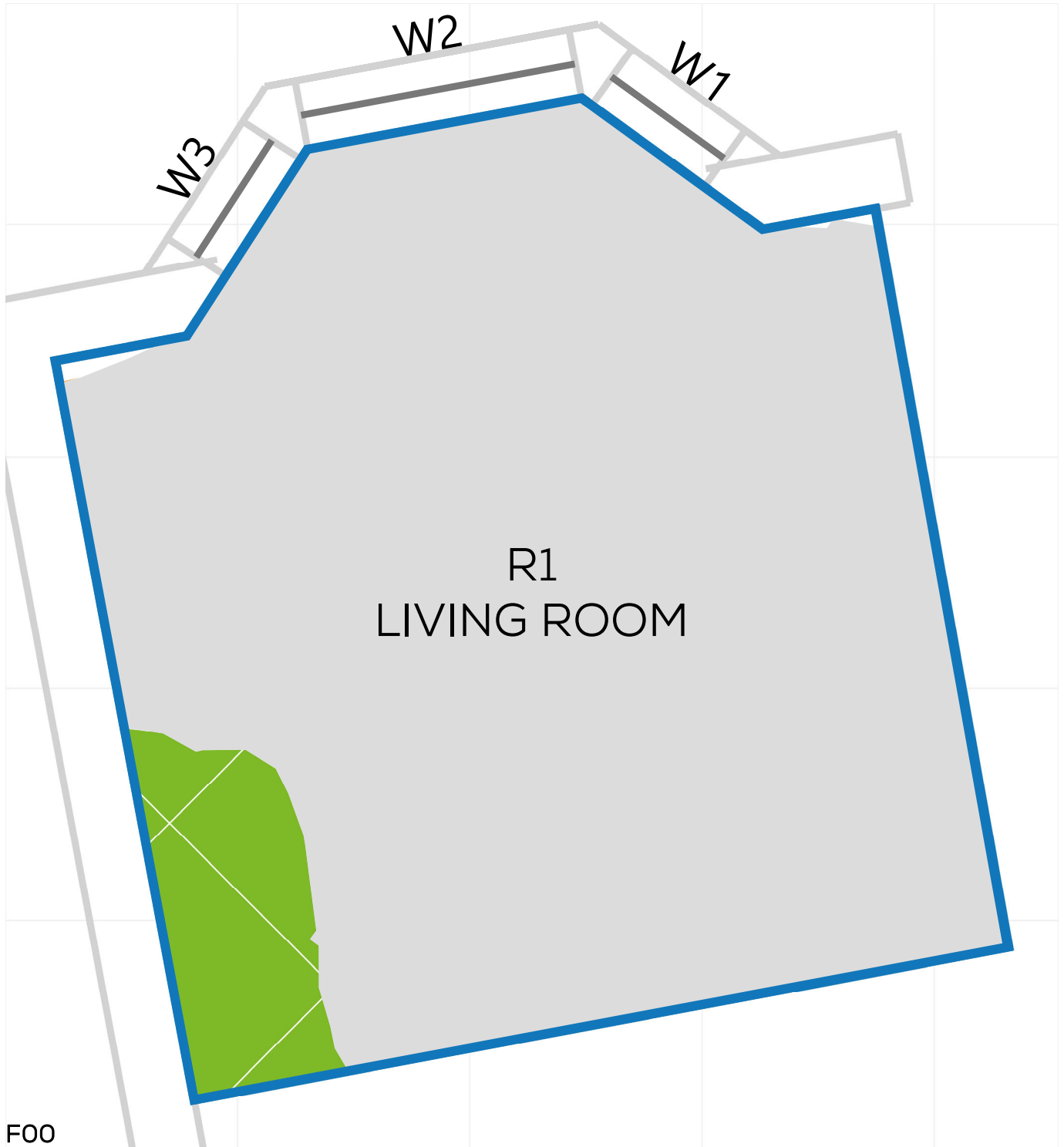



# NSL CONTOURS



PROJECT: 14047 - CAMBRIDGE ROAD  
REPORT TITLE: EXISTING VS. PROPOSED  
ADDRESS: 4 SOMERSET ROAD  
DATE: 02/10/2020  
SCHEME IR: IR23 (07.09.2020)  
DRAWING No.: 14047-RELO6-IS02-DD379

## KEY:

- GAIN
- LOSS
- MAINTAINED LIT AREA
- 1 METRE GRID

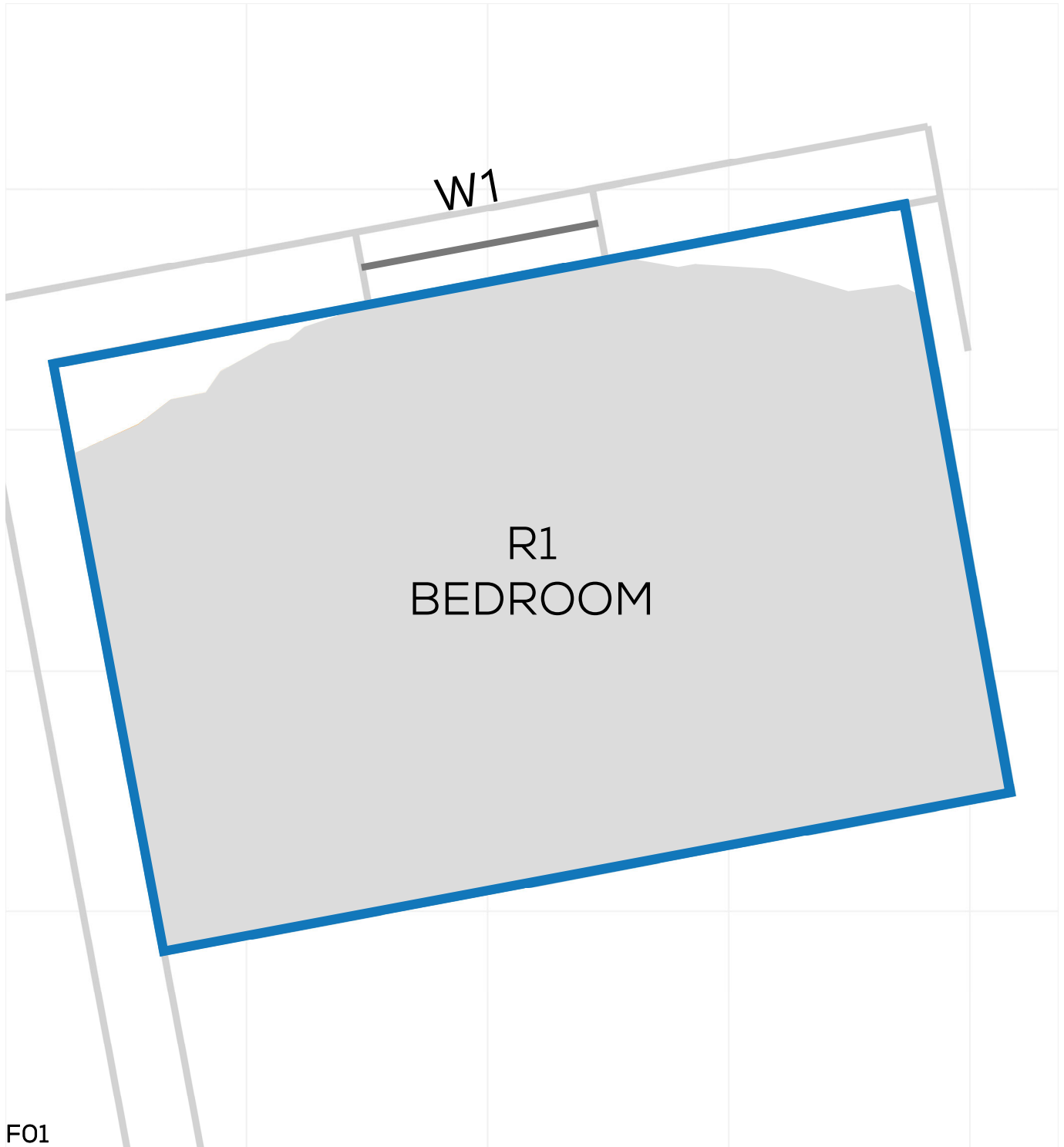





# NSL CONTOURS



PROJECT: 14047 - CAMBRIDGE ROAD  
REPORT TITLE: EXISTING VS. PROPOSED  
ADDRESS: 4 SOMERSET ROAD  
DATE: 02/10/2020  
SCHEME IR: IR23 (07.09.2020)  
DRAWING No.: 14047-RELO6-IS02-DD380

## KEY:

-  GAIN
-  LOSS
-  MAINTAINED LIT AREA
-  1 METRE GRID

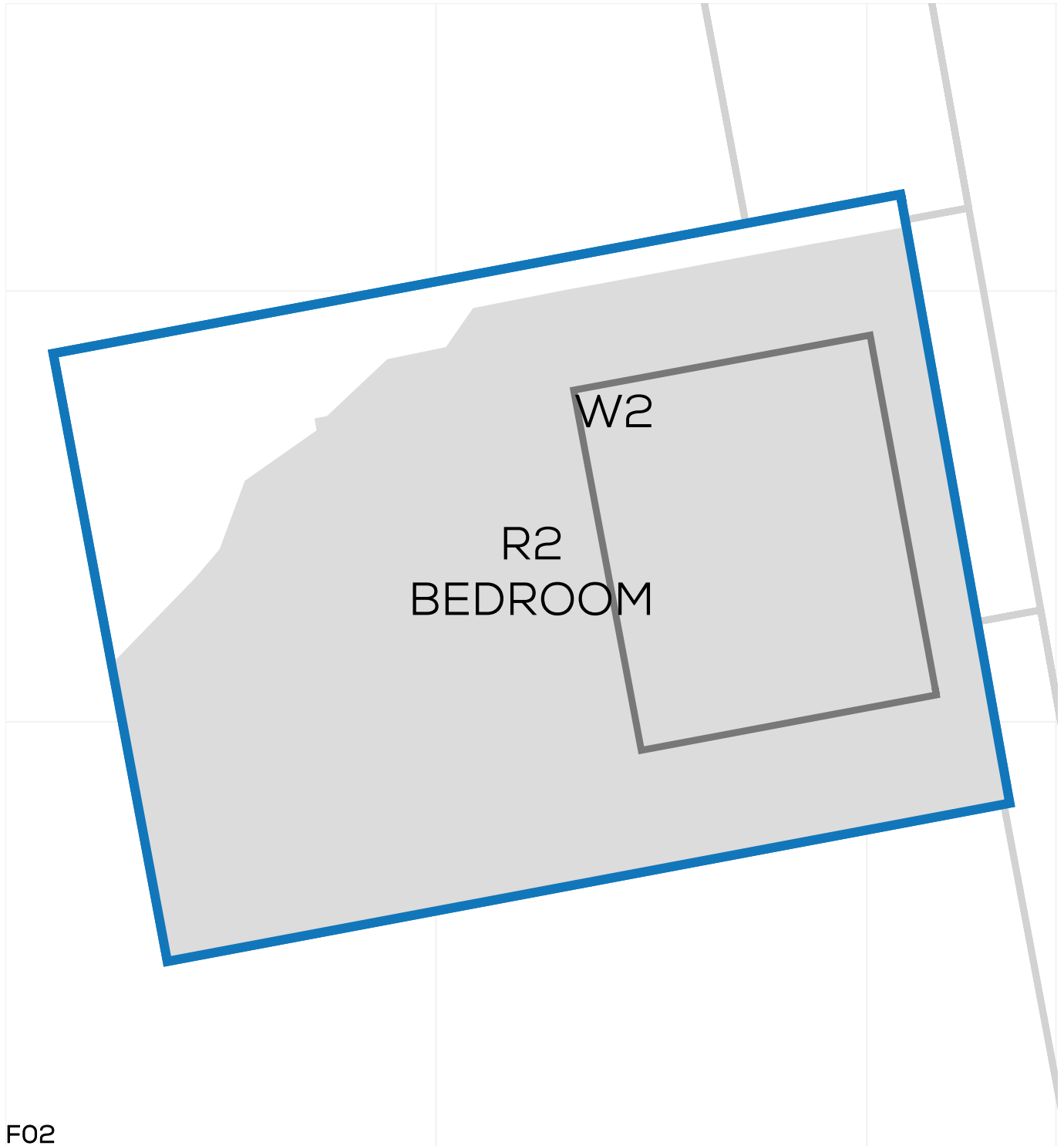

# NSL CONTOURS



PROJECT: 14047 - CAMBRIDGE ROAD  
REPORT TITLE: EXISTING VS. PROPOSED  
ADDRESS: 29 ROWLLS ROAD  
DATE: 02/10/2020  
SCHEME IR: IR23 (07.09.2020)  
DRAWING No.: 14047-RELO6-IS02-DD381

## KEY:

- GAIN
- LOSS
- MAINTAINED LIT AREA
- 1 METRE GRID

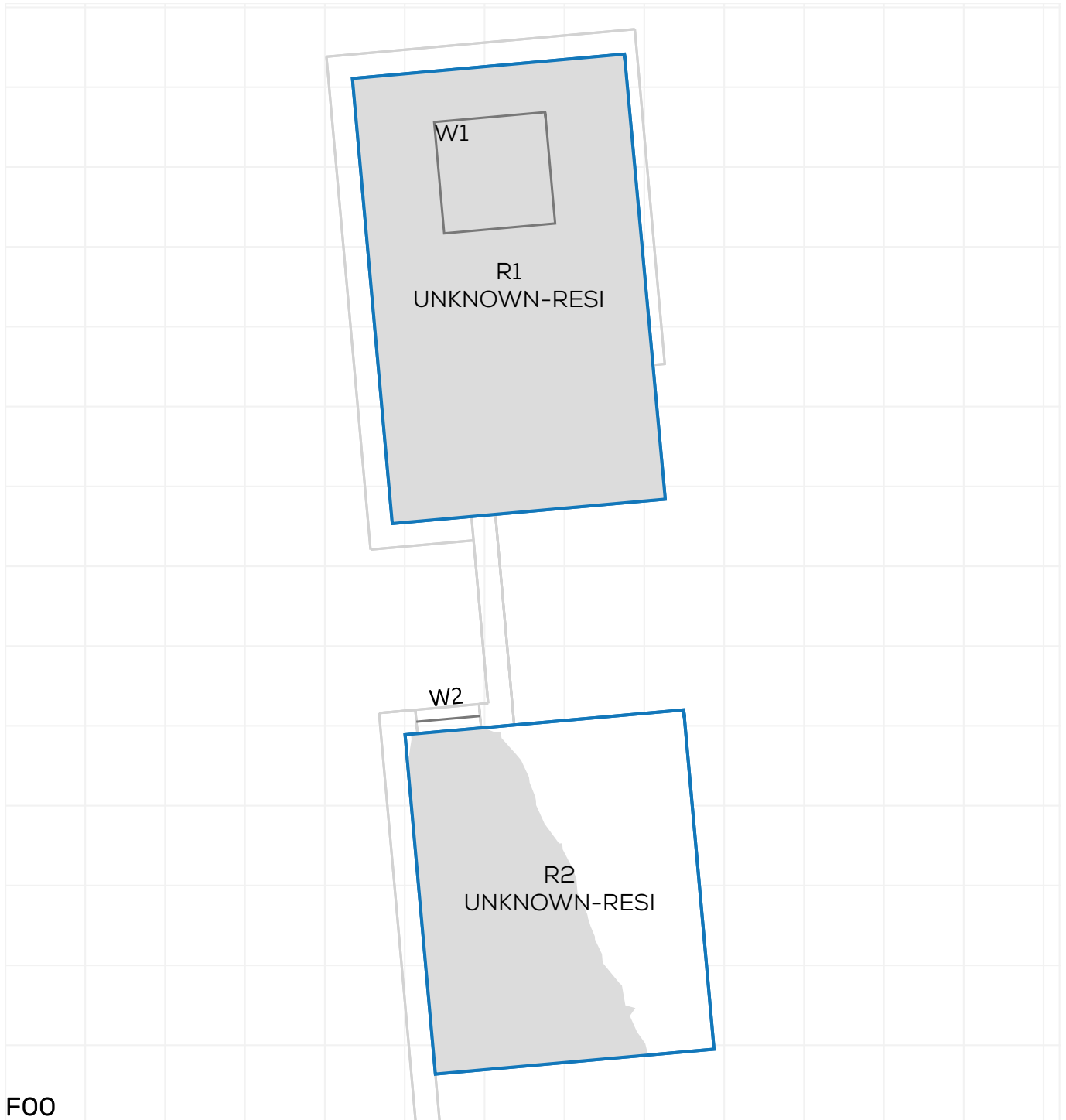

FOO

# NSL CONTOURS



PROJECT: 14047 - CAMBRIDGE ROAD  
REPORT TITLE: EXISTING VS. PROPOSED  
ADDRESS: 29 ROWLLS ROAD  
DATE: 02/10/2020  
SCHEME IR: IR23 (07.09.2020)  
DRAWING No.: 14047-RELO6-IS02-DD382

## KEY:

- GAIN
- LOSS
- MAINTAINED LIT AREA
- 1 METRE GRID

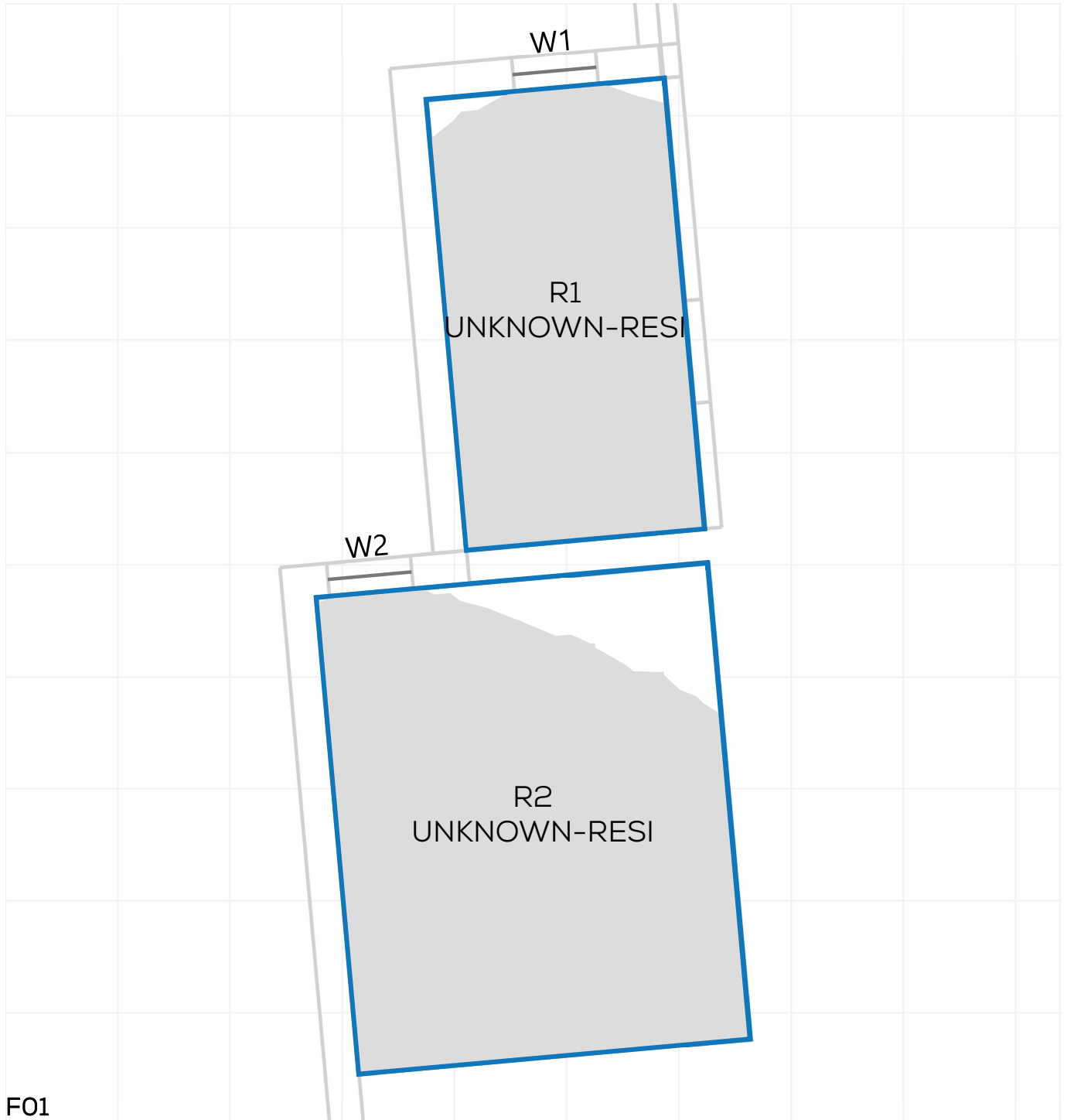

# NSL CONTOURS



PROJECT: 14047 - CAMBRIDGE ROAD  
REPORT TITLE: EXISTING VS. PROPOSED  
ADDRESS: 31 ROWLLS ROAD  
DATE: 02/10/2020  
SCHEME IR: IR23 (07.09.2020)  
DRAWING No.: 14047-RELO6-IS02-DD383

### KEY:

- GAIN
- LOSS
- MAINTAINED LIT AREA
- 1 METRE GRID

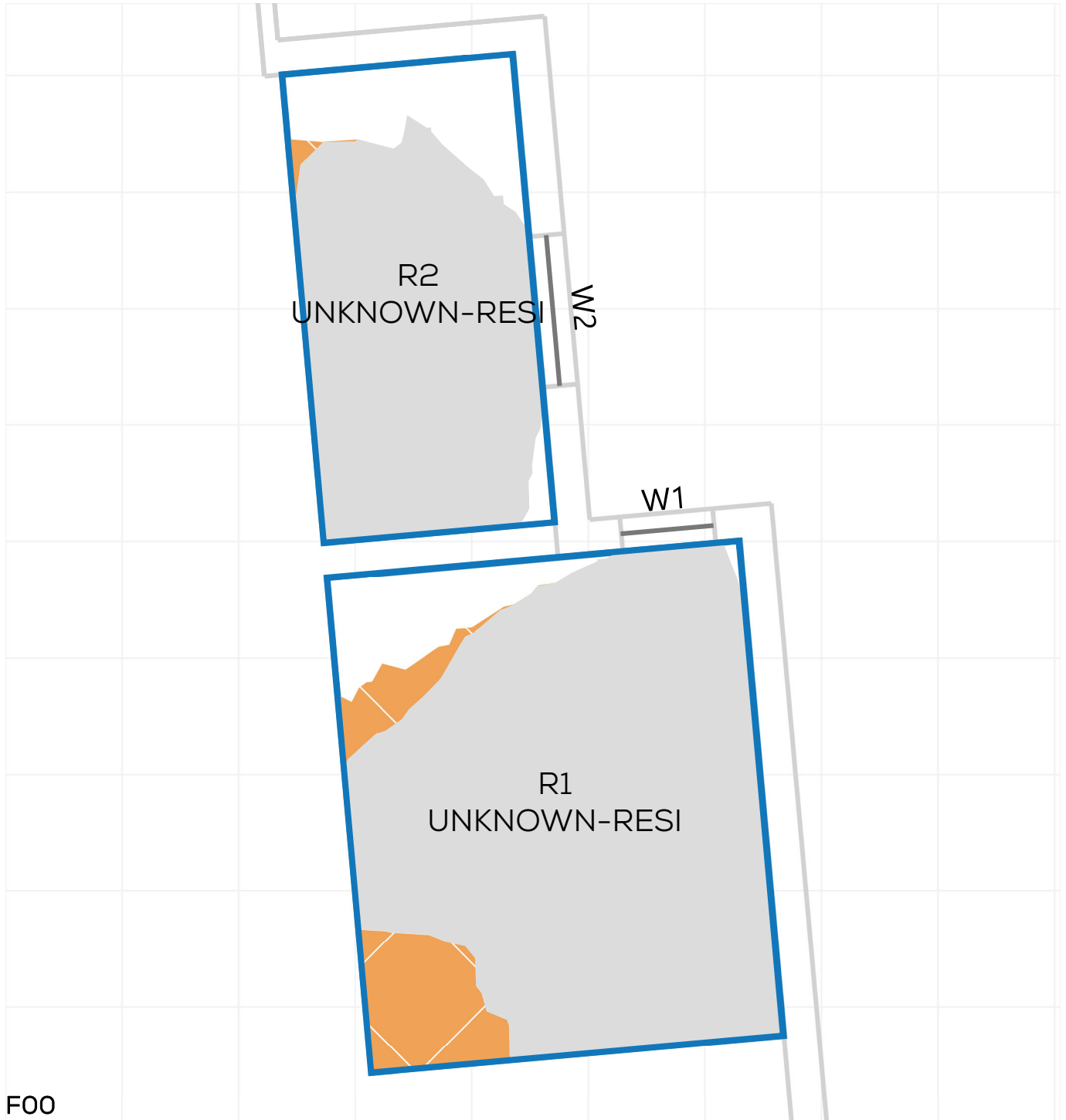
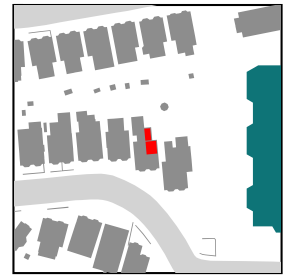

# NSL CONTOURS



PROJECT: 14047 - CAMBRIDGE ROAD  
REPORT TITLE: EXISTING VS. PROPOSED  
ADDRESS: 31 ROWLLS ROAD  
DATE: 02/10/2020  
SCHEME IR: IR23 (07.09.2020)  
DRAWING No.: 14047-RELO6-IS02-DD384

### KEY:

- GAIN
- LOSS
- MAINTAINED LIT AREA
- 1 METRE GRID



F01

# NSL CONTOURS



PROJECT: 14047 - CAMBRIDGE ROAD  
REPORT TITLE: EXISTING VS. PROPOSED  
ADDRESS: 30 ROWLLS ROAD  
DATE: 02/10/2020  
SCHEME IR: IR23 (07.09.2020)  
DRAWING No.: 14047-RELO6-IS02-DD385

**KEY:**

- GAIN
- LOSS
- MAINTAINED LIT AREA
- 1 METRE GRID

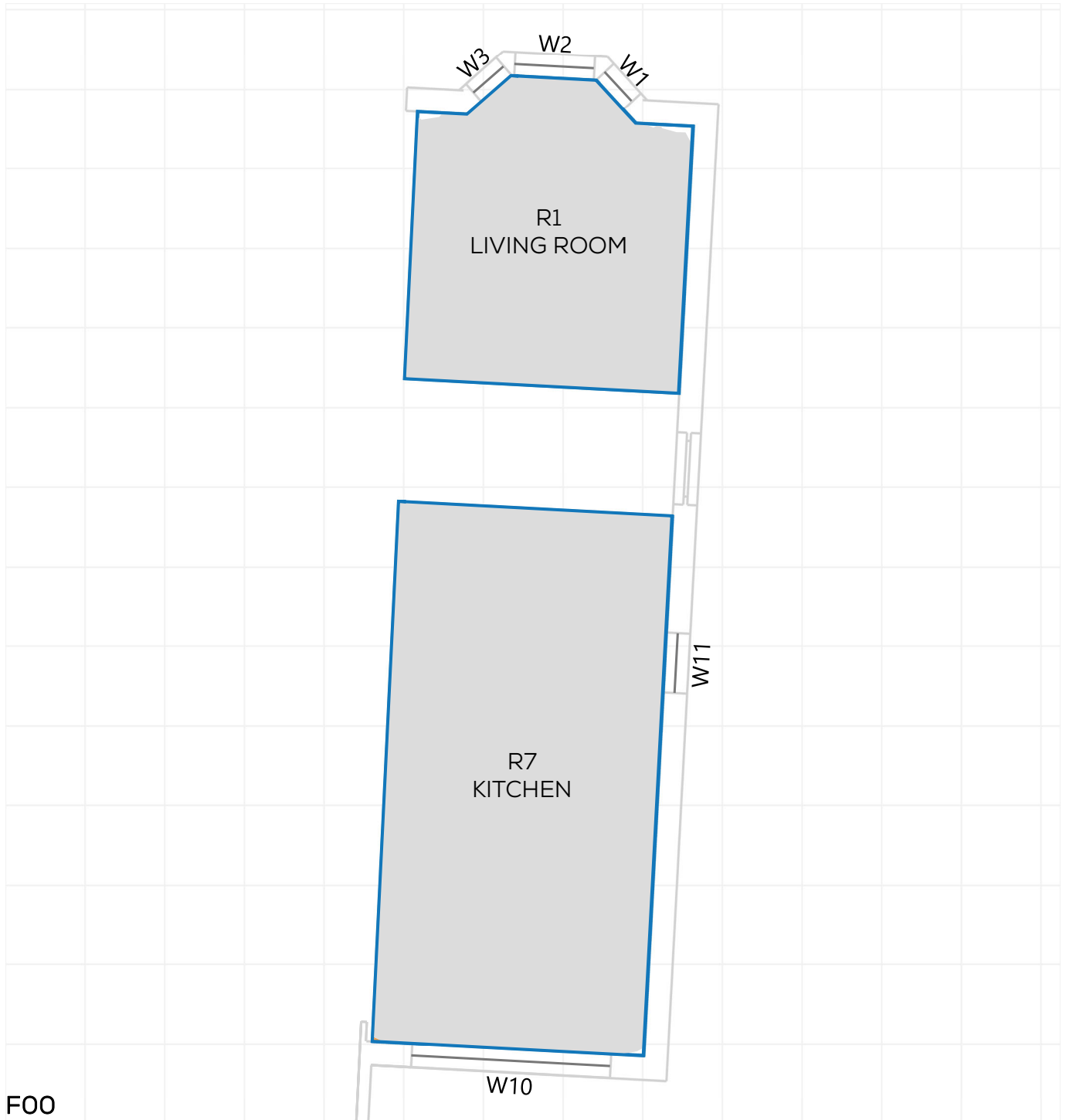

# NSL CONTOURS



PROJECT: 14047 - CAMBRIDGE ROAD  
REPORT TITLE: EXISTING VS. PROPOSED  
ADDRESS: 30 ROWLLS ROAD  
DATE: 02/10/2020  
SCHEME IR: IR23 (07.09.2020)  
DRAWING No.: 14047-RELO6-IS02-DD386

## KEY:

- GAIN
- LOSS
- MAINTAINED LIT AREA
- 1 METRE GRID

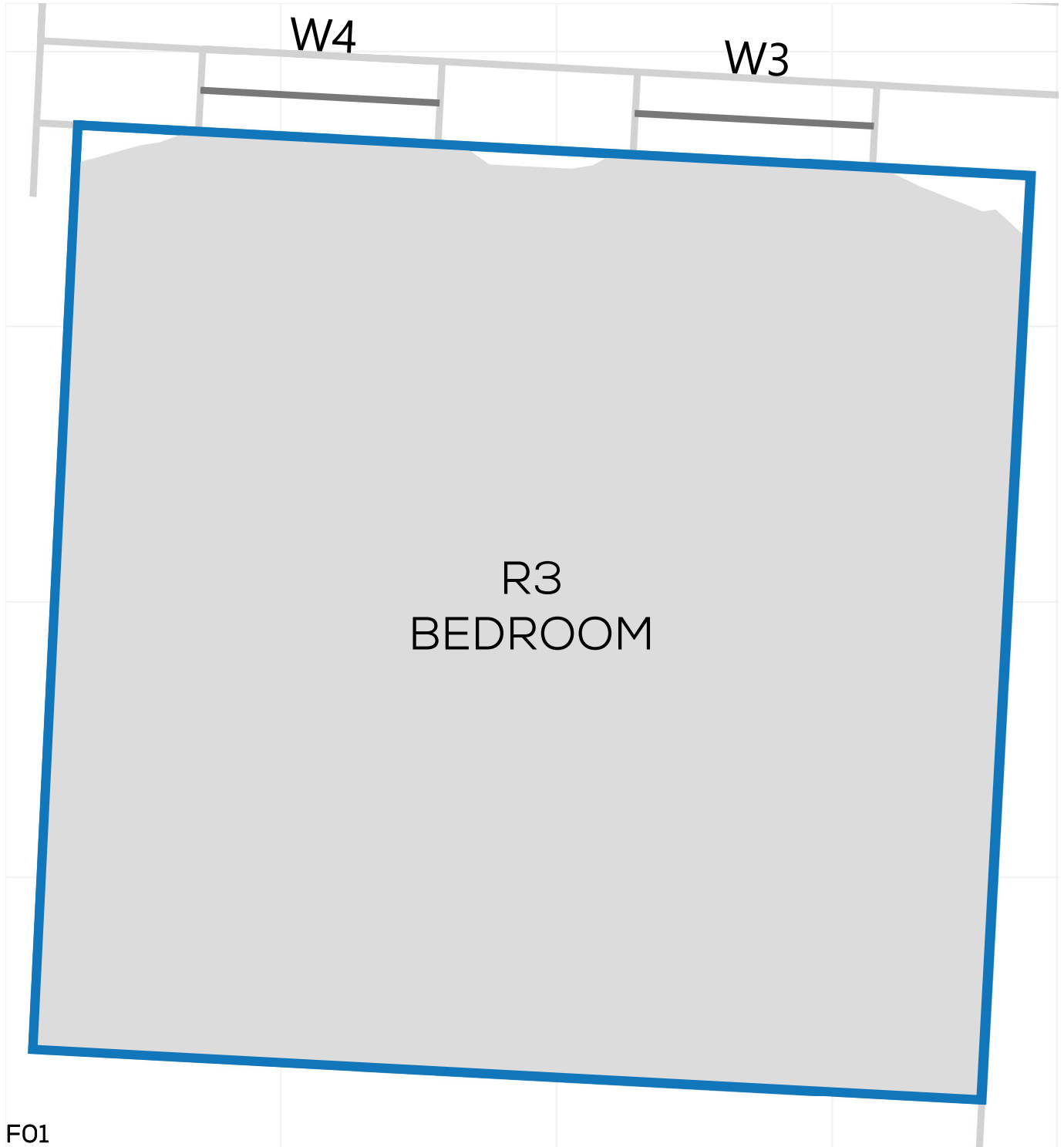



# NSL CONTOURS



PROJECT: 14047 - CAMBRIDGE ROAD  
REPORT TITLE: EXISTING VS. PROPOSED  
ADDRESS: 30 ROWLLS ROAD  
DATE: 02/10/2020  
SCHEME IR: IR23 (07.09.2020)  
DRAWING No.: 14047-RELO6-IS02-DD387

### KEY:

- GAIN
- LOSS
- MAINTAINED LIT AREA
- 1 METRE GRID

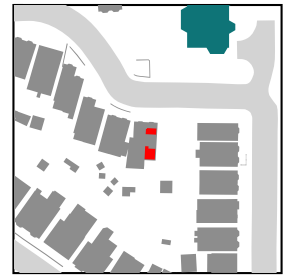

F02

# NSL CONTOURS



PROJECT: 14047 - CAMBRIDGE ROAD  
REPORT TITLE: EXISTING VS. PROPOSED  
ADDRESS: 28 ROWLLS ROAD  
DATE: 02/10/2020  
SCHEME IR: IR23 (07.09.2020)  
DRAWING No.: 14047-RELO6-IS02-DD388

## KEY:

- GAIN
- LOSS
- MAINTAINED LIT AREA
- 1 METRE GRID

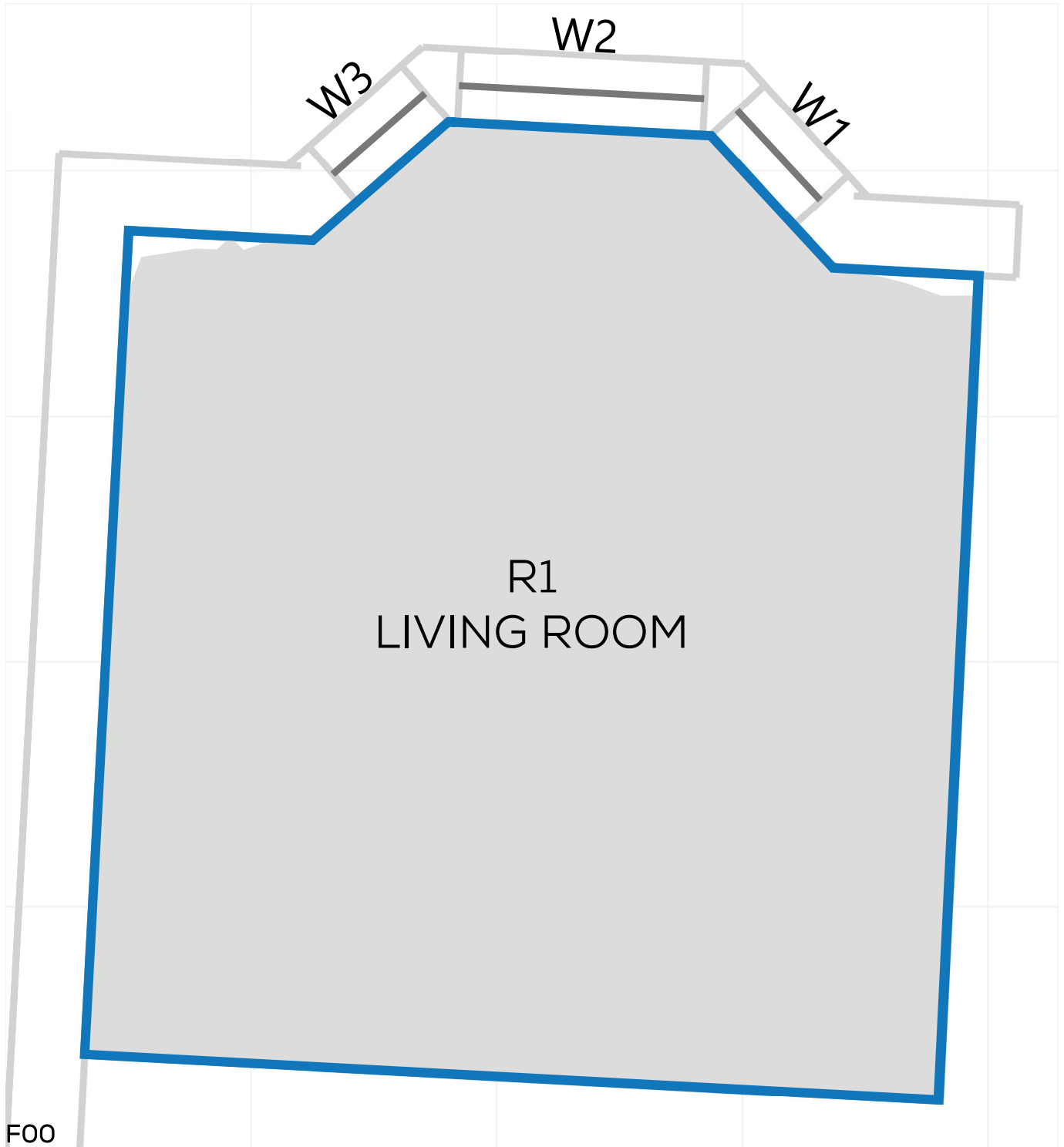

# NSL CONTOURS



PROJECT: 14047 - CAMBRIDGE ROAD  
REPORT TITLE: EXISTING VS. PROPOSED  
ADDRESS: 28 ROWLLS ROAD  
DATE: 02/10/2020  
SCHEME IR: IR23 (07.09.2020)  
DRAWING No.: 14047-RELO6-IS02-DD389

**KEY:**

- GAIN
- LOSS
- MAINTAINED LIT AREA
- 1 METRE GRID

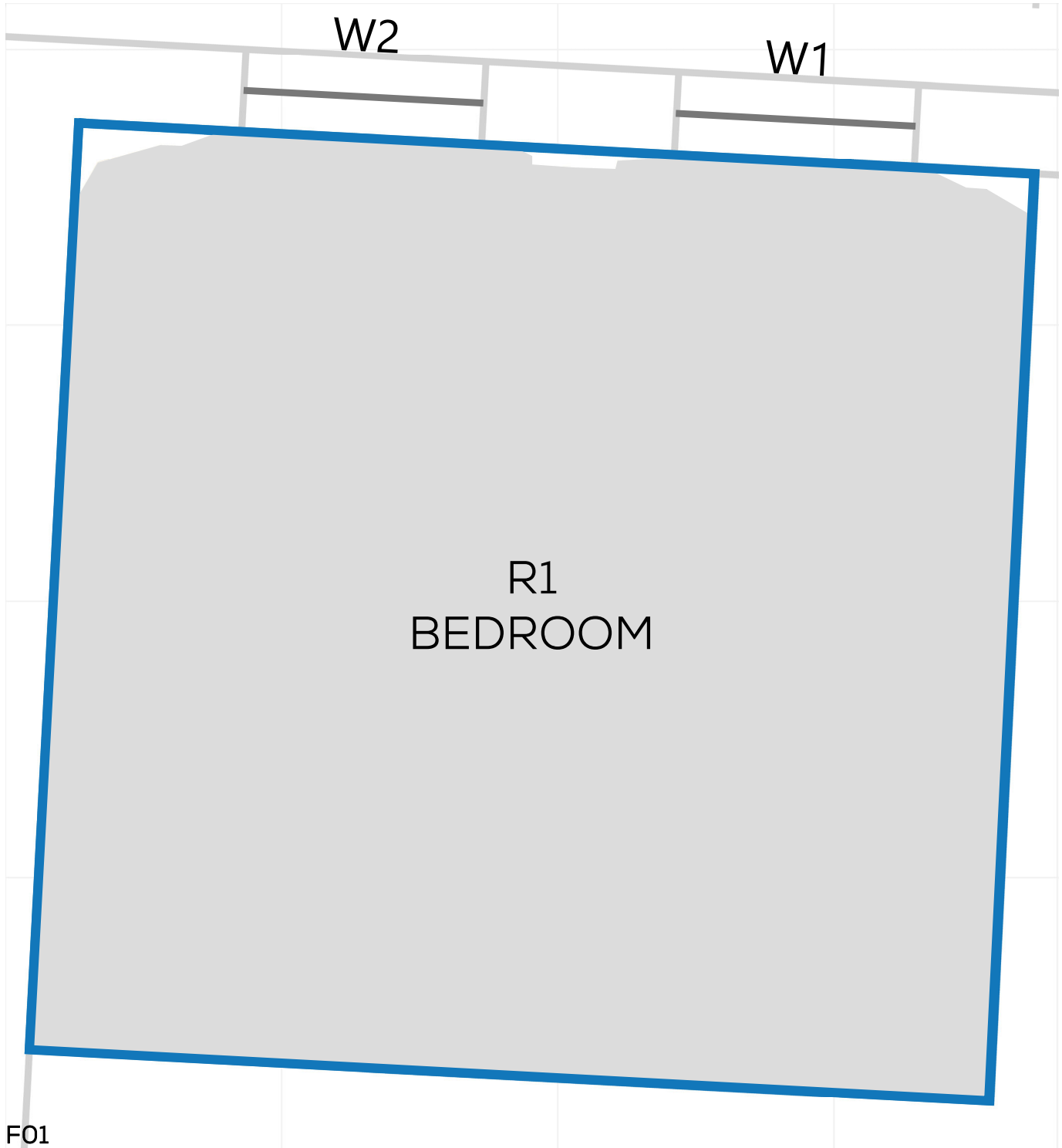

# NSL CONTOURS



PROJECT: 14047 - CAMBRIDGE ROAD  
REPORT TITLE: EXISTING VS. PROPOSED  
ADDRESS: 28 ROWLLS ROAD  
DATE: 02/10/2020  
SCHEME IR: IR23 (07.09.2020)  
DRAWING No.: 14047-RELO6-IS02-DD390

## KEY:

- GAIN
- LOSS
- MAINTAINED LIT AREA
- 1 METRE GRID

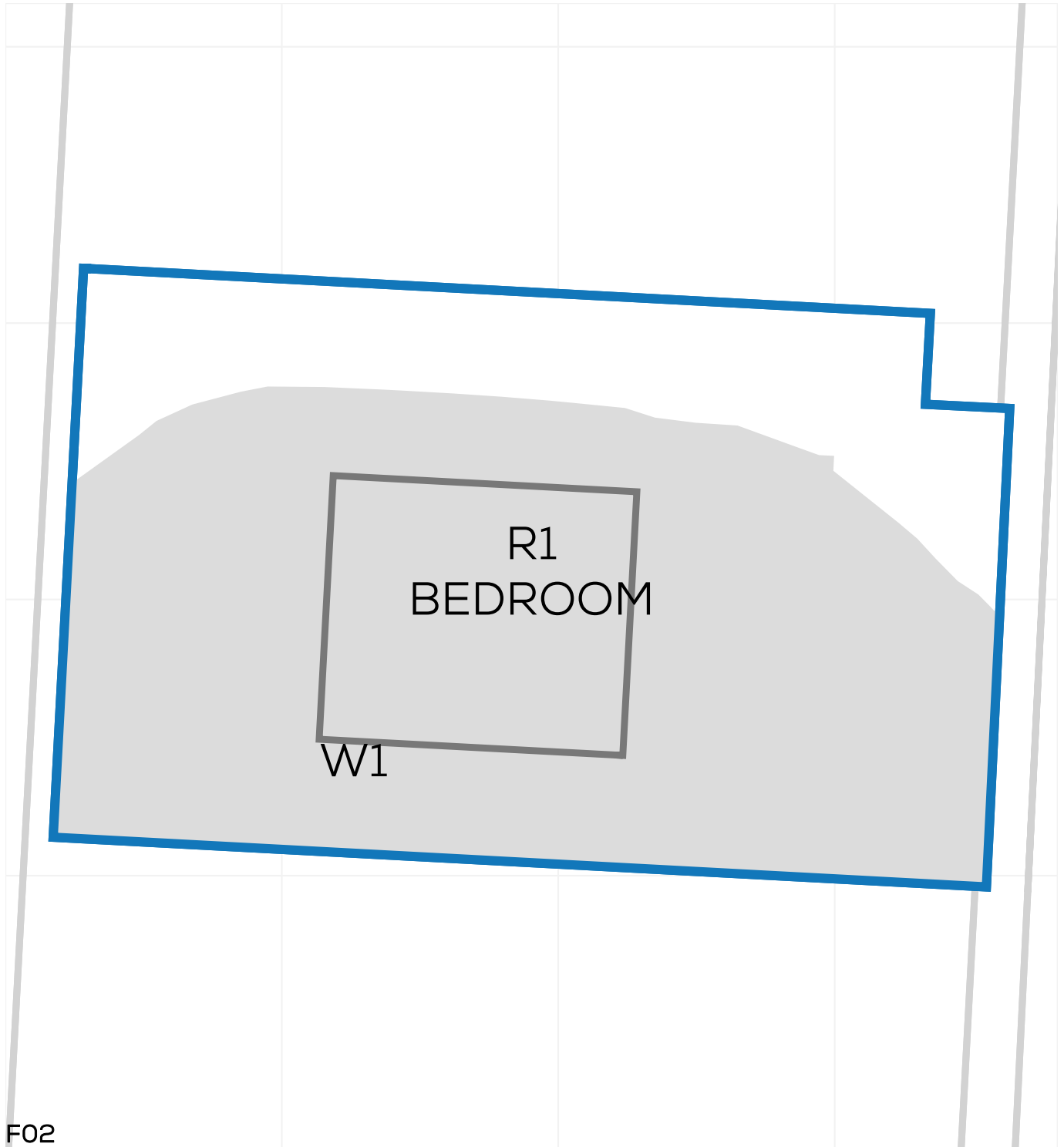

# NSL CONTOURS



PROJECT: 14047 - CAMBRIDGE ROAD  
REPORT TITLE: EXISTING VS. PROPOSED  
ADDRESS: 26 ROWLLS ROAD  
DATE: 02/10/2020  
SCHEME IR: IR23 (07.09.2020)  
DRAWING No.: 14047-RELO6-IS02-DD391

**KEY:**

- GAIN
- LOSS
- MAINTAINED LIT AREA
- 1 METRE GRID

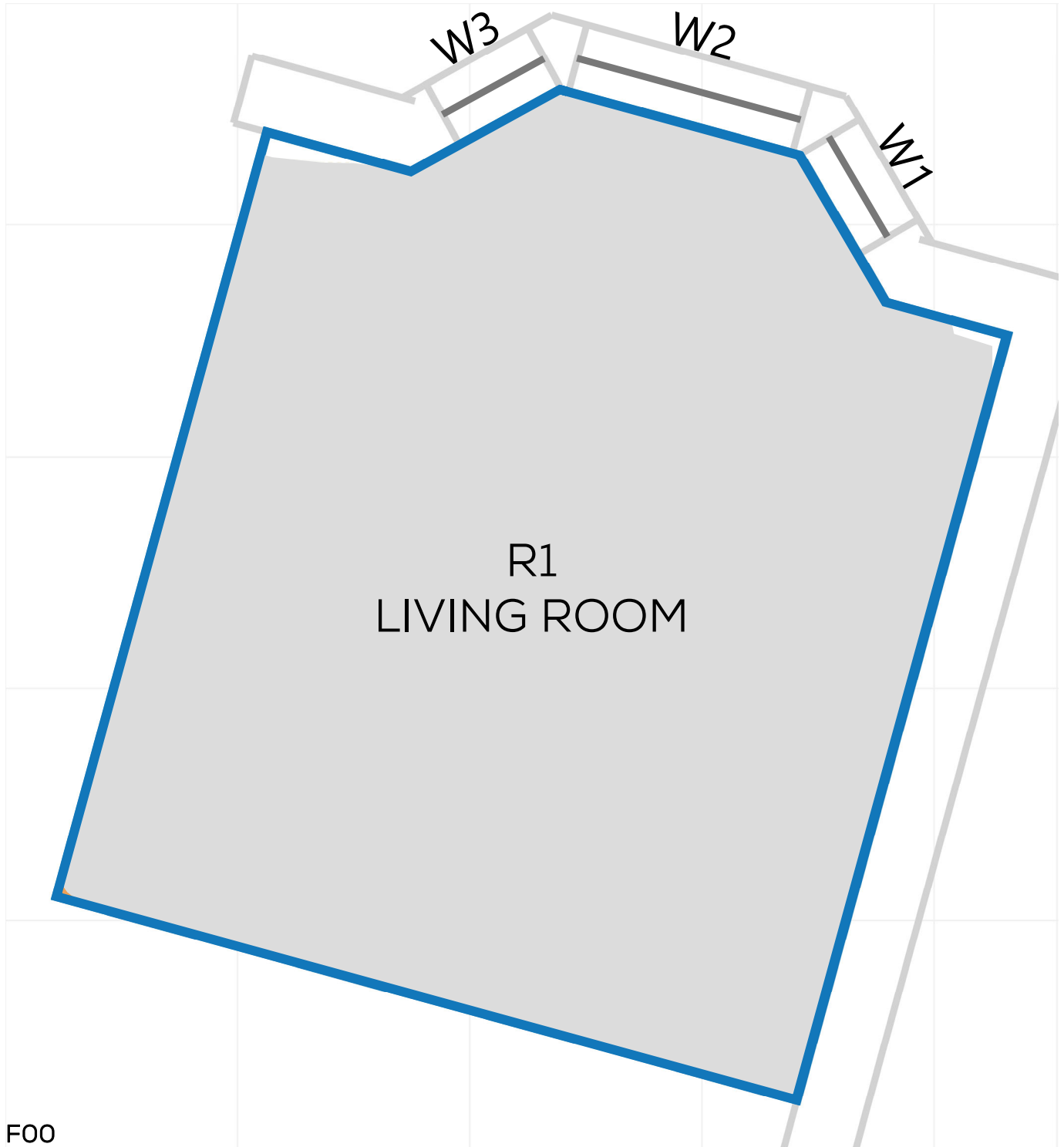

# NSL CONTOURS



PROJECT: 14047 - CAMBRIDGE ROAD  
REPORT TITLE: EXISTING VS. PROPOSED  
ADDRESS: 26 ROWLLS ROAD  
DATE: 02/10/2020  
SCHEME IR: IR23 (07.09.2020)  
DRAWING No.: 14047-RELO6-IS02-DD392

## KEY:

- GAIN
- LOSS
- MAINTAINED LIT AREA
- 1 METRE GRID

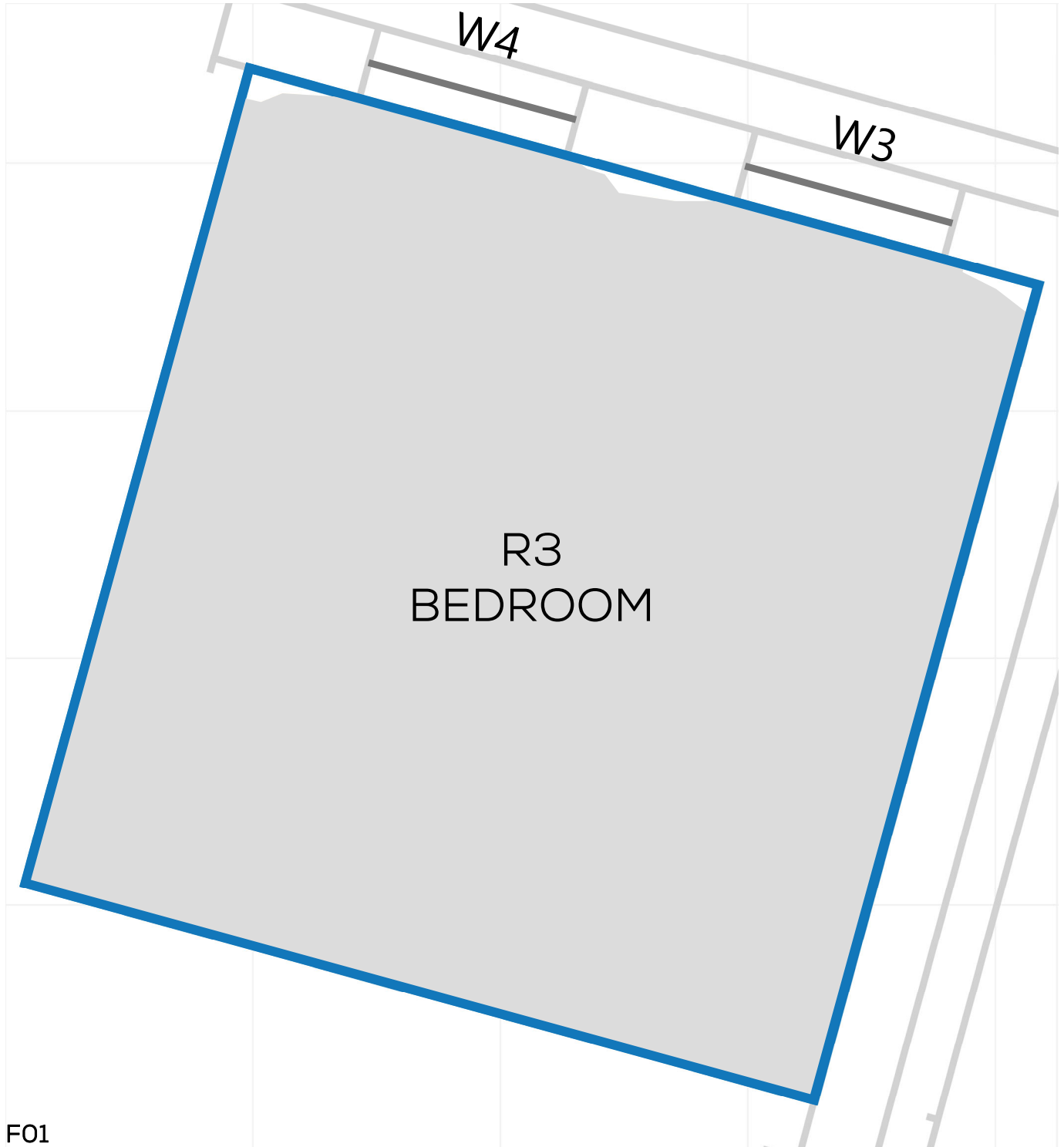





# NSL CONTOURS



PROJECT: 14047 - CAMBRIDGE ROAD  
REPORT TITLE: EXISTING VS. PROPOSED  
ADDRESS: 26 ROWLLS ROAD  
DATE: 02/10/2020  
SCHEME IR: IR23 (07.09.2020)  
DRAWING No.: 14047-RELO6-IS02-DD393

## KEY:

-  GAIN
-  LOSS
-  MAINTAINED LIT AREA
-  1 METRE GRID

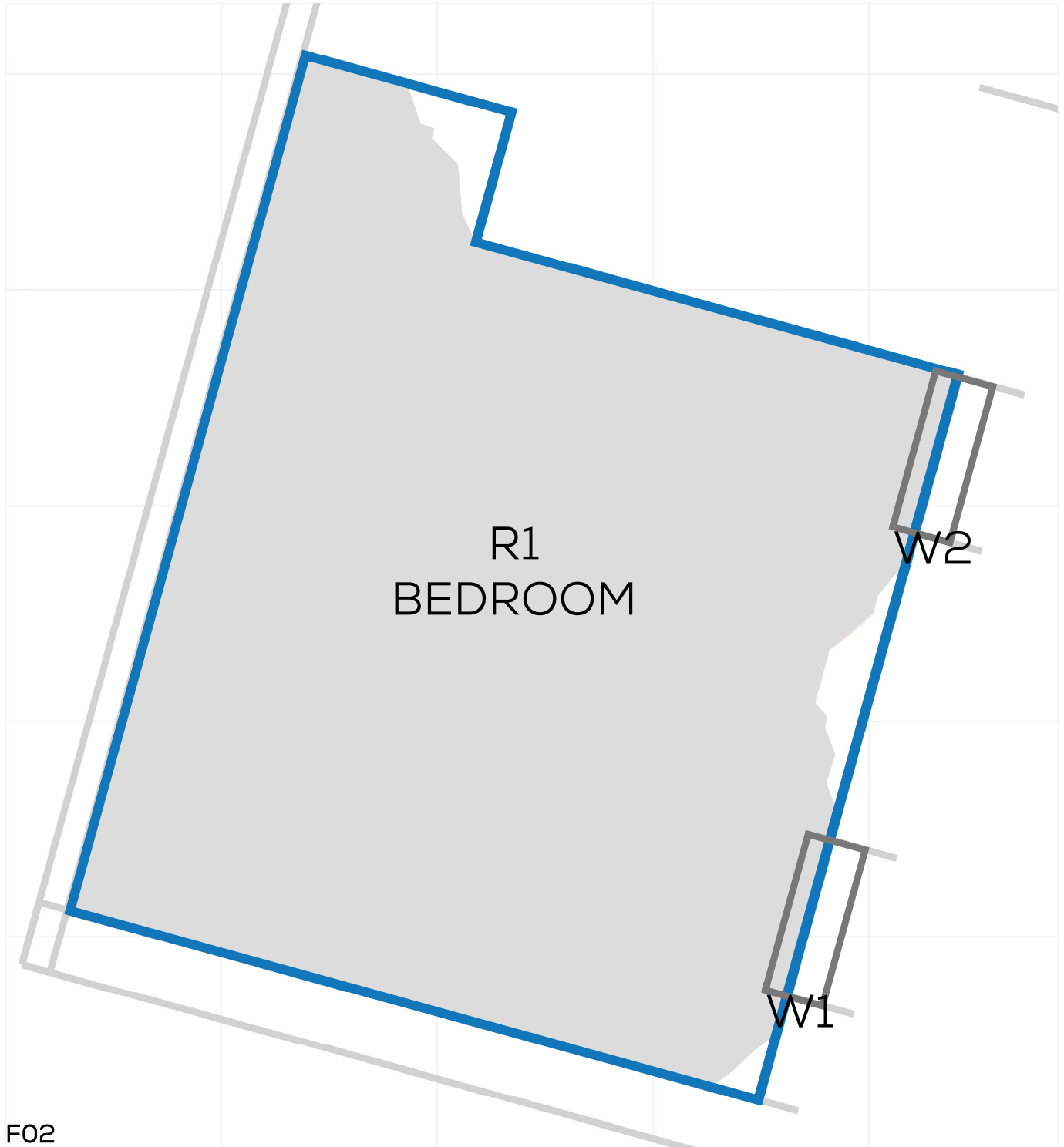

# NSL CONTOURS



PROJECT: 14047 - CAMBRIDGE ROAD  
REPORT TITLE: EXISTING VS. PROPOSED  
ADDRESS: 24 ROWLLS ROAD  
DATE: 02/10/2020  
SCHEME IR: IR23 (07.09.2020)  
DRAWING No.: 14047-RELO6-IS02-DD394

**KEY:**

- GAIN
- LOSS
- MAINTAINED LIT AREA
- 1 METRE GRID

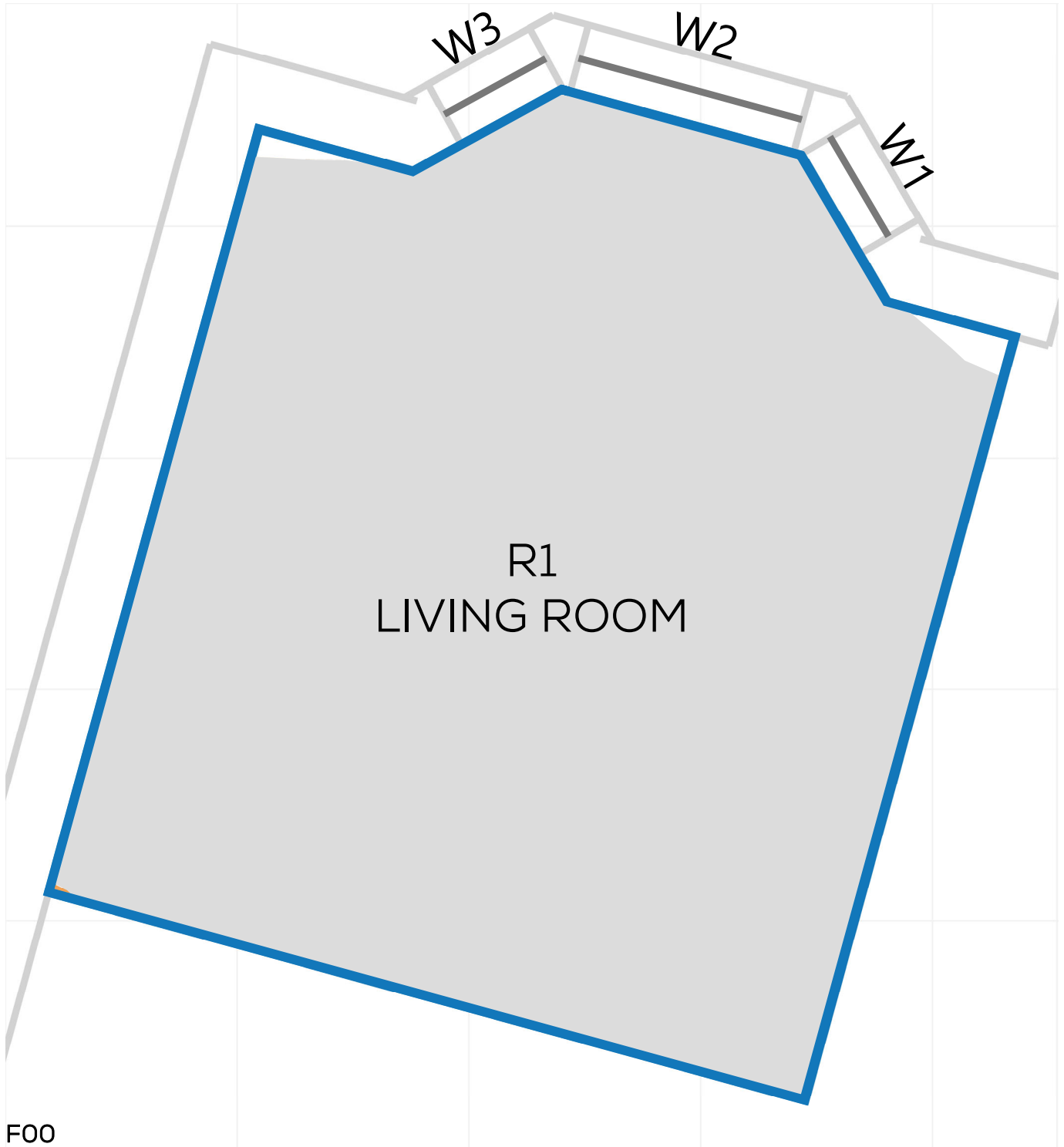



# NSL CONTOURS



PROJECT: 14047 - CAMBRIDGE ROAD  
REPORT TITLE: EXISTING VS. PROPOSED  
ADDRESS: 24 ROWLLS ROAD  
DATE: 02/10/2020  
SCHEME IR: IR23 (07.09.2020)  
DRAWING No.: 14047-RELO6-IS02-DD395

**KEY:**

- GAIN
- LOSS
- MAINTAINED LIT AREA
- 1 METRE GRID

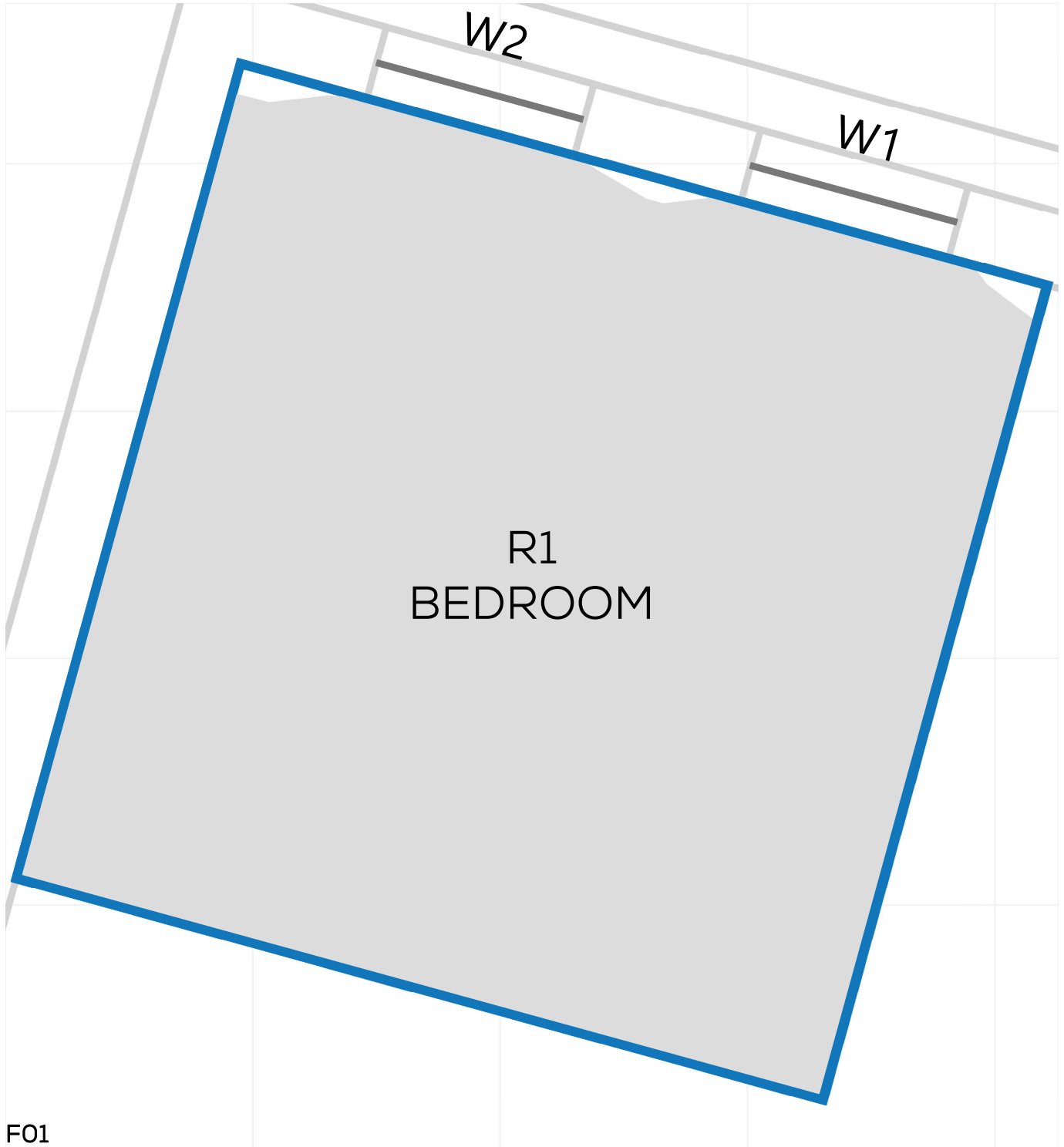

# NSL CONTOURS



PROJECT: 14047 - CAMBRIDGE ROAD  
REPORT TITLE: EXISTING VS. PROPOSED  
ADDRESS: 24 ROWLLS ROAD  
DATE: 02/10/2020  
SCHEME IR: IR23 (07.09.2020)  
DRAWING No.: 14047-RELO6-IS02-DD396

## KEY:

- GAIN
- LOSS
- MAINTAINED LIT AREA
- 1 METRE GRID

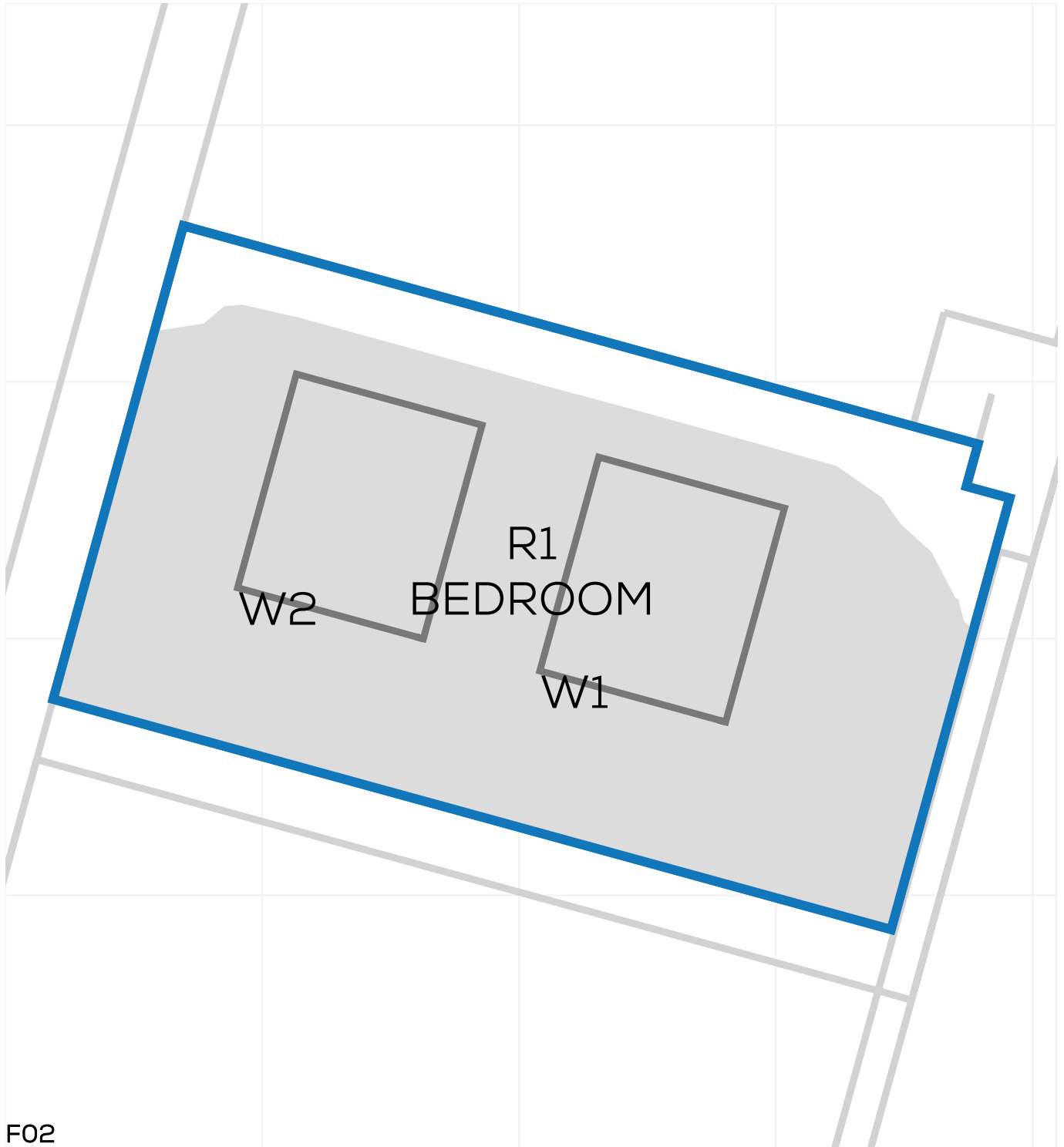

# NSL CONTOURS



PROJECT: 14047 - CAMBRIDGE ROAD  
REPORT TITLE: EXISTING VS. PROPOSED  
ADDRESS: 22 ROWLLS ROAD  
DATE: 02/10/2020  
SCHEME IR: IR23 (07.09.2020)  
DRAWING No.: 14047-RELO6-IS02-DD397

### KEY:

- GAIN
- LOSS
- MAINTAINED LIT AREA
- 1 METRE GRID

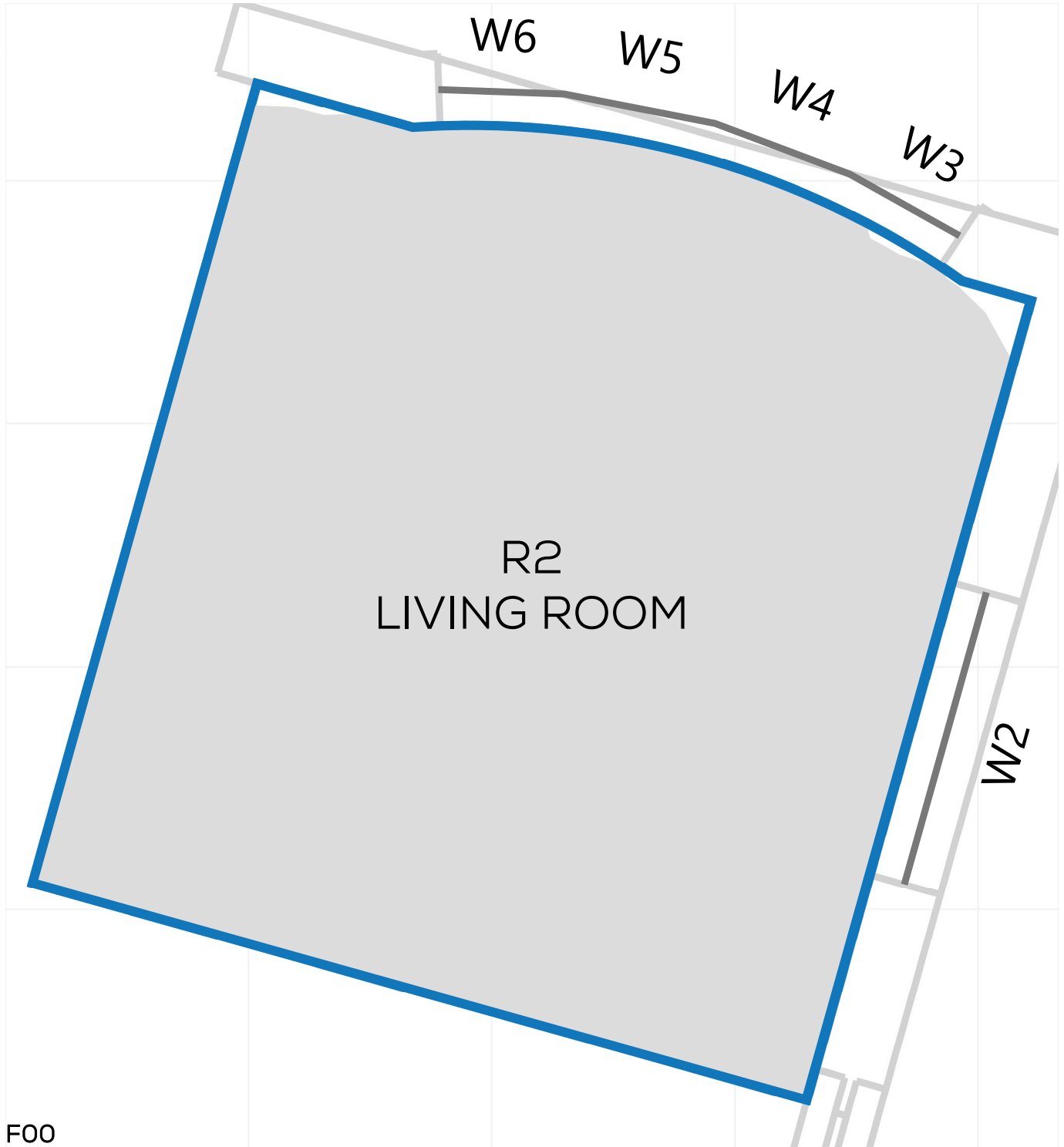
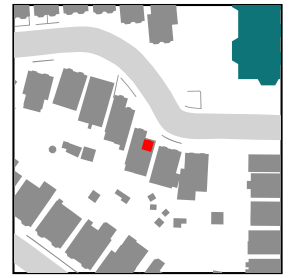

# NSL CONTOURS



PROJECT: 14047 - CAMBRIDGE ROAD  
REPORT TITLE: EXISTING VS. PROPOSED  
ADDRESS: 22 ROWLLS ROAD  
DATE: 02/10/2020  
SCHEME IR: IR23 (07.09.2020)  
DRAWING No.: 14047-RELO6-IS02-DD398

**KEY:**

- GAIN
- LOSS
- MAINTAINED LIT AREA
- 1 METRE GRID

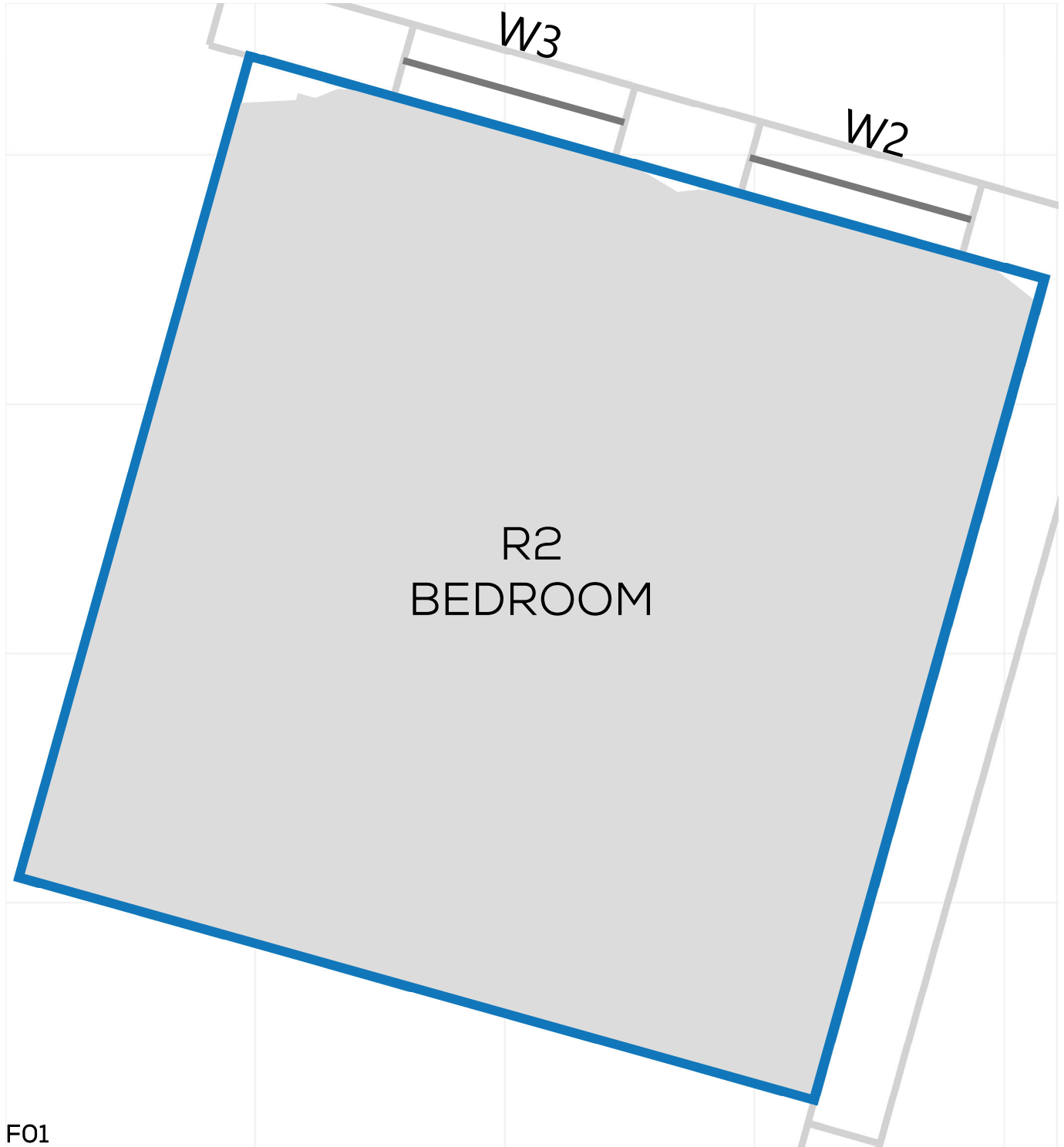

# NSL CONTOURS



PROJECT: 14047 - CAMBRIDGE ROAD  
REPORT TITLE: EXISTING VS. PROPOSED  
ADDRESS: 20 ROWLLS ROAD  
DATE: 02/10/2020  
SCHEME IR: IR23 (07.09.2020)  
DRAWING No.: 14047-RELO6-IS02-DD399

**KEY:**

- GAIN
- LOSS
- MAINTAINED LIT AREA
- 1 METRE GRID

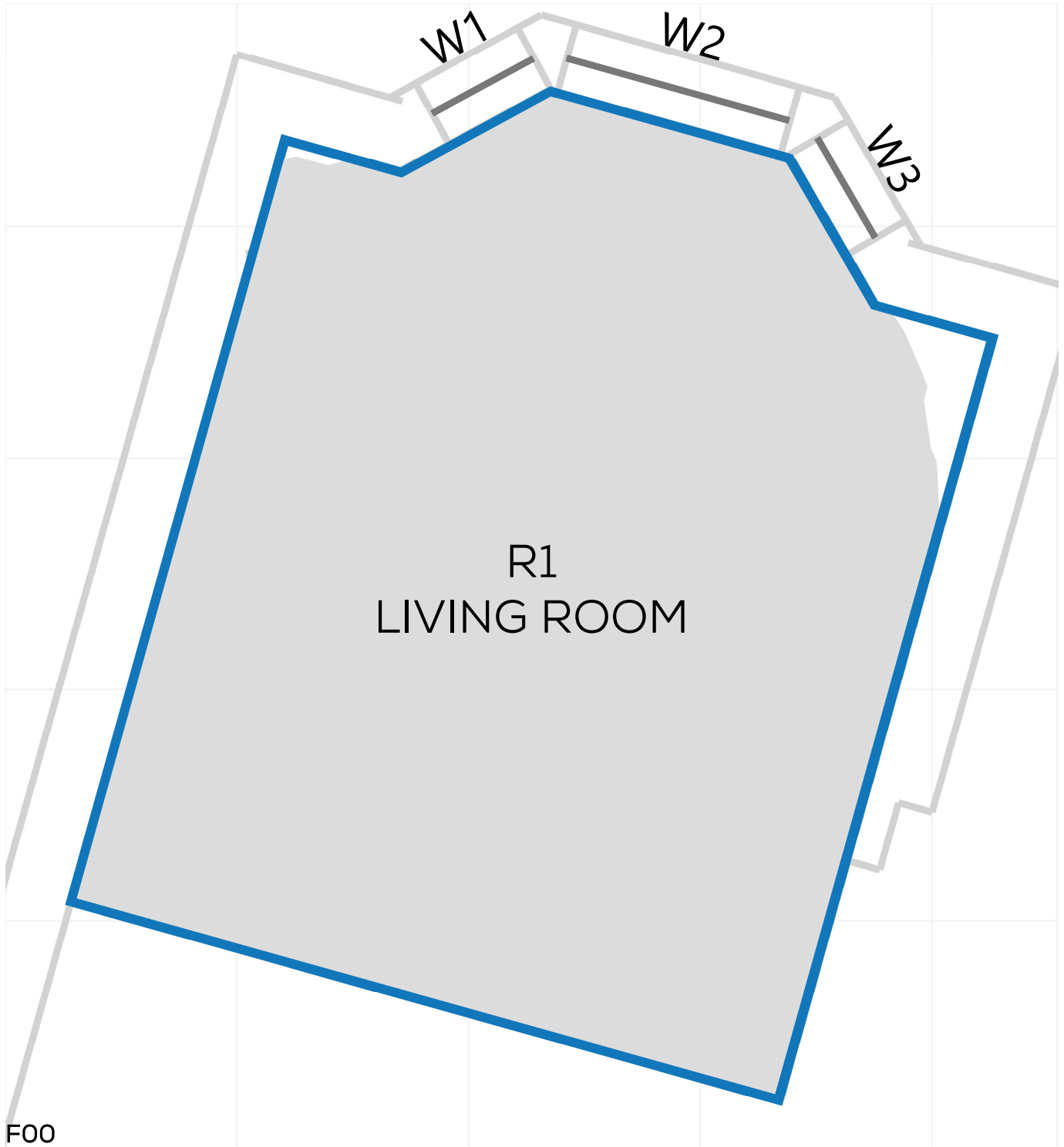

# NSL CONTOURS



PROJECT: 14047 - CAMBRIDGE ROAD  
REPORT TITLE: EXISTING VS. PROPOSED  
ADDRESS: 20 ROWLLS ROAD  
DATE: 02/10/2020  
SCHEME IR: IR23 (07.09.2020)  
DRAWING No.: 14047-RELO6-IS02-DD400

### KEY:

- GAIN
- LOSS
- MAINTAINED LIT AREA
- 1 METRE GRID

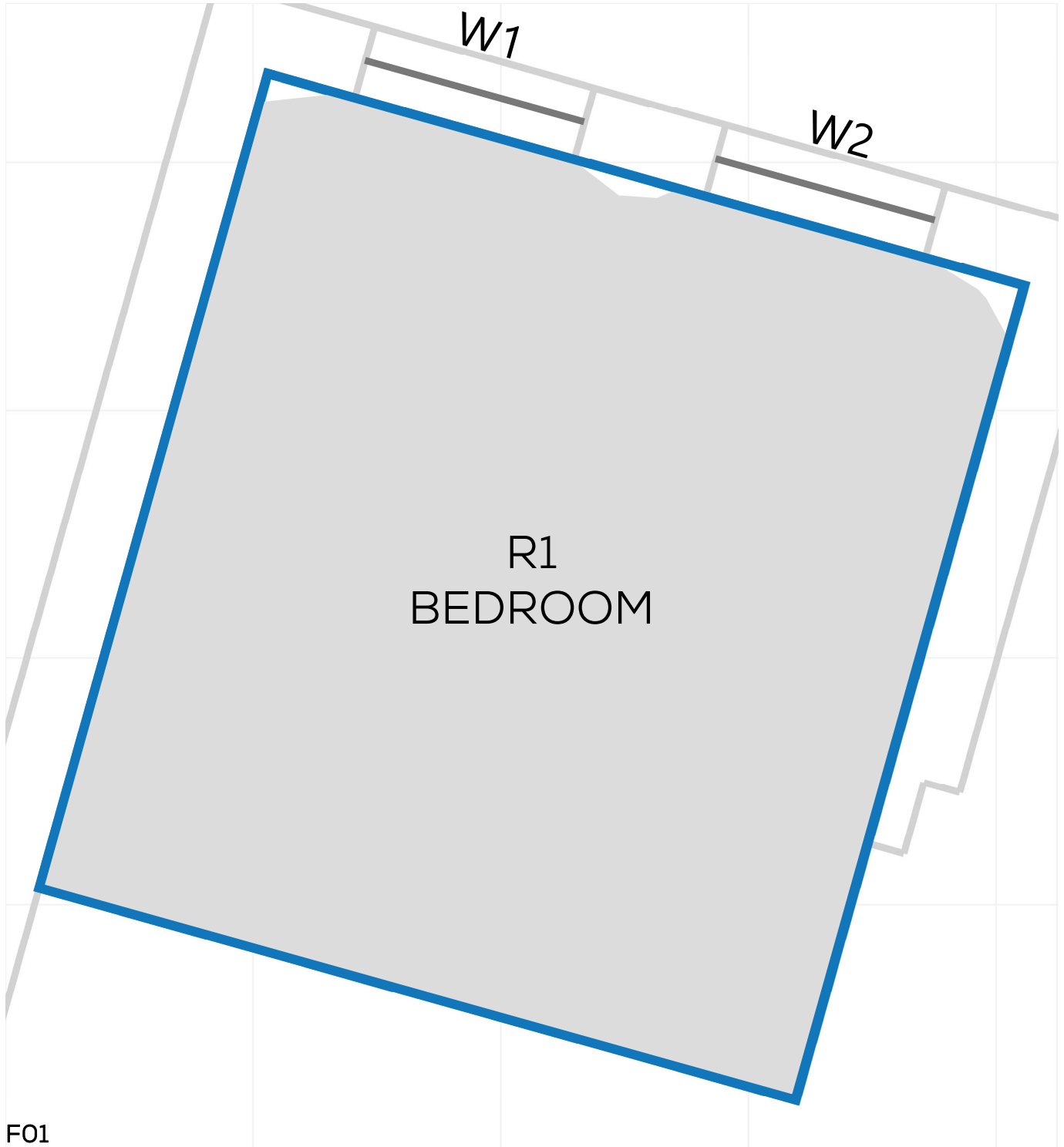





# NSL CONTOURS



PROJECT: 14047 - CAMBRIDGE ROAD  
REPORT TITLE: EXISTING VS. PROPOSED  
ADDRESS: 33 ROWLLS ROAD  
DATE: 02/10/2020  
SCHEME IR: IR23 (07.09.2020)  
DRAWING No.: 14047-RELO6-IS02-DD401

## KEY:

-  GAIN
-  LOSS
-  MAINTAINED LIT AREA
-  1 METRE GRID

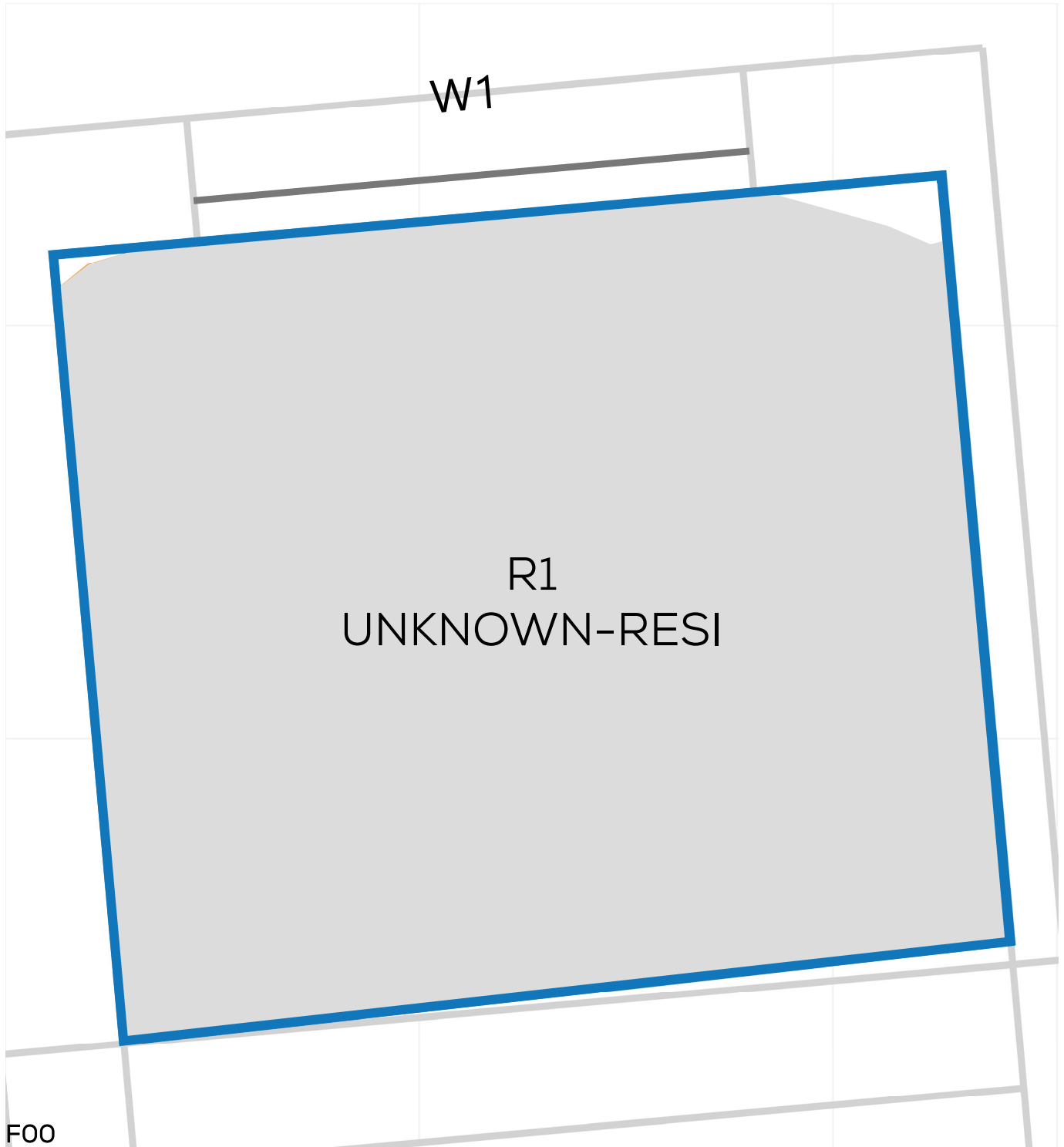
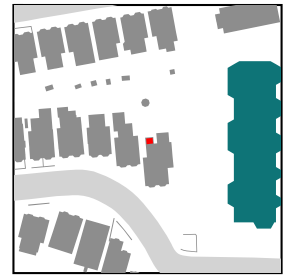





# NSL CONTOURS



PROJECT: 14047 - CAMBRIDGE ROAD  
REPORT TITLE: EXISTING VS. PROPOSED  
ADDRESS: 33 ROWLLS ROAD  
DATE: 02/10/2020  
SCHEME IR: IR23 (07.09.2020)  
DRAWING No.: 14047-RELO6-IS02-DD402

## KEY:

-  GAIN
-  LOSS
-  MAINTAINED LIT AREA
-  1 METRE GRID

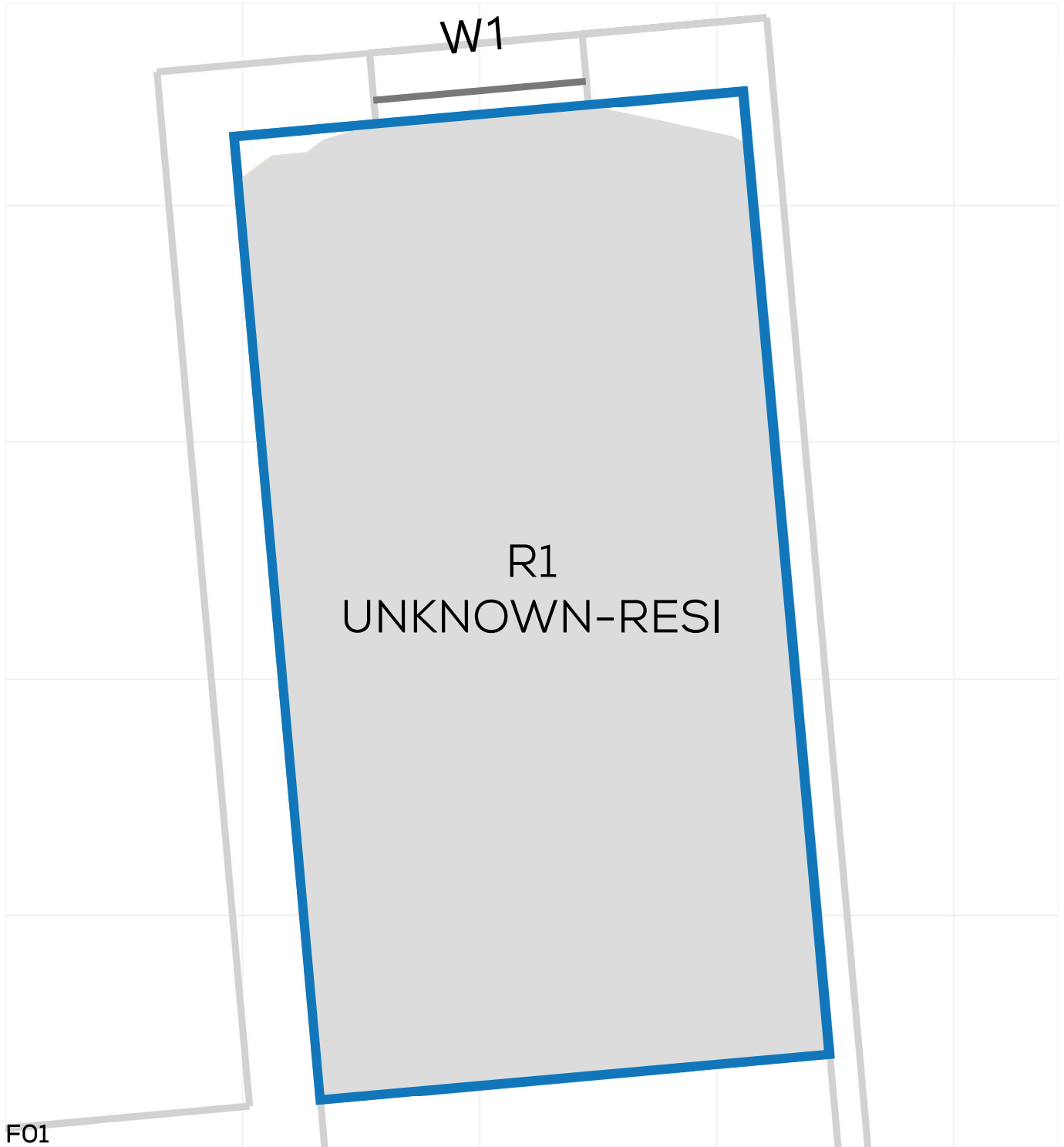



# NSL CONTOURS



PROJECT: 14047 - CAMBRIDGE ROAD  
REPORT TITLE: EXISTING VS. PROPOSED  
ADDRESS: 63 CAMBRIDGE GROVE ROAD  
DATE: 02/10/2020  
SCHEME IR: IR23 (07.09.2020)  
DRAWING No.: 14047-RELO6-IS02-DD403

**KEY:**

- GAIN
- LOSS
- MAINTAINED LIT AREA
- 1 METRE GRID

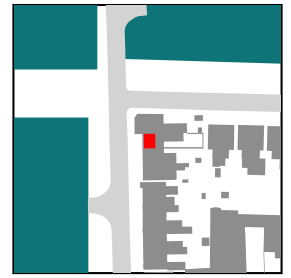

# NSL CONTOURS



PROJECT: 14047 - CAMBRIDGE ROAD  
REPORT TITLE: EXISTING VS. PROPOSED  
ADDRESS: 63 CAMBRIDGE GROVE ROAD  
DATE: 02/10/2020  
SCHEME IR: IR23 (07.09.2020)  
DRAWING No.: 14047-RELO6-IS02-DD404

## KEY:

- GAIN
- LOSS
- MAINTAINED LIT AREA
- 1 METRE GRID

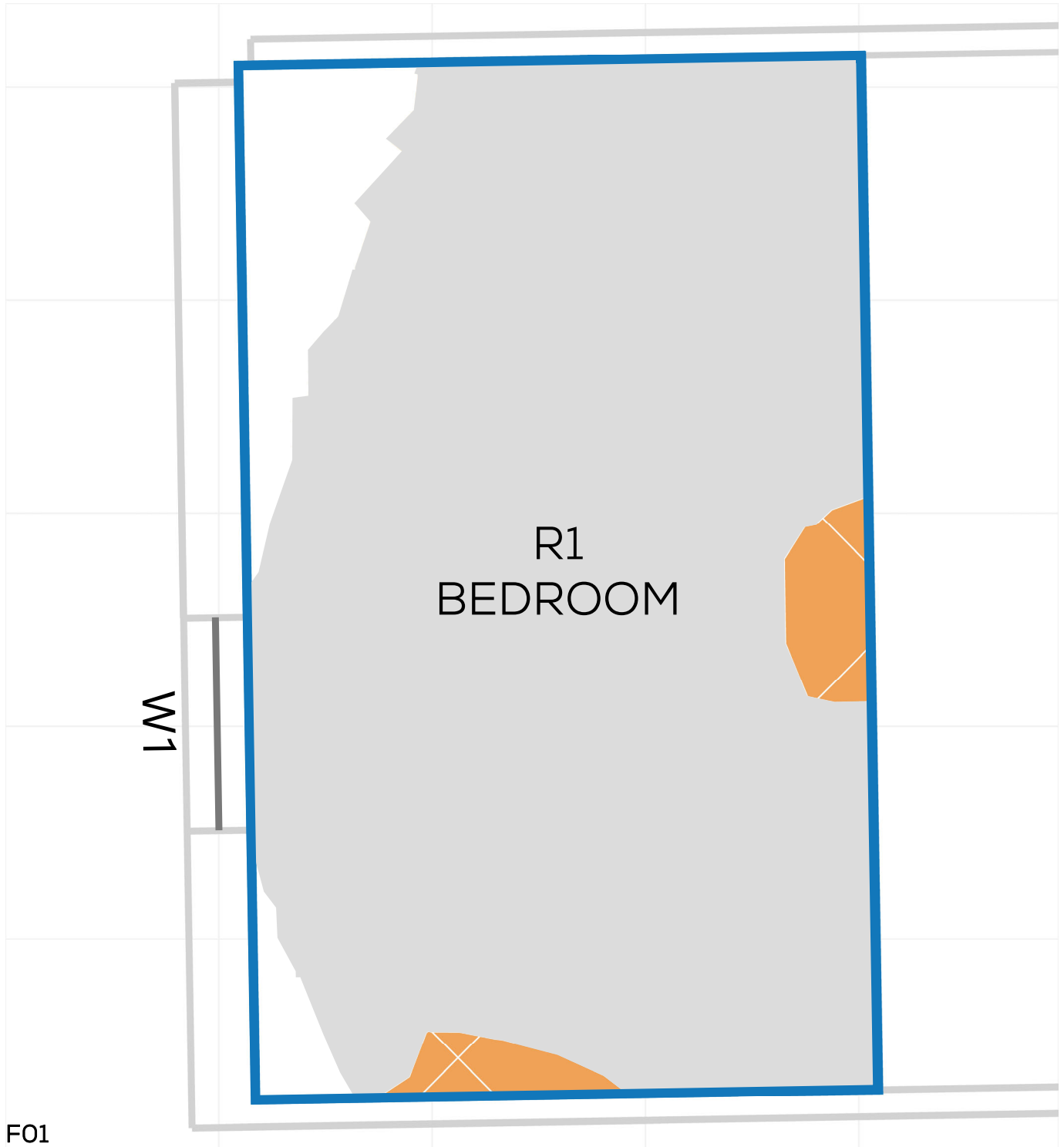

F01

PROJECT: 14047 - CAMBRIDGE ROAD  
REPORT TITLE: EXISTING VS. PROPOSED  
ADDRESS: 65 CAMBRIDGE GROVE ROAD  
DATE: 02/10/2020  
SCHEME IR: IR23 (07.09.2020)  
DRAWING No.: 14047-RELO6-IS02-DD405

**KEY:**

- GAIN
- LOSS
- MAINTAINED LIT AREA
- 1 METRE GRID

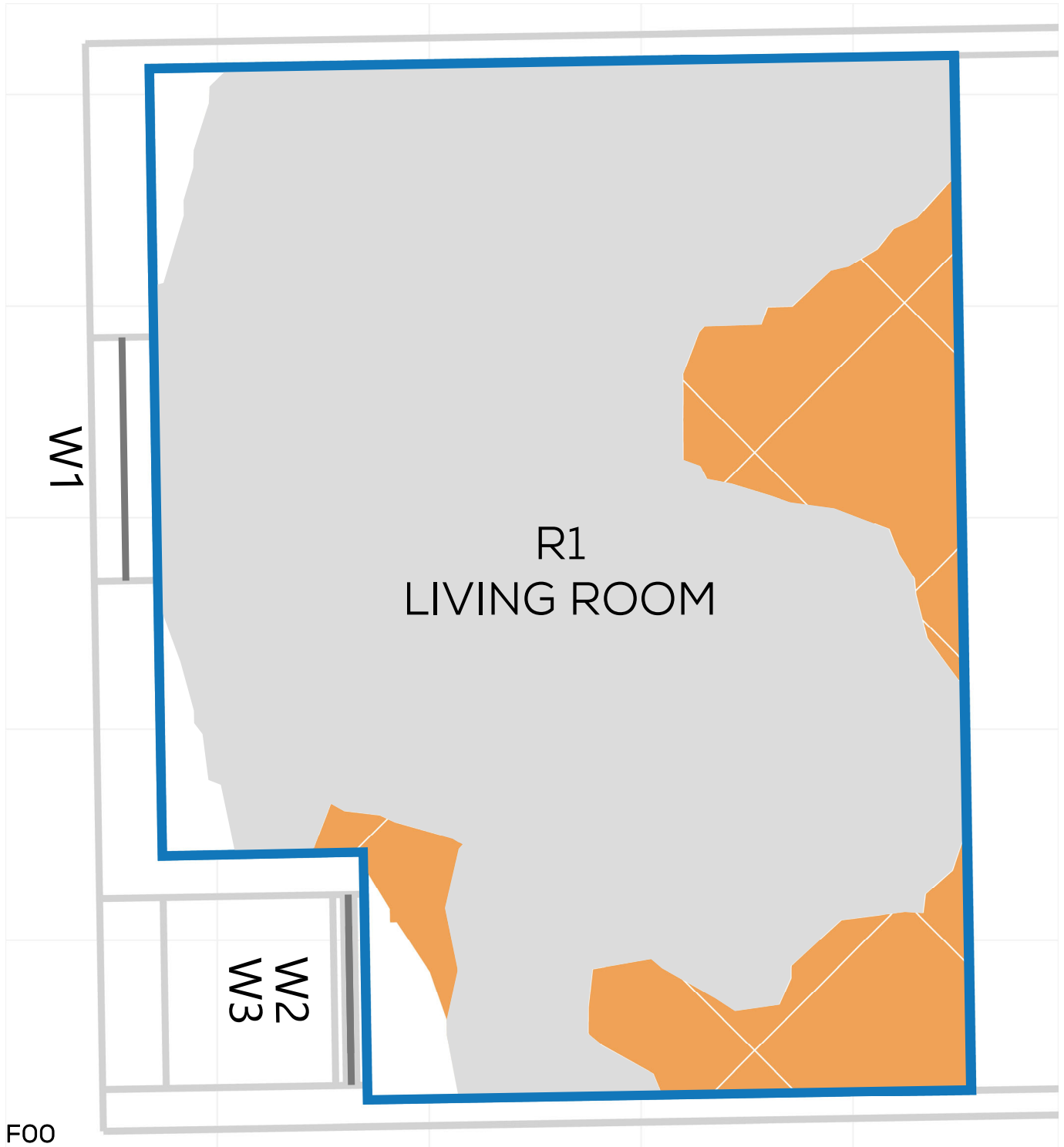

# NSL CONTOURS



PROJECT: 14047 - CAMBRIDGE ROAD  
REPORT TITLE: EXISTING VS. PROPOSED  
ADDRESS: 65 CAMBRIDGE GROVE ROAD  
DATE: 02/10/2020  
SCHEME IR: IR23 (07.09.2020)  
DRAWING No.: 14047-RELO6-IS02-DD406

## KEY:

- GAIN
- LOSS
- MAINTAINED LIT AREA
- 1 METRE GRID

