

NSL CONTOURS



PROJECT: 14047 - CAMBRIDGE ROAD
REPORT TITLE: EXISTING VS. PROPOSED
ADDRESS: 33 CAMBRIDGE ROAD
DATE: 02/10/2020
SCHEME IR: IR23 (07.09.2020)
DRAWING No.: 14047-RELO6-IS02-DD253

KEY:

- GAIN
- LOSS
- MAINTAINED LIT AREA
- 1 METRE GRID

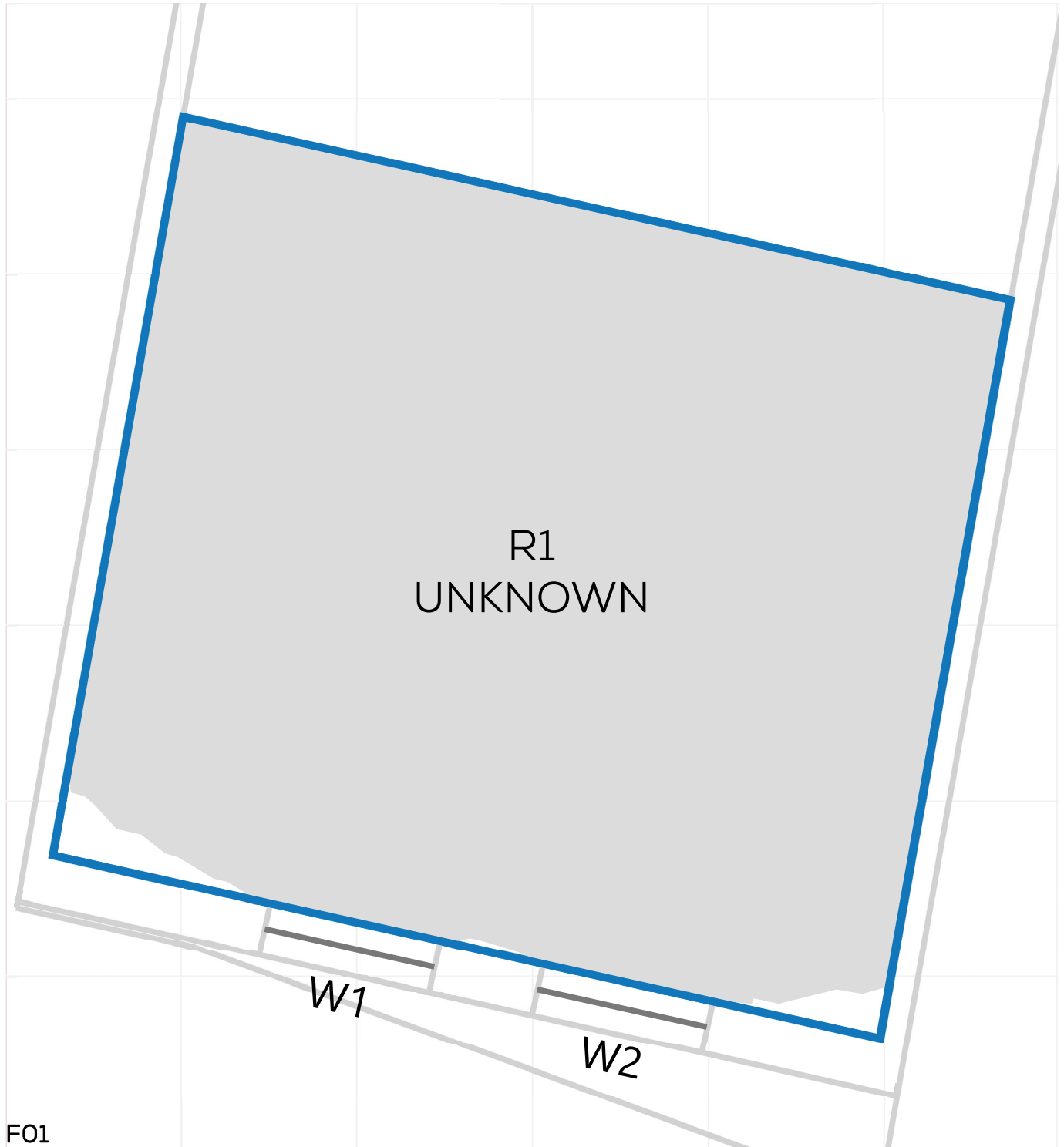





NSL CONTOURS



PROJECT: 14047 - CAMBRIDGE ROAD
REPORT TITLE: EXISTING VS. PROPOSED
ADDRESS: 31 CAMBRIDGE ROAD
DATE: 02/10/2020
SCHEME IR: IR23 (07.09.2020)
DRAWING No.: 14047-RELO6-IS02-DD254

KEY:

-  GAIN
-  LOSS
-  MAINTAINED LIT AREA
-  1 METRE GRID

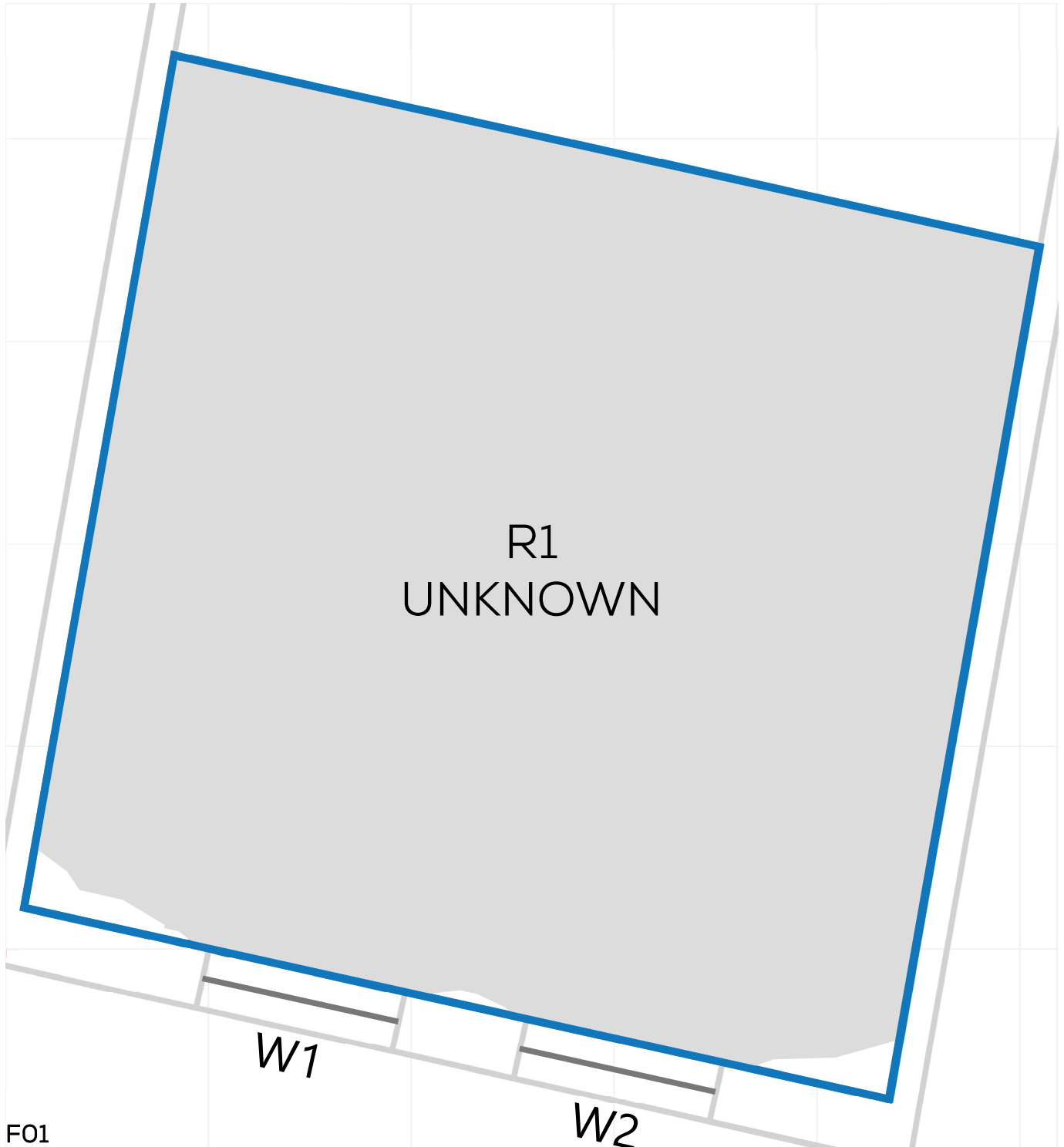





NSL CONTOURS



PROJECT: 14047 - CAMBRIDGE ROAD
REPORT TITLE: EXISTING VS. PROPOSED
ADDRESS: 31 CAMBRIDGE ROAD
DATE: 02/10/2020
SCHEME IR: IR23 (07.09.2020)
DRAWING No.: 14047-RELO6-IS02-DD255

KEY:

-  GAIN
-  LOSS
-  MAINTAINED LIT AREA
-  1 METRE GRID

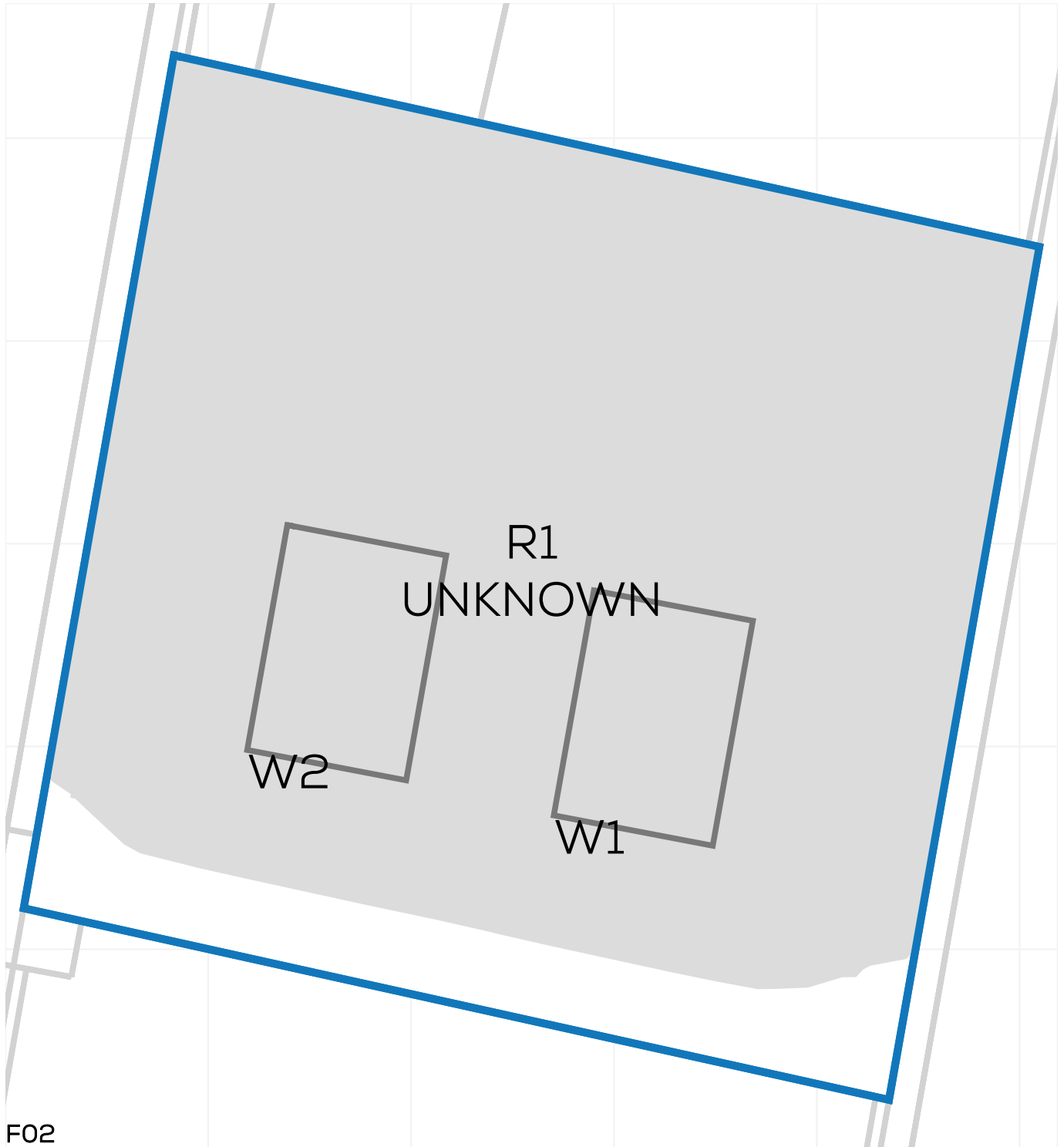

NSL CONTOURS



PROJECT: 14047 - CAMBRIDGE ROAD
REPORT TITLE: EXISTING VS. PROPOSED
ADDRESS: 29 CAMBRIDGE ROAD
DATE: 02/10/2020
SCHEME IR: IR23 (07.09.2020)
DRAWING No.: 14047-RELO6-IS02-DD256

KEY:

- GAIN
- LOSS
- MAINTAINED LIT AREA
- 1 METRE GRID

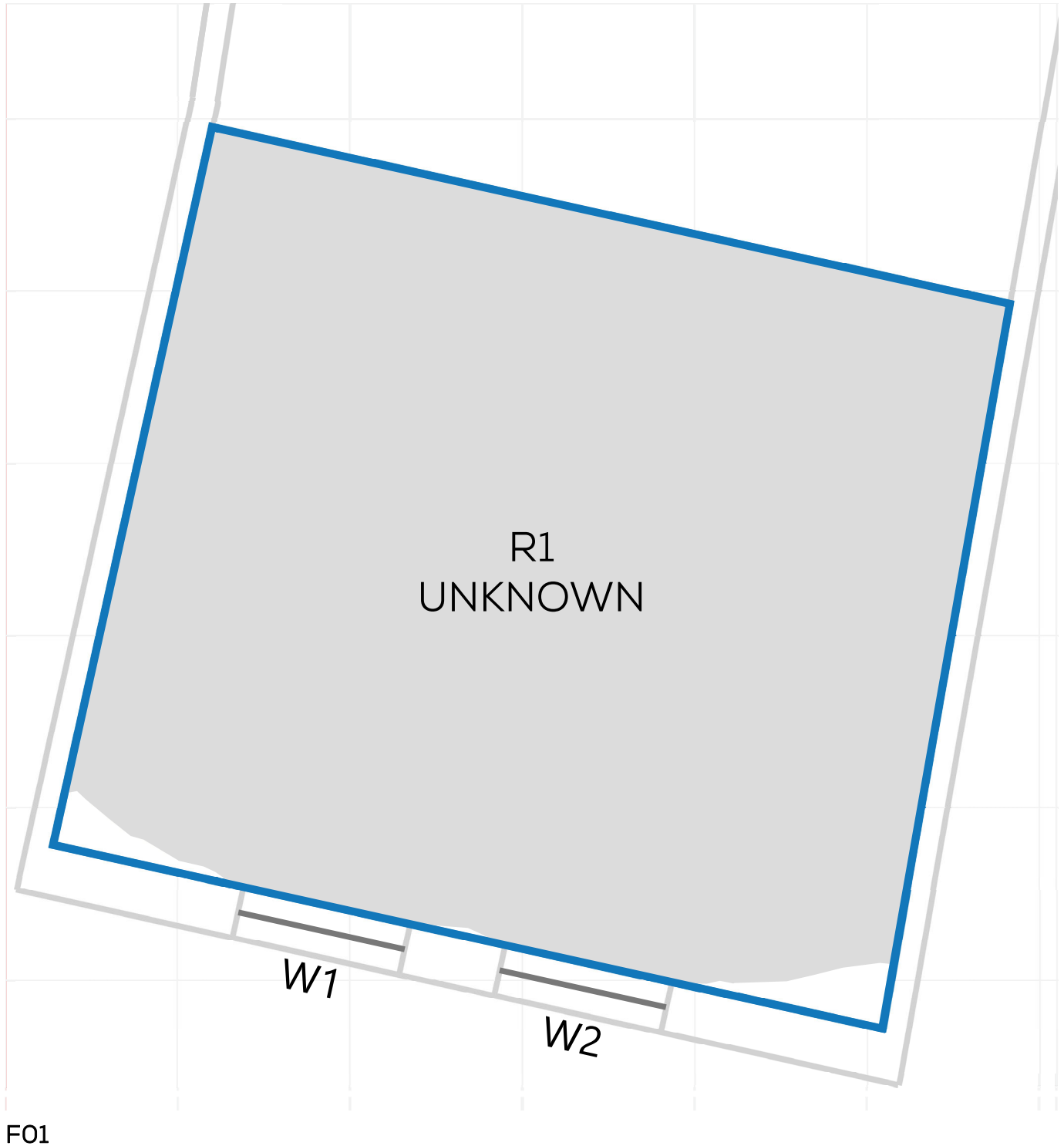
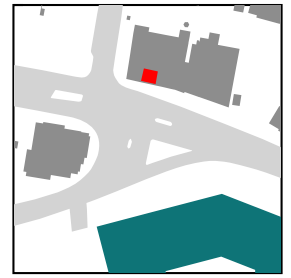

NSL CONTOURS



PROJECT: 14047 - CAMBRIDGE ROAD
REPORT TITLE: EXISTING VS. PROPOSED
ADDRESS: 27 CAMBRIDGE ROAD
DATE: 02/10/2020
SCHEME IR: IR23 (07.09.2020)
DRAWING No.: 14047-RELO6-IS02-DD257

KEY:

- GAIN
- LOSS
- MAINTAINED LIT AREA
- 1 METRE GRID

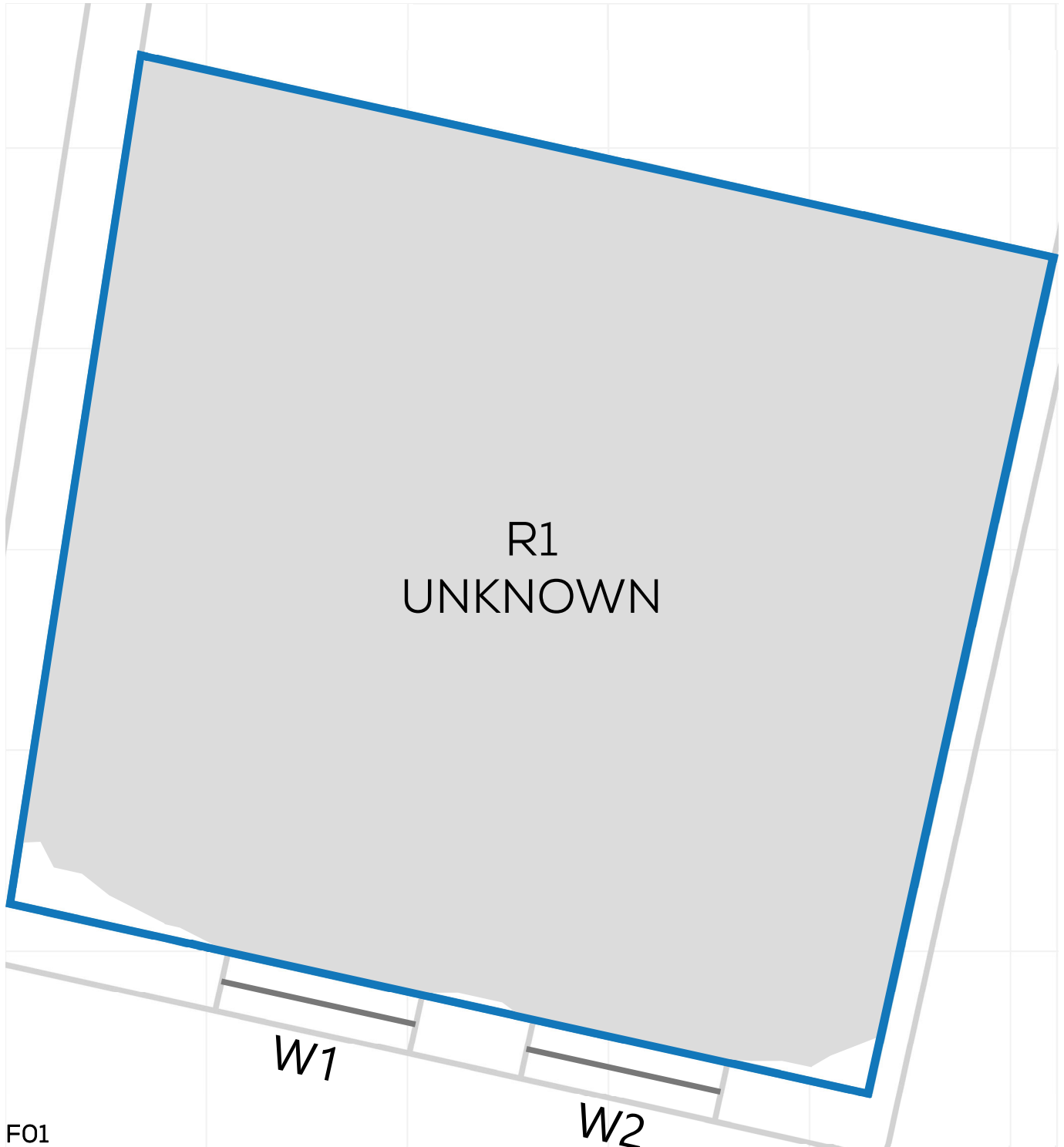

NSL CONTOURS



PROJECT: 14047 - CAMBRIDGE ROAD
REPORT TITLE: EXISTING VS. PROPOSED
ADDRESS: VIBE STUDENT LIVING 66-70 CAMBRIDGE
DATE: 02/10/2020
SCHEME IR: IR23 (07.09.2020)
DRAWING No.: 14047-RELO6-IS02-DD258

KEY:

- GAIN
- LOSS
- MAINTAINED LIT AREA
- 1 METRE GRID

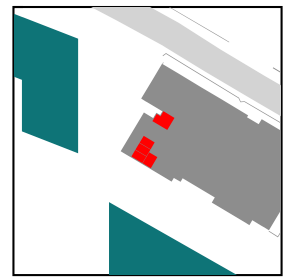

NSL CONTOURS



PROJECT: 14047 - CAMBRIDGE ROAD
REPORT TITLE: EXISTING VS. PROPOSED
ADDRESS: VIBE STUDENT LIVING 66-70 CAMBRIDGE
DATE: 02/10/2020
SCHEME IR: IR23 (07.09.2020)
DRAWING No.: 14047-RELO6-IS02-DD259

KEY:

- GAIN
- LOSS
- MAINTAINED LIT AREA
- 1 METRE GRID



F01

NSL CONTOURS



PROJECT: 14047 - CAMBRIDGE ROAD
REPORT TITLE: EXISTING VS. PROPOSED
ADDRESS: VIBE STUDENT LIVING 66-70 CAMBRIDGE
DATE: 02/10/2020
SCHEME IR: IR23 (07.09.2020)
DRAWING No.: 14047-RELO6-IS02-DD260

KEY:

- GAIN
- LOSS
- MAINTAINED LIT AREA
- 1 METRE GRID

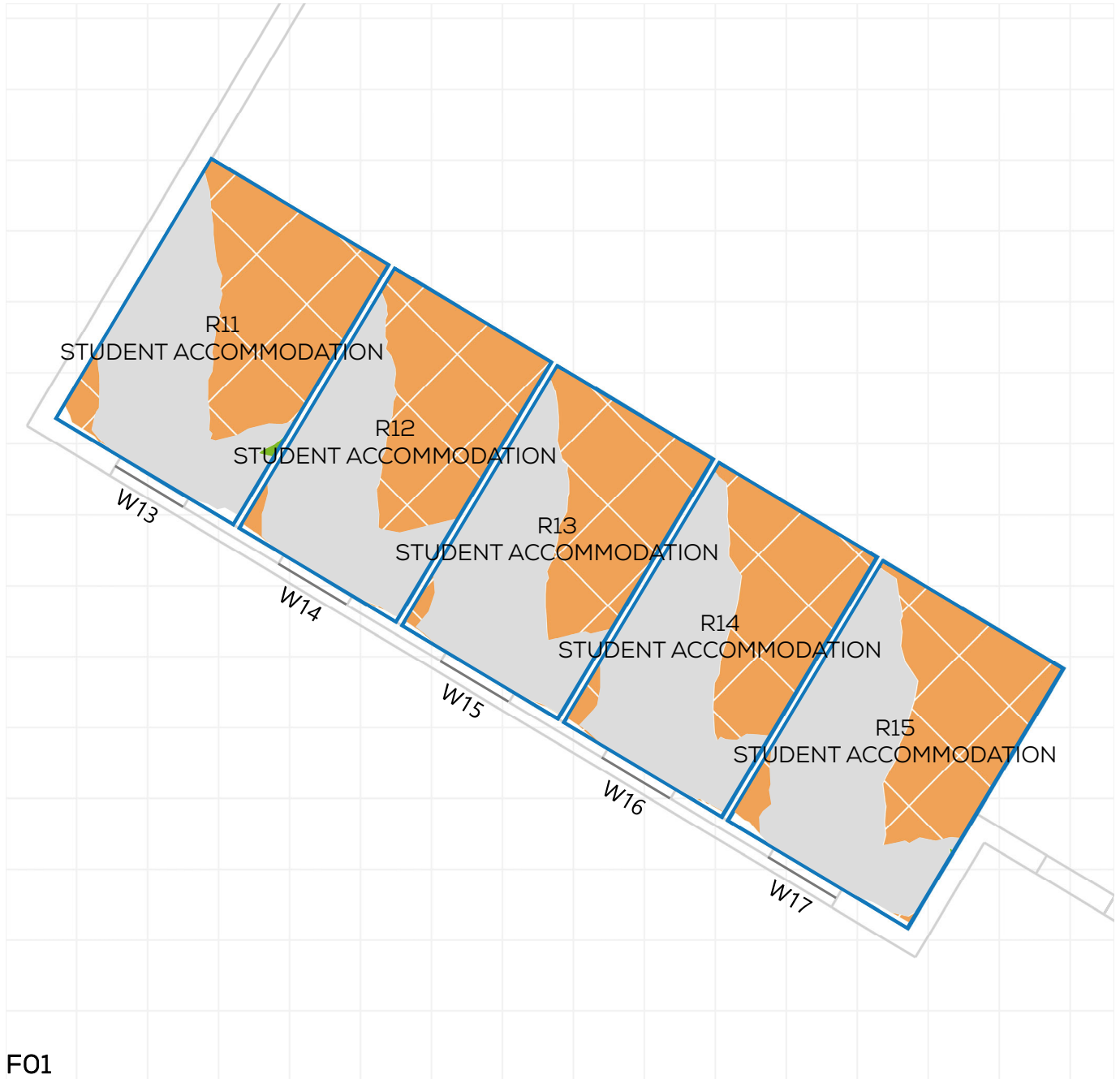
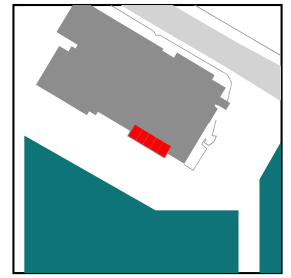

F01

NSL CONTOURS



PROJECT: 14047 - CAMBRIDGE ROAD
REPORT TITLE: EXISTING VS. PROPOSED
ADDRESS: VIBE STUDENT LIVING 66-70 CAMBRIDGE
DATE: 02/10/2020
SCHEME IR: IR23 (07.09.2020)
DRAWING No.: 14047-RELO6-IS02-DD261

KEY:

- GAIN
- LOSS
- MAINTAINED LIT AREA
- 1 METRE GRID

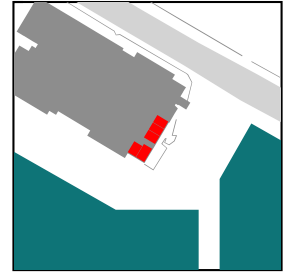

F01

NSL CONTOURS



PROJECT: 14047 - CAMBRIDGE ROAD
REPORT TITLE: EXISTING VS. PROPOSED
ADDRESS: VIBE STUDENT LIVING 66-70 CAMBRIDGE
DATE: 02/10/2020
SCHEME IR: IR23 (07.09.2020)
DRAWING No.: 14047-RELO6-IS02-DD262

KEY:

- GAIN
- LOSS
- MAINTAINED LIT AREA
- 1 METRE GRID



NSL CONTOURS



PROJECT: 14047 - CAMBRIDGE ROAD
REPORT TITLE: EXISTING VS. PROPOSED
ADDRESS: VIBE STUDENT LIVING 66-70 CAMBRIDGE
DATE: 02/10/2020
SCHEME IR: IR23 (07.09.2020)
DRAWING No.: 14047-RELO6-IS02-DD263

KEY:

- GAIN
- LOSS
- MAINTAINED LIT AREA
- 1 METRE GRID

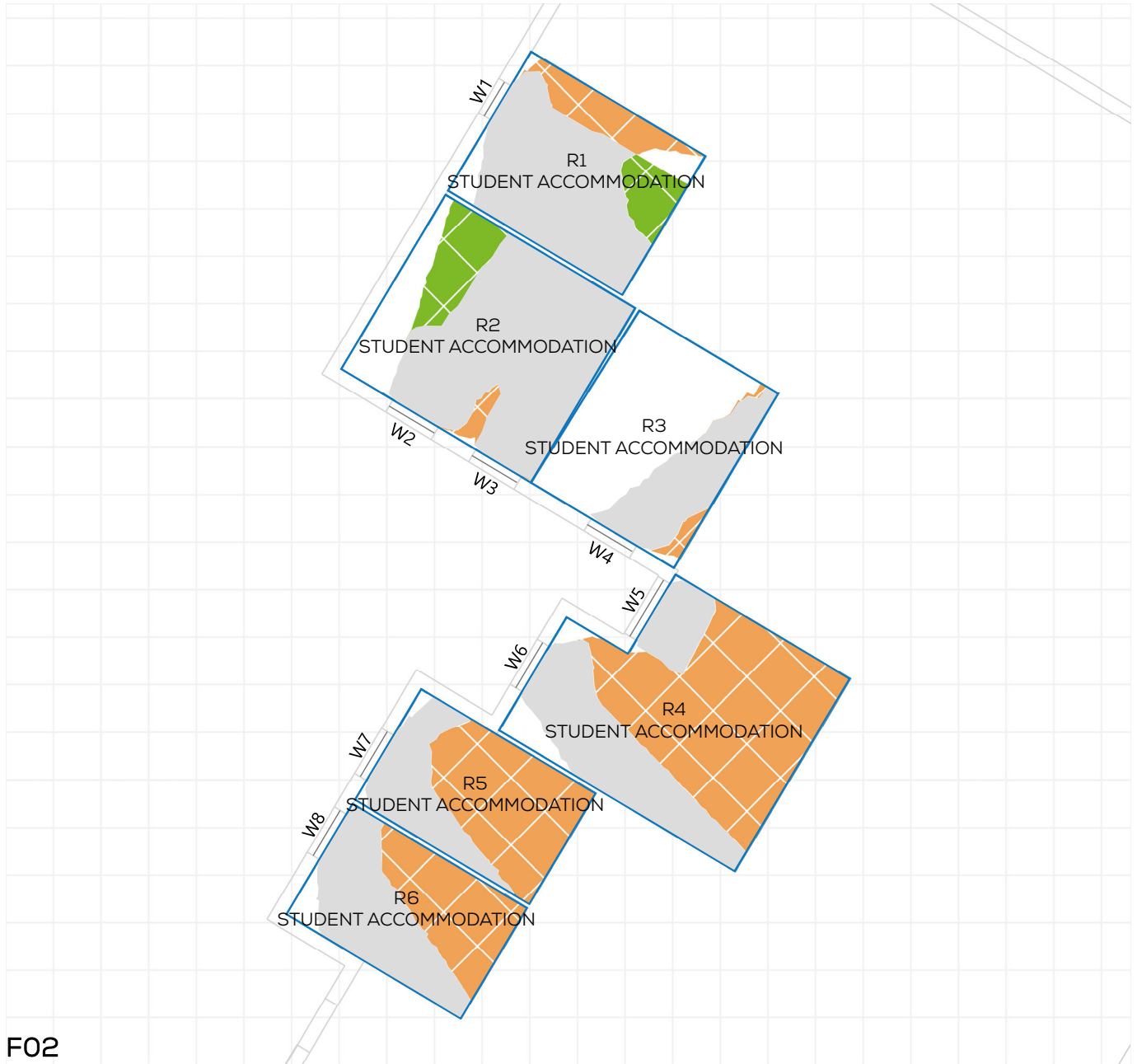
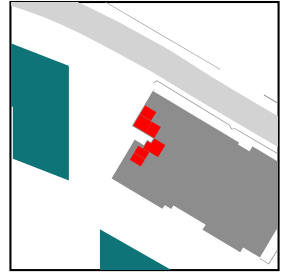

F02

NSL CONTOURS



PROJECT: 14047 - CAMBRIDGE ROAD
REPORT TITLE: EXISTING VS. PROPOSED
ADDRESS: VIBE STUDENT LIVING 66-70 CAMBRIDGE
DATE: 02/10/2020
SCHEME IR: IR23 (07.09.2020)
DRAWING No.: 14047-RELO6-IS02-DD264

KEY:

- GAIN
- LOSS
- MAINTAINED LIT AREA
- 1 METRE GRID

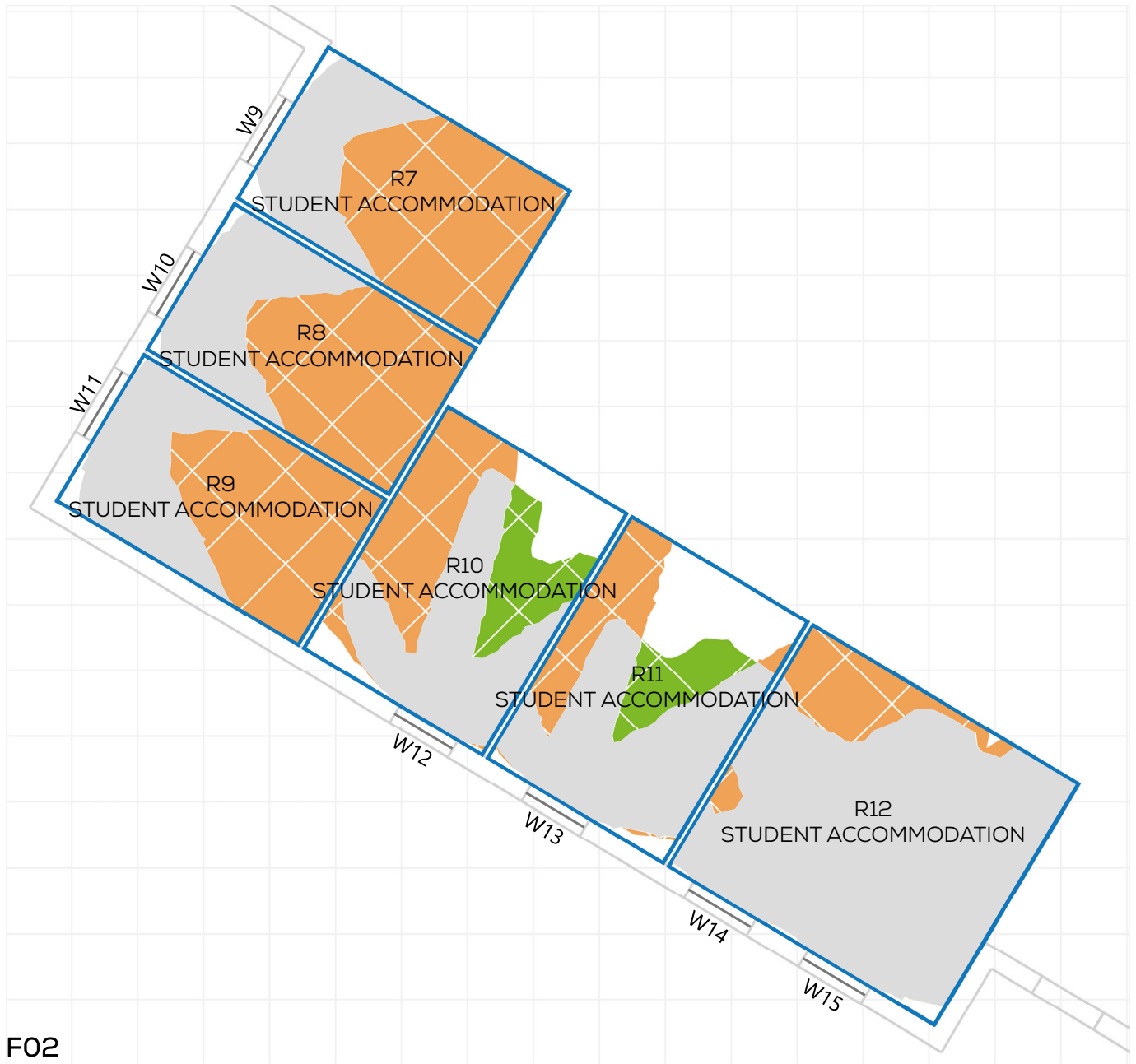
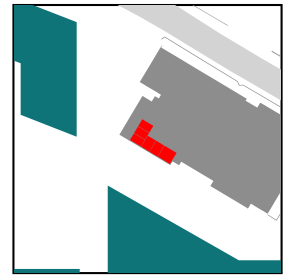

F02

NSL CONTOURS



PROJECT: 14047 - CAMBRIDGE ROAD
REPORT TITLE: EXISTING VS. PROPOSED
ADDRESS: VIBE STUDENT LIVING 66-70 CAMBRIDGE
DATE: 02/10/2020
SCHEME IR: IR23 (07.09.2020)
DRAWING No.: 14047-RELO6-IS02-DD265

KEY:

- GAIN
- LOSS
- MAINTAINED LIT AREA
- 1 METRE GRID

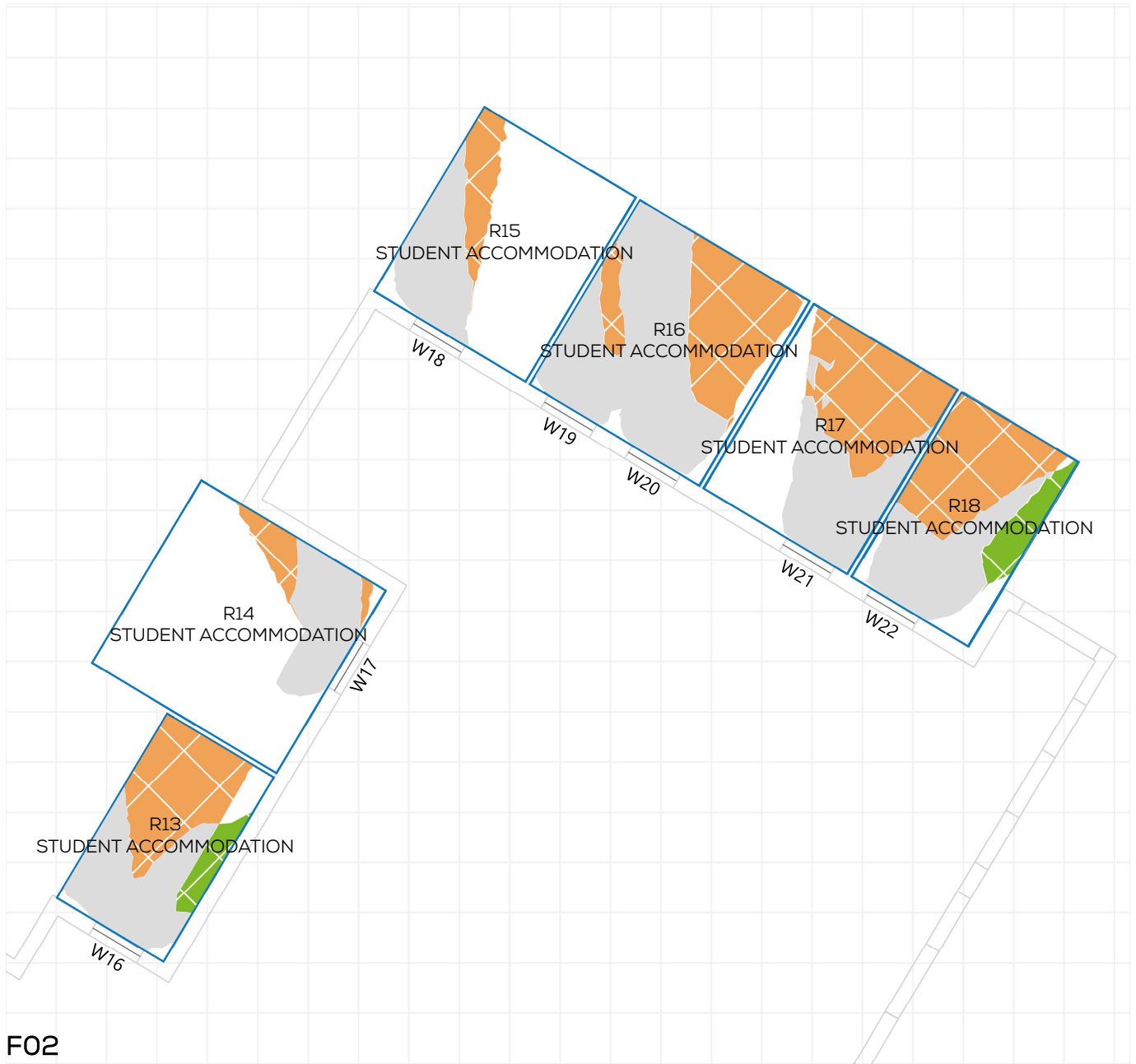
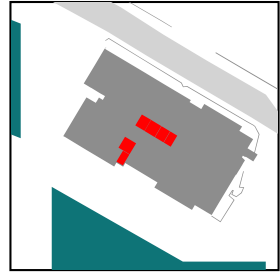

F02

NSL CONTOURS



PROJECT: 14047 - CAMBRIDGE ROAD
REPORT TITLE: EXISTING VS. PROPOSED
ADDRESS: VIBE STUDENT LIVING 66-70 CAMBRIDGE
DATE: 02/10/2020
SCHEME IR: IR23 (07.09.2020)
DRAWING No.: 14047-RELO6-IS02-DD266

KEY:

- GAIN
- LOSS
- MAINTAINED LIT AREA
- 1 METRE GRID

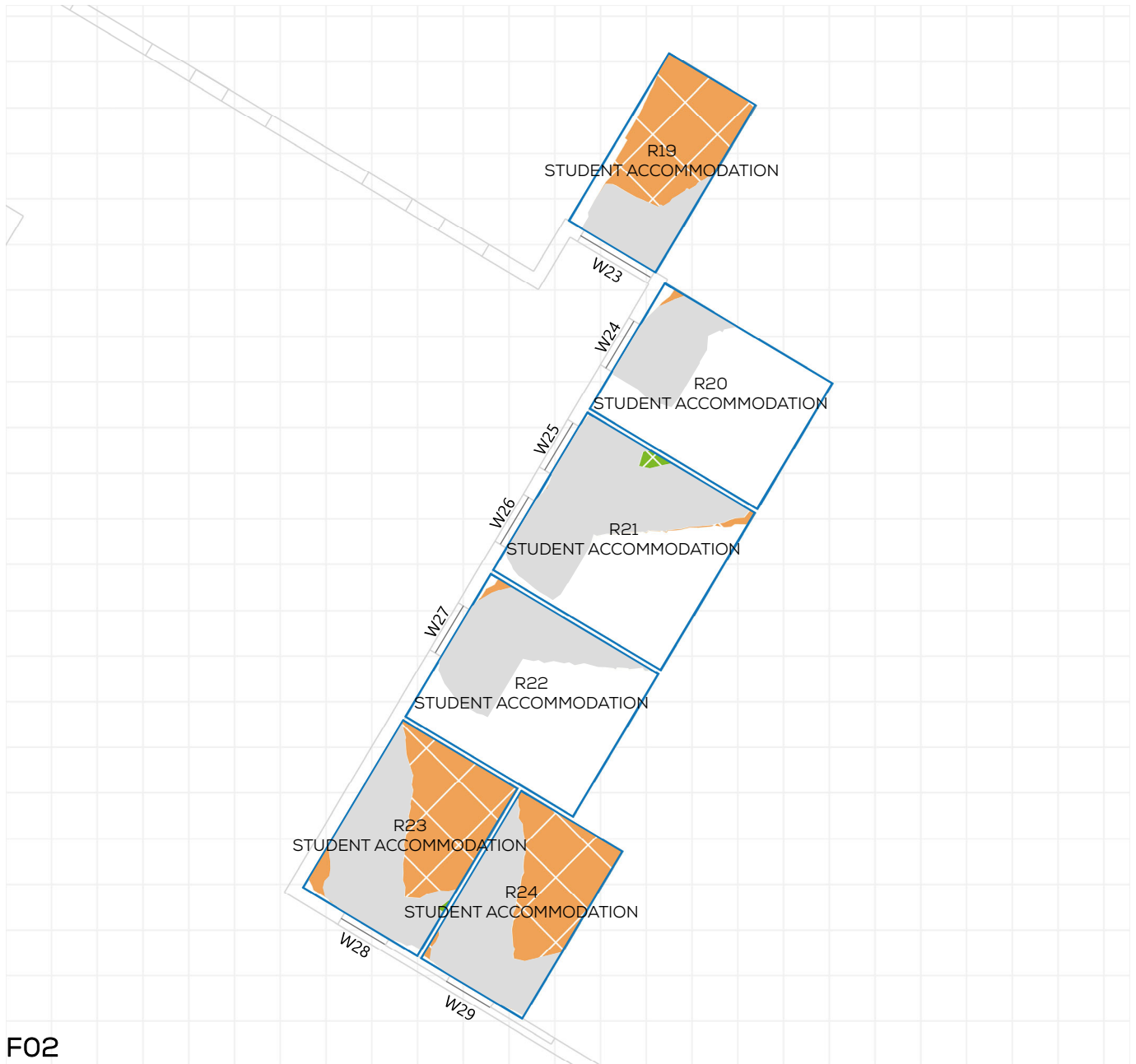
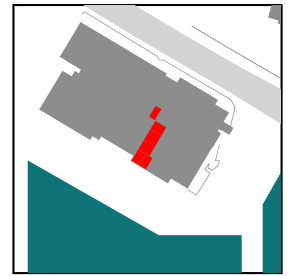

F02

NSL CONTOURS



PROJECT: 14047 - CAMBRIDGE ROAD
REPORT TITLE: EXISTING VS. PROPOSED
ADDRESS: VIBE STUDENT LIVING 66-70 CAMBRIDGE
DATE: 02/10/2020
SCHEME IR: IR23 (07.09.2020)
DRAWING No.: 14047-RELO6-IS02-DD267

KEY:

- GAIN
- LOSS
- MAINTAINED LIT AREA
- 1 METRE GRID

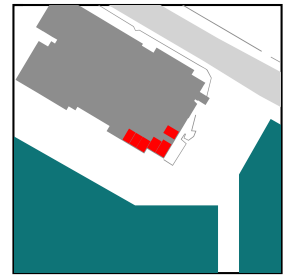

F02

NSL CONTOURS



PROJECT: 14047 - CAMBRIDGE ROAD
REPORT TITLE: EXISTING VS. PROPOSED
ADDRESS: VIBE STUDENT LIVING 66-70 CAMBRIDGE
DATE: 02/10/2020
SCHEME IR: IR23 (07.09.2020)
DRAWING No.: 14047-RELO6-IS02-DD268

KEY:

- GAIN
- LOSS
- MAINTAINED LIT AREA
- 1 METRE GRID

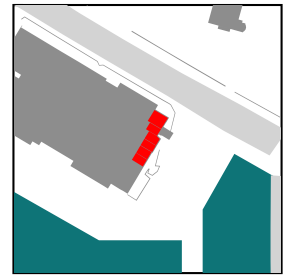

F02

NSL CONTOURS



PROJECT: 14047 - CAMBRIDGE ROAD
REPORT TITLE: EXISTING VS. PROPOSED
ADDRESS: VIBE STUDENT LIVING 66-70 CAMBRIDGE
DATE: 02/10/2020
SCHEME IR: IR23 (07.09.2020)
DRAWING No.: 14047-RELO6-IS02-DD269

KEY:

- GAIN
- LOSS
- MAINTAINED LIT AREA
- 1 METRE GRID

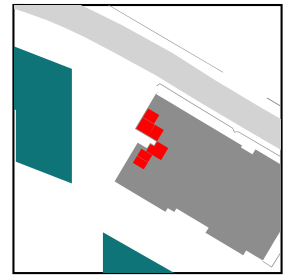

PROJECT: 14047 - CAMBRIDGE ROAD
REPORT TITLE: EXISTING VS. PROPOSED
ADDRESS: VIBE STUDENT LIVING 66-70 CAMBRIDGE
DATE: 02/10/2020
SCHEME IR: IR23 (07.09.2020)
DRAWING No.: 14047-RELO6-IS02-DD270

KEY:

- GAIN
- LOSS
- MAINTAINED LIT AREA
- 1 METRE GRID

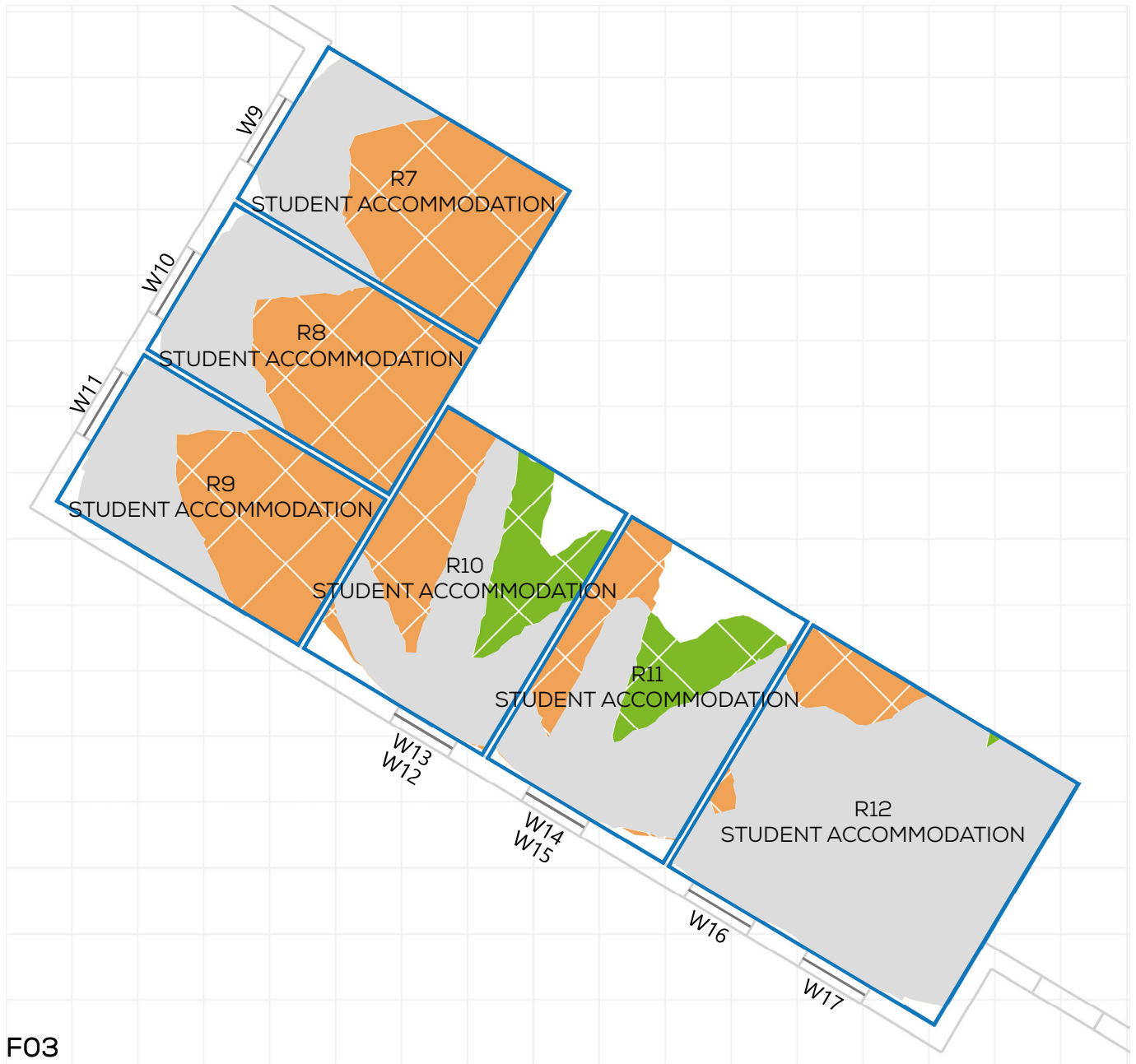
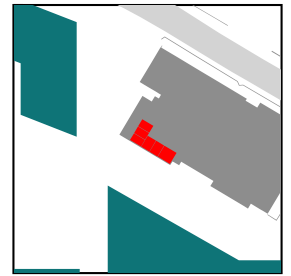

F03

NSL CONTOURS



PROJECT: 14047 - CAMBRIDGE ROAD
REPORT TITLE: EXISTING VS. PROPOSED
ADDRESS: VIBE STUDENT LIVING 66-70 CAMBRIDGE
DATE: 02/10/2020
SCHEME IR: IR23 (07.09.2020)
DRAWING No.: 14047-RELO6-IS02-DD271

KEY:

- GAIN
- LOSS
- MAINTAINED LIT AREA
- 1 METRE GRID

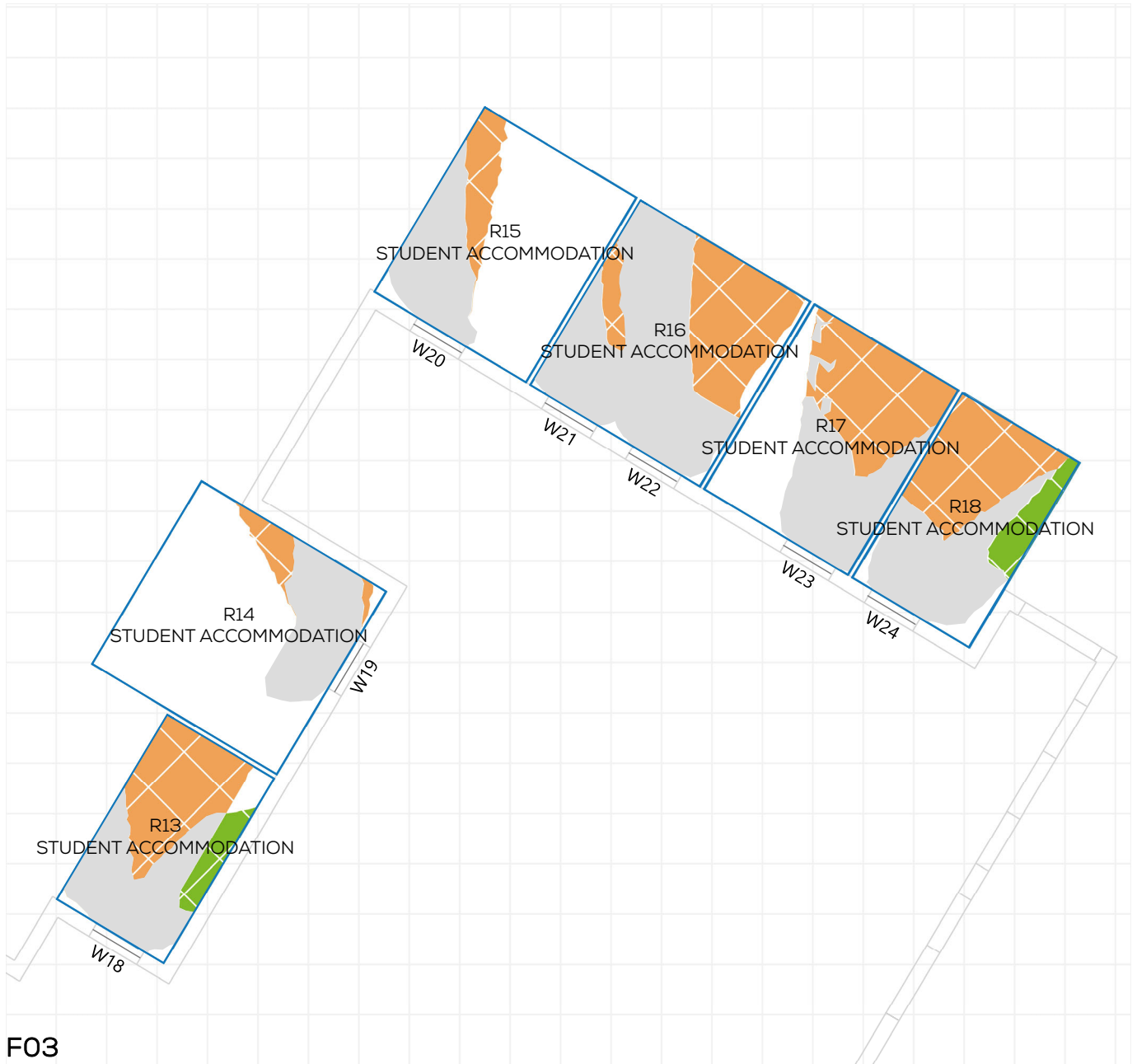
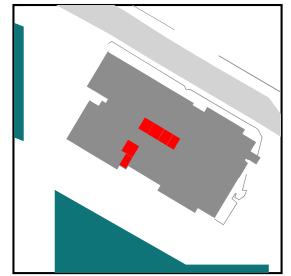

F03

NSL CONTOURS



PROJECT: 14047 - CAMBRIDGE ROAD
REPORT TITLE: EXISTING VS. PROPOSED
ADDRESS: VIBE STUDENT LIVING 66-70 CAMBRIDGE
DATE: 02/10/2020
SCHEME IR: IR23 (07.09.2020)
DRAWING No.: 14047-RELO6-IS02-DD272

KEY:

- GAIN
- LOSS
- MAINTAINED LIT AREA
- 1 METRE GRID

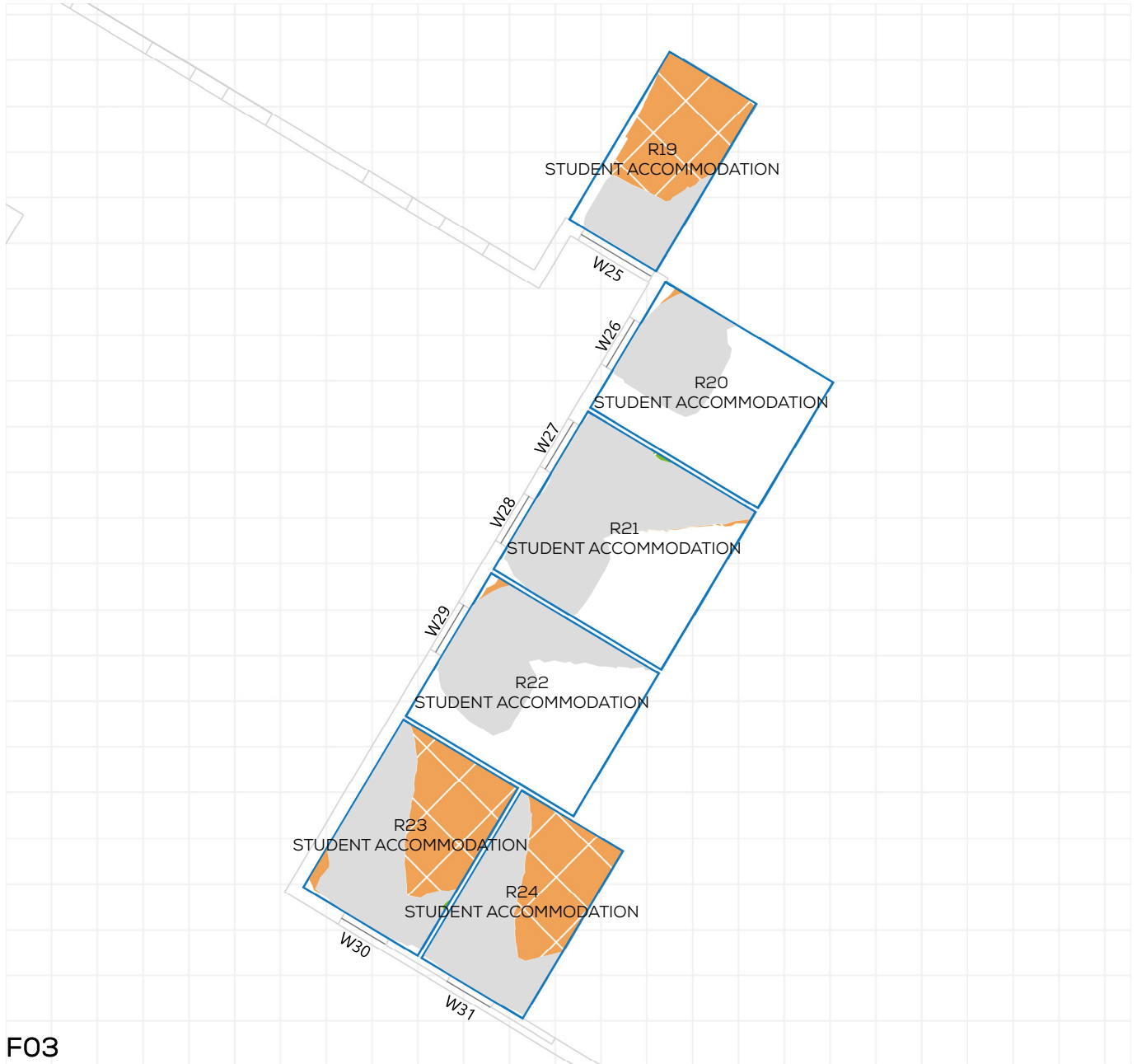
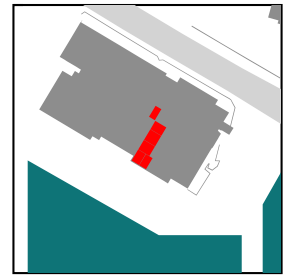

F03

NSL CONTOURS



PROJECT: 14047 - CAMBRIDGE ROAD
REPORT TITLE: EXISTING VS. PROPOSED
ADDRESS: VIBE STUDENT LIVING 66-70 CAMBRIDGE
DATE: 02/10/2020
SCHEME IR: IR23 (07.09.2020)
DRAWING No.: 14047-RELO6-IS02-DD273

KEY:

- GAIN
- LOSS
- MAINTAINED LIT AREA
- 1 METRE GRID

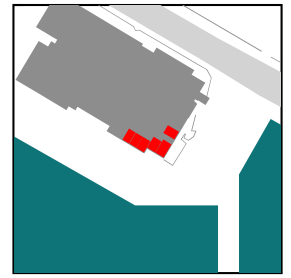

F03

NSL CONTOURS



PROJECT: 14047 - CAMBRIDGE ROAD
REPORT TITLE: EXISTING VS. PROPOSED
ADDRESS: VIBE STUDENT LIVING 66-70 CAMBRIDGE
DATE: 02/10/2020
SCHEME IR: IR23 (07.09.2020)
DRAWING No.: 14047-RELO6-IS02-DD274

KEY:

- GAIN
- LOSS
- MAINTAINED LIT AREA
- 1 METRE GRID

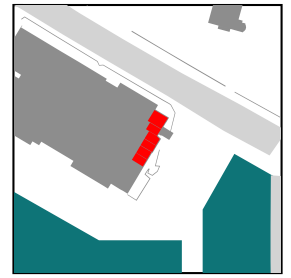

F03

NSL CONTOURS



PROJECT: 14047 - CAMBRIDGE ROAD
REPORT TITLE: EXISTING VS. PROPOSED
ADDRESS: VIBE STUDENT LIVING 66-70 CAMBRIDGE
DATE: 02/10/2020
SCHEME IR: IR23 (07.09.2020)
DRAWING No.: 14047-RELO6-IS02-DD275

KEY:

- GAIN
- LOSS
- MAINTAINED LIT AREA
- 1 METRE GRID

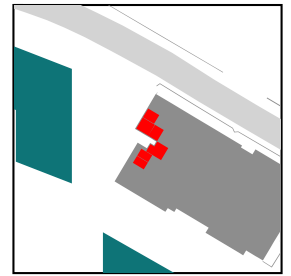

F04

NSL CONTOURS



PROJECT: 14047 - CAMBRIDGE ROAD
REPORT TITLE: EXISTING VS. PROPOSED
ADDRESS: VIBE STUDENT LIVING 66-70 CAMBRIDGE
DATE: 02/10/2020
SCHEME IR: IR23 (07.09.2020)
DRAWING No.: 14047-RELO6-IS02-DD276

KEY:

- GAIN
- LOSS
- MAINTAINED LIT AREA
- 1 METRE GRID

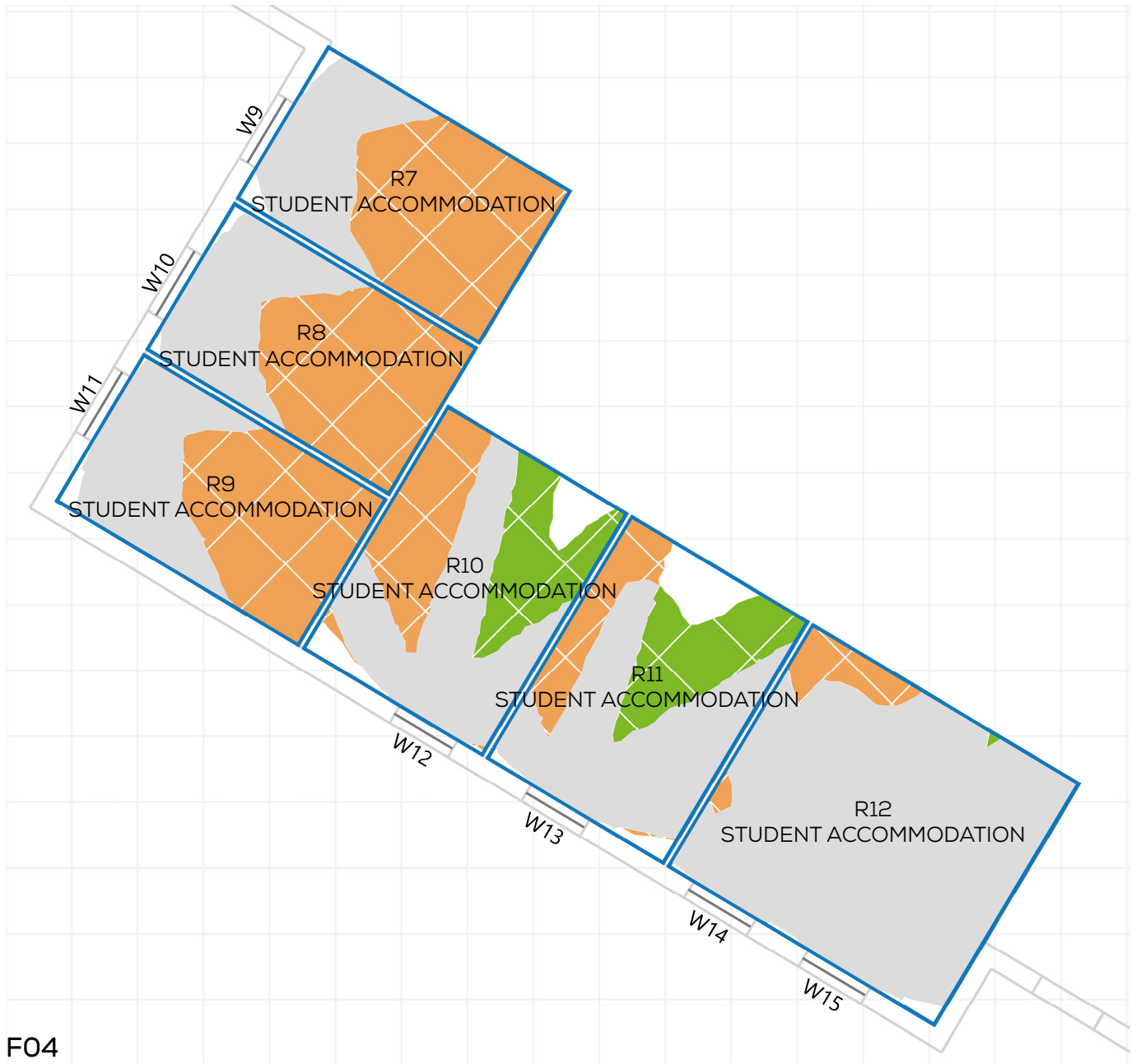
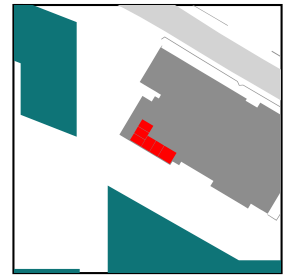

F04

NSL CONTOURS



PROJECT: 14047 - CAMBRIDGE ROAD
REPORT TITLE: EXISTING VS. PROPOSED
ADDRESS: VIBE STUDENT LIVING 66-70 CAMBRIDGE
DATE: 02/10/2020
SCHEME IR: IR23 (07.09.2020)
DRAWING No.: 14047-RELO6-IS02-DD277

KEY:

- GAIN
- LOSS
- MAINTAINED LIT AREA
- 1 METRE GRID

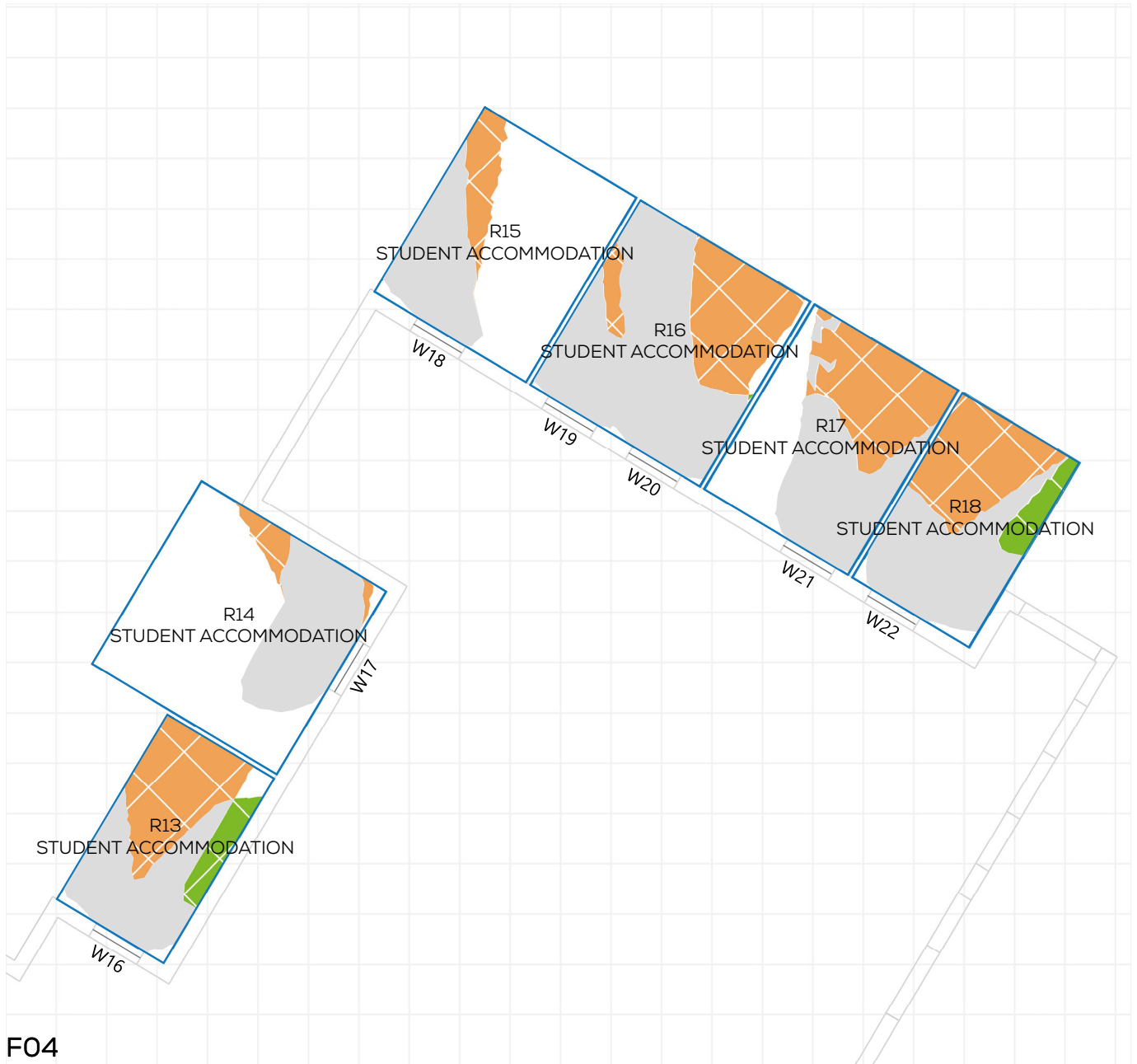
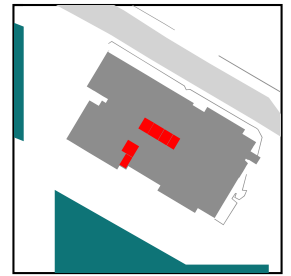

F04

NSL CONTOURS



PROJECT: 14047 - CAMBRIDGE ROAD
REPORT TITLE: EXISTING VS. PROPOSED
ADDRESS: VIBE STUDENT LIVING 66-70 CAMBRIDGE
DATE: 02/10/2020
SCHEME IR: IR23 (07.09.2020)
DRAWING No.: 14047-RELO6-IS02-DD278

KEY:

- GAIN
- LOSS
- MAINTAINED LIT AREA
- 1 METRE GRID

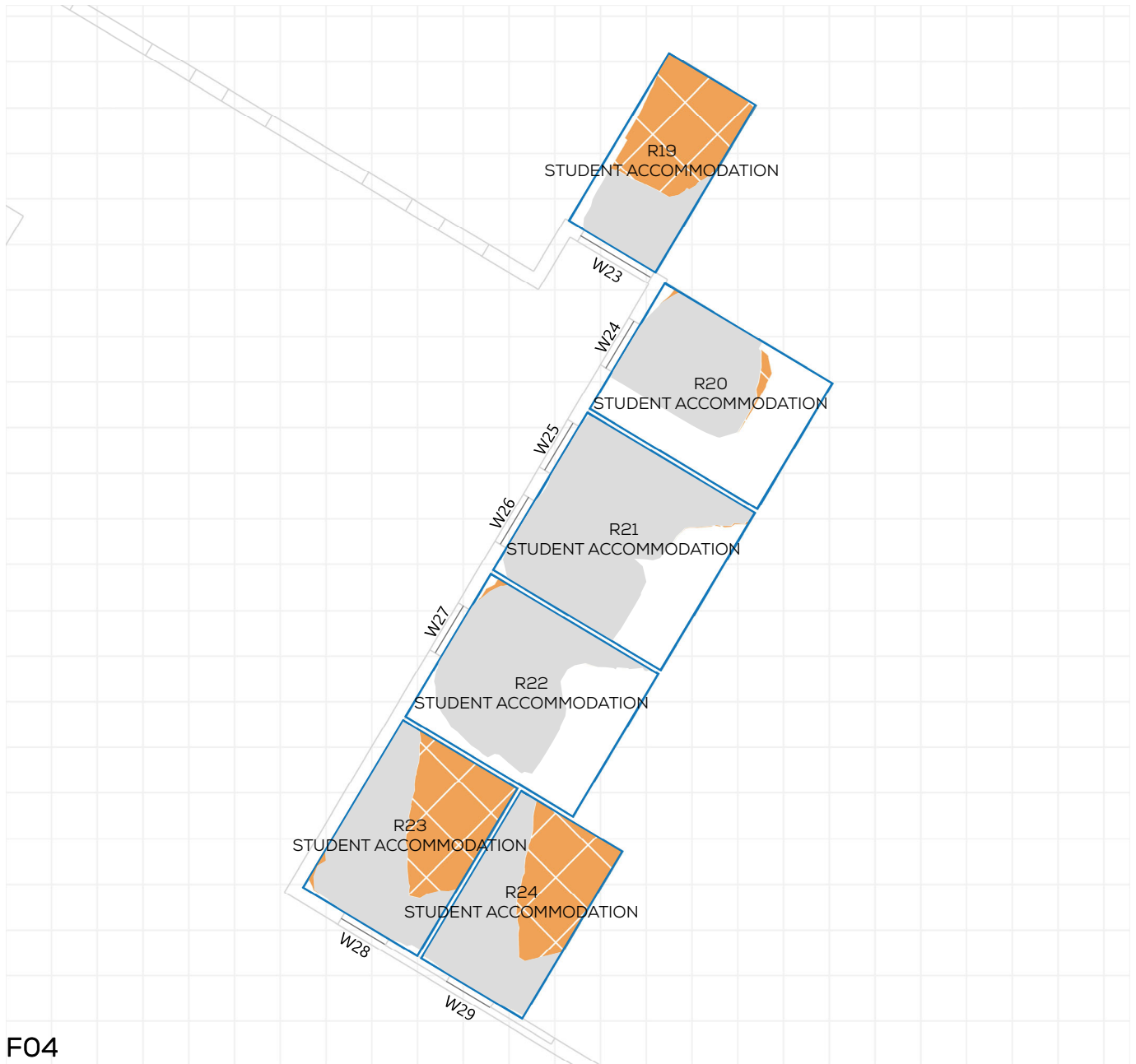
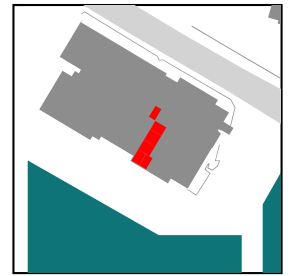

F04

NSL CONTOURS



PROJECT: 14047 - CAMBRIDGE ROAD
REPORT TITLE: EXISTING VS. PROPOSED
ADDRESS: VIBE STUDENT LIVING 66-70 CAMBRIDGE
DATE: 02/10/2020
SCHEME IR: IR23 (07.09.2020)
DRAWING No.: 14047-RELO6-IS02-DD279

KEY:

- GAIN
- LOSS
- MAINTAINED LIT AREA
- 1 METRE GRID

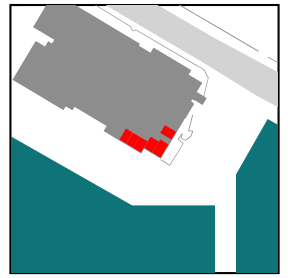

F04

NSL CONTOURS



PROJECT: 14047 - CAMBRIDGE ROAD
REPORT TITLE: EXISTING VS. PROPOSED
ADDRESS: VIBE STUDENT LIVING 66-70 CAMBRIDGE
DATE: 02/10/2020
SCHEME IR: IR23 (07.09.2020)
DRAWING No.: 14047-RELO6-IS02-DD280

KEY:

- GAIN
- LOSS
- MAINTAINED LIT AREA
- 1 METRE GRID

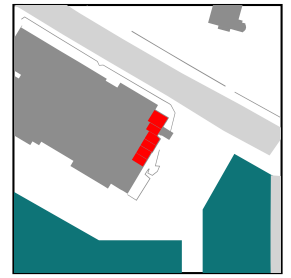

F04