

PROJECT: 14047 - CAMBRIDGE ROAD  
REPORT TITLE: EXISTING VS. PROPOSED  
ADDRESS: 32 VINCENT ROAD  
DATE: 02/10/2020  
SCHEME IR: IR23 (07.09.2020)  
DRAWING No.: 14047-RELO6-IS02-DD127

**KEY:**

- GAIN
- LOSS
- MAINTAINED LIT AREA
- 1 METRE GRID

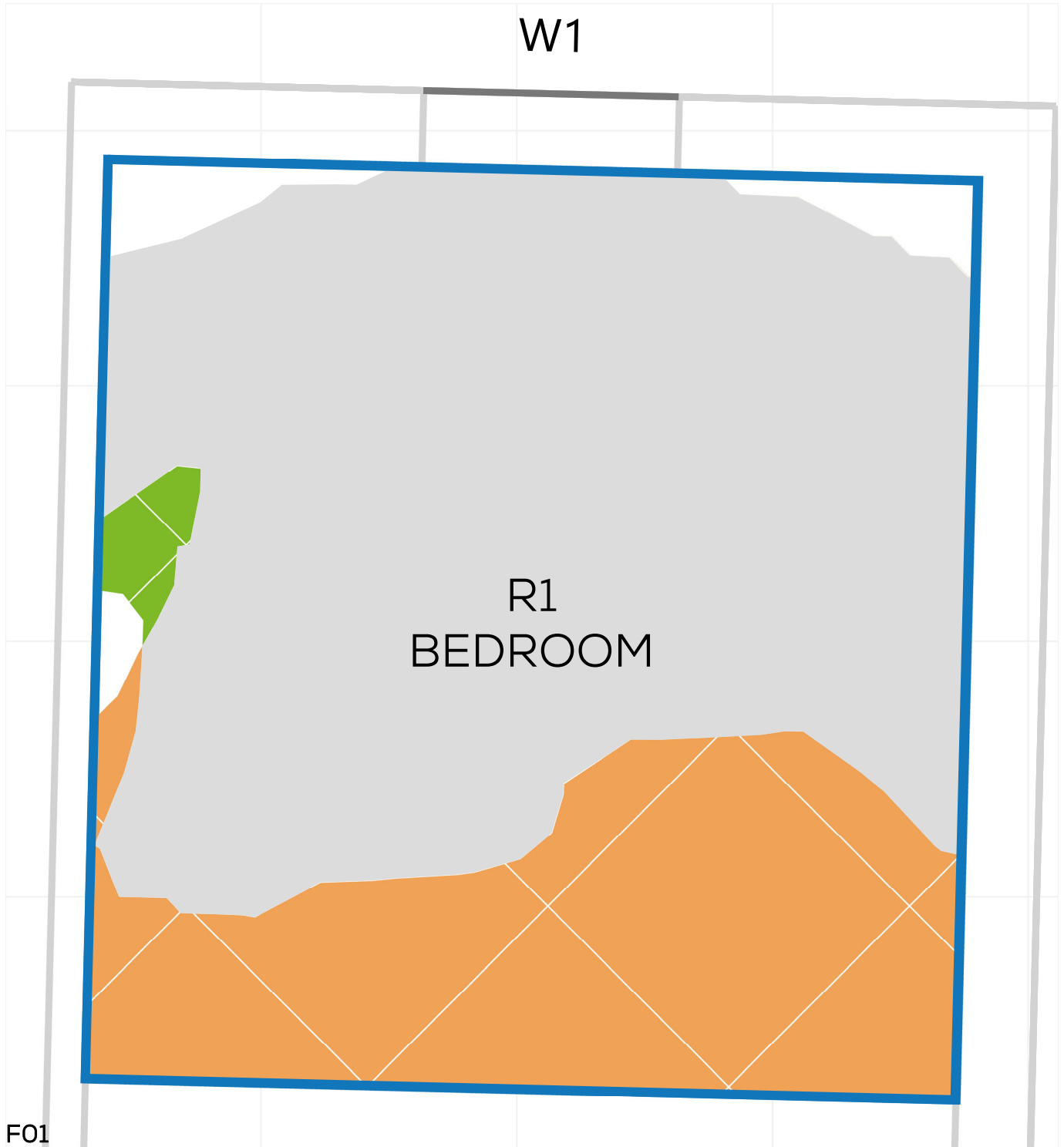

# NSL CONTOURS



PROJECT: 14047 - CAMBRIDGE ROAD  
REPORT TITLE: EXISTING VS. PROPOSED  
ADDRESS: THE LODGE 42 CAMBRIDGE ROAD  
DATE: 02/10/2020  
SCHEME IR: IR23 (07.09.2020)  
DRAWING No.: 14047-RELO6-IS02-DD128

**KEY:**

- GAIN
- LOSS
- MAINTAINED LIT AREA
- 1 METRE GRID

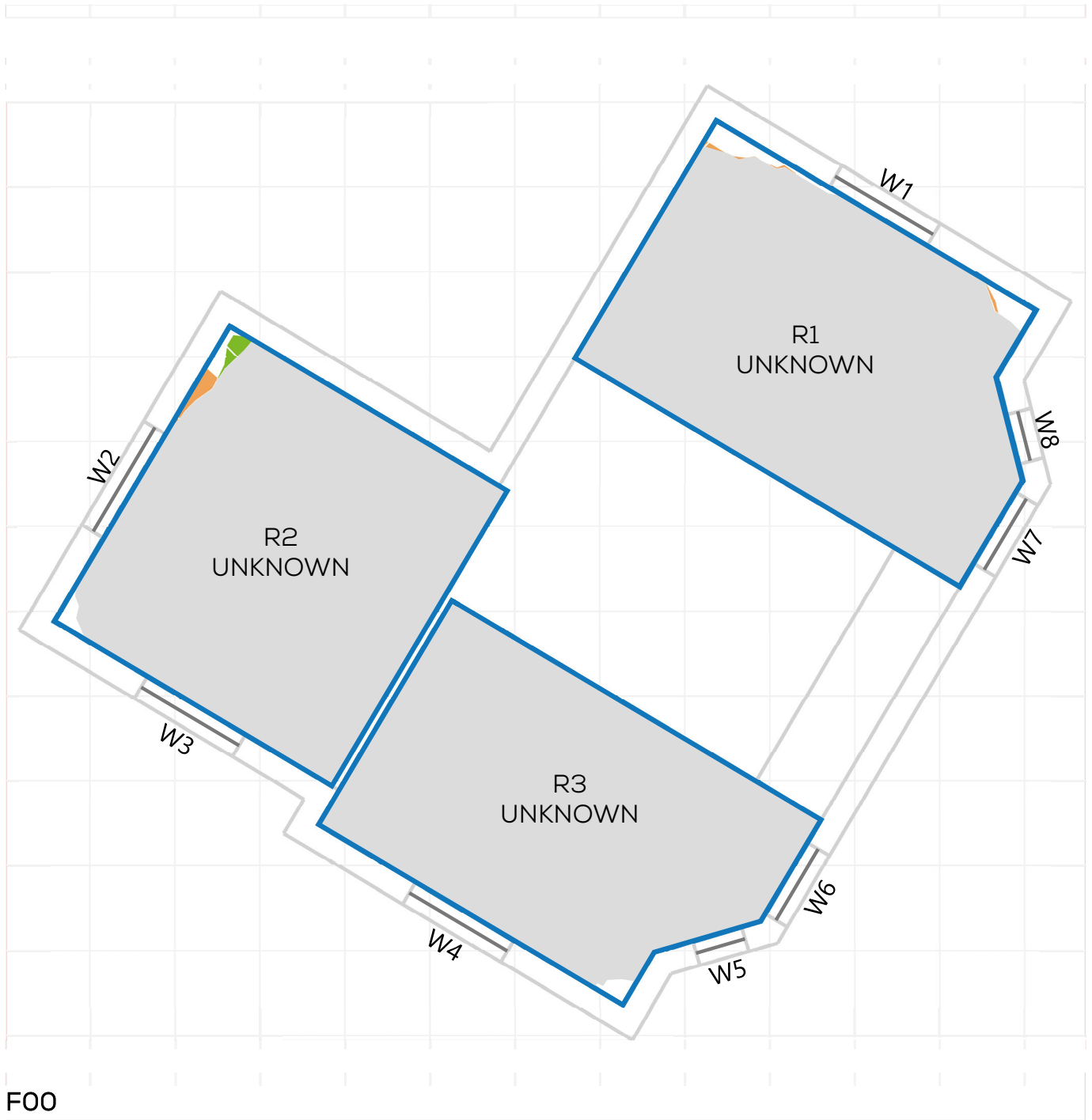
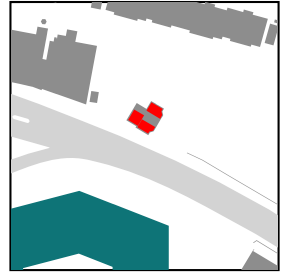

FOO

# NSL CONTOURS



PROJECT: 14047 - CAMBRIDGE ROAD  
REPORT TITLE: EXISTING VS. PROPOSED  
ADDRESS: THE LODGE 42 CAMBRIDGE ROAD  
DATE: 02/10/2020  
SCHEME IR: IR23 (07.09.2020)  
DRAWING No.: 14047-RELO6-IS02-DD129

**KEY:**

- GAIN
- LOSS
- MAINTAINED LIT AREA
- 1 METRE GRID

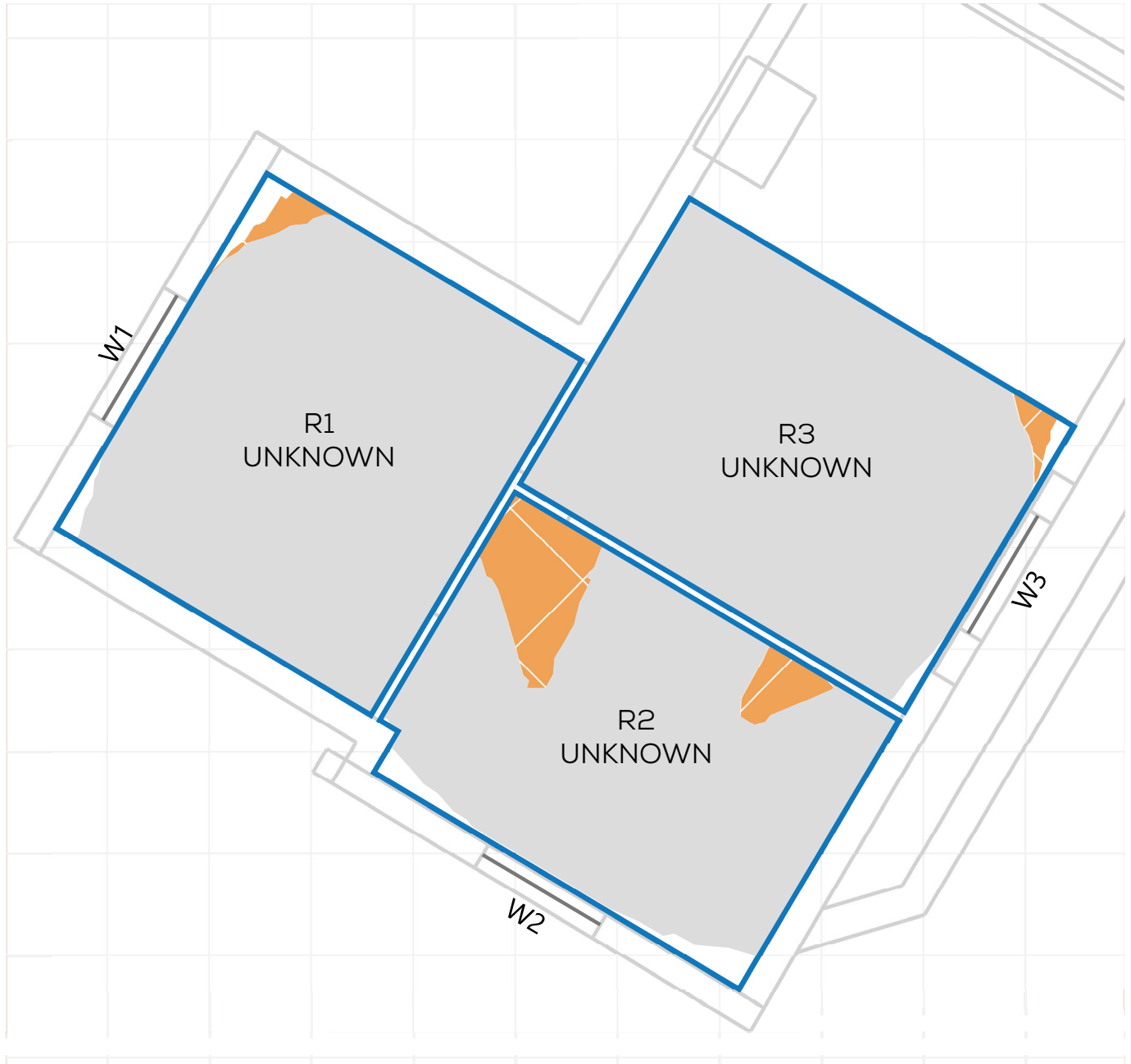
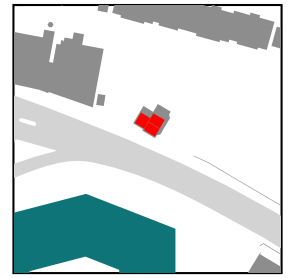

# NSL CONTOURS



PROJECT: 14047 - CAMBRIDGE ROAD  
REPORT TITLE: EXISTING VS. PROPOSED  
ADDRESS: CAMBRIDGE GARDENS  
DATE: 02/10/2020  
SCHEME IR: IR23 (07.09.2020)  
DRAWING No.: 14047-RELO6-IS02-DD130

**KEY:**

- GAIN
- LOSS
- MAINTAINED LIT AREA
- 1 METRE GRID

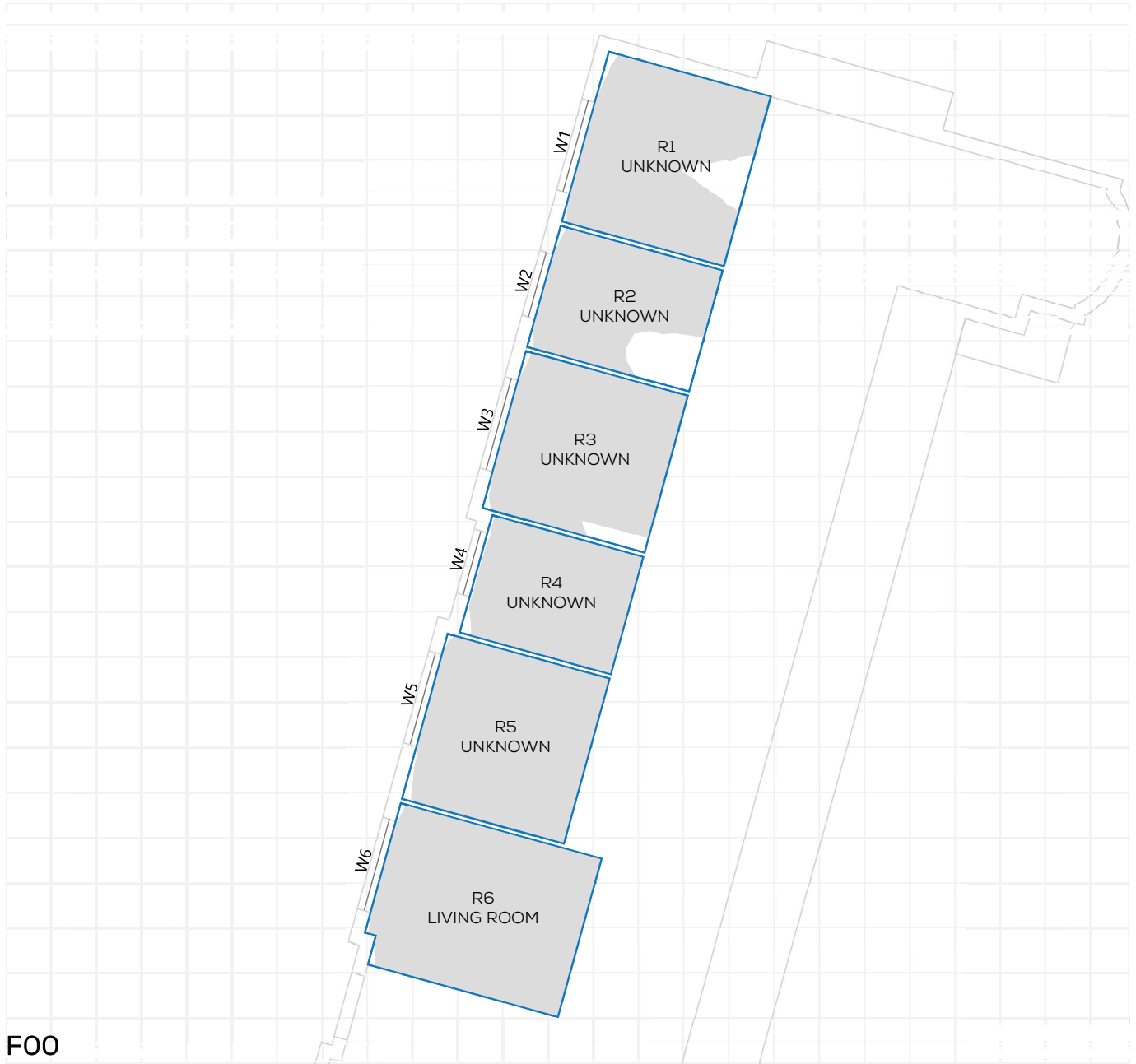



# NSL CONTOURS



PROJECT: 14047 - CAMBRIDGE ROAD  
REPORT TITLE: EXISTING VS. PROPOSED  
ADDRESS: CAMBRIDGE GARDENS  
DATE: 02/10/2020  
SCHEME IR: IR23 (07.09.2020)  
DRAWING No.: 14047-RELO6-IS02-DD131

## KEY:

- GAIN
- LOSS
- MAINTAINED LIT AREA
- 1 METRE GRID



FOO

# NSL CONTOURS



PROJECT: 14047 - CAMBRIDGE ROAD  
REPORT TITLE: EXISTING VS. PROPOSED  
ADDRESS: CAMBRIDGE GARDENS  
DATE: 02/10/2020  
SCHEME IR: IR23 (07.09.2020)  
DRAWING No.: 14047-RELO6-IS02-DD132

## KEY:

- GAIN
- LOSS
- MAINTAINED LIT AREA
- 1 METRE GRID

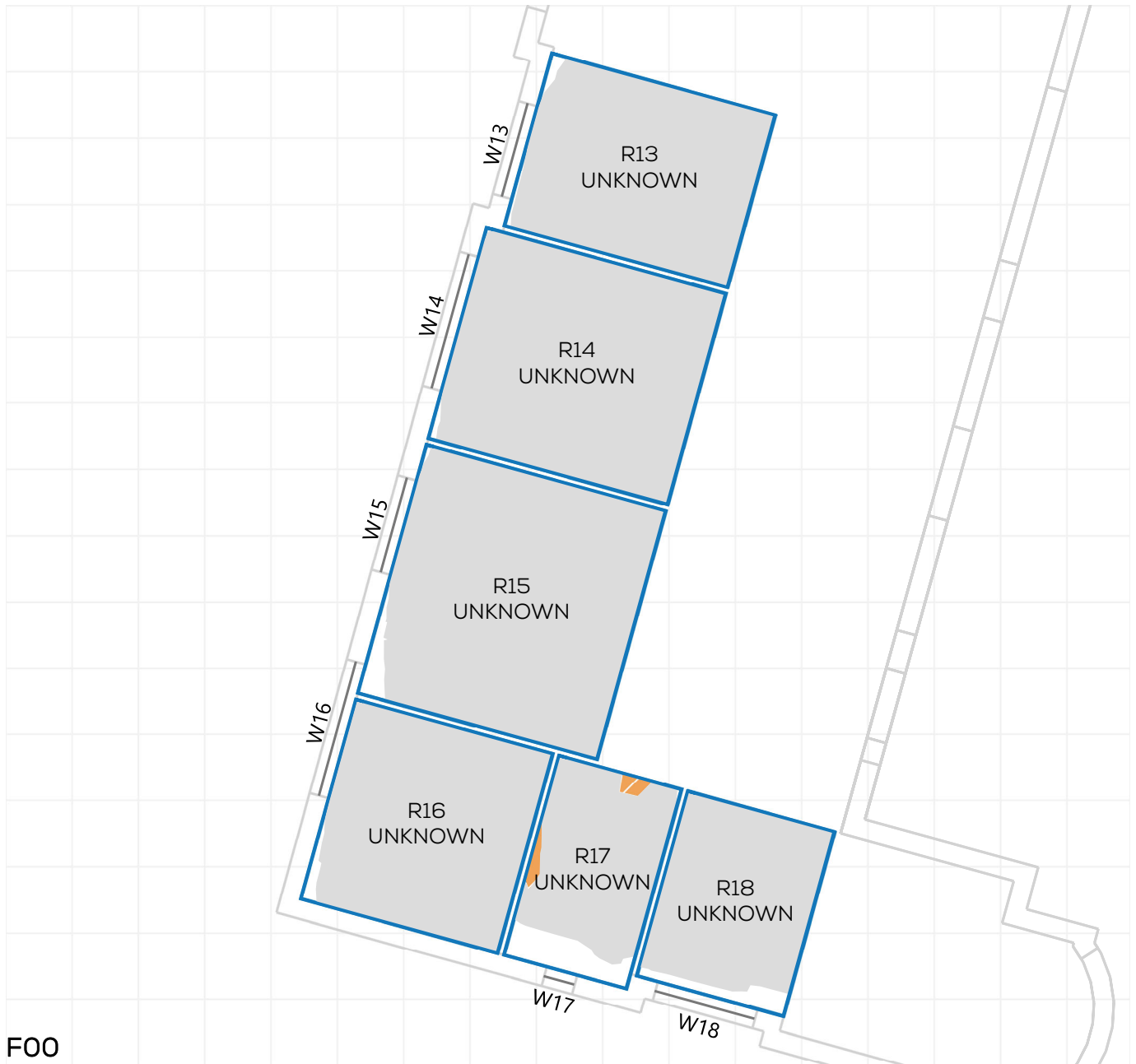
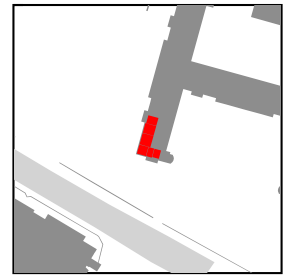

# NSL CONTOURS



PROJECT: 14047 - CAMBRIDGE ROAD  
REPORT TITLE: EXISTING VS. PROPOSED  
ADDRESS: CAMBRIDGE GARDENS  
DATE: 02/10/2020  
SCHEME IR: IR23 (07.09.2020)  
DRAWING No.: 14047-RELO6-IS02-DD133

## KEY:

- GAIN
- LOSS
- MAINTAINED LIT AREA
- 1 METRE GRID

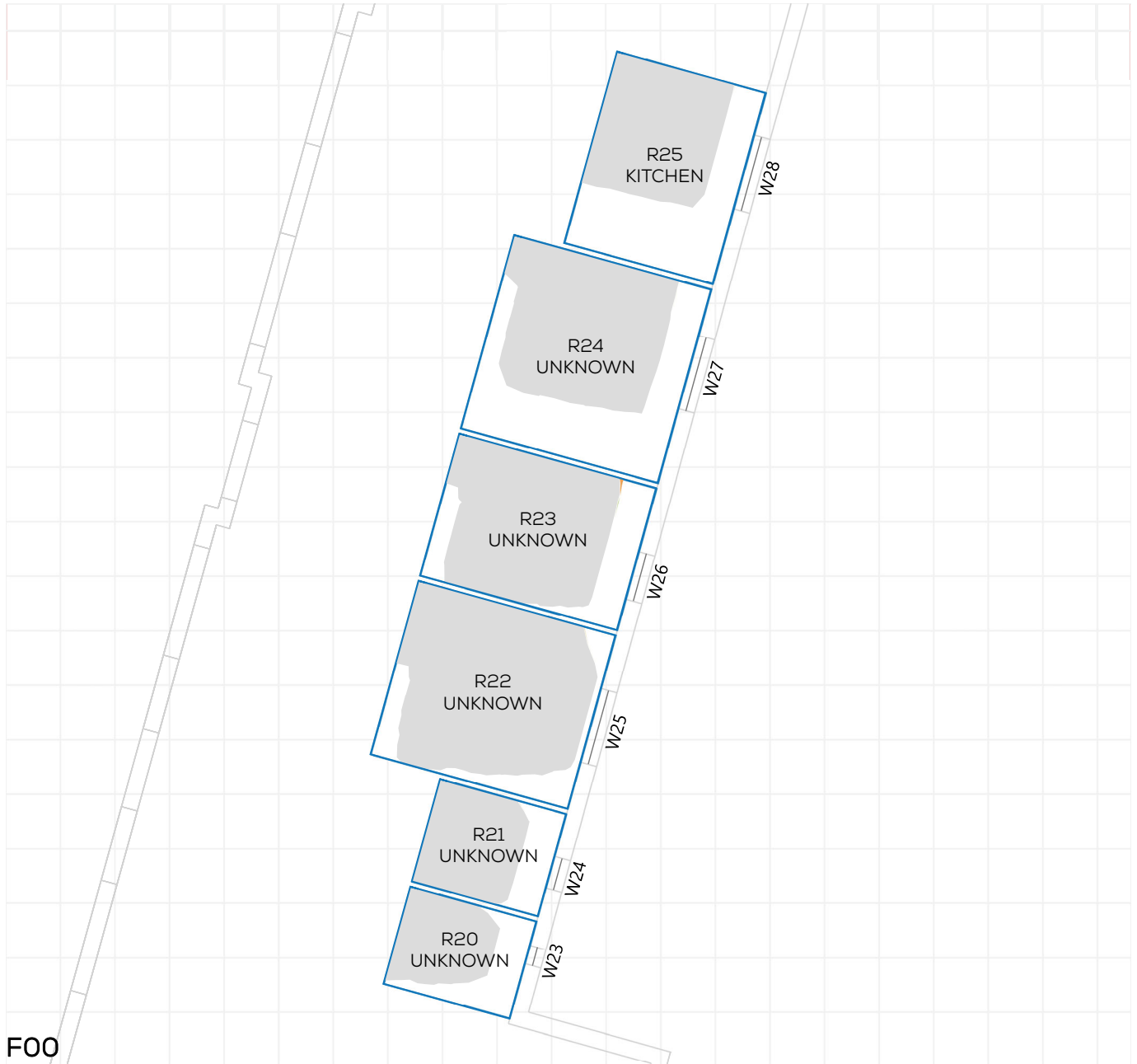
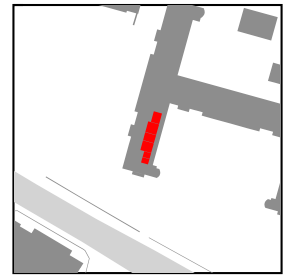

# NSL CONTOURS



PROJECT: 14047 - CAMBRIDGE ROAD  
REPORT TITLE: EXISTING VS. PROPOSED  
ADDRESS: CAMBRIDGE GARDENS  
DATE: 02/10/2020  
SCHEME IR: IR23 (07.09.2020)  
DRAWING No.: 14047-RELO6-IS02-DD134

**KEY:**

- GAIN
- LOSS
- MAINTAINED LIT AREA
- 1 METRE GRID

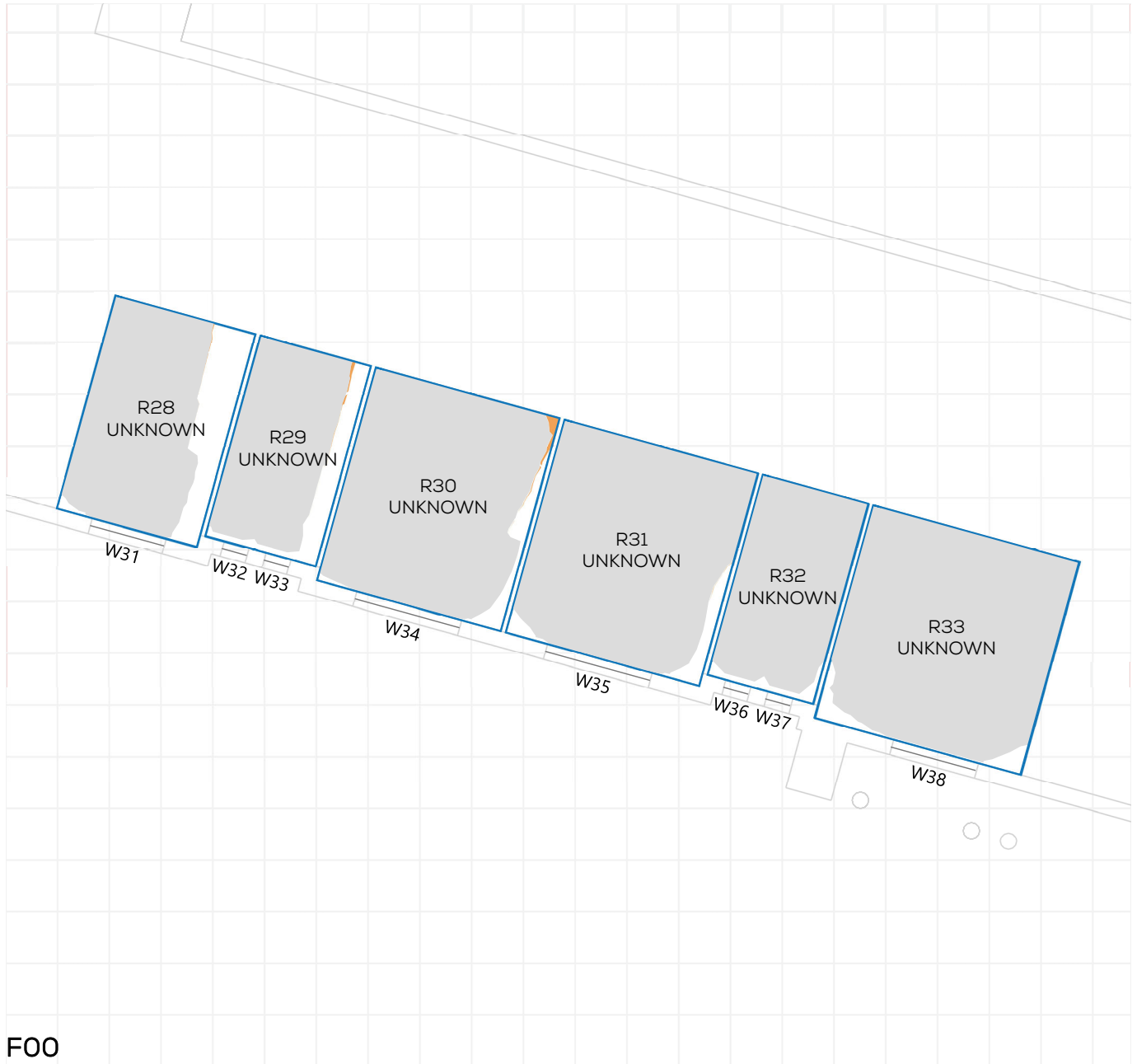
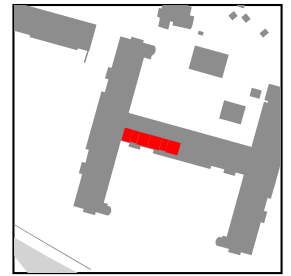

# NSL CONTOURS



PROJECT: 14047 - CAMBRIDGE ROAD  
REPORT TITLE: EXISTING VS. PROPOSED  
ADDRESS: CAMBRIDGE GARDENS  
DATE: 02/10/2020  
SCHEME IR: IR23 (07.09.2020)  
DRAWING No.: 14047-RELO6-IS02-DD135

## KEY:

- GAIN
- LOSS
- MAINTAINED LIT AREA
- 1 METRE GRID

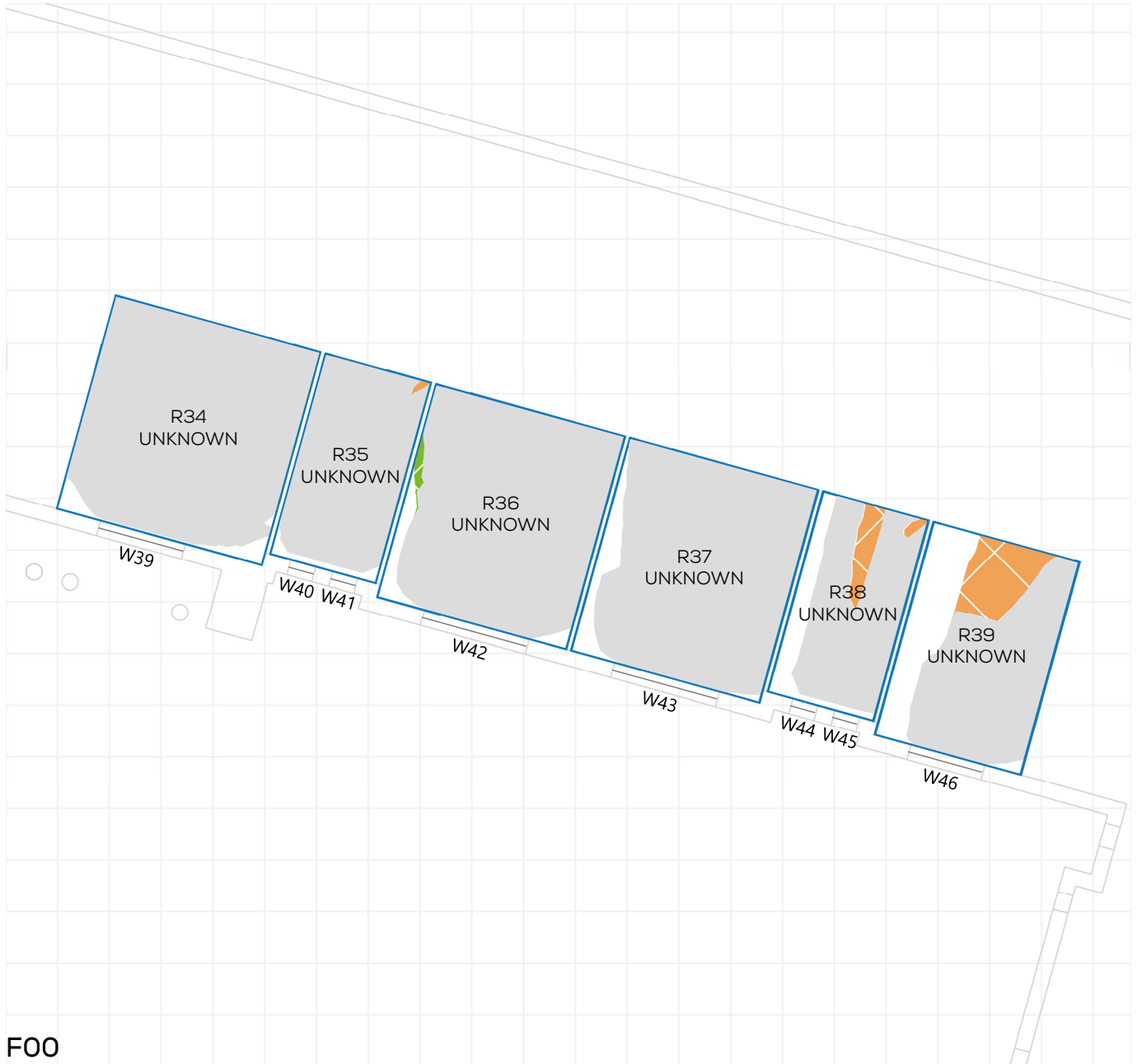
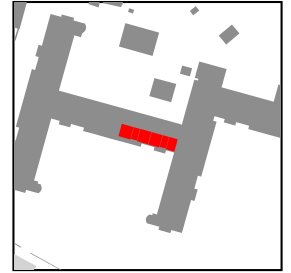

F00

# NSL CONTOURS



PROJECT: 14047 - CAMBRIDGE ROAD  
REPORT TITLE: EXISTING VS. PROPOSED  
ADDRESS: CAMBRIDGE GARDENS  
DATE: 02/10/2020  
SCHEME IR: IR23 (07.09.2020)  
DRAWING No.: 14047-RELO6-IS02-DD136

### KEY:

- GAIN
- LOSS
- MAINTAINED LIT AREA
- 1 METRE GRID

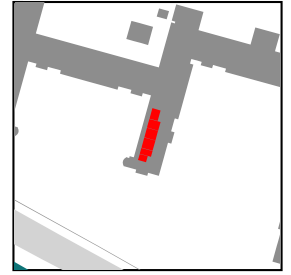

# NSL CONTOURS



PROJECT: 14047 - CAMBRIDGE ROAD  
REPORT TITLE: EXISTING VS. PROPOSED  
ADDRESS: CAMBRIDGE GARDENS  
DATE: 02/10/2020  
SCHEME IR: IR23 (07.09.2020)  
DRAWING No.: 14047-RELO6-IS02-DD137

## KEY:

- GAIN
- LOSS
- MAINTAINED LIT AREA
- 1 METRE GRID

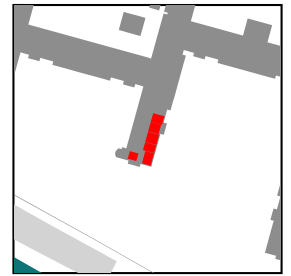

# NSL CONTOURS



PROJECT: 14047 - CAMBRIDGE ROAD  
REPORT TITLE: EXISTING VS. PROPOSED  
ADDRESS: CAMBRIDGE GARDENS  
DATE: 02/10/2020  
SCHEME IR: IR23 (07.09.2020)  
DRAWING No.: 14047-RELO6-IS02-DD138

## KEY:

- GAIN
- LOSS
- MAINTAINED LIT AREA
- 1 METRE GRID

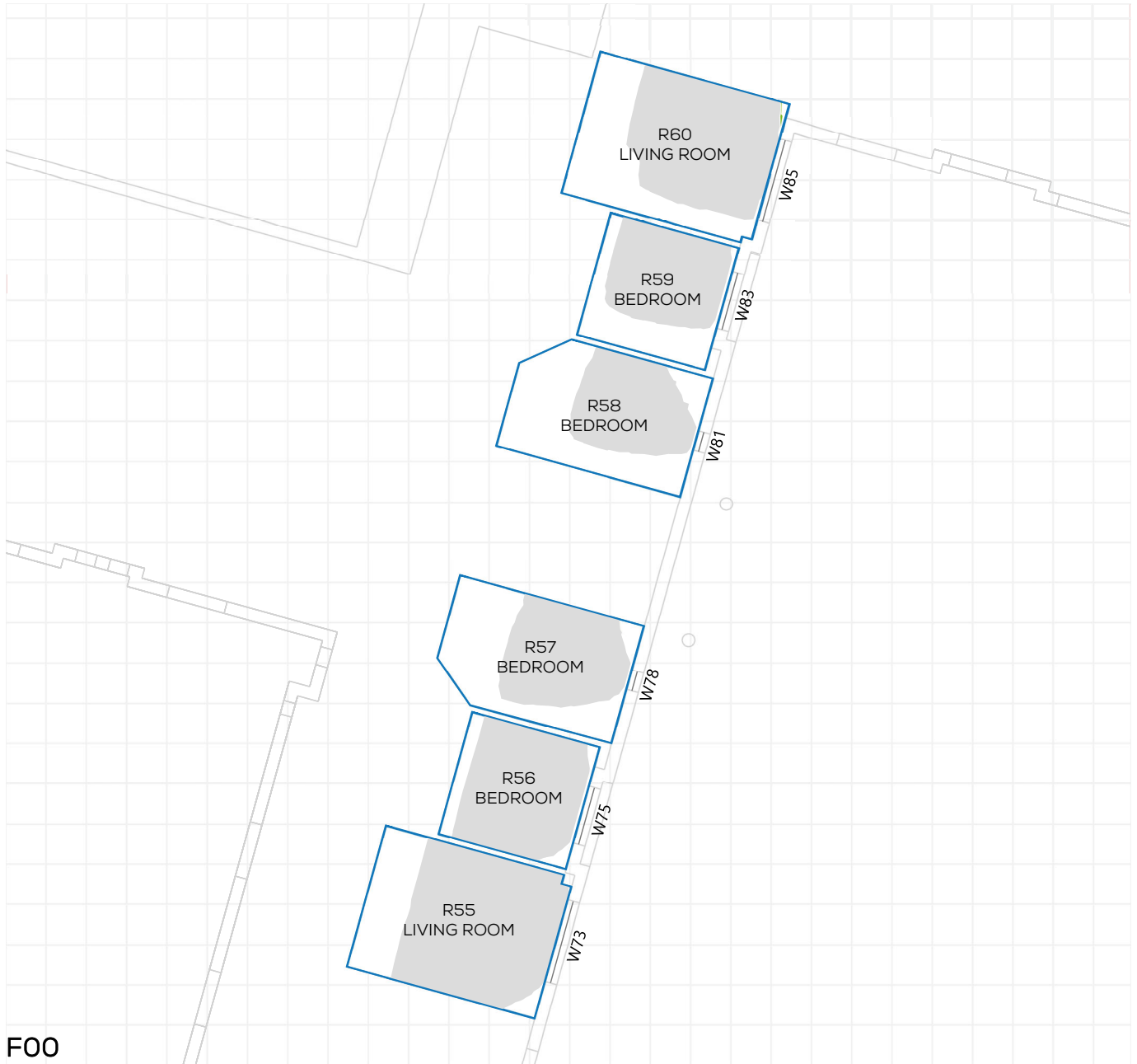



# NSL CONTOURS



PROJECT: 14047 - CAMBRIDGE ROAD  
REPORT TITLE: EXISTING VS. PROPOSED  
ADDRESS: CAMBRIDGE GARDENS  
DATE: 02/10/2020  
SCHEME IR: IR23 (07.09.2020)  
DRAWING No.: 14047-RELO6-IS02-DD139

### KEY:

- GAIN
- LOSS
- MAINTAINED LIT AREA
- 1 METRE GRID

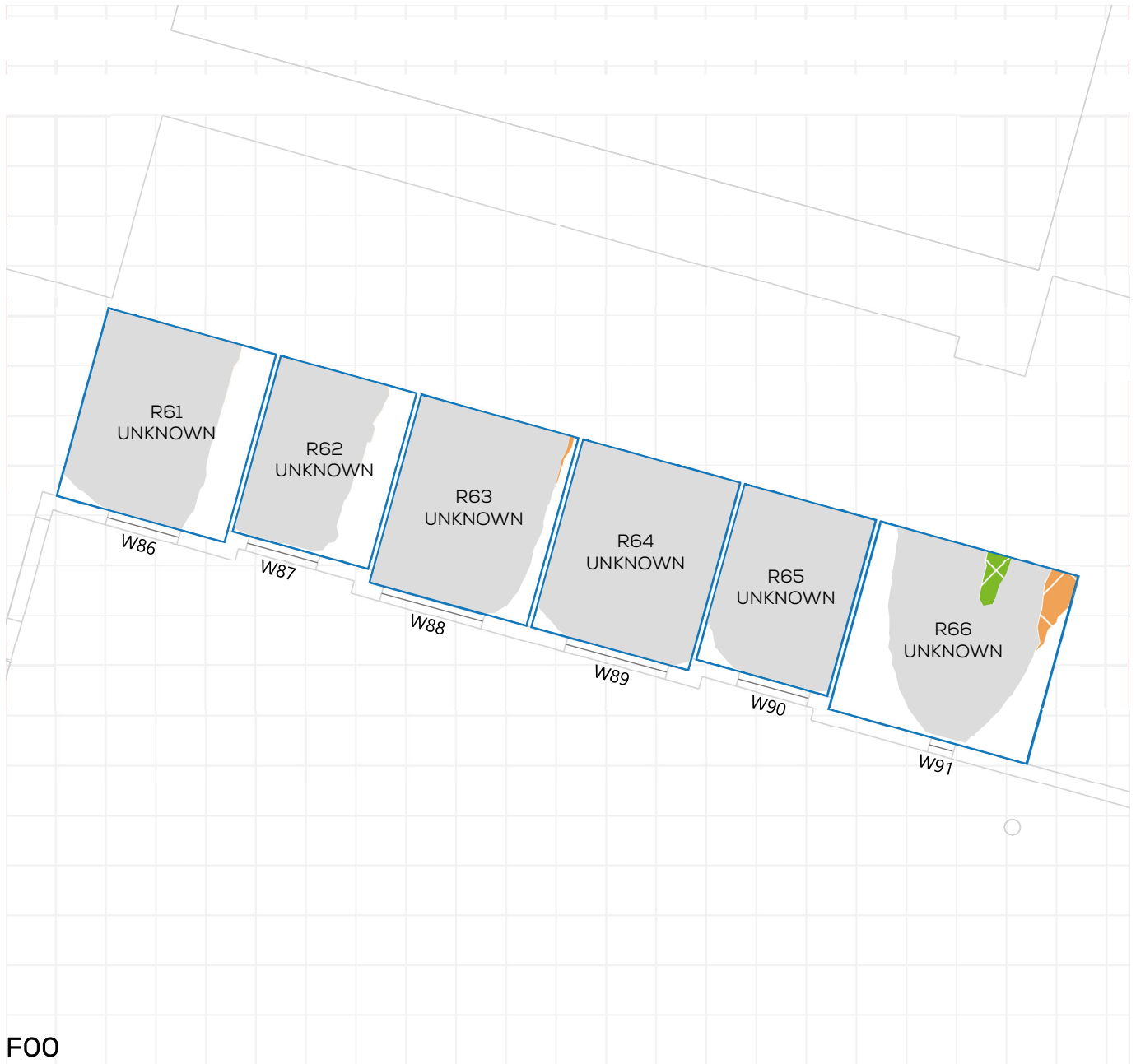
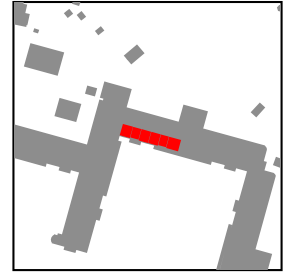

# NSL CONTOURS



PROJECT: 14047 - CAMBRIDGE ROAD  
REPORT TITLE: EXISTING VS. PROPOSED  
ADDRESS: CAMBRIDGE GARDENS  
DATE: 02/10/2020  
SCHEME IR: IR23 (07.09.2020)  
DRAWING No.: 14047-RELO6-IS02-DD140

### KEY:

- GAIN
- LOSS
- MAINTAINED LIT AREA
- 1 METRE GRID

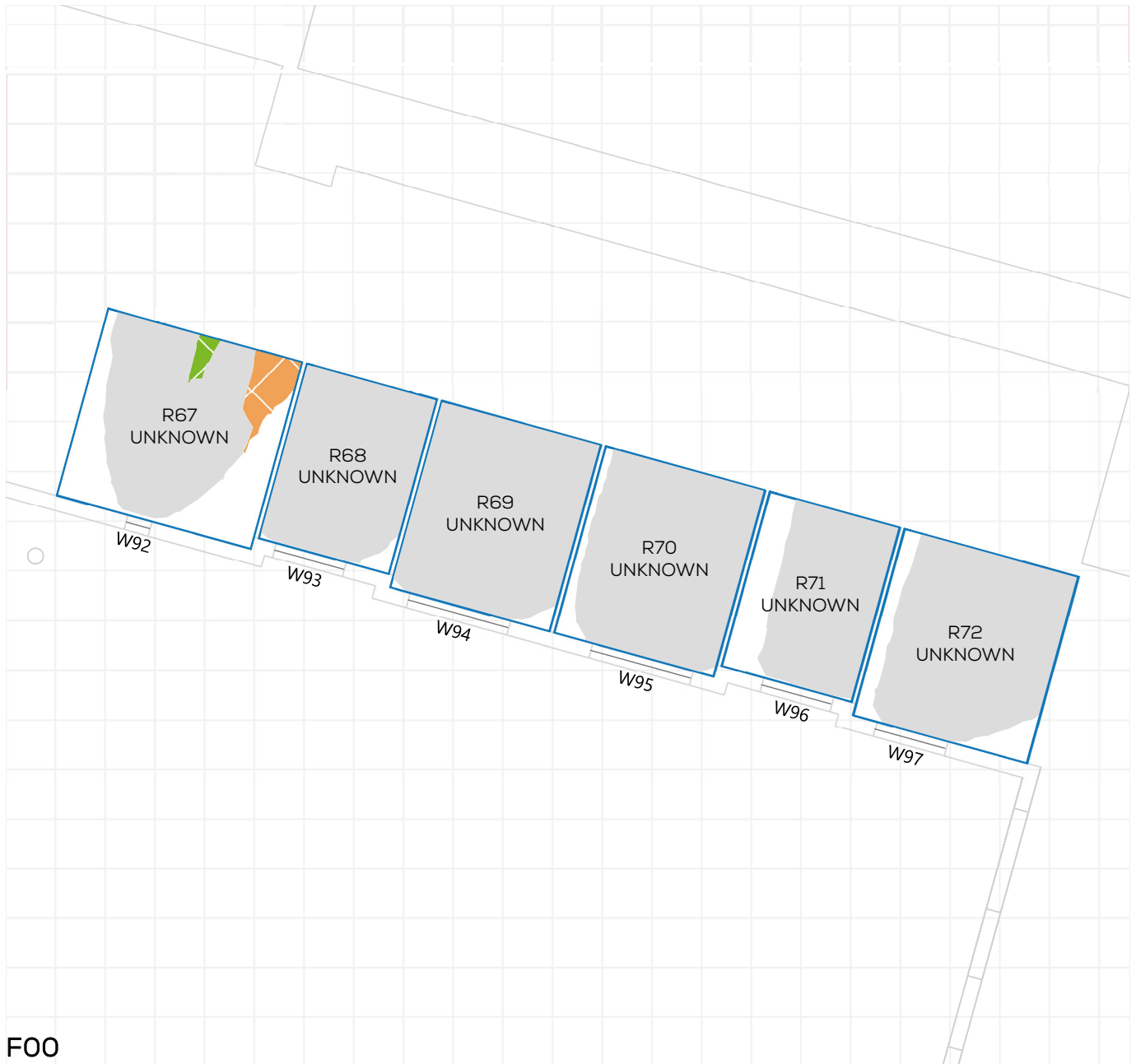
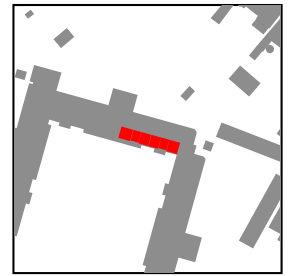

# NSL CONTOURS



PROJECT: 14047 - CAMBRIDGE ROAD  
REPORT TITLE: EXISTING VS. PROPOSED  
ADDRESS: CAMBRIDGE GARDENS  
DATE: 02/10/2020  
SCHEME IR: IR23 (07.09.2020)  
DRAWING No.: 14047-RELO6-IS02-DD141

## KEY:

- GAIN
- LOSS
- MAINTAINED LIT AREA
- 1 METRE GRID

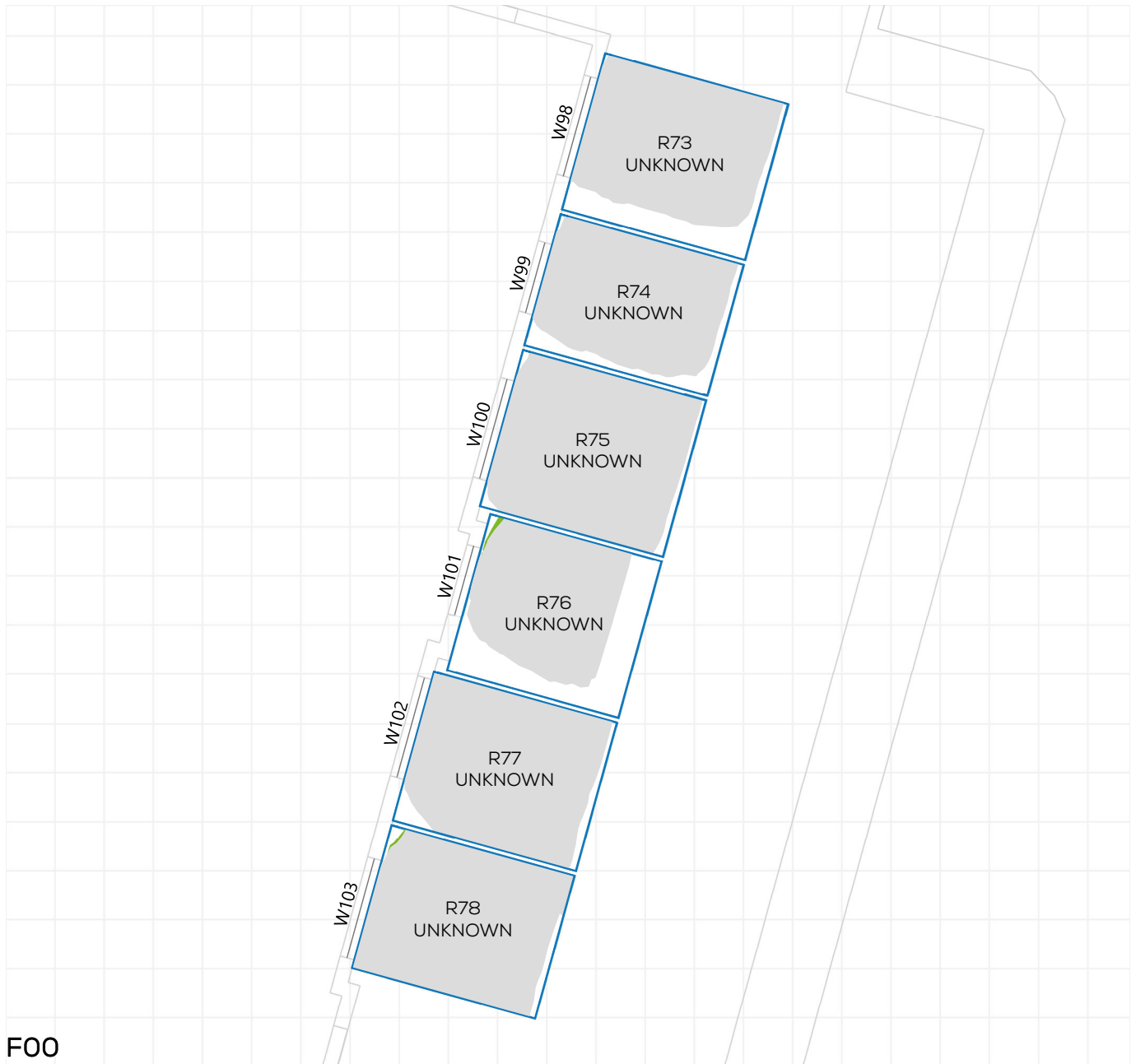
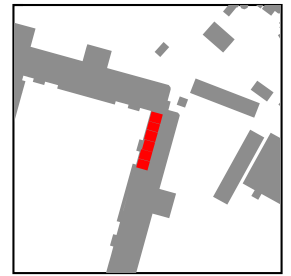

FOO



# NSL CONTOURS



PROJECT: 14047 - CAMBRIDGE ROAD  
REPORT TITLE: EXISTING VS. PROPOSED  
ADDRESS: CAMBRIDGE GARDENS  
DATE: 02/10/2020  
SCHEME IR: IR23 (07.09.2020)  
DRAWING No.: 14047-RELO6-IS02-DD143

**KEY:**

- GAIN
- LOSS
- MAINTAINED LIT AREA
- 1 METRE GRID

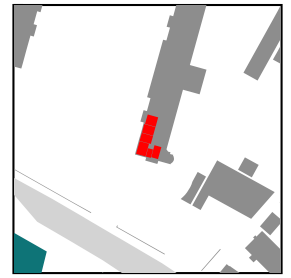

FOO

# NSL CONTOURS



PROJECT: 14047 - CAMBRIDGE ROAD  
REPORT TITLE: EXISTING VS. PROPOSED  
ADDRESS: CAMBRIDGE GARDENS  
DATE: 02/10/2020  
SCHEME IR: IR23 (07.09.2020)  
DRAWING No.: 14047-RELO6-IS02-DD144

**KEY:**

- GAIN
- LOSS
- MAINTAINED LIT AREA
- 1 METRE GRID

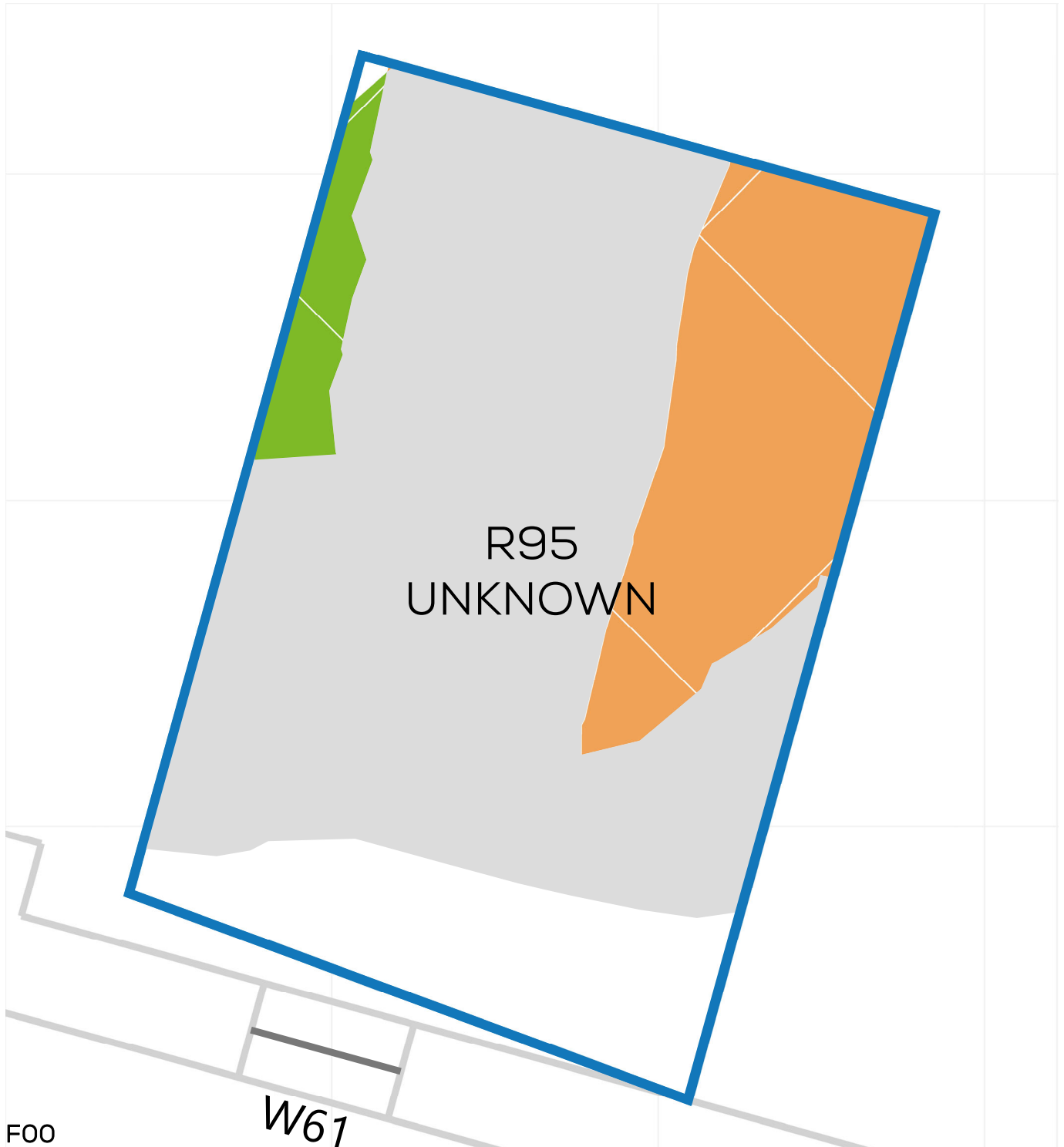
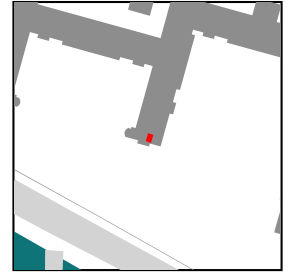

# NSL CONTOURS



PROJECT: 14047 - CAMBRIDGE ROAD  
REPORT TITLE: EXISTING VS. PROPOSED  
ADDRESS: CAMBRIDGE GARDENS  
DATE: 02/10/2020  
SCHEME IR: IR23 (07.09.2020)  
DRAWING No.: 14047-RELO6-IS02-DD145

## KEY:

- GAIN
- LOSS
- MAINTAINED LIT AREA
- 1 METRE GRID

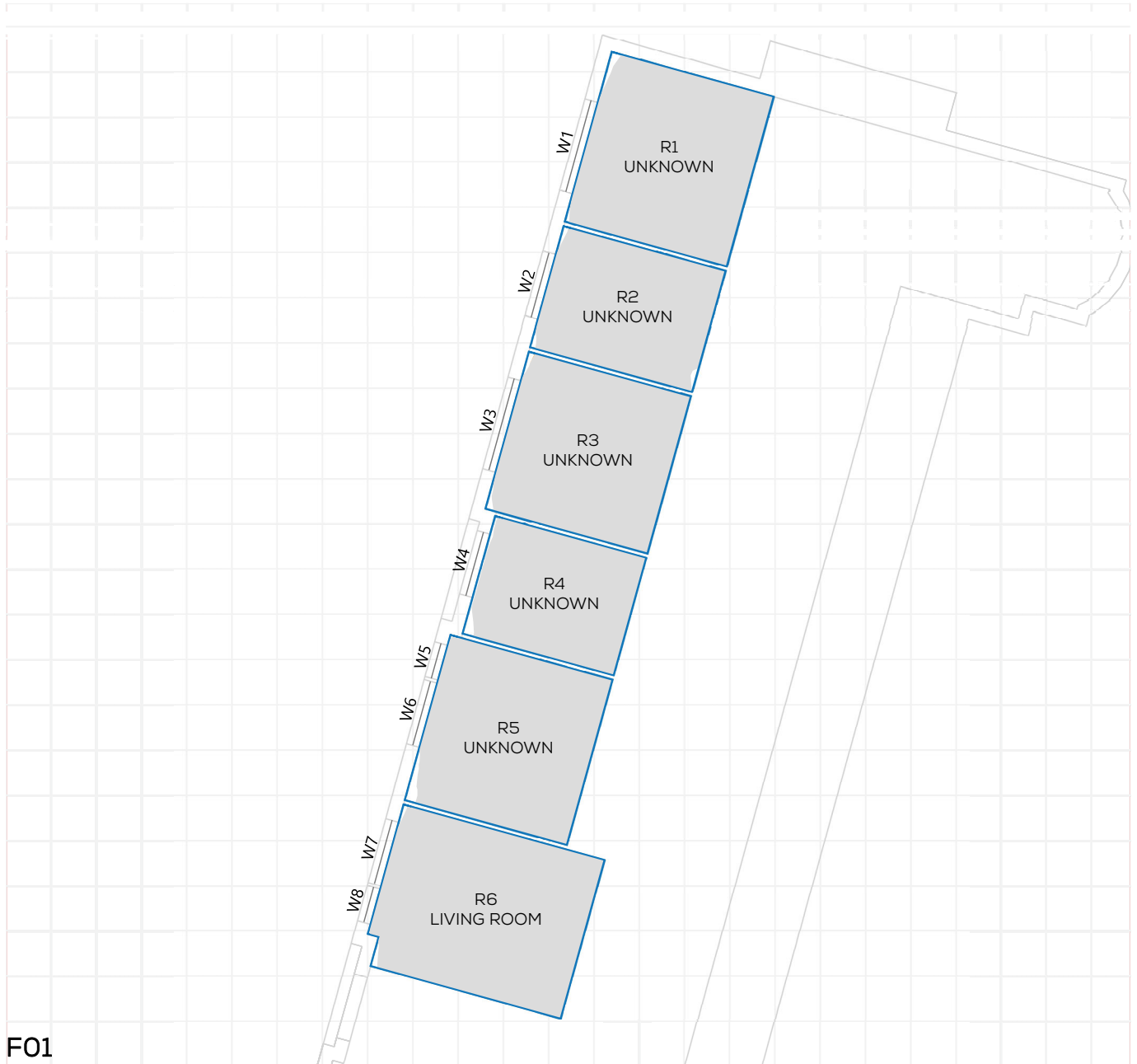

F01

# NSL CONTOURS



PROJECT: 14047 - CAMBRIDGE ROAD  
REPORT TITLE: EXISTING VS. PROPOSED  
ADDRESS: CAMBRIDGE GARDENS  
DATE: 02/10/2020  
SCHEME IR: IR23 (07.09.2020)  
DRAWING No.: 14047-RELO6-IS02-DD146

## KEY:

- GAIN
- LOSS
- MAINTAINED LIT AREA
- 1 METRE GRID



F01



# NSL CONTOURS



PROJECT: 14047 - CAMBRIDGE ROAD  
REPORT TITLE: EXISTING VS. PROPOSED  
ADDRESS: CAMBRIDGE GARDENS  
DATE: 02/10/2020  
SCHEME IR: IR23 (07.09.2020)  
DRAWING No.: 14047-RELO6-IS02-DD147

## KEY:

- GAIN
- LOSS
- MAINTAINED LIT AREA
- 1 METRE GRID

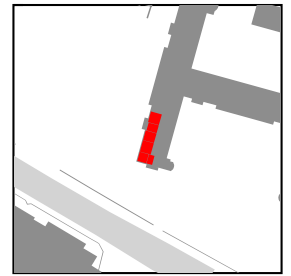

# NSL CONTOURS



PROJECT: 14047 - CAMBRIDGE ROAD  
REPORT TITLE: EXISTING VS. PROPOSED  
ADDRESS: CAMBRIDGE GARDENS  
DATE: 02/10/2020  
SCHEME IR: IR23 (07.09.2020)  
DRAWING No.: 14047-RELO6-IS02-DD148

## KEY:

- GAIN
- LOSS
- MAINTAINED LIT AREA
- 1 METRE GRID

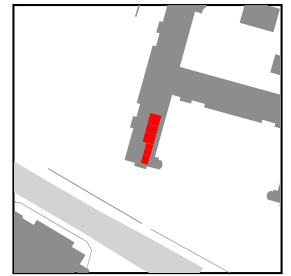





# NSL CONTOURS



PROJECT: 14047 - CAMBRIDGE ROAD  
REPORT TITLE: EXISTING VS. PROPOSED  
ADDRESS: CAMBRIDGE GARDENS  
DATE: 02/10/2020  
SCHEME IR: IR23 (07.09.2020)  
DRAWING No.: 14047-RELO6-IS02-DD149

### KEY:

-  GAIN
-  LOSS
-  MAINTAINED LIT AREA
-  1 METRE GRID

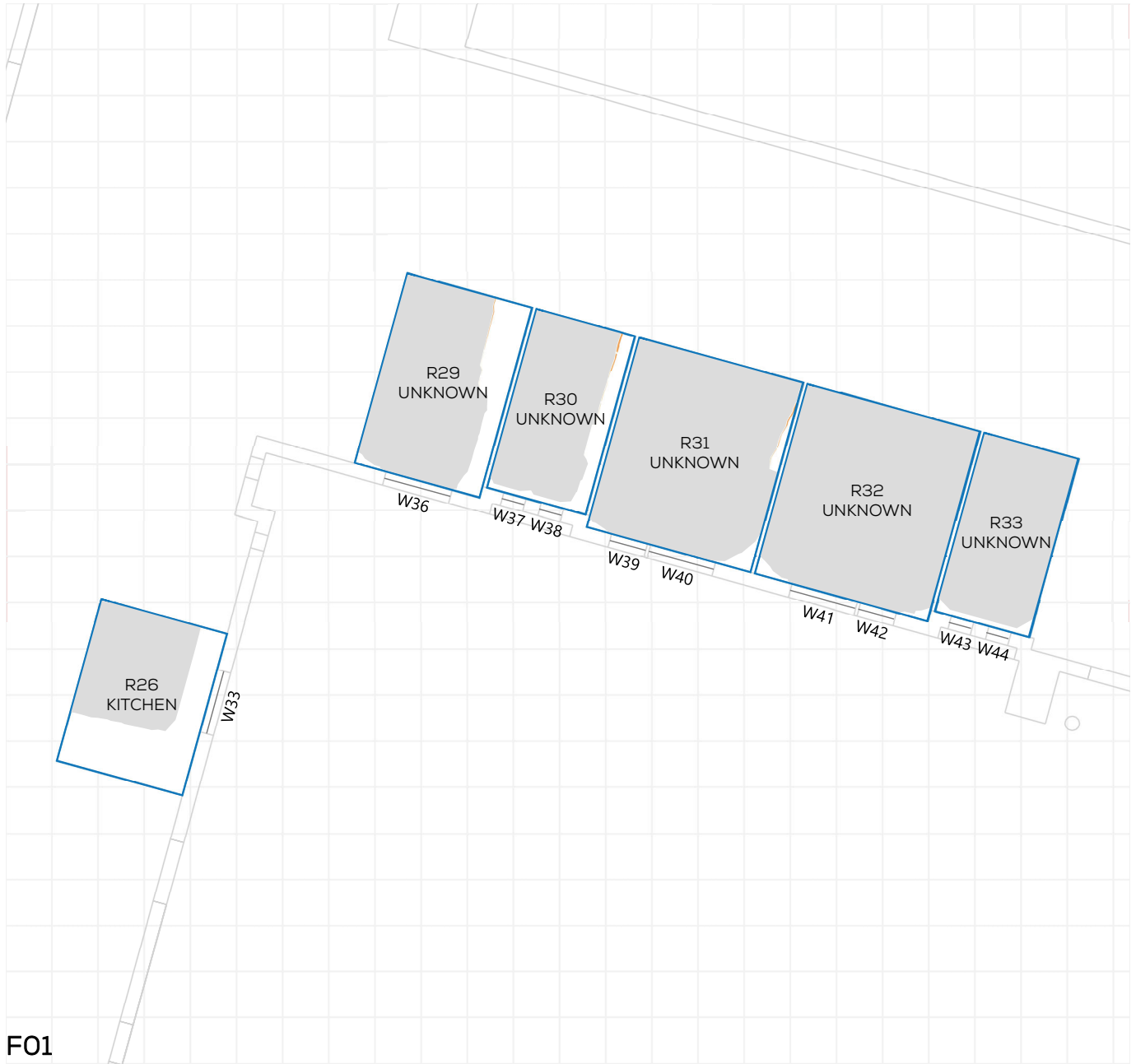
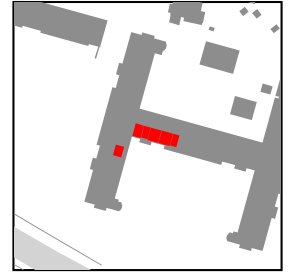

# NSL CONTOURS



PROJECT: 14047 - CAMBRIDGE ROAD  
REPORT TITLE: EXISTING VS. PROPOSED  
ADDRESS: CAMBRIDGE GARDENS  
DATE: 02/10/2020  
SCHEME IR: IR23 (07.09.2020)  
DRAWING No.: 14047-RELO6-IS02-DD150

### KEY:

- GAIN
- LOSS
- MAINTAINED LIT AREA
- 1 METRE GRID

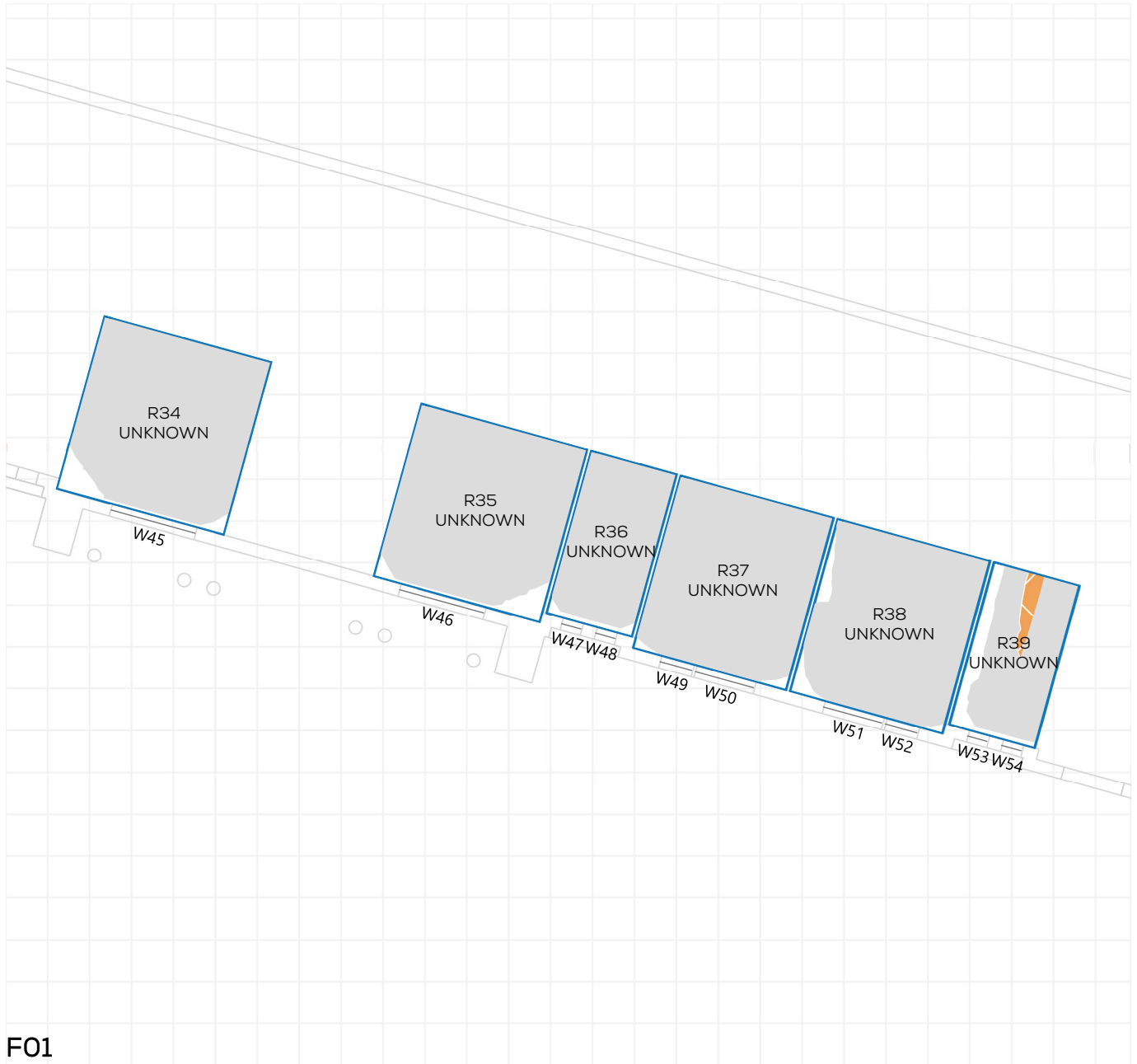

F01

# NSL CONTOURS



PROJECT: 14047 - CAMBRIDGE ROAD  
REPORT TITLE: EXISTING VS. PROPOSED  
ADDRESS: CAMBRIDGE GARDENS  
DATE: 02/10/2020  
SCHEME IR: IR23 (07.09.2020)  
DRAWING No.: 14047-RELO6-IS02-DD151

**KEY:**

- GAIN
- LOSS
- MAINTAINED LIT AREA
- 1 METRE GRID

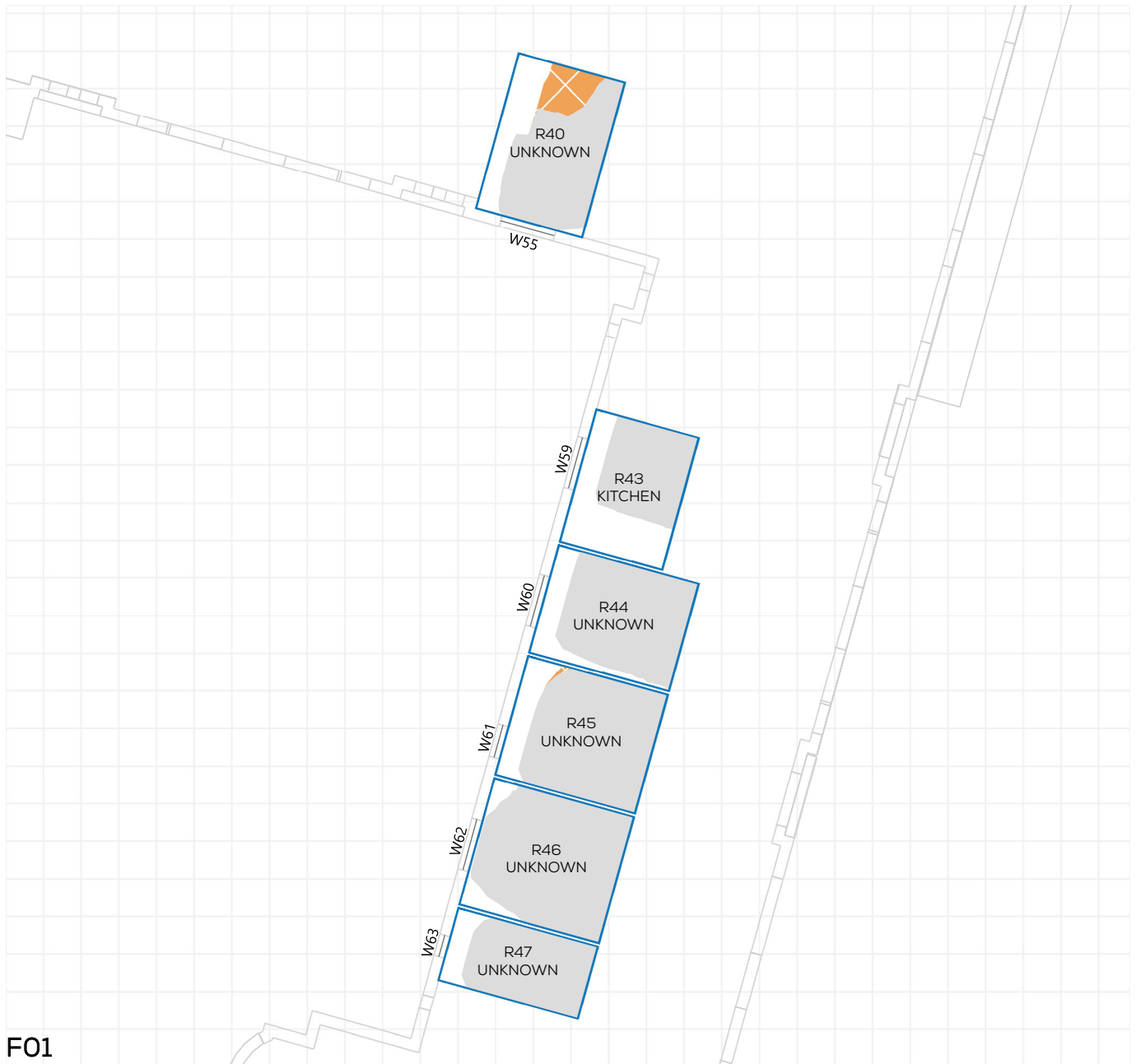
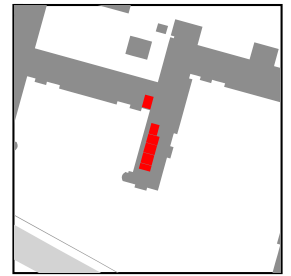

F01

# NSL CONTOURS



PROJECT: 14047 - CAMBRIDGE ROAD  
REPORT TITLE: EXISTING VS. PROPOSED  
ADDRESS: CAMBRIDGE GARDENS  
DATE: 02/10/2020  
SCHEME IR: IR23 (07.09.2020)  
DRAWING No.: 14047-RELO6-IS02-DD152

**KEY:**

- GAIN
- LOSS
- MAINTAINED LIT AREA
- 1 METRE GRID

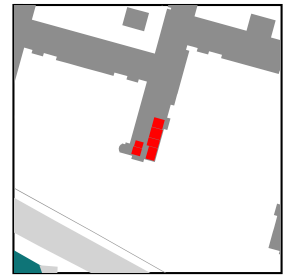

# NSL CONTOURS



PROJECT: 14047 - CAMBRIDGE ROAD  
REPORT TITLE: EXISTING VS. PROPOSED  
ADDRESS: CAMBRIDGE GARDENS  
DATE: 02/10/2020  
SCHEME IR: IR23 (07.09.2020)  
DRAWING No.: 14047-RELO6-IS02-DD153

## KEY:

- GAIN
- LOSS
- MAINTAINED LIT AREA
- 1 METRE GRID



# NSL CONTOURS



PROJECT: 14047 - CAMBRIDGE ROAD  
REPORT TITLE: EXISTING VS. PROPOSED  
ADDRESS: CAMBRIDGE GARDENS  
DATE: 02/10/2020  
SCHEME IR: IR23 (07.09.2020)  
DRAWING No.: 14047-RELO6-IS02-DD154

### KEY:

- GAIN
- LOSS
- MAINTAINED LIT AREA
- 1 METRE GRID

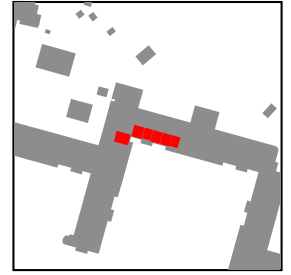

F01







# NSL CONTOURS



PROJECT: 14047 - CAMBRIDGE ROAD  
REPORT TITLE: EXISTING VS. PROPOSED  
ADDRESS: CAMBRIDGE GARDENS  
DATE: 02/10/2020  
SCHEME IR: IR23 (07.09.2020)  
DRAWING No.: 14047-RELO6-IS02-DD155

### KEY:

-  GAIN
-  LOSS
-  MAINTAINED LIT AREA
-  1 METRE GRID

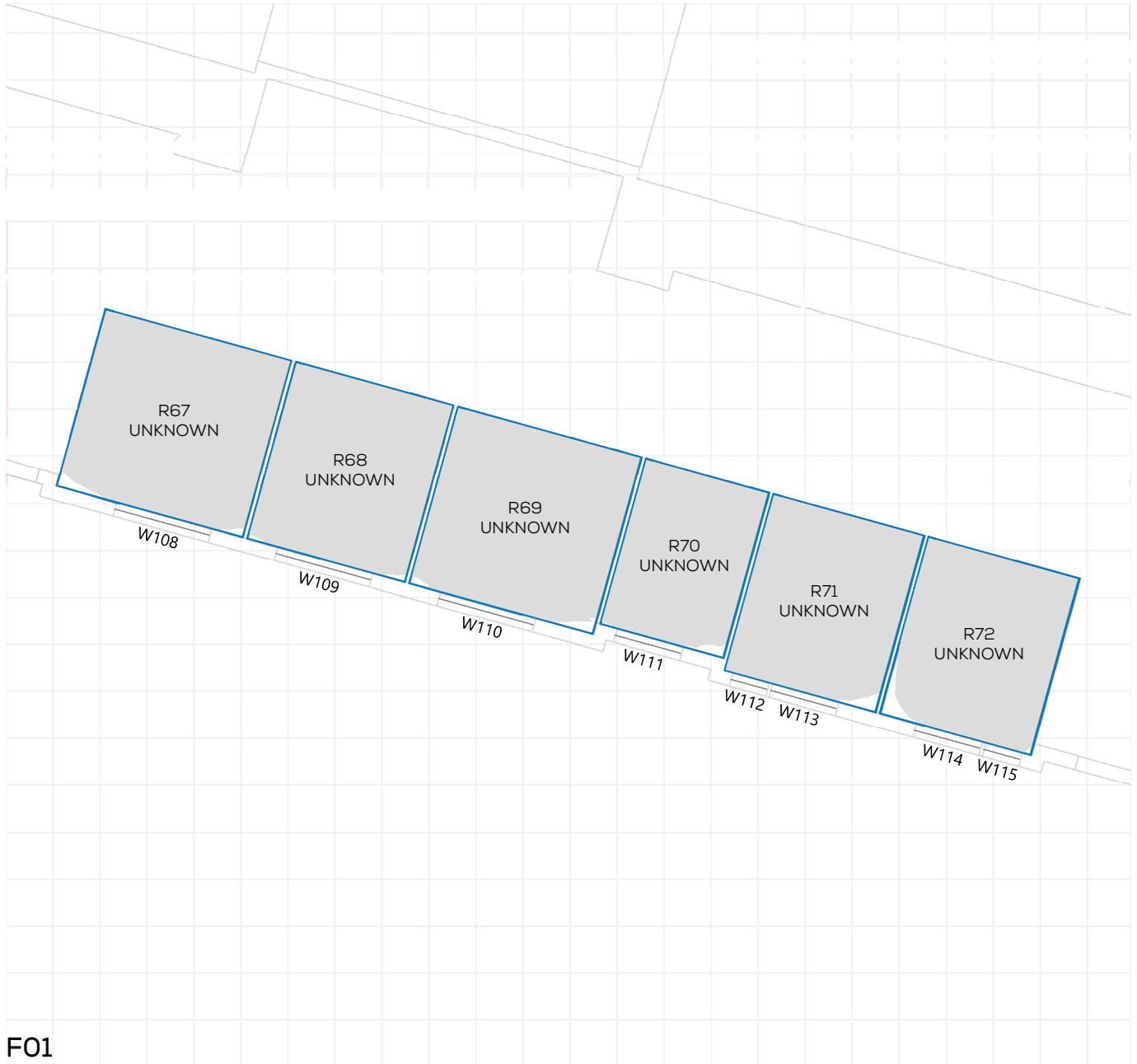
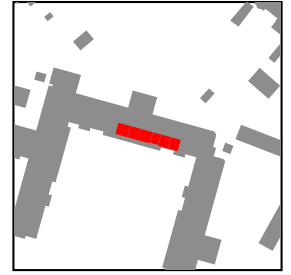

F01