

# NSL CONTOURS



PROJECT: 14047 - CAMBRIDGE ROAD  
REPORT TITLE: EXISTING VS. PROPOSED  
ADDRESS: CAMBRIDGE GARDENS  
DATE: 02/10/2020  
SCHEME IR: IR23 (07.09.2020)  
DRAWING No.: 14047-RELO6-IS02-DD156

**KEY:**

- GAIN
- LOSS
- MAINTAINED LIT AREA
- 1 METRE GRID

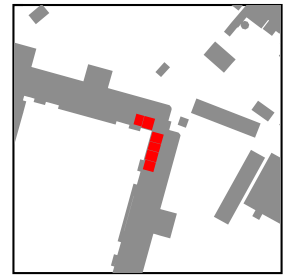

F01

# NSL CONTOURS



PROJECT: 14047 - CAMBRIDGE ROAD  
REPORT TITLE: EXISTING VS. PROPOSED  
ADDRESS: CAMBRIDGE GARDENS  
DATE: 02/10/2020  
SCHEME IR: IR23 (07.09.2020)  
DRAWING No.: 14047-RELO6-IS02-DD157

## KEY:

- GAIN
- LOSS
- MAINTAINED LIT AREA
- 1 METRE GRID

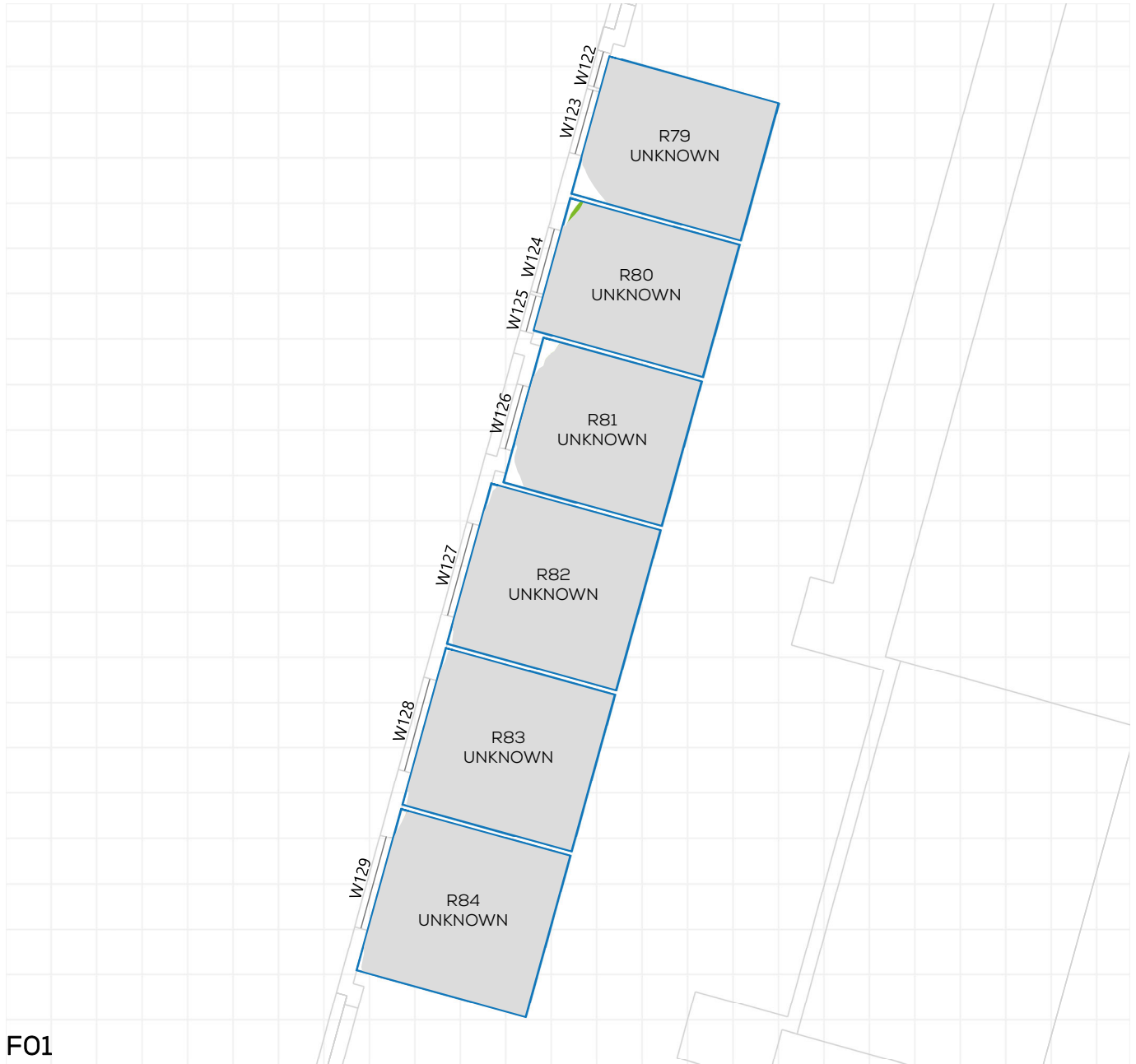
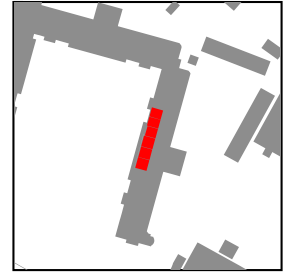

# NSL CONTOURS



PROJECT: 14047 - CAMBRIDGE ROAD  
REPORT TITLE: EXISTING VS. PROPOSED  
ADDRESS: CAMBRIDGE GARDENS  
DATE: 02/10/2020  
SCHEME IR: IR23 (07.09.2020)  
DRAWING No.: 14047-RELO6-IS02-DD158

### KEY:

- GAIN
- LOSS
- MAINTAINED LIT AREA
- 1 METRE GRID

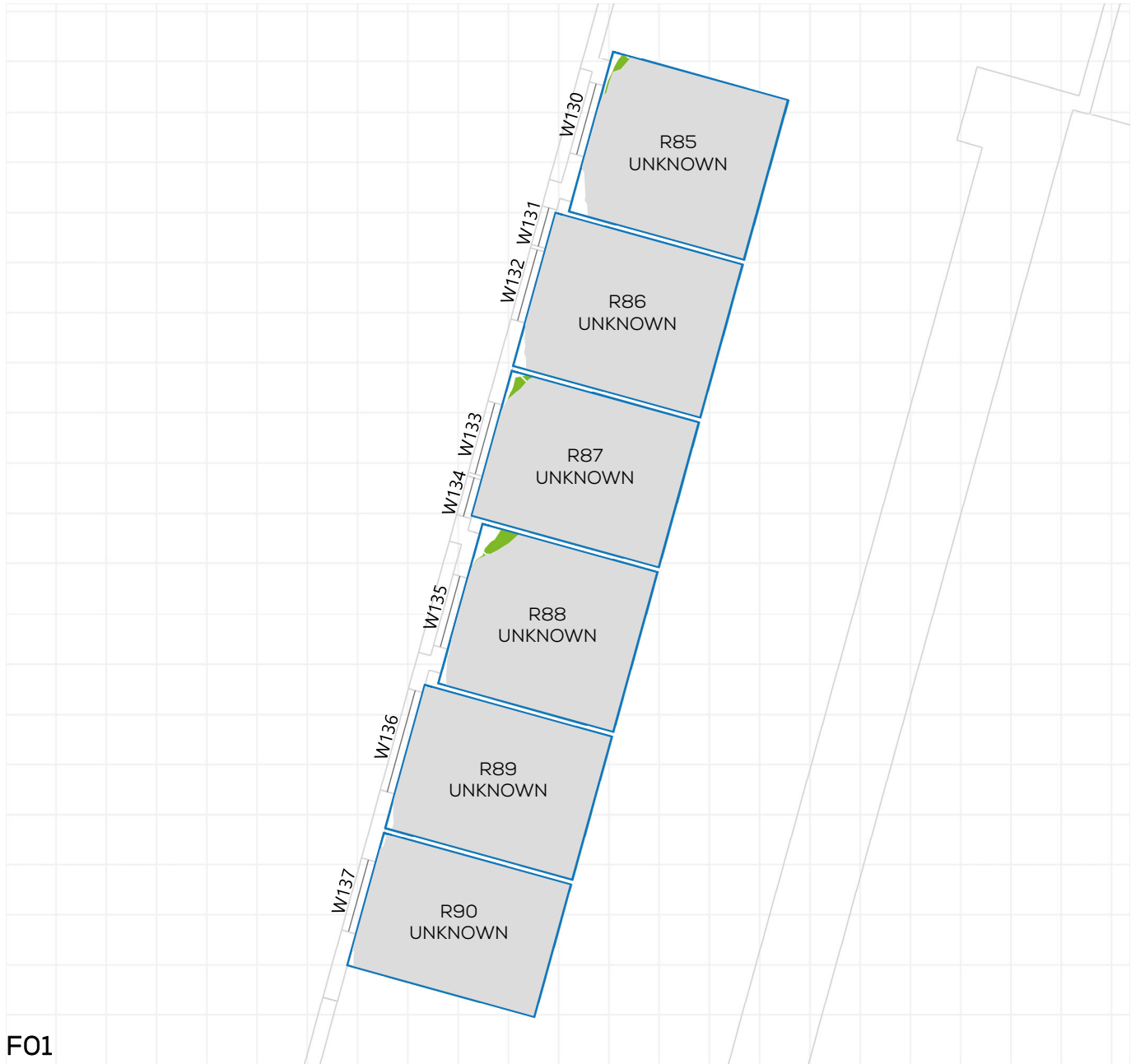

# NSL CONTOURS



PROJECT: 14047 - CAMBRIDGE ROAD  
REPORT TITLE: EXISTING VS. PROPOSED  
ADDRESS: CAMBRIDGE GARDENS  
DATE: 02/10/2020  
SCHEME IR: IR23 (07.09.2020)  
DRAWING No.: 14047-RELO6-IS02-DD159

## KEY:

- GAIN
- LOSS
- MAINTAINED LIT AREA
- 1 METRE GRID

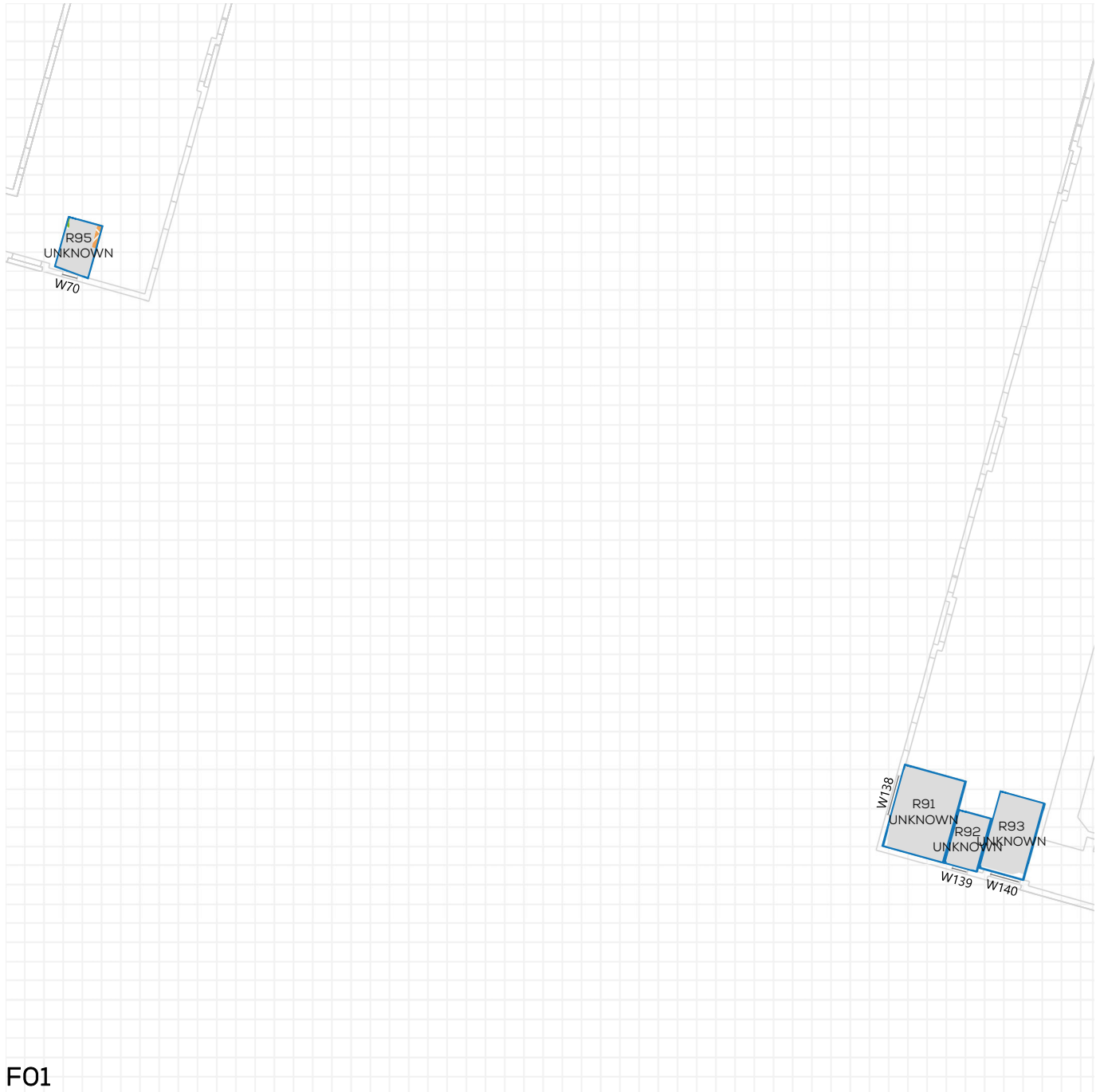
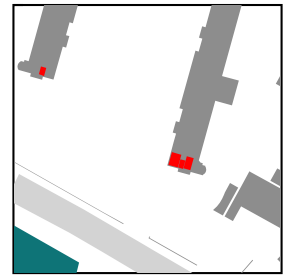

F01

# NSL CONTOURS



PROJECT: 14047 - CAMBRIDGE ROAD  
REPORT TITLE: EXISTING VS. PROPOSED  
ADDRESS: CAMBRIDGE GARDENS  
DATE: 02/10/2020  
SCHEME IR: IR23 (07.09.2020)  
DRAWING No.: 14047-RELO6-IS02-DD160

**KEY:**

- GAIN
- LOSS
- MAINTAINED LIT AREA
- 1 METRE GRID

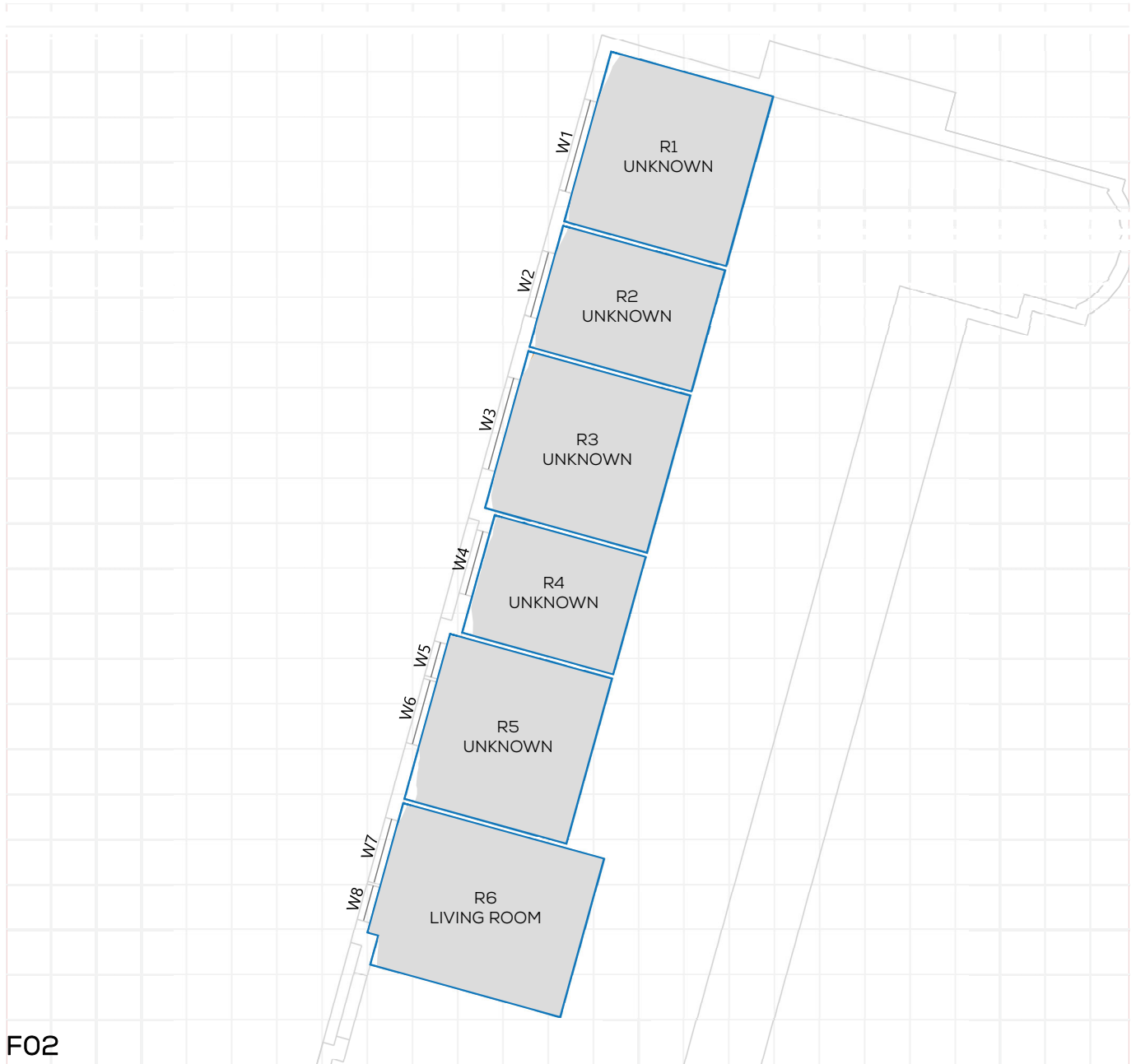

# NSL CONTOURS



PROJECT: 14047 - CAMBRIDGE ROAD  
REPORT TITLE: EXISTING VS. PROPOSED  
ADDRESS: CAMBRIDGE GARDENS  
DATE: 02/10/2020  
SCHEME IR: IR23 (07.09.2020)  
DRAWING No.: 14047-RELO6-IS02-DD161

### KEY:

- GAIN
- LOSS
- MAINTAINED LIT AREA
- 1 METRE GRID



F02

# NSL CONTOURS



PROJECT: 14047 - CAMBRIDGE ROAD  
REPORT TITLE: EXISTING VS. PROPOSED  
ADDRESS: CAMBRIDGE GARDENS  
DATE: 02/10/2020  
SCHEME IR: IR23 (07.09.2020)  
DRAWING No.: 14047-RELO6-IS02-DD162

## KEY:

- GAIN
- LOSS
- MAINTAINED LIT AREA
- 1 METRE GRID

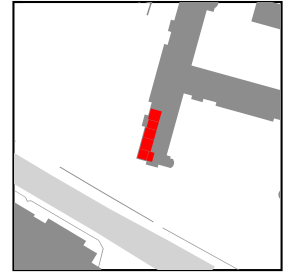

F02

# NSL CONTOURS



PROJECT: 14047 - CAMBRIDGE ROAD  
REPORT TITLE: EXISTING VS. PROPOSED  
ADDRESS: CAMBRIDGE GARDENS  
DATE: 02/10/2020  
SCHEME IR: IR23 (07.09.2020)  
DRAWING No.: 14047-RELO6-IS02-DD163

## KEY:

- GAIN
- LOSS
- MAINTAINED LIT AREA
- 1 METRE GRID

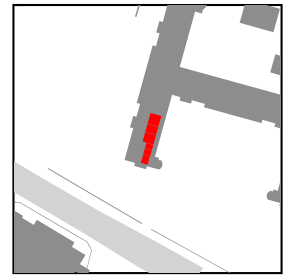



# NSL CONTOURS



PROJECT: 14047 - CAMBRIDGE ROAD  
REPORT TITLE: EXISTING VS. PROPOSED  
ADDRESS: CAMBRIDGE GARDENS  
DATE: 02/10/2020  
SCHEME IR: IR23 (07.09.2020)  
DRAWING No.: 14047-RELO6-IS02-DD164

**KEY:**

- GAIN
- LOSS
- MAINTAINED LIT AREA
- 1 METRE GRID

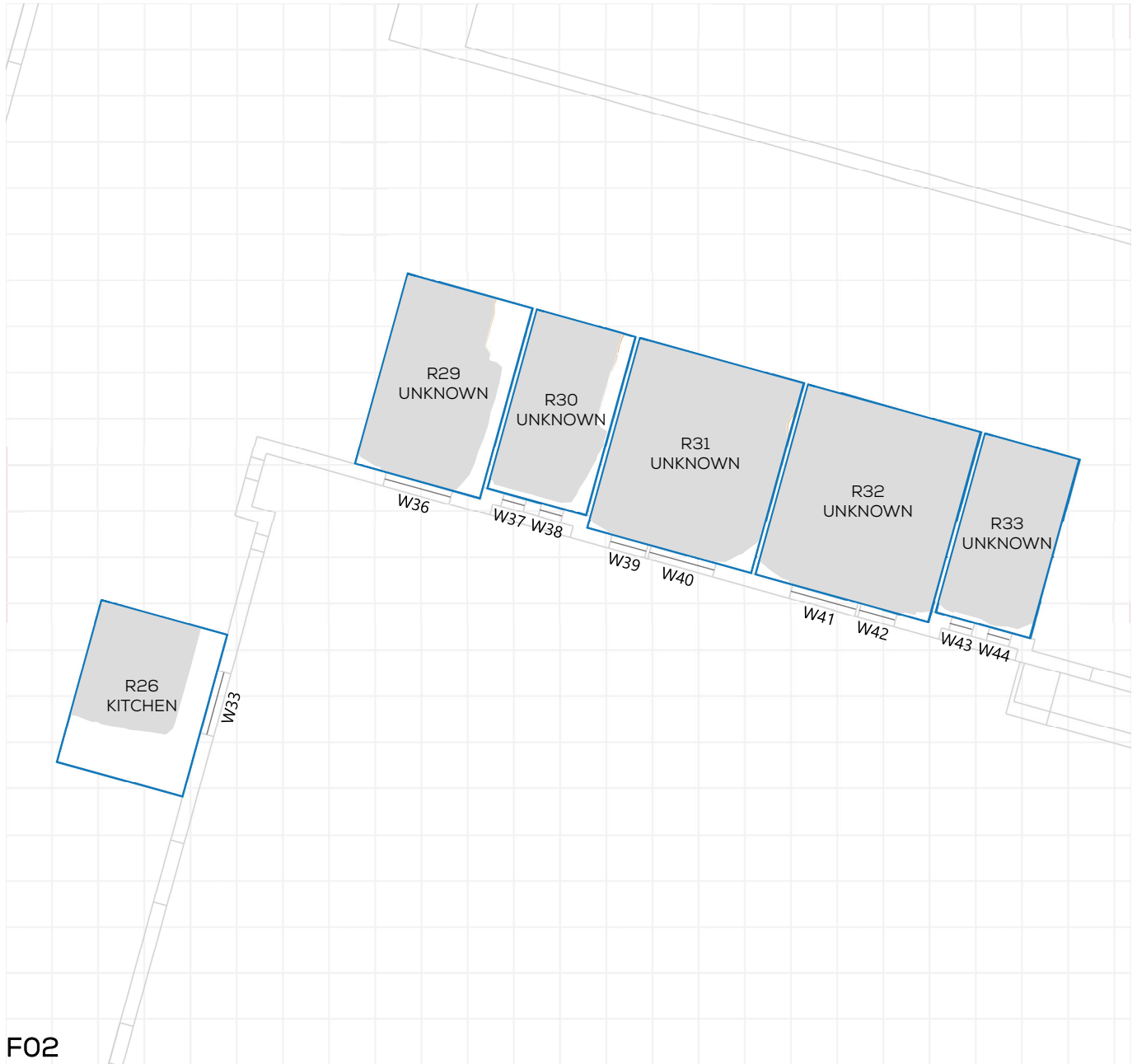
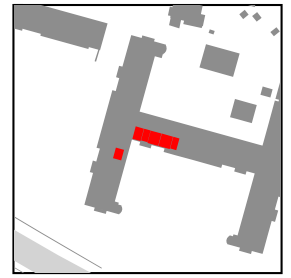

# NSL CONTOURS



PROJECT: 14047 - CAMBRIDGE ROAD  
REPORT TITLE: EXISTING VS. PROPOSED  
ADDRESS: CAMBRIDGE GARDENS  
DATE: 02/10/2020  
SCHEME IR: IR23 (07.09.2020)  
DRAWING No.: 14047-RELO6-IS02-DD165

**KEY:**

- GAIN
- LOSS
- MAINTAINED LIT AREA
- 1 METRE GRID

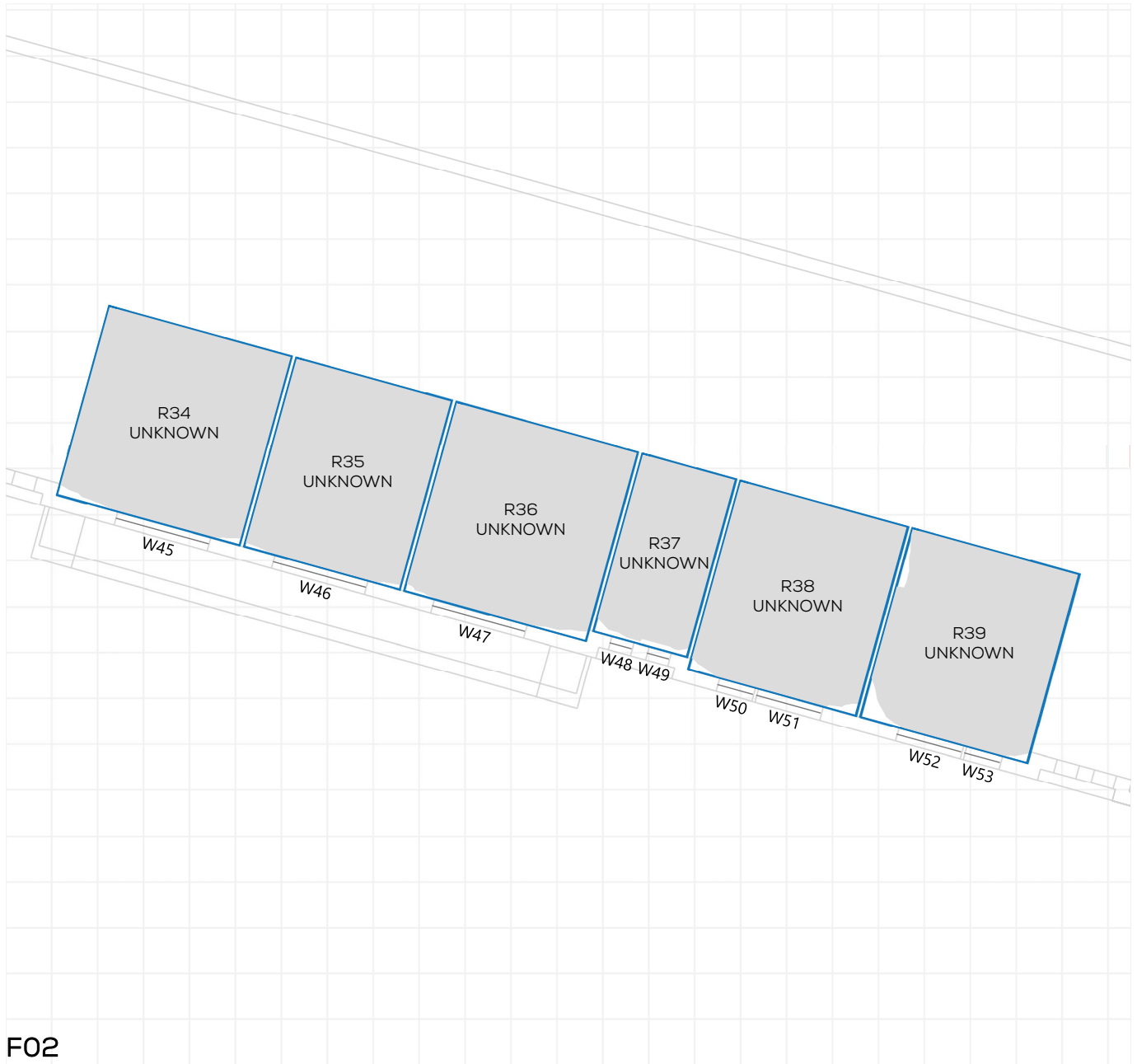
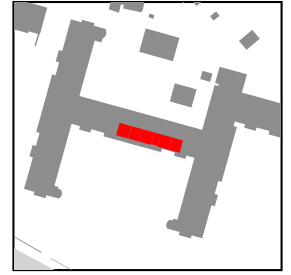

F02

# NSL CONTOURS



PROJECT: 14047 - CAMBRIDGE ROAD  
REPORT TITLE: EXISTING VS. PROPOSED  
ADDRESS: CAMBRIDGE GARDENS  
DATE: 02/10/2020  
SCHEME IR: IR23 (07.09.2020)  
DRAWING No.: 14047-RELO6-IS02-DD166

### KEY:

- GAIN
- LOSS
- MAINTAINED LIT AREA
- 1 METRE GRID

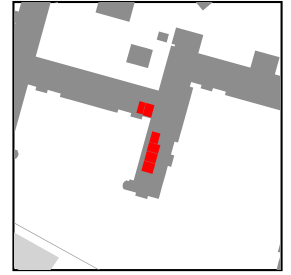

F02

# NSL CONTOURS



PROJECT: 14047 - CAMBRIDGE ROAD  
REPORT TITLE: EXISTING VS. PROPOSED  
ADDRESS: CAMBRIDGE GARDENS  
DATE: 02/10/2020  
SCHEME IR: IR23 (07.09.2020)  
DRAWING No.: 14047-RELO6-IS02-DD167

### KEY:

- GAIN
- LOSS
- MAINTAINED LIT AREA
- 1 METRE GRID

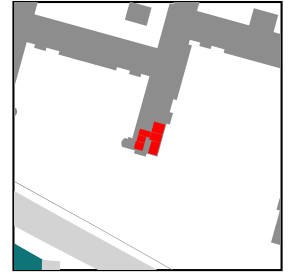

F02

# NSL CONTOURS



PROJECT: 14047 - CAMBRIDGE ROAD  
REPORT TITLE: EXISTING VS. PROPOSED  
ADDRESS: CAMBRIDGE GARDENS  
DATE: 02/10/2020  
SCHEME IR: IR23 (07.09.2020)  
DRAWING No.: 14047-RELO6-IS02-DD168

### KEY:

- GAIN
- LOSS
- MAINTAINED LIT AREA
- 1 METRE GRID



# NSL CONTOURS



PROJECT: 14047 - CAMBRIDGE ROAD  
REPORT TITLE: EXISTING VS. PROPOSED  
ADDRESS: CAMBRIDGE GARDENS  
DATE: 02/10/2020  
SCHEME IR: IR23 (07.09.2020)  
DRAWING No.: 14047-RELO6-IS02-DD169

### KEY:

- GAIN
- LOSS
- MAINTAINED LIT AREA
- 1 METRE GRID

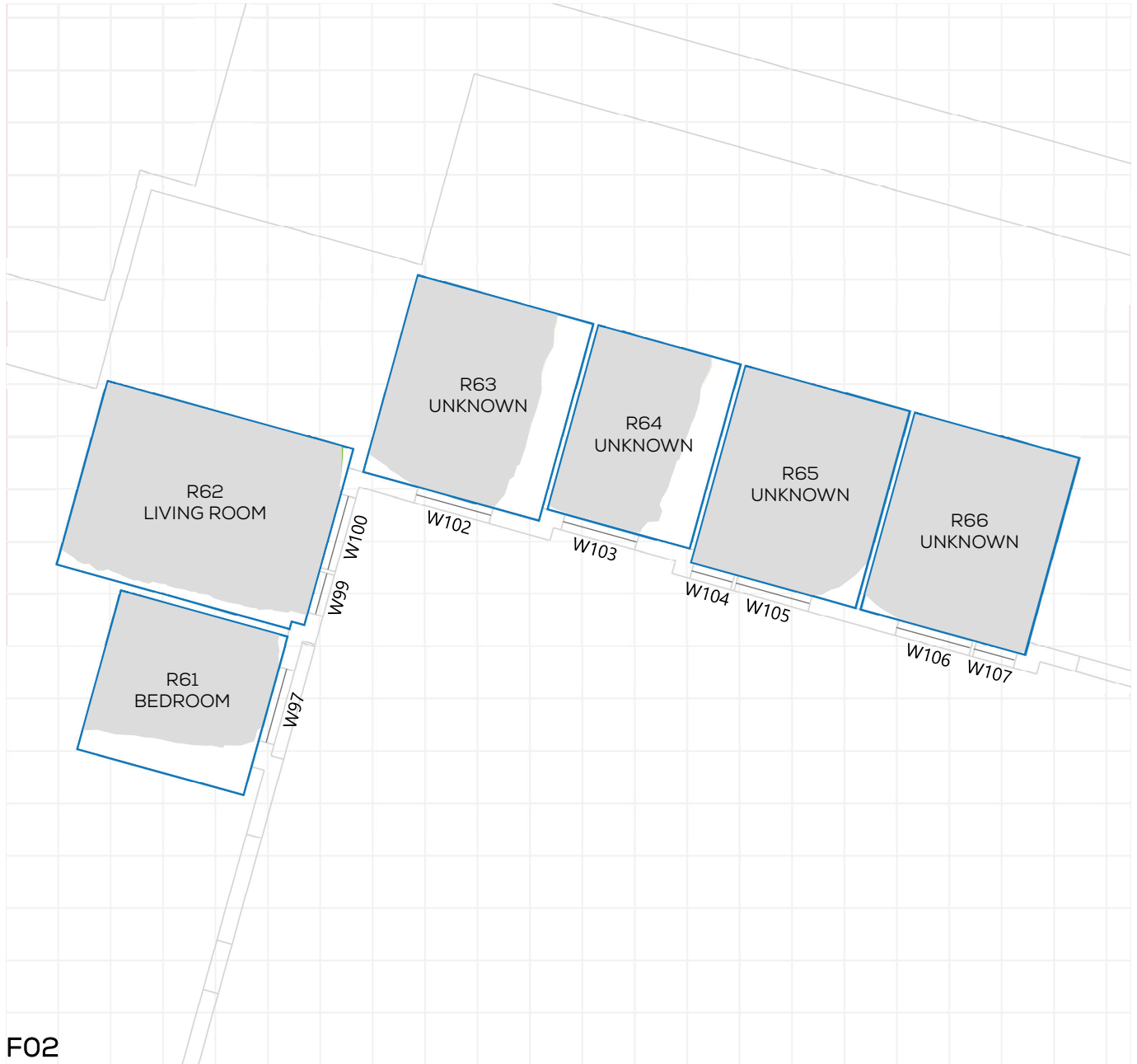
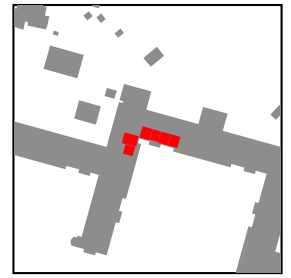

PROJECT: 14047 - CAMBRIDGE ROAD  
REPORT TITLE: EXISTING VS. PROPOSED  
ADDRESS: CAMBRIDGE GARDENS  
DATE: 02/10/2020  
SCHEME IR: IR23 (07.09.2020)  
DRAWING No.: 14047-RELO6-IS02-DD170

**KEY:**

- GAIN
- LOSS
- MAINTAINED LIT AREA
- 1 METRE GRID

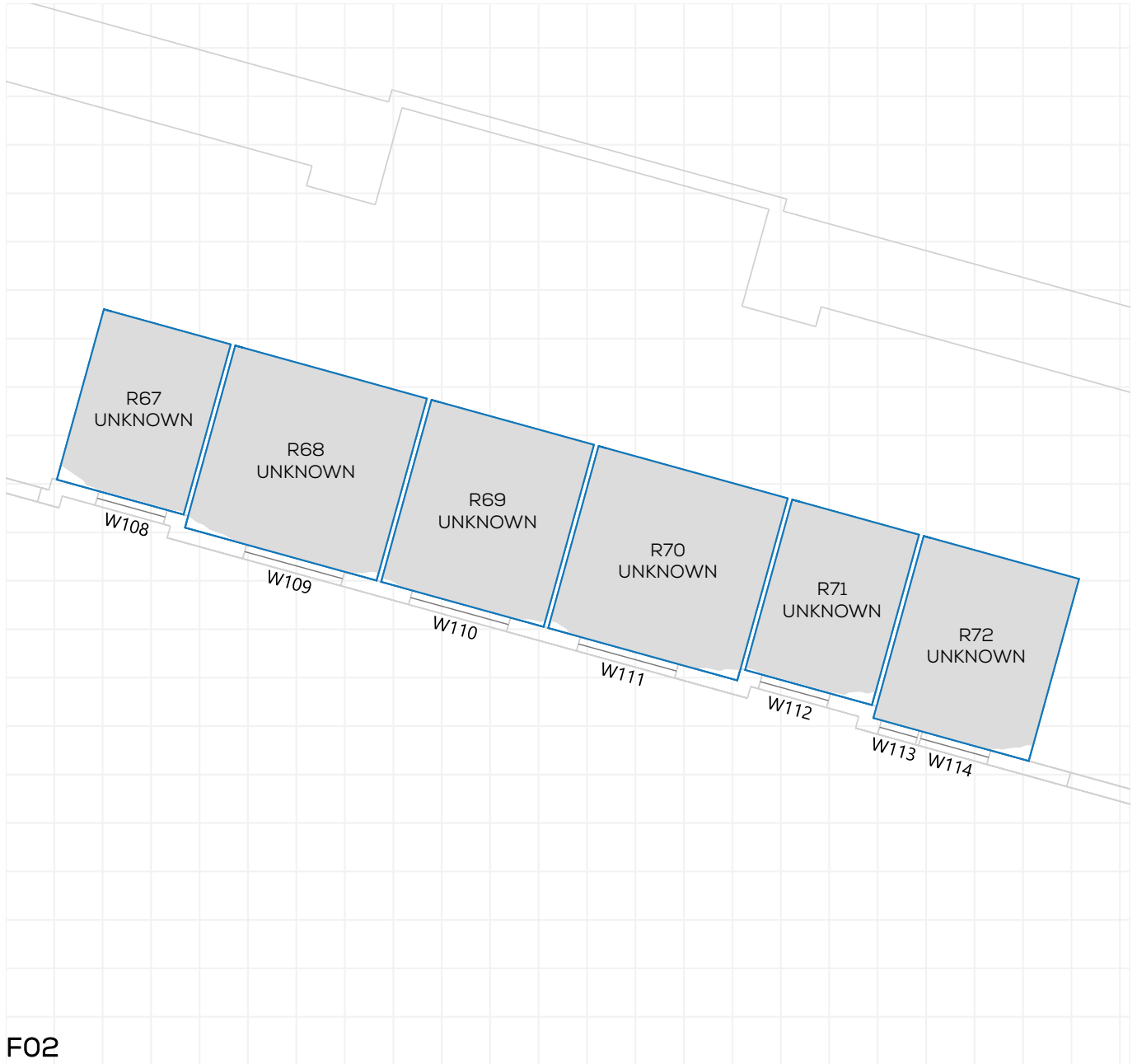
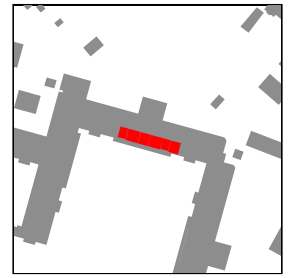

# NSL CONTOURS



PROJECT: 14047 - CAMBRIDGE ROAD  
REPORT TITLE: EXISTING VS. PROPOSED  
ADDRESS: CAMBRIDGE GARDENS  
DATE: 02/10/2020  
SCHEME IR: IR23 (07.09.2020)  
DRAWING No.: 14047-RELO6-IS02-DD171

**KEY:**

- GAIN
- LOSS
- MAINTAINED LIT AREA
- 1 METRE GRID

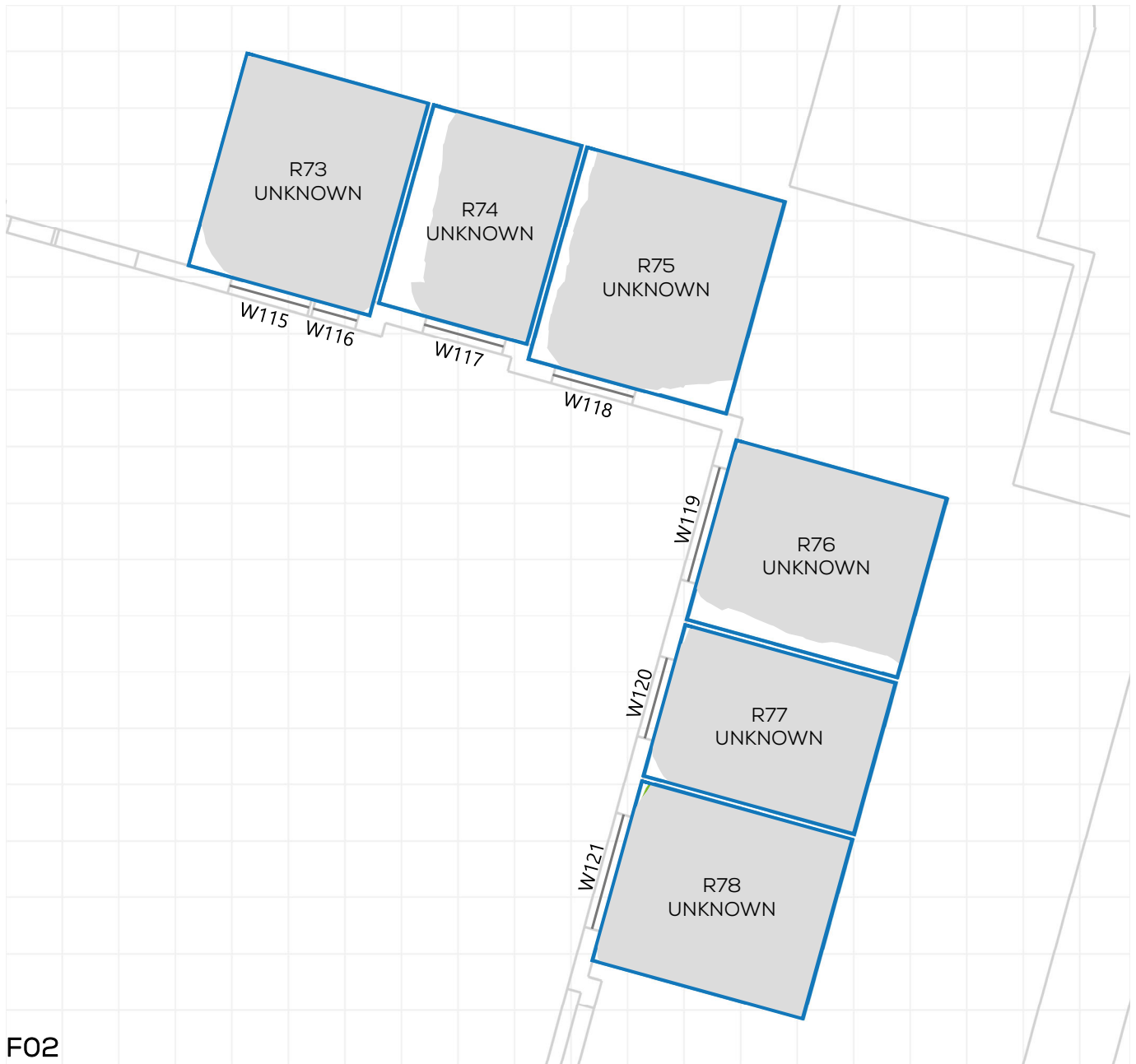
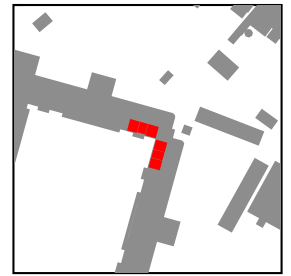

F02



# NSL CONTOURS



PROJECT: 14047 - CAMBRIDGE ROAD  
REPORT TITLE: EXISTING VS. PROPOSED  
ADDRESS: CAMBRIDGE GARDENS  
DATE: 02/10/2020  
SCHEME IR: IR23 (07.09.2020)  
DRAWING No.: 14047-RELO6-IS02-DD172

### KEY:

- GAIN
- LOSS
- MAINTAINED LIT AREA
- 1 METRE GRID

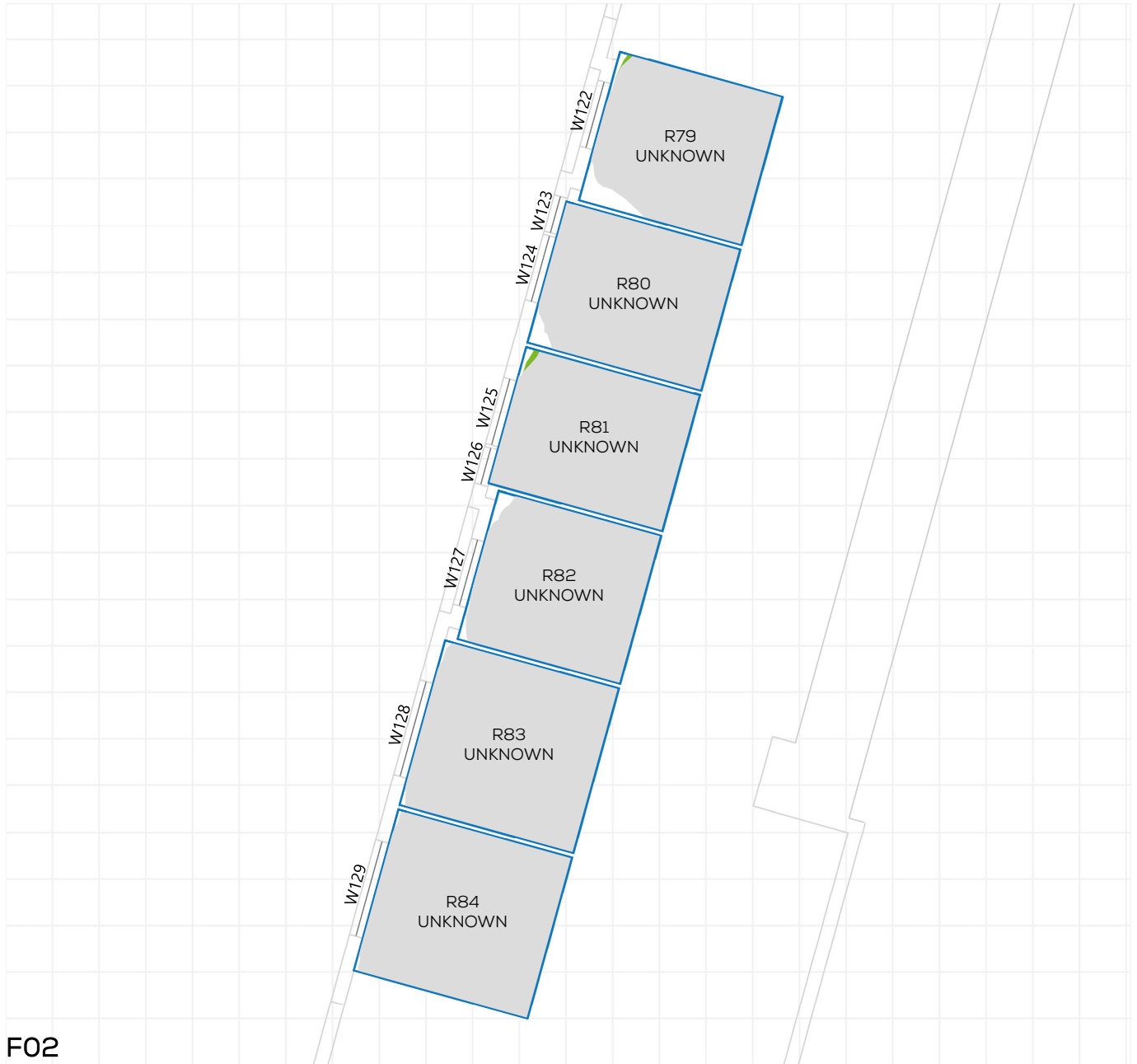
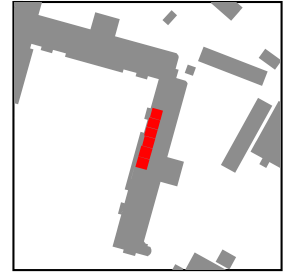

F02

# NSL CONTOURS



PROJECT: 14047 - CAMBRIDGE ROAD  
REPORT TITLE: EXISTING VS. PROPOSED  
ADDRESS: CAMBRIDGE GARDENS  
DATE: 02/10/2020  
SCHEME IR: IR23 (07.09.2020)  
DRAWING No.: 14047-RELO6-IS02-DD173

**KEY:**

- GAIN
- LOSS
- MAINTAINED LIT AREA
- 1 METRE GRID

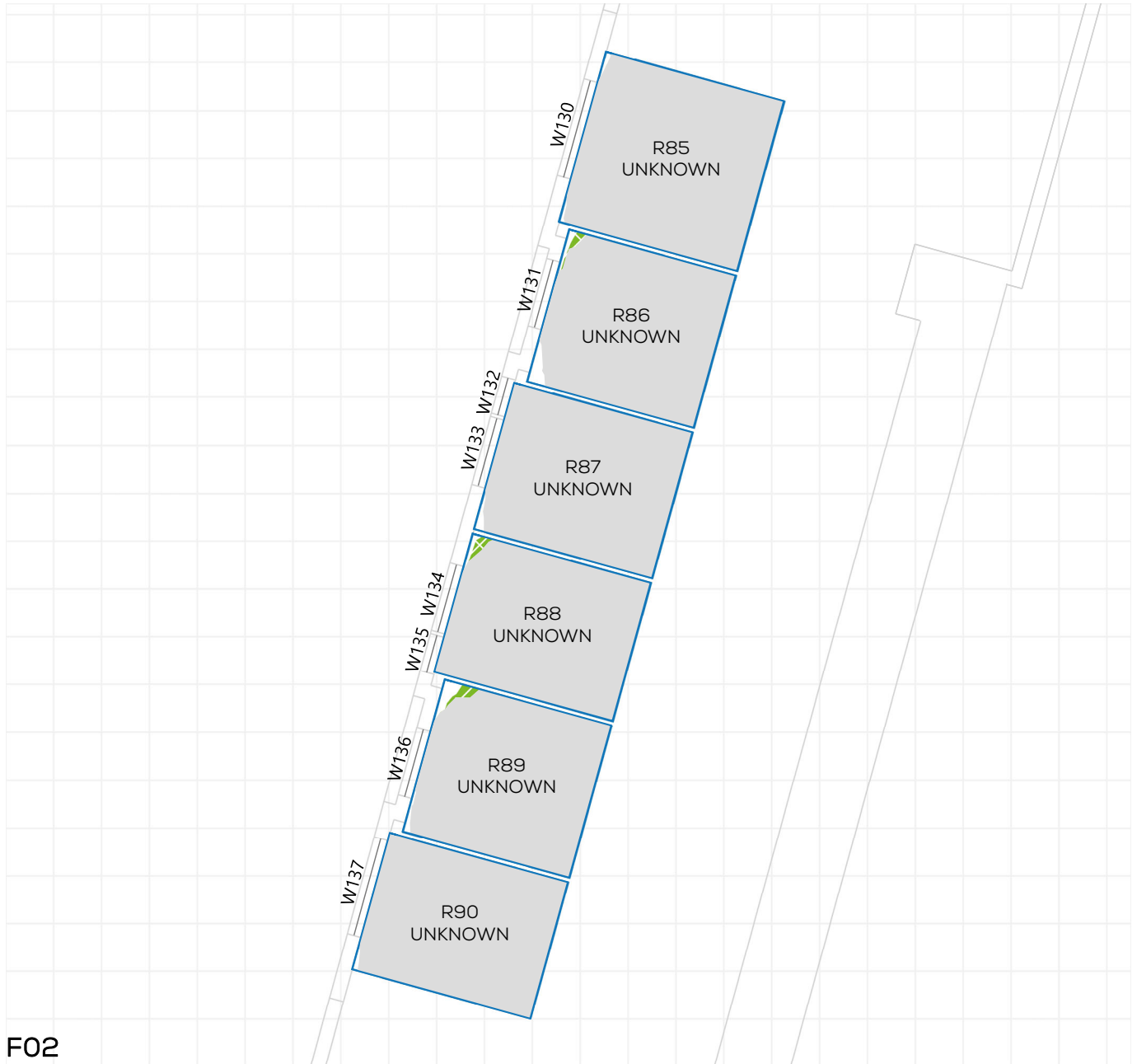

F02

# NSL CONTOURS



PROJECT: 14047 - CAMBRIDGE ROAD  
REPORT TITLE: EXISTING VS. PROPOSED  
ADDRESS: CAMBRIDGE GARDENS  
DATE: 02/10/2020  
SCHEME IR: IR23 (07.09.2020)  
DRAWING No.: 14047-RELO6-IS02-DD174

### KEY:

- GAIN
- LOSS
- MAINTAINED LIT AREA
- 1 METRE GRID

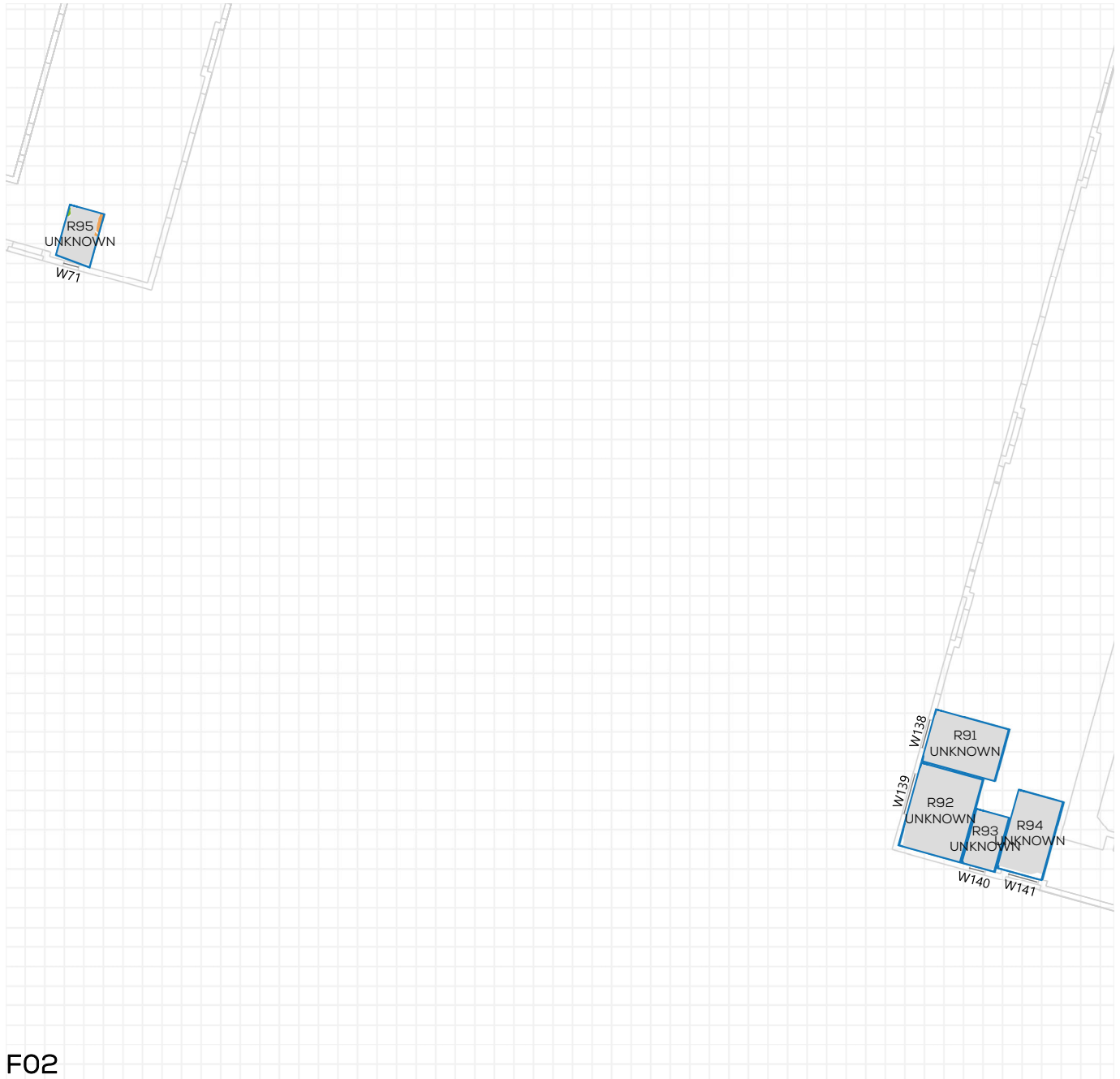

F02

# NSL CONTOURS



PROJECT: 14047 - CAMBRIDGE ROAD  
REPORT TITLE: EXISTING VS. PROPOSED  
ADDRESS: CAMBRIDGE GARDENS  
DATE: 02/10/2020  
SCHEME IR: IR23 (07.09.2020)  
DRAWING No.: 14047-RELO6-IS02-DD175

**KEY:**

- GAIN
- LOSS
- MAINTAINED LIT AREA
- 1 METRE GRID

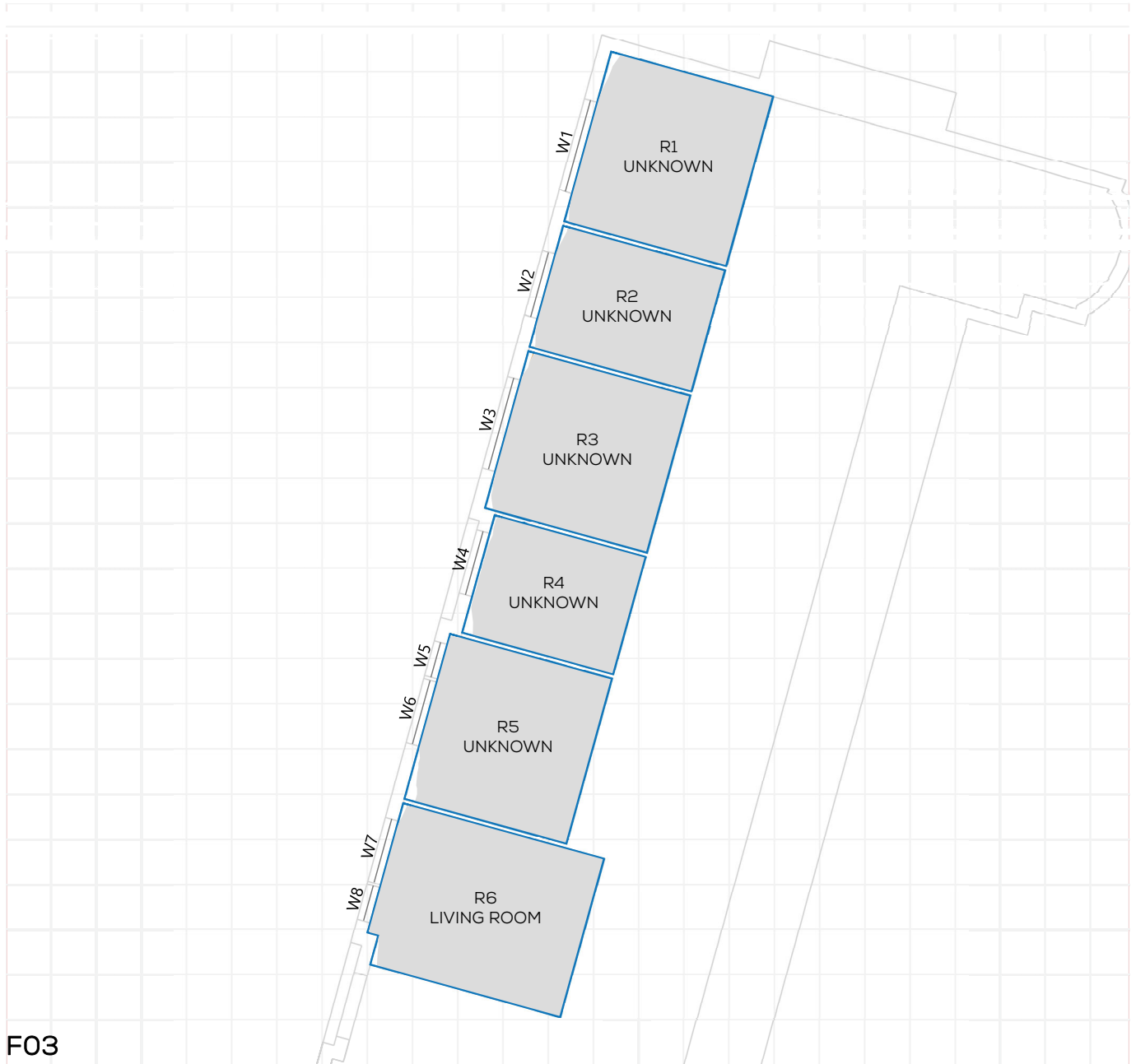

F03

# NSL CONTOURS



PROJECT: 14047 - CAMBRIDGE ROAD  
REPORT TITLE: EXISTING VS. PROPOSED  
ADDRESS: CAMBRIDGE GARDENS  
DATE: 02/10/2020  
SCHEME IR: IR23 (07.09.2020)  
DRAWING No.: 14047-RELO6-IS02-DD176

## KEY:

- GAIN
- LOSS
- MAINTAINED LIT AREA
- 1 METRE GRID



F03

# NSL CONTOURS



PROJECT: 14047 - CAMBRIDGE ROAD  
REPORT TITLE: EXISTING VS. PROPOSED  
ADDRESS: CAMBRIDGE GARDENS  
DATE: 02/10/2020  
SCHEME IR: IR23 (07.09.2020)  
DRAWING No.: 14047-RELO6-IS02-DD177

### KEY:

- GAIN
- LOSS
- MAINTAINED LIT AREA
- 1 METRE GRID

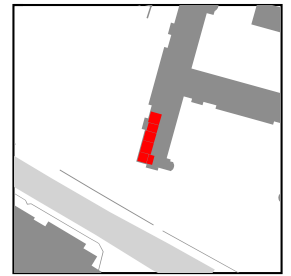

# NSL CONTOURS



PROJECT: 14047 - CAMBRIDGE ROAD  
REPORT TITLE: EXISTING VS. PROPOSED  
ADDRESS: CAMBRIDGE GARDENS  
DATE: 02/10/2020  
SCHEME IR: IR23 (07.09.2020)  
DRAWING No.: 14047-RELO6-IS02-DD178

### KEY:

- GAIN
- LOSS
- MAINTAINED LIT AREA
- 1 METRE GRID

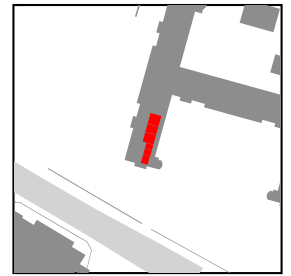

# NSL CONTOURS



PROJECT: 14047 - CAMBRIDGE ROAD  
REPORT TITLE: EXISTING VS. PROPOSED  
ADDRESS: CAMBRIDGE GARDENS  
DATE: 02/10/2020  
SCHEME IR: IR23 (07.09.2020)  
DRAWING No.: 14047-RELO6-IS02-DD179

### KEY:

- GAIN
- LOSS
- MAINTAINED LIT AREA
- 1 METRE GRID

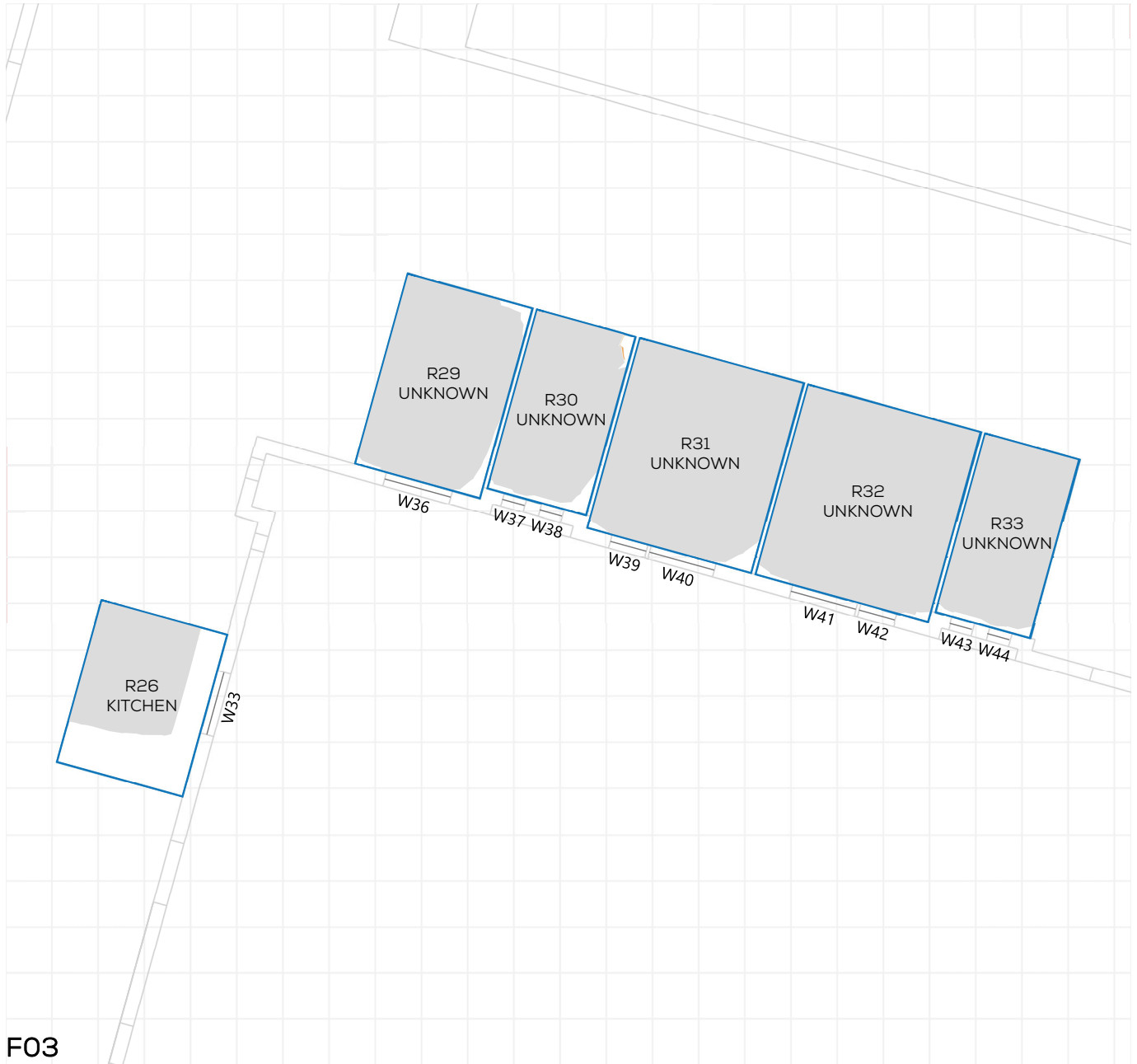
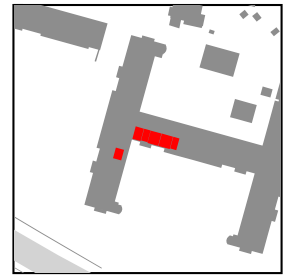

F03



# NSL CONTOURS



PROJECT: 14047 - CAMBRIDGE ROAD  
REPORT TITLE: EXISTING VS. PROPOSED  
ADDRESS: CAMBRIDGE GARDENS  
DATE: 02/10/2020  
SCHEME IR: IR23 (07.09.2020)  
DRAWING No.: 14047-RELO6-IS02-DD180

**KEY:**

- GAIN
- LOSS
- MAINTAINED LIT AREA
- 1 METRE GRID

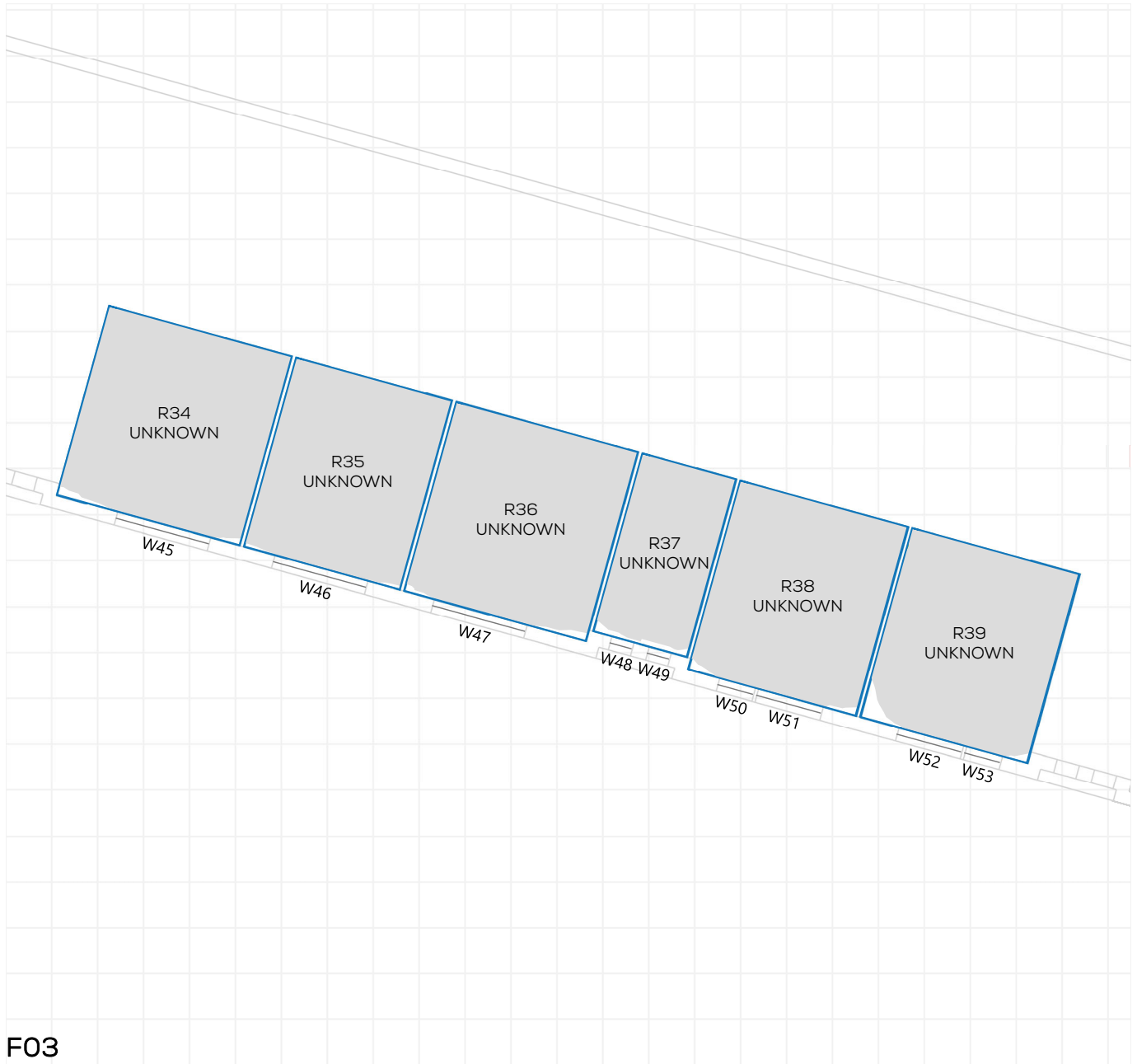
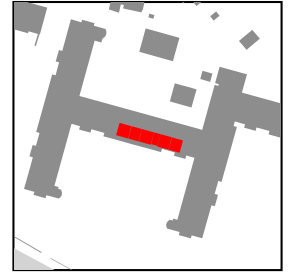

F03

# NSL CONTOURS



PROJECT: 14047 - CAMBRIDGE ROAD  
REPORT TITLE: EXISTING VS. PROPOSED  
ADDRESS: CAMBRIDGE GARDENS  
DATE: 02/10/2020  
SCHEME IR: IR23 (07.09.2020)  
DRAWING No.: 14047-RELO6-IS02-DD181

### KEY:

- GAIN
- LOSS
- MAINTAINED LIT AREA
- 1 METRE GRID

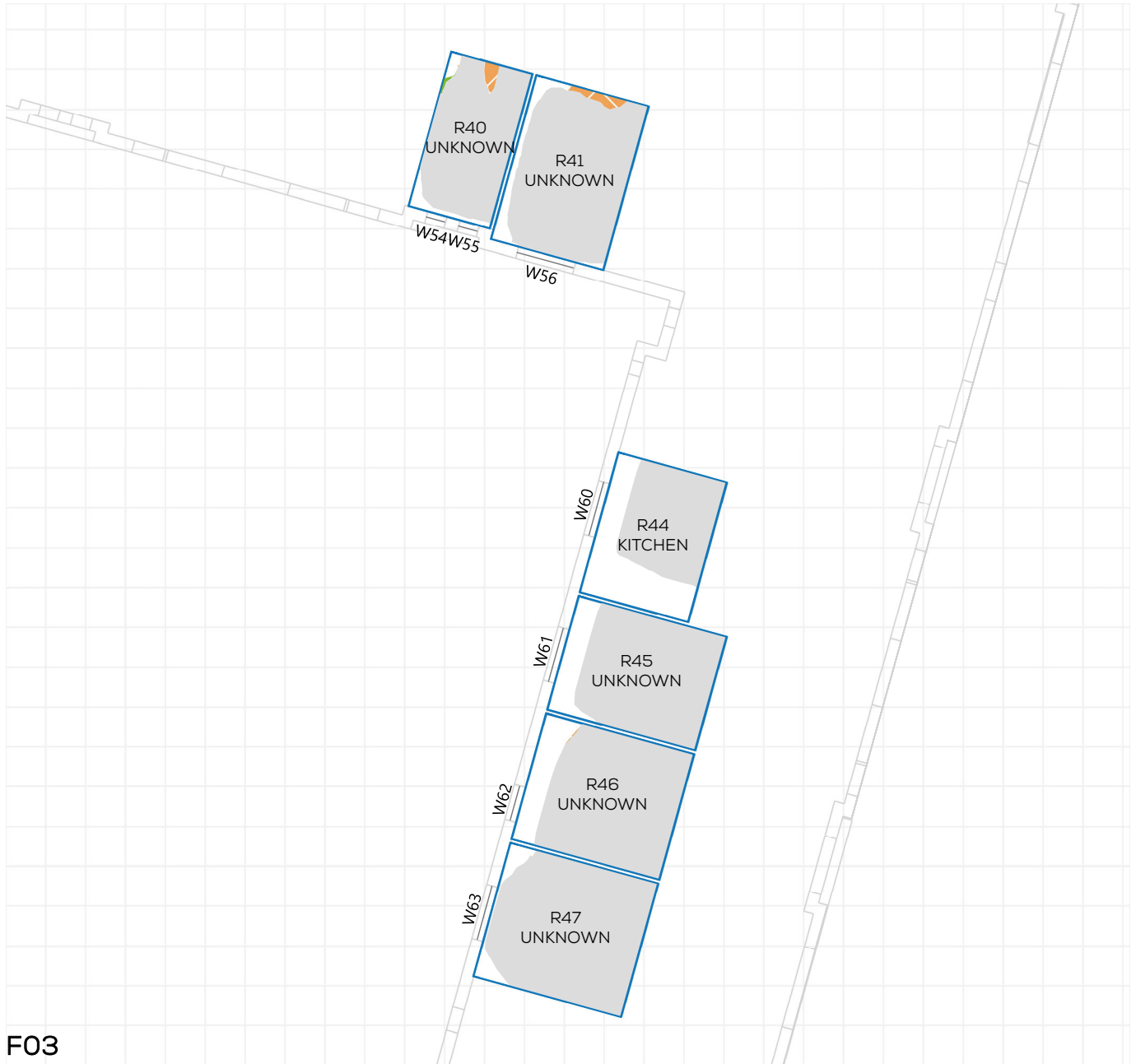
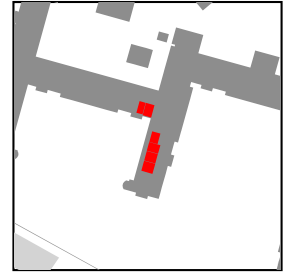

# NSL CONTOURS



PROJECT: 14047 - CAMBRIDGE ROAD  
REPORT TITLE: EXISTING VS. PROPOSED  
ADDRESS: CAMBRIDGE GARDENS  
DATE: 02/10/2020  
SCHEME IR: IR23 (07.09.2020)  
DRAWING No.: 14047-RELO6-IS02-DD182

**KEY:**

- GAIN
- LOSS
- MAINTAINED LIT AREA
- 1 METRE GRID

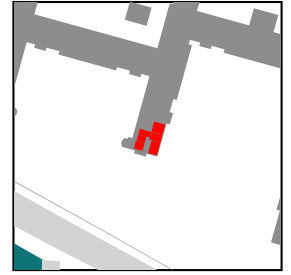

F03

# NSL CONTOURS



PROJECT: 14047 - CAMBRIDGE ROAD  
REPORT TITLE: EXISTING VS. PROPOSED  
ADDRESS: CAMBRIDGE GARDENS  
DATE: 02/10/2020  
SCHEME IR: IR23 (07.09.2020)  
DRAWING No.: 14047-RELO6-IS02-DD183

### KEY:

- GAIN
- LOSS
- MAINTAINED LIT AREA
- 1 METRE GRID



F03

# NSL CONTOURS



PROJECT: 14047 - CAMBRIDGE ROAD  
REPORT TITLE: EXISTING VS. PROPOSED  
ADDRESS: CAMBRIDGE GARDENS  
DATE: 02/10/2020  
SCHEME IR: IR23 (07.09.2020)  
DRAWING No.: 14047-RELO6-IS02-DD184

**KEY:**

- GAIN
- LOSS
- MAINTAINED LIT AREA
- 1 METRE GRID

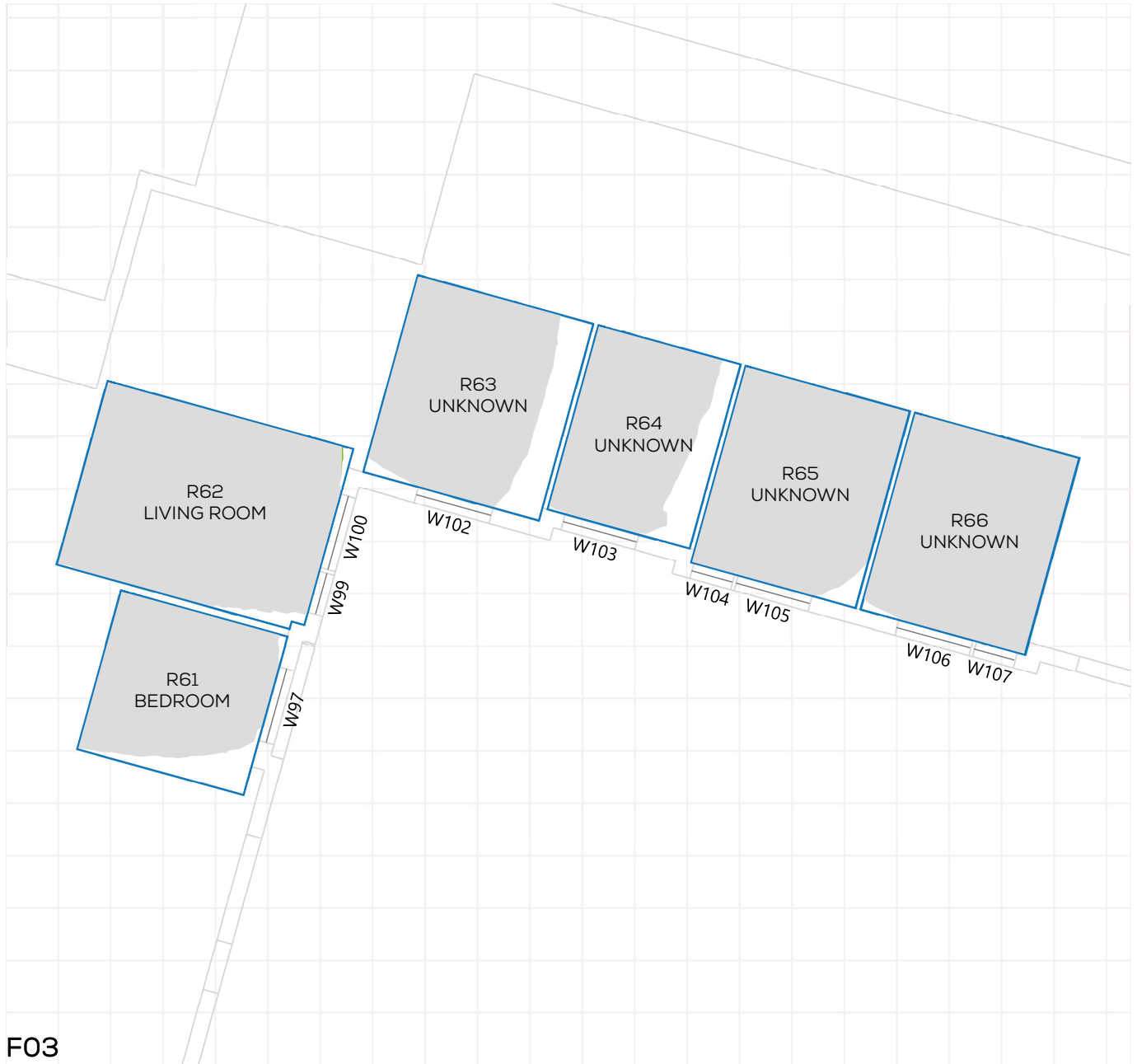
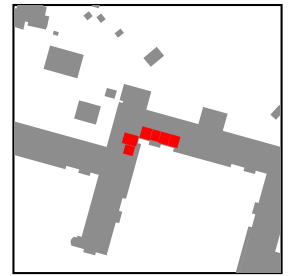

F03

PROJECT: 14047 - CAMBRIDGE ROAD  
REPORT TITLE: EXISTING VS. PROPOSED  
ADDRESS: CAMBRIDGE GARDENS  
DATE: 02/10/2020  
SCHEME IR: IR23 (07.09.2020)  
DRAWING No.: 14047-RELO6-IS02-DD185

**KEY:**

- GAIN
- LOSS
- MAINTAINED LIT AREA
- 1 METRE GRID

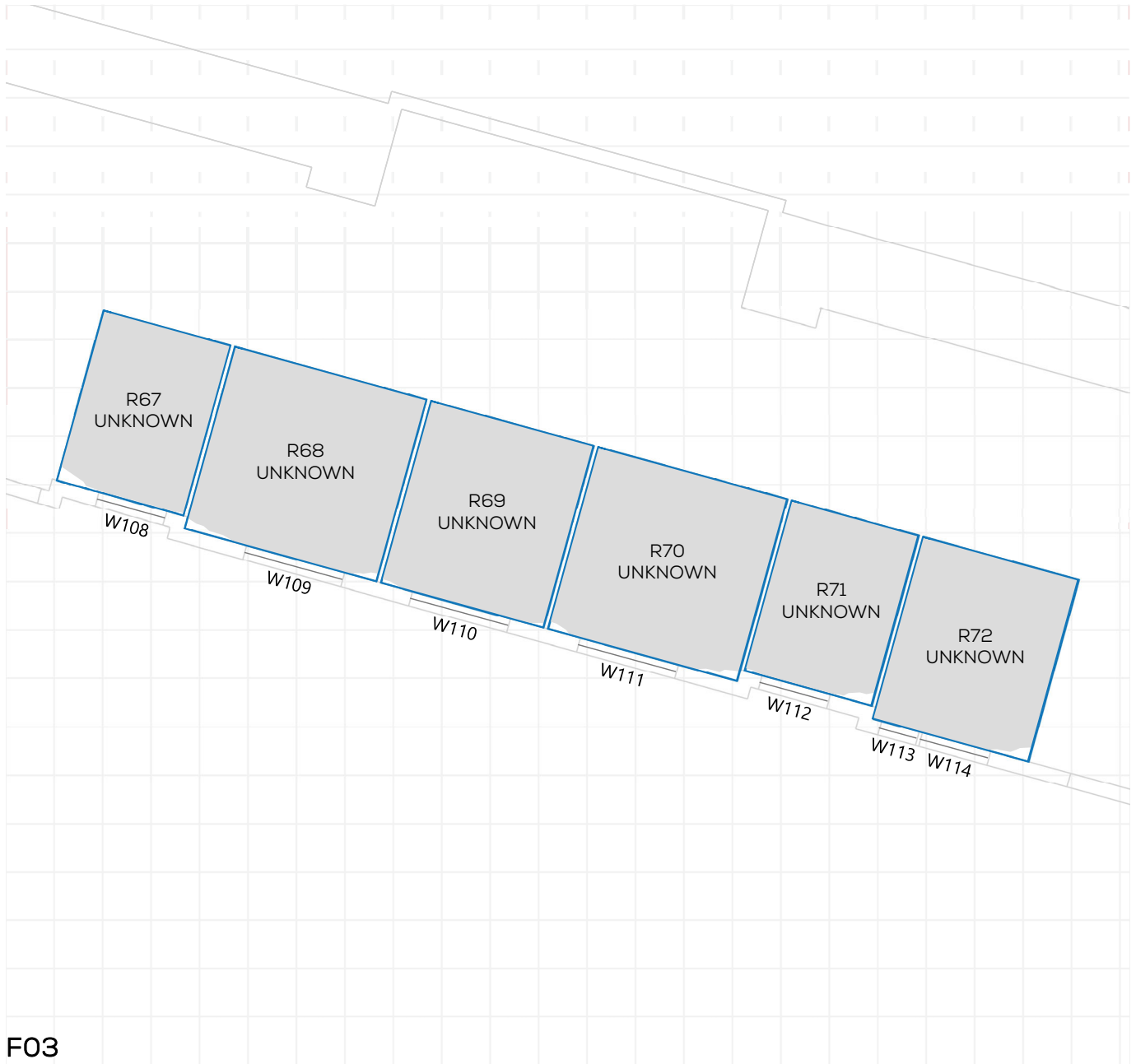
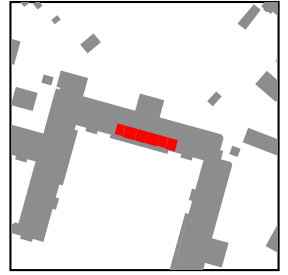

F03

# NSL CONTOURS



PROJECT: 14047 - CAMBRIDGE ROAD  
REPORT TITLE: EXISTING VS. PROPOSED  
ADDRESS: CAMBRIDGE GARDENS  
DATE: 02/10/2020  
SCHEME IR: IR23 (07.09.2020)  
DRAWING No.: 14047-RELO6-IS02-DD186

**KEY:**

- GAIN
- LOSS
- MAINTAINED LIT AREA
- 1 METRE GRID

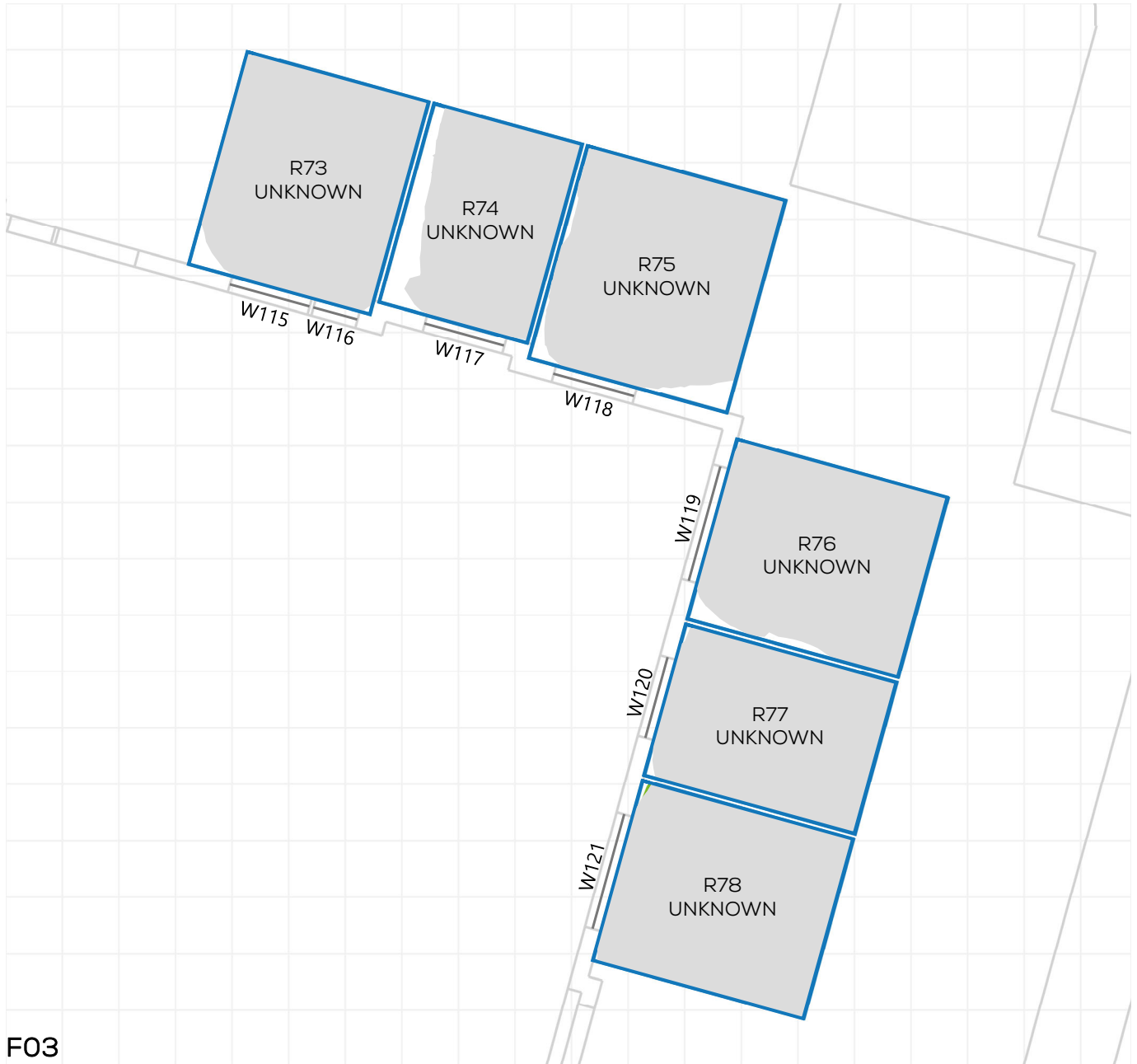
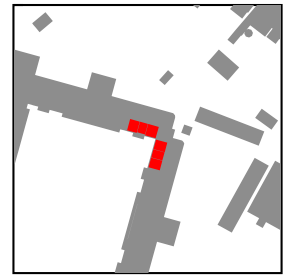

F03

# NSL CONTOURS



PROJECT: 14047 - CAMBRIDGE ROAD  
REPORT TITLE: EXISTING VS. PROPOSED  
ADDRESS: CAMBRIDGE GARDENS  
DATE: 02/10/2020  
SCHEME IR: IR23 (07.09.2020)  
DRAWING No.: 14047-RELO6-IS02-DD187

**KEY:**

- GAIN
- LOSS
- MAINTAINED LIT AREA
- 1 METRE GRID

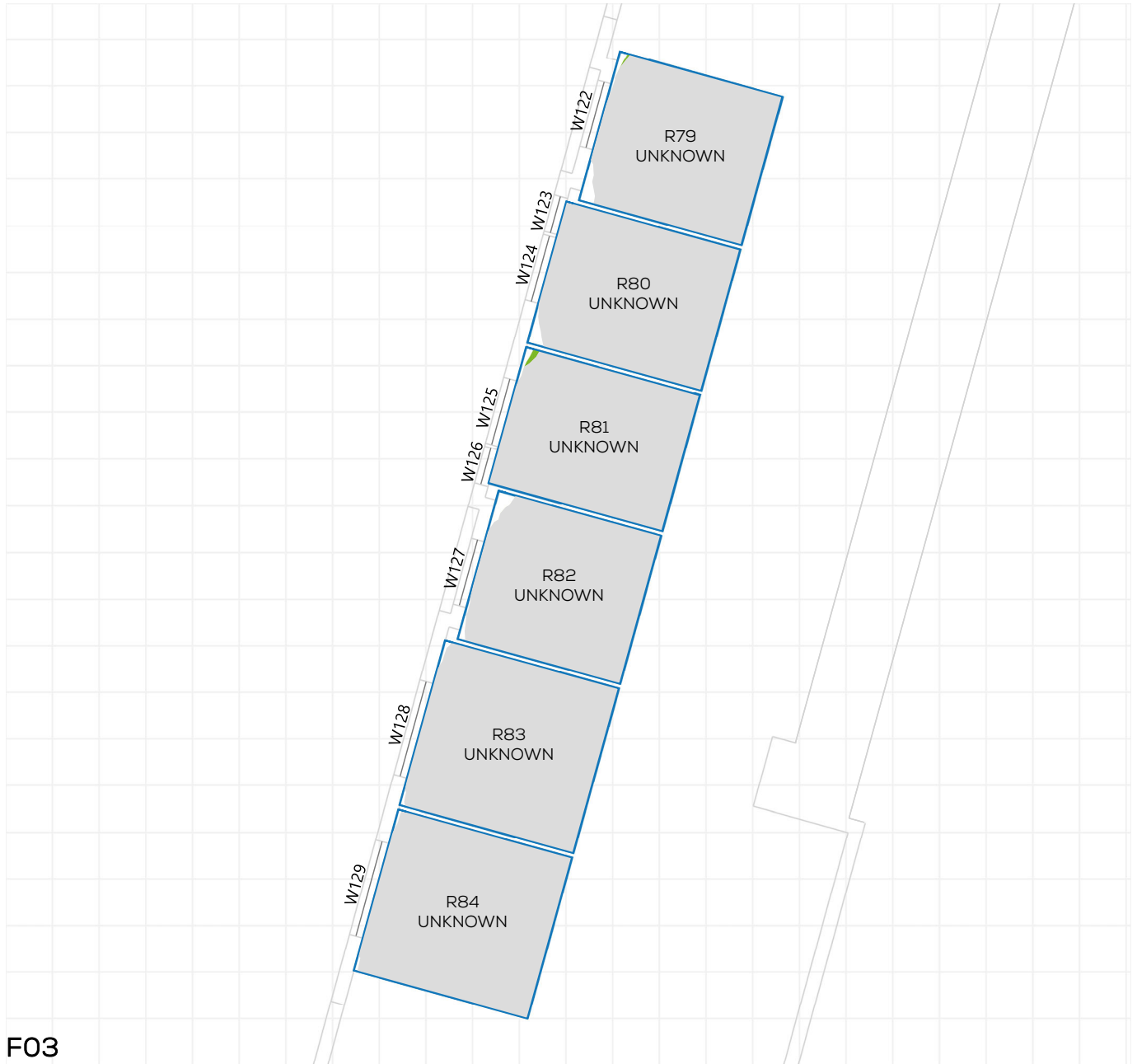
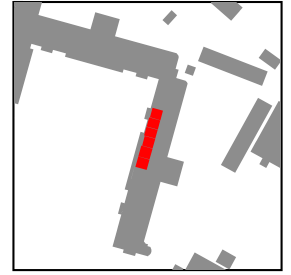



# NSL CONTOURS



PROJECT: 14047 - CAMBRIDGE ROAD  
REPORT TITLE: EXISTING VS. PROPOSED  
ADDRESS: CAMBRIDGE GARDENS  
DATE: 02/10/2020  
SCHEME IR: IR23 (07.09.2020)  
DRAWING No.: 14047-RELO6-IS02-DD188

**KEY:**

- GAIN
- LOSS
- MAINTAINED LIT AREA
- 1 METRE GRID

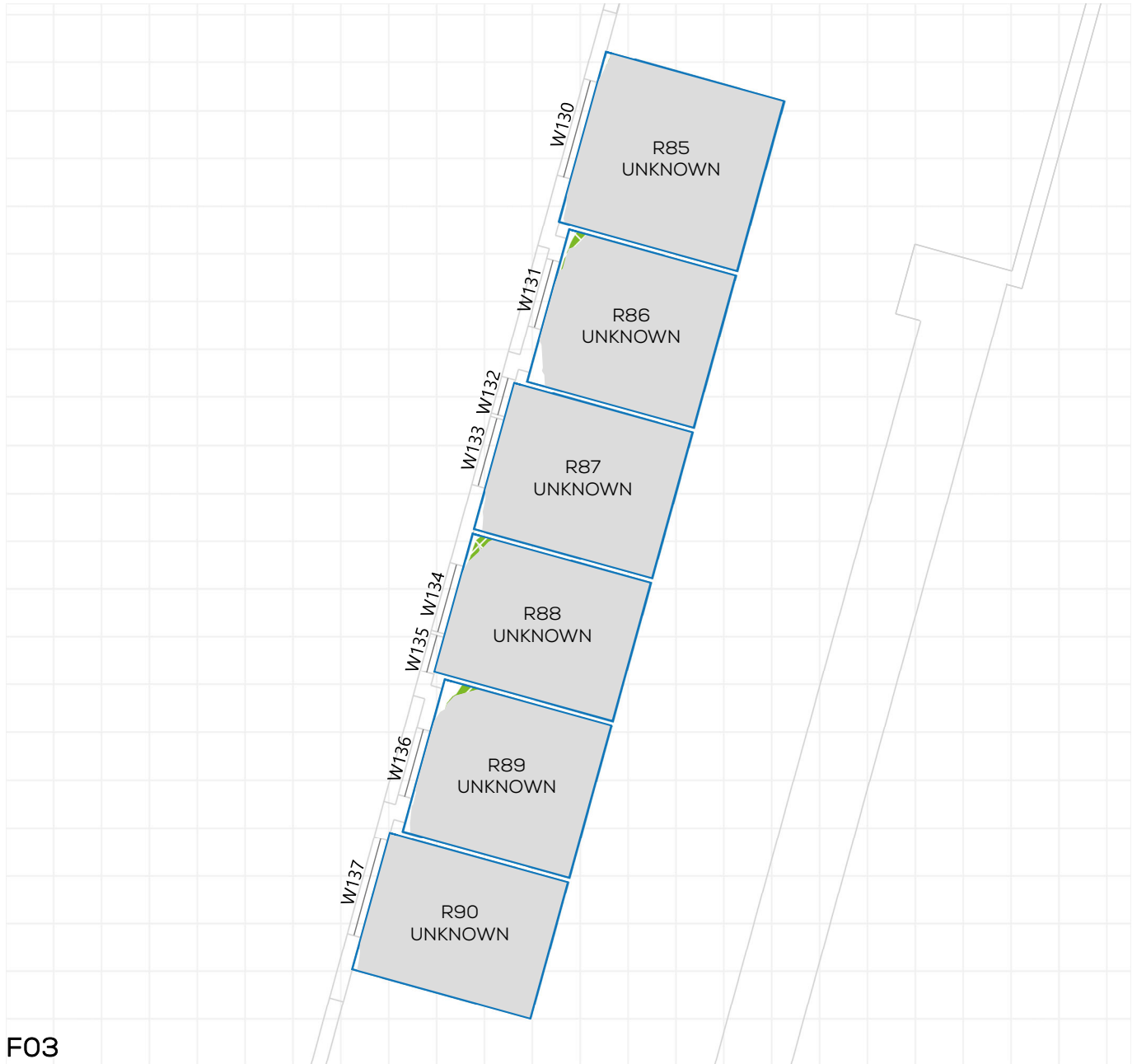
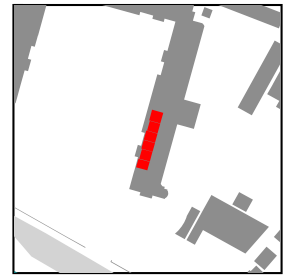

F03

# NSL CONTOURS



PROJECT: 14047 - CAMBRIDGE ROAD  
REPORT TITLE: EXISTING VS. PROPOSED  
ADDRESS: CAMBRIDGE GARDENS  
DATE: 02/10/2020  
SCHEME IR: IR23 (07.09.2020)  
DRAWING No.: 14047-RELO6-IS02-DD189

### KEY:

- GAIN
- LOSS
- MAINTAINED LIT AREA
- 1 METRE GRID

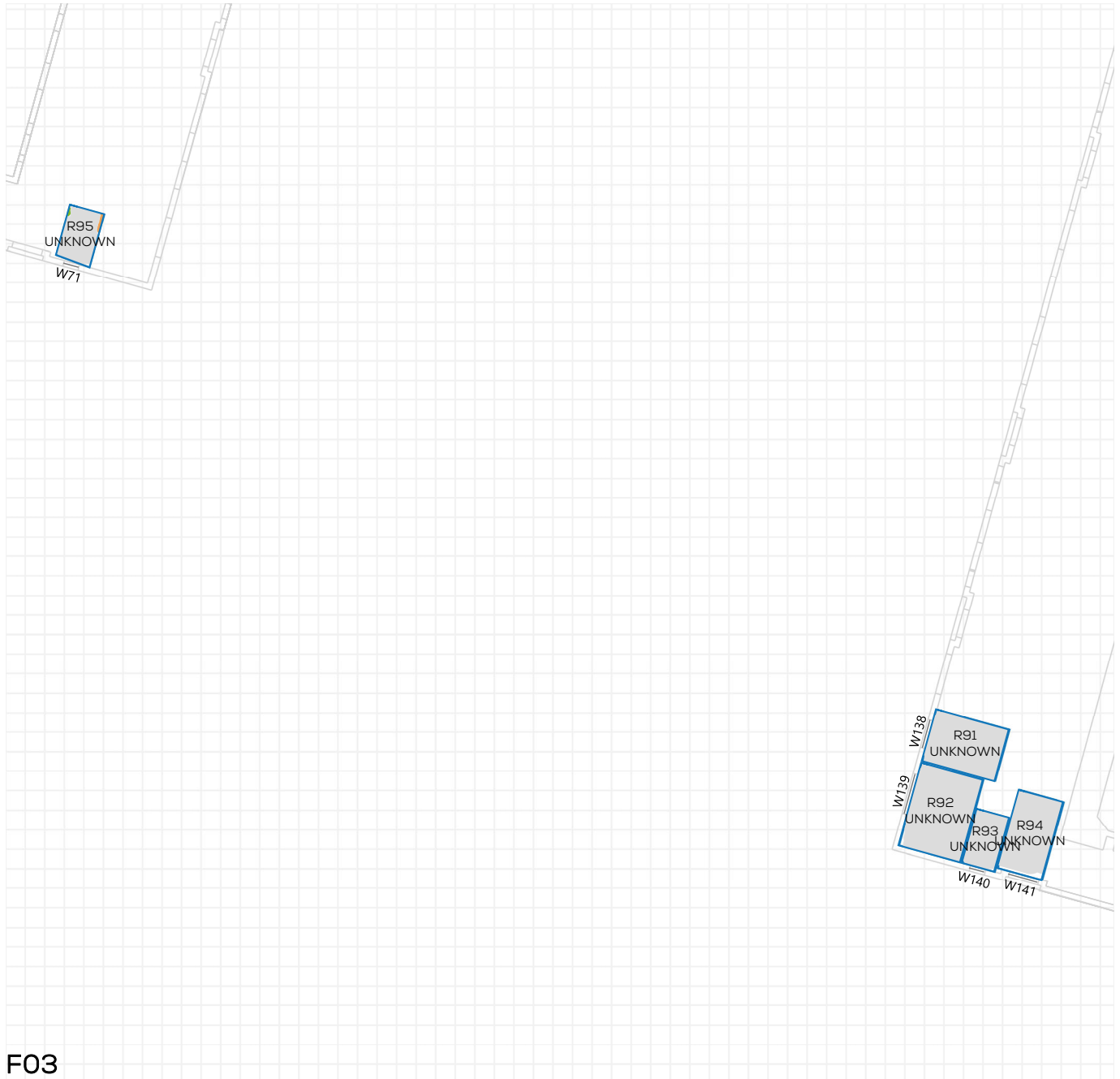

F03

# NSL CONTOURS



PROJECT: 14047 - CAMBRIDGE ROAD  
REPORT TITLE: EXISTING VS. PROPOSED  
ADDRESS: CAMBRIDGE GARDENS  
DATE: 02/10/2020  
SCHEME IR: IR23 (07.09.2020)  
DRAWING No.: 14047-RELO6-IS02-DD190

### KEY:

- GAIN
- LOSS
- MAINTAINED LIT AREA
- 1 METRE GRID

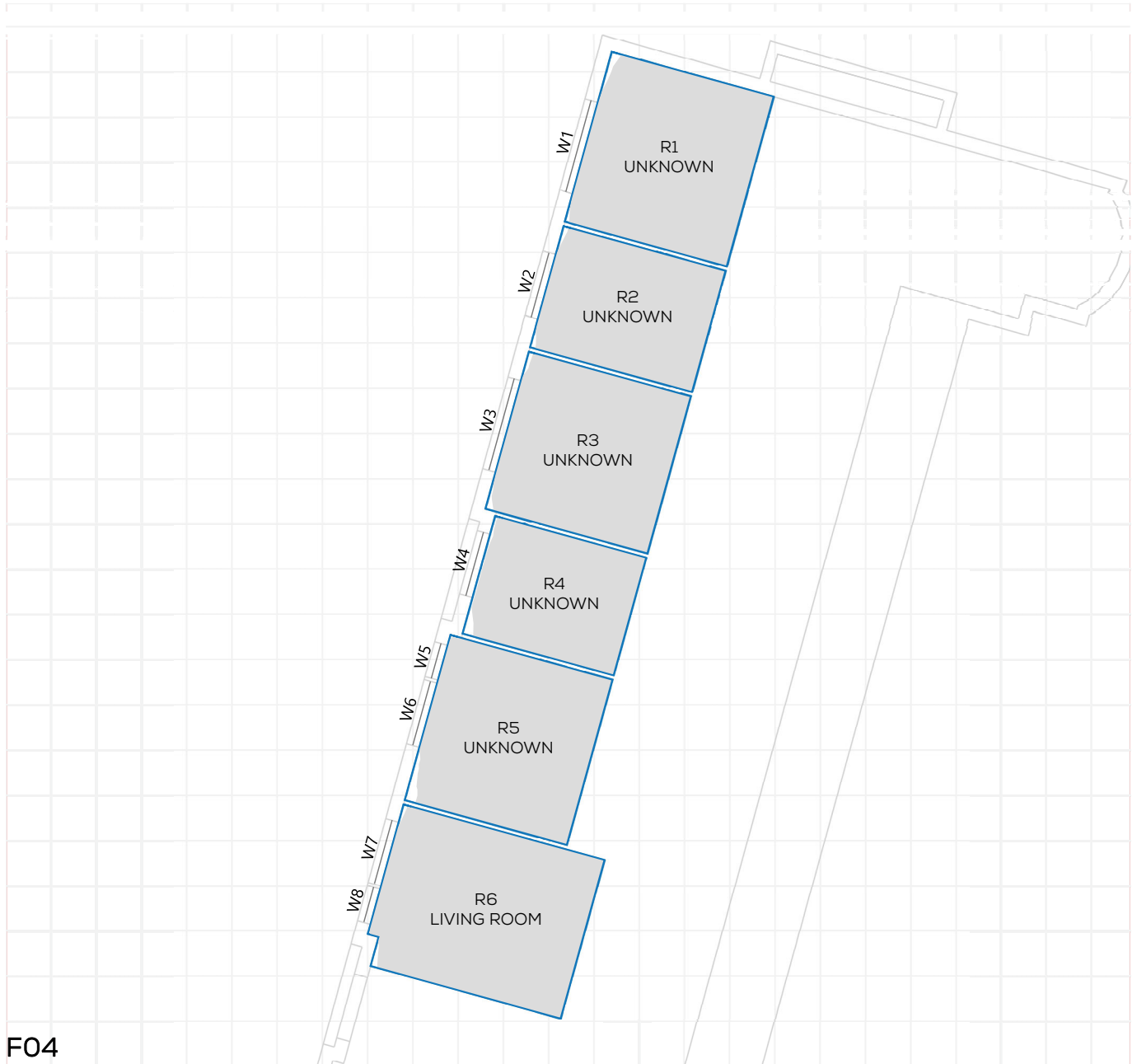

F04

# NSL CONTOURS



PROJECT: 14047 - CAMBRIDGE ROAD  
REPORT TITLE: EXISTING VS. PROPOSED  
ADDRESS: CAMBRIDGE GARDENS  
DATE: 02/10/2020  
SCHEME IR: IR23 (07.09.2020)  
DRAWING No.: 14047-RELO6-IS02-DD191

## KEY:

- GAIN
- LOSS
- MAINTAINED LIT AREA
- 1 METRE GRID



F04

# NSL CONTOURS



PROJECT: 14047 - CAMBRIDGE ROAD  
REPORT TITLE: EXISTING VS. PROPOSED  
ADDRESS: CAMBRIDGE GARDENS  
DATE: 02/10/2020  
SCHEME IR: IR23 (07.09.2020)  
DRAWING No.: 14047-RELO6-IS02-DD192

### KEY:

- GAIN
- LOSS
- MAINTAINED LIT AREA
- 1 METRE GRID

