

# NSL CONTOURS



PROJECT: 14047 - CAMBRIDGE ROAD  
REPORT TITLE: EXISTING VS. PROPOSED  
ADDRESS: 67 CAMBRIDGE GROVE ROAD  
DATE: 02/10/2020  
SCHEME IR: IR23 (07.09.2020)  
DRAWING No.: 14047-RELO6-IS02-DD407

**KEY:**

- GAIN
- LOSS
- MAINTAINED LIT AREA
- 1 METRE GRID

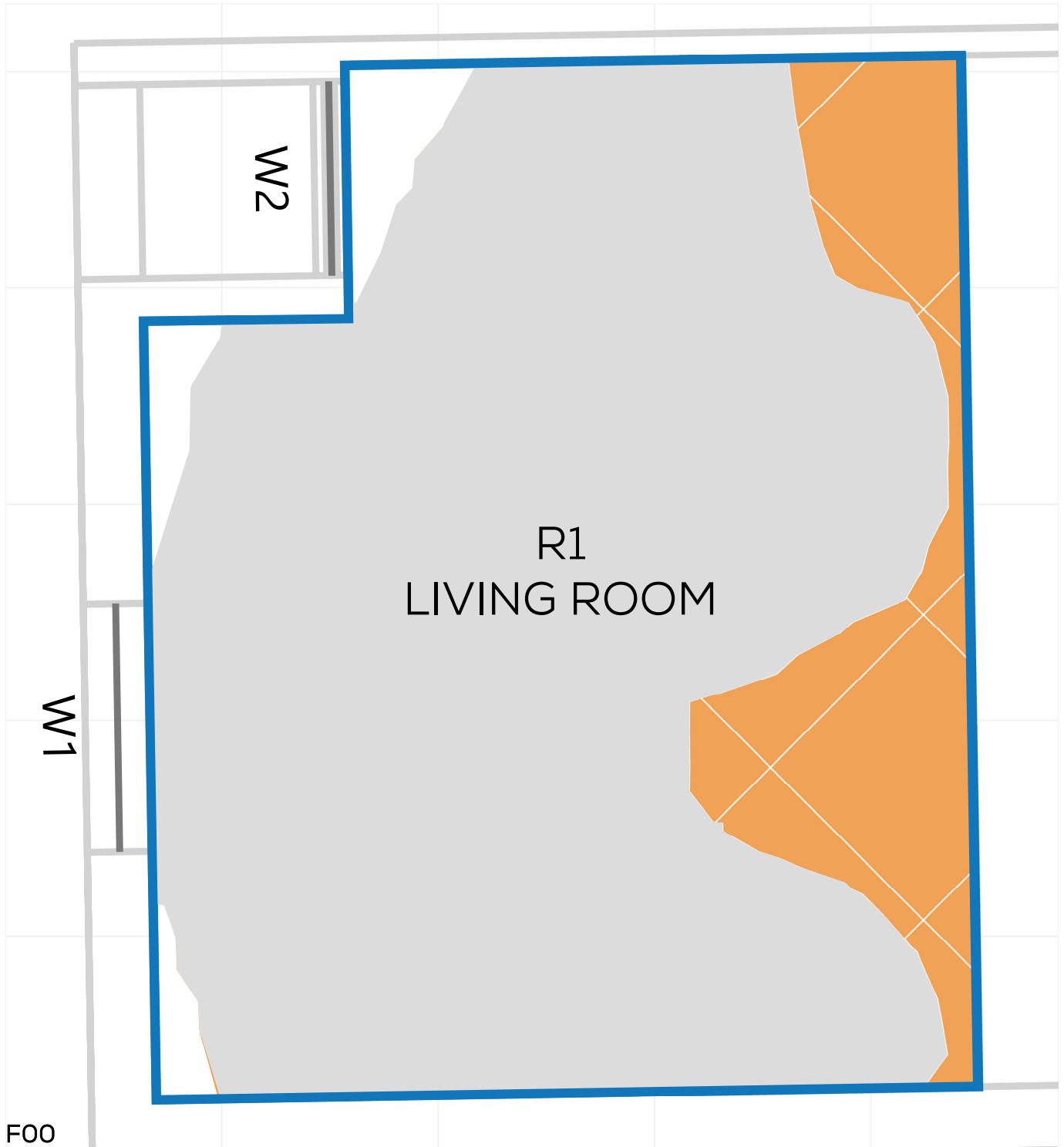
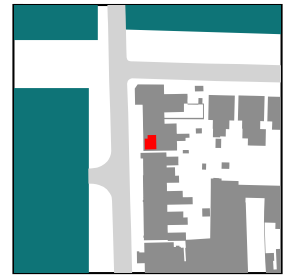

# NSL CONTOURS



PROJECT: 14047 - CAMBRIDGE ROAD  
REPORT TITLE: EXISTING VS. PROPOSED  
ADDRESS: 67 CAMBRIDGE GROVE ROAD  
DATE: 02/10/2020  
SCHEME IR: IR23 (07.09.2020)  
DRAWING No.: 14047-RELO6-IS02-DD408

**KEY:**

- GAIN
- LOSS
- MAINTAINED LIT AREA
- 1 METRE GRID

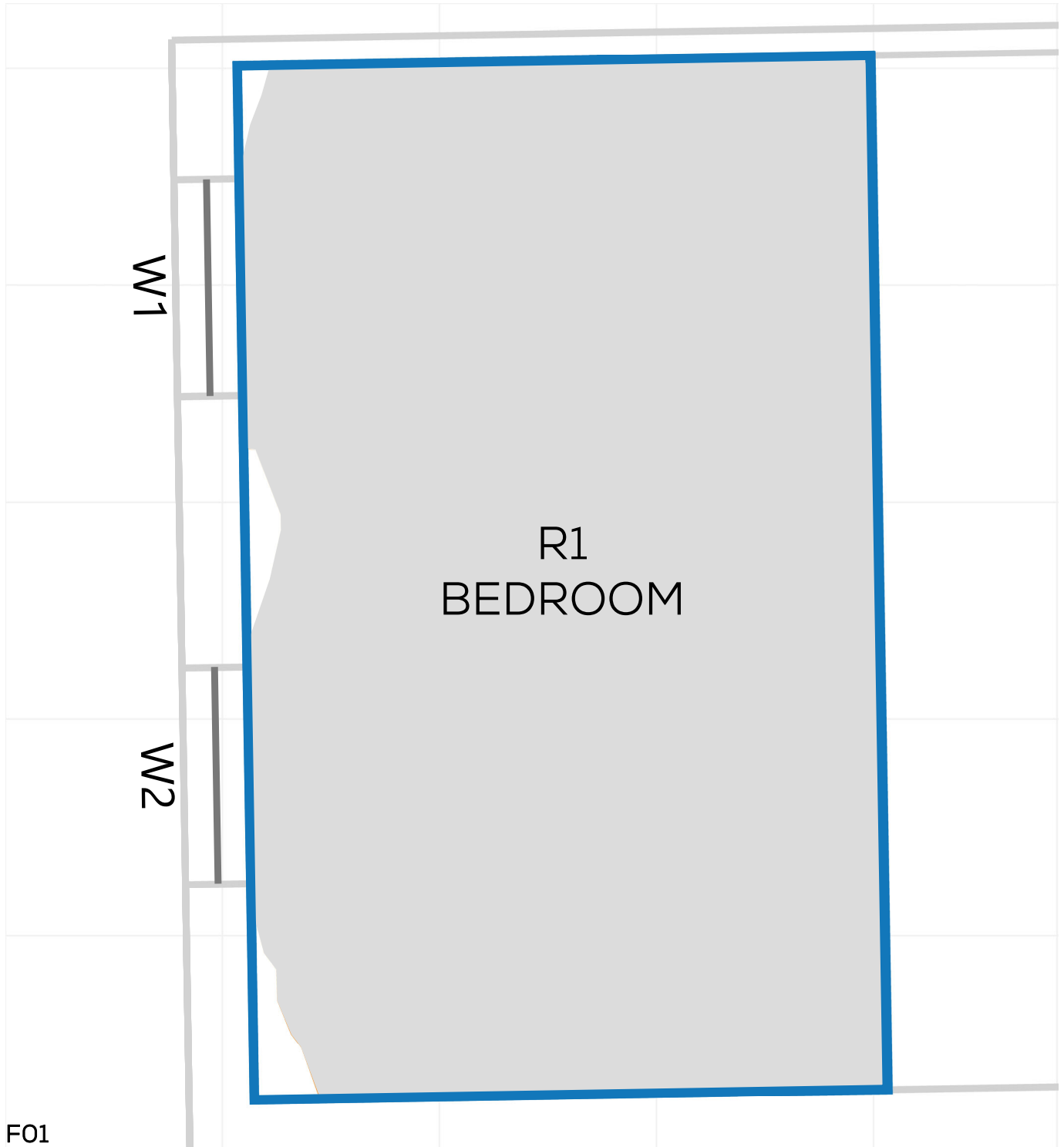

# NSL CONTOURS



PROJECT: 14047 - CAMBRIDGE ROAD  
REPORT TITLE: EXISTING VS. PROPOSED  
ADDRESS: 69 CAMBRIDGE GROVE ROAD  
DATE: 02/10/2020  
SCHEME IR: IR23 (07.09.2020)  
DRAWING No.: 14047-RELO6-IS02-DD409

## KEY:

- GAIN
- LOSS
- MAINTAINED LIT AREA
- 1 METRE GRID

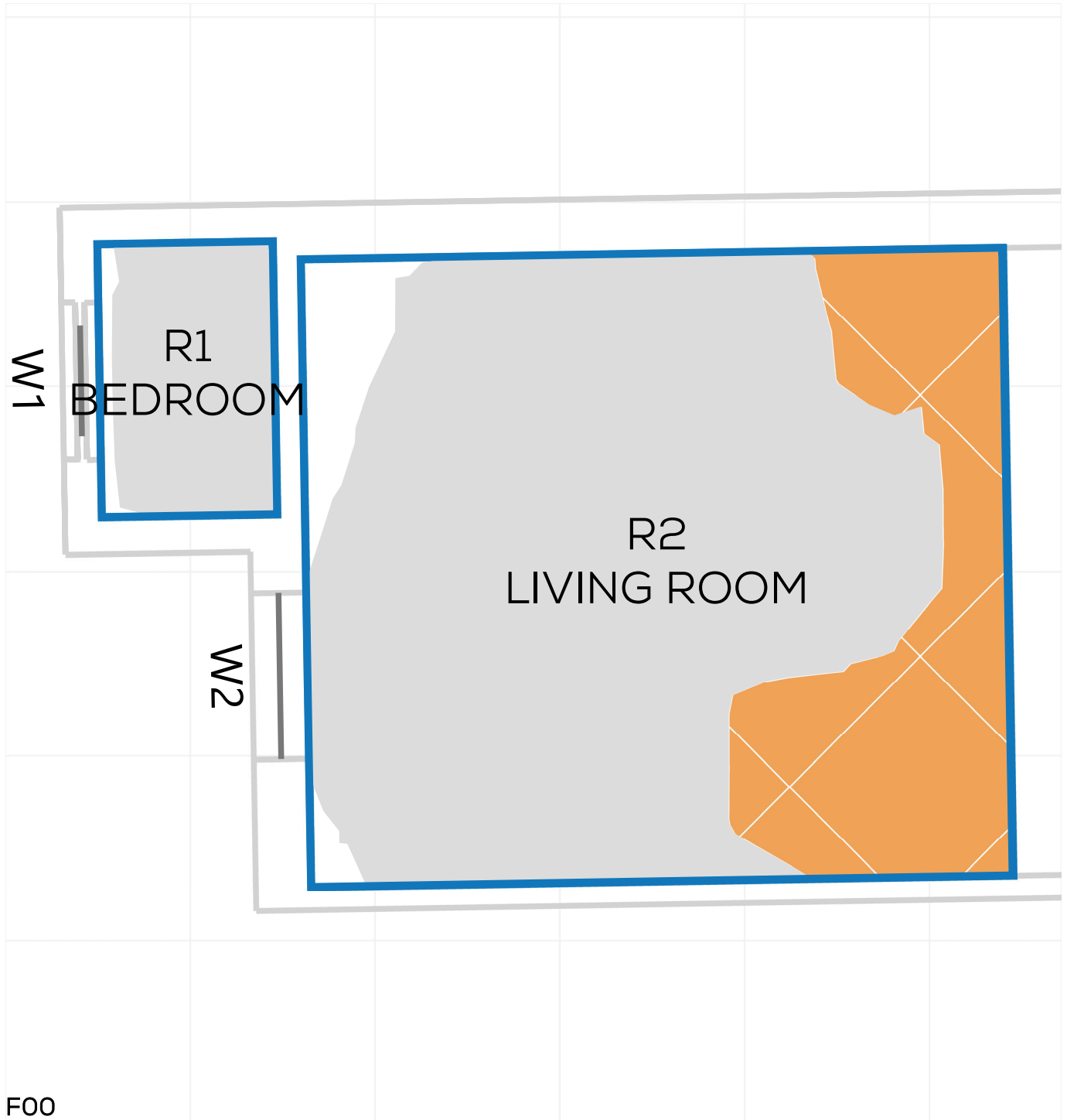
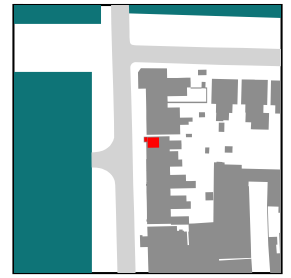

# NSL CONTOURS



PROJECT: 14047 - CAMBRIDGE ROAD  
REPORT TITLE: EXISTING VS. PROPOSED  
ADDRESS: 69 CAMBRIDGE GROVE ROAD  
DATE: 02/10/2020  
SCHEME IR: IR23 (07.09.2020)  
DRAWING No.: 14047-RELO6-IS02-DD410

**KEY:**

- GAIN
- LOSS
- MAINTAINED LIT AREA
- 1 METRE GRID

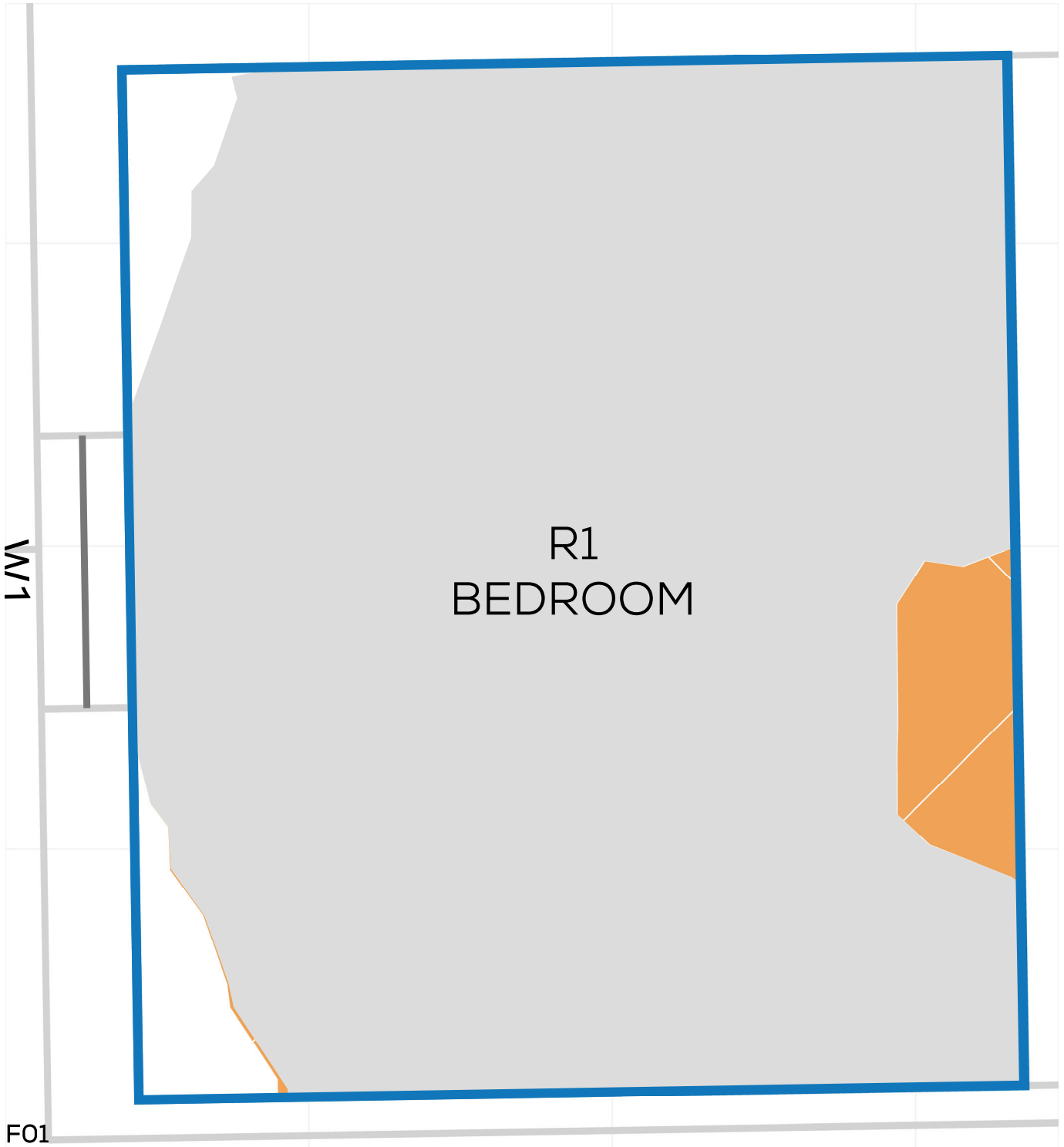

# NSL CONTOURS



PROJECT: 14047 - CAMBRIDGE ROAD  
REPORT TITLE: EXISTING VS. PROPOSED  
ADDRESS: 71 CAMBRIDGE GROVE ROAD  
DATE: 02/10/2020  
SCHEME IR: IR23 (07.09.2020)  
DRAWING No.: 14047-RELO6-IS02-DD411

**KEY:**

- GAIN
- LOSS
- MAINTAINED LIT AREA
- 1 METRE GRID



# NSL CONTOURS



PROJECT: 14047 - CAMBRIDGE ROAD  
REPORT TITLE: EXISTING VS. PROPOSED  
ADDRESS: 71 CAMBRIDGE GROVE ROAD  
DATE: 02/10/2020  
SCHEME IR: IR23 (07.09.2020)  
DRAWING No.: 14047-RELO6-IS02-DD412

**KEY:**

- GAIN
- LOSS
- MAINTAINED LIT AREA
- 1 METRE GRID

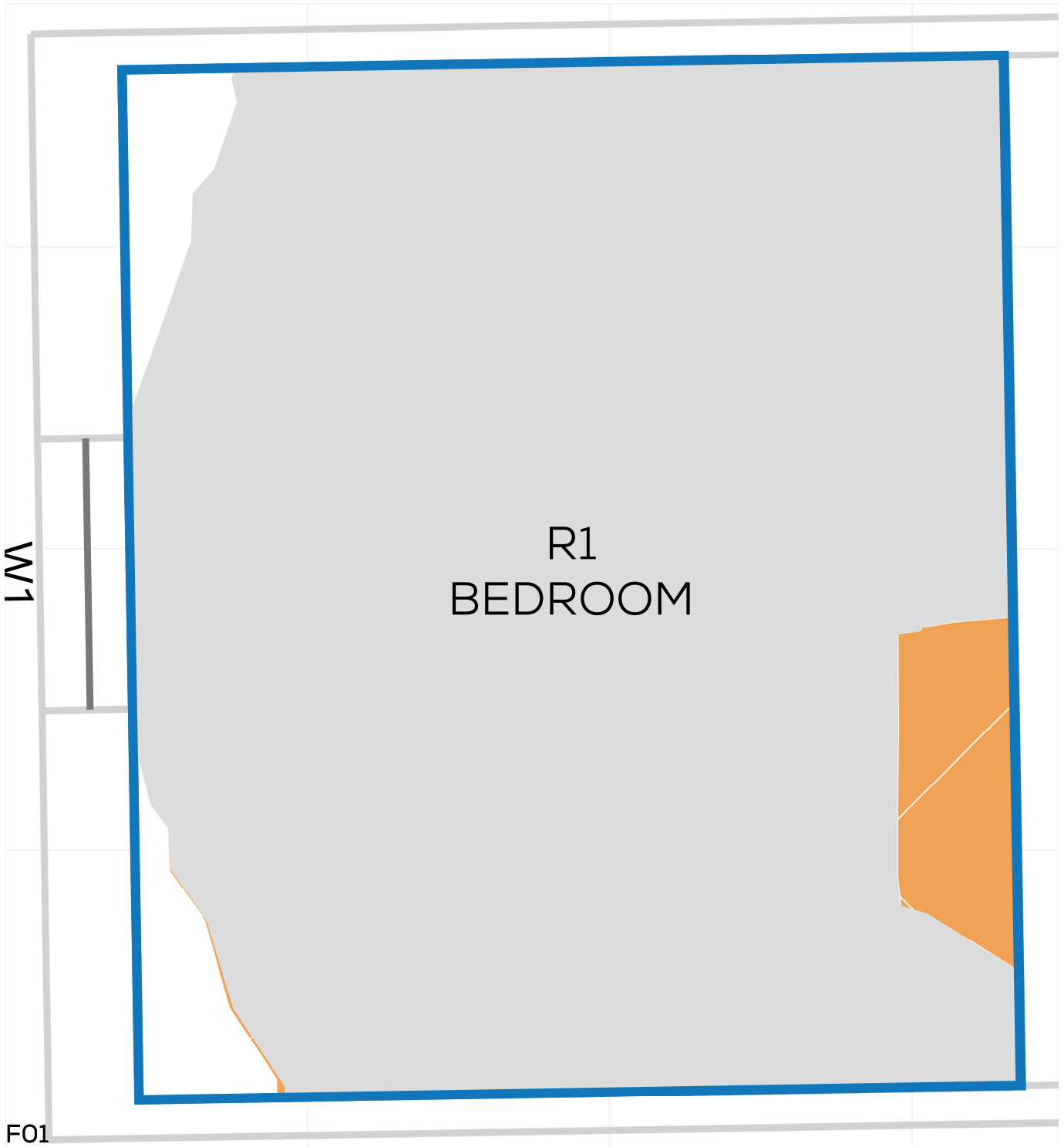

# NSL CONTOURS



PROJECT: 14047 - CAMBRIDGE ROAD  
REPORT TITLE: EXISTING VS. PROPOSED  
ADDRESS: 73 CAMBRIDGE GROVE ROAD  
DATE: 02/10/2020  
SCHEME IR: IR23 (07.09.2020)  
DRAWING No.: 14047-RELO6-IS02-DD413

## KEY:

- GAIN
- LOSS
- MAINTAINED LIT AREA
- 1 METRE GRID

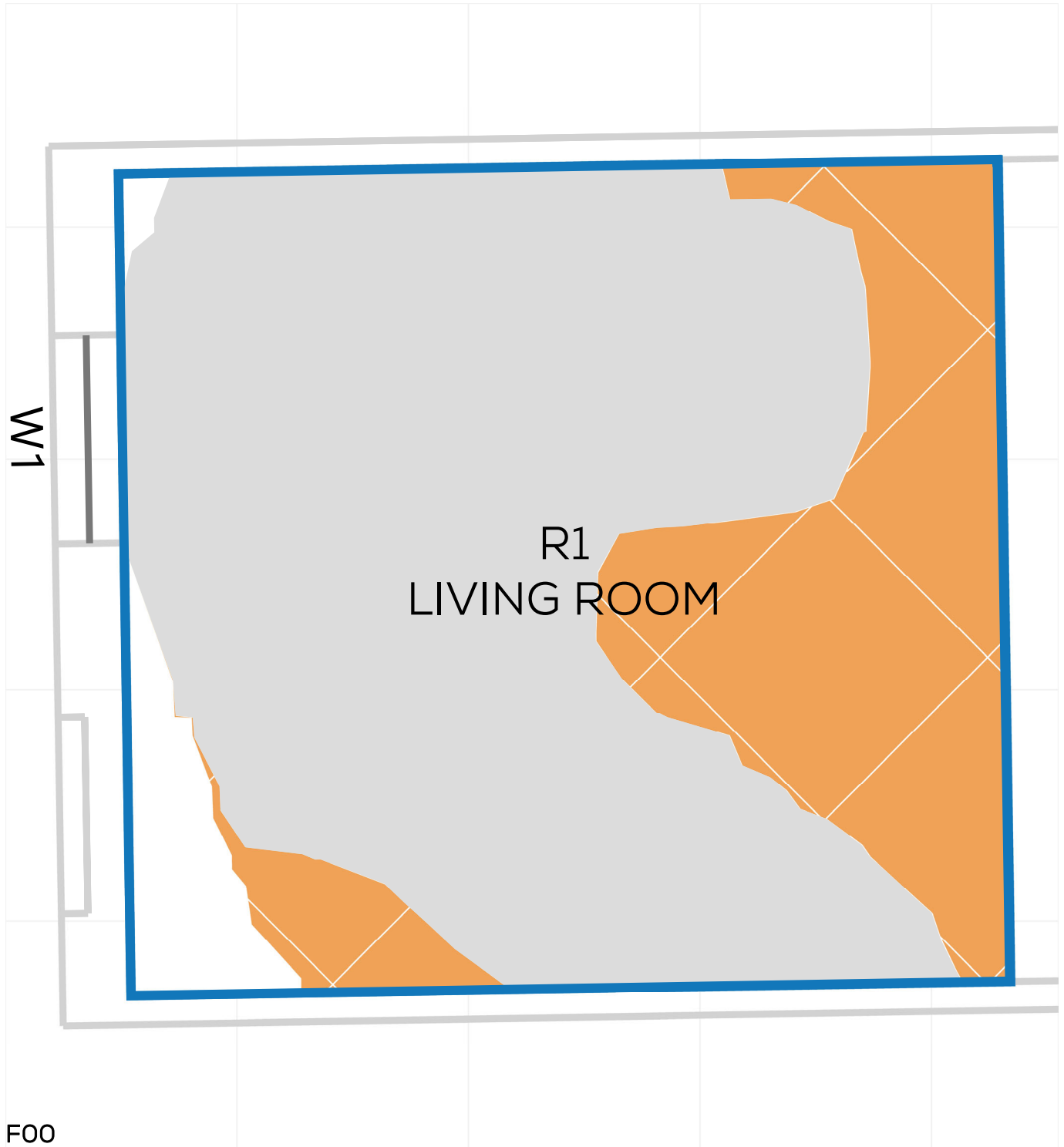

# NSL CONTOURS



PROJECT: 14047 - CAMBRIDGE ROAD  
REPORT TITLE: EXISTING VS. PROPOSED  
ADDRESS: 73 CAMBRIDGE GROVE ROAD  
DATE: 02/10/2020  
SCHEME IR: IR23 (07.09.2020)  
DRAWING No.: 14047-RELO6-IS02-DD414

### KEY:

- GAIN
- LOSS
- MAINTAINED LIT AREA
- 1 METRE GRID

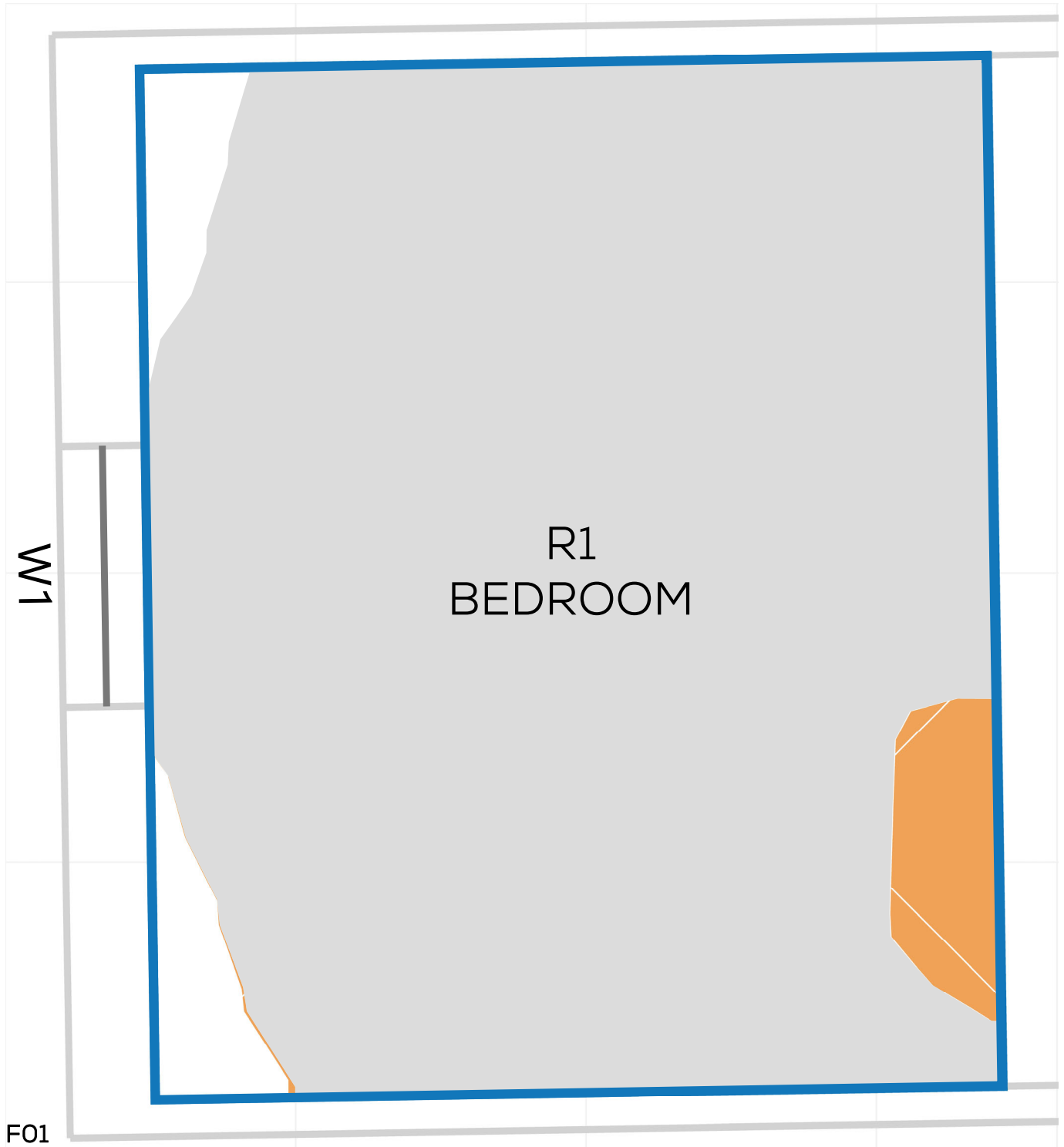



PROJECT: 14047 - CAMBRIDGE ROAD  
REPORT TITLE: EXISTING VS. PROPOSED  
ADDRESS: 75 CAMBRIDGE GROVE ROAD  
DATE: 02/10/2020  
SCHEME IR: IR23 (07.09.2020)  
DRAWING No.: 14047-RELO6-IS02-DD415

**KEY:**

- GAIN
- LOSS
- MAINTAINED LIT AREA
- 1 METRE GRID

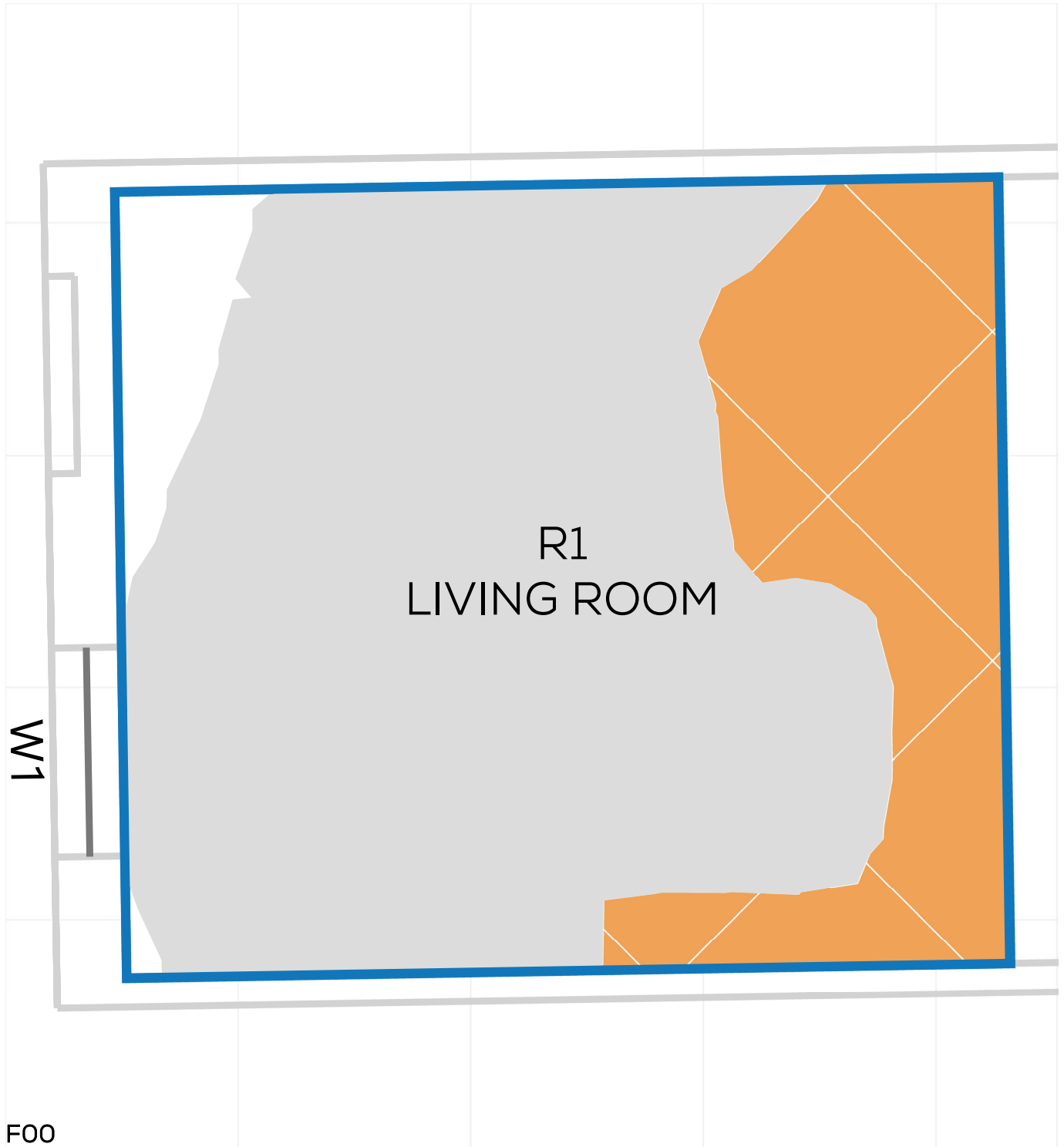

# NSL CONTOURS



PROJECT: 14047 - CAMBRIDGE ROAD  
REPORT TITLE: EXISTING VS. PROPOSED  
ADDRESS: 75 CAMBRIDGE GROVE ROAD  
DATE: 02/10/2020  
SCHEME IR: IR23 (07.09.2020)  
DRAWING No.: 14047-RELO6-IS02-DD416

## KEY:

- GAIN
- LOSS
- MAINTAINED LIT AREA
- 1 METRE GRID

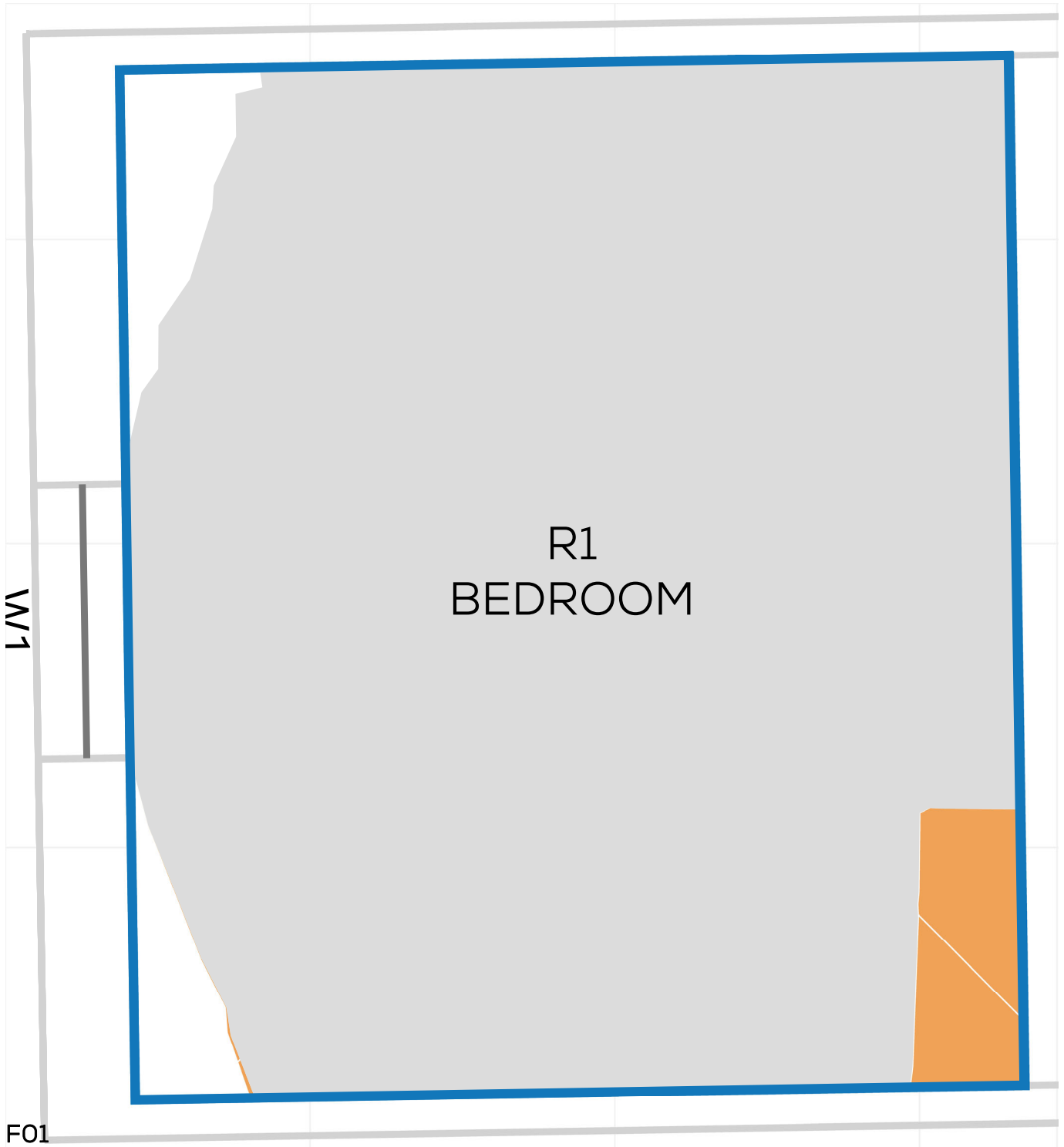
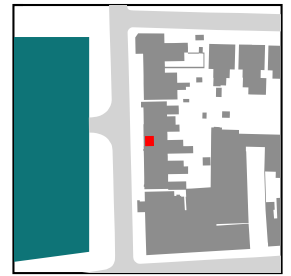

PROJECT: 14047 - CAMBRIDGE ROAD  
REPORT TITLE: EXISTING VS. PROPOSED  
ADDRESS: 77 CAMBRIDGE GROVE ROAD  
DATE: 02/10/2020  
SCHEME IR: IR23 (07.09.2020)  
DRAWING No.: 14047-RELO6-IS02-DD417

**KEY:**

- GAIN
- LOSS
- MAINTAINED LIT AREA
- 1 METRE GRID

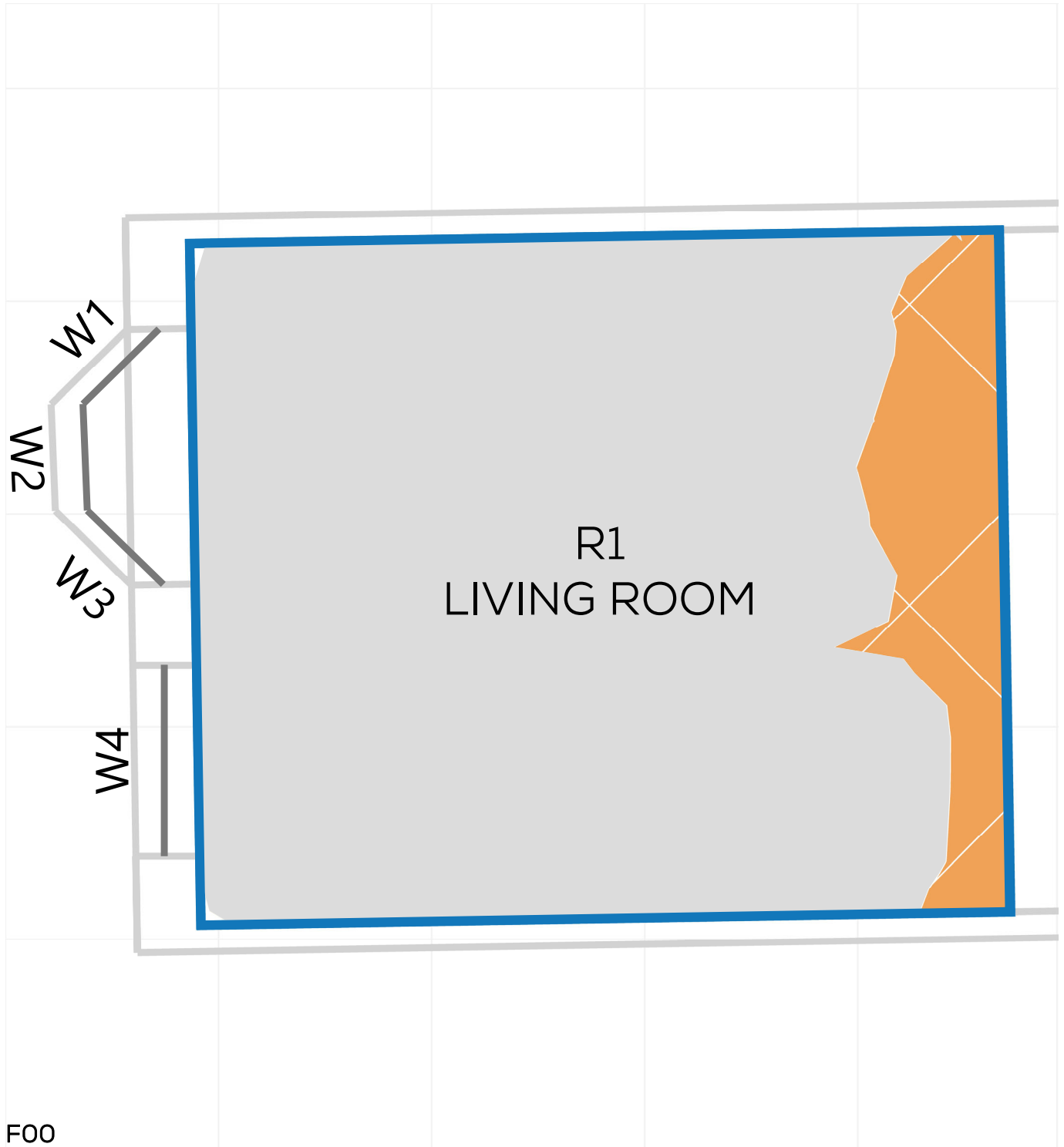





# NSL CONTOURS



PROJECT: 14047 - CAMBRIDGE ROAD  
REPORT TITLE: EXISTING VS. PROPOSED  
ADDRESS: 77 CAMBRIDGE GROVE ROAD  
DATE: 02/10/2020  
SCHEME IR: IR23 (07.09.2020)  
DRAWING No.: 14047-RELO6-IS02-DD418

## KEY:

-  GAIN
-  LOSS
-  MAINTAINED LIT AREA
-  1 METRE GRID

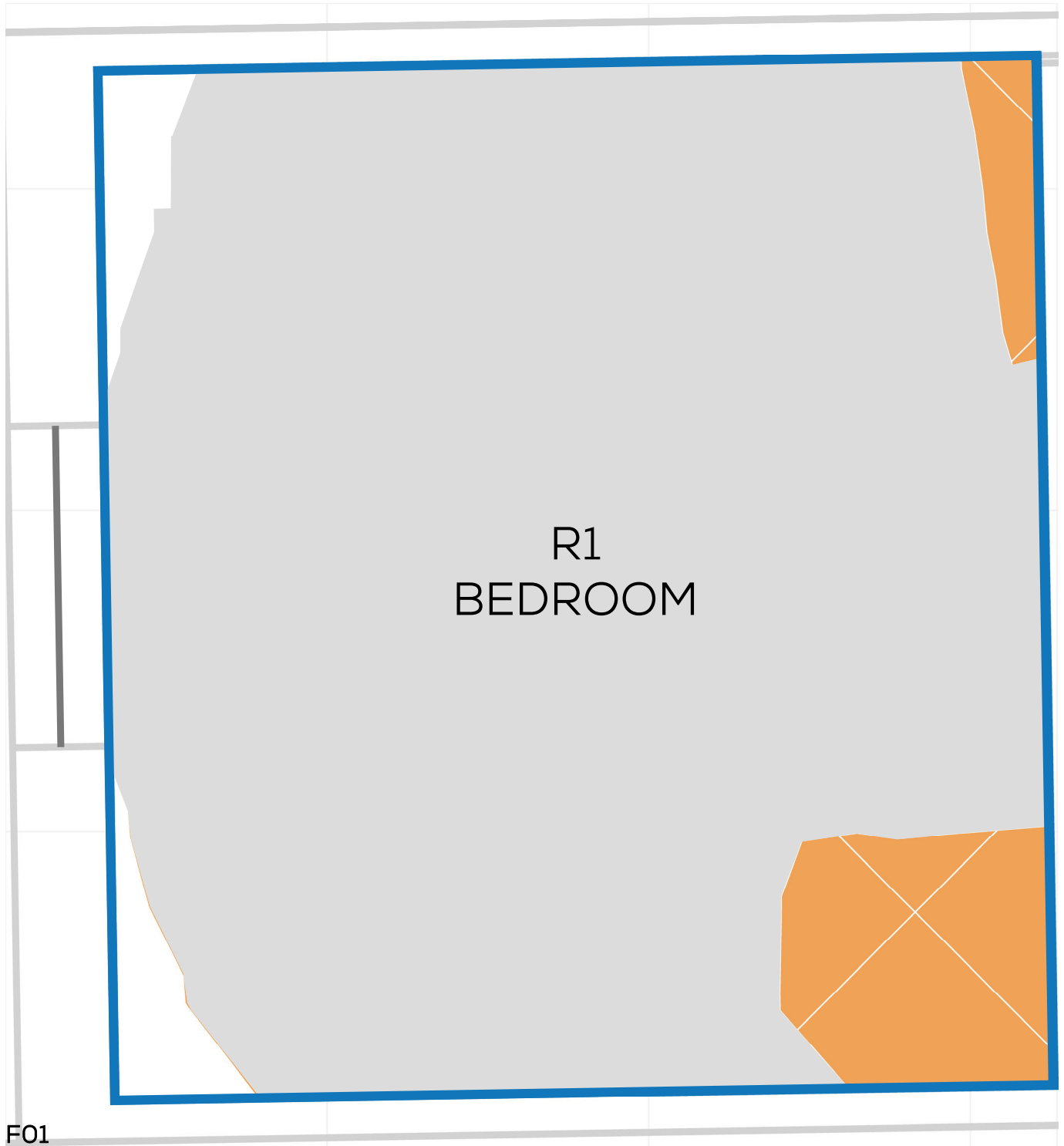

F01

# NSL CONTOURS



PROJECT: 14047 - CAMBRIDGE ROAD  
REPORT TITLE: EXISTING VS. PROPOSED  
ADDRESS: 79 CAMBRIDGE GROVE ROAD  
DATE: 02/10/2020  
SCHEME IR: IR23 (07.09.2020)  
DRAWING No.: 14047-RELO6-IS02-DD419

**KEY:**

- GAIN
- LOSS
- MAINTAINED LIT AREA
- 1 METRE GRID

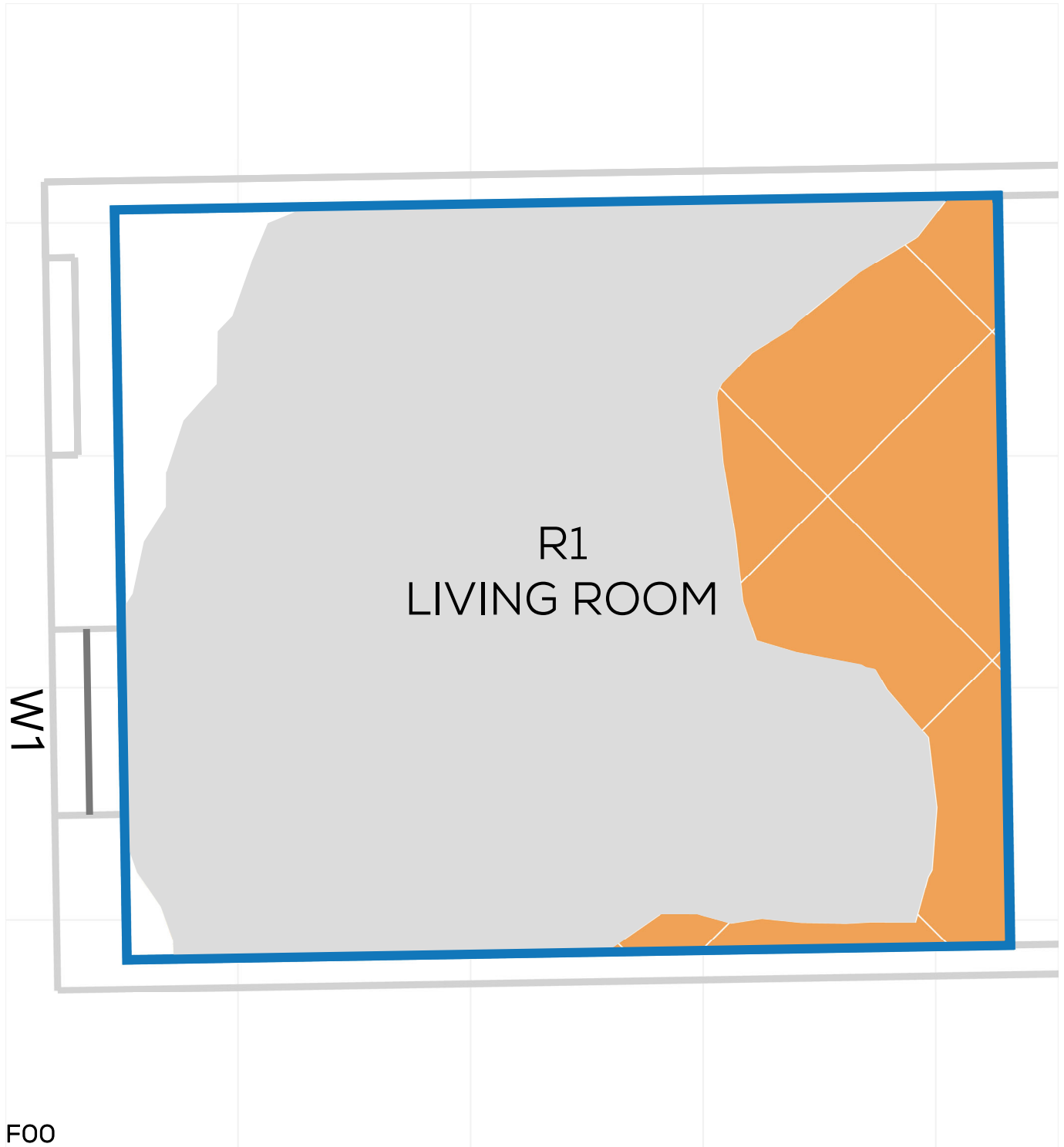

# NSL CONTOURS



PROJECT: 14047 - CAMBRIDGE ROAD  
REPORT TITLE: EXISTING VS. PROPOSED  
ADDRESS: 79 CAMBRIDGE GROVE ROAD  
DATE: 02/10/2020  
SCHEME IR: IR23 (07.09.2020)  
DRAWING No.: 14047-RELO6-IS02-DD420

**KEY:**

- GAIN
- LOSS
- MAINTAINED LIT AREA
- 1 METRE GRID

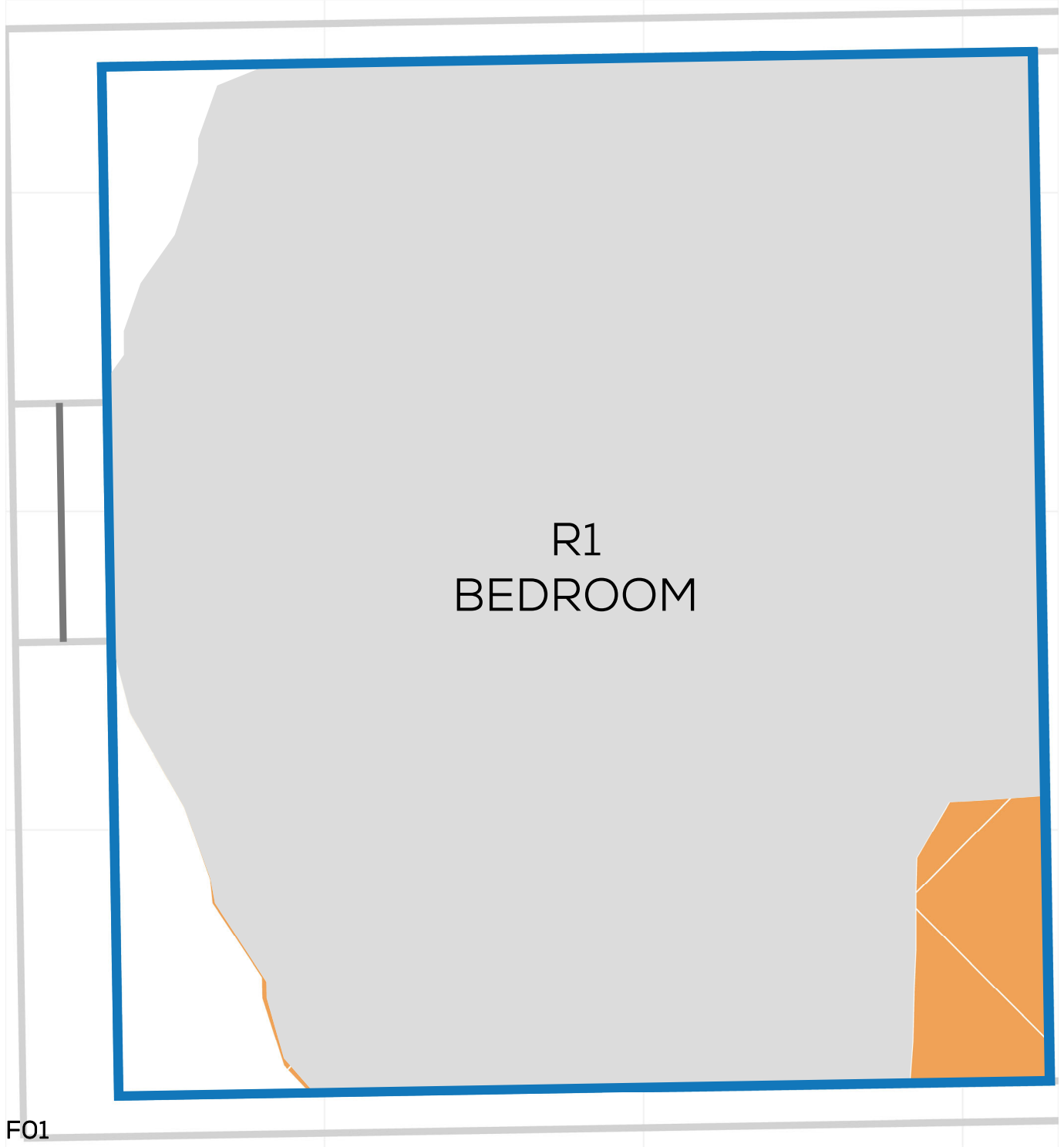
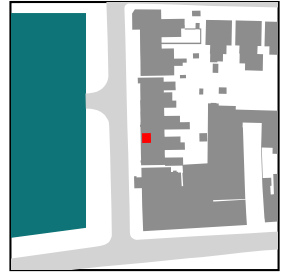

# NSL CONTOURS



PROJECT: 14047 - CAMBRIDGE ROAD  
REPORT TITLE: EXISTING VS. PROPOSED  
ADDRESS: 81 CAMBRIDGE GROVE ROAD  
DATE: 02/10/2020  
SCHEME IR: IR23 (07.09.2020)  
DRAWING No.: 14047-RELO6-IS02-DD421

### KEY:

- GAIN
- LOSS
- MAINTAINED LIT AREA
- 1 METRE GRID







# NSL CONTOURS



PROJECT: 14047 - CAMBRIDGE ROAD  
REPORT TITLE: EXISTING VS. PROPOSED  
ADDRESS: 81 CAMBRIDGE GROVE ROAD  
DATE: 02/10/2020  
SCHEME IR: IR23 (07.09.2020)  
DRAWING No.: 14047-RELO6-IS02-DD422

## KEY:

-  GAIN
-  LOSS
-  MAINTAINED LIT AREA
-  1 METRE GRID

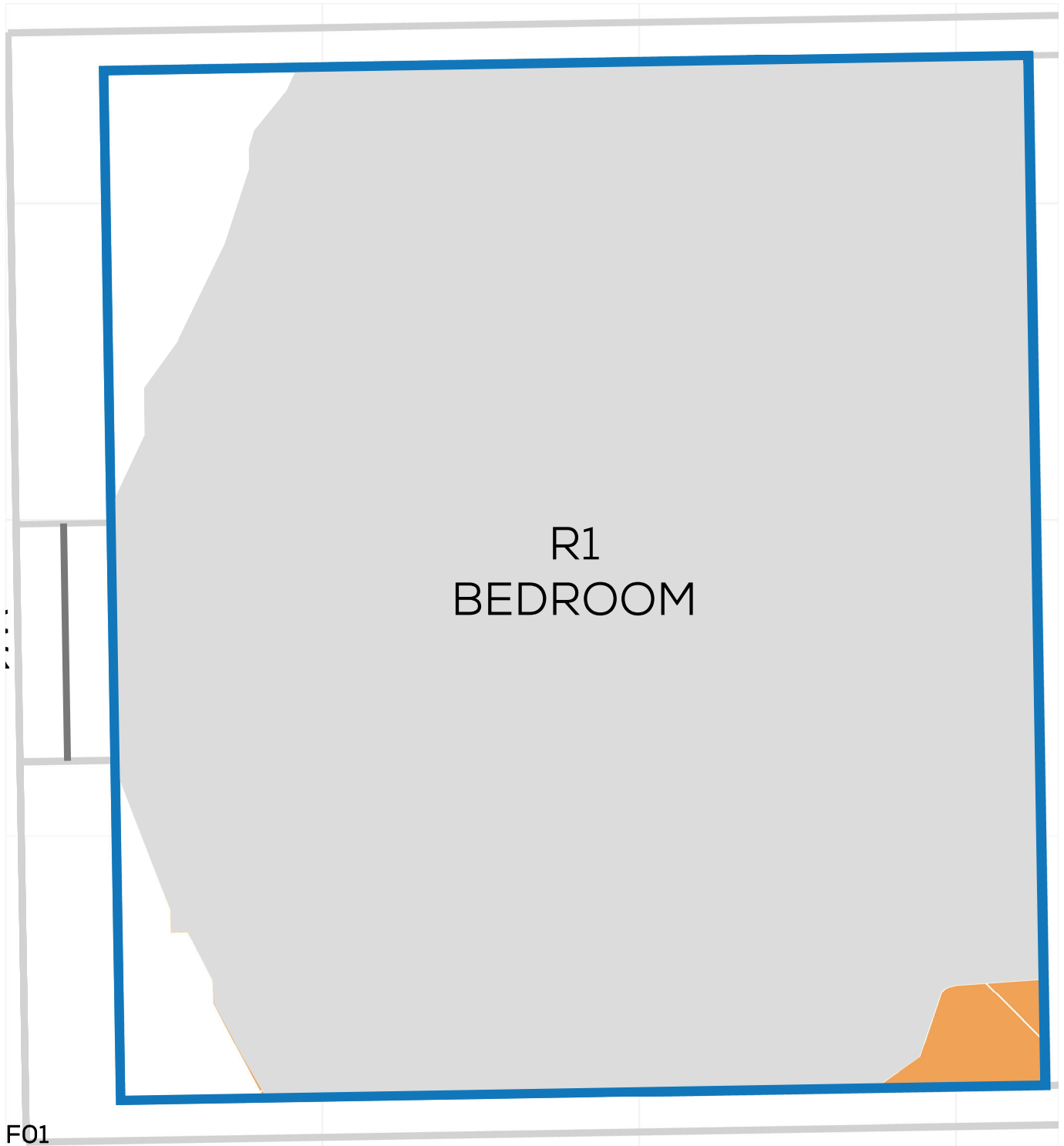
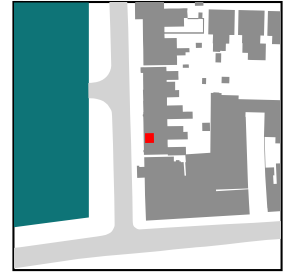



# NSL CONTOURS



PROJECT: 14047 - CAMBRIDGE ROAD  
REPORT TITLE: EXISTING VS. PROPOSED  
ADDRESS: 83 CAMBRIDGE GROVE ROAD  
DATE: 02/10/2020  
SCHEME IR: IR23 (07.09.2020)  
DRAWING No.: 14047-RELO6-IS02-DD423

### KEY:

- GAIN
- LOSS
- MAINTAINED LIT AREA
- 1 METRE GRID

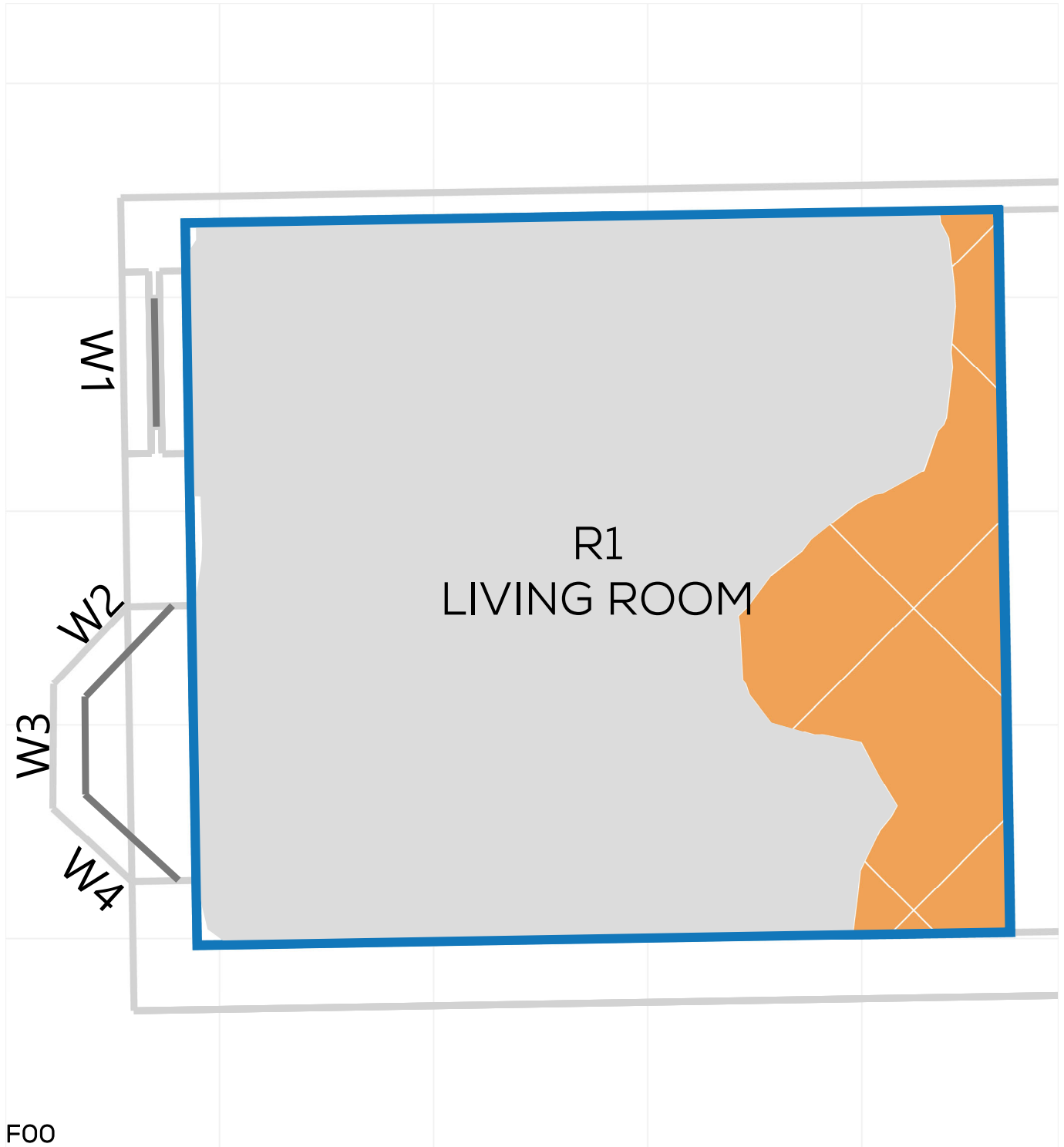

# NSL CONTOURS



PROJECT: 14047 - CAMBRIDGE ROAD  
REPORT TITLE: EXISTING VS. PROPOSED  
ADDRESS: 83 CAMBRIDGE GROVE ROAD  
DATE: 02/10/2020  
SCHEME IR: IR23 (07.09.2020)  
DRAWING No.: 14047-RELO6-IS02-DD424

**KEY:**

- GAIN
- LOSS
- MAINTAINED LIT AREA
- 1 METRE GRID

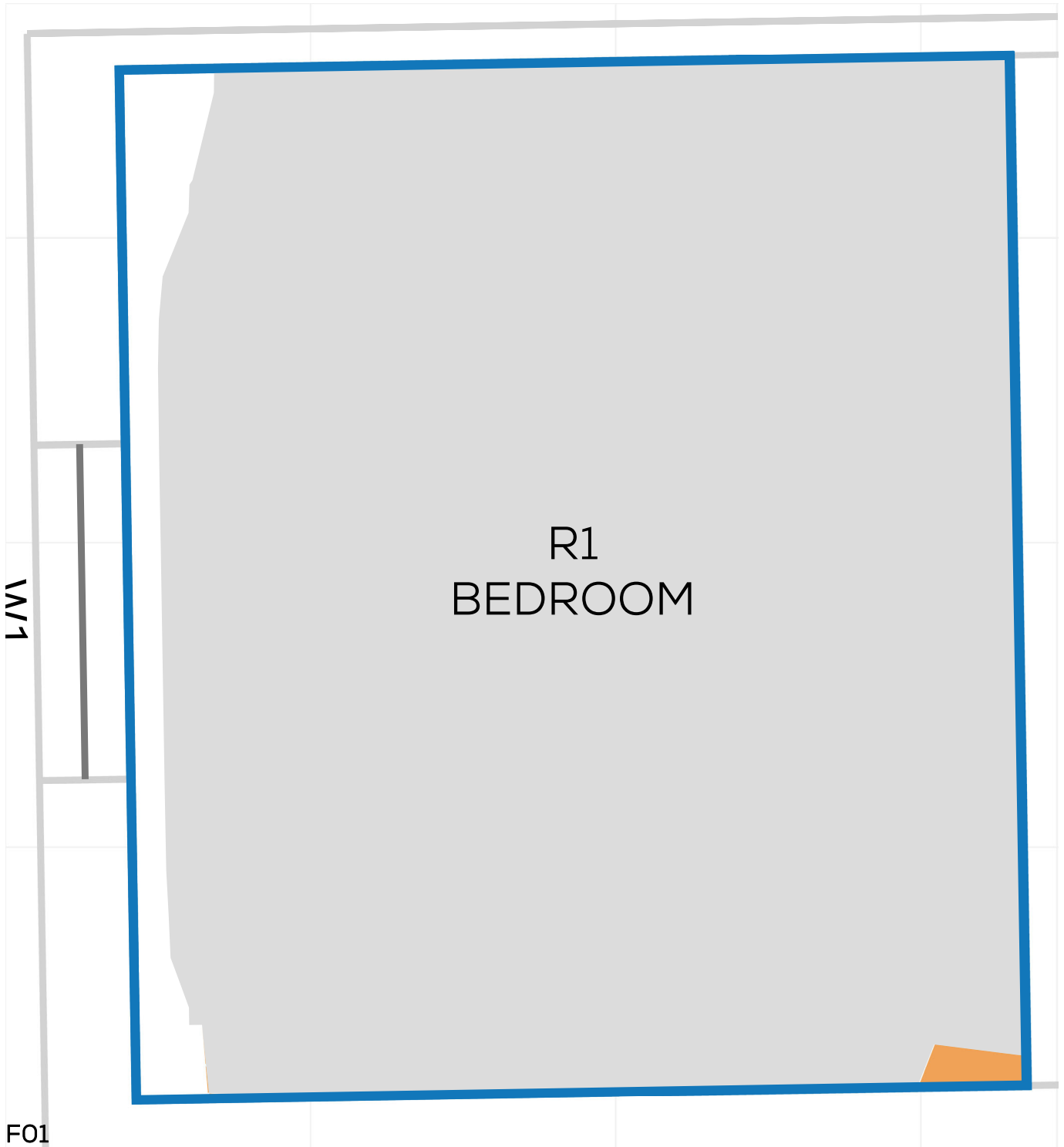
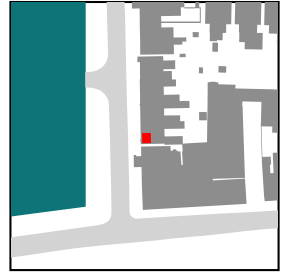

# NSL CONTOURS



PROJECT: 14047 - CAMBRIDGE ROAD  
REPORT TITLE: EXISTING VS. PROPOSED  
ADDRESS: 17 PIPER ROAD  
DATE: 02/10/2020  
SCHEME IR: IR23 (07.09.2020)  
DRAWING No.: 14047-RELO6-IS02-DD425

### KEY:

- GAIN
- LOSS
- MAINTAINED LIT AREA
- 1 METRE GRID

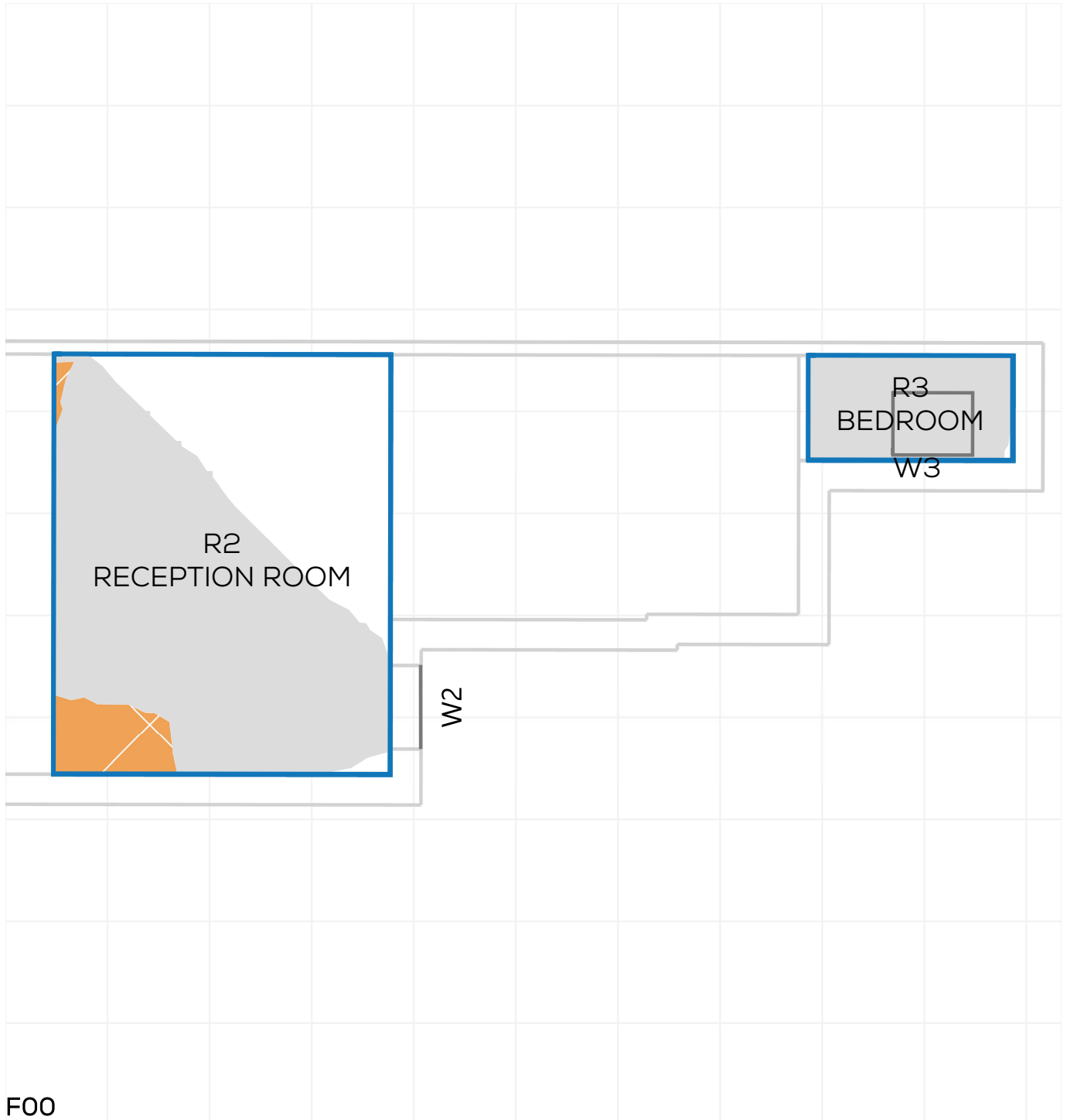
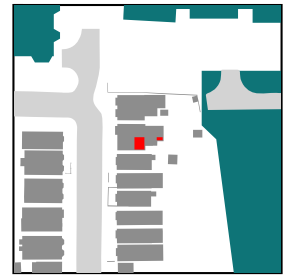

# NSL CONTOURS



PROJECT: 14047 - CAMBRIDGE ROAD  
REPORT TITLE: EXISTING VS. PROPOSED  
ADDRESS: 17 PIPER ROAD  
DATE: 02/10/2020  
SCHEME IR: IR23 (07.09.2020)  
DRAWING No.: 14047-RELO6-IS02-DD426

## KEY:

- GAIN
- LOSS
- MAINTAINED LIT AREA
- 1 METRE GRID

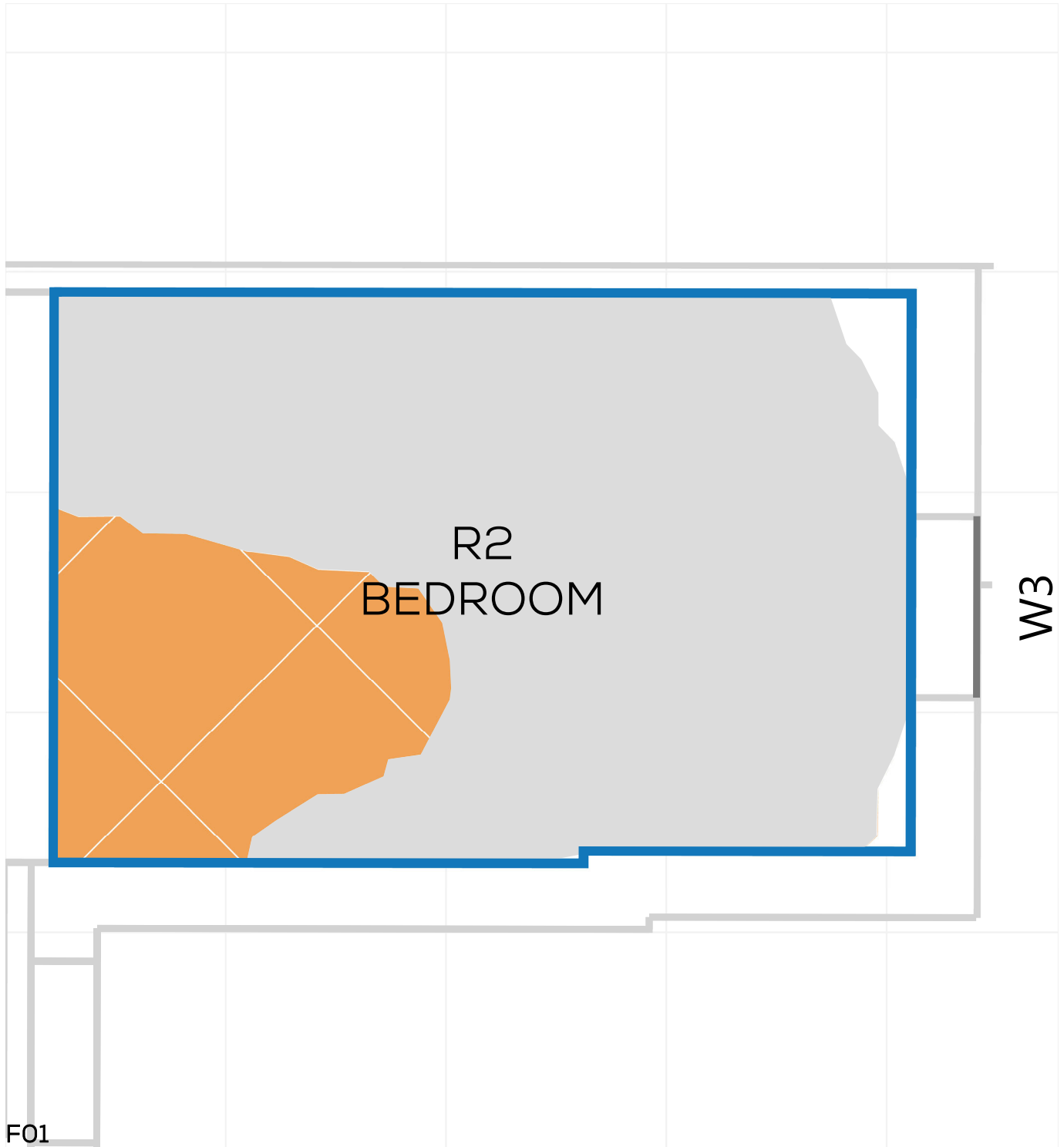
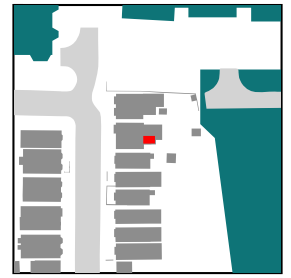

# NSL CONTOURS



PROJECT: 14047 - CAMBRIDGE ROAD  
REPORT TITLE: EXISTING VS. PROPOSED  
ADDRESS: 17 PIPER ROAD  
DATE: 02/10/2020  
SCHEME IR: IR23 (07.09.2020)  
DRAWING No.: 14047-RELO6-IS02-DD427

**KEY:**

- GAIN
- LOSS
- MAINTAINED LIT AREA
- 1 METRE GRID

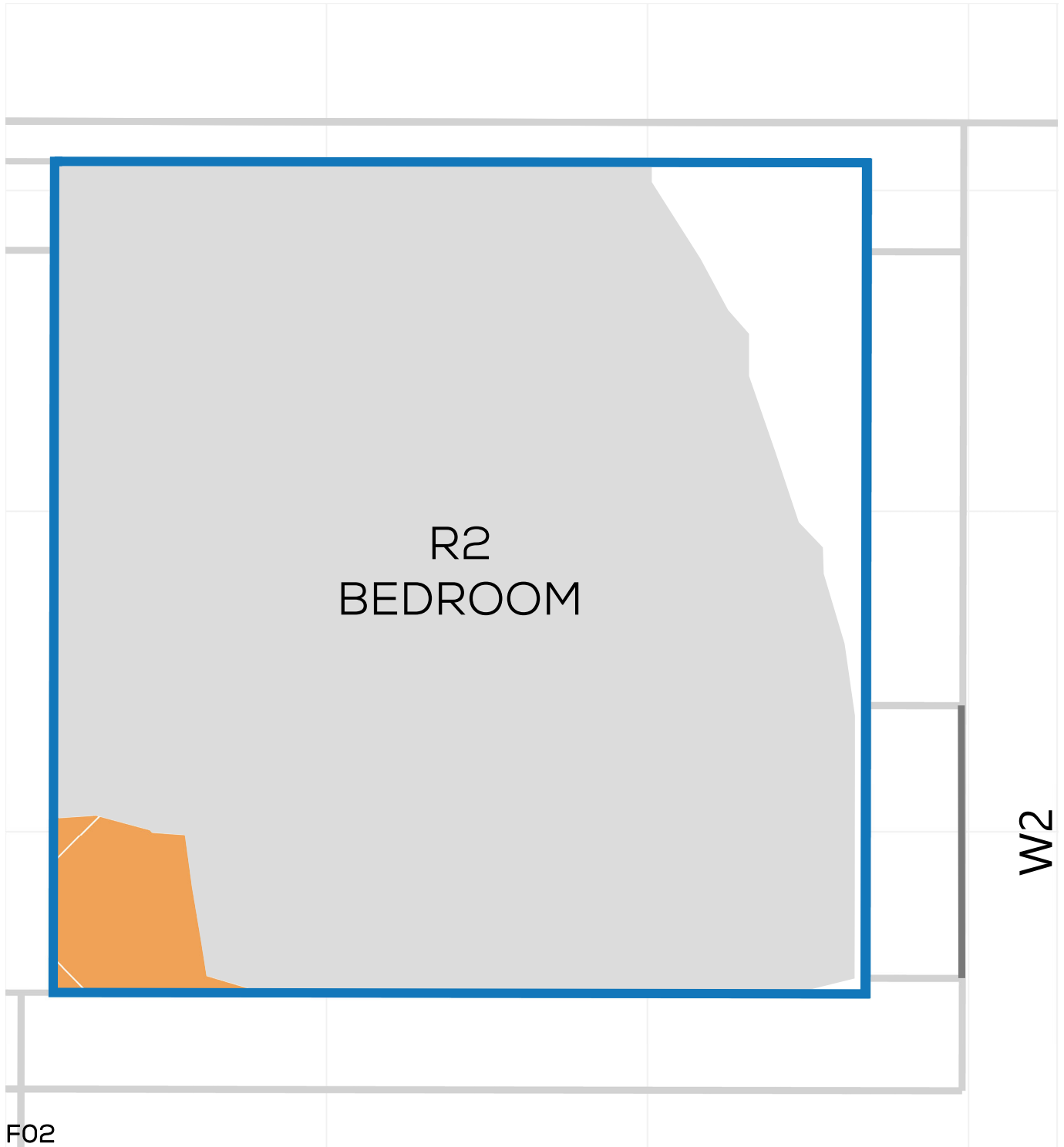
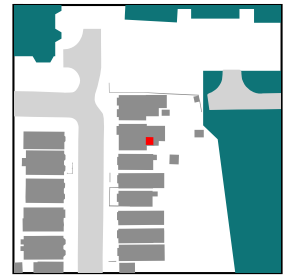

PROJECT: 14047 - CAMBRIDGE ROAD  
REPORT TITLE: EXISTING VS. PROPOSED  
ADDRESS: 11 PIPER ROAD  
DATE: 07/01/2021  
SCHEME IR: IR23 (07.09.2020)  
DRAWING No.: 14047-REL13-IS02-DD1

**KEY:**

- GAIN
- LOSS
- MAINTAINED LIT AREA
- 1 METRE GRID

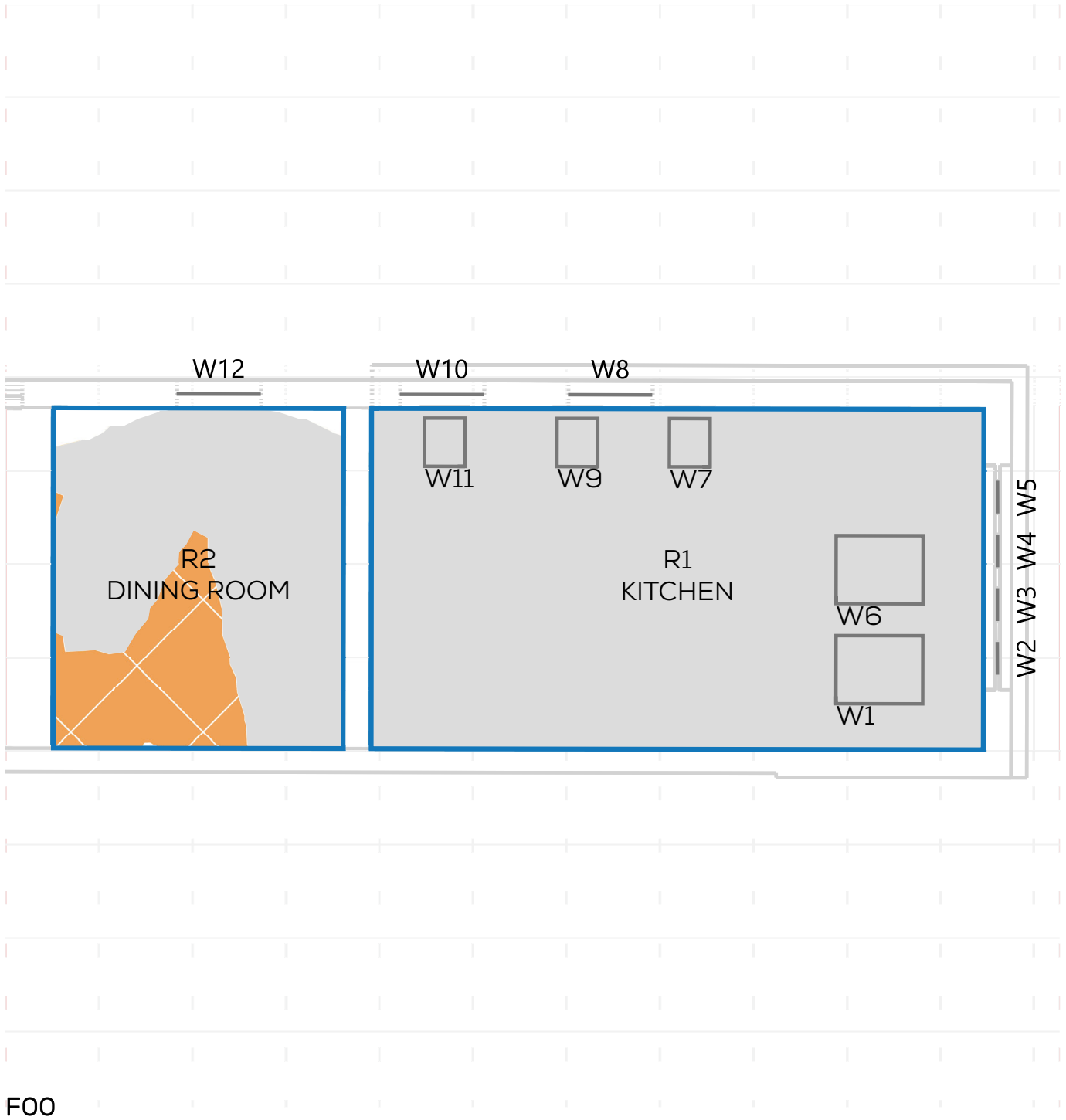
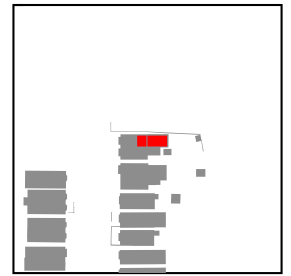





# NSL CONTOURS



PROJECT: 14047 - CAMBRIDGE ROAD  
REPORT TITLE: EXISTING VS. PROPOSED  
ADDRESS: 11 PIPER ROAD  
DATE: 07/01/2021  
SCHEME IR: IR23 (07.09.2020)  
DRAWING No.: 14047-REL13-IS02-DD2

### KEY:

-  GAIN
-  LOSS
-  MAINTAINED LIT AREA
-  1 METRE GRID

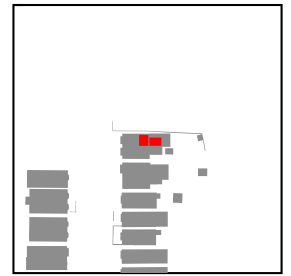

PROJECT: 14047 - CAMBRIDGE ROAD  
REPORT TITLE: EXISTING VS. PROPOSED  
ADDRESS: 11 PIPER ROAD  
DATE: 07/01/2021  
SCHEME IR: IR23 (07.09.2020)  
DRAWING No.: 14047-REL13-IS02-DD3

**KEY:**

- GAIN
- LOSS
- MAINTAINED LIT AREA
- 1 METRE GRID

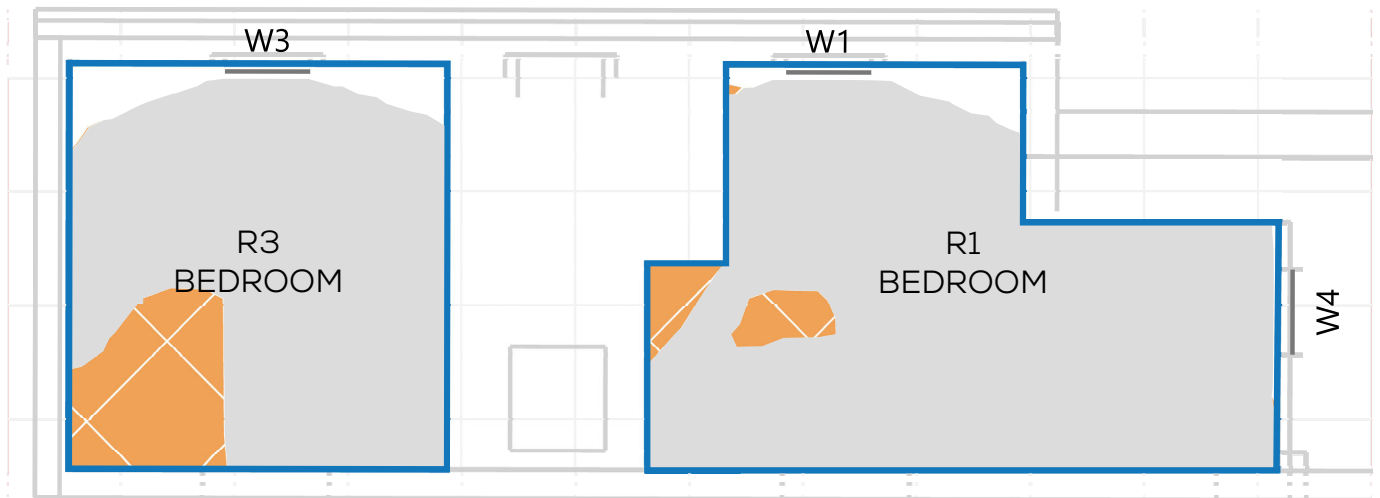
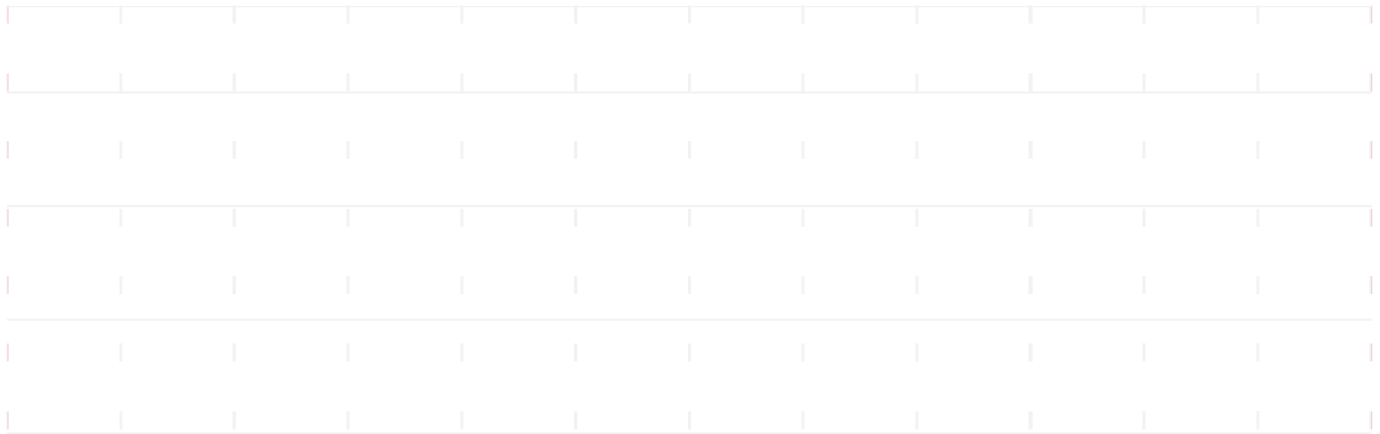
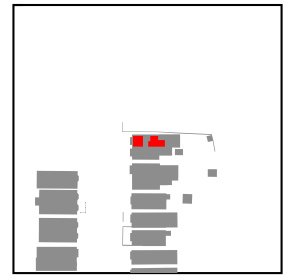







# NSL CONTOURS



PROJECT: 14047 - CAMBRIDGE ROAD  
REPORT TITLE: EXISTING VS. PROPOSED  
ADDRESS: 13 PIPER ROAD  
DATE: 07/01/2021  
SCHEME IR: IR23 (07.09.2020)  
DRAWING No.: 14047-REL13-IS02-DD4

### KEY:

-  GAIN
-  LOSS
-  MAINTAINED LIT AREA
-  1 METRE GRID

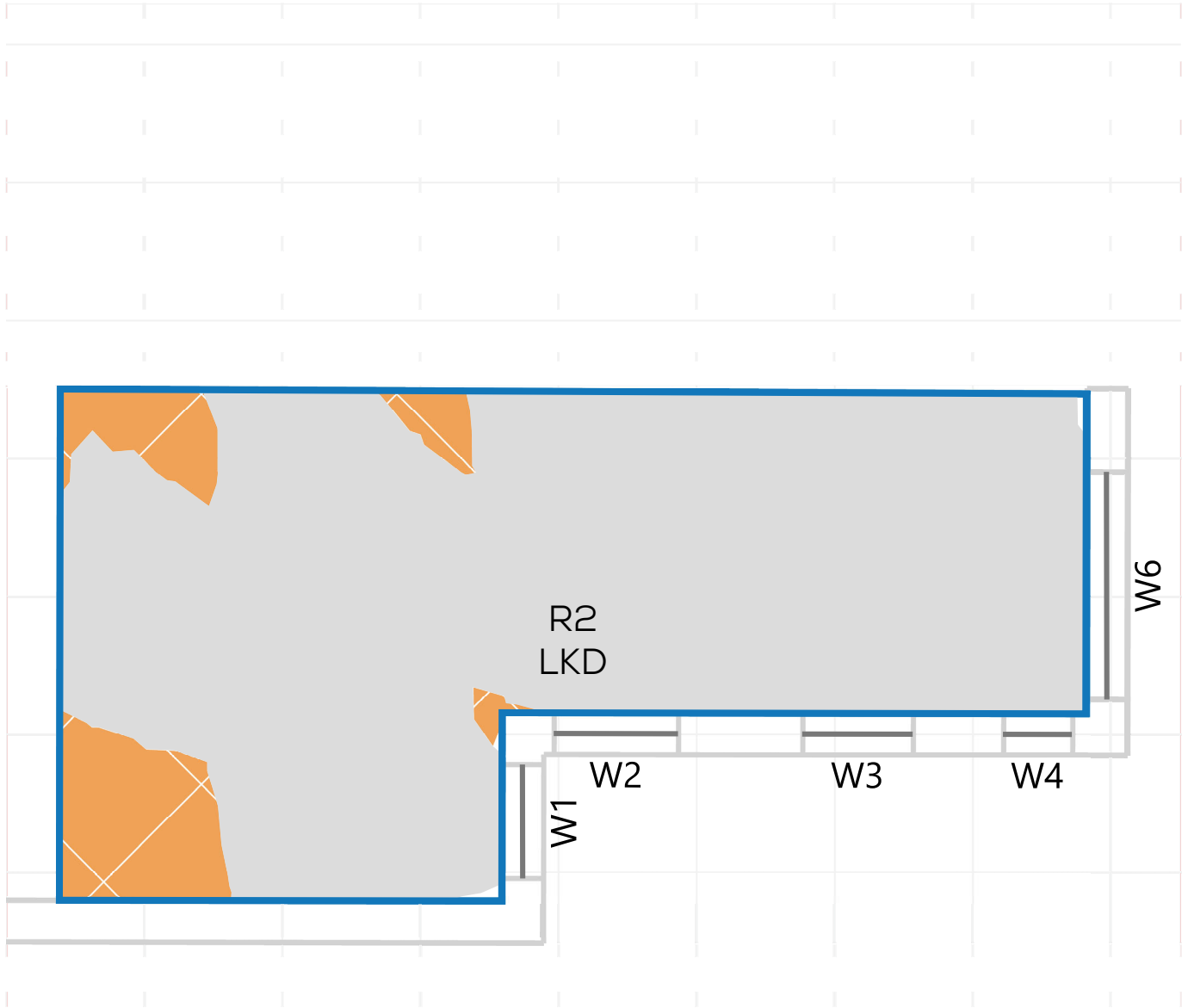
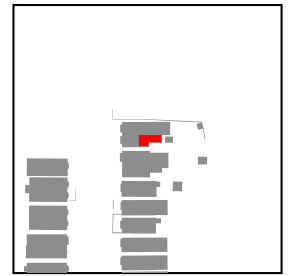

PROJECT: 14047 - CAMBRIDGE ROAD  
REPORT TITLE: EXISTING VS. PROPOSED  
ADDRESS: 13 PIPER ROAD  
DATE: 07/01/2021  
SCHEME IR: IR23 (07.09.2020)  
DRAWING No.: 14047-REL13-IS02-DD5

**KEY:**

- GAIN
- LOSS
- MAINTAINED LIT AREA
- 1 METRE GRID

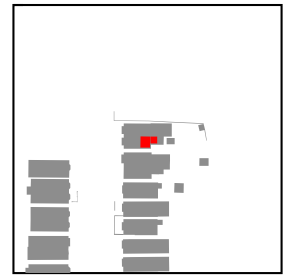





# NSL CONTOURS



PROJECT: 14047 - CAMBRIDGE ROAD  
REPORT TITLE: EXISTING VS. PROPOSED  
ADDRESS: 27 PIPER ROAD  
DATE: 02/10/2020  
SCHEME IR: IR23 (07.09.2020)  
DRAWING No.: 14047-RELO6-IS02-DD432

## KEY:

-  GAIN
-  LOSS
-  MAINTAINED LIT AREA
-  1 METRE GRID

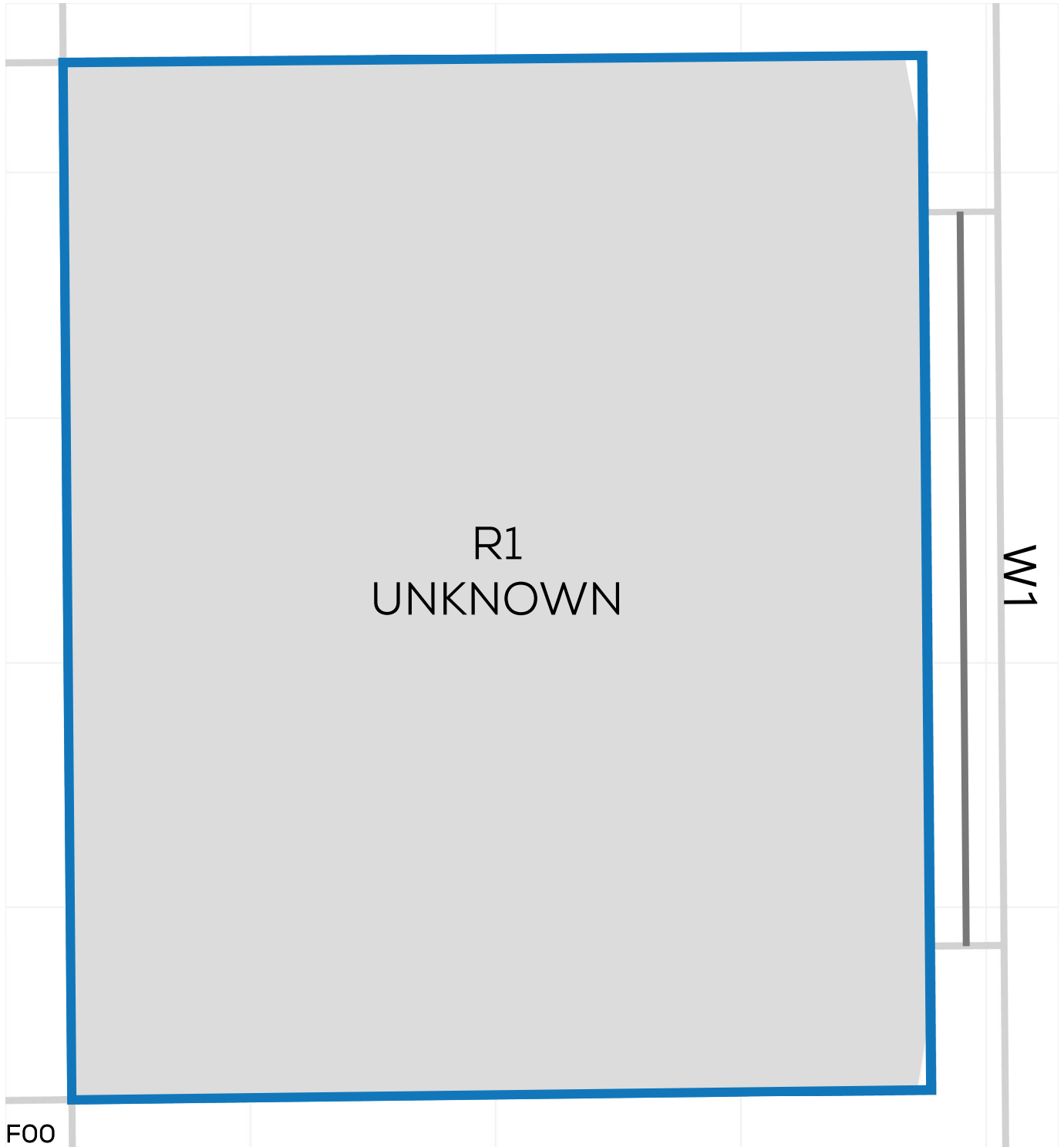

# NSL CONTOURS



PROJECT: 14047 - CAMBRIDGE ROAD  
REPORT TITLE: EXISTING VS. PROPOSED  
ADDRESS: 27 PIPER ROAD  
DATE: 02/10/2020  
SCHEME IR: IR23 (07.09.2020)  
DRAWING No.: 14047-RELO6-IS02-DD433

## KEY:

- GAIN
- LOSS
- MAINTAINED LIT AREA
- 1 METRE GRID

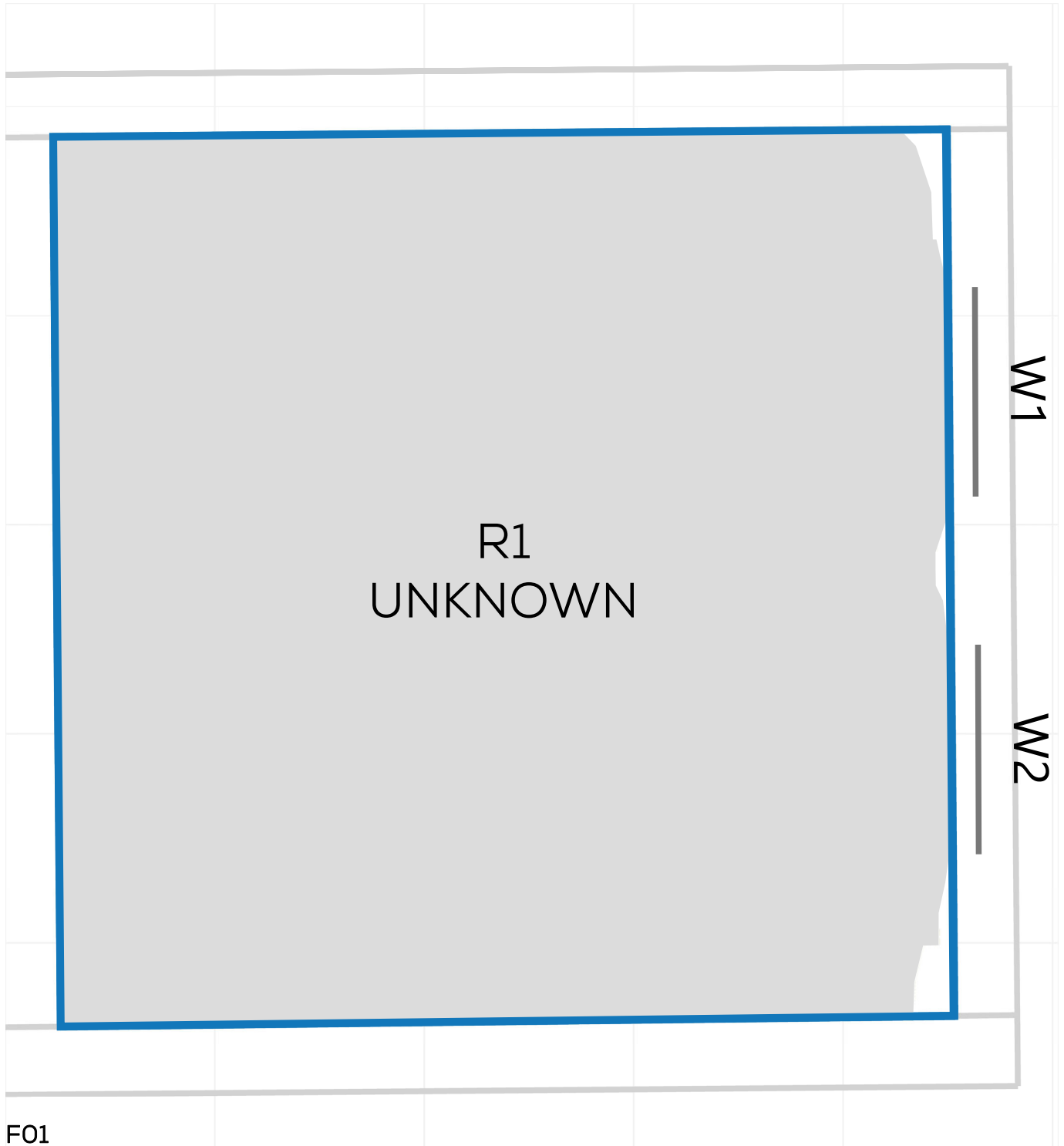

# NSL CONTOURS



PROJECT: 14047 - CAMBRIDGE ROAD  
REPORT TITLE: EXISTING VS. PROPOSED  
ADDRESS: 27 PIPER ROAD  
DATE: 02/10/2020  
SCHEME IR: IR23 (07.09.2020)  
DRAWING No.: 14047-RELO6-IS02-DD434

### KEY:

- GAIN
- LOSS
- MAINTAINED LIT AREA
- 1 METRE GRID

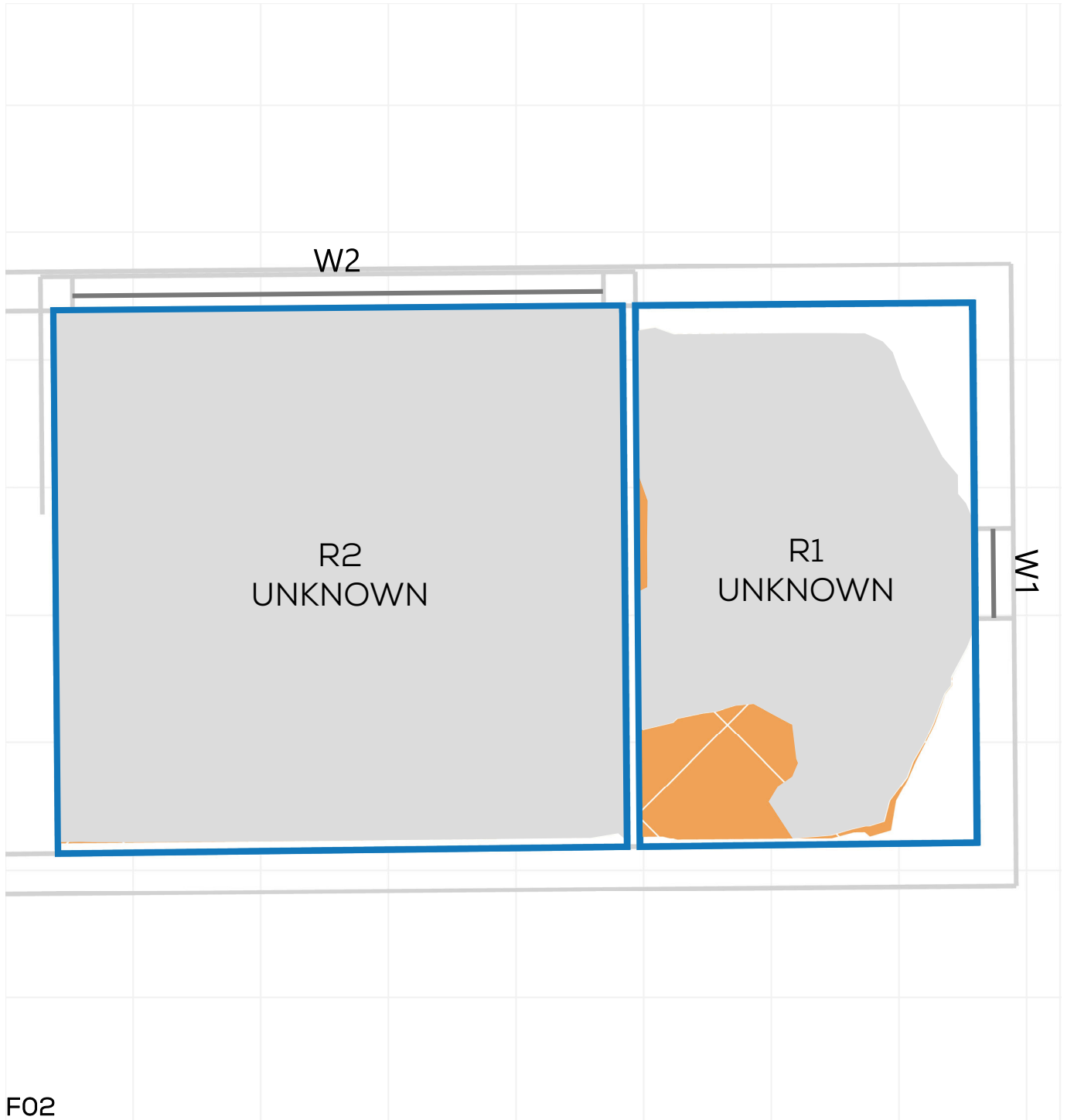

# NSL CONTOURS



PROJECT: 14047 - CAMBRIDGE ROAD  
REPORT TITLE: EXISTING VS. PROPOSED  
ADDRESS: 25 PIPER ROAD  
DATE: 02/10/2020  
SCHEME IR: IR23 (07.09.2020)  
DRAWING No.: 14047-RELO6-IS02-DD435

### KEY:

- GAIN
- LOSS
- MAINTAINED LIT AREA
- 1 METRE GRID

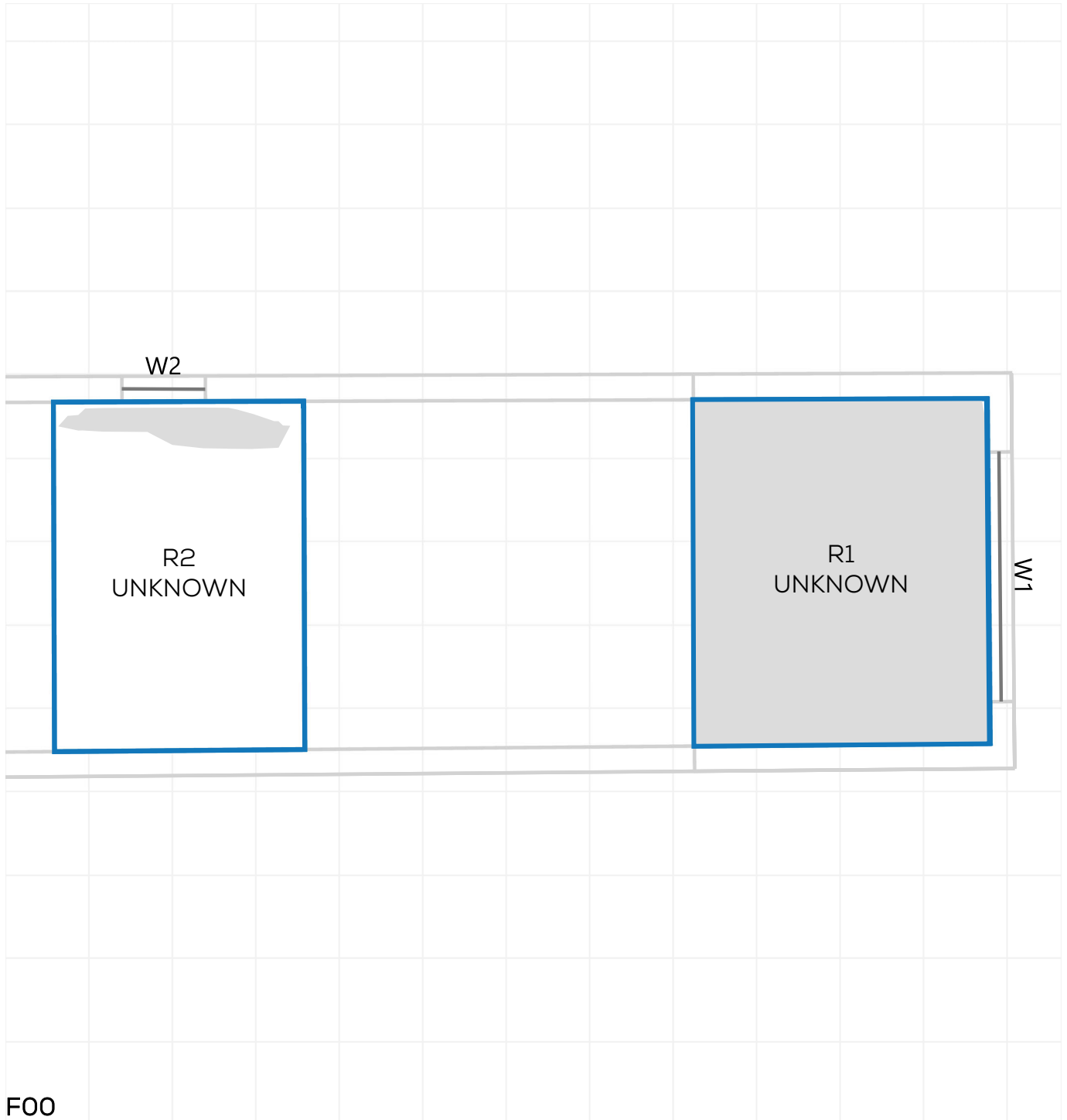

# NSL CONTOURS



PROJECT: 14047 - CAMBRIDGE ROAD  
REPORT TITLE: EXISTING VS. PROPOSED  
ADDRESS: 25 PIPER ROAD  
DATE: 02/10/2020  
SCHEME IR: IR23 (07.09.2020)  
DRAWING No.: 14047-RELO6-IS02-DD436

## KEY:

- GAIN
- LOSS
- MAINTAINED LIT AREA
- 1 METRE GRID

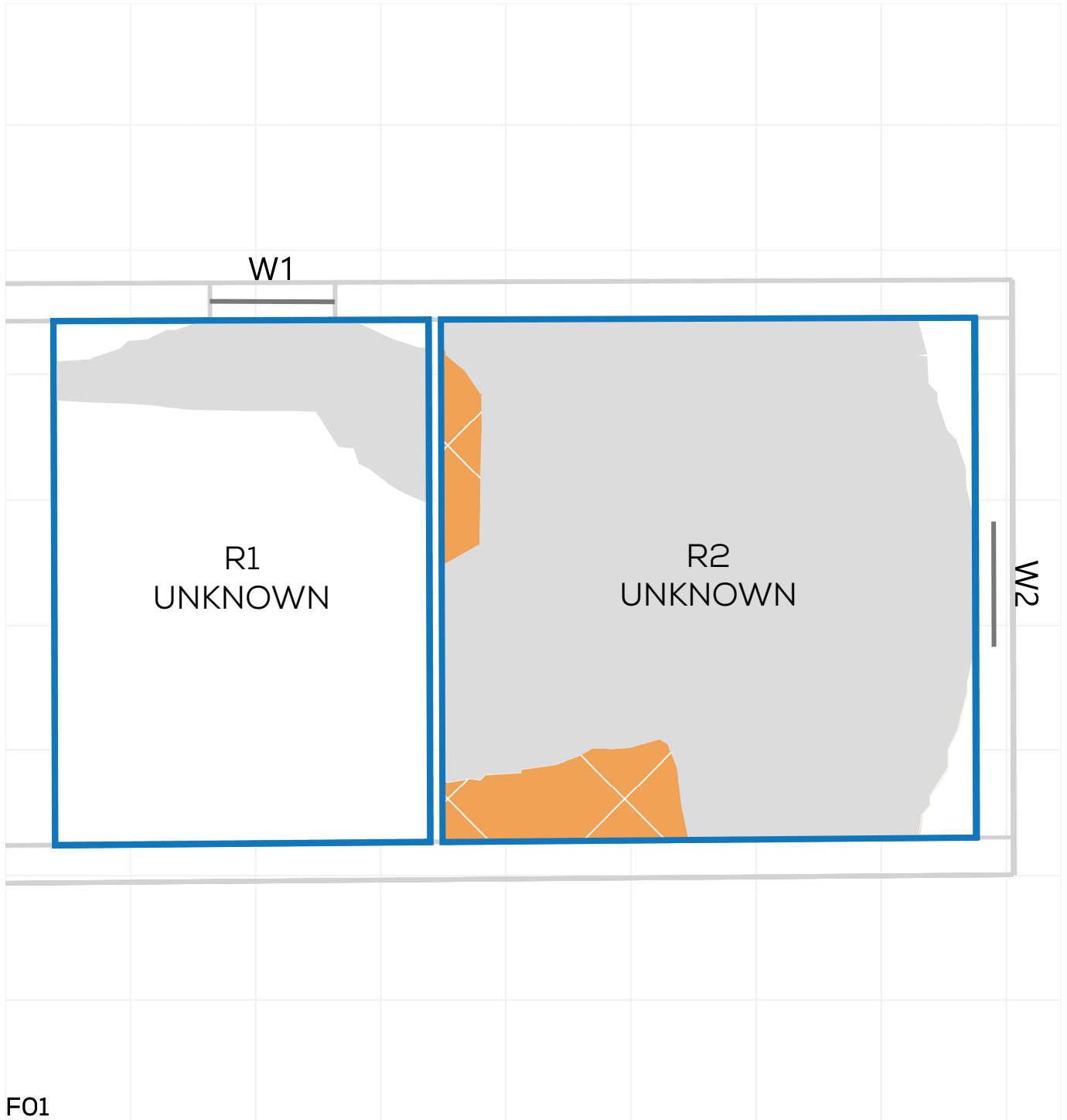
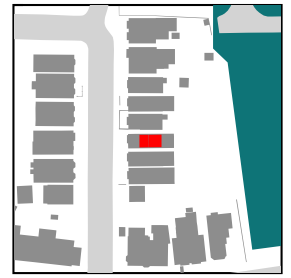

# NSL CONTOURS



PROJECT: 14047 - CAMBRIDGE ROAD  
REPORT TITLE: EXISTING VS. PROPOSED  
ADDRESS: 27A PIPER ROAD  
DATE: 02/10/2020  
SCHEME IR: IR23 (07.09.2020)  
DRAWING No.: 14047-RELO6-IS02-DD437

## KEY:

- GAIN
- LOSS
- MAINTAINED LIT AREA
- 1 METRE GRID

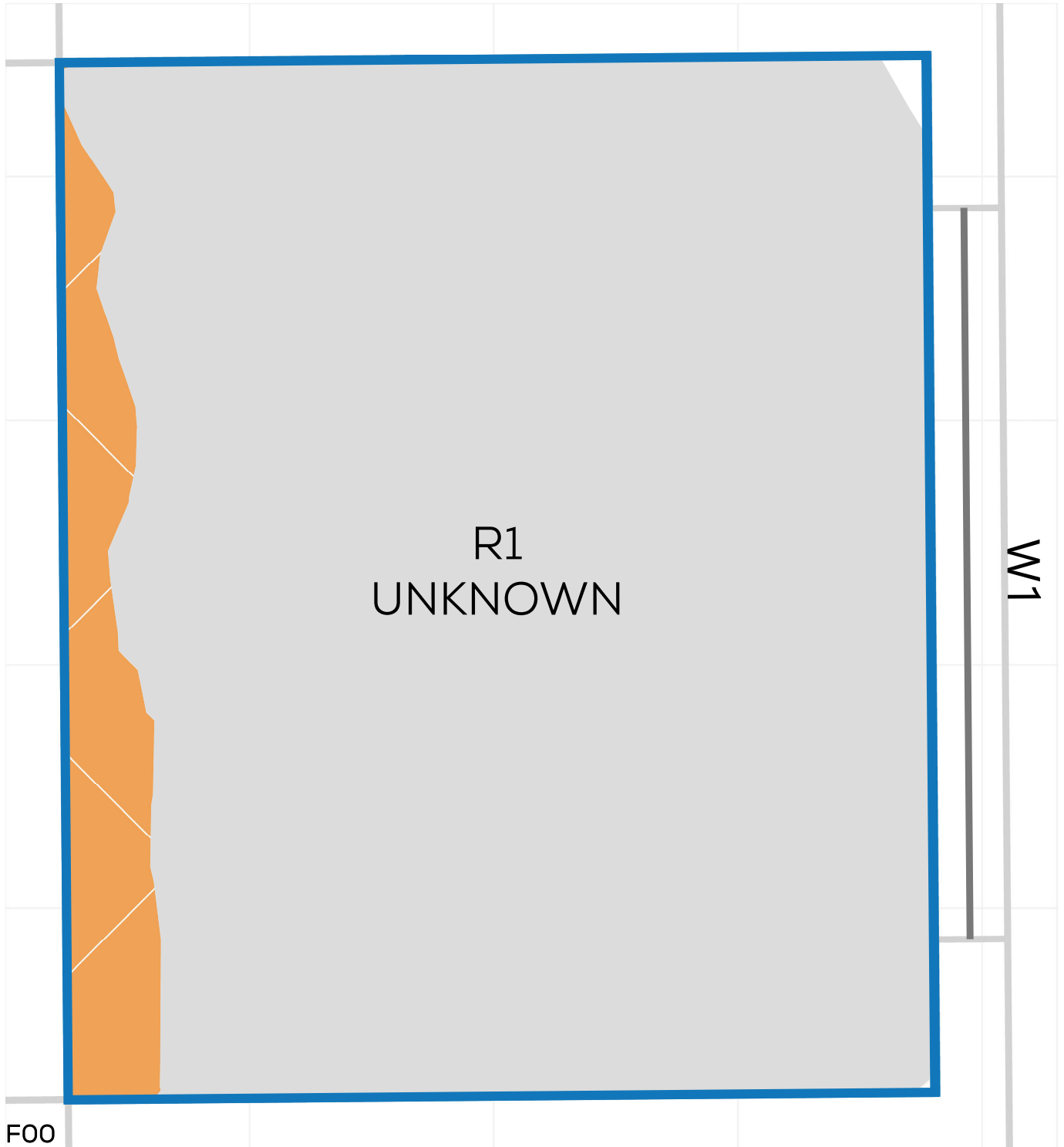



# NSL CONTOURS



PROJECT: 14047 - CAMBRIDGE ROAD  
REPORT TITLE: EXISTING VS. PROPOSED  
ADDRESS: 27A PIPER ROAD  
DATE: 02/10/2020  
SCHEME IR: IR23 (07.09.2020)  
DRAWING No.: 14047-RELO6-IS02-DD438

**KEY:**

- GAIN
- LOSS
- MAINTAINED LIT AREA
- 1 METRE GRID

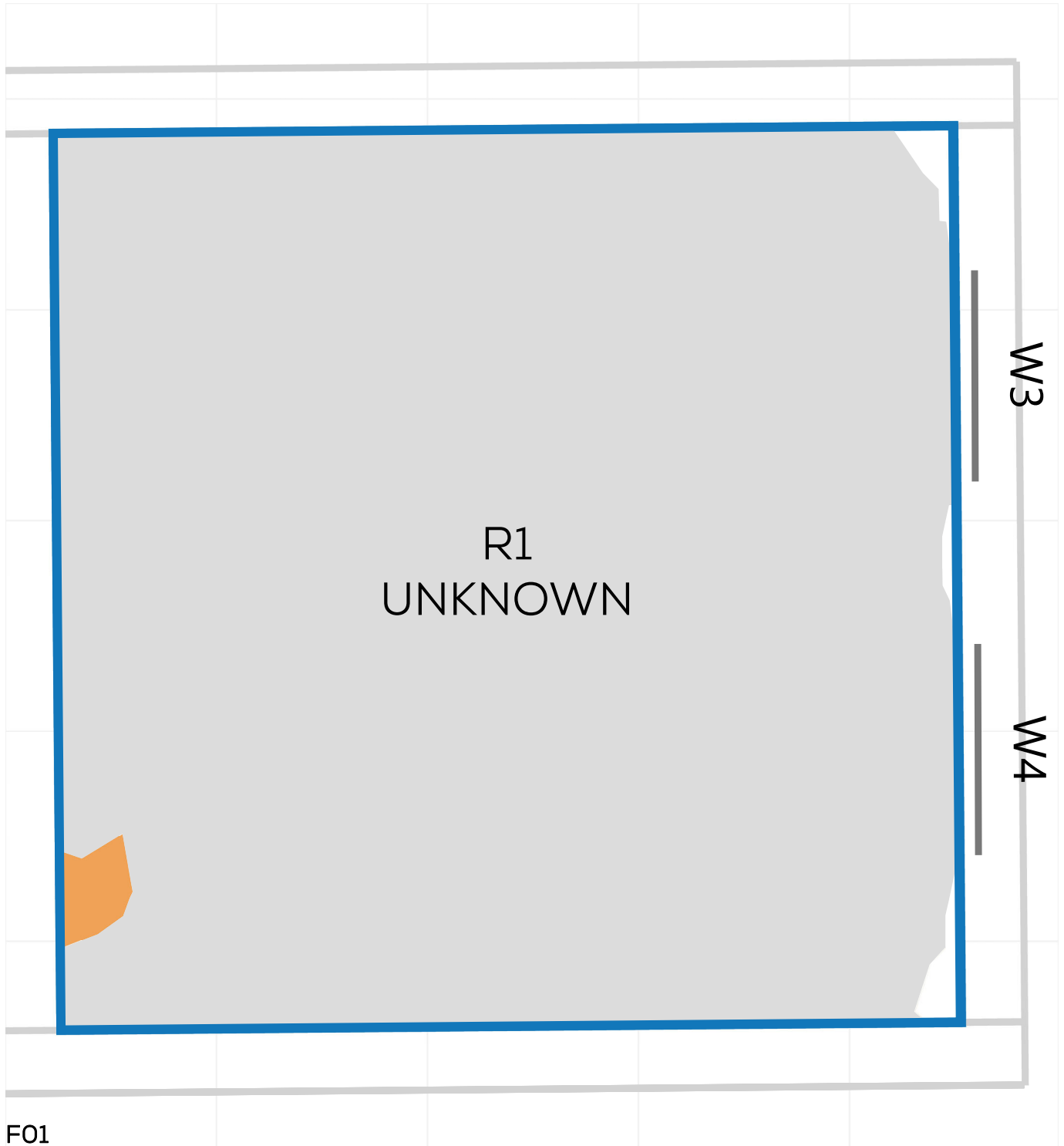

# NSL CONTOURS



PROJECT: 14047 - CAMBRIDGE ROAD  
REPORT TITLE: EXISTING VS. PROPOSED  
ADDRESS: 27A PIPER ROAD  
DATE: 02/10/2020  
SCHEME IR: IR23 (07.09.2020)  
DRAWING No.: 14047-RELO6-IS02-DD439

### KEY:

- GAIN
- LOSS
- MAINTAINED LIT AREA
- 1 METRE GRID

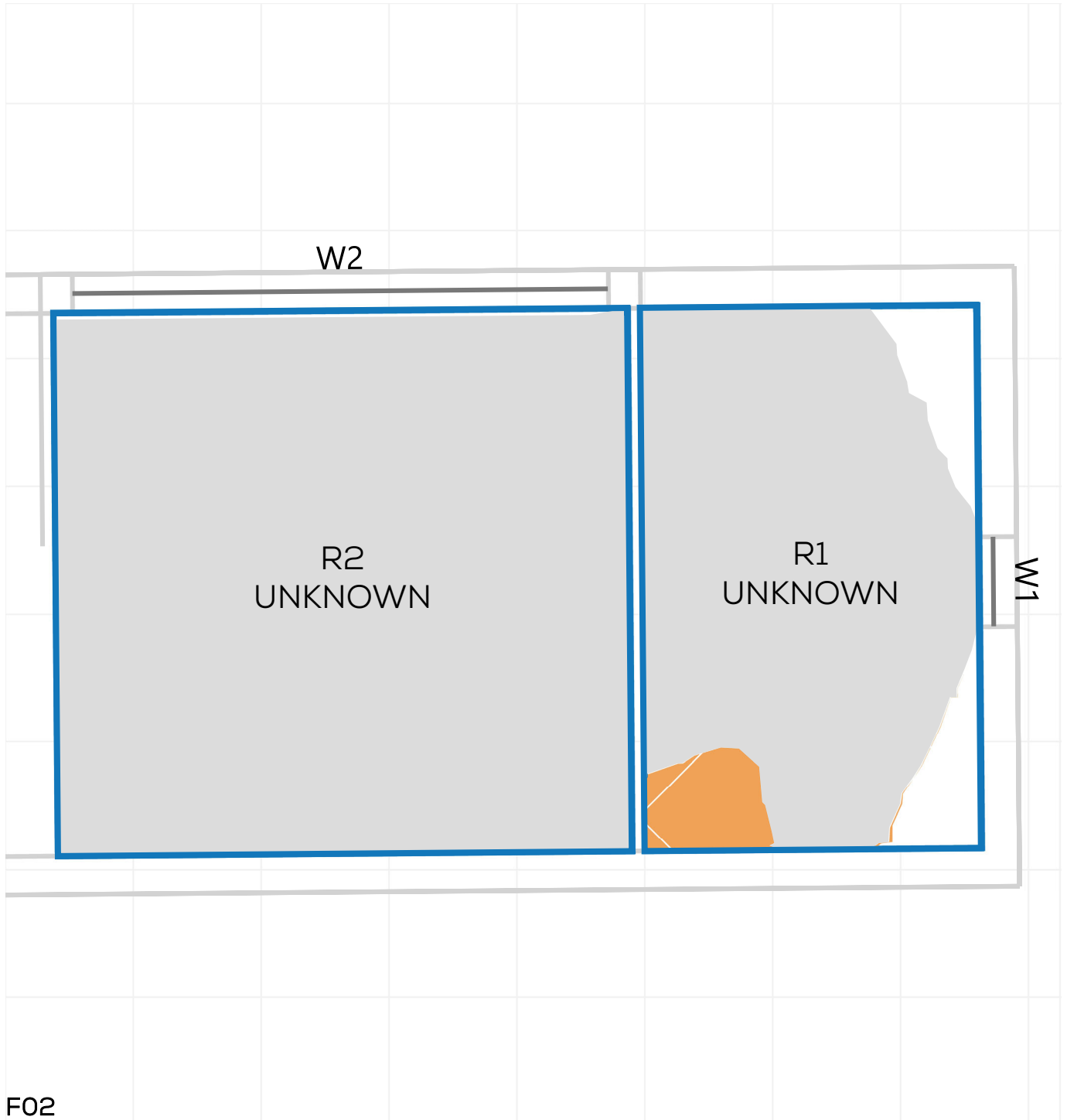

# NSL CONTOURS



PROJECT: 14047 - CAMBRIDGE ROAD  
REPORT TITLE: EXISTING VS. PROPOSED  
ADDRESS: 87 BONNER HILL ROAD  
DATE: 02/10/2020  
SCHEME IR: IR23 (07.09.2020)  
DRAWING No.: 14047-RELO6-IS02-DD440

## KEY:

- GAIN
- LOSS
- MAINTAINED LIT AREA
- 1 METRE GRID

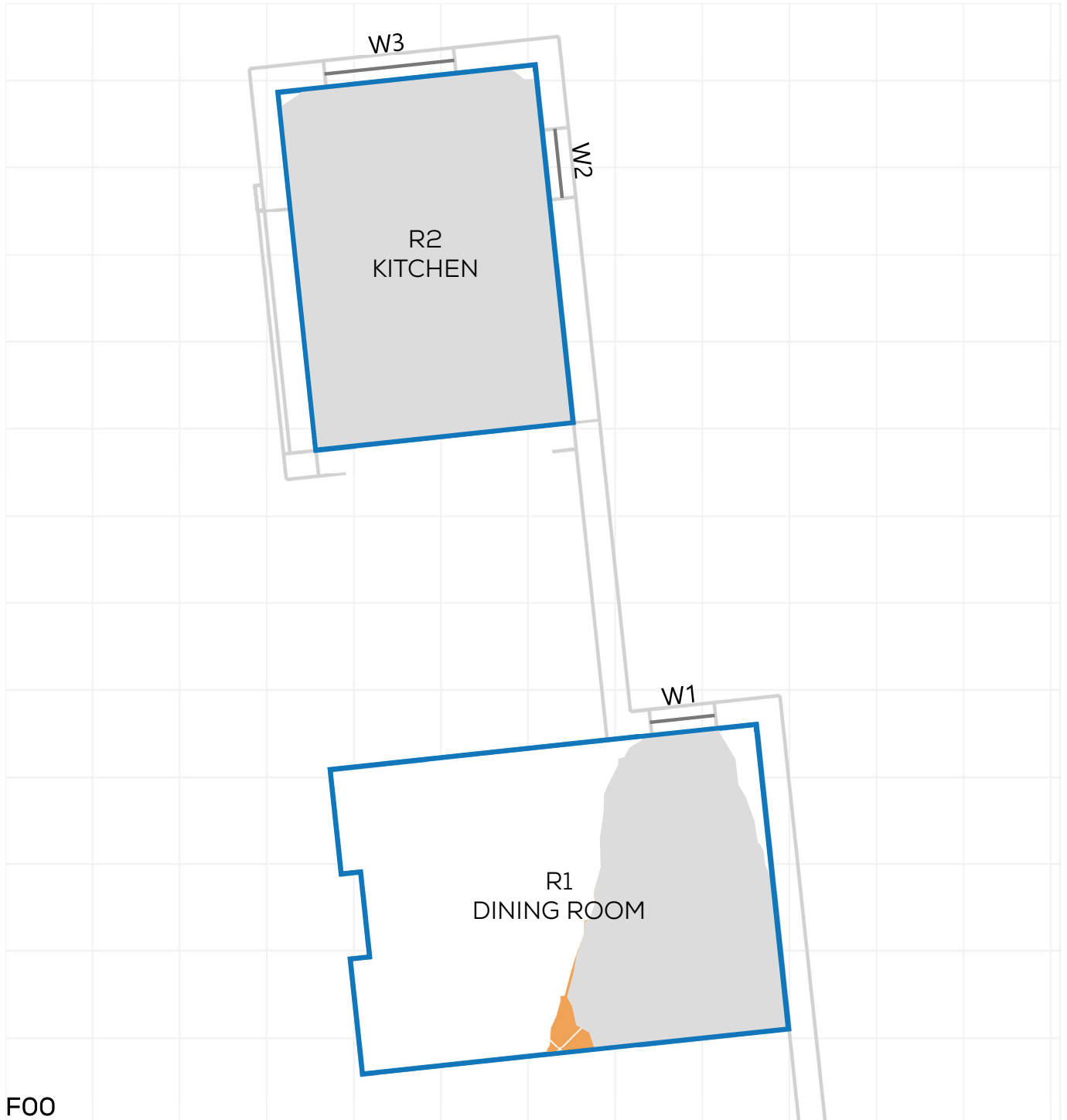

# NSL CONTOURS



PROJECT: 14047 - CAMBRIDGE ROAD  
REPORT TITLE: EXISTING VS. PROPOSED  
ADDRESS: 87 BONNER HILL ROAD  
DATE: 02/10/2020  
SCHEME IR: IR23 (07.09.2020)  
DRAWING No.: 14047-RELO6-IS02-DD441

## KEY:

- GAIN
- LOSS
- MAINTAINED LIT AREA
- 1 METRE GRID

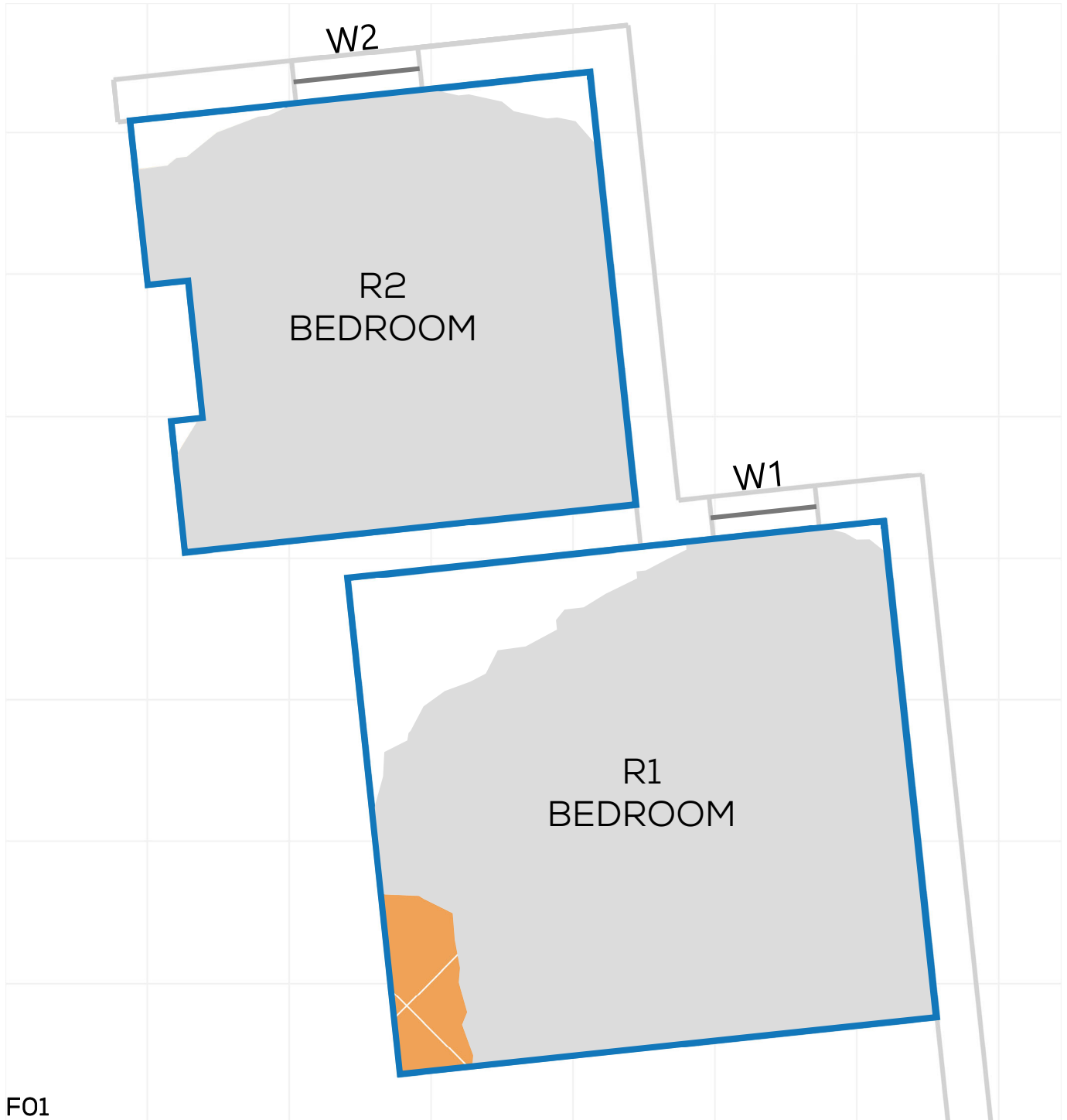

F01

# NSL CONTOURS



PROJECT: 14047 - CAMBRIDGE ROAD  
REPORT TITLE: EXISTING VS. PROPOSED  
ADDRESS: 85 BONNER HILL ROAD  
DATE: 02/10/2020  
SCHEME IR: IR23 (07.09.2020)  
DRAWING No.: 14047-RELO6-IS02-DD442

### KEY:

- GAIN
- LOSS
- MAINTAINED LIT AREA
- 1 METRE GRID



# NSL CONTOURS



PROJECT: 14047 - CAMBRIDGE ROAD  
REPORT TITLE: EXISTING VS. PROPOSED  
ADDRESS: 85 BONNER HILL ROAD  
DATE: 02/10/2020  
SCHEME IR: IR23 (07.09.2020)  
DRAWING No.: 14047-RELO6-IS02-DD443

## KEY:

- GAIN
- LOSS
- MAINTAINED LIT AREA
- 1 METRE GRID



F01