

PROJECT: 14047 - CAMBRIDGE ROAD
REPORT TITLE: EXISTING VS. PROPOSED
ADDRESS: 62 VINCENT ROAD
DATE: 02/10/2020
SCHEME IR: IR23 (07.09.2020)
DRAWING No.: 14047-RELO6-IS02-DD337

KEY:

- GAIN
- LOSS
- MAINTAINED LIT AREA
- 1 METRE GRID

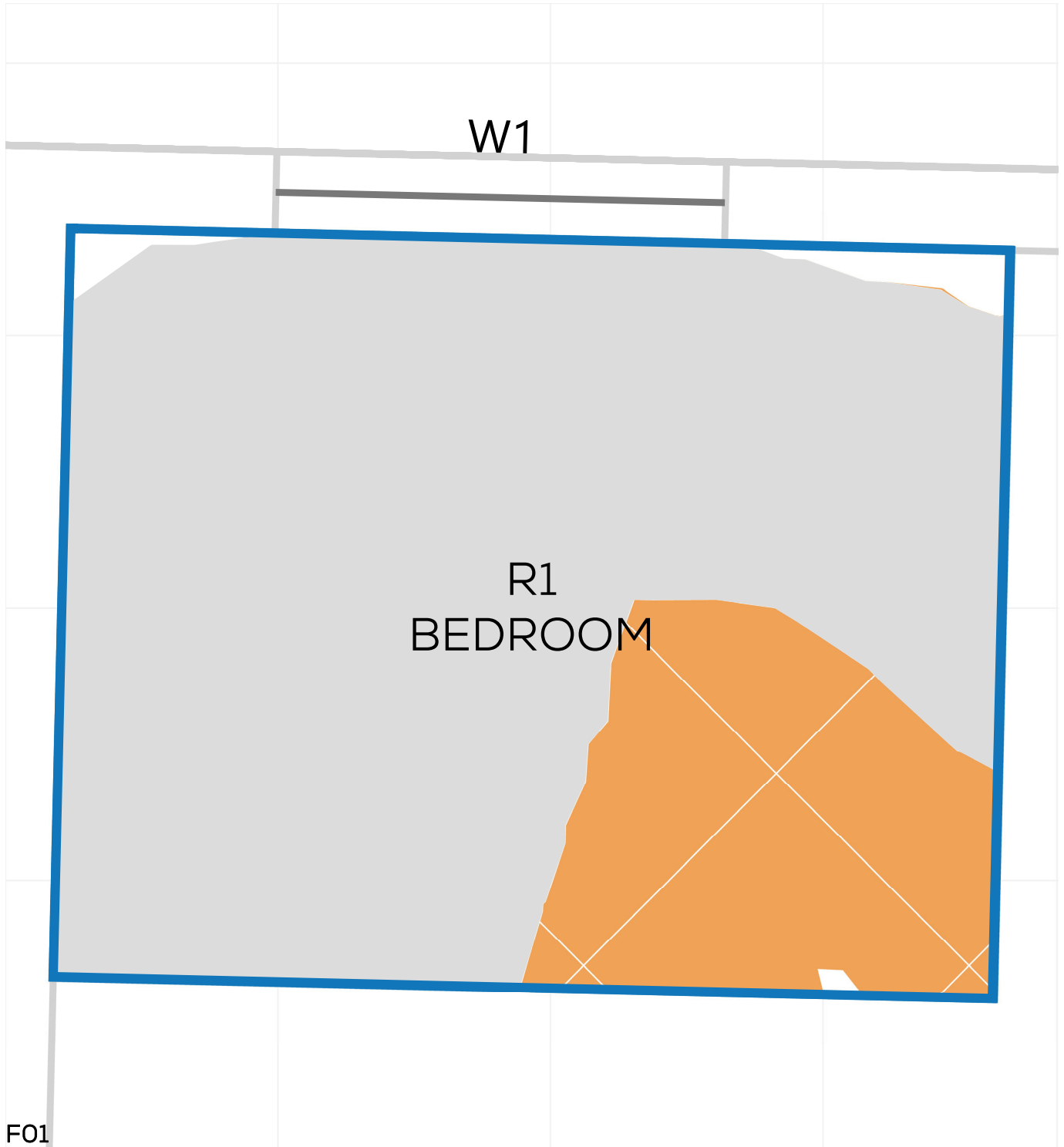

PROJECT: 14047 - CAMBRIDGE ROAD
REPORT TITLE: EXISTING VS. PROPOSED
ADDRESS: 64 VINCENT ROAD
DATE: 02/10/2020
SCHEME IR: IR23 (07.09.2020)
DRAWING No.: 14047-RELO6-IS02-DD338

KEY:

- GAIN
- LOSS
- MAINTAINED LIT AREA
- 1 METRE GRID

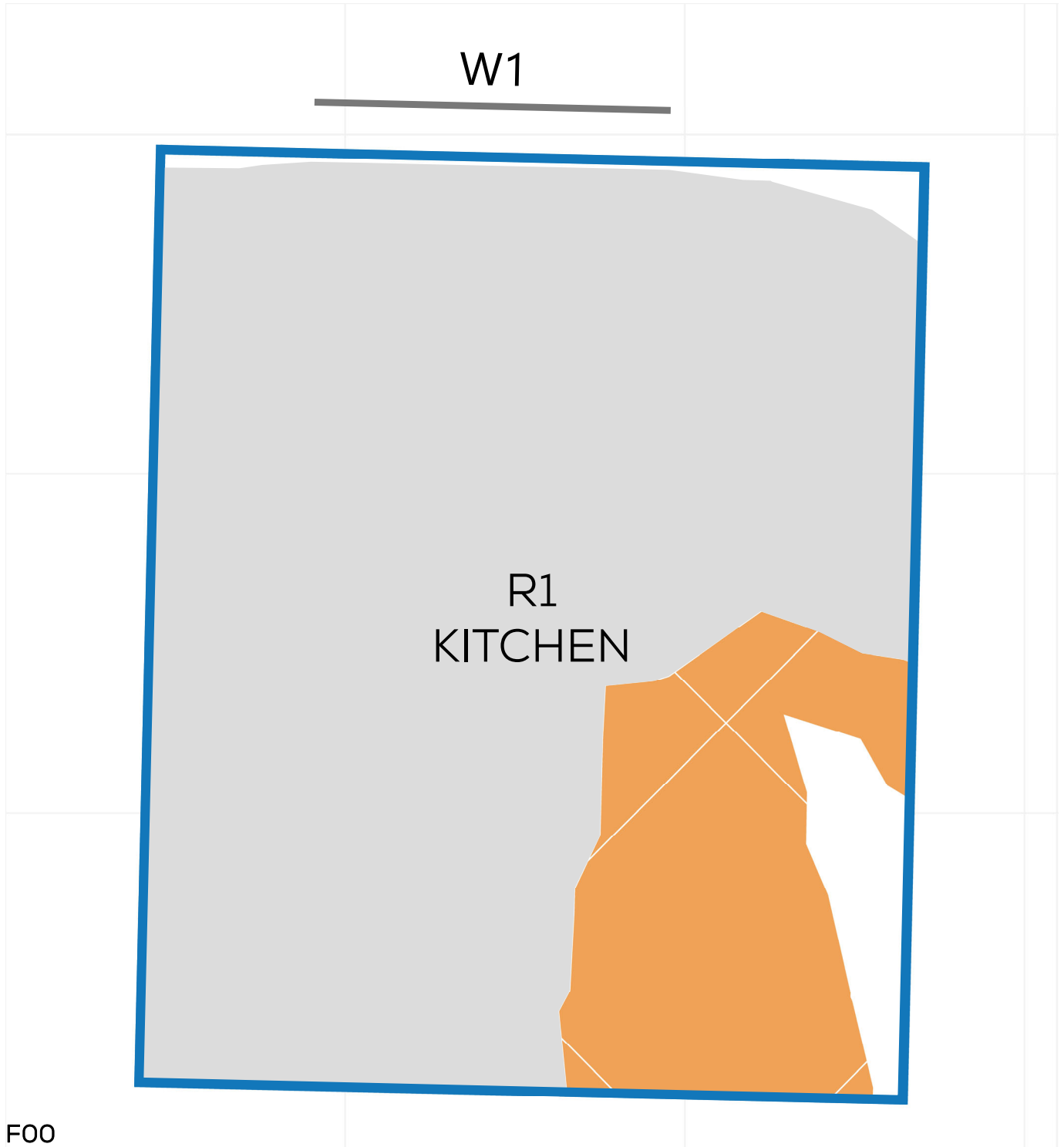
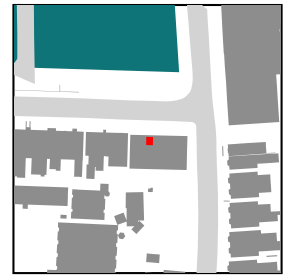

PROJECT: 14047 - CAMBRIDGE ROAD
REPORT TITLE: EXISTING VS. PROPOSED
ADDRESS: 64 VINCENT ROAD
DATE: 02/10/2020
SCHEME IR: IR23 (07.09.2020)
DRAWING No.: 14047-RELO6-IS02-DD339

KEY:

- GAIN
- LOSS
- MAINTAINED LIT AREA
- 1 METRE GRID

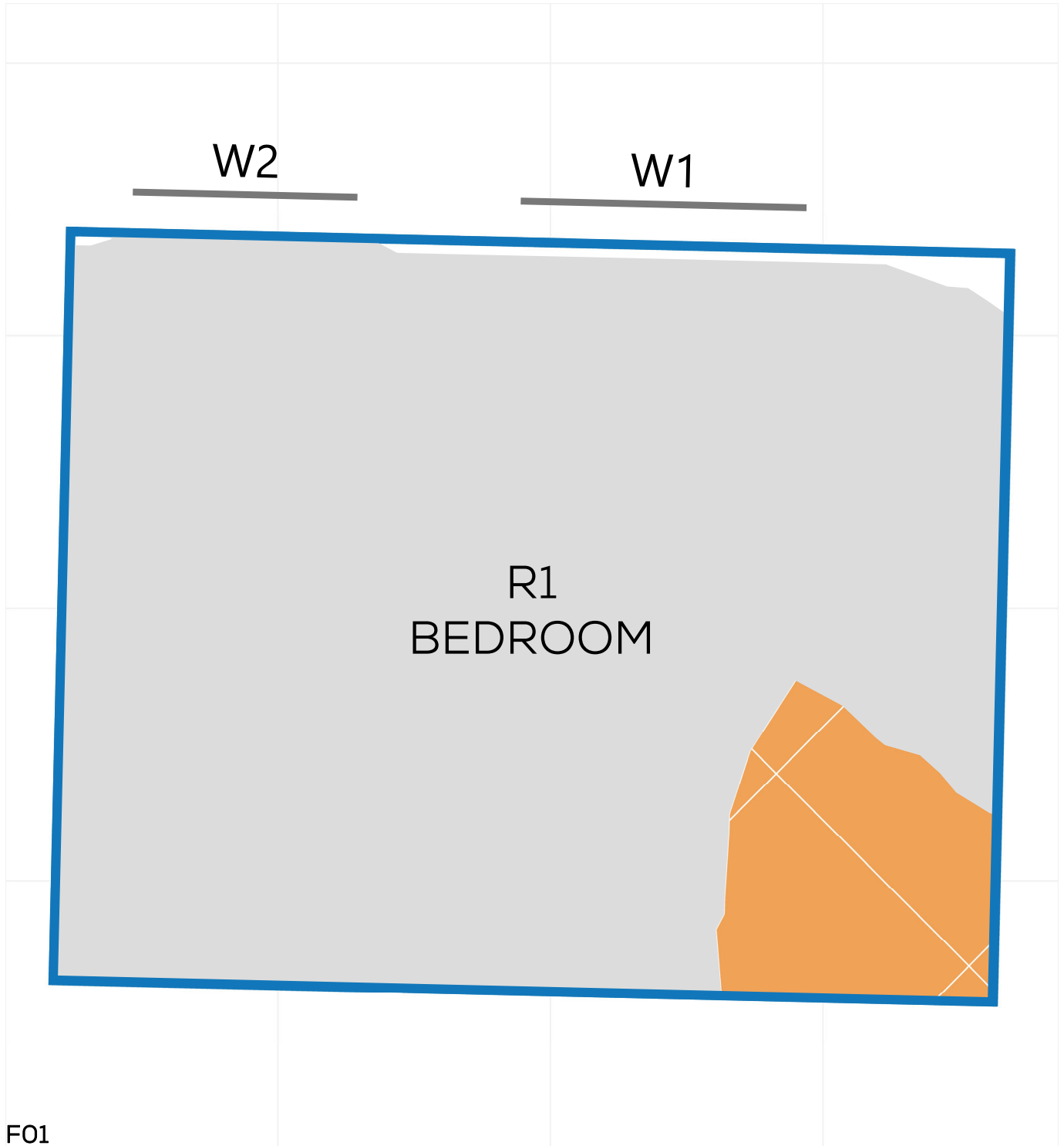

PROJECT: 14047 - CAMBRIDGE ROAD
REPORT TITLE: EXISTING VS. PROPOSED
ADDRESS: 66 VINCENT ROAD
DATE: 02/10/2020
SCHEME IR: IR23 (07.09.2020)
DRAWING No.: 14047-RELO6-IS02-DD340

KEY:

- GAIN
- LOSS
- MAINTAINED LIT AREA
- 1 METRE GRID

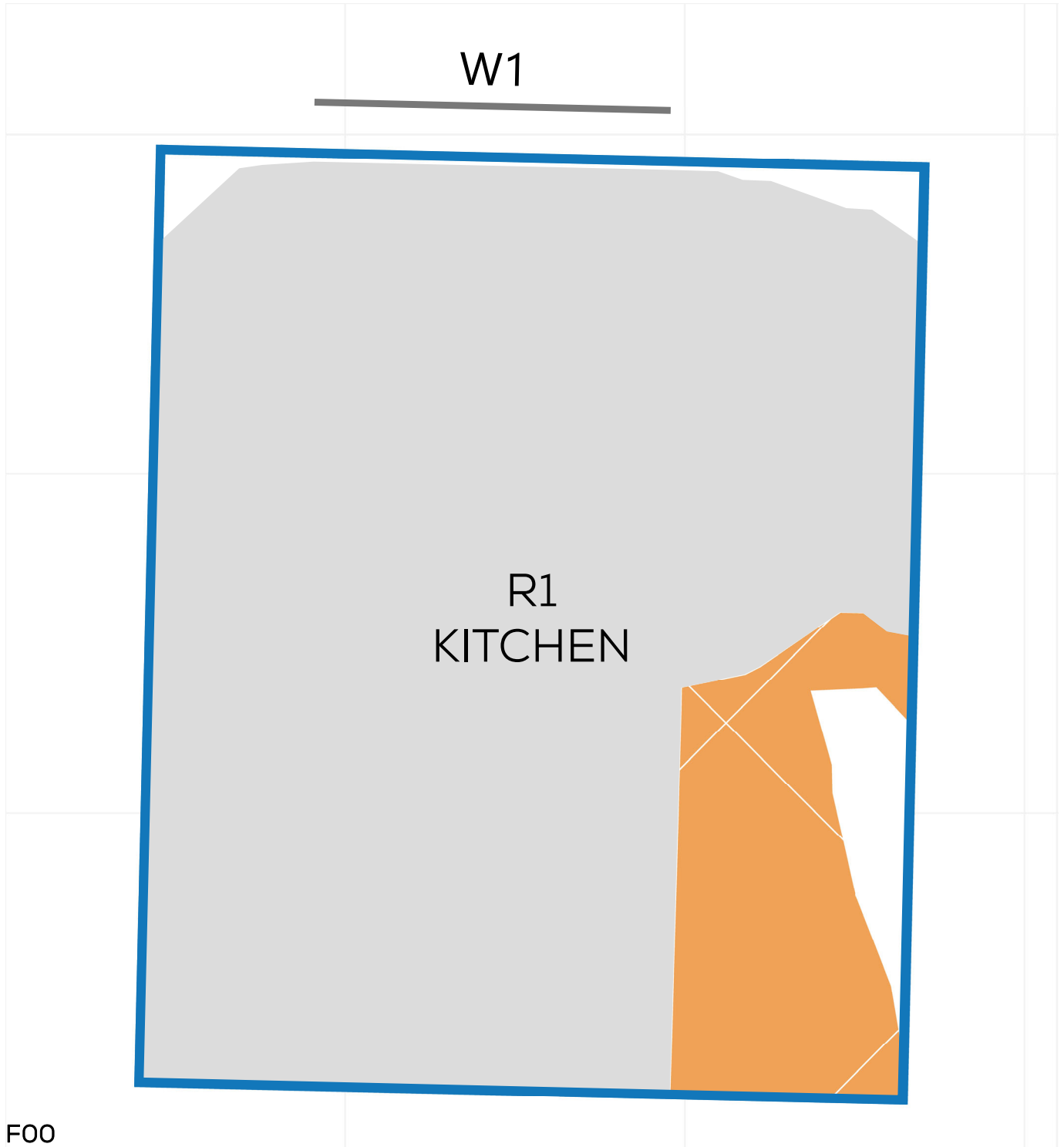
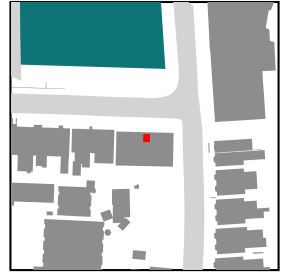

PROJECT: 14047 - CAMBRIDGE ROAD
REPORT TITLE: EXISTING VS. PROPOSED
ADDRESS: 66 VINCENT ROAD
DATE: 02/10/2020
SCHEME IR: IR23 (07.09.2020)
DRAWING No.: 14047-RELO6-IS02-DD341

KEY:

- GAIN
- LOSS
- MAINTAINED LIT AREA
- 1 METRE GRID

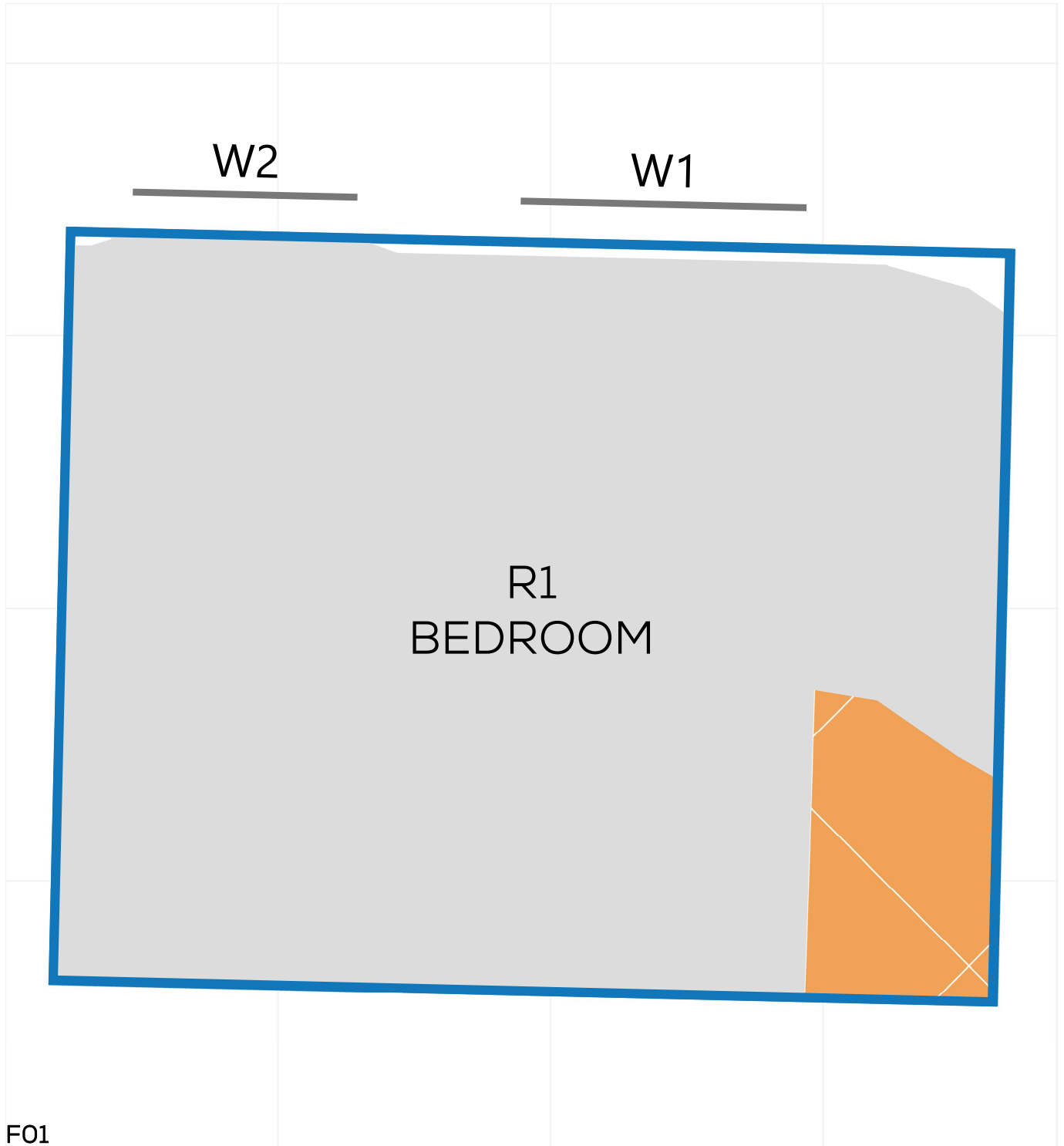

NSL CONTOURS



PROJECT: 14047 - CAMBRIDGE ROAD
REPORT TITLE: EXISTING VS. PROPOSED
ADDRESS: 13 PORTMAN ROAD
DATE: 02/10/2020
SCHEME IR: IR23 (07.09.2020)
DRAWING No.: 14047-RELO6-IS02-DD342

KEY:

- GAIN
- LOSS
- MAINTAINED LIT AREA
- 1 METRE GRID



F00

NSL CONTOURS



PROJECT: 14047 - CAMBRIDGE ROAD
REPORT TITLE: EXISTING VS. PROPOSED
ADDRESS: 17 PORTMAN ROAD
DATE: 02/10/2020
SCHEME IR: IR23 (07.09.2020)
DRAWING No.: 14047-RELO6-IS02-DD344

KEY:

- GAIN
- LOSS
- MAINTAINED LIT AREA
- 1 METRE GRID



NSL CONTOURS



PROJECT: 14047 - CAMBRIDGE ROAD
REPORT TITLE: EXISTING VS. PROPOSED
ADDRESS: 17 PORTMAN ROAD
DATE: 02/10/2020
SCHEME IR: IR23 (07.09.2020)
DRAWING No.: 14047-RELO6-IS02-DD345

KEY:

- GAIN
- LOSS
- MAINTAINED LIT AREA
- 1 METRE GRID

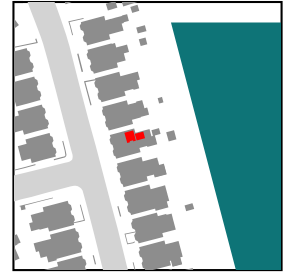

F01

NSL CONTOURS



PROJECT: 14047 - CAMBRIDGE ROAD
REPORT TITLE: EXISTING VS. PROPOSED
ADDRESS: 25 PORTMAN ROAD
DATE: 02/10/2020
SCHEME IR: IR23 (07.09.2020)
DRAWING No.: 14047-RELO6-IS02-DD346

KEY:

- GAIN
- LOSS
- MAINTAINED LIT AREA
- 1 METRE GRID



NSL CONTOURS



PROJECT: 14047 - CAMBRIDGE ROAD
REPORT TITLE: EXISTING VS. PROPOSED
ADDRESS: 25 PORTMAN ROAD
DATE: 02/10/2020
SCHEME IR: IR23 (07.09.2020)
DRAWING No.: 14047-RELO6-IS02-DD347

KEY:

- GAIN
- LOSS
- MAINTAINED LIT AREA
- 1 METRE GRID

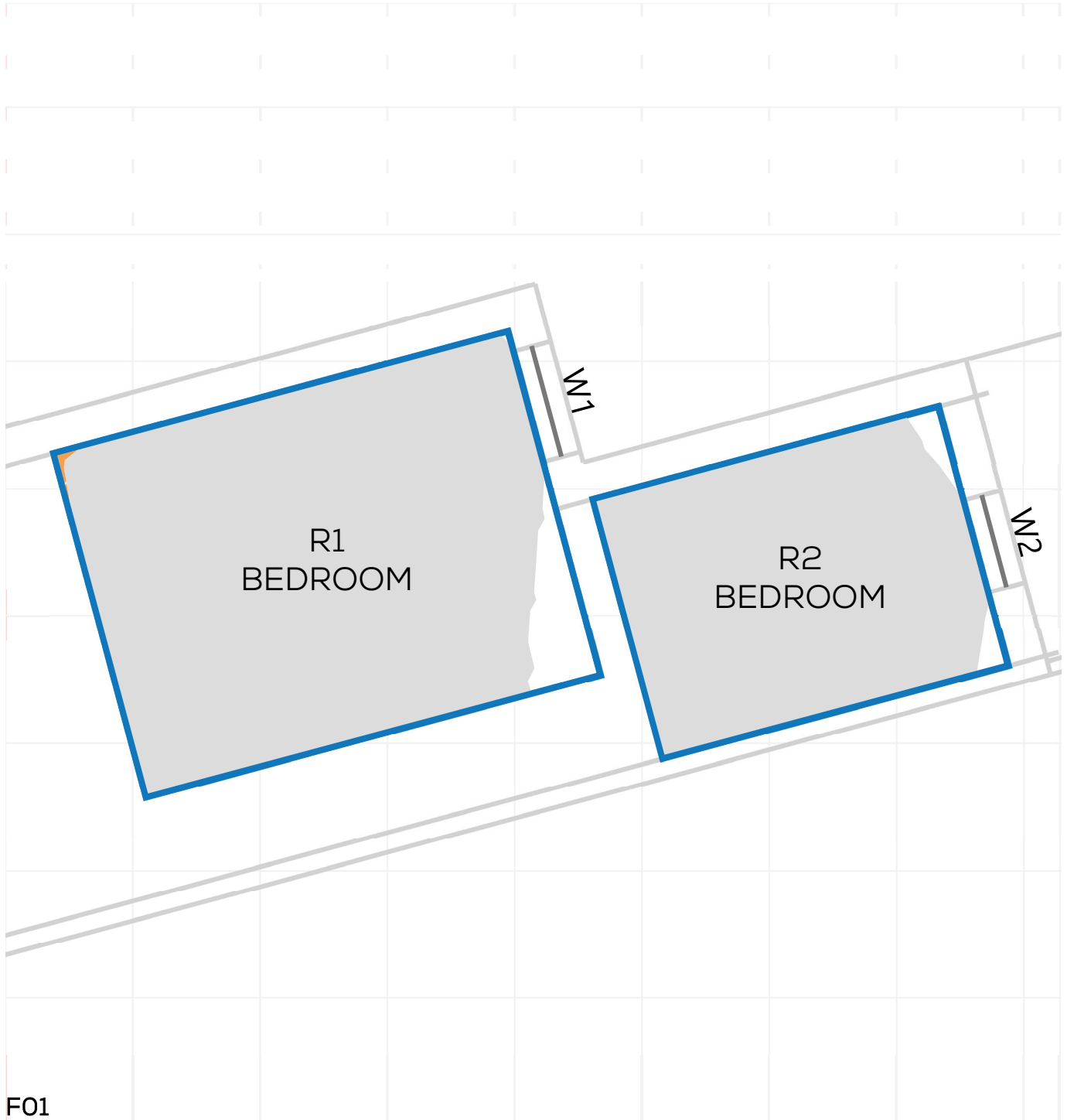
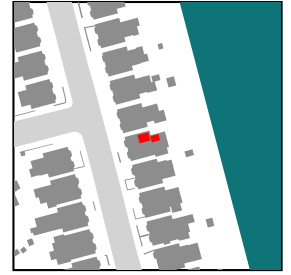

NSL CONTOURS



PROJECT: 14047 - CAMBRIDGE ROAD
REPORT TITLE: EXISTING VS. PROPOSED
ADDRESS: 33 PORTMAN ROAD
DATE: 02/10/2020
SCHEME IR: IR23 (07.09.2020)
DRAWING No.: 14047-RELO6-IS02-DD348

KEY:

- GAIN
- LOSS
- MAINTAINED LIT AREA
- 1 METRE GRID

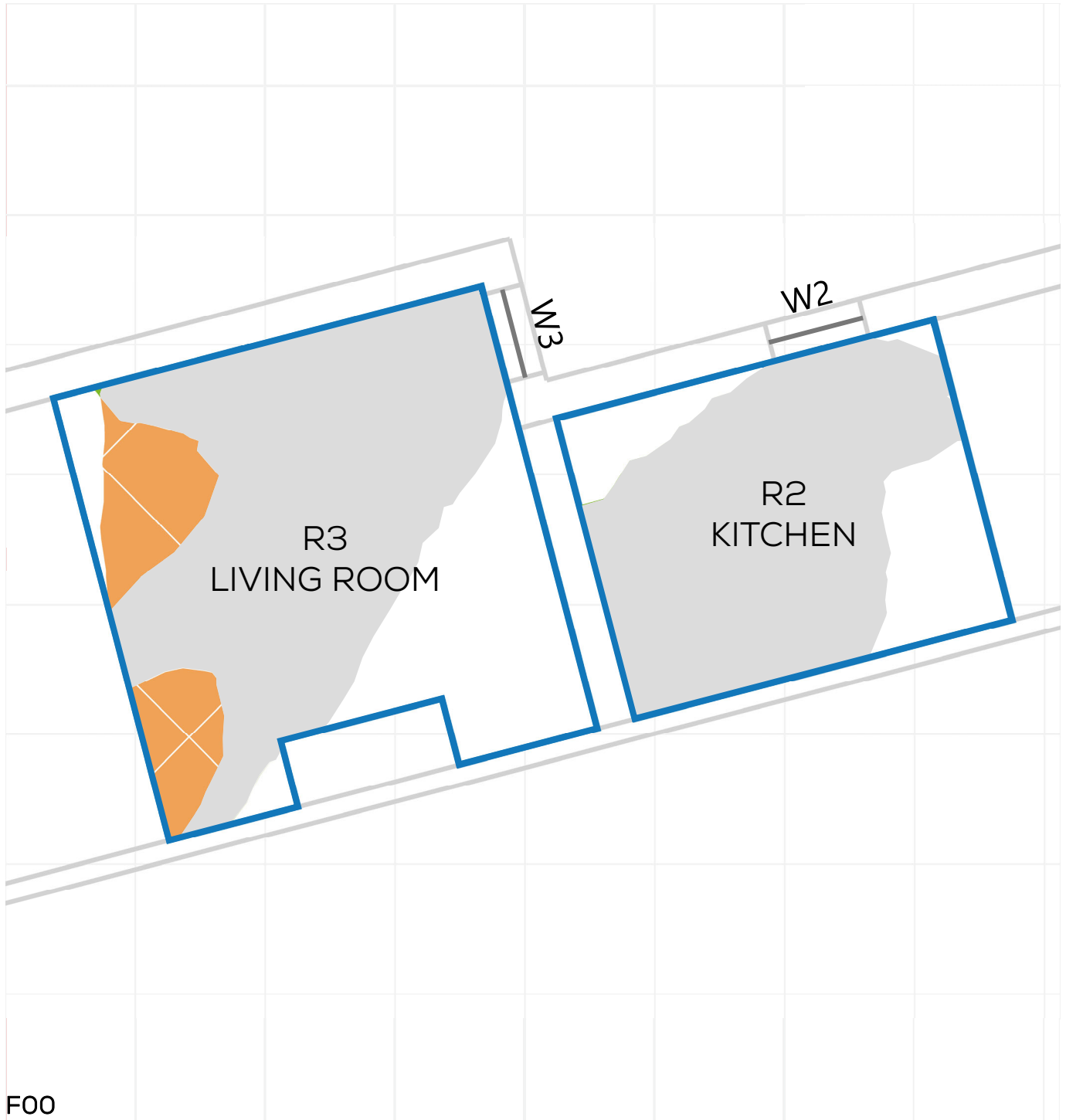
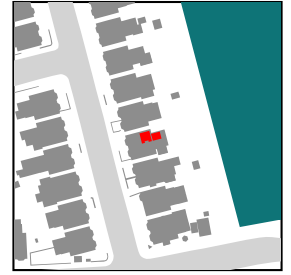

NSL CONTOURS



PROJECT: 14047 - CAMBRIDGE ROAD
REPORT TITLE: EXISTING VS. PROPOSED
ADDRESS: 33 PORTMAN ROAD
DATE: 02/10/2020
SCHEME IR: IR23 (07.09.2020)
DRAWING No.: 14047-RELO6-IS02-DD349

KEY:

- GAIN
- LOSS
- MAINTAINED LIT AREA
- 1 METRE GRID

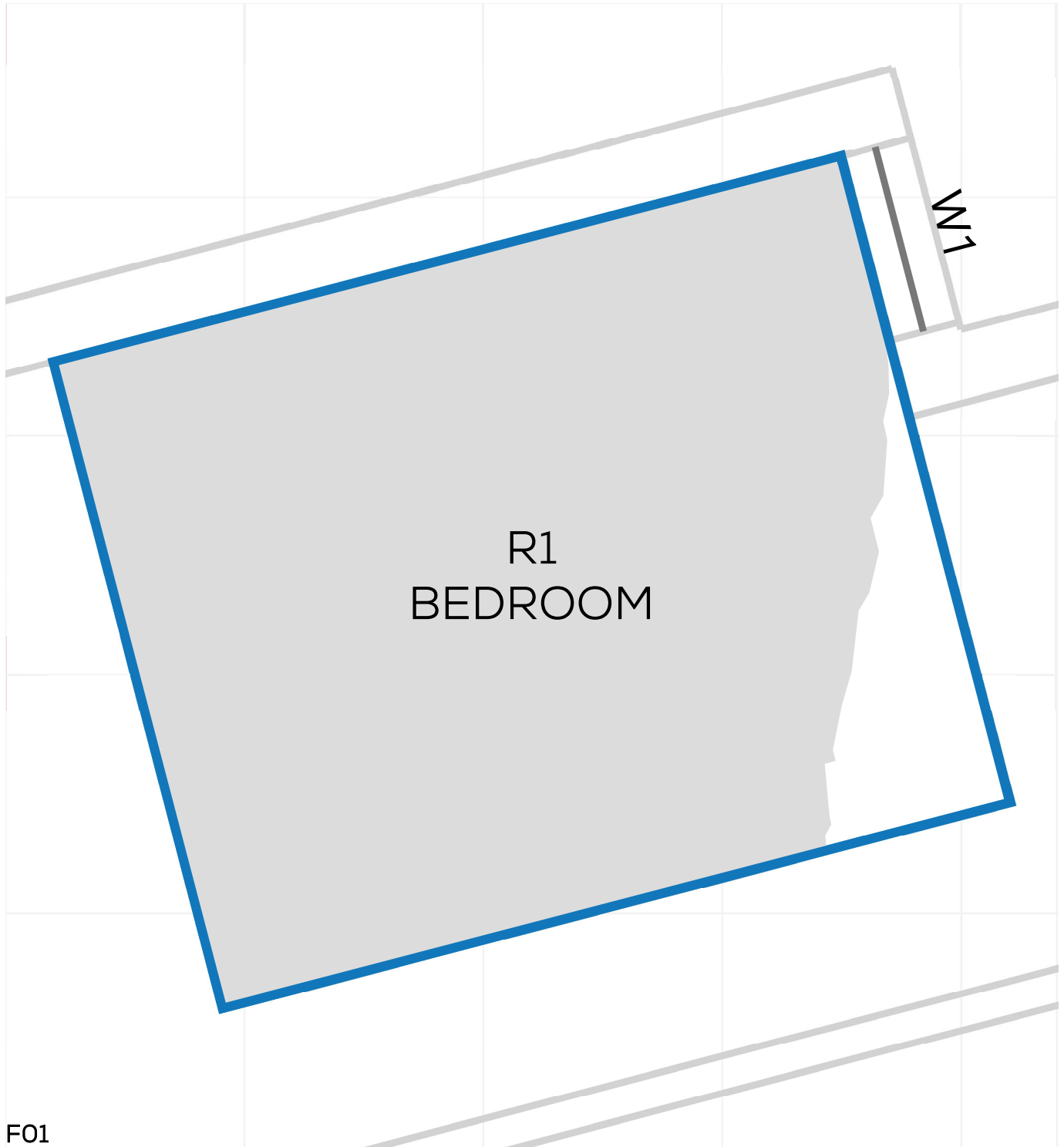
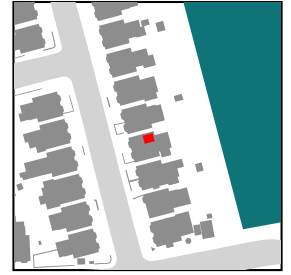

NSL CONTOURS



PROJECT: 14047 - CAMBRIDGE ROAD
REPORT TITLE: EXISTING VS. PROPOSED
ADDRESS: 15 PORTMAN ROAD
DATE: 02/10/2020
SCHEME IR: IR23 (07.09.2020)
DRAWING No.: 14047-RELO6-IS02-DD350

KEY:

- GAIN
- LOSS
- MAINTAINED LIT AREA
- 1 METRE GRID

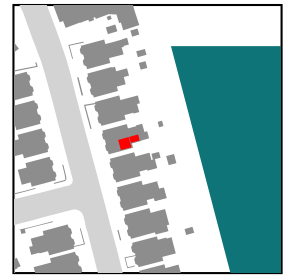





NSL CONTOURS



PROJECT: 14047 - CAMBRIDGE ROAD
REPORT TITLE: EXISTING VS. PROPOSED
ADDRESS: 15 PORTMAN ROAD
DATE: 02/10/2020
SCHEME IR: IR23 (07.09.2020)
DRAWING No.: 14047-RELO6-IS02-DD351

KEY:

-  GAIN
-  LOSS
-  MAINTAINED LIT AREA
-  1 METRE GRID



NSL CONTOURS



PROJECT: 14047 - CAMBRIDGE ROAD
REPORT TITLE: EXISTING VS. PROPOSED
ADDRESS: 19 PORTMAN ROAD
DATE: 02/10/2020
SCHEME IR: IR23 (07.09.2020)
DRAWING No.: 14047-RELO6-IS02-DD352

KEY:

- GAIN
- LOSS
- MAINTAINED LIT AREA
- 1 METRE GRID

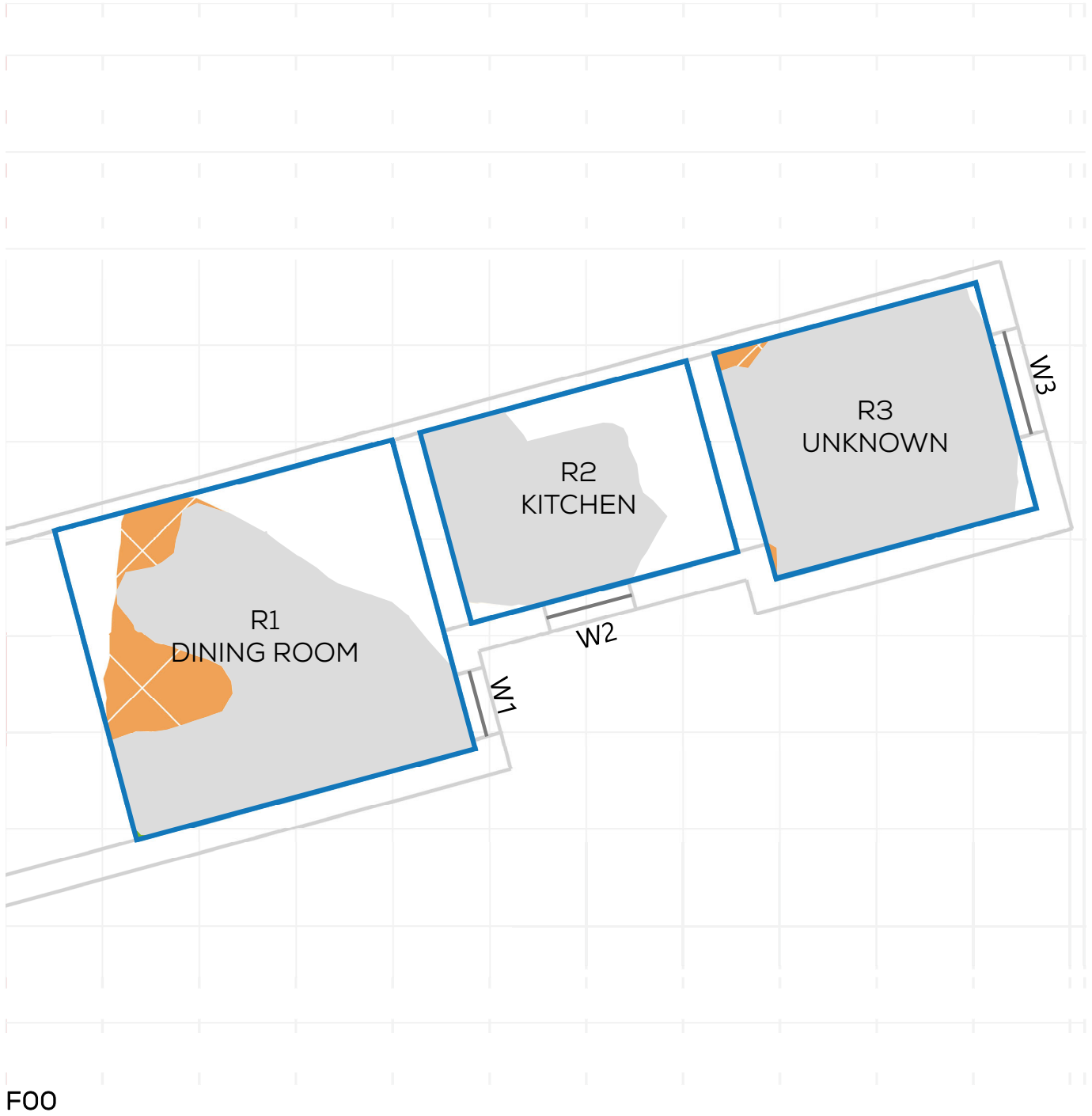

NSL CONTOURS



PROJECT: 14047 - CAMBRIDGE ROAD
REPORT TITLE: EXISTING VS. PROPOSED
ADDRESS: 19 PORTMAN ROAD
DATE: 02/10/2020
SCHEME IR: IR23 (07.09.2020)
DRAWING No.: 14047-RELO6-IS02-DD353

KEY:

- GAIN
- LOSS
- MAINTAINED LIT AREA
- 1 METRE GRID



NSL CONTOURS



PROJECT: 14047 - CAMBRIDGE ROAD
REPORT TITLE: EXISTING VS. PROPOSED
ADDRESS: 27 PORTMAN ROAD
DATE: 02/10/2020
SCHEME IR: IR23 (07.09.2020)
DRAWING No.: 14047-RELO6-IS02-DD354

KEY:

- GAIN
- LOSS
- MAINTAINED LIT AREA
- 1 METRE GRID

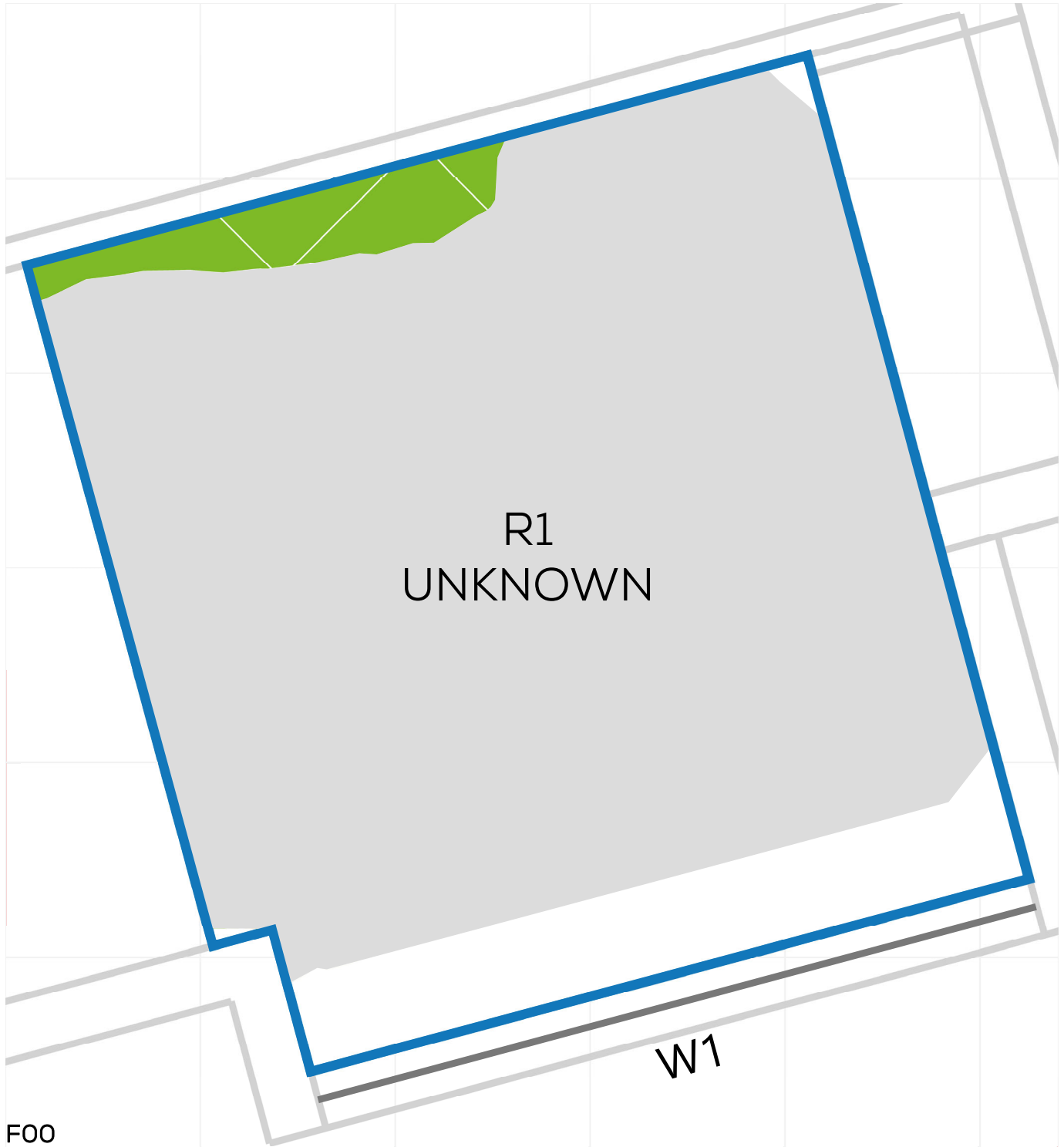

NSL CONTOURS



PROJECT: 14047 - CAMBRIDGE ROAD
REPORT TITLE: EXISTING VS. PROPOSED
ADDRESS: 27 PORTMAN ROAD
DATE: 02/10/2020
SCHEME IR: IR23 (07.09.2020)
DRAWING No.: 14047-RELO6-IS02-DD355

KEY:

- GAIN
- LOSS
- MAINTAINED LIT AREA
- 1 METRE GRID



NSL CONTOURS



PROJECT: 14047 - CAMBRIDGE ROAD
REPORT TITLE: EXISTING VS. PROPOSED
ADDRESS: 27 PORTMAN ROAD
DATE: 02/10/2020
SCHEME IR: IR23 (07.09.2020)
DRAWING No.: 14047-RELO6-IS02-DD356

KEY:

- GAIN
- LOSS
- MAINTAINED LIT AREA
- 1 METRE GRID



NSL CONTOURS



PROJECT: 14047 - CAMBRIDGE ROAD
REPORT TITLE: EXISTING VS. PROPOSED
ADDRESS: 31 PORTMAN ROAD
DATE: 02/10/2020
SCHEME IR: IR23 (07.09.2020)
DRAWING No.: 14047-RELO6-IS02-DD357

KEY:

- GAIN
- LOSS
- MAINTAINED LIT AREA
- 1 METRE GRID



NSL CONTOURS



PROJECT: 14047 - CAMBRIDGE ROAD
REPORT TITLE: EXISTING VS. PROPOSED
ADDRESS: 31 PORTMAN ROAD
DATE: 02/10/2020
SCHEME IR: IR23 (07.09.2020)
DRAWING No.: 14047-RELO6-IS02-DD358

KEY:

- GAIN
- LOSS
- MAINTAINED LIT AREA
- 1 METRE GRID



NSL CONTOURS



PROJECT: 14047 - CAMBRIDGE ROAD
REPORT TITLE: EXISTING VS. PROPOSED
ADDRESS: 29 PORTMAN ROAD
DATE: 02/10/2020
SCHEME IR: IR23 (07.09.2020)
DRAWING No.: 14047-RELO6-IS02-DD359

KEY:

- GAIN
- LOSS
- MAINTAINED LIT AREA
- 1 METRE GRID

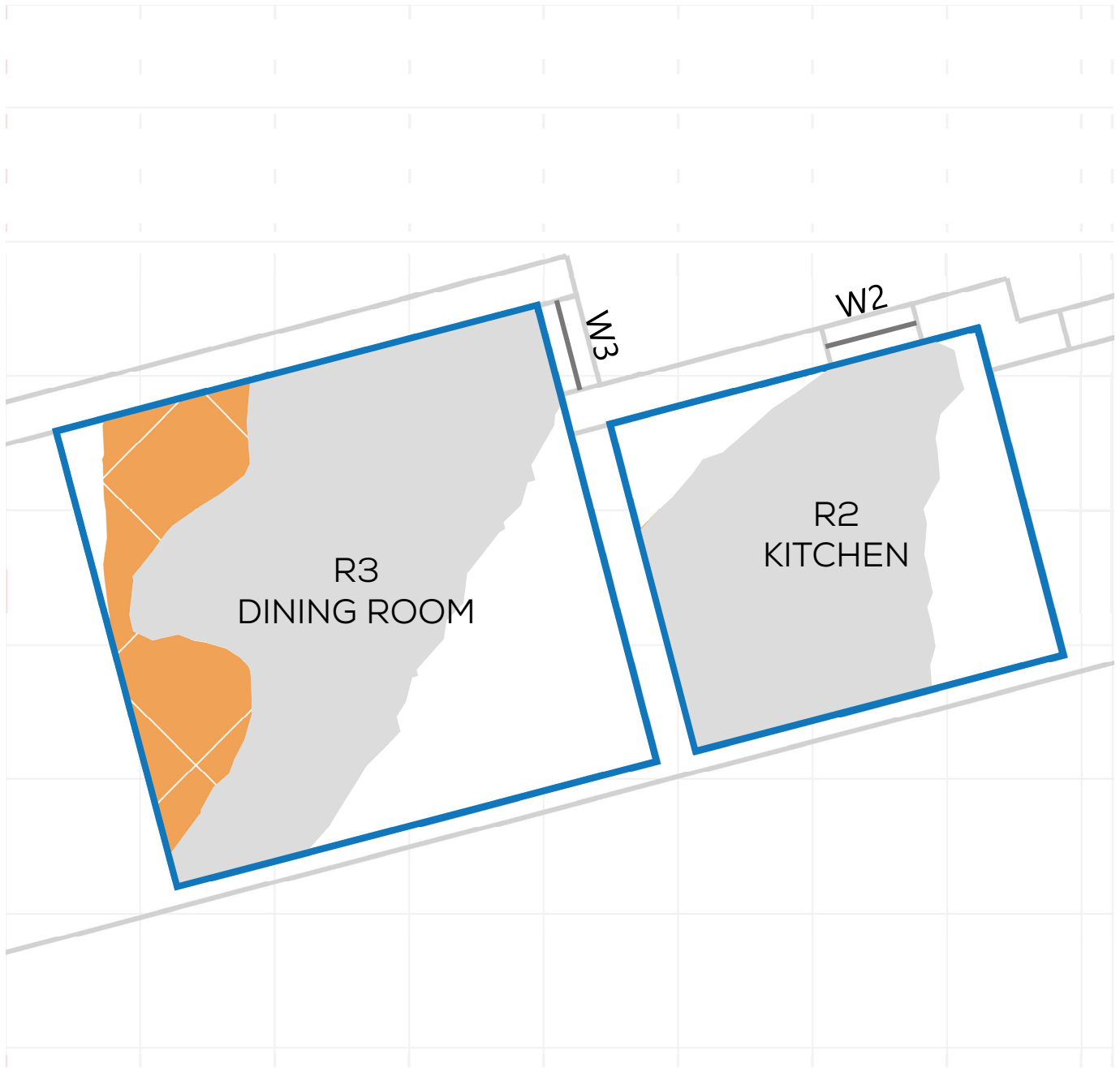

NSL CONTOURS



PROJECT: 14047 - CAMBRIDGE ROAD
REPORT TITLE: EXISTING VS. PROPOSED
ADDRESS: 29 PORTMAN ROAD
DATE: 02/10/2020
SCHEME IR: IR23 (07.09.2020)
DRAWING No.: 14047-RELO6-IS02-DD360

KEY:

- GAIN
- LOSS
- MAINTAINED LIT AREA
- 1 METRE GRID



NSL CONTOURS



PROJECT: 14047 - CAMBRIDGE ROAD
REPORT TITLE: EXISTING VS. PROPOSED
ADDRESS: 43 PORTMAN ROAD
DATE: 02/10/2020
SCHEME IR: IR23 (07.09.2020)
DRAWING No.: 14047-RELO6-IS02-DD361

KEY:

- GAIN
- LOSS
- MAINTAINED LIT AREA
- 1 METRE GRID

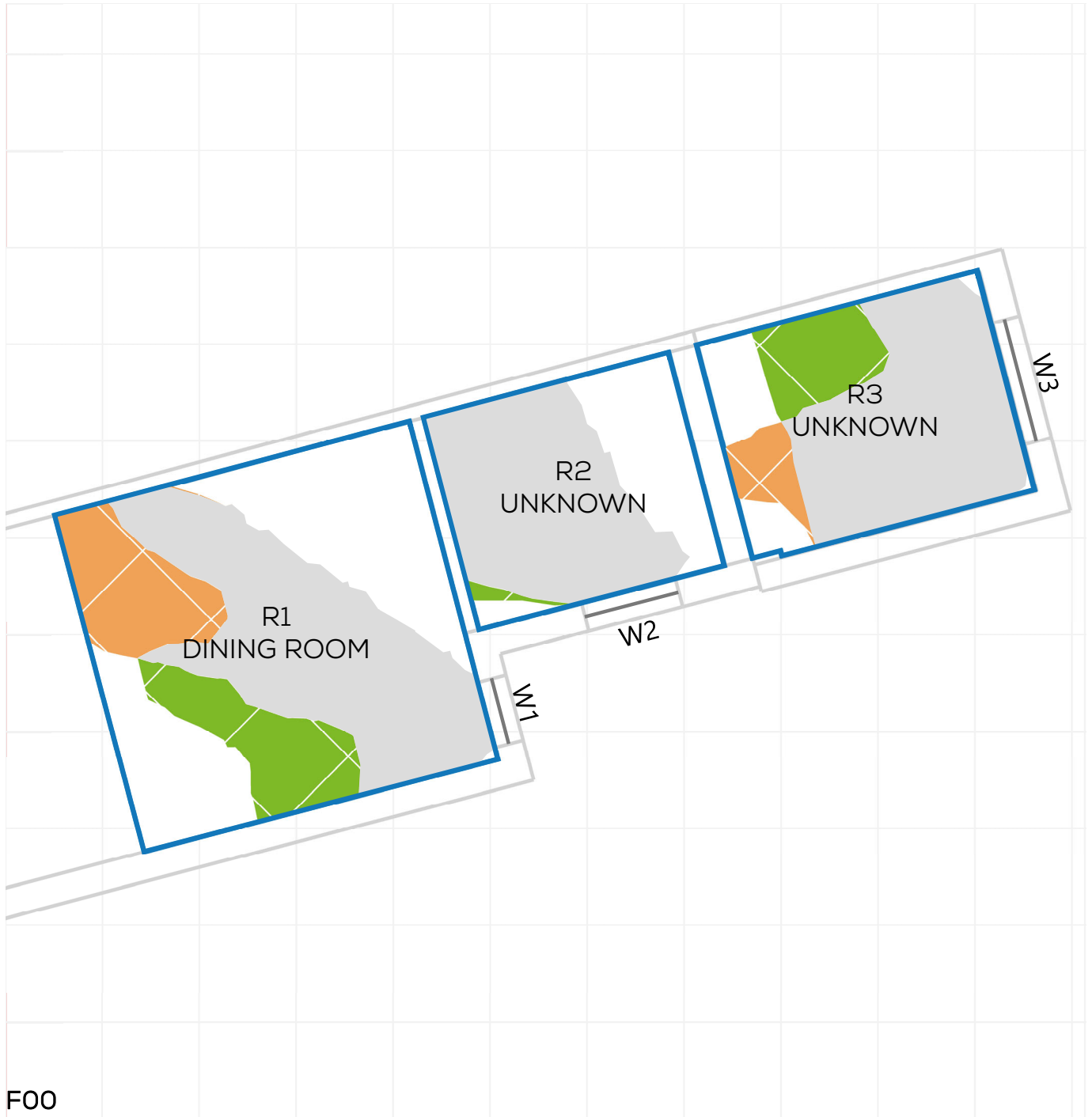

NSL CONTOURS



PROJECT: 14047 - CAMBRIDGE ROAD
REPORT TITLE: EXISTING VS. PROPOSED
ADDRESS: 43 PORTMAN ROAD
DATE: 02/10/2020
SCHEME IR: IR23 (07.09.2020)
DRAWING No.: 14047-RELO6-IS02-DD362

KEY:

- GAIN
- LOSS
- MAINTAINED LIT AREA
- 1 METRE GRID



NSL CONTOURS



PROJECT: 14047 - CAMBRIDGE ROAD
REPORT TITLE: EXISTING VS. PROPOSED
ADDRESS: 43 PORTMAN ROAD
DATE: 02/10/2020
SCHEME IR: IR23 (07.09.2020)
DRAWING No.: 14047-RELO6-IS02-DD363

KEY:

- GAIN
- LOSS
- MAINTAINED LIT AREA
- 1 METRE GRID

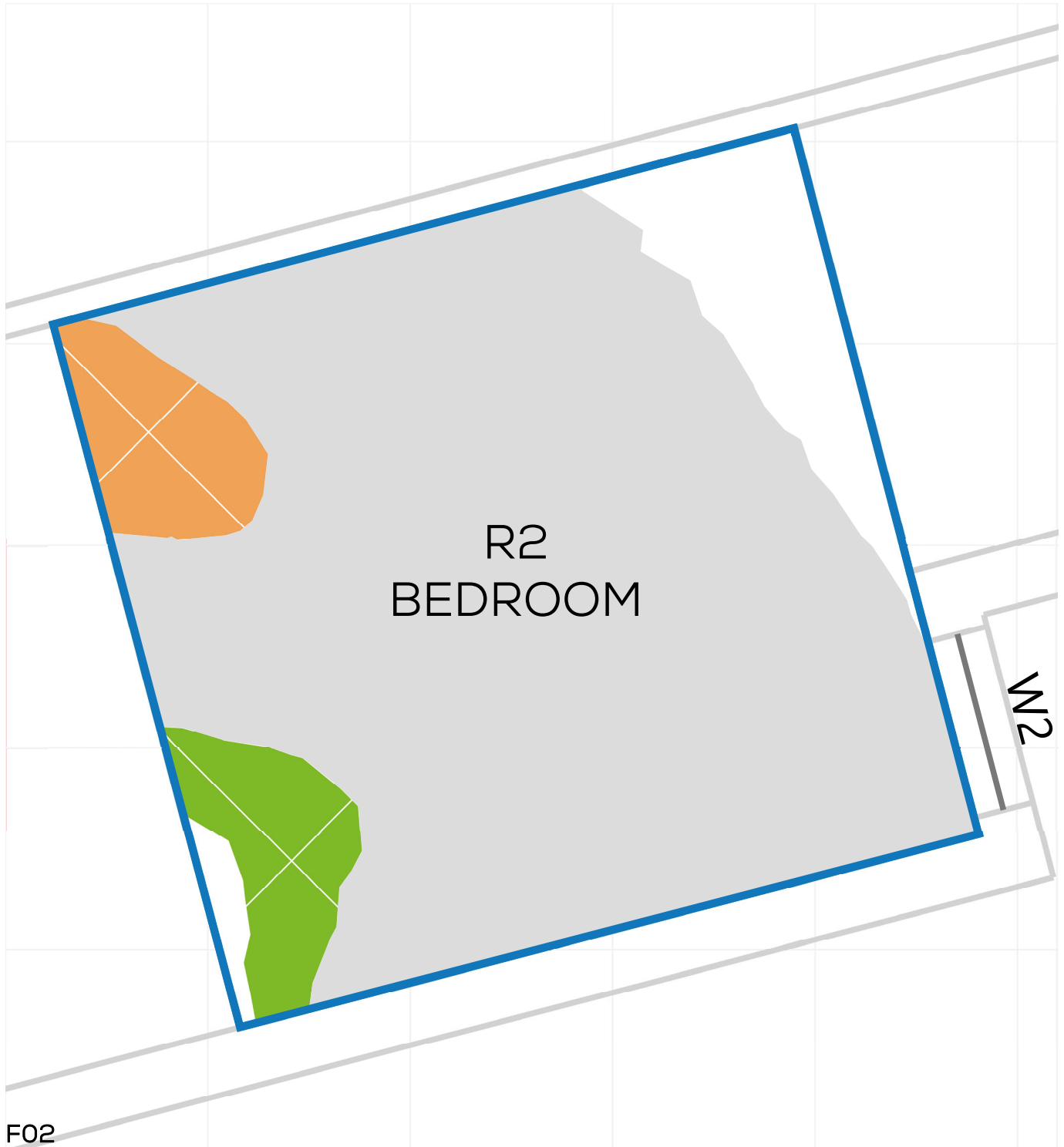

NSL CONTOURS



PROJECT: 14047 - CAMBRIDGE ROAD
REPORT TITLE: EXISTING VS. PROPOSED
ADDRESS: 41 PORTMAN ROAD
DATE: 02/10/2020
SCHEME IR: IR23 (07.09.2020)
DRAWING No.: 14047-RELO6-IS02-DD364

KEY:

- GAIN
- LOSS
- MAINTAINED LIT AREA
- 1 METRE GRID

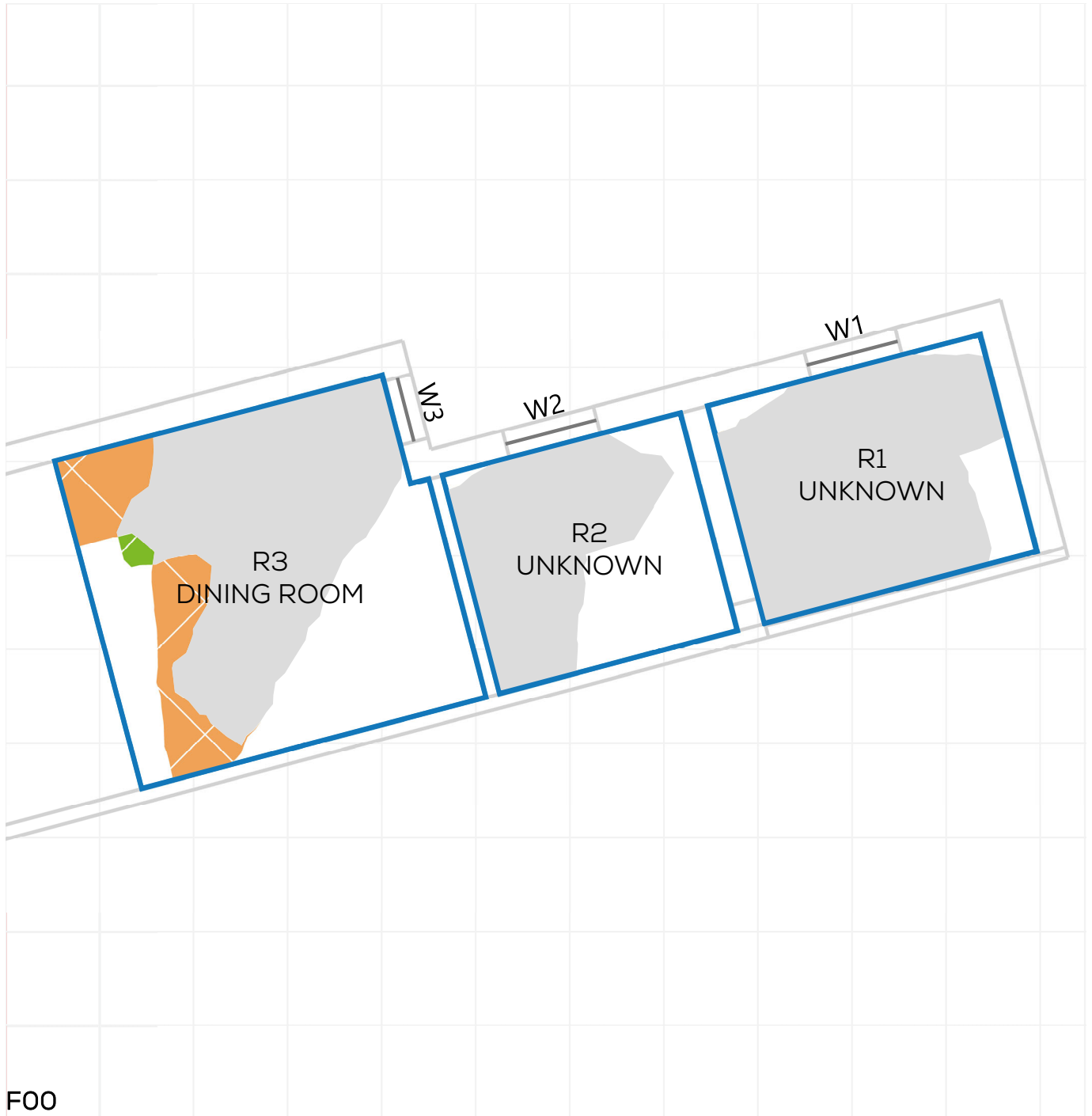

FOO

NSL CONTOURS



PROJECT: 14047 - CAMBRIDGE ROAD
REPORT TITLE: EXISTING VS. PROPOSED
ADDRESS: 41 PORTMAN ROAD
DATE: 02/10/2020
SCHEME IR: IR23 (07.09.2020)
DRAWING No.: 14047-RELO6-IS02-DD365

KEY:

- GAIN
- LOSS
- MAINTAINED LIT AREA
- 1 METRE GRID



NSL CONTOURS



PROJECT: 14047 - CAMBRIDGE ROAD
REPORT TITLE: EXISTING VS. PROPOSED
ADDRESS: 45 PORTMAN ROAD
DATE: 02/10/2020
SCHEME IR: IR23 (07.09.2020)
DRAWING No.: 14047-RELO6-IS02-DD366

KEY:

- GAIN
- LOSS
- MAINTAINED LIT AREA
- 1 METRE GRID

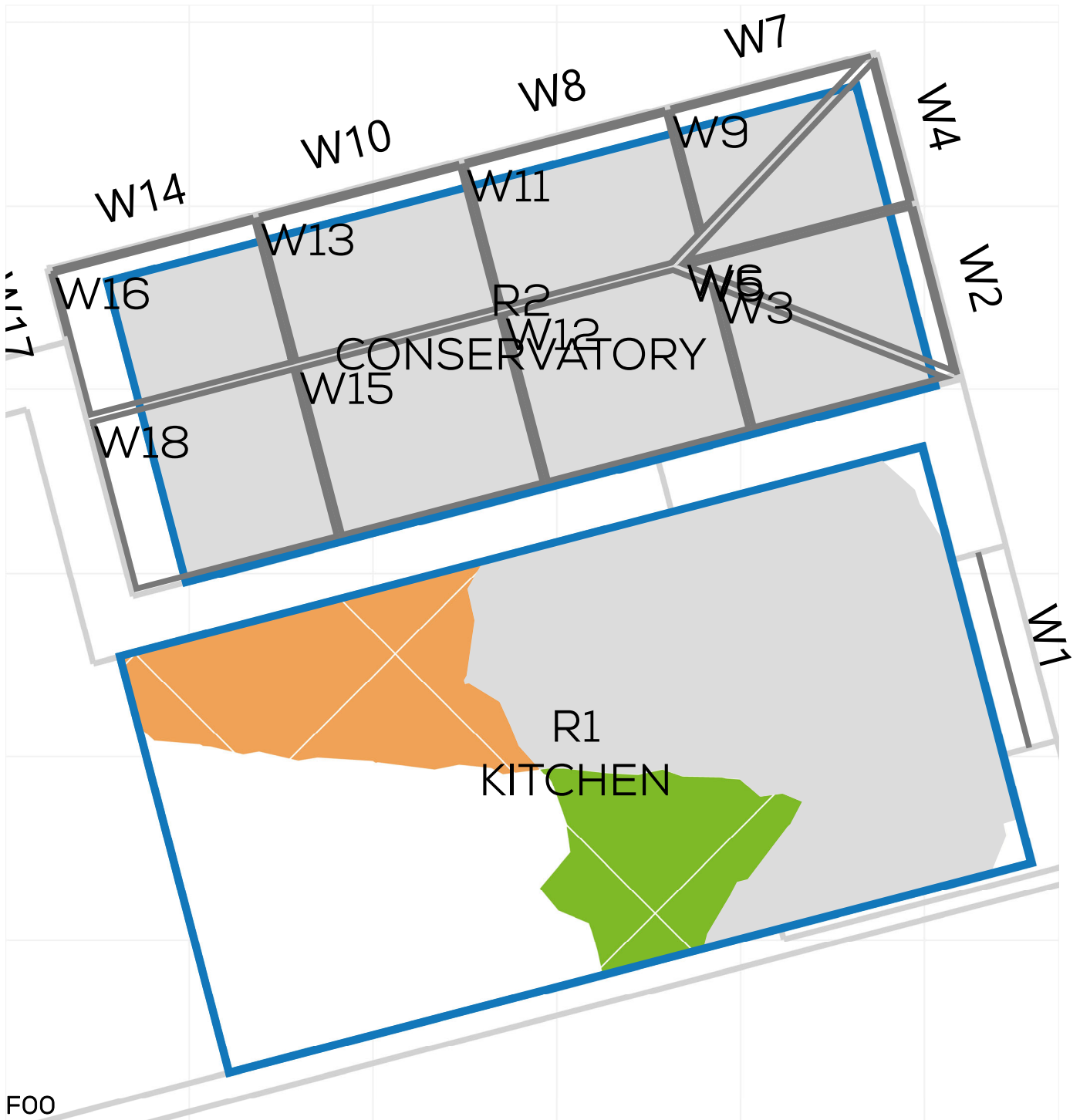

NSL CONTOURS



PROJECT: 14047 - CAMBRIDGE ROAD
REPORT TITLE: EXISTING VS. PROPOSED
ADDRESS: 45 PORTMAN ROAD
DATE: 02/10/2020
SCHEME IR: IR23 (07.09.2020)
DRAWING No.: 14047-RELO6-IS02-DD367

KEY:

- GAIN
- LOSS
- MAINTAINED LIT AREA
- 1 METRE GRID

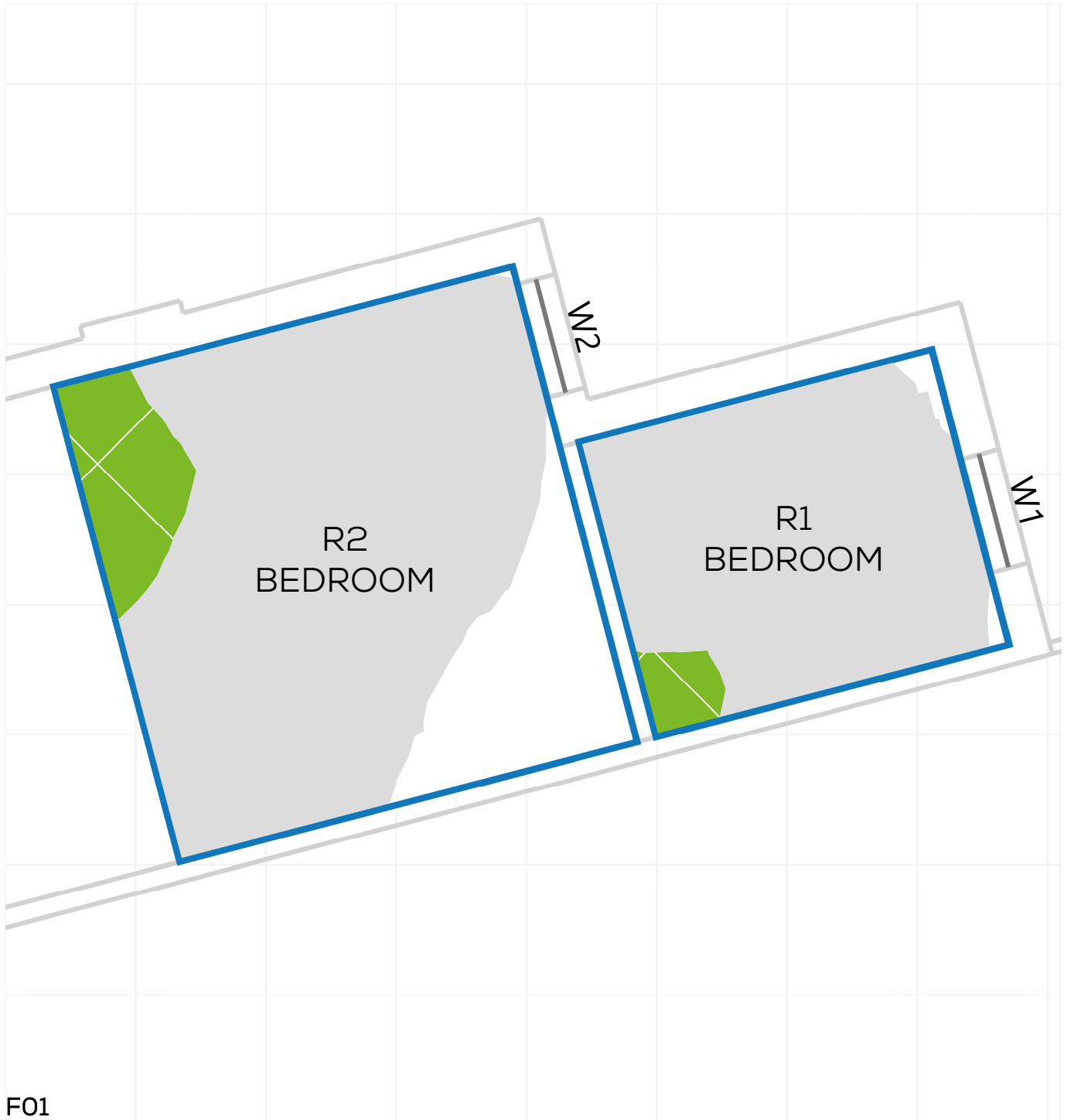

F01

NSL CONTOURS



PROJECT: 14047 - CAMBRIDGE ROAD
REPORT TITLE: EXISTING VS. PROPOSED
ADDRESS: 45 PORTMAN ROAD
DATE: 02/10/2020
SCHEME IR: IR23 (07.09.2020)
DRAWING No.: 14047-RELO6-IS02-DD368

KEY:

- GAIN
- LOSS
- MAINTAINED LIT AREA
- 1 METRE GRID

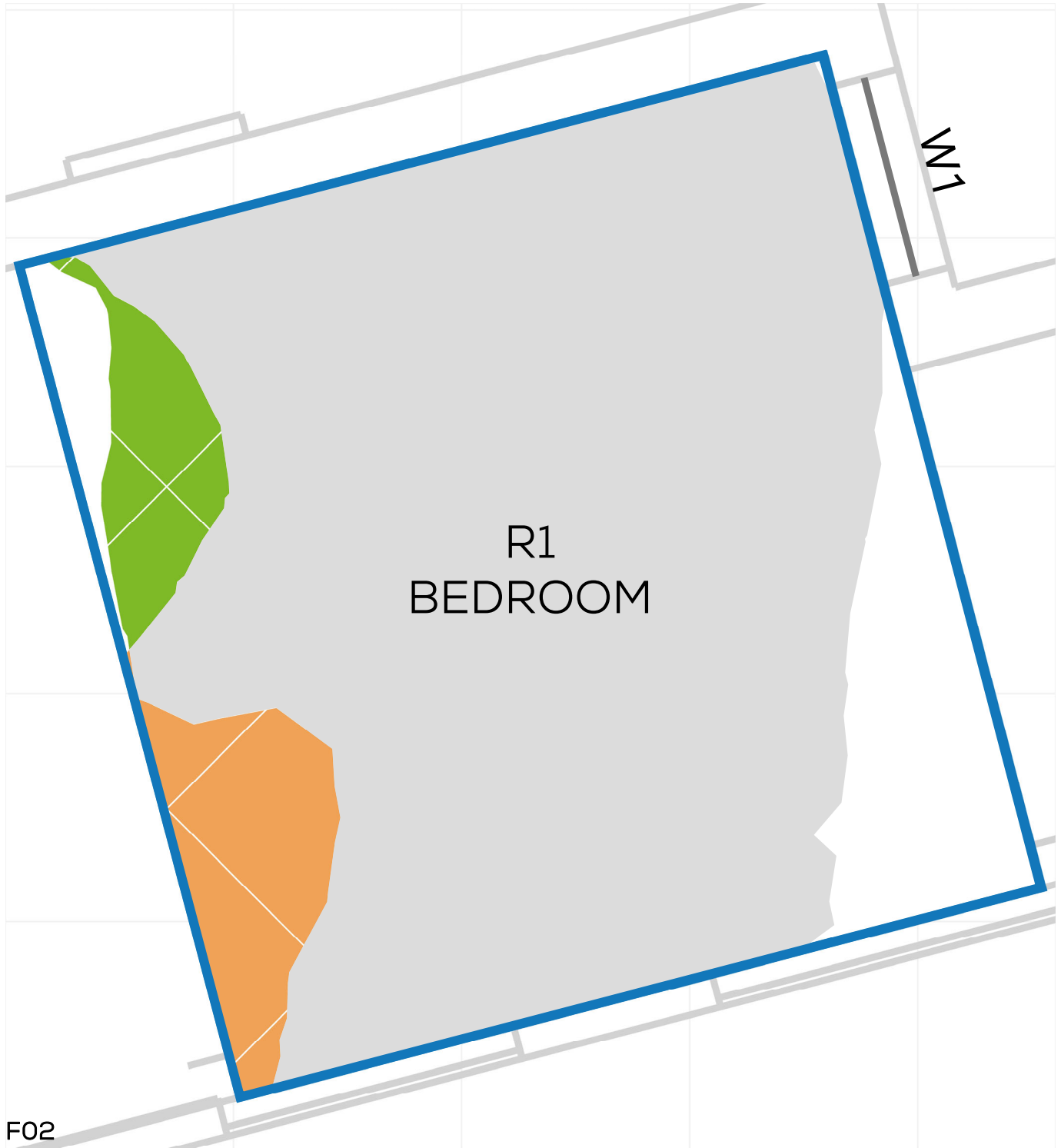

NSL CONTOURS



PROJECT: 14047 - CAMBRIDGE ROAD
REPORT TITLE: EXISTING VS. PROPOSED
ADDRESS: 47 PORTMAN ROAD
DATE: 02/10/2020
SCHEME IR: IR23 (07.09.2020)
DRAWING No.: 14047-RELO6-IS02-DD369

KEY:

- GAIN
- LOSS
- MAINTAINED LIT AREA
- 1 METRE GRID

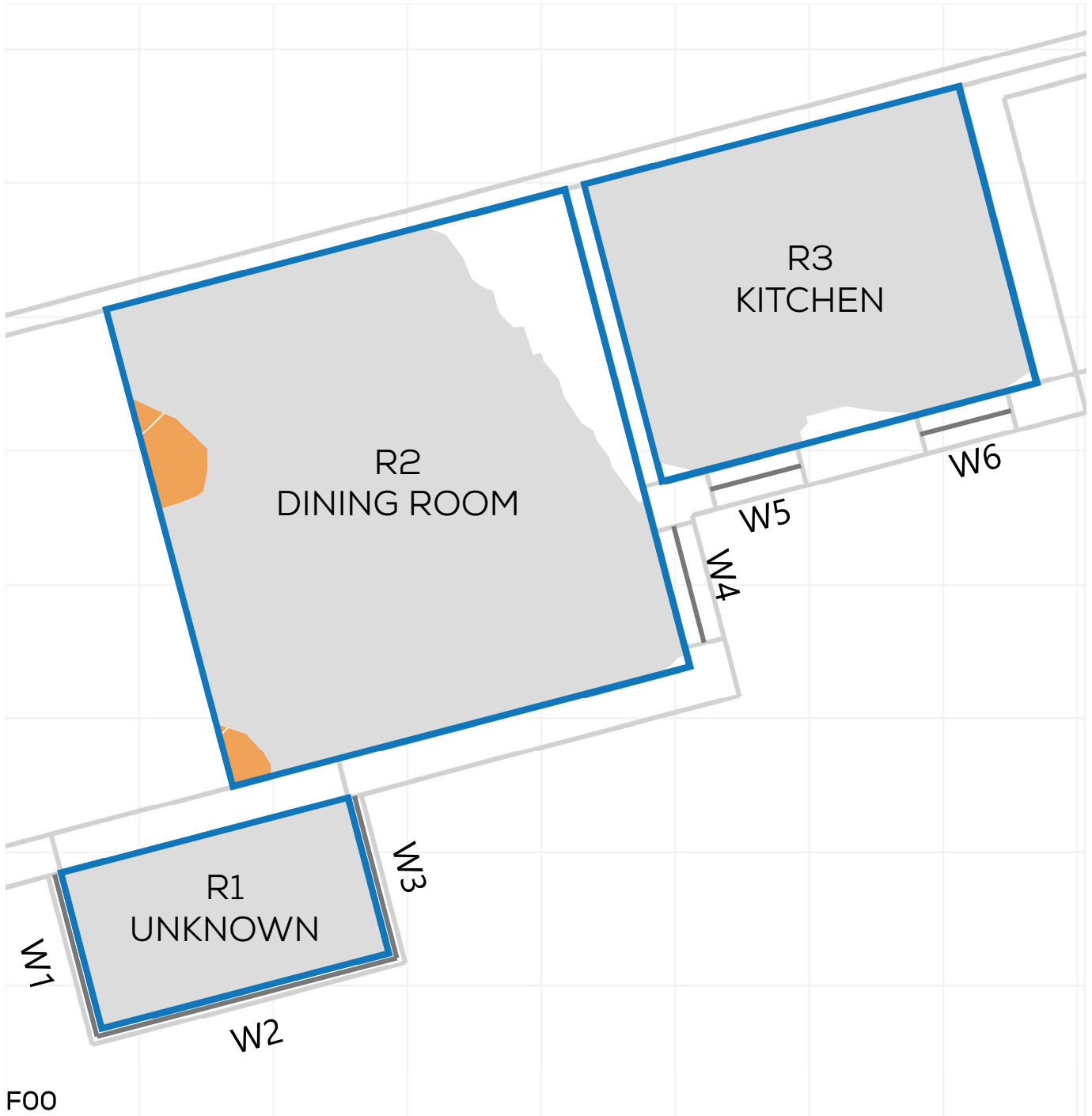

NSL CONTOURS



PROJECT: 14047 - CAMBRIDGE ROAD
REPORT TITLE: EXISTING VS. PROPOSED
ADDRESS: 47 PORTMAN ROAD
DATE: 02/10/2020
SCHEME IR: IR23 (07.09.2020)
DRAWING No.: 14047-RELO6-IS02-DD370

KEY:

- GAIN
- LOSS
- MAINTAINED LIT AREA
- 1 METRE GRID

