



**TOPOGRAPHICAL & MEASURED BUILDING SURVEYS**

**ABBREVIATIONS & SYMBOLS**

AA	Arch Height	FL	Fire Level	RL	Road Level
AB	Asphalt	FB	Floor Board	SL	Sign Post
AV	Air Valve	FR	Fire Risk	SP	Arch Spring Height
BL	Block Level	GL	Ground Level	ST	Street
BR	Brick	HL	High Level	SV	Surface Valve
BS	Bus Stop	IG	Iron Grate	SW	Surface Water
BT	Bus Stop	IS	Iron Stair	TC	Tree Centre
CC	Concrete	LD	Lead	TR	Tree
CD	Cast Iron	LS	Lead Stair	TR	Tree
CE	Cement	LV	Lead Valve	TR	Tree
CF	Cast Iron	LV	Lead Valve	TR	Tree
CG	Cast Iron	LV	Lead Valve	TR	Tree
CH	Cast Iron	LV	Lead Valve	TR	Tree
CI	Cast Iron	LV	Lead Valve	TR	Tree
CL	Cast Iron	LV	Lead Valve	TR	Tree
CM	Cast Iron	LV	Lead Valve	TR	Tree
CO	Cast Iron	LV	Lead Valve	TR	Tree
CP	Cast Iron	LV	Lead Valve	TR	Tree
CQ	Cast Iron	LV	Lead Valve	TR	Tree
CR	Cast Iron	LV	Lead Valve	TR	Tree
CS	Cast Iron	LV	Lead Valve	TR	Tree
CT	Cast Iron	LV	Lead Valve	TR	Tree
CU	Cast Iron	LV	Lead Valve	TR	Tree
CV	Cast Iron	LV	Lead Valve	TR	Tree
CW	Cast Iron	LV	Lead Valve	TR	Tree
CX	Cast Iron	LV	Lead Valve	TR	Tree
CY	Cast Iron	LV	Lead Valve	TR	Tree
CZ	Cast Iron	LV	Lead Valve	TR	Tree
DA	Cast Iron	LV	Lead Valve	TR	Tree
DB	Cast Iron	LV	Lead Valve	TR	Tree
DC	Cast Iron	LV	Lead Valve	TR	Tree
DD	Cast Iron	LV	Lead Valve	TR	Tree
DE	Cast Iron	LV	Lead Valve	TR	Tree
DF	Cast Iron	LV	Lead Valve	TR	Tree
DG	Cast Iron	LV	Lead Valve	TR	Tree
DH	Cast Iron	LV	Lead Valve	TR	Tree
DI	Cast Iron	LV	Lead Valve	TR	Tree
DJ	Cast Iron	LV	Lead Valve	TR	Tree
DK	Cast Iron	LV	Lead Valve	TR	Tree
DL	Cast Iron	LV	Lead Valve	TR	Tree
DM	Cast Iron	LV	Lead Valve	TR	Tree
DN	Cast Iron	LV	Lead Valve	TR	Tree
DO	Cast Iron	LV	Lead Valve	TR	Tree
DP	Cast Iron	LV	Lead Valve	TR	Tree
DQ	Cast Iron	LV	Lead Valve	TR	Tree
DR	Cast Iron	LV	Lead Valve	TR	Tree
DS	Cast Iron	LV	Lead Valve	TR	Tree
DT	Cast Iron	LV	Lead Valve	TR	Tree
DU	Cast Iron	LV	Lead Valve	TR	Tree
DV	Cast Iron	LV	Lead Valve	TR	Tree
DW	Cast Iron	LV	Lead Valve	TR	Tree
DX	Cast Iron	LV	Lead Valve	TR	Tree
DY	Cast Iron	LV	Lead Valve	TR	Tree
DZ	Cast Iron	LV	Lead Valve	TR	Tree

**DRAWING NOTE**

These drawings are to scale showing the average canopy spread. Descriptions and heights should be used as a guide only.

All building names, descriptions, number of storeys, construction type including roof line details are indicative only and taken externally from ground level.

All below ground details including drainage, voids and services have been identified from above ground and transferred to all details relating to these features including: size, depth, description etc will be appropriate only. All critical dimensions and connections should be checked and verified prior to starting work.

Datums, services and features may not have been surveyed if obstructed or not reasonably visible at the time of the survey.

**Measured Building Surveys**

Measurements to internal walls are taken to the wall finishes at approx 1m above the floor level and the wall assumed to be vertical.

Cell heights are measured as floor to the cell and head heights are measured from cell to the top of window.

**General**

The contractor must check and verify all site and building dimensions, levels, utilities and drainage details and connections prior to commencing work. Any errors or discrepancies must be notified to Survey Solutions immediately.

The accuracy of the digital data is the same as the plotting scale implies. All dimensions are in metres unless otherwise stated.

The survey control points are to be used for topographical surveys at the stated scale. All control must be checked and verified prior to use.

© Land Survey Solutions Limited holds the copyright to all the information contained within this document and their written consent must be obtained before copying or using the data other than for the purpose it was originally supplied.

Do not scale from this drawing.

**SURVEY GRID AND LEVEL DATUM**

The co-ordinate system established for this survey is related to Ordnance Survey (OS) national grid at a single point using GPS Smartnet, then oriented to Grid North with a scale factor of 1.000.

The level datum established for this survey is related to Ordnance Survey (OS) using GPS Smartnet.

To avoid discrepancies any co-ordinated data used in conjunction with this survey must be derived directly from this control data.

The major contour interval is 1 metre, the minor contour interval is 0.500 metres.

**CONTROL CO-ORDINATES**

POINT	EASTING	NORTHING	LEVEL	DESCRIPTION
MC01	519154.486	109022.318	12.405	Pt Nail
MC02	519154.413	109022.224	10.820	Pt Nail
MC03	519055.000	109022.224	14.331	Pt Nail
MC04	519055.000	109022.224	11.611	Pt Nail
MC05	519055.000	109046.301	10.845	Pt Nail
MC06	519055.000	109046.448	10.845	Pt Nail
MC07	519055.000	109071.054	10.286	Pt Nail
MC08	519055.000	109101.054	10.286	Pt Nail
MC09	519055.000	109101.054	10.286	Pt Nail
MC10	519055.000	109101.054	10.286	Pt Nail
MC11	519055.000	109101.054	10.286	Pt Nail
MC12	519055.000	109101.054	10.286	Pt Nail
MC13	519055.000	109101.054	10.286	Pt Nail
MC14	519055.000	109101.054	10.286	Pt Nail
MC15	519055.000	109101.054	10.286	Pt Nail
MC16	519055.000	109101.054	10.286	Pt Nail
MC17	519055.000	109101.054	10.286	Pt Nail
MC18	519055.000	109101.054	10.286	Pt Nail
MC19	519055.000	109101.054	10.286	Pt Nail
MC20	519055.000	109101.054	10.286	Pt Nail
MC21	519055.000	109101.054	10.286	Pt Nail
MC22	519055.000	109101.054	10.286	Pt Nail
MC23	519055.000	109101.054	10.286	Pt Nail

**SURVEY SOLUTIONS**

Ipswich Coventry Yeovil Norwich Perth Nottingham Brentwood

Tel: 01473 6255 989 Fax: 01473 6255 070  
www.survey-solutions.co.uk enquiries@survey-solutions.co.uk

LAND SURVEYING BUILDING SURVEYING UNDERGROUND SURVEYING

**PROJECT TITLE**  
CAMBRIDGE ROAD ESTATE,  
KINGSTON UPON THAMES, KT1 3JL.

**DRAWING DETAILS**  
TOPOGRAPHICAL SURVEY  
Sheet 3 of 5

CLIENT	SCALE
ARDENT CONSULTING ENGINEERS	1:200
SURVEYOR: JF, SB, BK	CHECKED BY: JAM
SURVEY DATE: 10.07.2017	APPROVED BY: JAM
DRAWING NUMBER: 20085e-03	ISSUE DATE: 11.08.2017
	REVISION:

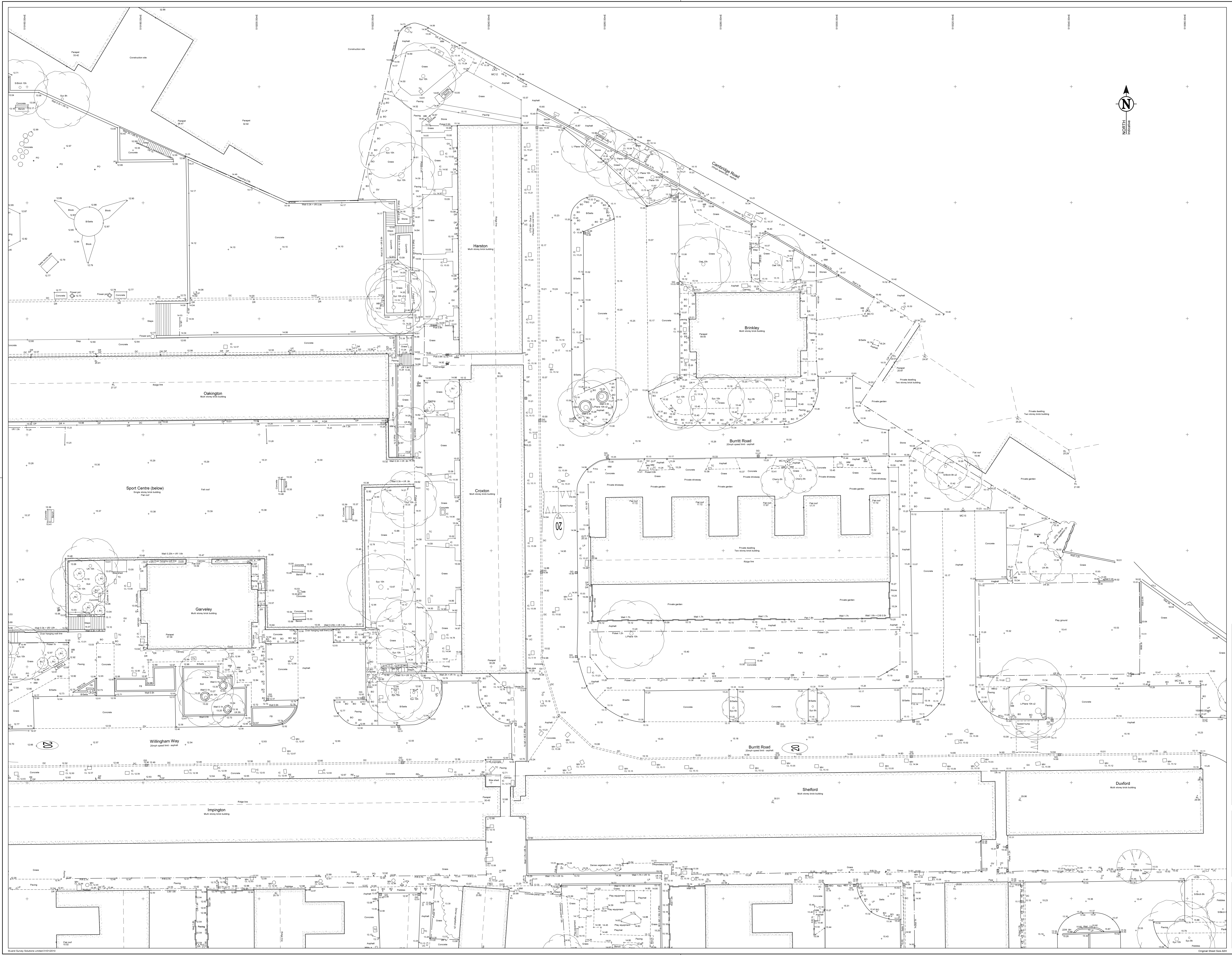

**TOPOGRAPHICAL & MEASURED BUILDING SURVEYS**

Table with columns for Abbreviations and Symbols, and their corresponding descriptions. Includes symbols for various survey points, levels, and building features.

**DRAWING NOTE**

Topographical Surveys: Trees are drawn to scale showing the average canopy spread. Descriptions and heights should be used as a guide only. All building names, descriptions, number of storeys, construction type including roof line details are indicative only and taken externally from ground level. All below ground details including drainage, voids and services have been identified from above ground and therefore all details relating to these features including: sizes, depth, description etc will be approximate only. All critical dimensions and connections should be checked and verified prior to starting work.

**Measured Building Surveys**

Measurements to internal walls are taken to the wall finishes at approx 1m above the floor level and the wall assumed to be vertical. All heights are measured as floor to the ceiling and head heights are measured from ceiling to the top of window. General: The contractor must check and verify all site and building dimensions, levels, utilities and drainage details and connections prior to commencing work. Any errors or discrepancies must be notified to Survey Solutions immediately. The accuracy of the digital data is the same as the plotting scale implies. All dimensions are in metres unless otherwise stated.

The survey control used in this drawing is for topographical surveys at the stated scale. All control must be checked and verified prior to use. Land Survey Solutions Limited holds the copyright to all the information contained within this document and their written consent must be obtained before copying or using the data other than for the purpose it was originally supplied. Do not scale from this drawing.

**SURVEY GRID AND LEVEL DATUM**

The co-ordinate system established for this survey is related to Ordnance Survey (OS) national grid at a single point using GPS Smartnet. Then orientated to Grid North with a scale factor of 1.000. The level datum established for this survey is related to Ordnance Survey (OS) using GPS Smartnet. To avoid discrepancies, any co-ordinated data used in conjunction with this survey must be derived directly from the control data. The major contour interval is 1 metre, the minor contour interval is 0.500 metres.

CONTROL CO-ORDINATES table with columns: STATION, Easting, Northing, ELEVATION, DESCRIPTION. Lists various survey points and their coordinates.

Table with columns: REV, DESCRIPTION, DRAWN, APPR, DATE. Shows revision history for the drawing.



PROJECT TITLE, DRAWING DETAILS, CLIENT, ARDENT CONSULTING ENGINEERS, SURVEYOR, SURVEY DATE, CHECKED BY, APPROVED BY, DRAWING NUMBER, SCALE, DWG STATUS, REVISION, ISSUE DATE.